

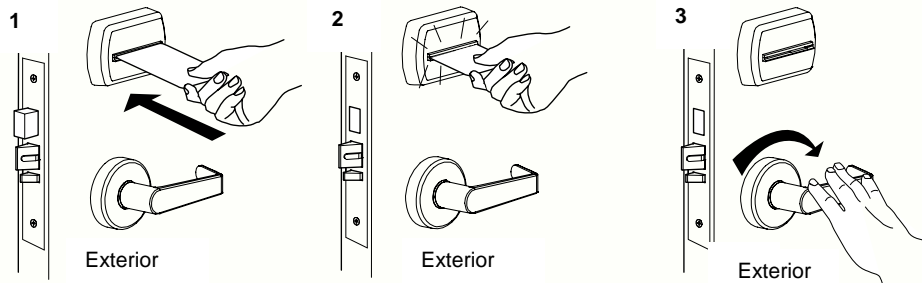

Quantum™ Lock Operation Instructions

Unlocking the Quantum™ MT™ lock from the outside

1. Fully insert your keycard into the slot.
2. Remove the keycard from the slot.
3. While the green light is flashing, turn the lever and open the door.



Unlocking the Quantum™ RFID lock from the outside

1. Bring the flat surface of your keycard near the circular RFID reader. When the keycard is close enough to be read, the yellow light will flash on the RFID reader. You will hear the lock operate.
2. The green light will begin to flash once access has been granted.
3. Turn the lever and open the door while the green light is flashing.

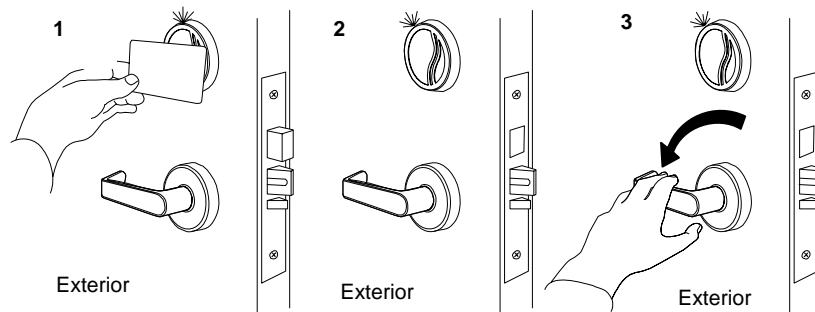

FCC Warning: The users of this equipment shall not change or modify the equipment in any way, or they could void their authority to operate the equipment under FCC rules.

All information contained herein, including but not limited to product pricing and other intellectual property, is confidential and intended for the sole use of the addressee(s) so named. Any misuse of this confidential information contained herein may result in legal action by Computerized Security Systems dba SAFLOK and its parent company.

Locking and unlocking the door from the inside

- Rotate the turn piece to engage the privacy feature.
- To unlock the door from the inside, simply turn the lever.

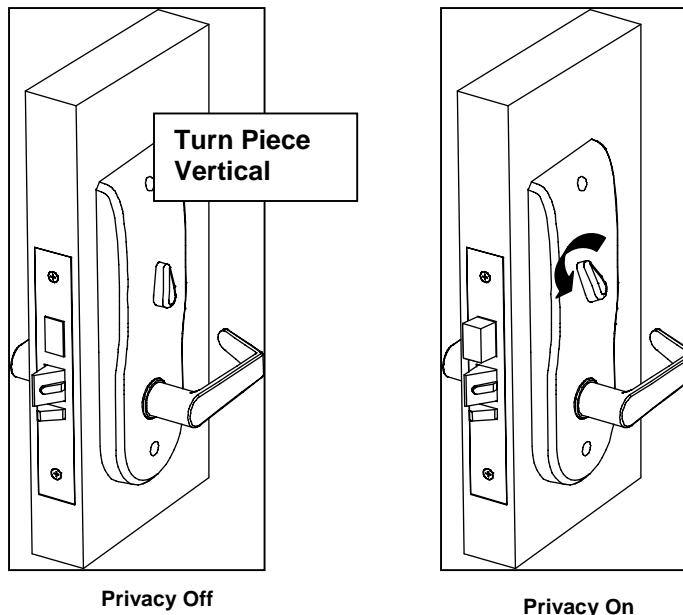

Programming Quantum Locks Using the LPI and LPI-R Probes

The front desk system (System 6000™, DeskLinc™, or Passport™) will transfer the lock code information from the main computer to the lock via the handheld LPI device.

Follow the steps for lock programming in the system’s operations manual.

- For Quantum MT locks, insert the probe directly into the lock to transfer the lock code information from the LPI Device to the lock.
- For Quantum RFID locks, remove the rubber cover from the port on the bottom of the RFID reader. Plug in the LPI-R device cable to transfer the lock code information from the LPI Device to the lock.

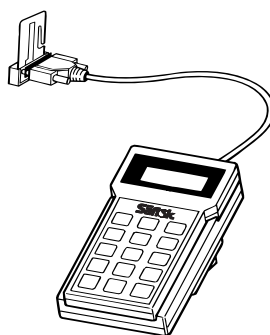

LPI Probe for Quantum MT Card Readers

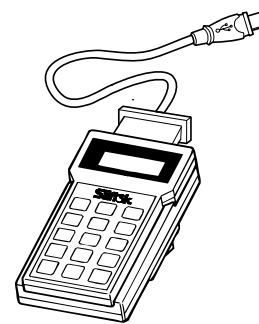

LPI-R Probe for Quantum RFID Readers



For worldwide office locations and contact information, visit us at www.Saflok.com.

Americas
Phone: **877.272.3565**
Troy, MI, USA

Europe · Middle East · Africa
Phone: **00.32.3.766.00.20**

Asia
Phone: **021.5868.1481**

Manufactured under one or more of the following patents:
U.S.: 4,177,657; 4,411,144; 4,534,194; 4,890,870; 5,198,643;
5,477,041; 5,820,177; 5,986,564; 7,051,561; D494,841; D501,131
D512,899; D519,021 CANADA: 1,252,854; 1,298,902
U.K. 2,010,375
Other U.S. and foreign patents pending

SAFLOK reserves the right to modify the characteristics and features of all products in this publication.
©2007 SAFLOK, all rights reserved.