

# Personal Audio Enhancer



## PAE-380 User Manual



Please note:

For ***PAE-Talk package***, please refer to ***PAE-380 Handset*** operations on this manual.

## IMPORTANT PRODUCT SAFETY AND OPERATION INSTRUCTIONS

THIS INSTRUCTION MANUAL HIGHLIGHTS KEY INFORMATION ABOUT SAFETY, OPERATION AND MAINTENANCE OF THE PERSONAL AUDIO ENHANCER.

PLEASE READ THROUGH THIS MANUAL IN ITS ENTIRETY BEFORE STARTING TO USE THE PRODUCT. IT PROVIDES VALUABLE INFORMATION FOR HOW TO UTILIZE AND MAINTAIN THE PRODUCT AND FOR HOW TO PROTECT USER'S SAFETY DURING OPERATION. PLEASE CAREFULLY FOLLOW THE INSTRUCTIONS OUTLINED IN THIS MANUAL.



### Note

- This product is not a hearing instrument. Anyone who is experiencing hearing loss is recommended to consult with a doctor.
- This product will not restore normal hearing nor reduce hearing loss.
- This product has a sound amplifying function and the sound level can cause discomfort or damage hearing if the product is used improperly. Always turn the volume down to a low level before putting on the headset.
- To ensure child safety, please keep the package and small parts included in this product out of reach of children.

# IMPORTANT PRODUCT SAFETY AND OPERATION INSTRUCTIONS

## ***Operating Your Personal Audio Enhancer***

- Do not drop, disassemble, burn, paint or insert foreign objects into this product.
- Do not use this product if it has been cracked, punctured or damaged by water.

## ***Cleaning the Surface of Your Personal Audio Enhancer***

- Disconnect all power cables and turn off the system before cleaning this product.
- Use a soft slightly damp, lint-free cloth to clean this product.
- Do not use window cleaners, household cleaners, aerosol sprayers, solvents, alcohol, ammonia, or abrasives to clean this product.

## ***Charging***

- This product use re-chargeable Lithium-ion battery.
- This product must be fully charged before the first use.
- Only the Base Unit or Micro-USB charger provided with this product should be used for charging.
- The battery must be replaced by qualified personnel.
- It may cause explosion if the battery is replaced improperly.
- Battery charging should be performed at the temperature of 5 °C (41°F) to 40 °C (104°F).

## ***Charger***

- If some trouble occurs while using the charger, immediately shut off the power by disconnecting the plug from the wall outlet.
- To reduce the risk of fire or electric shock, avoid wetting, exposing under water, or placing containers with water on the product.
- To completely disconnect the power, unplug the charger from the AC power source.
- The rating of the charger is shown on the back of the charger.

## ***Maintenance***

- This product should be repaired by VitaSound authorized dealers, or service center staff only.
- Unauthorized persons should not attempt to repair or modify this product.
- Any attempted disassembly or repair of the product by a user or unauthorized party will void the product warranty and may irreparably damage the product.

## ***Avoid Water or Direct Heat***

- Do not expose the product into water or under rain.
- Do not expose under a temperature over 60 °C (140°F) such as directly under sunlight or in a car parked under sunlight.
- Do not burn, throw into fire, or heat by microwave.

**Introduction**

Personal Audio Enhancer .....	1
-------------------------------	---

**Getting started**

## PAE-380 Handset

Identifying parts .....	2
-------------------------	---

Power on/off .....	3
--------------------	---

Power indicator status .....	4
------------------------------	---

Bluetooth indicator status .....	5
----------------------------------	---

## Base Unit

Identifying parts .....	6
-------------------------	---

Power on/off .....	7
--------------------	---

Installation of Base Unit to television .....	8-11
---	------

Charging the PAE-380 handset .....	12-15
------------------------------------	-------

Bluetooth pairing with cell phone .....	16-18
---	-------

**Using Personal Audio Enhancer: PAE-380 handset**

General Operation .....	19-20
-------------------------	-------

Using PAE-380 handset to make or receive a call .....	21
---	----

Select Function Mode .....	22-28
----------------------------	-------

Select EQ Mode .....	29
----------------------	----

Adjust Volume .....	30
---------------------	----

Low Battery .....	31
-------------------	----

Reset PAE-380 handset .....	31
-----------------------------	----

# Table of contents

## **Wi-Mic: The assistant broadcasting device for PAE-380**

Wi-Mic introduction	32-33
Identifying parts of Wi-Mic	34
Charging the Wi-Mic	35
Auto-connection with PAE-380 handset	36
Using Wi-Mic	37-41

## **Other**

Frequently Asked Questions	42-44
Technical Specification	45-46

## Personal Audio Enhancer PAE-380

Thank you for choosing the Personal Audio Enhancer PAE-380 designed by VitaSound Audio Inc. This is a multi-functional communication device which delivers high-definition sound for everyday listening situations. Powered by patent neural-based technology, the Personal Audio Enhancer allows users to benefit from improved sound quality where background noise or low volume levels make listening and communication difficult.

### POWERED BY:





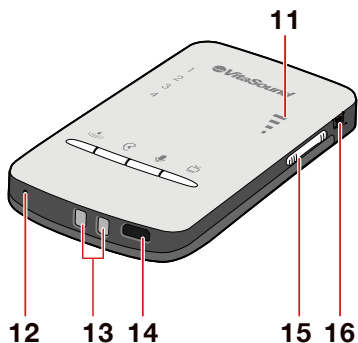
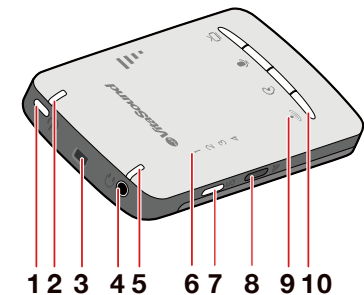

Using leading-edge brain science, patented Neuro-Compensator® technology enforces an optimal electrical signal from the root of the auditory nerve to the brain. Improving the listening experience by delivering a clear and natural sound.

## PAE-380 Handset



### Identifying parts

1. Power button
2. Bluetooth Indicator
3. Hook for neck strap
4. Headset port (Connect to headset)
5. Power indicator
6. EQ mode indicator
  - 1- Normal
  - 2/3/4 - High pitch frequency boost
7. EQ mode button
8. Bluetooth pair button
9. Function mode indicator
10. Function mode buttons
  -  TV Mode  
(For PAE-380 TALK package, optional Base Unit required.)
  -  Talk Mode
  -  Wi-Mic Mode  
(For PAE-380 TALK package, optional Wi-Mic is required.)
  -  Relaxation Mode
11. Volume level indicator
12. Reset button
13. Charging port for Base Unit
14. Micro-USB charger port
15. Volume buttons
16. Lock switch

## PAE-380 Handset

### Power On

Press and hold the power button until the **RED** power indicator is on;

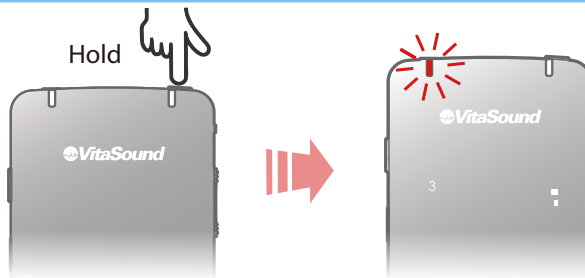

### Power Off

Press and hold the power button until all four function mode indicators are lit, then release the power button to turn off PAE-380 handset.

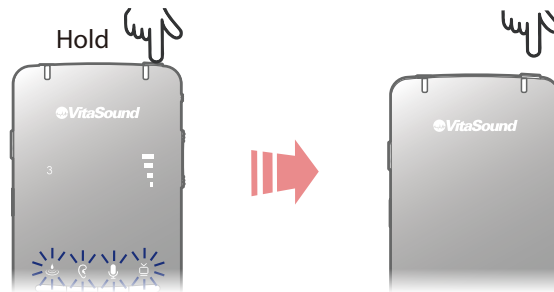

## Power Indicator Status

### Red

#### **Solid Red:**



The PAE-380 handset is on.

#### **Off:**



The PAE-380 handset is off.

#### **Flashing Red:**



Low battery:  
The PAE-380 handset needs charging.

### Green

#### **Solid Green:**



The PAE-380 handset is paired with  
Base Unit in TV Mode or Wi-Mic in  
Wi-Mic Mode.

#### **Flashing Green:**



The PAE-380 handset is not paired  
with Base Unit in TV or Wi-Mic  
mode.

## Bluetooth Indicator Status

### **Red flashing:**



Not paired with any device.

### **Red/Blue alternative flashing:**



In pairing process.

### **Blue flashing:**



Paired with a device successfully.

## Base Unit

### Identifying parts

17. Power indicator
  - **Solid Red:** Base Unit is **ON**
  - **Off:** Base Unit is **OFF**
18. Power button
19. Charging port for the Personal Audio Enhancer
20. Analog (RCA) audio-in port
21. Audio input mode switch
  - Optical audio input
  - Coaxial audio input
22. Optical audio-in port
23. Coaxial audio-in port
24. A/C adaptor port

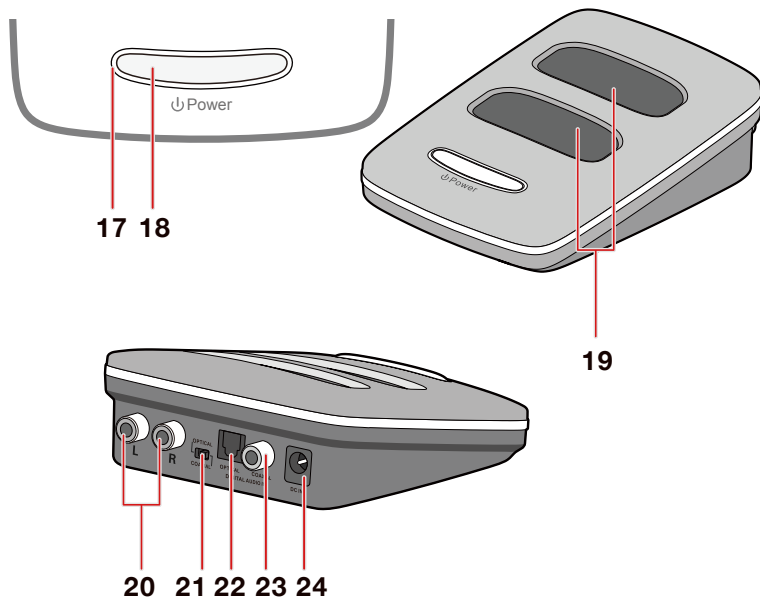

## Base Unit

### Power On

Press and hold the power button until the **RED** power indicator is on;

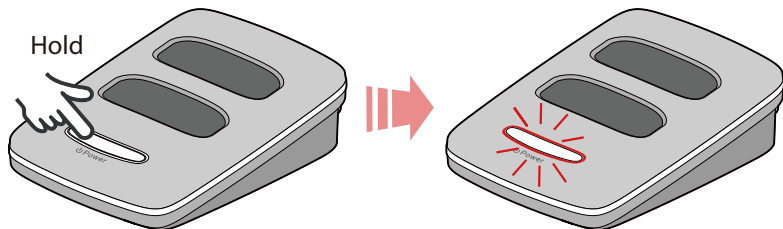

### Power Off

Press and hold the power button until the **RED** power indicator is off;

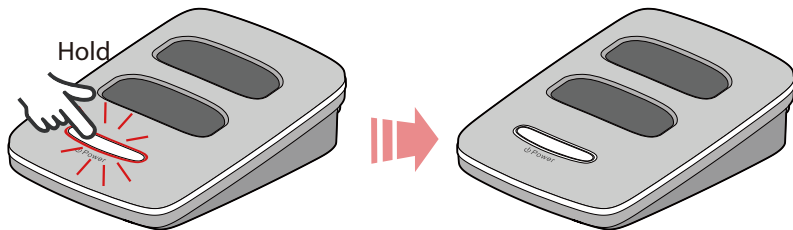

### Installation of Base Unit to television

*Please select one of the audio cables below to connect the Base Unit and your TV.*

#### Analog (RCA) audio cable

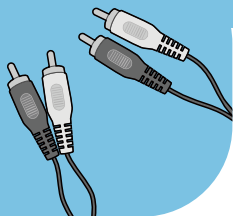

- 1 Connect the Base Unit with one end of the analog (RCA) audio cable;  
(Red connector to Red port; White connector to White port)
- 2 Connect the other end of the analog (RCA) audio cable with the analog (RCA) audio-out port of the TV.  
(Red connector to Red port; White connector to White port)

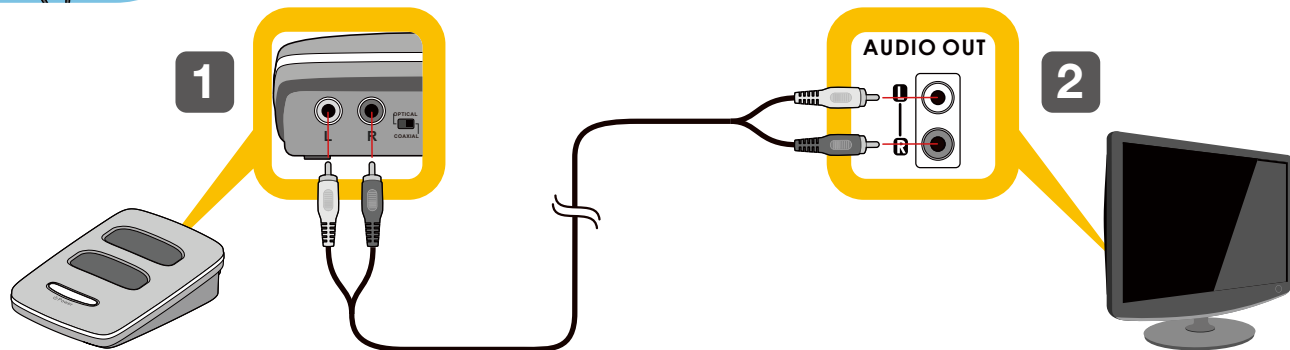

## Optical audio cable

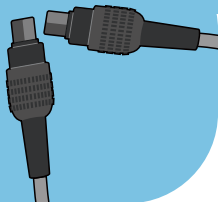

- 1 Switch "Audio input mode switch" into "Optical audio input";
- 2 Connect one end of the optical audio cable with the optical audio-in port of the Base Unit;
- 3 Connect the other end of the optical audio cable with the optical audio-out port of the TV.

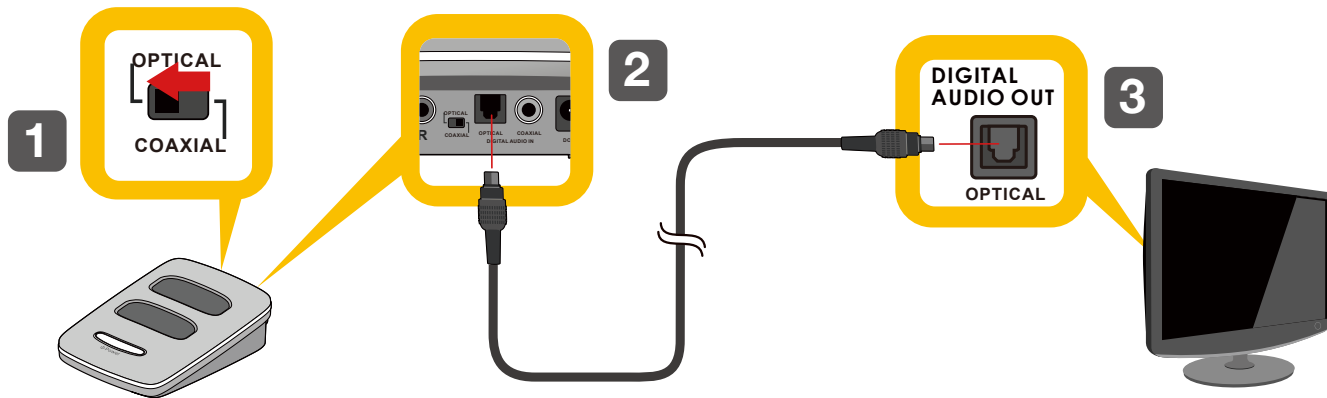

### Coaxial audio cable

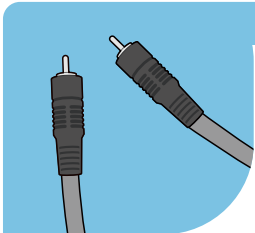
- 
- 1 Switch "Audio input mode switch" into "Coaxial audio input";
  - 2 Connect one end of the coaxial audio cable with the coaxial audio-in port of the Base Unit;
  - 3 Connect the other end of the coaxial audio cable with the coaxial audio-out port of the TV.

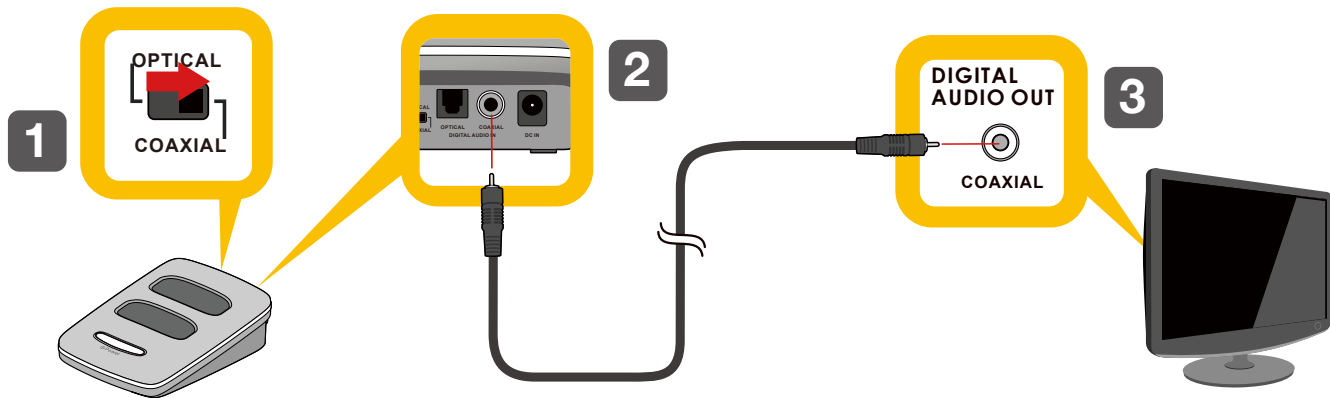

## Connect the AC power adaptor

- 1 Plug the A/C power adaptor into wall socket;
- 2 Connect the A/C power adaptor with the Base Unit.

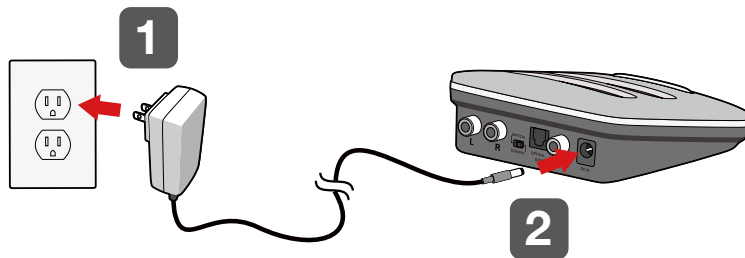

### Note

1. The Base Unit should be placed firmly.
2. The Base Unit will take the signal from optical or coaxial audio cable as higher priority when both of the analog (RCA) cable and the optical or coaxial audio cable connect to the Base Unit. To use analog audio cable as audio source, please first disconnect the optical and coaxial audio cables.
3. The types and positions of the audio output port equipped on the television are dependent on the brand and model of the television. Please read the television manual provided or contact the television supplier for details.
4. The optical and coaxial audio input ONLY support 44.1 kHz and 48 kHz PCM audio coding.
5. The Base Unit does NOT support Dolby Digital 2.1/5.1/7.1 audio coding.

### Charging PAE-380 handset either by the Base Unit or USB charger

#### By Base Unit

- 1 Plug the AC adaptor into wall socket;
- 2 Connect the Base Unit with the AC adaptor;
- 3 Insert the PAE-380 handset into the charging port of the Base Unit;
- 4 Remove the PAE-380 handset from the Base Unit when the power indicator is off for complete charging.

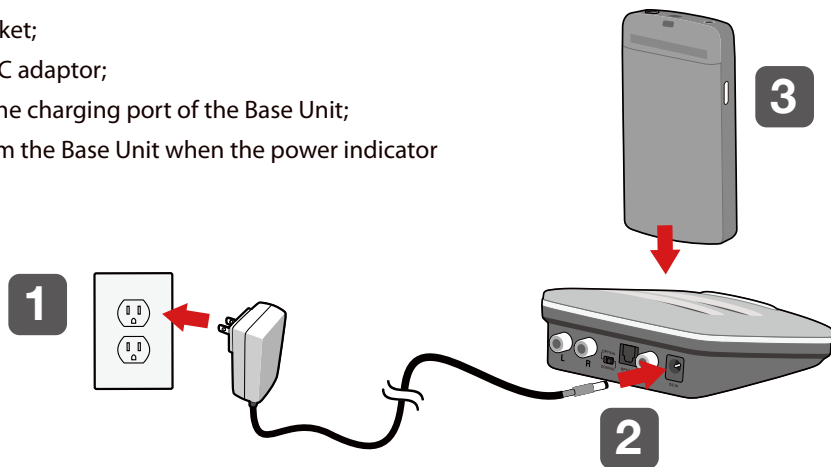

#### Note

The Base Unit can still charge the Personal Audio Enhancer when the Base Unit is off.

### *By micro-USB charger*

- 1 Plug the micro-USB charger into wall socket;
- 2 Connect the PAE-380 handset with the micro-USB charger for charging;
- 3 Disconnect the PAE-380 handset from the micro-USB charger after the charging is completed;
- 4 Unplug the micro-USB charger from the wall socket.

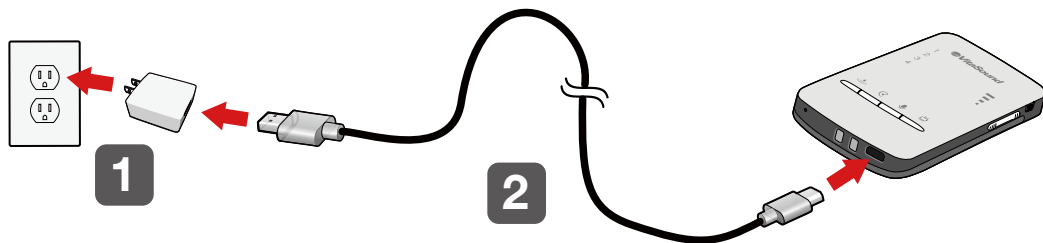

The PAE-380 handset can be only charged through the micro-USB charger of VitaSound.

### Power Indicator Status for Charging

**Solid Red:**

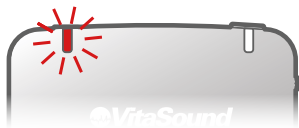

Charging.

**Off:**



Charging is completed.

**Complete charging time** (by Base Unit/micro-USB charger):

approximately 5 Hours



**Note**

The above time required to fully charge is based on charging the battery at a temperature of 25 °C (77 °F). The actual charging time may be different depending on the remaining battery level, environment, and temperature.

## Battery Life



Talk Mode, and Relax mode : 12 to 14 hours



TV Mode, Wi-Mic Mode and Bluetooth connection: 6 to 8 hours



### Note

The battery life depends on the conditions of use and circumstances after the battery is fully charged.

### Bluetooth pairing with cell phone

- 1 Make sure that the Bluetooth on your cell phone is turned on.

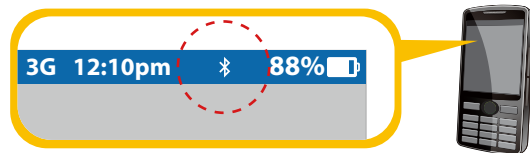

- 2 Press and hold the Bluetooth button on the PAE-380 handset (approximate for 4 seconds) until the Bluetooth indicator is **Red/Blue** alternative flashing.

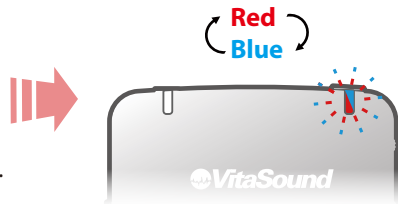

3

From the cell phone setting menu, seek a Bluetooth device in pairing mode. Once **"PAE-380 Bluetooth"** name is displayed, select it.

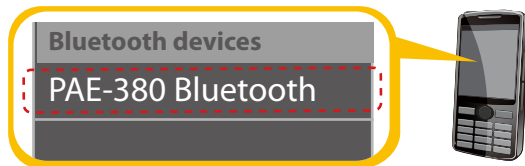

4

If password is required by the cell phone, enter "0000" for the password.



5

Once the pairing succeeds, the Bluetooth LED will flash in **Blue**.



### Re-pairing a paired PAE-380 handset with another device

When PAE-380 handset is paired with Bluetooth phone and it needs to be paired with another Bluetooth phone, please proceed the following:

1

The paired device must be turned off or the Bluetooth of the paired device must be deactivated;

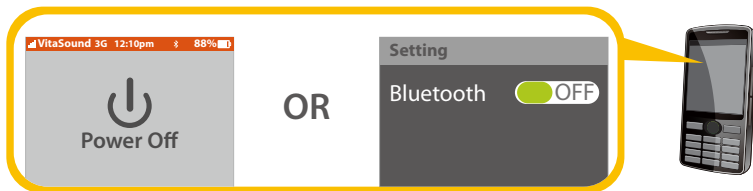

2

Reboot the PAE-380 handset by turning it off and then on again;

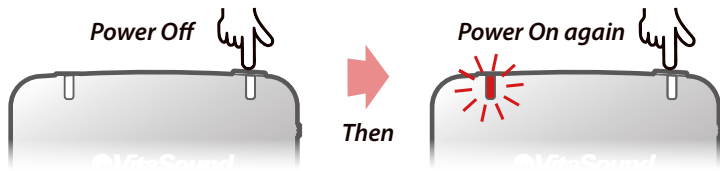

3

Proceed the procedures "Bluetooth pairing with cell phone" above.

## General Operation

### Lock mode



All buttons (except the Power Button) will be locked after sliding the lock switch downward in order to prevent any change of the setting by mistake.



Switch upward to cancel the lock mode.



#### Note

Before operating the PAE-380 handset, please sliding the lock switch upward; otherwise, no effect will be taken while pressing any buttons.

### Energy Save Mode for the indicators

When no operation is done to the PAE-380 handset for 40 seconds, it will automatically turn into energy saving mode that all indicators will be off.

### **Wake up the indicators**

To wake up the function and EQ mode indicators to show the current status of the PAE-380 handset, press any buttons during the energy save mode (*except power button and bluetooth pair button*).

This operation does not do any change on the status of the PAE-380 handset.

### **Taking effect by operation**

All operations (Ex: switching function or EQ mode, adjusting volume) will ONLY take effect after the indicators are lit.

## Using the PAE-380 handset to make or receive a call

### To make a call

Dial a phone number on your phone. You will hear ringing tone on the headset when your cell phone is calling.



### To receive a call

Press and release the mute button on the mic of the headset, or press the relevant button on your cell phone directly.

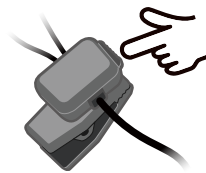

OR



### To hang up the call

Press and release the mute button on the mic of the headset to finish the call, or press the relevant button on your cell phone directly.

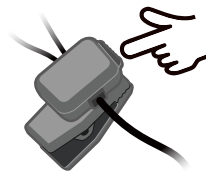

OR



## Select function mode



### TV Mode

Audio source of TV is transmitted to PAE-380 handset through the Base Unit for watching the TV program and movie, and playing TV game.

- Connect the Base Unit with the television  
(Refer to "Installation of the Unit Base to television")
- Plug the headset into the Personal Audio Enhancer, and then put on the headset into the ears for listening to the TV program.

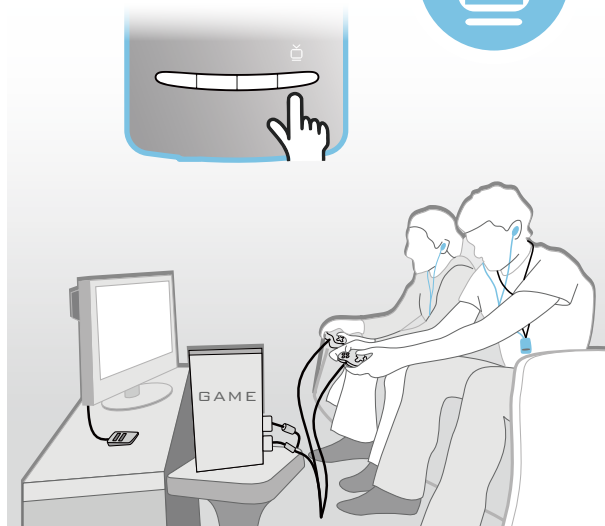

**Tip**

First time user is recommended to use TV mode first for watching TV for 1 to 2 hours in order to get familiar with the operation and function of PAE-380 handset.

### *Auto-connection between PAE-380 and Base Unit*

When the body color of the PAE-380 handset and the "Vitasound" trademark color on the Base Unit are the same, the PAE-380 handset and Base Unit will be automatically connected within a range of 10 meters. No pairing progress is required.

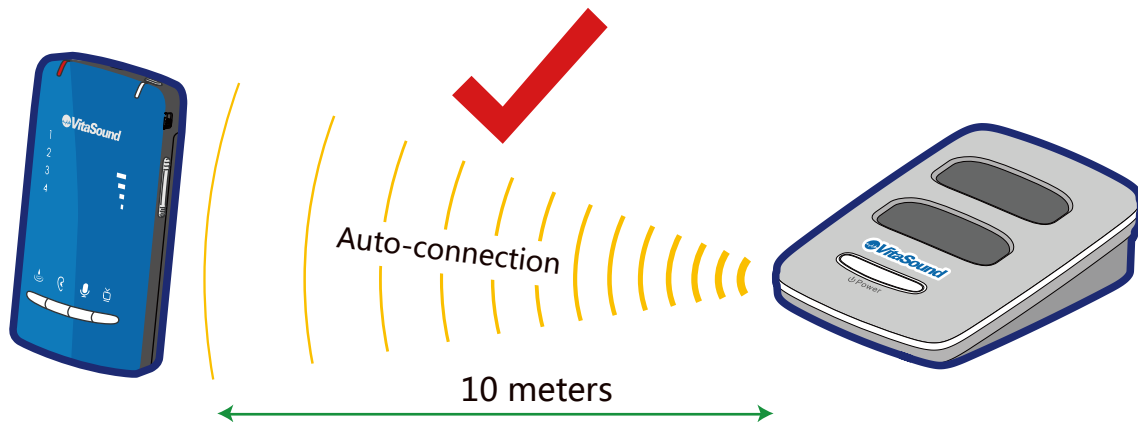

## Using PAE-380 handset

When the body color of the PAE-380 handset and the "VitaSound" trademark color on the Base Unit are different. The PAE-380 handset and Base Unit will not be connected. Please be aware of the body color of the PAE-380 handset and the "VitaSound" trademark color before use.

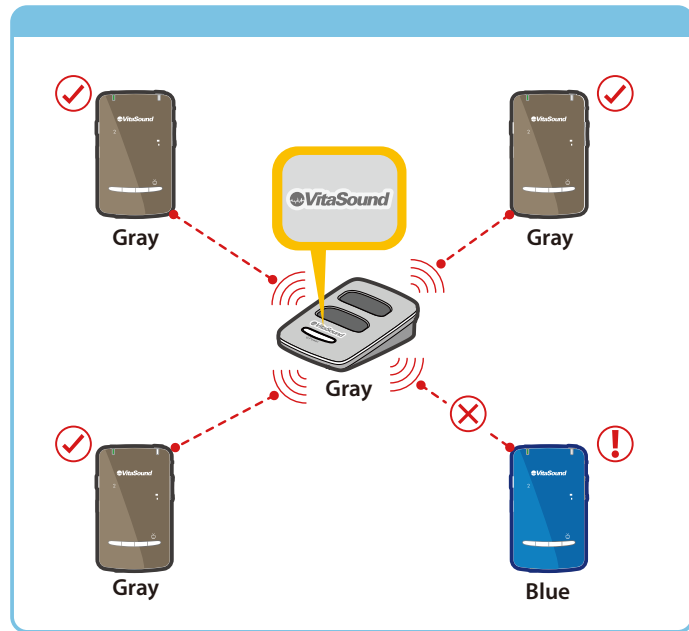
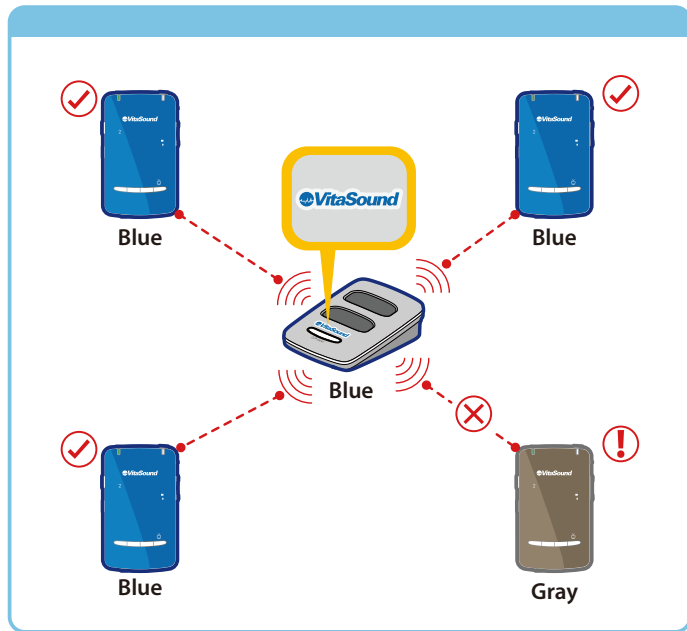



## Wi-Mic Mode

The voice of the speaker like teacher at school or the preacher at church can go through the Wi-Mic and is transmitted to the PAE-380 handset for the PAE-380 users to hear better in the class or speech.

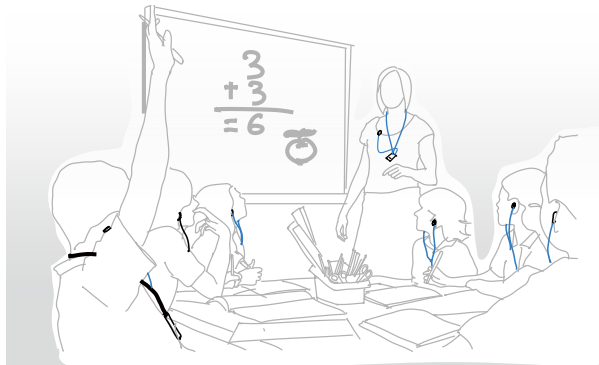

## Using PAE-380 handset

When Base Unit and Wi-Mic are present within 3 meters, please power off either one of them according the usage situation to prevent signal interference.

*Example: Power off the Wi-Mic when the PAE-380 handset is in TV mode; Power off the Base Unit when the PAE-380 handset is in Wi-Mic mode.*

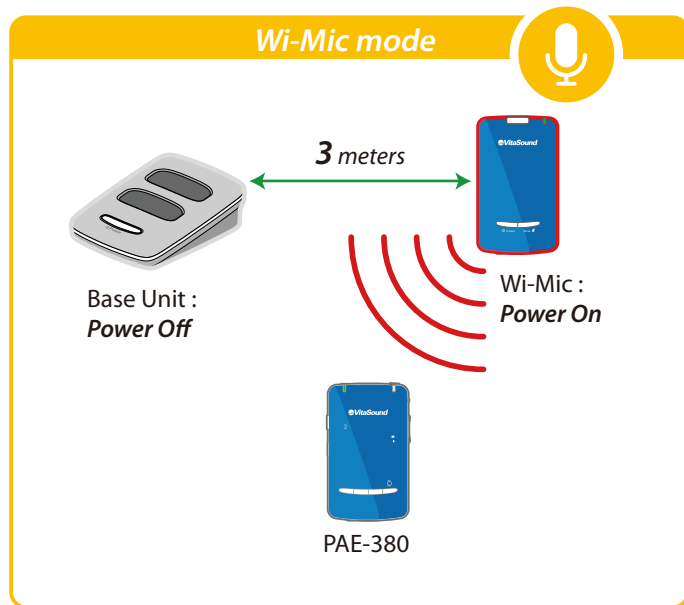
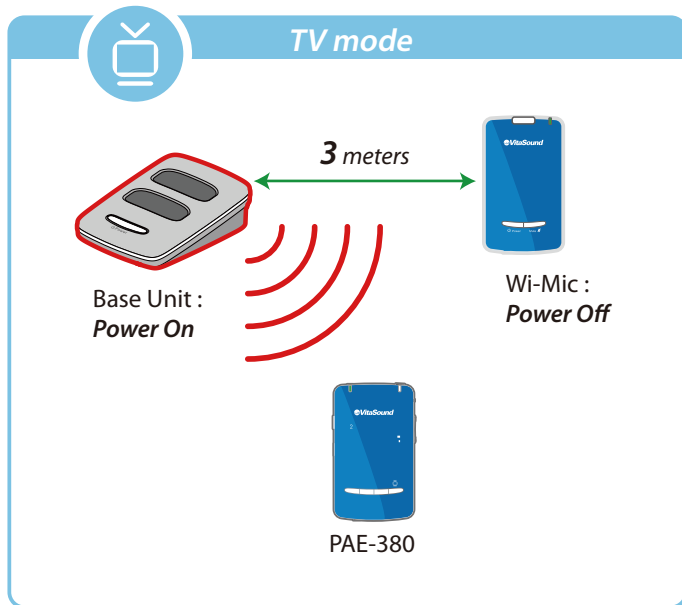

## Talk mode

The Personal Audio Enhancer optimizes the voice of the people received by the mic on the headset for better communication.

- Plug the headset into the headset port of the PAE-380 handset first; Then, put the headset onto ears to chat with people around;
- In the Talk Mode, the headset will be in Mute Mode by pressing and holding the mute button. The Mute Mode will be cancelled when releasing the mute button.

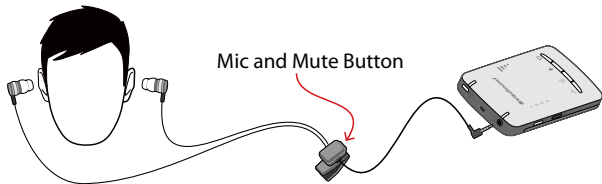

**Note**

High pitch whistler that can affect hearing may be generated through the headset while the speaker and the microphone are too closed. Please decrease the volume of the device before putting on the headset to reduce or prevent the whistle.



## Relax mode

a relaxing sound is played through the headset.

### Select sound effect:

- Sound effect Cycle Selection: Press the EQ mode button to switch the sound mode once: from Sound 1 to Sound 2; from Sound 2 to Sound 3; from Sound 3 to Sound 4; from Sound 4 to Sound 1, and so on.
- The corresponding indicator will be lit after sound effect is selected.

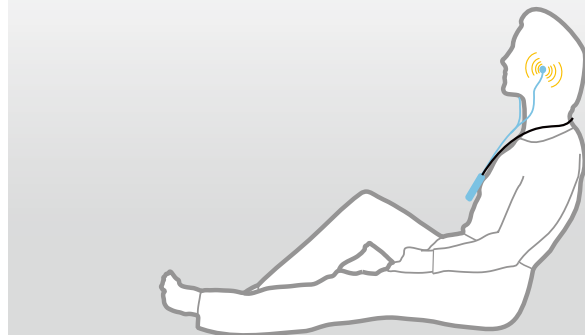
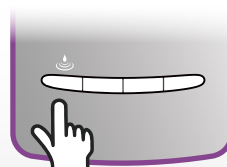
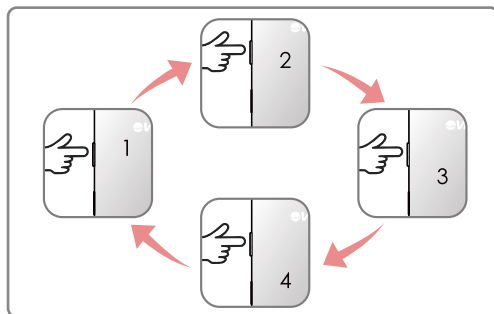

## Select EQ mode

The Personal Audio Enhancer is equipped with four different EQ modes, each of which provide a different quality of sound in each function mode:

- EQ mode 1: Normal
- EQ mode 2: Low frequency boost
- EQ mode 3: Medium frequency boost
- EQ mode 4: High frequency boost

**Select one of the sound modes according to the personal preferences of the user.**

EQ Mode Cycle Selection: Press the EQ mode button to switch the EQ mode once: from Mode 1 to Mode 2; from Mode 2 to Mode 3; from Mode 3 to Mode 4; from Mode 4 to Mode 1, and so on.

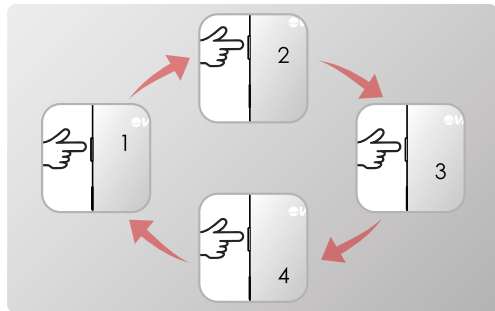

The corresponding indicator will be lit after sound mode is selected.



**Tip**

- The EQ Mode can be switched anytime desired depending on the different environment.
- First time user is recommended to try each EQ mode for 1 minute to find the most suitable EQ mode.

## Adjust Volume

### Total 8 volume levels

Volume level indicators will be lit to present the volume level while adjusting the volume.

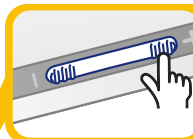

Press and release **+** button for increasing the volume level

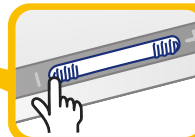

Press and release **-** button for lowering the volume level

## Low Battery

- The Power Indicator will flash when battery level is low. Please turn off and charge the PAE-380 handset immediately.
- A double Beep sound will be generated through the headset while battery level is low.

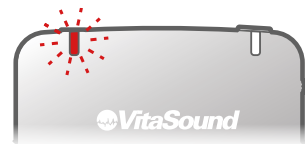

## Reset the Personal Audio Enhancer

When the Personal Audio Enhancer cannot be operated in any situation, press the reset button by a small pin object to reset the PAE-380 handset.

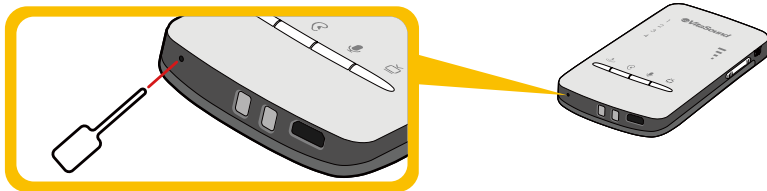

### Introduction

Wi-Mic is the PAE-380 handset's assistant device equipped with an internal microphone to receive voice from speaker such as teacher at class or preacher at church, and then wireless broadcast to all audiences using PAE-380 handset, allowing the audiences to benefit from improved sound quality where background noise or low volume levels make listening and communication difficult.



## How the PAE-380 works with Wi-Mic

Speaker can speak to the internal mic on the Wi-Mic. The voice of the spokesman will go through the Wi-Mic, and then is transmitted to all PAE-380 handsets which are paired with the Wi-Mic. The PAE-380 users are able to listen to the spokesman's voice clearly through the PAE-380 handset.

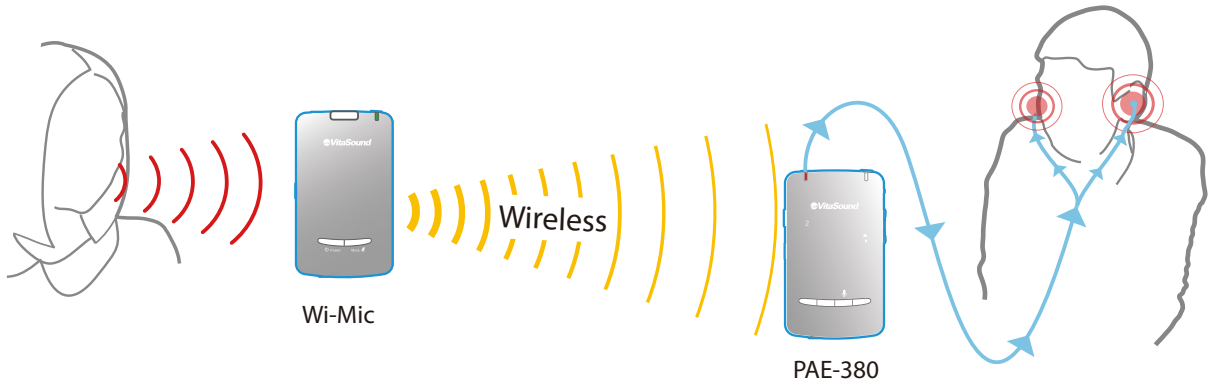

## Identifying parts

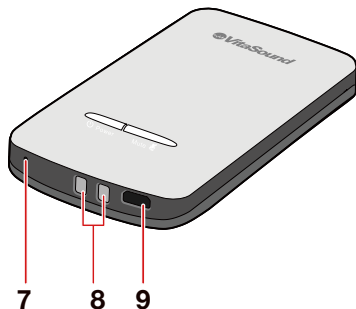
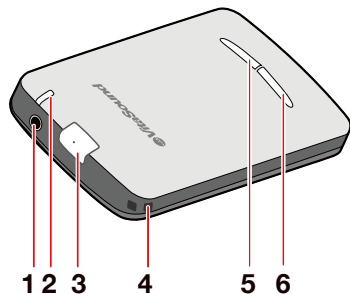

## Wi-Mic

1. External microphone port
2. Power indicator
3. Internal microphone
4. Hook for neck loop
5. Mute button
6. Power button
7. Reset button
8. Charging port for Base Unit
9. Micro-USB charging port

## Charging the Wi-Mic

Turn off the Wi-Mic;



Plug the micro-USB charger into micro-USB charging port of the Wi-Mic. RED power indicator lights up during charging.

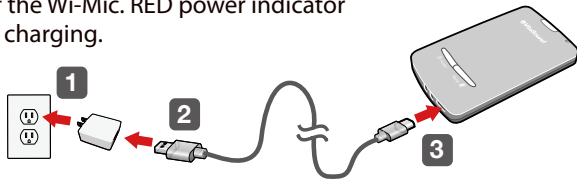

**Optional:**

The Wi-Mic can be charged when placed it into the charging port of the Base Unit.

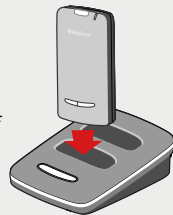

The power indicator is off when charging is completed.



Charging



Charging completed

## Auto-connection with PAE-380 handset

The Wi-Mic and PAE-380 handset with the same body color will be connected automatically within a range of 10 meters. No pairing process is required before use.



### Note

1. The auto-connecting feature of the Wi-Mic is not available for the Personal Audio Enhancer Model PAE-300.
2. The PAE-380 handset and Wi-Mic in DIFFERENT body color cannot be connected. Please be aware of the color of the PAE-380 handset and Wi-Mic for use.
3. In the environment that both of the Base Unit and Wi-Mic are present (*approximately within 3 meters*), please turn off either one of them according to the current usage situation of the PAE-380 handset to prevent signal interference.  
(Example: To use TV mode, please turn off the Wi-Mic; To use Wi-Mic Mode, please turn off the Base Unit.)

## Using Wi-Mic

### Power On

Press and hold the power button for approximate 2 seconds until **GREEN** power indicator lights up.

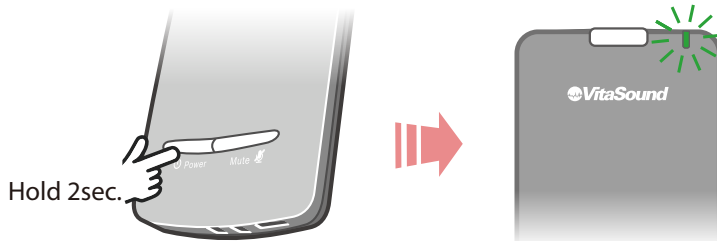

### Power off

Press and hold the power button for approximate 2 seconds until power indicator is off.

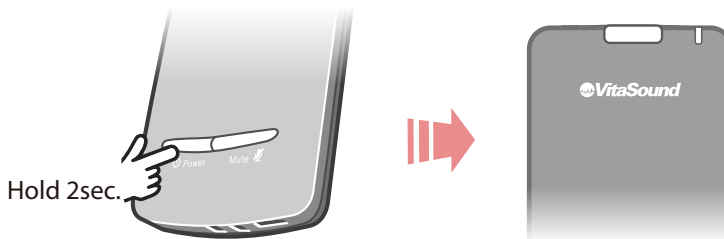

## Using internal microphone on Wi-Mic

The internal microphone is activated when the Wi-Mic is powered on. Wi-Mic collects the voice of the speaker by its internal microphone and broadcasts to all PAE-380 handset users.

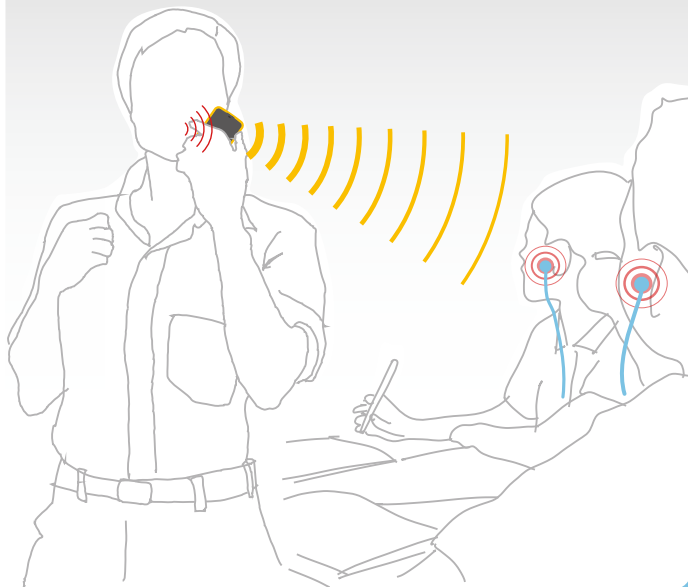
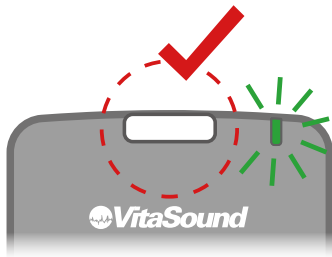

## Using external microphone

An external microphone can be used after plugged onto the Wi-Mic. The speaker is free from holding the Wi-Mic to speak with the external microphone.

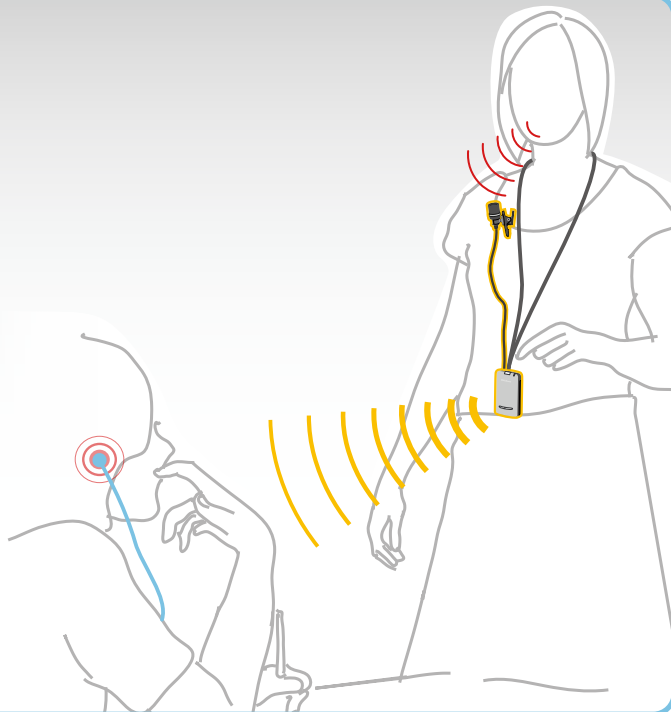
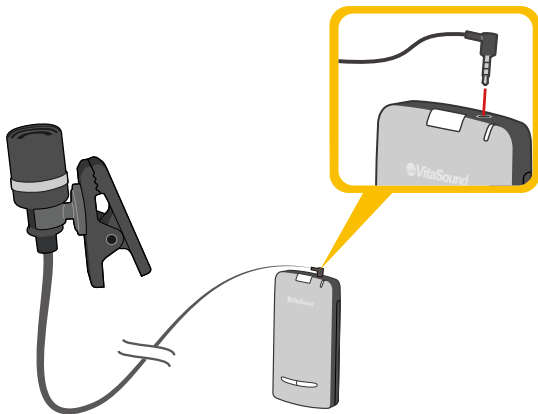

## Mute On



To mute the internal/external microphone, press the mute button once.



The **GREEN** power indicator is flashing when Wi-Mic is in mute mode.

## Mute Off



To cancel the mute status of Wi-Mic, press mute button once.



The **GREEN** power indicator lights up and stops flashing.

## Low battery

The power indicator will flash when battery level is low.  
Please turn off and charge the Wi-Mic immediately.

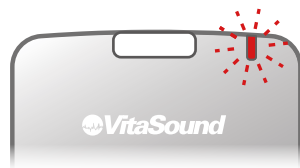

## Reset Wi-Mic

When the Wi-Mic cannot be operated in any situation, press the reset button by a small pin object to reset the Wi-Mic.

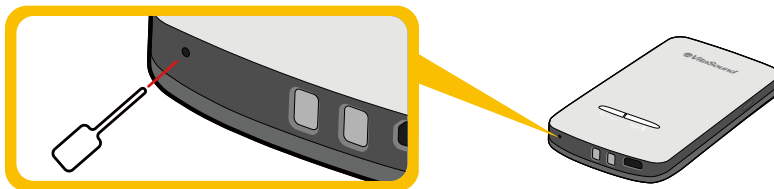



<i>Symptom</i>	<i>Possible Cause</i>	<i>Possible Corrective Action</i>	<i>Page</i>
The PAE-380 handset is not working.	The PAE-380 handset is off.	Turn on the PAE-380 handset.	3
	The PAE-380 handset is out of battery.	Charge the PAE-380 handset immediately.	12-15
	The PAE-380 handset is in "Lock Mode".	Switch the lock switch upward to unlock the PAE-380 handset.	19
	The PAE-380 handset is hang off.	Press the Reset Button with a small pin object to reset the PAE-380 handset.	31
	Operation is performed while the PAE-380 handset is in the energy save mode.	Press any button of the PAE-380 handset once to wake up the indicators, then perform the operation before the indicators are turned off.	20
All indicators of the PAE-380 handset turn off itself, except the power and Bluetooth indicator.	This behavior is normal. The indicators will be off automatically for energy saving when no operation is performed for 40 seconds.	N/A	N/A
A double beep alert is emitted through headset.	The battery is running low.	Turn off the PAE-380 handset and charge it.	12-15
Red LED (Power indicator) of the PAE-380 handset is flashing.			
Green LED (Power indicator) of the PAE-380 handset is flashing.	In TV mode, the Base Unit is off.	Power on the Base Unit by pressing the power button on the Base Unit once.	7
	In TV mode, the PAE-380 handset is out of the 10 meters range from the Base Unit.	Make sure the PAE-380 handset is within 10 meters range from the Base Unit.	37
	In TV mode, No signal from the Base Unit is received by the PAE-380 handset when the PAE-380 handset is within 10 meters range from the Base Unit.	Please contact VitaSound for support.	
	In Wi-Mic mode, the Wi-Mic is off.	Power on the Wi-Mic by pressing the power button on the Wi-Mic once.	
	In Wi-Mic mode, the PAE-380 handset is out of 10 meters range from the Wi-Mic.	Make sure the PAE-380 handset is within the 10 meters range from the Wi-Mic.	
	In Wi-Mic mode, No signal from the Wi-Mic is received by the PAE-380 handset when the PAE-380 handset is within 10 meters range of the Wi-Mic.	Please contact VitaSound for support.	

# Frequently Asked Questions

<i>Symptom</i>	<i>Possible Cause</i>	<i>Possible Corrective Action</i>	<i>Page</i>
Acoustic feedback is produced.	The volume level of the PAE-380 handset is too high.	1) Pull the speaker away from the mic on the the headset.	27
		2) Decrease the volume level of the PAE-380 handset.	30
No sound is produced. (Green power indicator is solid on; wireless connection is normal.)	The mute mode of the PAE-380 handset is on.	Release the Mute button on the mic.	27
	The headset is not plugged into the PAE-380 handset properly.	Make sure the plug of the headset is securely connected with the PAE-380 handset.	27
	The volume level of the PAE-380 handset is too low.	Increase the volume level of the PAE-380 handset.	30
		Make sure the television is turned on. (Please read the manual of your television for detail.)	
		Make sure the volume of the television is on. (Please read the manual of your television for detail.)	
		Make sure the mute mode of the television is off. (Please read the manual of your television for detail.)	
		When using the analog (RCA) audio cable to connect the Base Unit and television, make sure both of the optical and coaxial cables are disconnected with the Base Unit and television.	8
		When using the analog (RCA) audio cable, make sure the cable is plugged into the "Audio Out" port of the television. (Please read the manual of your television for detail.)	8
		When using the optical audio cable to connect the Base Unit and television, make sure: 1) the optical cable is connected with the Base Unit and television properly; and 2) the "Audio input mode switch" is switched into "optical audio input".	9
	In TV mode, no audio signal from the Base Unit is received by the PAE-380 handset. (Green LED on the PAE-380 handset is solid lit.)		

Symptom	Possible Cause	Possible Corrective Action	Page
No sound is produced. (Green power indicator is solid on; wireless connection is normal.)	In TV mode, no audio signal from the Base Unit is received by the PAE-380 handset.	When using the coaxial audio cable to connect the Base Unit and television, make sure: 1) the coaxial cable is connected with the Base Unit and television properly; and 2) the "Audio input mode switch" is switched into "coaxial audio input".	10
	In Phone mode, no audio signal is received from the phone.	Make sure your phone is on and its Bluetooth is activated. (Please read the manual of your phone for detail.)	16-17
		Make sure the Bluetooth connection between the PAE-380 handset and your phone works fine.	16-17
	In Phone mode, the volume level of the phone is too low.	Increase the volume level of the phone or the PAE-380 handset.	30
	In Wi-Mic mode, the Wi-Mic is in its mute mode.	Press the mute button on Wi-Mic once to cancel the mute mode on the Wi-Mic.	40
Auto-connection between PAE-380 handset and Base Unit/Wi-Mic is not working in TV Mode/Wi-Mic Mode.	The PAE-380 handset handset and Base Unit/Wi-Mic are out of a range of 10 meters.	Make sure PAE-380 handset is within a range of 10 meters from the Base Unit/Wi-Mic.	36
	The auto-connection does NOT occur on the PAE-380 handset handset and Base Unit/Wi-Mic with DIFFERENT color.	Make sure the case color of the PAE-380 handset and Base Unit/Wi-Mic are the SAME before use.	36
Singal interference occurs in TV mode or Wi-Mic Mode	In a range of 3 meters, either: 1) more than one Base Units are present; 2) more than one Wi-Mic are present; or, 3) Base Unit and Wi-Mic are present.	For more than one Base Unit/Wi-Mic are present in a range of 3 meters: 1) turn off the Base Unit/Wi-Mic which is not in use; or, 2) Keep the distance between each Base Unit /Wi-Mic more than 3 meters.	26
		For Base Unit and Wi-Mic are present in a range of 3 meters: 1) turn off the Base Unit when PAE-380 handset is in Wi-Mic Mode; 2) turn off Wi-Mic when PAE-380 handset is in TV Mode; or, 3) Keep the distance between the Base Unit and Wi-Mic more than 3 meters..	26

# Technical specification

## PAE-380

Dimension:	100.20 mm x 60 mm x 19.10 mm
Weight:	91 gram
Batteries:	Built in rechargeable lithium-ion, 2000 mAh
Operating time:	12 - 14 hours (fully charged) 6 - 8 hours (Wi-Mic / TV mode)
Charging time:	4 - 5 hours
Microphone:	Built in omnidirectional microphone on headset
Headset socket:	3.5 mm stereo jack plug
Output signal frequency range:	200 -16,000 Hz
EQ mode:	4 modes
Volume control:	8 steps (4 dB/step)
Output power:	60 mW (16 ohm load)
Function mode:	Separate function mode select buttons
Digital signal processing:	32 kHz sampling frequency 16 bit resolution in stereo
Radio communication frequency:	2.4 GHz, ISM band
Radio communication range:	10m indoor, clear line of sight
Radio communication characteristics:	Automatic channel searching Coexists with other radio transmitters operating on the 2.4GHz frequency band
Topology:	Point-to-point
Antenna Type:	Internal SMD antenna
Bluetooth:	Bluetooth 4.0 with superior audio performance using aptX Hi-Fi

## Wi-Mic

Dimension:	100.20 mm x 60 mm x 19.10 mm
Weight:	94.6 gram
Batteries:	Built in rechargeable lithium-ion, 2000 mAh
Operating time:	4 - 6 hours (fully charged)
Charging time:	4 - 5 hours
Internal Microphone:	Built in omnidirectional microphone
External Microphone socket:	3.5 mm stereo jack plug
Output signal frequency range:	200 -16,000 Hz
Output power:	60 mW (16 ohm load)
Digital signal processing:	32 kHz sampling frequency 16 bit resolution in stereo
Radio communication frequency:	2.4 GHz, ISM band
Radio communication range:	10m indoor, clear line of sight
Radio communication characteristics:	Automatic channel searching Coexists with other radio transmitters operating on the 2.4GHz frequency band
Topology:	Point-to-multi
Antenna Type:	Internal Antenna

## Base Unit

Dimension:	120.30mm x 94.10mm x 40.10mm
Weight:	111.8 gram
Power:	9V 2A (18W)
Audio source input:	Analog (RCA) Jack (Red / White) Optical jack 44.1kHz PCM / 48kHz PCM Coaxial jack 44.1kHz PCM / 48kHz PCM
Digital radio transmission:	2.4GHz ISM band Coexists with other radio transmitters using the 2.4GHz ISM band
Radio communication range:	10m indoor, clear line of sight
Radio communication characteristics:	Automatic channel searching Coexists with other radio transmitters operating on the 2.4GHz frequency band
Topology:	Point-to-Multipoints
Transmitter output:	8dBmW

## Environmental requirements

Operating temperature:	0 °C to 35 °C (32 °F to 95 °F)
Relative humidity:	5 % to 95 %

## Regulatory requirements

Complies with the following requirements:	CE, FCC, RoHS and C-Tick
---	--------------------------

## Certification and Compliance

### FCC Statement:

This device complies with Part 15 of the FCC Rules. Operation is subject to the following two conditions: (1) this device may not cause harmful interference, and (2) this device must accept any interference received, including interference that may cause undesired operation.

-----

Changes or modifications not expressly approved by the party responsible for compliance could void the user's authority to operate the equipment.

This equipment has been tested and found to comply with the limits for a Class B digital device, pursuant to Part 15 of the FCC Rules. These limits are designed to provide reasonable protection against harmful interference in a residential installation. This equipment generates, uses and can radiate radio frequency energy and, if not installed and used in accordance with the instructions, may cause harmful interference to radio communications. However, there is no guarantee that interference will not occur in a particular installation. If this equipment does cause harmful interference to radio or television reception, which can be determined by turning the equipment off and on, the user is encouraged to try to correct the interference by one or more of the following measures:

- Reorient or relocate the receiving antenna.
- Increase the separation between the equipment and receiver.
- Connect the equipment into an outlet on a circuit different from that to which the receiver is connected.
- Consult the dealer or an experienced radio/TV technician for help.

This device complies with Industry Canada licence-exempt RSS standard(s). Operation is subject to the following two conditions: (1) this device may not cause interference, and (2) this device must accept any interference, including interference that may cause undesired operation of the device.

Le présent appareil est conforme aux CNR d'Industrie Canada applicables aux appareils radio exempts de licence. L'exploitation est autorisée aux deux conditions suivantes :

(1) l'appareil ne doit pas produire de brouillage, et (2) l'utilisateur de l'appareil doit accepter tout brouillage radioélectrique subi, même si le brouillage est susceptible d'en compromettre le fonctionnement.





[www.vitasound.com](http://www.vitasound.com)

[info@vitasound.com](mailto:info@vitasound.com)

1-877-967-0742