

JUNO T41/5

User Manual

Welcome

Thank you for purchasing this JUNO T41/5! This manual will help you set up your device so you can begin using it.

Important information for using the guide

This guide has been prepared to guide you through the operation of your device from first set-up through to continuous use, which includes:

- Setting up the device
- Operating basics
- Navigating
- Securing your device

Please read this guide carefully before using your device for the first time.

Formatting

It is important to understand the terms and typographical conventions used in this guide. The following kinds of formatting in the text identify special information:

- **CAPITAL** — indicates the hardware items on the device. Example: press the **POWER** button.
- **Bold** — indicates the items displayed on the screen, including buttons, headings, field names and options. Example: tap the **E-mail** button.
- *Italics* — indicates the name of a screen/window. Example: the *Bluetooth* screen.

Terms

The following terms are used throughout this guide to describe user actions.

- **Press** — press and then release a hardware button quickly.
- **Tap** — touch and then release an item displayed on the screen quickly.
- **Select** — tap an item in a list or tap a command from a menu.
- **Drag** — tap and hold on the item and then move it to the target position without releasing your fingertip.
- **Slide** — drag to the left/right/top/down to switch to the next item on the list.

Important safety information

- **THE DEVICE IS NOT CHARGED WHEN YOU TAKE IT OUT OF THE BOX.**
- **DO NOT REMOVE THE BATTERY PACK WHEN THE DEVICE IS CHARGING.**
- **WHEN INSERTING YOUR SIM CARD, MAKE SURE THE DEVICE IS POWERED-OFF BEFORE YOU REMOVE THE BATTERY PACK.**
- **IN MANY COUNTRIES YOU ARE REQUIRED BY LAW TO TURN OFF YOUR PHONE WHEN YOU FLY. TURNING OFF YOUR POCKET PC DOESN'T TURN OFF YOUR PHONE; YOU MUST TURN OFF YOUR WIRELESS CONNECTION TO YOUR OPERATOR'S NETWORK.**
- **YOUR WARRANTY IS INVALIDATED IF YOU OPEN OR TAMPER WITH THE DEVICE'S OUTER CASING.**

Disclaimer

The manufacturer operates a policy of ongoing development. The manufacturer reserves the right to make changes and improvements to any of the products described in this document without prior notice. The manufacturer does not warrant that this document is error-free.

Not all models are available in all regions. Depending on the specific model purchased, the color and look of your device and accessories may not exactly match the graphics shown in this document.

The screenshots and other presentations shown in this guide may differ from the actual screens and presentations generated by the actual product.

All such differences are minor and the actual product will deliver the described functionality as presented in this User Manual in all material respects.

Copyright

All brand and product names are trademarks or registered trademarks of their respective companies.

Revision: 1.0

(06/2012)

Regulatory Compliance Statements

FCC Warning Statement

This equipment has been tested and found to comply with the limits for a Class B digital device, pursuant to part 15 of the FCC rules. These limits are designed to provide reasonable protection against harmful interference in a residential installation. This equipment generates, uses and can radiate radio frequency energy and, if not installed and used in accordance with the instructions, may cause harmful interference to radio communications. However, there is no guarantee that interference will not occur in a particular installation. If this equipment does cause harmful interference to radio or television reception, which can be determined by turning the equipment off and on, the user is encouraged to try to correct the interference by one or more of the following measures:

- Reorient or relocate the receiving antenna.
 - Increase the separation between the equipment and receiver.
 - Connect the equipment into an outlet on a circuit different from that to which the receiver is connected.
 - Consult the dealer or an experienced radio/TV technician for help.
1. This Transmitter must not be co-located or operating in conjunction with any other antenna or transmitter.
 2. This equipment complies with FCC RF radiation exposure limits set forth for an uncontrolled environment. To maintain compliance with FCC RF exposure compliance requirements, avoid direct contact to the transmitting antenna during transmitting.
 3. Any changes or modifications (including the antennas) made to this device that are not expressly approved by the manufacturer may void the user's authority to operate the equipment.

FCC Label Statement

This device complies with part 15 of the FCC rules. Operation is subject to the following two conditions:

1. This device may not cause harmful interference, and
2. This device must accept any interference received, including interference that may cause undesired operation.

Canada, Industrie Canada (IC)

This Class B digital apparatus complies with Canadian ICES-003

Cet appareil numérique de classe B est conforme à la norme NMB-003.

This device complies with Industry Canada licence-exempt RSS standard(s).

Operation is subject

to the following two conditions: (1) this device may not cause interference, and (2)

this device

must accept any interference, including interference that may cause undesired

operation of the

device.

Cet appareil est conforme avec Industrie Canada RSS standard exempts de licence (s). Son fonctionnement est soumis aux deux conditions suivantes:

(1) cet appareil ne peut pas provoquer d'interférences et

(2) cet appareil doit accepter toute interférence, y compris les interférences pouvant entraîner un mauvais fonctionnement de la appareil.

RF Radiation Exposure Statement:

For body worn operation, this phone has been tested and meets RF exposure guidelines when used with an accessory that contains no metal and that positions the handset a minimum of 1.5 cm from the body.

Use of other accessories may not ensure compliance with RF exposure guidelines.

Déclaration de l'exposition aux radiations RF:

Pour le fonctionnement du corps, ce téléphone a été testé et répond aux directives d'exposition RF lorsqu'il est utilisé avec un accessoire

qui ne contient pas de métal et qui place le combiné d'un minimum de 1.5 cm du corps.

Utilisation d'autres accessoires peut ne pas assurer le respect des directives d'exposition RF

RF Radiation Exposure Statement

For body worn operation, this phone has been tested and meets FCC RF exposure guidelines when used with an accessory that contains no metal and that positions the handset a minimum of 1.5 cm from the body. Use of other accessories may not ensure compliance with FCC RF exposure guidelines.

Canadian Compliance Statement

This Class B Digital apparatus meets all requirements of the Canadian Interference-Causing Equipment Regulations.

Cet appareil numérique de la classe B respecte les exigences du Règlement sur le matériel brouilleur du Canada.

European Conformity Statement

Declaration of Conformity with Regard to the R&TTE 1999/5/EC and EMC 89/336/ EEC directives.

RoHS Statement



This device conforms to RoHS (Reduction Of Hazardous Sub-stances) European Union regulations that set maximum con-centration limits on hazardous materials used in electrical and electronic equipment.

CAUTION
RISK OF EXPLOSION IF BATTERY IS REPLACED
BY AN INCORRECT TYPE.
DISPOSE OF USED BATTERIES ACCORDING
TO THE INSTRUCTIONS

To prevent possible hearing damage, do not listen at high volume levels for long periods.



Figure 1 – Warning label (IEC 60417-6044)

Contents

Welcome	2
Important information for using the guide	2
Formatting.....	2
Terms.....	3
Important safety information.....	3
Disclaimer	4
Copyright.....	4
Contents	8
Setting up the device	9
Step1. Insert the SIM card.....	9
Step2. Insert the memory card	10
Step3. Charge the battery	11
Step4. Switch on and enter your PIN.....	12
Step5. Install ActiveSync.....	12
Operating basics	13
Device components.....	13
Navigating	14
Home screen.....	14
Programs screen.....	15
Power menu.....	15
Securing your device	16
Lock the keypad	16
Lock your phone.....	16
Lock the SIM card	16
Specification	17
Regulatory Information	19
Exposure to Radio Frequency (RF) Signals	20
Declaration of Conformity	21
Safe Use of your Unit	23

Setting up the device

Follow the sections below to set up your device and get it ready to synchronize with your computer.

Step1. Insert the SIM card

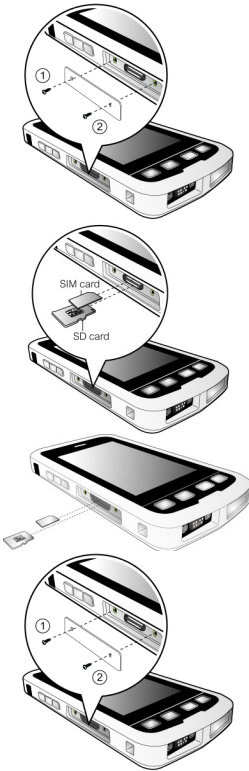

1. Remove the cover on the left panel of the device by unscrewing the screws.

2. Insert the SIM card into the slot with its golden contacts facing the front of your device.

3. To remove a card, gently push the top edge of the card inwards to release it, and pull it out of the slot.

4. Replace the cover and then secure it with the screws.

Step2. Insert the memory card

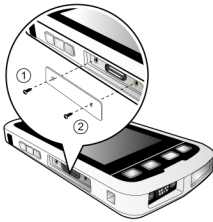

1. Remove the cover on the left panel of the device by unscrewing the screws.

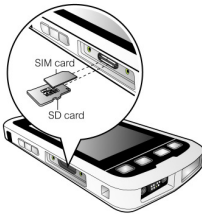

2. Hold the microSD card by the edges and gently insert it into the slot with the label facing the front of your device. Do not apply pressure to the centre of the memory card while inserting the card.

TIP: The device supports up to 32GB microSD memory cards.



3. To remove a card, gently push the top edge of the card inwards to release it, and pull it out of the slot.

NOTE: Make sure you have saved any data in open programs before removing the memory card.

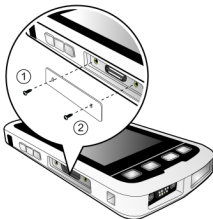

4. Replace the cover and then secure it with the screws.

Step3. Charge the battery

IMPORTANT: Fully charge the battery at least 4 hours after installing in the unit. The battery LED will turn green when fully charged.



1. Plug the converter to the AC charger.
TIP: The converter plug varies with the region of your purchase.
2. Locate the power connector on the bottom of the device. Connect the DC end of the AC charger to the connector on your device.
3. Plug the other end of the AC charger into a wall outlet.

CAUTION: Extreme Heat

- Extreme heat: The battery is designed to stop operating at or above the extreme heat of +149°F (+65°C). If this icon appears, the battery has overheated to +140°F (+60°C).
- If the battery temperature exceeds 158 °F (70°C) it will be disabled and will need to be replaced.

Step4. Switch on and enter your PIN

Once you have started to charge your device, you can switch it on.



1. Press the POWER button on the right panel of the device for about 5 seconds. The device is turned on.

2. The Welcome Wizard will lead you through the setup process.

3. Enter your PIN on the keypad screen. When done, tap **Enter**.

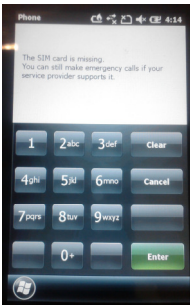

Step5. Install ActiveSync

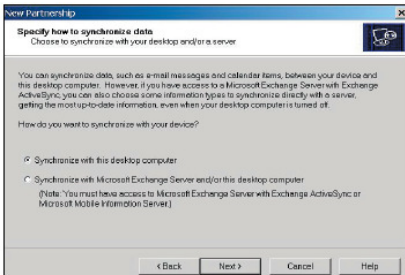

Using Microsoft® ActiveSync® you can synchronize information on your computer and/or a Microsoft® Exchange Server with the information on your device.

ActiveSync compares the information on your device with the information on your computer and/or the server and updates all locations, keeping you up-to-date with the most recent information.

Before you can begin synchronization with your computer, you must install ActiveSync on your computer. After the installation is completed, you can connect your device to the computer for synchronization.

Operating basics

Device components



- | | | | |
|----------|---------------------------------------|-----------|-------------------------|
| 1 | POWER button | 8 | UP button |
| 2 | Headphone connector | 9 | DOWN button |
| 3 | VOLUME control buttons | 10 | OK button |
| 4 | Memory card and SIM card slots | 11 | Microphone |
| 5 | Touch screen | 12 | Camera and Flash |
| 6 | Notification LED | 13 | Speaker |
| 7 | START button | 14 | Power connector |

Navigating

Home screen



The *Home* Screen is an easy way to launch your favorite programs. You can view high-level information at a glance, with notifications for Live services, e-mail and SMS/MMS.

To navigate the *Home* screen, slide your fingertip up/down on the screen; or simply drag the highlighted bar to the desired item on the screen. The programs provided on the *Home* screen include:

- **pictures:** You can select your photos from this menu.
- **music:** You can select your music from this menu.
- **getting started:** You can set up your device using the wizard.
- **phone:** You can use the device's phone function by selecting this item.
- **voicemail:** You can use the device's voicemail function by selecting this item.
- **time:** You can select your time zone, set the time and date to the correct values and set alarms.
- **Text:** If you have the phone feature set up on your unit, you can send and receive text messages from this menu.
- **e-mail:** Email can be set up and launched here.
- **calendar:** Appointments can be managed from here.
- **favorites:** Internet Explorer can be launched from here.

Programs screen

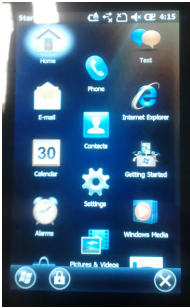

Press START button to access the *Programs* screen. The main features of the *Programs* screen listed below. Slide your fingertip up/down on the *Programs* screen to browse more items and then access an item by tapping on the item.

Power menu

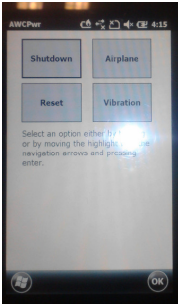

Press and hold the POWER button for about 3 seconds to display a countdown. Continuing to press the POWER button will cause a reset when the countdown reaches zero. If you release the POWER button while the countdown is proceeding, you access the following menu. Tap an option or **OK** to exit.

- **Shutdown:** Turn off the device.
- **Airplane:** Enable the Airplane mode for the device.
- **Reset:** Restart the device.
- **Vibration:** Enable the Vibration mode for the device.

NOTE: If the countdown or the Power menu does not appear when the power button is held down, continue to hold down the power button for at least 8 seconds to start the reset. It may take up to 10 seconds for the unit to start after the power button has been released.

Securing your device

You can customize the level of security you want to have on your Pocket PC phone by locking the keypad, the entire device, or the SIM card.

Lock the keypad

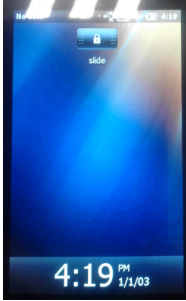

The keypad lock turns off the keypad functionality. This is a helpful feature if, for example, your device is turned off and in your pocket, and you want to prevent accidental keypresses from pressing a button.

Lock your phone

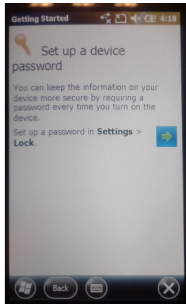

Locking your device prevents access to personal data. When you enable this feature, your device will automatically lock after a specified time of inactivity. A screen will be displayed requiring your device lock password before access is granted.

Lock the SIM card

You can protect your device from unauthorized use by assigning a type of password called a PIN (Personal Identification Number). Your first PIN will be given to you by your mobile phone service provider.

Specification

CPU	800-MHz Cortex A8 ARM processor for the low end 1-GHz Cortex A8 ARM processor for the high-end
RAM	256MB for the low end 512MB for the high end
Storage	8GB for the low end 16GB for the high end
OS	WM6.5 Std/Pro or Android 2.x (Stable higher version acceptable)
Display	4.3" WVGA with Multi-touch Capacitive touch screen
Keypad & Buttons	Limited Keypad, Function Keys only
Barcode Scanner	Barcode Scanning Thru. Camera Imaging Software, only for the high end 1D/2D Barcode Imager/Scanner, only for the high-end 02
RFID Reader	RFID Reader provided for the high-end 01 only
Camera	Color, 8 megapixel for the low-end 01, the high-end 01, the high-end 02, and the high-end 03
Autofocus & Flash	Designed for the low-end 01, the high-end 01, the high-end 02, and the high-end 03
LED Indicator	Single tri-color LED (Red/ Amber/Green)
Audio Port	Microphone, Speaker, Receiver, and 3.5mm Audio Jack
GPS	2~4M, Trimble provided for the low-end, the high-end 1 and 2 1M enhanced Trimble with AGPS for the high-end 3
Expansion Slot	Micro SD
SIM Card Slot	Designed for the high end only

Power Source	Input voltage range of 90VAC to 240VAC at 50-60Hz Non-removable battery, of which the life in each user case: Low User Case: 12 hours Normal Use Case: 9 hours High Use Case: 5 hours Cold Weather: 3 hours @ Freezing	
Environmental	Charging temperature	0 °C - 40 °C
	Storage temperature	-40 - +70C
Models	Basic prosumer: No WWAN, no RFID, no 1D/2D barcode imager/scanner Military unit: No radio's or camera, 2-4M GPS WWAN, faster CPU, 2-4M GPS, no RFID or 1D/2D barcode imager/scanner WWAN, 2-4M GPS and RFID WWAN, 2-4M GPS and 1D/2D barcode imager/scanner WWAN, 1M GPS	
Bluetooth	Bluetooth V2.1 or better for Low-End 01, High-End 01, High-End 02, and High-End 03	
Wi-Fi	802.11 b/g/n for Low-End 01, High-End 01, High-End 02, and High-End 03	
3G Radio	Data & Voice only for High-End 01, High-End 02, and High-End 03	
Standard Software	Office companion (WM only for Low-End; WM / Android for High-End) OS and Utilities Camera Software for Low-End 01, High-End 01, High-End 02, and High-End 03 GPS control Software Mobile Mapping/Navigation only for High-End 01, High-End 02, and High-End 03	

Regulatory Information

U.S.A.

This device complies with Part 15 of the FCC Rules. It is tested to comply with FCC standards for home or office use. Operation is subject to the following two conditions:

(1) this device may not cause harmful interference, and (2) this device must accept any interference received, including interference that may cause undesired operation.

This equipment has been tested and found to comply with the limits for a Class B digital device, pursuant to Part 15 of the FCC Rules. These limits are designed to provide reasonable protection against harmful interference in a residential installation. This equipment generates, uses and can radiate radio frequency energy and, if not installed and used in accordance with the instructions, may cause harmful interference to radio communications. However, there is no guarantee that interference will not occur in a particular installation. If this equipment does cause harmful interference to radio or television reception, which can be determined by turning the equipment off and on, the user is encouraged to try to correct the interference by one or more of the following measures:

- Reorient or relocate the receiving antenna.
- Increase the separation between the equipment and receiver.
- Connect the equipment to an outlet on a circuit different from that to which the receiver is connected.
- Consult the dealer or an experienced radio/TV technician for help.

Canada

This digital apparatus does not exceed the Class B limits for radio noise emissions from digital apparatus as set out in the radio interference regulations of the Canadian Department of Communications. Le présent appareil numérique n'émet pas de bruits radioélectriques dépassant les limites applicables aux appareils numériques de Classe B prescrites dans le règlement sur le brouillage radioélectrique édicté par le Ministère des Communications du Canada.

Exposure to Radio Frequency (RF) Signals

Your device contains a radio transmitter and receiver. The radiated output power is far below the international radio frequency exposure limits. These limits are part of comprehensive guidelines and establish permitted levels of RF energy for the general population. The guidelines are based on the safety standards previously set by international standards bodies:

- American National Standards Institute (ANSI) IEEE. C95.1-1992.
- National Council on Radiation Protection and Measurement (NCRP). Report 86. 1986.
- Int'l Commission on Non-Ionizing Radiation Protection (ICNIRP) 1996.
- Ministry of Health (Canada), Safety Code 6. The standards include a substantial safety margin designed to assure the safety of all persons, regardless of age and health.

Use of unauthorized or modified antennas may impair call quality and damage the phone, causing loss of performance. To assure optimal phone performance and ensure human exposure to RF energy is within the guidelines set forth in the relevant standards; always use your device only in its normal-use position.

Avoiding contact with the antenna area when the phone is IN USE optimizes the antenna performance.

This device has been designed to operate with the antennas listed below, and having a maximum gain of 3 dB. Antennas not included in this list or having a gain greater than 3 dB are strictly prohibited for use with this device. The required antenna impedance is 50 ohms.

Trimble Antenna # 81288-01A

To reduce potential radio interference to other users, the antenna type and its gain should be so chosen that the equivalent isotropically radiated power (e.i.r.p.) is not more than that permitted for successful communication.

Carrying the unit

Due to radio frequency emissions, it is unsafe to operate the radio with the unit in a holster, dangling from a lanyard, or with any method that keeps the powered unit in very close proximity to the head or torso. For safe operation, carry the unit in your hand with the antennas located at least 20 cm (~8 inches) from the head or torso. See the following illustration for the correct and incorrect way to operate the unit.

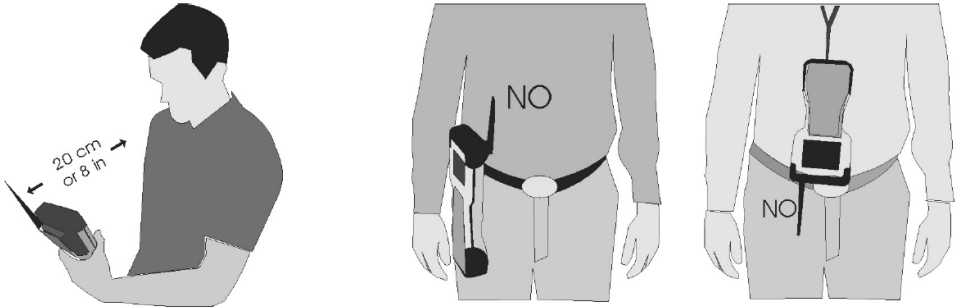

Declaration of Conformity

Europe

According to ISO / IEC Guide 22 and EN 450 14

Manufacturer's Name: Trimble Navigation Limited.

Manufacturer's Address: PO Box 947, Corvallis, OR 97339 USA

Declares, under our sole responsibility, that the product:

Product Name: JUNO T41/5

Model Number: JUNO/T41/5-BW; JUNO/T41/5; JUNO/T41/5-BW

Regulatory Name: JUNO/T41/5-BW; JUNO/T41/5; JUNO/T41/5-BW

Product Options: ALL

Conforms to the following Product Specifications:

EN 300 328: V1.7.1:2006	EN 61000-3-2:2006
EN 301 489-1: V1.8.1:2008	EN 61000-3-3:2008
EN 301 489-17: V2.1.1:2009	EN 61000-4-2:2001
EN 301 511:V9.0.2:2003	EN 61000-4-3:2006
EN 301 489-07 V1.3.1:2005	EN 61000-4-4:2004
EN 301 489-24 V1.4.1:2007	EN 61000-4-5:2006
EN 301 908-1&2:V4.2.1:2010	EN 61000-4-6:2005
EN 55022:2006, Amendment A1:2007	EN 61000-4-11:2004
EN 55024:1998, Amendments A1:2001, A2:2003	EN 60950-1:2001
CISPR 22:2005, Amendments A1:2005, A2:2006	
R&TTE Directive 1999/5/EC	
CFR 47, Part 15, Subpart B	

Supplementary Information:

In addition, the product is battery powered and the power supply provided with this product has been certified to IEC 60950 +A1, A2, A3, A4, A11. As manufacturer, we declare under our sole responsibility that the equipment follows the provisions of the Standards stated above.
Corvallis, OR USA

Importer of Record: Trimble European Regional Fulfillment Center,
Logistics Manager, Meerheide 45, 5521DZ Eersel,
Netherlands.

CAUTION: Only approved accessories may be used with this equipment. In general, all cables must be high quality, shielded, correctly terminated and normally restricted to two meters in length. The power supply approved for this product employs special provisions to avoid radio interference and should not be altered or substituted.

Unapproved modifications or operations beyond or in conflict with these instructions for use may void authorization by the authorities to operate the equipment.

Safe Use of your Unit

Repair: Do not attempt to dismantle the unit for repair. There are no user-serviceable parts inside. For service, use the contact details listed on the cover of this manual or contact your local dealer.

Battery safety: Lithium-Ion batteries are classified by the U. S. Federal Government as non-hazardous waste and are safe for disposal in the normal municipal waste stream. These batteries contain recyclable materials and are accepted for recycling. Dispose of used batteries in accordance with local regulations.

- 1) Do not disassemble or open, crush, bend or deform, puncture, or shred the battery assembly. There are no user-serviceable parts in the battery assembly.
- 2) Do not use battery if plastic case is cracked, compromised or punctured.
- 3) Do not attempt to separate battery from the battery door.
- 4) Do not modify or remanufacture, attempt to insert foreign objects into the battery, immerse or expose to water or other liquids.
- 5) Do not expose to fire, explosion, or other hazard. Do not expose to temperatures above +158 °F (+70 °C). The battery is designed to stop functioning if it reaches an unsafe temperature.
- 6) Do not short circuit a battery or allow metallic or conductive objects to contact the battery terminals. If battery contacts appear damaged, DO NOT use the battery.
- 7) Use only the battery for the system for which it was specified.
- 8) Non-approved batteries will not function in the device. Replace the battery only with another battery that has been qualified with the system per this standard, IEEE-Std-1725-200x. Improper battery use or use of an unqualified battery may present a risk of fire, explosion, leakage, or other hazard.
- 9) Only use the battery with a charging system that has been qualified with the system per this standard.
- 10) In the event of a battery leak, do not allow the liquid to come in contact with the skin or eyes. If contact has been made, wash the affected area with large amounts of water and seek medical advice.

Power supply safety

Use only AC and vehicle adapters intended for the unit. Other external power sources may damage your product and void the warranty. Certification of this Class III product is only valid with the power supply – PSA10F-050Q.

- Ensure the input voltage on the adapter matches the voltage in your location. Ensure the adapter has prongs compatible with your outlets.
- The power supply is designed for **indoor use only**. Avoid using the power supply in wet areas.
- Unplug the power supply from power when not in use.
- Do not short the output connector.

Telecommunications & Internet Association (TIA) information

Hearing Aids: Some digital wireless phones may interfere with some hearing aids. In the event of such interference, you may want to consult your service provider, or call the customer service line to discuss alternatives.



Pacemakers and Other Medical Devices: The Health Industry Manufacturers Association recommends a minimum separation of six inches be maintained between a handheld wireless phone and a pacemaker to avoid potential interference with the pacemaker. These recommendations are consistent with the independent research by and recommendations of Wireless Technology Research. Persons with pacemakers should use the ear opposite the pacemaker to minimize the potential for interference. If you have any reason to suspect that interference is taking place, turn the phone OFF immediately. If you use any other personal medical device, consult the manufacturer of your device to determine if they are adequately shielded from external RF energy. Your physician may be able to assist you in obtaining this information.

Turn the phone OFF in health care facilities when any regulations posted in these areas instruct you to do so. Hospitals or health care facilities may be using equipment that could be sensitive to external RF energy.



Environmental Hazards

The product complies with international RoHS regulations.

Toxic and Hazardous Substances and Elements

Part Name	Lead (Pb)	Mercury (Hg)	Cadmium (Cd)	Hexavalent Chromium (Cr6+)	Poly-brominated biphenyls (PBB)	Poly-brominated diphenyl ethers (PBDE)	
Printed Circuit Assemblies	X	O	O	O	O	O	
Display	X	O	O	O	O	O	
Keypad	X	O	O	O	O	O	
Housing	O	O	O	O	O	O	
Hardware	O	O	O	O	O	O	

Product Period does not include these items

Battery	X	O	O	O	O	O	
Power supply	X	O	O	O	O	O	
cable	O	O	O	O	O	O	
Manual	O	O	O	O	O	O	
Hand strap	O	O	O	O	O	O	
Stylus pkg.	O	O	O	O	O	O	
Companion CD	O	O	O	O	O	O	