

Wireless Headset S30

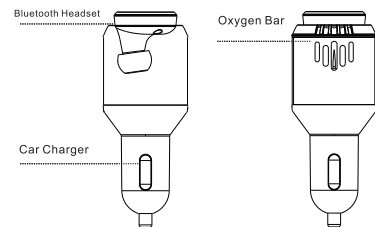

PATENTED PRODUCT
Patent number:201420142401.6

2

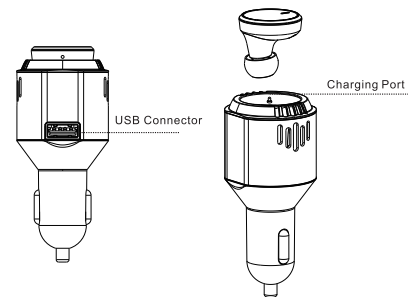

3

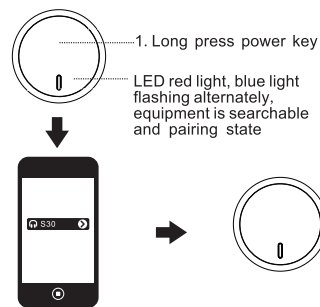

1. Long press power key
LED red light, blue light flashing alternately, equipment is searchable and pairing state
2. Turn on Bluetooth in Smart phones, search Bluetooth devices, click S30 on the screen
3. LED blue light flashing slowly, paired and ready to use

4

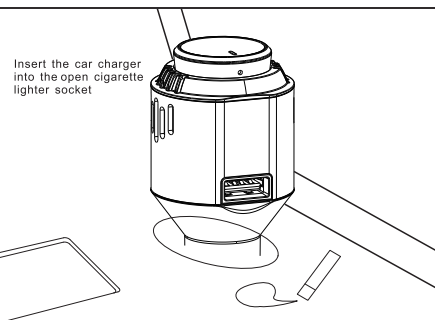

Attention: USB charging cable is not included, please prepare it by yourself

5

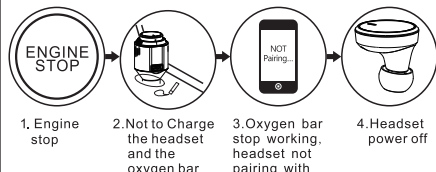
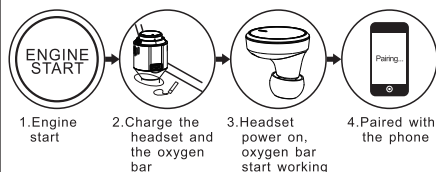

6



When the phone ringing, pick up the headset, you can answer the call

When the conversation is over, put down the headset, you can finish the call

7

To avoid affecting charging, please keep the charging port clean

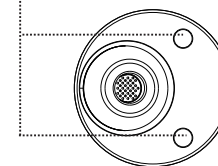

8

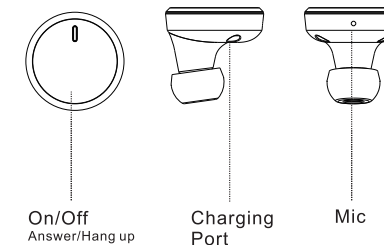

On/Off
Answer/Hang up

Charging
Port

Mic

9



Charge smart phone or tablets with USB cable

Car charger
Input voltage: 12V/24V
Output voltage: 5V
Output current: 2.4A

Headset
Longest distance: Accessible 10M
Bluetooth version: 4.1
Ways to wear: Insert the ear
Function: Play music, Voice call, Charging quickly

10

Oxygen bar

Input voltage: 5V
Output voltage: -1.5KV~3.5KV
Power: <1W



WARNING

- Please supply power to the device with nominal voltage according to this user menu
- Do not expose you device to direct sunlight for extended periods of time
- Please do not throw, beat or knock the device in order to avoid damaging the shell and internal components and parts
- Please put away from magnetic materials (credit car, bus car)
- Please turn off your headset when chemical plant, gas station, oil depot or other explosive are around
- Do not use a Bluetooth headset at high temperatures, is likely to cause an explosion

11

Model number: S30
FCC ID: S7J-S30
Made In China

This device complies with part 15 of the FCC Rules. Operation is subject to the condition that this device does not cause harmful interference

(1) this device may not cause harmful interference including interference that may cause undesired operation.
(2) this device must accept any interference received, The device has been evaluated to meet general RF exposure requirements. The device can be used in portable exposure conditions without restriction.

NOTE:THE GRANTEE IS NOT RESPONSIBLE FOR ANY CHANGES OR MODIFICATIONS NOT EXPRESSLY APPROVED BY THE PARTY RESPONSIBLE FOR COMPLIANCE. SUCH MODIFICATIONS COULD VOID THE USER'S AUTHORITY TO OPERATE THE EQUIPMENT.

12

<p>Note: This equipment has been tested and found to comply with the limits for a Class B digital device, pursuant to part 15 of the FCC Rules.</p> <p>These limits are designed to provide reasonable protection against harmful interference in a residential installation.</p> <p>This equipment generates, uses and can radiate radio frequency energy and, if not installed and used in accordance with the instructions, may cause harmful interference to radio communications. However, there is no guarantee that interference will not occur in a particular installation. If this equipment does cause harmful interference to radio or television reception, which can be determined by turning the equipment off and on, the user is encouraged to try to correct the interference by one or more of the following measures:</p> <p>Reorient or relocate the receiving antenna. Increase the separation between the equipment and receiver. Connect the equipment into an outlet on a circuit different from that to which the receiver is connected. Consult the dealer or an experienced radio/TV technician for help.</p>		