

Start/End Group Intercom

Start Group Intercom

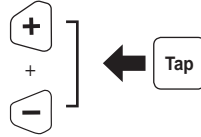

End Group Intercom



Mesh Intercom On/Off



Mesh Intercom Public Mode

When Mesh Intercom is initially turned on, the headset will be in **Public Mode**. The headset will automatically connect to nearby users and allow them to talk to each other by pressing the Mesh Intercom Button.

Mesh Intercom Private Mode

For using **Private Mode**, a Mesh needs to be created by a user. In **Private Mode**, participants can leave, join, or rejoin a group intercom.

Create Mesh [Creator]



When a user creates a Mesh, the headset automatically switches from **Public Mode** to **Private Mode**.

Accept a participant [Creator]



Reject a participant [Creator]



Accept Invitation During Mesh Creation [Participant]



Join an Existing Mesh [Participant]

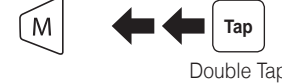

Quit Mesh Permanently



Quitting the Mesh will automatically return to **Public Mode**.

Mesh Intercom Mic Enable/Disable



Mesh Intercom Toggle Public Mode/Private Mode



Radio On/Off



Radio Seek Stations

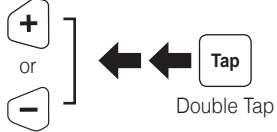

Radio Scan Up FM Band



Save to preset while scanning



Radio Save or Delete Preset



1 ~ 10, Cancel



Radio Move to Preset Station

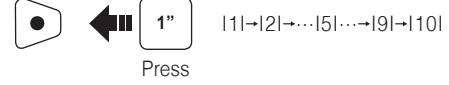

Setting

Using the Sena Smartphone App

The Sena Smartphone App allows you to configure the device settings, create groups of intercom friends, and view the quick start guide. Simply pair your phone with your Boom! Audio HD-N02 headset, run the Sena Smartphone App and you can configure its settings directly from your smartphone. You can download the Sena Smartphone App for Android or iPhone from [oem.sena.com/harley-davidson](http://oem.sena.com/harley-davidson).

Certification and Safety Approvals  
FCC Compliance Statement

This device complies with part 15 of the FCC rules.

Operation is subject to the following two conditions:

- (1) This device may not cause harmful interference, and
- (2) This device must accept any interference received, including interference that may cause undesired operation.

This equipment has been tested and found to comply with the limits for a Class B digital device pursuant to part 15 of the FCC rules. These limits are designed to provide reasonable protection against harmful interference in a residential installation. This equipment generates, uses and can radiate radio frequency energy and, if not installed and used in accordance with the instructions, may cause harmful interference to radio communications. However, there is no guarantee that interference will not occur in a particular installation. If this equipment does cause harmful interference to radio or television reception, which can be determined by turning the equipment on and off, the user is encouraged to try to correct the interference by one or more of the following measures:

- Reorient or relocate the receiving antennae
- Increase the separation between the equipment and the receiver
- Connect the equipment into an outlet on a circuit different from that to which the receiver is connected.
- Consult the dealer or an experienced radio/TV technician for help.

**FCC RF Exposure Statement**  
The separation distance between the helmet and the head surface should be mounted to the product not less than 30.2 mm. However, considering the RF exposure environment, the SAR testing was performed at 10mm distance, which is somewhat conservative.  
The highest SAR value reported under this standard during product certification for use next to the head with the minimum separation distance of 10mm is **1.539 W/kg**. This transmitter must not be collocated or operating in conjunction with any other antenna or transmitter. This product is compliance to FCC RF Exposure requirements and refers to FCC website [https://apps.fcc.gov/oetcf/eas/reports/](https://apps.fcc.gov/oetcf/eas/reports/GenericSearch.cfm) GenericSearch.cfm search for FCC ID: S7A-SP57.

**FCC Caution**  
Any changes or modifications to the equipment not expressly approved by the party responsible for compliance could void user's authority to operate the equipment.

**Industry Canada Statement**  
This device complies with Industry Canada license-exempt RSS standard(s). Operation is subject to the following two conditions:

- (1) This device may not cause interference.
- (2) This device must accept any interference, including interference that may cause undesired operation of the device.

**Déclaration de conformité IC (Industrie Canada)**  
Le présent appareil est conforme aux CNR d'Industrie Canada applicables aux appareils radio exempts de licence. L'exploitation est autorisée aux deux conditions suivantes :  
(1) Cet appareil ne doit pas créer d'interférences.  
(2) Cet appareil doit accepter toutes les interférences reçues, y compris celles qui pourraient entraver son bon fonctionnement.

**troubleshooting**

**Factory Reset**

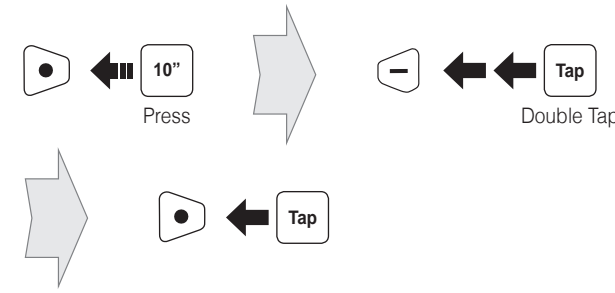

**Fault Reset**

If the Boom! Audio HD-N02 headset is not working properly for any reason, reset by gently pushing the pin-hole reset button as shown below.

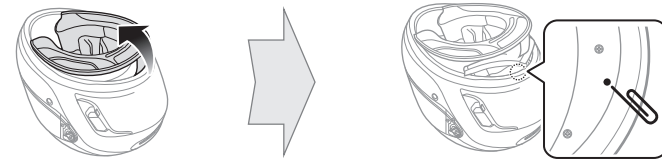

Partially pull out the neck roll from the rear side of the helmet



**Customer Support:** [support.sena.com](https://support.sena.com)  
E-mail: [support@sena.com](mailto:support@sena.com)