

OUTRANDER M Manual

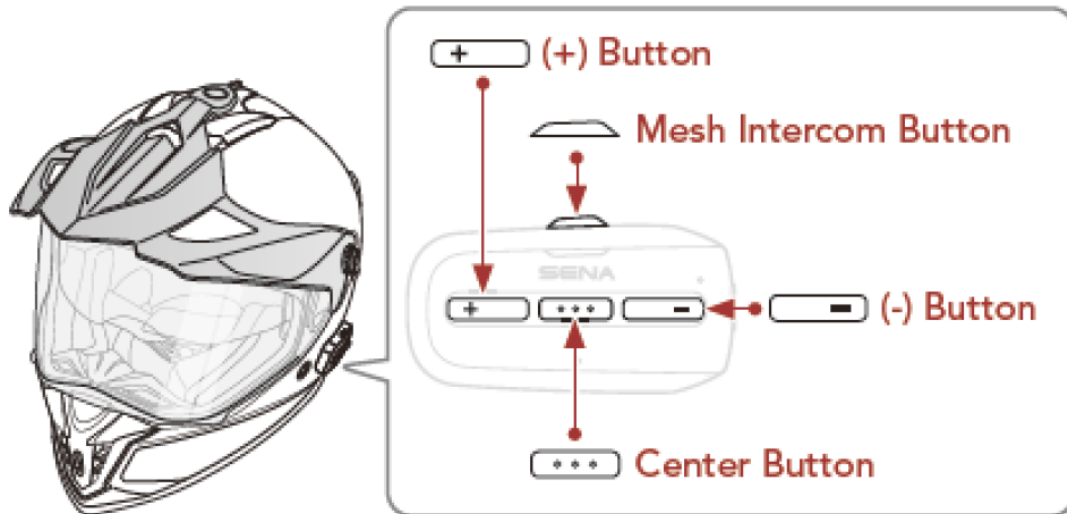

Charging

Red LED: Charging

Blue LED: Fully charged

Power On/Off

(+) Button + Center Button for 1 sec

Volume Adjustment

(+) Button - Increase the volume

(-) Button - Decrease the volume

Battery Check

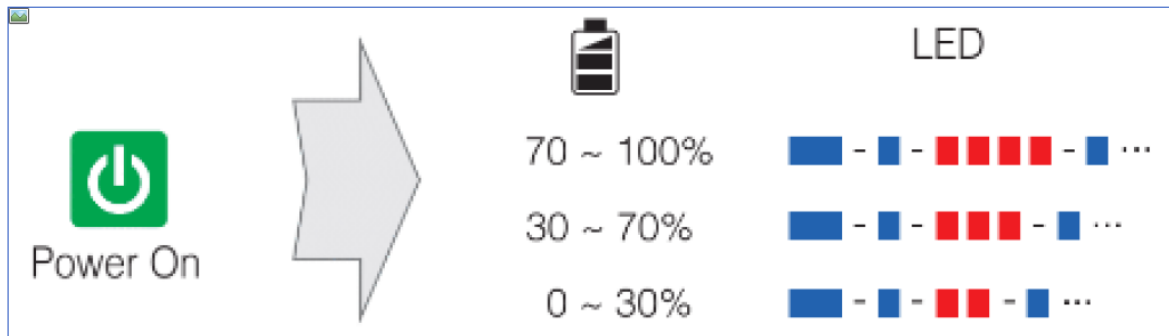

Phone, Music Pairing

Initially Pairing the Cast

The headset will automatically enter the phone pairing mode when you initially turn on the headset or in the following situation:

Rebooting after executing Factory Reset

Press and hold the Center Button and (+) Button for 1 second.

Search for Bluetooth devices on your mobile phone. Select the OUTLANDER M in the list of the devices detected on the mobile phone.

Enter 0000 for the PIN. Some mobile phones may not ask for the PIN.

Music Operation

Play or pause music: Press the Center Button for 1 second. Track back: Press the (-) Button for 1 second.

Track forward: Press the (+) Button for 1 second.

Mobile Phone Call Making and Answering

Answering a call: Tap the Center Button

Ending a call: Press the Center Button for 2 seconds. Voice dial: Press the Center Button for 3 seconds. Speed dial: Press the (+) Button for 3 seconds. Rejecting a call: Press the Center Button for 2 seconds.

Mesh Intercom On/Off

Mesh Intercom On : Tap the Mesh Intercom Button.

Mesh Intercom Off : Tap the Mesh Intercom Button.

Radio On/Off

Turn on the FM radio: Press the (-) Button for 1 second. Turn off the FM radio: Press the (-) Button for 1 second.

Setting

Configuration Menu: Press the Center Button for 10 seconds.

Troubleshooting

Factory Reset

If you want to restore the headset to factory default settings, use the Factory Reset in the configuration menu. The headset automatically restores the default settings and turns off.

Certification and Safety Approvals FCC Compliance Statement

This device complies with part 15 of the FCC rules. Operation is subject to the following two conditions: (1) This device may not cause harmful interference, and

(2) This device must accept any interference received, including interference that may cause undesired operation.

This equipment has been tested and found to comply with the limits for a Class B digital device pursuant to part 15 of the FCC rules. These limits are designed to provide reasonable protection

against harmful interference in a residential installation. This equipment generates, uses and can radiate radio frequency energy and, if not installed and used in accordance with the instructions, may cause harmful interference to radio communications. However, there is no guarantee that interference will not occur in a particular installation. If this equipment does cause harmful interference to radio or television reception, which can be determined by turning the equipment on and off, the user is encouraged to try to correct the interference by one or more of the following measures:

-Reorient or relocate the receiving antennae

-Increase the separation between the equipment and the receiver

-Connect the equipment into an outlet on a circuit different from that to which the receiver is connected. -Consult the dealer or an experienced radio/TV technician for help.

FCC RF Exposure Statement

This equipment complies with FCC/IC radiation exposure limits set forth for an uncontrolled environment. End users must follow the specific operating instructions for satisfying RF exposure compliance.

When equipped, the distance between antenna and one's head surface is 34.5mm.

FCC Caution

Any changes or modifications to the equipment not expressly approved by the party responsible for compliance could void user's authority to operate the equipment.

Industry Canada(IC) Statement

This device complies with Industry Canada license-exempt RSS standard(s). Operation is subject to the following two conditions:

(1) this device may not cause interference, and

(2) this device must accept any interference, including interference that may cause undesired operation of the device.

Le present appareil est conforme aux CNR d'Industrie Canada applicables aux appareils radio exempts de licence. L'exploitation est autorisee aux deux conditions suivantes :

- (1) l'appareil ne doit pas produire de brouillage, et
- (2) l'utilisateur de l'appareil doit accepter tout brouillage radioelectrique subi, meme si le brouillage est susceptible d'en compromettre le fonctionnement.

IC RF Exposure Statement

Cet équipement est conforme aux limites d'exposition aux radiations de la FCC/IC définies pour un environnement non contrôlé. Les utilisateurs finaux doivent suivre les instructions d'utilisation spécifiques pour satisfaire à la conformité d'exposition RF.

Lorsque équipé, la distance entre l'antenne et la surface de la tête est de 34.5mm.