

SUUNTO GPS POD

USER'S MANUAL

SUUNTO
REPLACING LUCK.

CUSTOMER SERVICE CONTACTS

Suunto Oy	Phone +358 9 875870 Fax +358 9 87587301
Suunto USA	Phone 1 (800) 543-9124
Canada	Phone 1 (800) 776-7770
European Call Center	Phone +358 2 284 11 60
Suunto Website	www.suunto.com

COORDONNÉES DU SERVICE CLIENTS

Suunto Oy	Tél. +358 9 875870 Fax +358 9 87587301
Suunto USA	Tél. 1 (800) 543-9124
Canada	Tél. 1 (800) 776-7770
Centres d'appels en Europe	Tél. +358 2 284 11 60
Site Web Suunto	www.suunto.com

KUNDENDIENST

Suunto Oy	Tel. +358 9 875870 Fax +358 9 87587301
Suunto USA	Tel. 1 (800) 543-9124
Canada	Tel. 1 (800) 776-7770
Europaweites Call Center	Tel. +358 2 284 11 60
Suunto im Internet	www.suunto.com

DATOS DE CONTACTO DE SERVICIO AL CLIENTE

Suunto Oy	Tel. +358 9 875870 Fax +358 9 87587301
Suunto USA	Tel. 1 (800) 543-9124
Canadá	Tel. 1 (800) 776-7770
Centro de llamadas para Europa	Tel. +358 2 284 11 60
Sitio web de Suunto	www.suunto.com

NUMERI UTILI PER IL SERVIZIO CLIENTI

Suunto Oy	Tel. +358 9 875870 Fax +358 9 87587301
Suunto USA	Tel. 1 (800) 543-9124
Canada	Tel. 1 (800) 776-7770
Call Center Europeo	Tel. +358 2 284 11 60
Sito Internet Suunto	www.suunto.com

KLANTENSERVICE

Suunto Oy	Tel. +358 9 875870 Fax +358 9 87587301
Suunto USA	Tel. 1 (800) 543-9124
Canada	Tel. 1 (800) 776-7770
European Call Center	Tel. +358 2 284 11 60
Suunto Website	www.suunto.com

ASIAKASPALVELUN YHTEYSTIEDOT

Suunto Oy	Puh. +358 9 875870 Fax +358 9 87587301
Suunto USA	Puh. 1 (800) 543-9124
Kanada	Puh. 1 (800) 776-7770
Euroopan Call Center	Puh. +358 2 284 11 60
Suunnon verkkosivut	www.suunto.com

KUNDSERVICE, KONTAKTER

Suunto Oy	Tel. +358 9 875870 Fax +358 9 87587301
Suunto USA	Tel. 1 (800) 543-9124
Kanada	Tel. 1 (800) 776-7770
Callcenter i Europa	Tel. +358 2 284 11 60
Suuntos webbplats	www.suunto.com

1. QUICK START GUIDE

To start using your Suunto GPS POD right away, follow these quick steps (see figures below).

1. Insert batteries (size AAA; included in the sales package).

- Open the GPS POD by turning the bottom cover counterclockwise.
- Insert batteries and close the POD by turning the bottom cover clockwise.

2. Pair the GPS POD with your Suunto wristop.

- Select TRAINING > PAIR > SPD POD in the wristop menu.
=> 'TURN ON NEW DEVICE' or 'TURN ON GPS' is displayed.
- Turn the GPS POD on by pressing the Power (Start/Stop) button for 1 sec.
=> Soon after, 'PAIRING COMPLETE' or 'PAIRED GPS' is displayed.

3. Connect the devices.

- Select SPD/DST > CONNECT in the wristop menu. Make sure the POD is on.
=> 'FND SPD/GPS POD' is shortly displayed when the device has been found.

4. Let the POD find a GPS connection (outdoors).

- Take the POD outside, its top cover facing to the sky. Wait for the green LED to change from a quick double-blink to a slower single blink (this may take 60 seconds). Now the POD has found a satellite connection and your wristop displays speed and distance information in the SPD/DST mode.

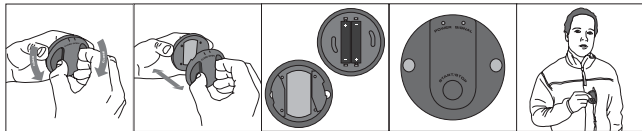

2. USING THE GPS POD

Suunto GPS POD is an accessory for Suunto ANT compatible wristop computers. It is a lightweight, wireless speed and distance sensor suitable for outdoor sports. You can attach it to your upper body by using a textile armband or an easy-to-use clip that come with the device. The contents of the sales package are pictured on the right.

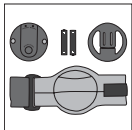

2.1. PAIRING WITH THE WRISTOP

You only need to pair the GPS POD with your Suunto wristop once. After successful pairing, your wristop will display a new mode, SPD/DST, where you can view all the speed and distance-related information. The pairing instructions are given in the Quick Start Guide above.

=> If pairing does not succeed, the wristop will return to Pairing menu (after trying for 15-30 seconds). 'NO DEVICES FOUND' may shortly be displayed. Make sure that there are no other active PODs or heart rate belts nearby and try again.

NOTE! Some of the info messages may vary between different Suunto wristop computer models due to screen size limitations.

2.2. ATTACHING THE POD TO YOUR UPPER BODY

Attach the GPS POD so that the top cover, where the antenna is located, faces up toward the sky (see figure on the right).

- Use the armband that comes with the GPS POD to attach the POD to your arm (see figures below).
- Use the clip to attach the POD to one of the straps of your backpack (see figures below).
- You can also slip the POD into your chest pocket - however, the GPS satellite signal may be interrupted more easily if the POD's top cover is not facing up.

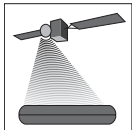



2.3. ACTIVATING THE POD

Press and hold the Start/Stop button until the LEDs start to blink.

=> To deactivate, press and hold the button until the LED lights disappear.

2.4. CONNECTING THE POD WITH THE WRISTOP

Every time the POD is activated or the connection has been lost, you need to reconnect the POD with the wristop.

- Select SPD/DST > CONNECT in your Suunto wristop menu.

=> If 'NO DEVICES FOUND' is displayed, check the battery power indicator: if the red LED is on, the connection may not succeed. Replace the batteries and try again.

If the POD does not receive a signal from the wristop for 5 minutes, or if it does not receive a satellite signal for 15 minutes, it will turn off automatically.

2.5. REPLACING THE BATTERY

1. Turn the bottom cover slightly left (counterclockwise) and detach it from the top cover.
2. Replace the AAA size (LR03) batteries, set the bottom cover over the top cover and close the POD by turning the bottom cover right (clockwise).

2.6. SUUNTO TRAINING MANAGER

You can transfer the speed and distance data recorded by your wristop to your computer to be viewed in the Suunto Training Manager.

3. TECHNICAL SPECIFICATIONS

- Weight: 60g (72g incl. batteries, without attachments)
- Water-resistance: IPX 7 + 3 m immersion
- Operating temperature: -20°C to +60°C / -5°F to +140°F
- Battery size/life: 1,5V AAA (LR03), min. 10h (at 20°C/68°F)
- Transmission range: up to 10m/30ft
- Accuracy: speed: ± 2 km/h, distance: ± 5 % of the reading
- Digital radio link: 2.465 GHz ANT compatible

4. INTELLECTUAL PROPERTY

4.1. COPYRIGHT

This publication and its contents are proprietary to Suunto Oy and are intended solely for the use of its clients to obtain knowledge and key information regarding the operation of Suunto t6 products.

Its contents shall not be used or distributed for any other purpose and/or otherwise communicated, disclosed or reproduced without the prior written consent of Suunto Oy.

While we have taken great care to ensure that information contained in this documentation is both comprehensive and accurate, no warranty of accuracy is expressed or implied. Its content is subject to change at any time without notice. The latest version of this documentation can always be downloaded in www.suunto.com.

© Suunto Oy 5/2006

4.2. TRADEMARK

Suunto and Replacing Luck are registered trademarks of Suunto Oy. Suunto t6 and other Suunto product, feature and content names are registered or unregistered trademarks of Suunto Oy. Other product and company names are trademarks of their respective owners.

4.3. PATENT NOTICE

This product is protected by US6,513,381, US6,301,964, US5,955,667 patents and corresponding non-US patents. Other patents have been applied for.

5. DISCLAIMERS

5.1. USER'S RESPONSIBILITY

This instrument is intended for recreational use only. Suunto GPS Pod must not be substituted for obtaining measurements that require professional or industrial precision.

5.2. CE

The CE mark is used to mark conformity with the European Union EMC directives 89/336/EEC and 99/5/EEC.

5.3. FCC COMPLIANCE

This device complies with Part 15 of the FCC limits for class B digital devices. This equipment generates, uses, and can radiate radio frequency energy and, if not installed or used in accordance with the instructions, may cause harmful interference to radio communications. There is no guarantee that interference will not occur in a particular instance. If this equipment does cause harmful interference to other equipment, try to correct the problem by relocating the equipment.

Consult an authorized Suunto dealer or other qualified service technician if you cannot correct the problem. Operation is subject to the following conditions:

(1) This device cannot cause harmful interference.

(2) This device must accept any interference received, including interference that may cause undesired operation.

Repairs should be made by authorized Suunto service personnel. Unauthorized repairs will void warranty.

Tested to comply with FCC standards. For home or office use.

FCC WARNING: *Changes or modifications not expressly approved by Suunto Oy could void your authority to operate this device under FCC regulations.*

5.4. LIMITS OF LIABILITY AND ISO 9001 COMPLIANCE

If this product should fail due to defects in materials or workmanship, Suunto Oy will, at its sole option, repair or replace it with new or rebuilt parts, free of charge, for two (2) years from the date of its purchase. This warranty is only extended to the original purchaser and only covers failures due to defects in materials and workmanship that occur during normal use while in the period of the warranty.

It does not cover battery, battery replacement, damage or failures resulting from accident, misuse,

neglect, mishandling, alteration or modifications of the product, or any failure caused by operation of the product outside the scope of its published specifications, or any causes not covered by this warranty.

There are no express warranties except as listed above.

The client can exercise the right to repair under the warranty by contacting Suunto Oy's Customer Service department to obtain a repair authorization.

Suunto Oy and its subsidiaries shall in no event be liable for any incidental or consequential damages arising from the use of or inability to use the product. Suunto Oy and its subsidiaries do not assume any responsibility for losses or claims by third parties that may arise through the use of this device.

Suunto's Quality Assurance System is certified by Det Norske Veritas to be ISO 9001 compliant in all Suunto Oy's operations (Quality Certificate No. 96-HEL-AQ-220).

5.5. AFTER SALES SERVICE

If a claim under warranty appears to be necessary, return the product, freight prepaid, to your Suunto dealer who is responsible for having your product repaired or replaced. Include your name, address, proof of purchase and/or service registration card, as required in your country. The claim will be honored and the product repaired or replaced at no charge and returned in what your Suunto dealer determines a reasonable amount of time, provided that all necessary parts are in stock. All repairs that are not covered under the terms of this warranty will be made at the owner's expense. This warranty is non-transferable from the original owner.

If it is not possible to contact your Suunto dealer, contact your local Suunto distributor for further information. You can locate your local Suunto distributor in www.suunto.com.

6. DISPOSAL OF THE DEVICE

Please dispose of the device in an appropriate way, treating it as electronic waste. Do not throw it in the garbage. If you wish, you may return the device to your nearest Suunto representative.



COPYRIGHT

This publication and its contents are proprietary to Suunto Oy.

Suunto, Wristop Computer, Suunto Foot Pod, Replacing Luck and their logos are registered or unregistered trademarks of Suunto Oy. All rights reserved.

While we have taken great care to ensure that information contained in this documentation is both comprehensive and accurate, no warranty of accuracy is expressed or implied. Its content is subject to change at any time without notice.

www.suunto.com

© Suunto Oy, 5/2006