

Dual Portable Wireless Speakers

User's Guide for Model No. ISB2006 v1409-01



Important Safety Instructions

- Read these Instructions.
- Keep these Instructions.
- Heed all Warnings.
- Follow all instructions.
- Do not use this apparatus near water.
- Clean only with a dry cloth.
- Do not block any ventilation openings. Install in accordance with the manufacturer's instructions.
- Do not install near any heat sources such as radiators, heat registers, stoves, or other apparatus (including amplifiers) that produce heat.
- Do not defeat the safety purpose of the polarized or grounding - type plug. A polarized plug has two blades with one wider than the other. A grounding type plug has two blades and a third grounding prong. The wide blade or the third prong are provided for your safety. When the provided plug does not fit into your outlet, consult an electrician for replacement of the obsolete outlet.
- Protect the power cord from being walked on or pinched particularly at plugs, convenience receptacles, and the point where they exit from the apparatus.
- Only use attachments/accessories specified by the manufacturer.
- Unplug this apparatus during lightning storms or when unused for long periods of time.
- Refer all servicing to qualified service personnel. Servicing is required when the apparatus has been damaged in any way, such as power-supply cord or plug is damaged, liquid has been spilled or objects have fallen into the apparatus, the apparatus has been exposed to rain or moisture, does not operate normally, or has been dropped.
- Use only with a cart, stand, tripod, bracket, or table specified by the manufacturer, or sold with the apparatus. When a cart is used, use caution when moving the cart/apparatus combination to avoid injury from tip-over.



FCC Warnings

Warning: Changes or modifications to this unit not expressly approved by the party responsible for compliance could void the user's authority to operate the equipment.

NOTE: This equipment has been tested and found to comply with the limits for a Class B digital device, pursuant to Part 15 of the FCC Rules. These limits are designed to provide reasonable protection against harmful interference in a residential installation. This equipment generates, uses, and can radiate radio frequency energy and, if not installed and used in accordance with the instructions, may cause harmful interference to radio communications. However, there is no guarantee that interference will not occur in a particular installation. If this equipment does cause harmful interference to radio or television reception, which can be determined by turning the equipment off and on, the user is encouraged to try to correct the interference by one or more of the following measures:

- Reorient or relocate the receiving antenna.
- Increase the separation between the equipment and receiver.
- Connect the equipment into an outlet on a circuit different from that to which the receiver is connected.
- Consult the dealer or an experienced radio/TV technician for help.

RF warning for Mobile device:
This equipment complies with FCC radiation exposure limits set forth for an uncontrolled environment.
This equipment should be installed and operated with minimum distance 20cm between the radiator & your body.

FEATURES & CONTROLS

Features

- Supports Bluetooth
- Automatic device reconnect
- Bluetooth Wireless range: 33 ft to main speaker/15 ft between speakers
- Aux In 3.5 mm audio input
- Built in rechargeable lithium ion battery
- Battery life: approx. 3 hrs

Includes

- AC/DC power adapter
- Micro-USB to USB cable

Rear View

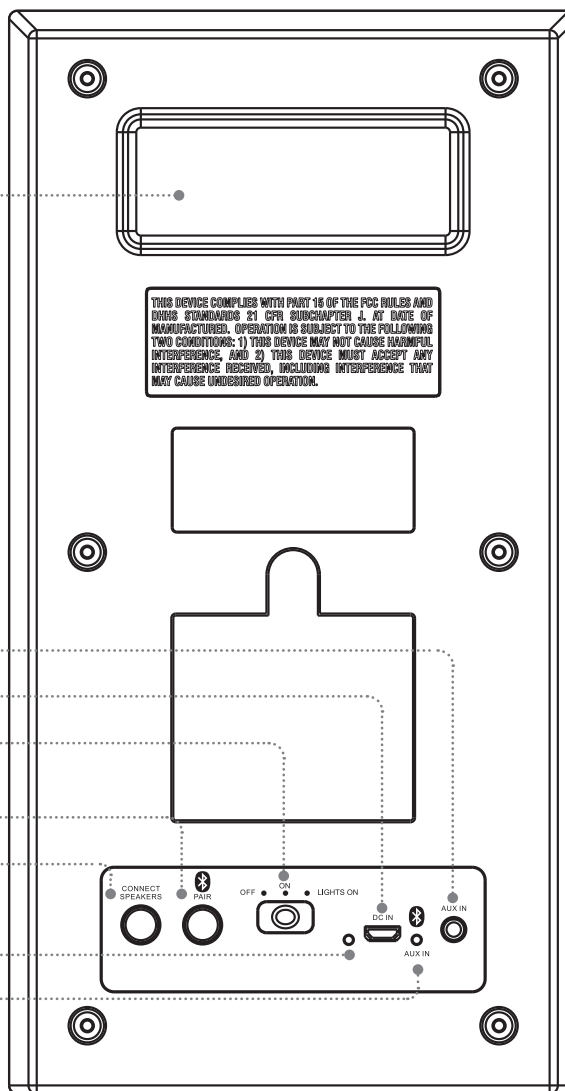

Carry Handle

Aux In 3.5mm Audio Input

Micro-USB Power Input

Power/Lights Switch

Slide to power OFF, ON, or ON with Light effects

Pair Bluetooth

Connect Speakers

Power/Connect Speaker Indicator

Function Mode Indicator

POWER & CHARGING

DC Power Input

Requires an AC/DC power adapter (included).

Each speaker must be charged independently.

Battery life when not in use is roughly 6 months. The battery must then be fully recharged. Charge each speaker for at least 2.5 hours before use.

1. Connect one end of the included **AC/DC power adapter** to the unit and one end to an **AC power outlet** to recharge the battery.

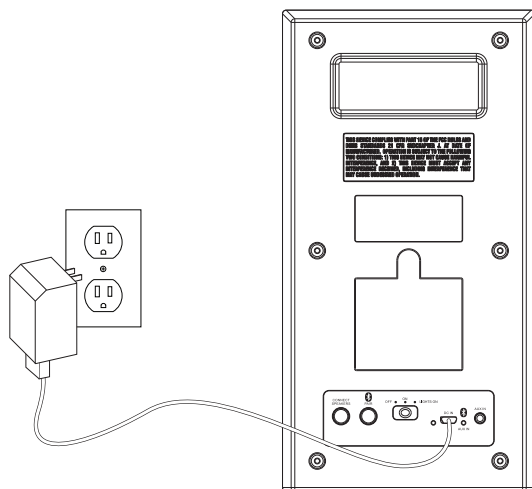

Battery LED Indicators (RED/YELLOW)

Speaker Status	Indicator Light
Low Battery	Flashing Red/Yellow OFF
Charging Battery	Solid Red/Yellow OFF
Battery Fully Charged	Red OFF/Yellow ON

Speaker Pairing LED Indicators (Yellow)

Speaker Status	Indicator Light
Speakers Pairing	Flashing Yellow
Speakers Paired	Solid Yellow

Function & Bluetooth LED Indicators (BLUE/GREEN)

Speaker Status	Indicator Light
Aux In	Solid Green
Pairing Bluetooth	Quick Flashing Blue
Reconnecting Bluetooth	Slow Flashing Blue
Bluetooth Paired	Solid Blue

BLUETOOTH

Pairing the Speakers

The speakers should be paired **BEFORE** pairing to a Bluetooth device. This should only need to be done upon first use. Make sure the speakers are fully charged before beginning the pairing process.

1. Power on the speakers by sliding the power switch to the **ON** position on both units.
2. The **Bluetooth Indicator** and **Speaker Connection Indicator** will flash slowly in unison. *If the Speaker Connection Indicator is not flashing, but is solid yellow on both speakers, your speakers are already paired. Skip to the Pairing a Bluetooth Device section.*
3. Press the **Connect Speakers button** on both speakers simultaneously. *The Speaker Connection Indicators will flash quickly.*
4. Wait until both **Speaker Connection Indicators** are solid yellow. This indicates that the speakers have successfully paired.
5. For all future uses, please turn on both speakers and wait for them to connect. If any pairing issues should occur, repeat the above steps.

Pairing to a Bluetooth Device

Make sure you have first followed the instructions for *Pairing the Speakers*. When pairing, the device should remain within 3 feet of the speakers.

1. Press the **Pair button** on **ONLY ONE** of the speakers (this will be the left speaker channel). *The pair indicator will begin flashing quickly.*
2. Using the controls on your Bluetooth device, select **ISB2006** in your Bluetooth settings.
3. If your device requests a password, enter the default password **0000**.
4. Refer to the user's manual for your specific device for instructions on pairing and connecting Bluetooth devices.
5. When successfully paired, the pairing indicator will stop flashing and will remain solid.
6. After initial pairing, the unit will stay paired unless unpaired manually by the user or erased due to a reset of the device.

If your device should become unpaired for any reason, repeat the above steps.

If any pairing issues should occur, un-pair the unit on your Bluetooth device and repeat the above steps.

If two speakers with the ISB2006 name appear on the pairing list of your device, please erase one listing from your Bluetooth device and repeat the above steps.

AUX IN

Using Aux In

Requires a 3.5mm audio cable (not included).

1. Connect a 3.5mm audio cable to the **Aux In Input** on the unit and the **audio output** on an audio device. *The Pairing/Aux In Indicator will display a solid green light.*
2. Use the controls on the connected device to select, play, and adjust the volume of your audio tracks.

INTERNATIONAL SUPPORT

To download this User's Guide in English, Spanish, or French, or to get answers to frequently asked questions, visit the support section at: www.iLiveElectronics.com

Para descargar este Manual del Usuario en inglés, español y francés, o para obtener respuestas a preguntas frecuentes, visite la sección de apoyo en: www.iLiveElectronics.com

Pour télécharger ce guide de l'utilisateur en anglais, espagnol ou français, ou pour obtenir des réponses à des questions fréquemment posées, consultez la rubrique d'assistance sur: www.iLiveElectronics.com

For Warranty Information and the most up-to-date version of this User's Guide, go to www.iLiveElectronics.com

Customer Service: 1-888-999-4215 | **Email Support:** prodinfo@dpiinc.com | **Email Parts:** partsinfo@dpiinc.com

Copyright © 2016 Digital Products International (DPI, Inc.) All other trademarks appearing herein are the property of their respective owners. Specifications are subject to change without notice.

