

ZONDA
www.zonda.com.mx



ZMNG110

ColourZ

Discover your phone

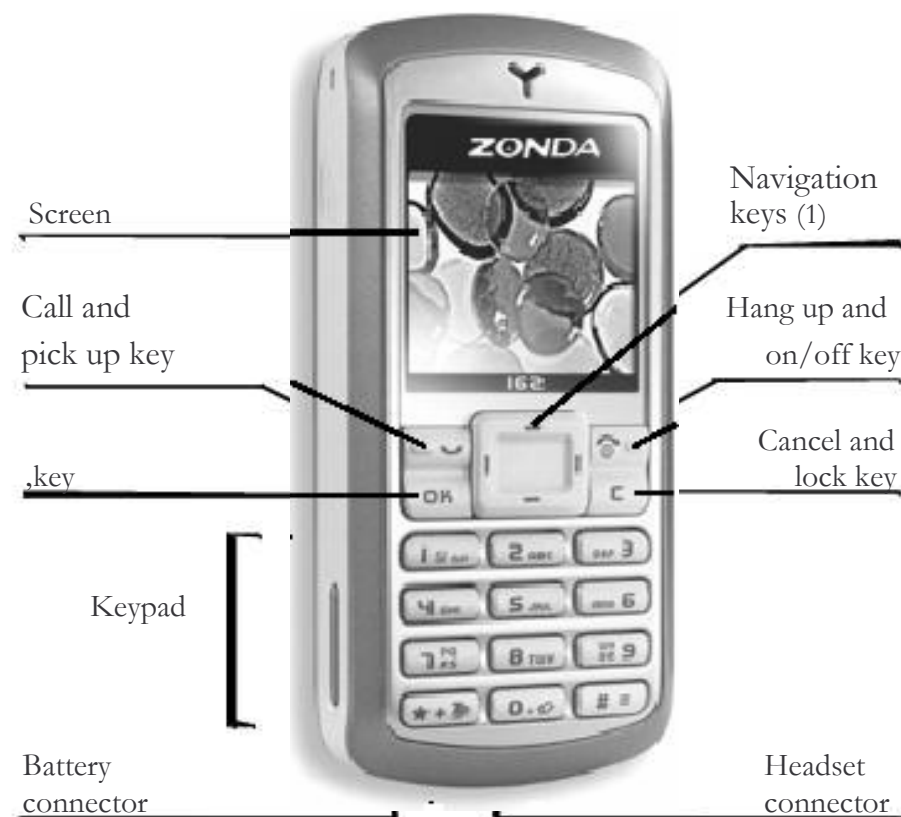

(1) Navigation keys will be represented in the manual by the following signs: left < / > right, up + / - down.

Zonda continuously strives to improve its products. Therefore, Zonda reserves the rights to revise this user guide or withdraw it at any time without prior notice. Zonda provides this user guide "as is" and does not accept, except as required by applicable law, liability

for any error, omission or discrepancy between this user guide and the product described. The device is meant to be connected to GSM network.

How to...

Switch phone On/Off	Press and hold).
Enter PIN code	Enter your PIN code using the keypad and press , or # to confirm.
Make a call	Enter the phone number on the keypad and press (to dial.
Answer a call	Press (when your phone rings.
End a call	Press).
Set conversation volume	Press + or - during the call.
Access the main menu	Press , in idle mode.
Change the ringer volume	Press + in idle mode.
Access the Contacts	Press-in idle mode.

Use the **Contacts**

Browse the list by moving
+or- and press (to
call the selected name.

Access the **Call list**

Press (in idle mode.

Go to previous menu Press c.

Quickly return to idle
when browsing menus hold c.

Press) or press and

Launch **WAP**

Press and hold 0.

Open the **SMS** menu

Press > in idle mode.

Open the **Sound Album** Press < in idle mode.

Lock/Unlock the keypad Press and hold c.

The carousel

You access the carousel menu by pressing , when in idle mode. Each icon represents a feature or operation of your phone. Use<or>to browse the menu and press , to select a menu (or press c to cancel). Another sub-menu or list will then appear.

Pressing +or -will alternate between two options, such as Activate/Deactivate, On/Off, Increase/Decrease a value, etc.

Events

Some events may modify the idle screen (missed call, new message, etc.). Press , to access the corresponding menu or press c to go back to the idle screen.

Table of contents

1. Getting started1	Edit and manage contacts	10
Insert the SIM card1	5. Settings	12
Set date and time2	Sounds	12
Copy the SIM phonebook2	Display	12
Switch on the phone2	Hotkeys	13
Charge the battery2	Time and date	13
2. Main features4	Language	14
Access and view the phonebook4	Security	14
Make a call4	Network	15
Answer and end a call4	6. Messages	17
Adjust the earpiece volume4	SMS	17
Mute/Unmute the microphone4	Broadcast SMS	19
Change the ringer5	SMS chat	19
Activate the vibra alert5	7. Multimedia	20
Quickly scroll a list5	Sound album	20
3. Text or number entry6	Picture album	20
T9 ® Text input6	Memory status	21
Basic text input7	8. Games & Applications	22
4. Contacts8	Calculator	22
Settings8	Alarm clock	22
Add contacts to a phonebook8	Euro converter	22
Fotocall: See & hear who's calling9	Games	23

9. Call information	24
Call settings	24
Call list	25
Counters	25
10. Operator.....	26
WAP	26

Handling several calls.....	28
Icons & symbols	30
Precautions	31
Troubleshooting	34
Zonda authentic accessories	37

1 • Getting started

Read the safety instructions in the “Precautions” section before use.

To use your phone, you must insert a valid SIM card supplied by your operator or retailer. The SIM card contains your subscription and a memory in which you can store phone numbers and messages.

Insert the SIM card

1. Press on the two clips on each side of the phone and pull the back cover to remove it.

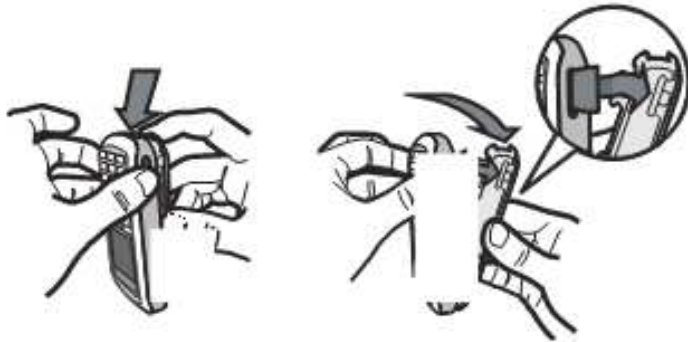

2. Place the SIM card in its slot (with the connectors facing the phone) then replace the metallic holder.



3. Insert the battery (with the connectors facing the phone) and press until it clips.



4. Replace the back cover as shown below. Remove the protective film covering the screen before using the phone.

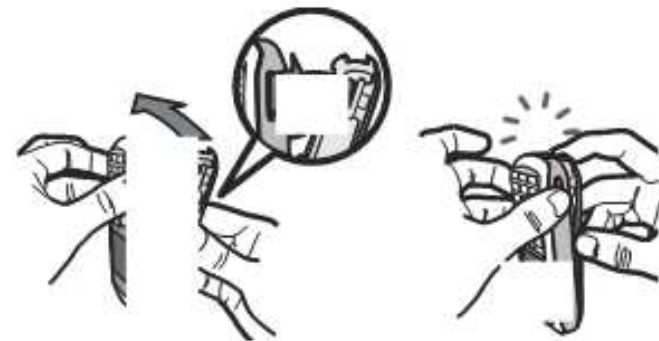

Switch on the phone

To switch on the phone, long press **⏻**. Enter the PIN code if required (i.e. the 4- to 8-digit secret code of your SIM card). It is preconfigured and communicated to you by your operator or retailer. To personalise the PIN code, see “Change codes” page 14. Press **✓**, to confirm.

If you enter an incorrect PIN code 3 times, your SIM card is blocked. To unblock it, you must request the PUK code from your operator.

Set date and time

As prompted by the phone at first switch on, set the date by pressing the appropriate numeric keys (press **C** to erase a number), then set the time.

For complete date and time options, see page 13.

Copy the SIM phonebook

The mobile phone detects a SIM card that already contains names and a message asks you if you want to copy your SIM phonebook onto the built-in phonebook. Press **C** to cancel or **✓**, to accept.

If at first switch you do not copy the SIM phonebook, you can do it manually (see page 8).

Charge the battery

Your phone is powered by a rechargeable battery. A new battery is partially charged and an alarm will warn you when the battery reaches low. If the battery is completely flat, it will take 2 or 3 minutes of charging for its icon to reappear.

You may lose all your personal settings if you remove the battery when the phone is switched on.

1. Once the battery and battery cover are clipped on the phone, plug the connector of the charger (supplied with the phone, in the box) into the socket at the base of the phone on one end, then

plug it into a main AC power socket with easy access to the other end.

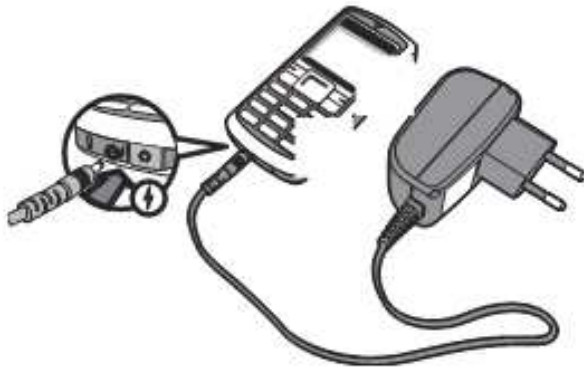

2. The battery symbol indicates the state of charge:

- During charging the 4 charge indicators scroll; it takes around 2.30 hours to fully recharge your mobile phone.
- When all 4 bars are steady the battery is fully charged and you can disconnect the charger. Depending on the network and condition of use, talk time goes from 2 to 4 hours and standby time from 200 to 300 hours.

Keeping the charger plugged into the mobile when the battery is fully charged doesn't damage the battery. The only way to turn off the charger is to unplug it, so use an easily accessible AC power socket. You can connect the charger to an IT supply (Belgium only).

2 • Main features

Access and view the phonebook

In idle mode, press *****. Depending on the selected phonebook (in SIM or in phone, see page 8), the content that appears on the screen may vary.

To view the phonebook during a call, press *****, and select **Names List**. Press **c** twice to return to the in-call screen.

In the phonebook, select **<Search>**, enter the first letters of the name you are searching, and press *****, to go directly to that name.

To read your own mobile phone number, select **Own number > Show**.

Make a call

1. In idle mode, enter the phone number using the keypad. To correct an error, press **c**.

2. Press **(** to dial the number and press **)** to hang up.

For an international call, press and hold ***** to enter the "+" sign instead of the usual international

prefix. For details on how to handle several calls (operator-dependent), see page 28.

Answer and end a call

When receiving a call, the number of the caller may be displayed. If the number is stored in the phonebook, the corresponding name is displayed instead of the number.

1. To answer the call, press *****.
2. To reject the call, press **)**. If you have activated Call forward (see page 24), the call is diverted to a number or voice mail.
3. To hang up, press **)**.

~~If you have selected Any Key Answer (see page 25), you can accept a call by pressing any key (except **)**).~~

Adjust the earpiece volume

During a call, press **+** or **-** to increase or decrease the volume.

Mute/Unmute the microphone

You can mute the microphone so that your caller cannot hear you. During a call, press **,**, select **Mute** and press, again. To unmute the

microphone, press , , select **Unmute** and confirm by pressing ,.

Change the ringer

Select **Settings** > **Sounds** > **Ringtone**, press , and move+or- to select a ringer. Press , to confirm.

Activate the vibra alert

If you want your phone to vibrate when you receive a call, activate the vibra alert by selecting **Settings** > **Sounds** > **Vibra alert**, then **On** or **Off**.

The vibra alert is automatically set to **Off** when you plug the charger.

Quickly scroll a list

When browsing a list (of ringers, events, etc.), long press + or - to quickly scroll.

3 • Text or number entry

Text can be entered in editing screens in two different ways: by using T9® predictive text input, or basic text input. Two other modes for numbers and punctuation marks are also available. Icons appearing on the screen indicate the active text mode.

T9® Text input



Tegic Euro. Pat.
App. 0842463

T9® predictive Text Input is an intelligent editing mode for messages including a comprehensive dictionary. It allows you to quickly enter text. Press only once on the key corresponding to each letter needed to spell a word:

keystrokes input are analysed and the word suggested by T9® is displayed in the edit screen. If several words are available according to the keys used, the word you entered is highlighted: press < or > to browse the list and to choose from those proposed by the T9® built-in dictionary (see example below).

How to use it

Alphabets and symbols represented by each key are as follows:

2to 9 To key in letters.

< or > To browse the list of candidate words.

,or 1 To confirm entry.

c Short press to clear one entry, long press to clear all text.

0 Shift from Standard, to lower, to UPPER case.

* Shift from T9® to basic mode, to numeric mode.

Shift to symbols and punctuation mode. Press > to display other pages.

Example: how to enter the word "home":

1.Press 4 6 6 3

The screen displays the first word of a list: **Good**.

2.Press>to scroll and select **Home**.

3.Press , or 1 to confirm selection of the word **Home**.

Basic text input

If you wish to access the basic text input, press *. This method requires multiple key presses to reach the desired character: the letter "h" is the second letter on the 4 key, so you must press it twice to enter "h".

Example: how to enter the word "home":

Press 4, 4 (GHI) 6, 6, 6 (MNO),
6 (MNO), 3, 3 (DEF). Press , when
the message is completed.

Letters, numbers and symbols are located on each key as follows:

Short press	Long press
1space ' . , ! ? " @	1
2a b c 2 à ä å æ ç	2
3d e f 3 é è - √	3
4g h i 4 ø ì	4
5j k l 5 ¸	5
6m n o 6 ñ ò ó	6
7p q r s 7 ® ∠ ∪ ©	7
8t u v 8 ü ù	8
9w x y z 9 ø & € ¬	9
0Shift letter case	0

4 • Contacts

Contacts are stored in one of the two available phonebooks: in your SIM card (number of entries depending on capacity) or in your phone (up to 99 names). When entering new names, they will only be added to the selected phonebook.

99 is the maximum number of name cards, provided that other features (sounds, pictures, etc.) are not using a significant amount of the phone's memory.

Settings

Contacts select

Press + or - to select a phonebook, **In SIM card** or **In phone**. Contacts added to the selected phonebook can then be copied into the other, via **Copy to SIM** or **Copy to phone** options.

Your phone only manages one phonebook at a time and will ignore the information relative to the other one e.g. if "Smith" is present in both phonebooks and if you delete it in the phone, it remains unchanged in the SIM.

Delete all

To delete all contacts at once. This option only applies to the phonebook in phone, NOT to the SIM phonebook.

Copy to phone

If you cancelled or aborted the automatic copy of your SIM phonebook at first switch, you can do it manually with this option.

Copy to phone will copy the content of your SIM card into your phone. Selecting this option twice will duplicate all the names.

Groups settings

Allows you to manage groups, rename them and link a specific melody and picture to each group. See "Fotocall: See & hear who's calling" page 9.

Add contacts to a phonebook

Contacts will be added to the selected phonebook.

In the SIM phonebook

1. Press when in idle mode and select **<New>**.
2. Enter the name and the number of your choice, then the type of number (**Phone**, **Fax** or **Data**)

and press , to store this name in your phonebook.

A number is limited to 40 digits, depending on your SIM card. Entering international prefix, country & area codes allows you to dial a number from any location.

In the phone phonebook

1. Press when in idle mode and select <New>.

Enter the first, then last name (up to 20 latin characters); one of the two fields can be empty, but not both.

2. Then select the **Number type**. Numeric fields can hold up to 40 digits and one "+" sign and alphanumeric fields feature up to 50 latin characters. Each contact can feature a maximum of 5 numeric fields (e.g. 2 mobile numbers, 3 work numbers, an e-mail address and a text note).

3. If needed, choose the group you want this contact to belong to.

Own numbers

The **Own numbers** item that appears in the names list should contain your own phone number. If not, we

advise that you enter your mobile number as well as any other relevant information.

Although all its fields can be empty, the **Own numbers** item cannot be deleted.

Emergency number

The emergency number will call the emergency services number in your country. In most cases, you can call this number even if you haven't yet entered your PIN.

In Europe the standard emergency number is 112, in the UK it is 999.

Fotocall. See & hear who's calling

This feature is available ONLY when you select the phonebook in phone.

This feature allows you to personalize the groups available with a name ("Friends", "Office", etc.), a given picture and a given melody. One or several names can be linked to a group. When a name in that group calls, it will appear along with the corresponding picture, and the melody defined for that group will ring.

1. In **Contacts > Settings > Groups setting**, select a group to be identified.
2. Rename the group and select the **Melody** and the **Picture** to be associated to this group.
3. Back to idle mode, press - to access the phonebook. Select a contact you wish to link to this group, then choose **Select group** and select the group of your choice.

Edit and manage contacts

Press-when in idle mode to access the **Contacts** you have stored. To search for a given name:

2 to 9 Press the key for the letter that you want to go to in the list (e.g. press 8 twice to access the letter "U"). The first record starting with this letter is selected.

Or press #, enter the first letters of the name you are searching, and press , to access directly to that name.

In the SIM card phonebook

Choose a contact in the SIM card phonebook and press , to access the following options:

- Call
- Flash dial
- Delete
- Send SMS
- Copy to phone
- Change

In the phone phonebook

Choose a contact in the phone phonebook and press , to access the following options:

- Call
- Change name
- Delete
- Send SMS
- Select group
- Show

Select **Show** to access the list of all numbers or fields saved for this contact then **<New>** to create a new field for this contact. Select one of the fields and press , to access a second set of options, which are:

Make default The first number you enter becomes the default number. This option allows you to make another number default.

Copy to SIM card To copy a contact from your phone phonebook into the SIM card.

Show	To display the details of the selected field.
Change type	To change or to define the field type of the selected number.

Alphanumeric fields can only be changed or deleted.

5 • Settings

This menu allows you to customise your phone and change the settings related to each available option (sounds, time and date, security, etc.).

Sounds

Ringer volume

Press +or -to select the volume of your ringer from **Silent** to **Increasing**.

This setting also applies to the messages ringer.

Ringtone

Allows you to select a ringer. The list also includes melodies you saved. Scroll through the list and wait to hear the selected melody being played.

You will not hear the melody if the volume ringer is set to **Silence**.

Vibra alert

Allows you to set the vibra alert **On** or **Off** when receiving a call, when you receive a message or when the alarm rings.

The vibra alert is always **Off** when you connect the charger or the Cigarette Lighter Adapter.

Battery alert

Allows you to switch **On** or **Off** the alert that indicates when the battery is running low.

Minute alert

Allows you to switch **On** or **Off** a beep alert that sounds every minute during a call to help you manage the duration of your call.

For alerts, the menu only allows you to set the alert sounds **On** or **Off**, NOT the alert themselves.

Key tones

Allows you to switch the key tones **On** or **Off**. **Messages ringer**

Allows you to switch **On** or **Off** an alert for each time you receive a new message. When **On**, this option allows you to select the alert from the ringers list.

Display

Screen saver

When **On**, it will run a slide show in idle mode, by using the JPEG file(s) you have stored in your phone

and selected. Use > to select the pictures of your choice, then press , to activate the screen saver.

Economic mode

When **On**, this mode displays the current time on a background when the phone is in idle. It increases battery life.

Backlight

Backlight is activated when receiving incoming calls or messages, browsing menus, etc. Select one of the available values.

Deactivating this function increases battery life.

Wallpaper

Allows you to set the wallpaper display on the main screen **On** or **Off** in idle mode.

Only JPEG type pictures can be used as wallpapers.

Contrast

Allows you to choose from several levels of contrast.

Hotkeys

Allows you to set up a direct access to a specific function or a contact (**Flash dial**) by linking it to a key.

Hotkeys are configured by default, e.g. 6 for Silence, but you can reprogram them (keys from 2 to 9 only). The following hotkeys are locked: 1 (call voice mailbox) and * (dial international call). Depending on your service provider, other hotkeys may be predefined and locked.

Select a key from 2 to 9 and press ,. Browse the list to select the function you wish to associate with this key and press ,. To use the hotkeys, press and hold the programmed key while in idle mode.

If the selected key is already set, you can reprogram it by pressing , twice and selecting **Change**. This will bring you to the list of available functions. If you select **Flash dial**, you will be asked to select a contact in the name list.

Time and date

Clock display

Allows you to select **Analogue**, **Digital**, **Tiny digital** or **No clock** time formats when shown in idle mode.

Set time

Allows you to set the time by pressing the appropriate numeric keys. You can also use +/-to increase or decrease the time minute by minute.

Set date

Allows you to set the date by pressing the appropriate numeric keys. You can also use +/-to set the date.

Language

Allows you to select a language for all menu texts. Press+/-to select a language then , to confirm.

Security

PIN protection

The PIN protection can be set **On** or **Off**. When **On**, you will be asked to enter your PIN code when switching your phone on. Depending on your SIM card, some features or options may require a PIN2 secret code, given to you by your operator.

You cannot change your PIN code if this option is Off.

Change codes

Allows you to change your **PIN** and **PIN 2** codes.

If you enter an incorrect PIN2 code 3 times, your SIM card is blocked. To unblock it, request the PUK2 code from your operator or retailer. If you enter an incorrect PUK code 10 times in a row, the SIM card will be blocked and unusable. If this happens, contact your operator or retailer.

Public names

Allows you to manage a specific names list, called **Public Names** list, and restrict calls to this list via the **Call restriction** option.

This function is subscription dependent and requires a PIN2 code. This option might also apply to WAP.

Public names Allows you to create, edit and modify your **Public Names** list. via a PIN2 code.

Call restriction Allows you to restrict the calls to the **Public Names** list. In this case, you can only access the names of the **Public names** list, as opposed to the **Contacts** of the main menu.

Call barring

Network dependent. This requires a specific call barring password supplied by your service provider.

Allows you to limit the use of your phone to specific calls by letting you bar both **Outgoing** and **Incoming** calls. In all cases, the **Cancel** option of these menus applies to all calls at once. The **Status** menu allows you to know whether a type of call is barred or not.

Keypad lock

Allows you to set a delayed automatic keypad lock in idle. The keypad unlocks when receiving a call or when placing an emergency call. Long press **C** to unlock the keypad.

In idle, long press **C** to lock/unlock the keypad manually.

Network

Register again

Provides you with a list of the networks available in the area when the **Manual** mode is selected. Select the network you want to register with and press **,**.

Preferred list

Allows you to build a network list in order of preference. Once defined, the phone will try to register on a network, according to your preferences.

Access settings

This menu allows you to create several data profiles: when using WAP, the selected profile will be used to connect to the network.

Options described below are operator and/or subscription dependent. Error messages during connections are mainly due to incorrect parameters: contact your operator before first use, in order to have the appropriate settings, which you may receive by SMS in some cases. Some pre-configured profiles might be locked, preventing re-programming and renaming.

Select an item in the list and press **,** to access the following options:

- | | |
|--------------------|--|
| Change name | To rename the selected profile. |
| Show | To visualise all parameters of the selected profile. |

GSM Settings

To change the GSM settings:
Login, **Password**, **Phone number** needed to establish the connection and provided by your operator, **Inactivity time** (a value of over 30 seconds after which the phone disconnects automatically if a connection was in progress).

6 • Messages

SMS

This menu allows you to send short messages (SMS) with sounds, animations or pictures, as well as manage the ones you receive.

Send SMS

This menu allows you to send an SMS to one or several contacts.

1. Choose from three different types of messages:

- <New>** To write a new message.
- Last message** To edit, modify and re-send the last message.
- Template** To select a pre-configured message, such as **Can you ring me back at this number.** including your number, if it is the first one of the **Own num.** option (see page 9).

2. Enter your text then press , to access the next options:

- Save** To store the current message in the **Archive** menu.
- Send** To validate the message and select the recipient(s) of the message.
- Add sound** To attach a melody.
- Add graphic** To attach a bitmap image or an animation.

You can send up to 2 attachments of 2 different types together with your SMS. Animations and pictures are exclusive: if you first select an animation, then a picture, only the picture will be taken into account and vice-versa.

~~Some pre-defined items are supplied as standard with your mobile phone. Personal pictures and sounds cannot be sent when they are copyright protected.~~

- 3. Choose a recipient in the names list. Select **<Add contacts>** to add other recipient(s). When selecting a recipient in the mailing list, you can remove it from the list or edit the number.
- 4. Select **Send now** to send the message.

Outbox

When the **Auto Save SMS** option is **On** (see page 18), messages you sent are stored in this menu.

Inbox

This menu allows you to read your SMS. The number indicates the number of unread message(s). When a message is displayed, press , to access the following options:

Delete all To delete all the messages at once.

Delete To delete the selected message.

Move to archive To store messages in the phone memory. You can then consult them in **SMS > Archive**.

Moving a message to the archive list deletes it from the read SMS list.

Reply To reply to the sender.

Forward to To edit and forward the selected message.

Attachments cannot be forwarded.

Store number To save the number of the sender if it is attached to the message.

Call back To call the sender of the message (operator- dependent).

No. extracted To extract a number included in the message itself, if this number is included in double quotes (several numbers can be included and extracted).

SMS settings

This menu allows you to customise your SMS via the following options:

SMS To select your default SMS centre. If **centre** not available on your SIM card, you must enter your SMS centre number.

Signature To add a signature at the end of your message. You can **Edit**, **Change** or **Save** the signature.

Validity period To select the length of time your message is to be stored in your SMS centre.

This feature is subscription dependent.

Delivery report

When **On**, this option will inform you via SMS whether your own SMS was received or not.

This feature is subscription dependent.

Auto save SMS

When **On**, this option will automatically save messages sent in the **Outbox** menu.

Archive

This menu allows you to consult all stored messages in the phone's memory. Select a message, then press , to access to the following options: **Delete** the selected message, **Delete all** messages at once, **Reply Forward**, **Call back**, **Store number** **Extract number**.

Broadcast SMS

This feature is network dependent.

This menu allows you to manage the reception of SMS broadcasts regularly transmitted to all subscribers on the network. Please contact your operator for details.

SMS chat

This menu allows you to set the **SMS chat** feature **On** or **Off**. When **On**, any SMS you receive is automatically displayed in idle mode.

Scroll down to read it, and quickly reply by pressing , twice: first to enter the editing screen, then to send your message. The phone will automatically go back to the idle screen.

If you receive a second SMS while you are reading one, reply to the first one or press **c** to exit. The mobile phone will then display the second message.

7 • Multimedia

Sound album

This menu allows you to manage and listen to the sounds stored in your mobile phone. Select a sound and press **>**, to access the following options:

Delete all To delete all sounds at once.
Copyright protected melodies cannot be deleted.

Delete To delete the selected sound.

Set as ringer To set the selected sound as **Ringer**.

Set as SMS ringer To set the selected sound as **Messages ringer** (this option must be set **On**, see page 12).

Rename To rename the selected sound.

The **Download new** option gives you access to a WAP page where you can download sounds (operator dependent).

Picture album

JPEG pictures must have the correct size and format for your mobile phone to store and display them correctly (max 640 x 640 pixels).

This menu allows you to manage and display the pictures stored in your mobile phone. To access the graphical display, select a picture in the list and press **>**. Press **>**, to access the following options:

Delete all To delete all pictures at once.
Copyright protected pictures cannot be deleted.

Delete To **Delete** the selected picture. **Rename** To **Rename** the selected picture.

Set as wallpaper To set the selected picture as wallpaper (this option must be set **On**, see page 13).

The **Download new** option gives you access to a WAP page where you can download pictures (operator dependent).

If there isn't enough space to store a new picture, you must delete some other pictures to release memory.

Memory status

This menu allows you to display the percentage of memory available in your phone. Several features share the mobile capacity: pictures and sound albums, archive messages, phonebook entries, etc.

Press **[F5]**, to check the general memory status (in Kilobytes, KB). Press **[F6]**, again to access the detailed list of memory used by each feature.

If "List full" appears when saving a new item or to free memory space, you must delete an item to be able to create or add a new one.



8 • Games & Applications

Calculator

This menu provides the following functions:

Addition Press * once or press >.

Subtraction Press * twice or press <.

Multiplication Press * 3 times or press +.

Division Press * 4 times or press -.

Equals Press # or ,.

Enter the figures using the keypad. Calculator accuracy is to 2 decimal places and is rounded up to the higher decimal figure. Press and hold 0 to get the decimal point.

Alarm clock

This menu allows you to set the alarm clock (up to 3 alarms). Select an alarm clock and press + or - to set it **On** or **Off**. When set to **On**, enter the time and press ,, select the frequency (**Once**, **Every day**, **On weekdays**) and press ,. Then select a melody in the list.

The alarm clock will ring even if you turned off your phone, and even if the Ringer volume is set to **Silence**. Press any key to stop the alarm ringing.

Snooze mode

This menu allows you to set the snooze mode **On** or **Off**.

The setting applies to all the alarms.

When the alarm rings and the snooze mode is **On**, press any key (except ,) to stop the ringing temporarily or wait till the ringing time is out. The alarm will ring again around 7 minutes later. To stop the alarm repetition, long press , .

The snooze mode is automatically deactivated after 9 alarm repetitions.

Euro converter

These menus allow you to convert a sum from or into Euros by entering the amount and pressing ,.

The currency used for the conversion is determined by the country where you have subscribed. The Euro converter is available upon subscription and only in countries using the Euro.

Games

Your phone is supplied with 3 games: Brick, Snake and Master mind.

Brick

Goal: destroy the bricks by hitting them with a ball.

4/ 6 To move the racket left or right.

To throw the ball.

0 To pause/resume the game.

Snake

Goal: feed the snake without it touching the wall.

1 / 7 To move the snake up, down or left.

3 / 9 To move the snake up, down or right.

0 To pause/resume the game.

Master mind

Goal: find the correct combination.

1- 8 To enter symbols.

,To validate the combination.

To change the difficulty level or to start a new game.

0 To pause/resume the game.

9 • Call information

Call settings

This menu allows you to set all the call options (call forward, waiting, etc.).

Call forward

To divert incoming calls to your mailbox or to a number (whether in your [Contacts](#) or not) and applies to [Data calls](#), [Voice calls](#) and [Fax calls](#).

Before activating this option, you must enter your voice mailbox numbers (see below). This feature is subscription dependent, and different from the call transfer, which takes place when one/several calls are in progress.

Unconditional

Will divert all the incoming calls.

[Warning!](#) When selecting this option, you will not receive any calls at all until you deactivate it.

If busy

If no reply

If unreachable

Allows you to choose in which circumstance you want to divert incoming calls.

Conditional

Will divert the incoming calls in all above circumstances.

Status

Will display the status of all call forwarding.

Mailboxes

To enter your voice mailbox numbers (if not available on your SIM card).

[In some cases](#), you might have to enter two numbers: one to listen to your mailbox, the other one to forward calls. [Contact your operator](#) for more information on this subject.

Auto redial

To set the auto redial [On](#) or [Off](#). When [On](#) if the person you are calling is busy, your phone automatically redials this number until a successful connection is made or until the maximum number of attempts is reached (10).

[The time between redials increases with each attempt.](#)

Any key answer

When this option is active, you can accept a call by pressing any key, except ***** (which is used to reject a call).

Call waiting

When this option is active, you hear a beep if someone tries to call you while already on a call. Select the **Status** option to check whether the call waiting is active or not.

This function is subscription dependent. Contact your operator.

Caller ID

To **Show** or **Hide** your identity to your correspondent. The **Status** option will inform you if this function is activated or not.

Call list

This menu provides you with the list of outgoing and incoming calls and call details.

Select an item and press *****, to consult the date, time, number and call status. If the number is stored in the selected phonebook, the corresponding name is displayed.

Press *****, again to access the options: **Delete all** to reset the list, **Call back** this correspondent, **Send a SMS**, **Delete** the selected call or **Store** the number (if not already in your phonebook).

Counters

This menu allows you to handle the duration of your incoming and outgoing calls.

Most options mentioned below are subscription dependent.

Total duration

To display the duration of calls since last reset.

Reset

To reset the outgoing and incoming call counters.

10 • Operator

Most items of this menu are subscription dependent and specific to operators. Consequently, the menus shown following may or may not be available.

Contact your network operator for details.

The services provided may involve making a phone call or sending a SMS for which you may be charged.

WAP

This menu allows you to access services supplied with your network, such as news, sports, weather, etc.

Your mobile phone may have been pre-configured. If not, settings can be configured "over the air", via the club Zonda website. Connect to www.club.Zonda.com then select your country. Note that this service isn't available if your country and/or mobile doesn't appear in the list. In this case, contact your operator for information.

To launch a WAP session, press **,** and select **WAP > Homepage**.

Move **+** or **-** To browse the on-line pages.

Press **,**

To select a highlighted item.

Press **c**

To return to the previous page. To end the WAP session.

Press and hold **c**

You can also select **Options > Exit** and press **,**.

Your mobile phone connects to the network according to the **Access settings** you have defined in the menu **Settings > Network** (see page 15). In case of a connection error, the screen displays "Go to menu": press **(** to go to the WAP options.

Homepage

This is the link to the first WAP site you access when launching a WAP session. In most cases, this menu item is preconfigured and will connect to your operator's WAP homepage. To change this default homepage see "Settings" page 27.

Bookmarks

This menu allows you to store your favourite WAP site addresses, rename them and access them quickly from the list.

Press (while browsing, then select **Bookmarks**: the Name and URL fields will be automatically filled in with the information of the page you are browsing.

Select **Add bookmark** and start entering the new name for the edit screen to appear. Press ,, then proceed the same way to enter the URL address.

The **Manage bookmarks** menu allows you to **Delete** or **Edit** the selected bookmark.

Go to URL

This menu allows you to enter a WAP site address, to which you connect directly when selecting it (a quick way to access WAP addresses without saving them as bookmarks).

All the addresses you enter in this menu and connect to at least once will appear in a list. Select one of the items and press , to reconnect to the corresponding page, without having to re-enter its complete address.

Settings

Select profile

To select one of the available profiles, then define the connection settings for each of them (press </> to select / deselect).

All connection settings described below apply to the selected profile.

Connection

Homepage allows you to change the name and address (start entering the new name for the edit screen to appear).

Select connection allows you to select one of the data profiles you have defined in **Settings > Access settings** (see page 15).

Proxy address and **Proxy port** allow you to define a gateway address and port number to be used when launching a WAP connection using the selected profile.

Push inbox

This menu allows you to read and manage messages automatically sent to you by the network and / or by your operator. Push messages may include URL for

quick access to WAP services: press *****, to connect to the WAP site.

If your push inbox is full, a message will ask you to delete some messages in **WAP > Push Inbox**.

Options

While browsing, press the **(** key to access:

Homepage To access the homepage of the WAP site you are browsing.

Back To go back to the previous page.

Forward To go to the next page.

Refresh To reload the currently browsed page from its original server.

Set as homepage To save the currently browsed WAP page as the default homepage.

Save as... To save images embedded in the pages that are displayed in the **Picture album**.

Exit To end a WAP session.

Handling several calls

Subscription dependent.

Making a second call

When you are in an active call, you can dial a number (or select a contact in the phonebook) and press *****. The first call is put on hold and the second number is dialled. Then press *****, to access the following options:

- **Switch calls** to toggle between calls.
- **Transfer** to connect the two calls. You are disconnected when the transfer is completed.
- **Conference** to introduce the caller into a conference call.
- **End call** to hang up the active line.

You can also use **<** and **>** to toggle between calls.

Answering a second call

When you receive a second call while already in communication, the phone emits a beep alert and the screen displays **Call waiting**. You can then:

- Press (To answer the call (the first one is put on hold). Then press , and select:
- **Switch calls** to toggle between calls,
 - **Conference** to introduce the new caller into a conference call.

Press) To reject the call.

Press, To select **End call** to end the current call, then answer the incoming call.

To receive a second call, you must have deactivated the **Call forward** for voice calls (see page 24) and activated the **Call waiting** (see page 25).

Conference call

A conference call allows you to speak with up to 5 callers at the same time.

1. Make a first call, then a second one .
2. Press , and select **Conference**.
3. Repeat the process until 5 callers are connected.
4. Select **Remove party** to disconnect a caller of the conference, or select **Private call** to have a private call with this caller only (other callers are put on hold).
5. Press) to disconnect all calls at once.

If there is an incoming call during the conference call and there are less than 5 callers, you can accept this new call and add this member to the conference call (if 5 callers are already connected, you can answer the call, but cannot add it to the conference).

Icons & symbols

In idle mode, several symbols can be displayed simultaneously on the screen.

If the network symbol isn't displayed, the network is not currently available. You may be in a bad reception area, moving to a different location may help.

Silence - Your phone will not ring when receiving a call.

Vibra - Your phone will vibrate when receiving a call.

SMS message - You have received a new message.

Voice mail - You have received a new voice mail.

Battery - The bars indicate the battery level (4 bars = full, 1 bar = low).

Alarm clock activated.

Keypad lock activated.

Roaming - Displayed when your phone is registered to a network other than your own (especially when you're abroad).

SMS full - Memory for messages is full. Delete old messages to receive new ones.

Call Forward Unconditional to number - All your incoming voice calls are being forwarded to a number other than voice mail.

Call Forward to voice mailbox - All your calls are being forwarded to voice mail.

Home zone - A zone designated by your network operator. Subscription dependent, contact your service provider for details.

GSM Network: your phone is connected to a GSM network

Reception quality: the more bars are shown the better the reception is.

SMS Chat - option is set to **On**

Memory full - The phone's memory is full. Delete items to store new ones.

WAP message - You have received a message in the WAP push inbox.

Precautions

Radio waves



Your cellular mobile phone is a low power radio transmitter and receiver. When it is operating, it sends and receives radio waves. The radio waves carry your voice or data signal to a base station that is connected to the telephone network. The network controls the power at which the phone transmits. • Your phone transmits/receives radio waves in the GSM frequency (900 /1800MHz).

- The GSM network controls transmission power (0.01 to 2 watts).
- Your phone complies with all relevant safety standards. • The CE mark on your phone shows compliancy with European electromagnetic compatibility (Ref. 89/336/EEC) and low voltage directives (Ref. 73/23/EEC). Your cellular mobile phone is your responsibility. To avoid damage to yourself, to others or to the phone itself, read and follow all the safety instructions and make them known to anyone borrowing your phone. Furthermore to prevent unauthorised use of your phone:



Keep your phone in a safe place and keep it out of small children's reach.
Avoid writing down your PIN code. Try to remember it instead.

Switch off the phone and remove the battery if you are going to leave it unused for a long time.
Use the **Security** menu to change the PIN code after purchasing the phone and to activate call restriction options.



The design of your phone complies with all applicable laws and regulations. However your phone may cause interference with other electronic devices. Consequently you should follow all local recommendations and regulations when using your cellular phone both at home and when away. Regulations on the use of cellular phones in vehicles and aircraft are particularly stringent. Public concern has been focused for some time on the possible health risks for users of cellular phones. The current research on radio wave technology, including the GSM technology, has been reviewed and safety standards have been drawn up to ensure protection from exposure to radio wave energy. Your cellular telephone complies with all applicable safety standards and the Radio Equipment and Telecommunications Terminal Equipment Directive 1999/5/EC.

Always switch on your phone

Inadequately protected or sensitive electronic equipment may be affected by radio energy. This interference can lead to accidents.



Before boarding an aircraft and/or when packing the phone in your luggage: the use of mobile phones in an aircraft may be dangerous for the operation of the aircraft, disrupt the mobile phones network and may be illegal.



In hospitals, clinics, other health care centres and anywhere else where you may be in the close vicinity of medical equipment.



In areas with a potentially explosive atmosphere (e.g. petrol stations and also areas where the air contains dust particles, such as metal powders).

In a vehicle transporting flammable products (even if the vehicle is parked) or a vehicle powered by liquefied petroleum gas (LPG), check first that the vehicle complies with the applicable safety rules.

In areas where you are requested to turn off radio transmitting devices, such as quarries or other areas where blasting operations are in progress.



Check with the vehicle manufacturer that electronic equipment used in your vehicle will not be affected by radio energy.

Users of pacemakers

If you are a user of a pacemaker:

- Always keep the phone more than 15 cm from your pacemaker when the phone is switched on, in order to avoid potential interference.
- Do not carry the phone in a breastpocket.
- Use the ear opposite to the pacemaker to minimise the potential interference.
- Switch off your phone if you suspect that interference is taking place.

Users of hearing aids

If you are a user of a hearing aid, consult your physician and hearing aid manufacturer to learn whether your particular device is susceptible to cellular phone interference.

Performance improvement

In order to improve the performance of your phone, reduce radio energy emission, reduce battery consumption and ensure safe operation adhere to the following guidelines:



For the optimal and satisfactory operation of the phone you are recommended to use the phone in the normal operating position (when not using in hands-free mode or with a hands-free accessory).

- Do not expose your phone to extreme temperatures. • Treat the phone with care. Any misuse will void the International Guarantee.
- Do not immerse the phone in any liquid; if your phone is damp, switch it off, remove the battery and let them dry for 24hrs before using them again.
- To clean the phone, wipe it with a soft cloth. • Placing and receiving calls consumes the same amount of battery energy. However, the mobile consumes less energy in idle screen when kept in the same place. When in idle screen and while you are moving, your phone consumes energy to transmit updated location information to the network. Setting the backlight for a shorter period of time as well as avoiding unnecessary navigating in the menus will also help to save the battery's energy for longer phoning and stand-by performances.

Information displayed on the battery

- Your phone is powered by a rechargeable battery. • Use specified charger only.
- Do not incinerate.

- Do not deform or open the battery.
- Do not allow metal objects (such as keys in your pocket) to short circuit the battery contacts.
- Avoid exposure to excessive heat (>60°C or 140°F), moisture or caustic environments.



You should only use Zonda Authentic Accessories, as the use of any other accessories may damage your phone and will make all guarantees for your Zonda phone null and void.

Make sure damaged parts are replaced immediately by a qualified technician and that they are replaced with genuine Zonda replacement parts.

Do not use your phone while driving



It lowers concentration, which can be dangerous. Adhere to the following guidelines: Give your full attention to driving. Pull off the road and park before using the phone. Respect the local regulations in countries where you drive and use your GSM phone. If you want to use your phone in a vehicle, install the hands-free car kit which is designed for that purpose, still ensuring you give full attention to driving. Ensure that your phone and car kit do not block any air bags or other security devices fitted in your car. The use of an alarm system to operate a vehicle's light or horn to indicate incoming phone calls is prohibited on public roads in some countries. Check local regulations.

EN 60950 Norm

In case of hot weather or after a prolonged exposure to the sun (e.g. behind a window or a windscreen), the temperature of your phone's casing might increase, especially when featuring a metallic finish. Be very careful in this case when picking up your phone and also avoid using it with an ambient temperature over 40°C.

Environmental care



Remember to observe the local regulations regarding the disposal of your packaging materials, exhausted batteries and old phone and please promote their recycling.

Zonda has marked the battery and packaging with standard symbols designed to promote the recycling and appropriate disposal of your eventual waste.



The battery should not be disposed of with general household waste.



The labelled packaging material is recyclable.



A financial contribution has been made to the associated national packaging recovery and recycling system (e.g. EcoEmballage in France).

The materials are recyclable (also identifies the plastic material).

Troubleshooting

The phone does not switch on

Remove and reinstall the battery (see page 1). Make sure you plugged the jack of the charger into the correct connector (see page 2). Then charge the phone until the battery icon has stopped scrolling. Finally, unplug from the charger and try to switch the mobile on.

The display shows BLOCKED when you switch on

Somebody tried to use your phone but didn't know the PIN code nor the unblocking code (PUK). Contact your service provider.

The display shows IMSI failure

This problem is related to your subscription. Contact your operator.

The symbol is not displayed

The network connection is lost. Either you are in a radio shadow (in a tunnel or between tall buildings) or you are outside the network coverage area. Try from another place, try to reconnect to the network (especially when abroad), check that the antenna is in place if your mobile has an external antenna, or contact your network operator for assistance/information about the network.

The display doesn't respond (or the display responds slowly) to key presses

The display responds more slowly at very low temperatures. This is normal and does not affect the operation of the phone. Take the phone to a warmer place and try again. In other cases please contact your phone supplier.

Your phone doesn't return to the idle screen

Press and hold **C** or switch off the phone, check that the SIM card and the battery are installed correctly and switch it on again.

Your phone doesn't display the phone numbers of incoming calls

This feature is network and subscription dependent. If the network doesn't send the caller's number, the phone will display **Call 1** or **Withheld** instead. Contact your operator for detailed information on this subject.

You can't send text messages

Some networks don't allow message exchanges with other networks. First check that you entered the number of your SMS centre, or contact your operator for detailed information on this subject.

You can't receive and/or store JPEG pictures

A picture may not be accepted by your mobile phone if it is too large, if its name is too long, or if it doesn't have the correct file format.

During battery charge, the battery icon shows no bar and the outline is flashing

Only charge the battery in an environment where the temperature does not go below 0°C (32°F) or above 50°C (113°F). In other cases please contact your phone supplier.

The display shows SIM failure

Check that the SIM card has been inserted in the right position (see page 1). If the problem remains, your SIM card may be damaged. Contact your operator.

You have the feeling that you miss some calls

To receive all calls, make sure that none of the features "Conditional call forward" or "unconditional call forward" is activated (see page 24).

When attempting to use a feature in the menu, the mobile displays
NOT ALLOWED

The display shows
INSERT YOUR SIM CARD

The autonomy of your phone seems lower than indicated in the user guide

Some features are network dependent. They are only available, therefore, if the network or your subscription supports them. Contact your operator for detailed information on this subject.

Check that the SIM card has been inserted in the right position (see page 1). If the problem remains, your SIM card might be damaged. Contact your operator.

The autonomy is linked to your settings (e.g. ringer volume, backlight duration) and the features you use. To increase the autonomy, and whenever possible, you must deactivate features you do not use.

Your phone doesn't work well in your car

A car contains many metallic parts that absorb electromagnetic waves which can affect the phone's performances. A car kit is available to provide you with an external antenna and enables you to make and receive phone calls without handling the handset. Check with local authorities if you are allowed to use the phone whilst driving.

Your phone is not charging

Make sure you plugged the jack of the charger into the correct connector (see "Charge the battery" page 2). If your battery is completely flat, it might take several minutes of pre-charge (up to 5 in some cases) before the charging icon is displayed on the screen.

Zonda authentic accessories

Some accessories, such as a standard battery and a charger are included as standard in the package of your mobile phone. Other accessories might be sold in the commercial package (according to the operator or the retailer), or sold separately. As a consequence, the package content may vary.

To maximise the performance of your Zonda phone and not to void the warranty, always purchase Zonda Authentic Accessories that are specially designed for use with your phone. Zonda Consumer Electronics cannot be held liable for any damage due to use with non authorised accessories.

Charges your battery in any AC outlet. Small enough to carry in a briefcase/handbag.

Cigarette light adapter

Charges the battery and plugs into any vehicle power outlet.

Universal car kit

Designed to operate your Zonda mobile phone hands-free and easy to use, this compact hands-free solution offers a high audio quality.

Simply plug the kit into the vehicle auxiliary outlet.

In certain countries, telephoning whilst driving is prohibited. For safe and trouble free installation, we recommend that specialized technicians install hands free car kits.

Deluxe headset

In-line answer button offers you a simplified alternative to searching for the phone. Simply answer an incoming call by pressing the button.

