



AXI-TR5

Users quick guide

Requirements

You need

Car's lighter socket. Ipod or any portable device with 3.5mm audio channel

1. Unpacking



1 iPod FM Stereo Transmitter



1 Pc audio cable (3.5mm)



1 Users manual

IFM
FM transmitter

2. Connecting to iPod



Locate the iPod connector in your transmitter



Plug in the transmitter in your iPod

The transmitter will also recharge power for the same unit at the same time

3. Connecting to the car



Find the car's lighter socket



Plug in the transmitter in the lighter socket

4. Connecting to portable devices



Locate the 3.5mm audio jack for audio line-in



Plug in the 3.5mm cable in the jack



Connect the 3.5mm cable in your portable device

5. Tuning FM



Locate the tuning buttons on your transmitter



Tune the same frequency of the stereo car and the transmitter using the tuning buttons

You can only adjust the volume with the volume radio car

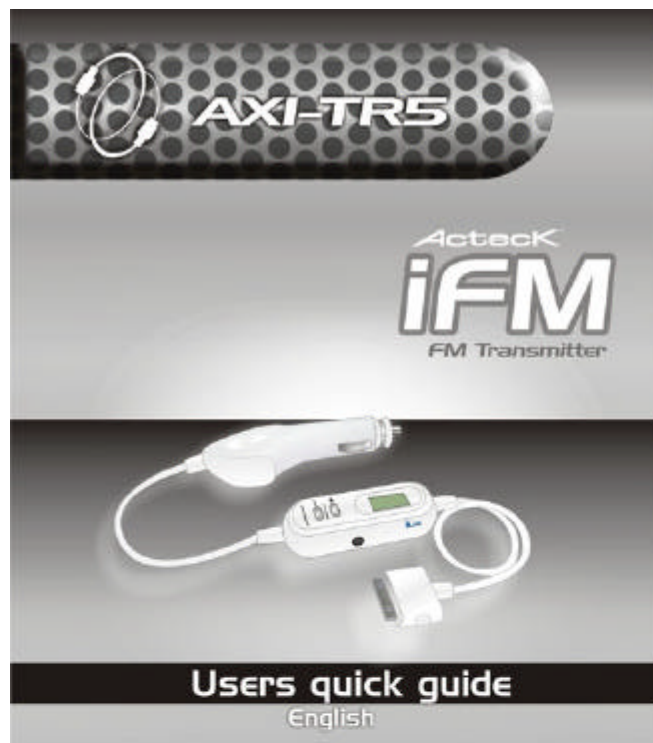

WELCOME

Thanks for choosing our product AXI-TR5, we hope you will enjoy the Acteck's iFM. We recommend you read this user manual carefully and put attention to the warnings and recommendations.

PACKAGE CONTENT

- 1 iPod FM Stereo Transmitter
- 1 Pc audio cable (3.5mm)
- 1 Users quick guide

CHARACTERISTICS

With the new Acteck iFM transmitter, you will be able to hear all of your iPod's playlist songs without the need of special adapters. Just plug in your transmitter on your vehicle's lighter and you'll be ready to dive into the world of digital music.

It has an LCD display, input button to select channels and 3.5mm audio Jack-in.

IMPORTANT NOTICE

Federal Communication Commission Interference Statement
This piece of equipment has been approved and is within the limits of the B digital class,
conforming to article 15 of the FCC rules.
These limits were designed to protect against any harmful interference on home installations.

This equipment can generate, use or emit radio frequencies, and if not installed in accordance to instructions it can cause harmful interference to radio communications. Nevertheless, there is no

warranty that interference will not occur on a particular installation.

Place receptor antenna again
Increase distance between system and receiver.
Connect system to a different energy circuit.
Ask for an expert's assistance.

This transmitter should not be placed near another antenna or transmitter.

This device conforms to section 15 of the FCC rules. This compels two conditions:

- (1) It is highly probable that this piece of equipment will not cause undesired interferences.
- (2) It can receive audio interferences, even of undesired frequencies.

Declaration of radiation exposition of the FCC:

This piece of equipment is based on the radiation exposition limits of the FCC for uncontrolled environments. To maintain good results, please avoid direct contact with antenna. All users should follow the specific use instructions.

This transmitter should not be placed near another antenna or transmitter.

FCC warning: All unapproved modifications can void user's warranty.

SAFETY NOTE

1. Your product complies with FCC and Rules
2. This product does not include parts that can be given maintenance by user.
3. Adjustment procedures or distinct use other than what is stated on the User's manual can cause dangerous results.

WARNINGS

All changes or modifications not approved by the system's distributor can void warranty.

FEATURES

- iPod FM stereo transmitter
- Built-in LCD Display
- Input button for channel select
- Memory frequency
- Built-in 3.5mm audio jack for audio line-in

TECHNICAL SPECIFICATIONS

- Input voltage: +12V / +24V
- Transmission frequency: 88.3MHz-107.7MHz, Step 100KHz
- Operating Temp -0 C- 70 C
- Storage Temp -20 C- 70 C
- Dimensions 77 mm(L) x 30 mm(W) x 17 mm(H)
- Weight 68g
- Audio Cable 3.5mm male to 3.5 mm male / 45mm

POWER CONSUMPTION

12-24V == 40-30mA

Buttons and connectors diagram

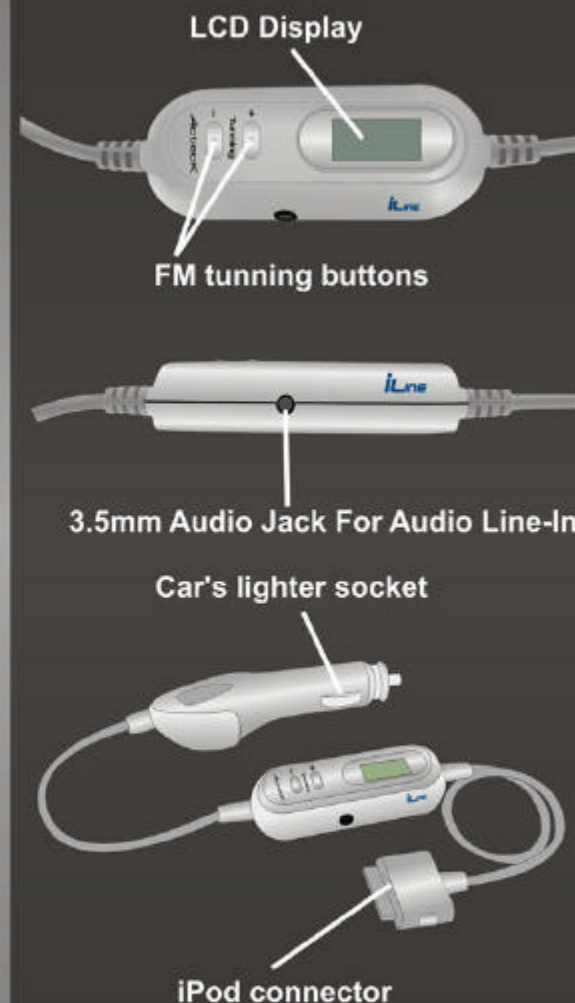

We want to know more about you. Send
All suggestions and comments to:
comentarios@acteck.com

If you have any doubts or questions
about our products visit our website:

www.acteck.com

Free technical support in Mexico
Mondays to Fridays from 9am to 7pm
Central time
01800 8130505

This device complies with part 15 of the FCC rules. Operation is subject to the following two conditions.

- 1) This device may not cause harmful interference, and
- 2) This device must accept any interference received, including interference that may cause undesired operation.

Per FCC 15.21, you are cautioned that changes or modifications not expressly approved by the party responsible for compliance could void the user's authority to operate the equipment.