

THE KEYS



KEY WITH REMOTE CONTROL



Metal insert A fig. 1 of the key operates:

- the ignition device;
- the door lock.

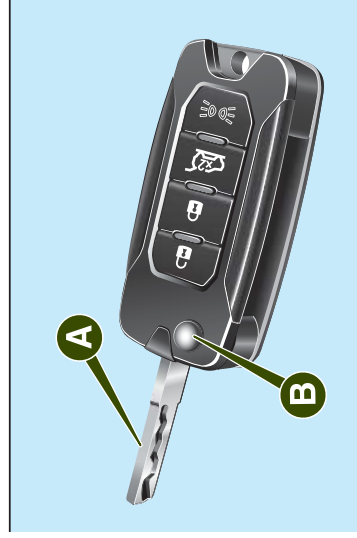

J0A0181C

Press button B to open/close the metal insert.

ELECTRONIC KEY

(versions with "Keyless Enter-N-Go" system)

On versions equipped with "Keyless Enter-N-Go" system, the vehicle features an electronic keyfig. 2, of which two copies are provided.



2

J0A0315C

Briefly press button **6** : unlocking of doors and luggage compartment, timed switching-on of internal lights and double flashing of direction indicators (where provided).

Briefly press button **7** : lock of doors and luggage compartment with roof lights off and single flash of direction indicators (where provided).

Press button **8** : remote opening of the luggage compartment (to open the luggage compartment press the button twice in quick succession).

Press button **9** : remote switching on of the main beam headlights, for a maximum of 90 seconds.

Pressing button **9** again or at the end of the 90 seconds, the lights switched on previously will go off (if the parking light function was already active it will remain so). If, when 90 seconds have passed, button **6** is pressed, the main beam headlights and the side lights will stay on for further 30 seconds.

REQUEST FOR ADDITIONAL KEYS

Should a new key with remote control or a new electronic key be necessary, go to a Jeep Dealership, taking an ID document and the vehicle ownership documents.



WARNING

1) Press button B only with the key away from your body, especially your eyes and from objects which could get damaged (e.g. your clothes). Do not leave the key unattended, to prevent people, especially children, from inadvertently pressing the button.

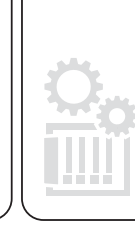
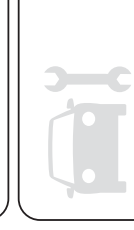
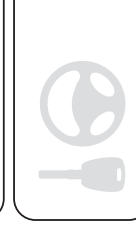
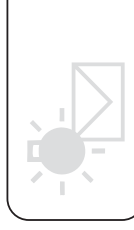

THE KEYS OPERATION

Unlocking door and luggage compartment

When the function is available, press and release the unlock button on the remote control once only to unlock the driver side front door or twice within 1 second to unlock all doors and the tailgate.

The current setting can be changed using the display menu or the Uconnect system, for the system to unlock the driver door only or all the doors the first time the button is pressed on the remote control.

The doors can always be unlocked by putting the metal insert inside the driver side door lock.

Locking door and luggage compartment

For vehicles with keys with remote control, if one or more doors are open, the doors will not be locked. This situation is indicated by a rapid flashing of the direction indicators (where provided). The doors will be locked if the tailgate is open however.

For vehicles with electronic keys, if one or more doors are open, the doors are locked and this is indicated by a rapid flashing of the direction indicators (where provided). The doors prepare for locking, which is active from the moment they are closed. The doors will unlock again only if the key presence is detected inside the passenger compartment.

Where the selection is available, the current setting can be changed using the display menu or the Uconnect system, so that the possibility of locking when one or more doors are open is permitted/inhibited by the system. The doors can always be locked by putting the metal insert inside the driver side door lock.

Opening the luggage compartment



Rapidly press the  button twice to open the luggage compartment remotely.

The direction indicators will flash twice to indicate that the luggage compartment has been opened.

Lights switching on (for key with remote control only)

Press button  : to remotely control the switching on of the side and main beam headlights, for a maximum of 90 seconds.

This is useful for example to find the vehicle easily in a crowded parking.

Pressing button  again or at the end of the 90 seconds, the lights switched on previously will go off (if the parking light function was already active it will remain so). If, when 90 seconds have passed, button  is pressed, the main beam headlights and the side lights will stay on for further 30 seconds.

REPLACING THE BATTERY IN THE KEY WITH REMOTE CONTROL

To replace the battery, proceed as follows:

- operate in the points indicated by the arrows using a fine bit screwdriver and remove cover A fig. 27;
- replace battery B using a new one with the same specifications, respecting its polarity;
- refit cover A, making sure it is correctly locked.



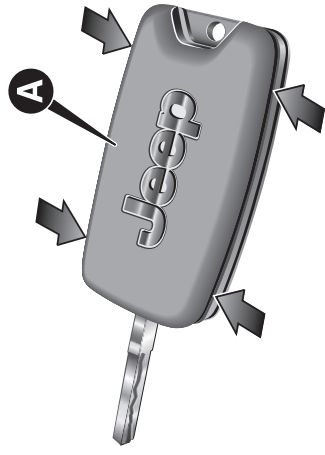

27

REPLACING THE ELECTRONIC KEY BATTERY

To replace the battery, proceed as follows:

- extract the metal insert in the electronic key (see description above);

J0A0246

- gently introduce the end of the metal insert in the housing A fig. 28 of the key in order to separate its two parts (as an alternative to the metal insert, it is possible to use the flat part of the screwdriver supplied with the car);

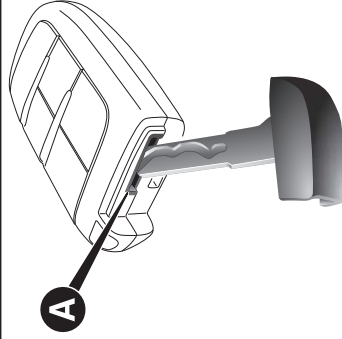

28

J0A0039

- remove the battery B fig. 29 (CR2032 type);
- insert a new battery, making sure that the polarity is correct;
- refit the two parts of the electronic key, ensuring that they are locked correctly;
- reinsert the metal insert in the key.

REQUEST FOR ADDITIONAL KEYS

Key with remote control

The system can recognise up to 8 keys with remote control.

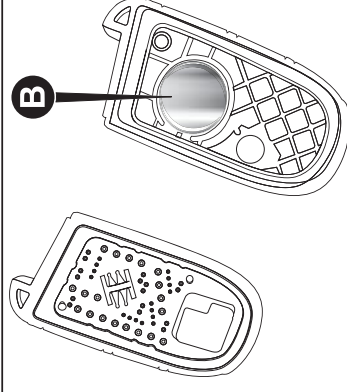

29

J0A0036

Electronic key

To guarantee that the engine starts and the vehicle operates correctly, use only electronic keys specifically coded for the vehicle's electronics. If an electronic key is coded for a vehicle, it cannot be used on any other vehicle.

FCC REGULATORY NOTICES

Modification statement Magneti Marelli has not approved any changes or modifications to this device by the user. Any changes or modifications could void the user's authority to operate the equipment.

Interference statement This device complies with Part 15 of the FCC Rules.

Operation is subject to the following two conditions: (1) this device may not cause interference, and (2) this device must accept any interference, including interference that may cause undesired operation of the device.

Radiation exposure statement This device complies with FCC radiation exposure limits set forth for an uncontrolled environment and meets the FCC radio frequency Exposure Guidelines in Supplement C to OET65. This transmitter must not be co-located or operating in conjunction with any other antenna or transmitter

