

etyBLU

Bluetooth Headset

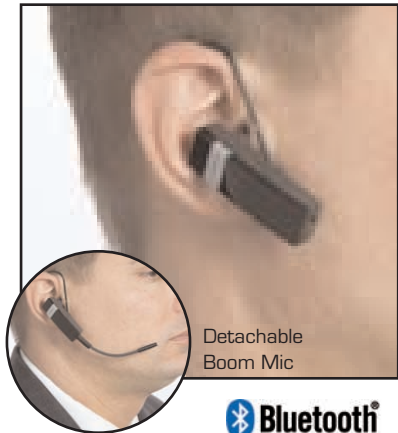

Detachable
Boom Mic



User Manual

English	For complete operating instructions, go to www.etymotic.com/hf2/manual
中文	若需查阅完整的操作说明，请访问 www.etymotic.com/hf2/manual
Dansk	For de fulde betjeningsinstruktioner, gå til www.etymotic.com/hf2/manual
Niederländisch	Voor volledige bedieningsinstructies gaat u naar www.etymotic.com/hf2/manual
Français	Pour les instructions d'utilisation détaillées, consultez : www.etymotic.com/hf2/manual
Deutsch	Die komplette Betriebsanweisung finden Sie unter www.etymotic.com/hf2/manual
Italiano	Per istruzioni d'uso complete, visitare il sito www.etymotic.com/hf2/manual
한국의	사용설명서 전문을 원하시면 www.etymotic.com/hf2/manual 로가십시오
日本語	すべての操作説明書を参照する場合は、 www.etymotic.com/hf2/manual をご覧ください
Español	Para obtener las instrucciones completas de uso, visite www.etymotic.com/hf2/manual

Introduction

The Etymotic etyBlu™ headset contains two microphones. One microphone is located at the end of the earpiece; the other, a highly-directional, noise-rejecting microphone is located at the tip of the boom. The combination of an in-ear noise-isolating earphone and a directional microphone placed close to the mouth provides exceptional sound quality and clear communication at both ends of the conversation. The etyBlu headset was developed by Etymotic Research for use in high levels of background noise. The boom is detachable. Another Etymotic first.

The etyBlu headset utilizes Bluetooth® 2.0 + EDR extended data rate wireless technology.

Features

- etyBlu Bluetooth® headset
- Detachable directional microphone boom
- Highest isolation and noise rejection of any headset—
with boom mic in place
- Optional adjustable earloop that can be worn on either ear
- 5-6 hours talk time; 70 hours standby
- Lightweight (< .5 oz)
- Charges from USB port (cable included)

Included

- etyBlu Bluetooth headset
- Earloop
- Detachable Boom mic
- Leather storage case
- Assorted eartips
- Filter changing tool with replacement filters
- USB charging cable

Identification

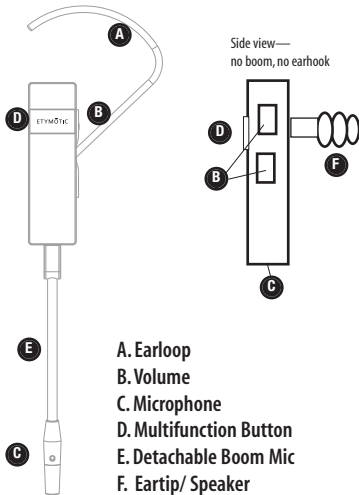

Getting Started

Before using the etyBlu headset:

- Fully charge the headset. Typical charging time from empty is 2-3 hours; 80% charge in 1 hour
- Pair the headset with a Bluetooth-enabled device, e.g., cell phone, PDA, computer

Selecting an Eartip

When properly inserted, the headset is self-supporting in the ear canal. An optional earloop is supplied with the headset. The earloop can be used on either ear. Sound quality and noise isolation depend on a good eartip seal.

Insertion

- Carefully insert the earpiece while pulling up and out on the back of the ear.
- Twist the earpiece while inserting until outside noise is blocked out.
- Position the earpiece for best fit and comfort.
- **Flanged eartip:** Moistening eases insertion.
- **Foam eartip:** Roll down or compress foam eartip before inserting. Hold the eartip in place for about 5 seconds while the foam expands to create a tight seal in the ear canal.



For a video on proper earphone insertion go to www.etymotic.com.

Removal

To avoid discomfort, remove the headset slowly with a twisting motion to gradually break the seal. Open jaw slightly to equalize pressure, because suction can occur when the eartip is removed.

Wearing the EtyBlu

Important: To insure optimal performance it is important that the eartip seals the ear canal.

- Choose an eartip that fits.
- Push the earloop through the earloop hole and adjust it to fit comfortably on the ear. The earpiece is designed to be self-supporting in the ear canal, so the earhook is optional.
- When using the boom, there is only one way to attach it to the headset. Bend the gooseneck so that the tip of the microphone is close to the mouth.
- The etyBlu headset can be worn on either ear.



Boom Mic—When to use

Without Boom Mic

For quiet /low noise environments.



With Boom Mic

For noisy environments.

- Gives up to 25 dB more noise rejection than microphones that are not close to the mouth, which can mean a critical difference in understanding and being understood.



Boom Mic — Connect

Connect

The plug on the boom is designed to connect to the headset only one way.

- 1. Gently snap the connector into the socket.**
- 2. Do not force the plug into the socket; it should insert easily.**
- 3. When the boom is connected correctly, the opening at the tip of the microphone is closest to the mouth and the opening at the middle of the mic tip is facing away from the mouth.**

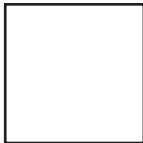
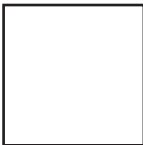

Boom Mic — Disconnect

Disconnect

1. Hold the boom where it connects to the headset and gently pull downward.



2. Keep the boom in the storage case for easy access.

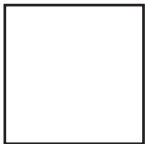

LED Chart

Power ON	Blue and yellow LEDs are solid for 3 seconds while turning on
Power OFF	Blue and yellow LEDs are solid for 3 seconds while turning off then all LEDs off
Pairing Mode	Blue blinking
Active call	Blue LED blinks once per second
No active call	Blue LED blinks every 3 seconds
Charging	Solid yellow LED
Low battery	Blinking yellow LED
Charge complete	Yellow LED off

Battery Life

The etyBlu comes with an integrated lithium polymer (rechargeable) battery. Charge the headset for at least one hour before first use.

Battery life

External BT device with EDR support	> 5 hours
External BT device with basic rate support	4 hours
Standby time	70 hours

Low Battery Indicator

The software monitors the battery voltage level. When there is less than five minutes of use left, the LED blinks yellow.

Charging

Typical charging time

From empty: 2-3 hours

80% charge: 1 hour

Charging with the USB connector (included)

- Plug the charging cable into a computer USB port.
- Plug the boom connector into the etyBlu headset as shown; it should slide in easily.
- The solid yellow LED will indicate that the headset is charging.
- When charging is complete the yellow LED turns OFF.

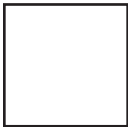

Charging with a wall charger (not included)

- Plug the charger adapter into an AC wall outlet.
- Plug the USB end of the etyBlu charging cable into the adapter.
- Plug the boom connector on the etyBlu charging cable into the headset as shown; it should slide in easily.
- The solid yellow LED will indicate that the headset is charging.
- When charging is complete the yellow LED turns OFF.

Pairing

Pairing varies by device

The headset is discoverable for five minutes after Power On.

- Turn the phone OFF and then back ON.
- Turn on the mobile phone's Bluetooth function.
- Press and hold the Multifunction Button (MFB) for 5 seconds.
- The blue LED will flash rapidly when ready for pairing. The etyBlu stays in pairing mode for 5 minutes.
- Activate the search for BT and/or audio devices on the phone
- When the etyBlu is found, the phone will display "ER89 etyBlu." Scroll to it and press OK to confirm pairing.
- If a passkey is requested, enter 0000.

Note: Bluetooth transmitter pairing varies. For best results, consult the user instructions for the specific device being paired with the etyBlu. Some mobile phones require a security setting change for automatic headset-phone pairing.

Multifunction Button

Some features depend on phone support.

Power ON Press the On/Play/Pause button for 4 seconds to Power On. The blue LED blinks when the headset is ON.

Power OFF Press the On/Play/Pause button for 4 seconds to Power Off. The blue LED turns off when the headset is OFF.

Volume Press the UP (+) and DOWN (-) buttons on the side of the headset to increase or decrease volume. The exact number of volume levels is set and maintained by the phone.

Answer a Call Press once quickly (short press) on when phone rings to connect the call.

End a Call Press once quickly (short press) to disconnect the call.

Reject a call Press and hold (long press) for one second to reject an incoming call (if supported by the phone)

Multifunction Button

- | | |
|--|---|
| Redial | Press and hold (long press) for one second (if supported by the phone) |
| Transfer Audio to the Handset
(during a call) | Double press (2 quick presses < 1 second) |
| Call Waiting
Answer an incoming call while on a call | <ul style="list-style-type: none">• Press and hold MFB for 1 second to put a call on hold to answer another (if phone is HFP supported)• Press the MFB for 1 second to switch between calls• Press MFB to end the current active call |
| 3-Way Calling
(if supported by phone) | <ul style="list-style-type: none">• Put active call on hold: Press and hold (long press) for one second to put the active call on hold.• Add another caller: Press quickly (short press) to add the held call to the conference or hold the call based on the call state• End: Double press (two quick presses of less than 1 second) to release all parties. |

Earpiece Filter

The earphone in the etyBlu headset has a special filter that smoothes the frequency response and prevents earwax from entering the earphone. The filter is located at the end of the earphone and is visible when the eartip is removed. A dirty filter will reduce earphone output. Change the filter if loudness decreases or the sound quality declines.

Note: Filters are not reusable.

Filter Removal



1. Remove Eartip.

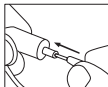

2. Insert tool into the filter.



3. Remove filter.

Filter Replacement



1. Insert a new filter and press gently against a hard surface to secure it in place.



2. Re-attach eartip.

Proper Care

- Do not expose the headset to extreme temperatures.
- Avoid dropping and strong impact.
- Leave an eartip on the headset for shock protection.

Cleaning/replacement of eartip

- Clean or replace a flanged eartip prior to use by others.
- Replace a foam eartip prior to use by others.
- Clean a flanged eartip by simply wiping it off with a soft cloth.
If water and mild soap are used, dry the eartip before replacing it on the headset.
- Replace disposable foam eartips regularly.
- Replace flanged eartips every 6-12 months.

Caution

Consult an audiologist or physician if you have excessive ear wax, difficulty inserting the eartips, or discomfort after prolonged use. The etyBlu headset excludes most external sounds. Always use extreme caution while using any headset when operating a motorized vehicle.

Do not use the headset at excessively loud levels. Research confirms that earphones that seal the ear canal allow listeners to listen at safer levels. Noise-induced hearing loss is a function of exposure time, the average sound level and the peak of very loud sounds. A sealed eartip and lower listening levels allow for longer periods of safe listening time.

Specifications

Battery Life (Estimated)

External BT device with EDR support > 5 hours

External BT device with basic rate support 4 hours

Standby time 70 hours

Duration of low battery indicator 5 minutes

Environmental Performance

Operating/charging temperature 0 to +60°

Storage temperature -20 to +70°

Radio Performance:

Range should exceed 20 meters in free space. Real-life performance will vary based on position of the two BT devices relative to the user's body, including other obstacles and the performance of the other device.

Weight

Headset 9 grams

Headset with boom < 13 grams

Headset with boom and earloop 14 grams

The earphone complies with the Bluetooth 2.0 specification and implements the following protocols:

- Radio including EDR. EDR certification may be deferred.
- HSP profile 1.1
- HFP profile 1.5

Conforms to FCC, Industry Canada, and EU (CE mark) regulations.

Etymotic Research, Inc.

Etymotic Research has spent twenty-five years developing in-ear technology for auditory research, precision monitoring and critical listening. Etymotic has developed many innovative hearing technologies available today. Etymotic's products are used by musicians and others who insist on superior sound quality. Etymotic means "true to the ear."

etyBlu is a trademark of Etymotic Research, Inc. The Bluetooth word, mark and logos are owned by the Bluetooth SIG, Inc. etyBlu is covered by US patents xxxxxxxx, xxxxxxxxxx and other patents applied for and pending.

Warranty

Etymotic Research, Inc. warrants this product against defects in material or workmanship for a period of two years from the date of original purchase from an authorized Etymotic distributor or reseller. Etymotic will repair or replace the defective product at its option if returned within the warranty period to our designated service facility. This warranty is in lieu of all other warranties, expressed or implied, including, but not limited to, any implied warranty of merchantability or fitness for a particular purpose.

FCC & Other Information

This equipment has been tested and found to comply with the limits for a Class B digital device, pursuant to Part 15 of the FCC Rules. Operation is subject to the following two conditions:

1. This device may not cause harmful interference, and
2. This device must accept any interference received, including interference that may cause undesired operation. These limits are designed to provide reasonable protection against harmful interference in a residential installation. Some equipment operates at frequencies that may cause interference to nearby TVs and VCRs; to minimize or prevent such interference, the system base should not be placed near or on top of a TV, PC monitor, or VCR; and, if interference is experienced, moving the desk station farther away from the TV or VCR will often reduce or eliminate the interference. However, there is no guarantee that interference will not occur in a particular installation. If this equipment does cause harmful interference to radio or television reception, which can be determined by turning the system off and on, the user is encouraged to try to correct the interference by one or more of the following measures:
 1. Increase the separation between the equipment and receiver.
 2. Consult the dealer or an experienced radio TV technician for help.

FCC & Other Information

FCC Health and Safety Information

Your device is a radio transmitter and receiver. It is designed and manufactured not to exceed the emission limits for exposure to radio frequency (RF) energy set by the Federal Communications Commission of the U.S. Government. The FCC has established criteria for the amount of radio frequency energy various products may produce depending on their intended usage. This product has been evaluated and found to comply with the FCC's exposure criteria. For body worn operation, the FCC RF exposure guidelines were also met when used with the accessories supplied or designed for this product. Use of other accessories may not ensure compliance with FCC RF exposure guidelines and should be avoided. Caution: Any changes or modifications not expressly approved by the party responsible for compliance could void the user's authority to operate this device. This device must not be colocated with other transmitters.

ETYMŌTIC RESEARCH INC.

61 Martin Lane • Elk Grove Village, IL 60007

www.etymotic.com • 1-888-ETYMOTIC

©2008. etyBlu is a trademark of Etymotic Research, Inc..

