



OWNER'S MANUAL

AVGO Wifi Security Camera Video Doorbell

MODEL NO : 4NPHLN0000010

Made In China

WD608+ 英文说明书 128G双铜封面过哑胶 骑马钉 四色印刷 尺寸: 120X85mm

物料编码	制作日期	制作人	物料名称	工艺	材质	用量	其它
		黄柳苗	WD608+说明书	骑马钉	128g双铜	1PCS	

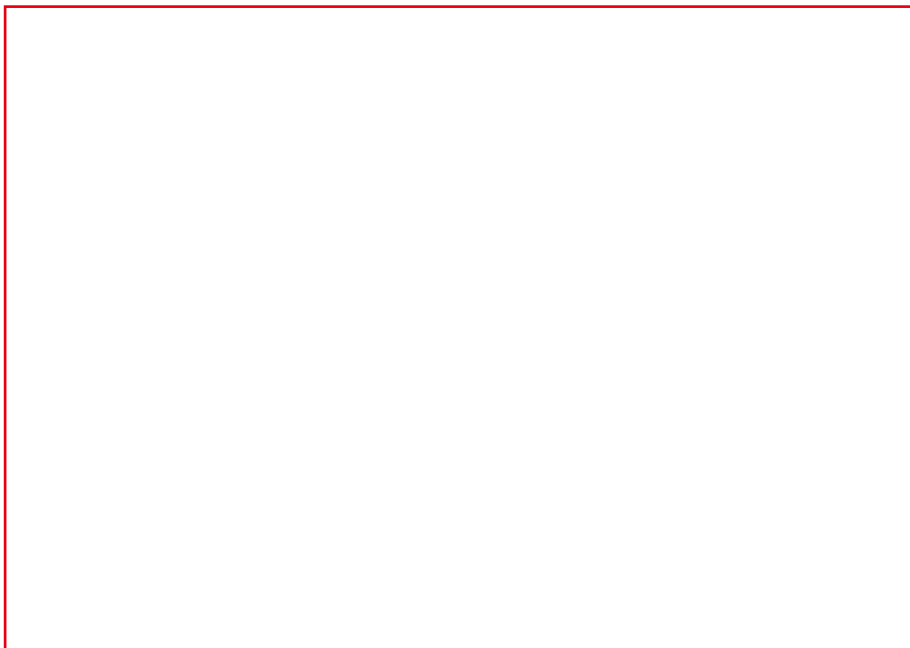

Components And Interfaces

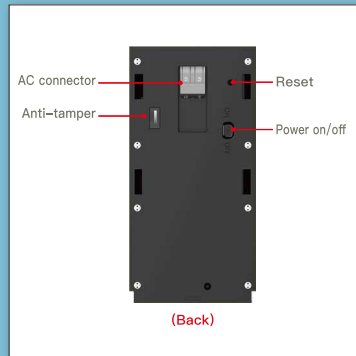
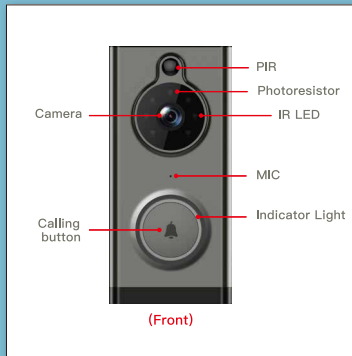

The pictures are for reference only.

Components And Interfaces

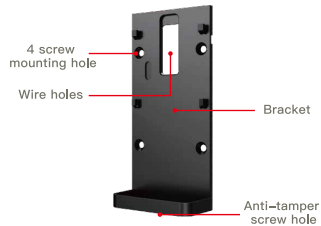

IR LED: When the light is not enough, the IR LEDs will be enabled to increase the brightness.

Photoresistor: It is used to collect the brightness value, when the illumination is lower than 2LUX, the IR LED will be enabled.

MIC: Collect voice

Calling button: Used to activate the doorbell, notified if there is a visitor, link to indoor chime.

PIR: Automatically activate the doorbell when movement is detected.

Camera: Capture images and video.

Indicator Light: The red indicator flashes slowly: The device is in configuration mode.
The blue indicator flashes slowly: The device is working.
The red and blue indicator flashes alternately: WiFi connection failed.



The pictures are for reference only.

Components And Interfaces



AC connector: Connect to external AC power AC16-24V.
Anti-temper: Once the device is removed, the temper switch will be activated.
Reset: Long press 5s to reset.
Power on/off: Power switch.
USB charging: Charge the backup battery via the USB.
Speaker: Talk to the visitor.
Memory card slot: Insert a memory card up to 32G.
Screw hole: Prevent equipment from being removed.



The pictures are for reference only.

Installation instructions

- 1.1 Mounting bracket.
Fix four screws on the wall, plank.
- 1.2 Install doorbell at the height about 1.3–1.6m
Try to protect itself from rain and sun

STEP
1

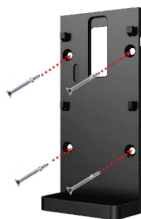

1 Fix bracket with screws



2 Fix bracket well

Wire Doorbell

STEP 2

Connect the doorbell to your existing low voltage wiring

2.1 Power supply of

A: Low voltage AC 16–24V

B: Battery 3.7–4.2V

C: USB 5V (only for charging, not suggested to use it as power supply)

2.2 Insert disconnected 2–low voltage wires into the connector at the back. Cable will lock if it is inserted properly. Pull the cable to test.



Warning!

Connect only Low Voltage AC 16–24V or DC5V power
DO NOT CONNECT AC & DC BOTH AT THE SAME TIME



You can insert any color wire to any connector.



Install Doorbell

STEP
3

3.1 Slide the doorbell from Top to Bottom on the bracket.



④ Install the doorbell onto to mounting plate

Install Doorbell

STEP
4

4.1 Install the anti-tamper screw at the bottom of the mounting bracket.



4 Screw the bottom, installation finished.



Do NOT over-tighten the locking screw.

Complete the installation

5.1 Locate existing (old) indoor bell/chime



STEP
5

5.2 Open the front cover by pulling the cover outward. You will see the existing chime terminal markings:
“F” – Front Push Button Wire
“T” – Transformer Wire
“R” – Rear Push Button Wire



WARNING! Turn off power or circuit breaker before installing.

Finishing installation

- 5.3 Disconnect the wires from Trans (T) & Front (F) marked terminal
- 5.4 Join Trans (T) & Front (F) wire with twist –on wire connectors (Marette)
- 5.5 Remove wire from Rear (R) to disconnect the Rear doorbell.
- 5.6 Place the cover back on the old indoor bell/chime

STEP
5

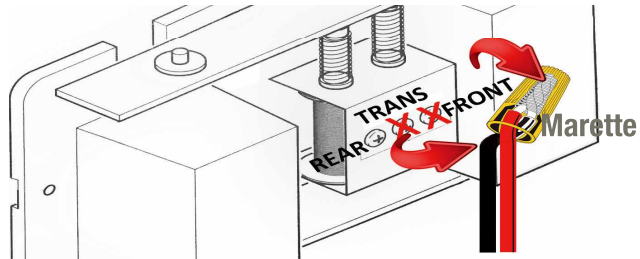

i If you have Front and Rear doorbells, the Rear doorbell must be disconnected. One Transformer can power only one doorbell.

Install indoor bell

Indoor bell uses 3pcs*AAA batteries.

When you press the WIFI doorbell button, indoor bell will ring.

STEP
6



Indoor bell is already synced with the WiFi doorbell unit.

Change Ringtones

Install the indoor bell to the wall

- 1 Find your favorite ringtone by pressing the “◀” or “▶” button.
- 2 Press and hold the Vol button until you hear a sound.
Watch for blinking lights on the indoor bell.
- 3 Quickly press the doorbell “call” button to pair.

New ringtone will play if the pairing is successful.

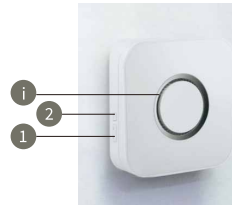
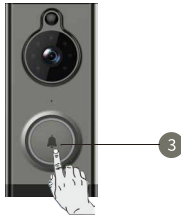

Your existing (old) indoor bell will stop working.

Calling and Answer Calling



(a)

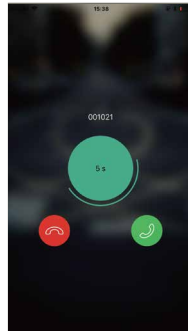

(b)



(c)

Connect Doorbell to Network

APP name is “ToSee”, it supports both Android and IOS app, you can download it by scanning QR code on cover page or in the following ways:

1. Android: Search keyword “ToSee” on Google Play or Myapp to download the APP for Android devices.
2. IOS: Search keyword “ToSee” on APP store to download the APP for IOS devices.



ToSee



Connect Doorbell to Network

3. Tap “+” in the upper right of the app to add the device, select add device, and enter the next step.

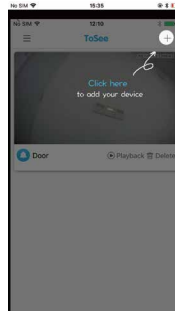

(3)

Connect Doorbell to Network

4. Enter the WIFI setting page of the mobile phone according to the instructions, find and connect the WIFI hotspot emitted by the Doorbell whose name starts with "ToSee", then return to the APP to continue to the next step.

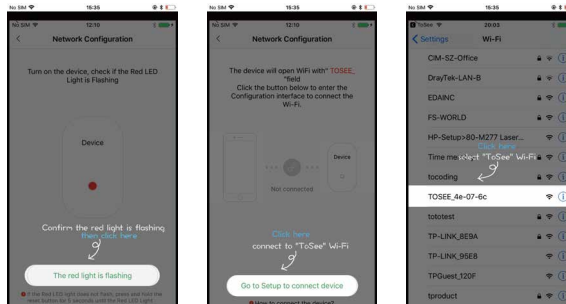

(4)

Connect Doorbell to Network

5. In the configuration mode page, fill in the password of your WIFI and start configuring.
6. Set the administrator password for the device for device sharing and management.

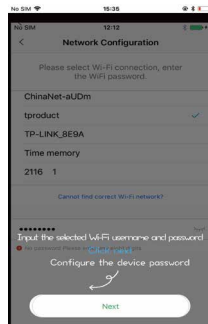

(5)

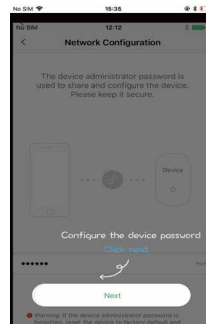

(6)

Connect Doorbell to Network

7. Please modify the name of the device after it is added successfully.

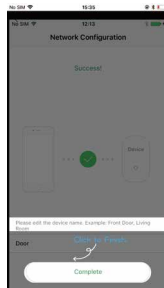

(7)

Note: If you need to change the WiFi, please press and hold the reset button for 5 seconds, and the red light of the WiFi indicator will flash slowly, which means it is entering configuration mode.

Motion Detection Sensitivity Settings

To Improve the cameras response time to motion, you can adjust the motion sensitivity in the APP "Settings" section. The factory default setting for motion detection sensitivity is currently set at 10 seconds delay and can be adjusted as depicted below.

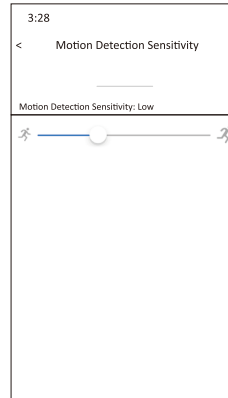
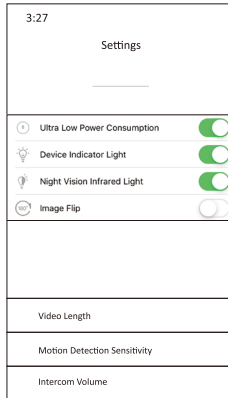

Specifications

Pixel	highest 720P(1280W*720H)
Angle	diagonal 160 degree
Infrared lamp	6 pcs 850nm
WiFi	IEEE 802.11b/g/n. 2.4G
Intercom	Two-way voice intercom with echo cancellation.
Video	Memory Card (of 15 frames)
Storage	8G/16G/32G
Battery	Lithium battery 4000Mah

Specifications

Message	Speed push for 2 seconds.
Wake up	Among 600ms
The method of wake up	Push the button
	Trigger PIR motion sensor
	Operating the APP by you phone
Power consumption	Standby current :300uA
	Working current :300mA
Note: Normal operating for 10 minutes a day, you can use it for 5 to 6 months.	

Q&A

Q: The device cannot connect to the WiFi.

A: 1. Please confirm that the network is 2.4G. 5G networks are not supported.

2. Please make sure the red light of WiFi indicator flashes slowly.

3. Please check whether the account and account password is correct.

Please make sure there are no blanks.

Q: Trigger it when the device is online, but the phone can't receive the message.

A: Open the "self-start" in your mobile app. And the notification function is enabled on "application permissions". Turn off "battery optimization".

Close the background and the interest screen and end the background running APP Settings. The mobile phone manufacturer's optimization method is inconsistent, please refer to the actual situation.

Q&A

Q: What type of power supply does the device support?

- A: 1. The equipment can be operated alone with 4000mAh battery.
2. Use AC (16–24v) to charge and work with the built-in battery.
3. The device can be charged via USB.

Q: What kind of storage are supported by the device?

A: 8g/16g/32g are supported.

Notice

This device complies with Part 15 of the FCC Rules.

Operation is subject to the following two conditions:

1. This device may not cause harmful interference.
 2. This device must accept any interference received, including interference that may cause undesired operation.”
- “Warning: Changes or modifications to this unit not expressly approved by the party responsible for compliance could void the user’s authority to operate the equipment.”
 - “NOTE: This equipment has been tested and found to comply with the limits for a Class B digital device, pursuant to Part 15 of the FCC Rules. These limits are designed to provide reasonable protection against harmful interference in a residential installation. This equipment generates, uses, and can radiate radio frequency energy and, if not installed and used in accordance with the instructions, may cause harmful interference to radio communications.

Notice

However, there is no guarantee that interference will not occur in a particular installation. If this equipment does cause harmful interference to radio or television reception, which can be determined by turning the equipment off and on, the user is encouraged to try to correct the interference by one or more of the following measures:

- Reorient or relocate the receiving antenna.
- Increase the separation between the equipment and receiver.
- Connect the equipment into an outlet on a circuit different from that to which the receiver is connected.

Consult the dealer or an experienced radio/TV technician for help.

This equipment complies with FCC radiation exposure limits set forth for an uncontrolled environment. This equipment should be installed and operated with minimum distance 20cm between the radiator & your body.

Distributed by Bluestem Brands Inc.,

7075 Flying Cloud Drive, Eden Prairie, MN 55344

Tel: 1-800-208-2500 (Monday-Friday 8:00am-8:00pm Central time)



■ Android ■ iOS