



Tag User Manual

Date: 13-Jul-04

Prepared by:

Scanpak Inc.

2250 Place Transcanadienne

Dorval, Quebec

Canada H9P 2X5

Tel: 1-514-685-3505

Fax: 1-514-685-5484

www.scanpak.com



TABLE OF CONTENTS

1. <u>INTRODUCTION</u>	3
2. <u>PREPARING FOR INSTALLATION</u>	4
INSTALLATION CHECKLIST	4
INSTALLATION GUIDELINES	4
3. <u>PREPARATION OF GALLEY EQUIPMENT</u>	5
GALLEY EQUIPMENT CLEANING AND PREPARATION	5
INSTALLATION OF THE TAG	6



1. Introduction

These installation procedures describe how to properly install a tag in conformity with Scanpak's standards.

First and foremost, this document presumes that you are familiar with Galley Equipment.

If you feel uncomfortable with any of the above tasks, immediately contact your supervisor and discuss that matter with him or her.

This document will firstly present to you an installation checklist to make sure you have all the equipments and tools required to a successful installation. Then, it will guide you to make decisions regarding the positioning of the tag onto the Galley Equipment.

2. Preparing for Installation

Installation Checklist

The following installation checklist is intended to help you prepare the installation of tag.

When performing the installation, you should bring with you the following tools:

-
- Acetone



-
- Rag cloth



-
- Tag

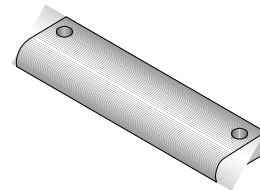

Installation Guidelines

Your installation company will create a special help-desk for all installation questions. If the installation company help-desk cannot answer a question, it will immediately establish a phone conference with Scanpak's help-desk to answer the question.

3. Preparation of Galley Equipment

Galley Equipment Cleaning and Preparation

1. The location of the tag will determine the type of galley equipment. See images below.

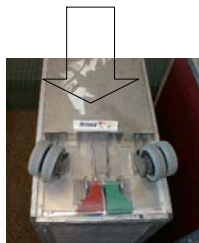

Full size atlas

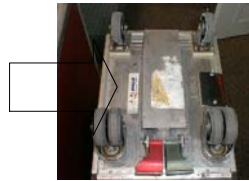

Half size atlas

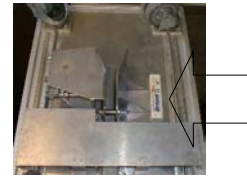

Custom

2. Empty all remaining items and trays inside the galley equipment.
3. Close equipment door and lock if needed.
4. Flip the equipment upside down as shown by the above pictures.
5. Clean the outside surface of the galley equipment where the tag will be installed with a rag cloth with acetone. This is done to remove any grease, paint etc. that will interfere with adhesion. (You should wear rubber or latex gloves and perform this task in a well-ventilated area)



Installation of the Tag

1. Peel off the adhesive protector at the bottom of the tag to expose the adhesive side of the tag. See figure below.

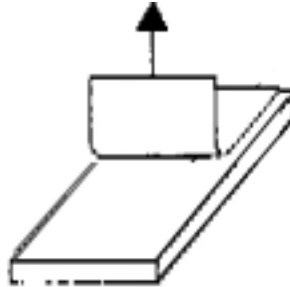

Bonding Pressure	27 kg
Bonding Period	10 to 12 sec
Bonding Temperature	High, Medium, Low temperature
Bonding Solvency	Solvent resistance
Bonding Thickness	2.0 mil

2. Position the Tag horizontally to the location where you have cleaned with the acetone.
3. Carefully press the Tag down and hold for about 10 seconds.
4. The installation of the tag onto the galley equipment is now complete.



Tag's User Guides

Warning: Changes or modifications not expressly approved by Scanpak Inc. could void the user's authority to operate the equipment

Model: TTAGB model TTB-434-01

FCC ID: RUQTTB-434-01

THIS DEVICE COMPLIES WITH PART 15 OF THE FCC RULES. OPERATION IS SUBJECT TO THE FOLLOWING TWO CONDITIONS. (1) THE DEVICE MAY NOT CAUSE HARMEFUL INTERFERENCE AND (2) THIS DEVICE MUST ACCEPT ANY INTERFERENCE RECEIVED, INCLUDING INTERFERENCE THAT MAY CAUSE UNDESIRE OPERATION.