



Getting Start

7

Open battery cabinet cover



Insert SIM card

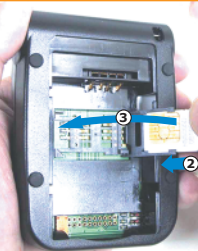

Put battery in



Close battery cabinet cover





GSM LED indicator

Status	LED
GSM Stand-by	Off 3 sec. and on 75 micro Sec.
Searching network or no SIM card	On 600 micro sec. and off 600 micro sec.
Network connected	Stay on

Power LED indicator

Status	LED (Color)
Battery low	Red
External powered (Power full)	Green
External powered - charging	Orange

GPS LED indicator

Status	LED
Searching GPS	Stay on
GPS 3D fixed	Blinking

HI-601VT set contains two main units:

1. HI-601VT unit installed on the "client side":
in your car, someones' back pack, etc.
2. Decoder unit carried with the "host side"

Inside HI-601VT contain five main parts: 1) SiRF StarIII high sensitive GPS receiver module, 2) Tri-band GSM module, 3) System control circuit section, 4) Power management section, 5) Rechargeable battery

Decoder unit contain three parts: 1) A/D converter circuit section, 2) Bluetooth module, 3) Two 3A batteries



Inside HI-601VT, the GPS module receive satellite signal and transfer the data into standard NMEA protocol data. Then, the GSM module transmit the data in analog voice message via regular communication network (just like calling and talk from one phone to another phone).

As soon as these two devices communicated, HI-601VT will keep transmitting the "voice" to the user side. By connecting the voice phone jack cable from the users' phone to the decoder unit (the purpose of the decoder unit is to transfer the analog voice message into the digital NMEA standard sentences), the wireless Bluetooth module inside will start sending the NMEA message to the display devices, such as, PDA, laptopPC, desktopPC, etc. after the Bluetooth connection was set up.

Track with different occasions:

1. □ With Smartphone:

- If user has the smartphone (PDA with Bluetooth feature and phone function), by connecting the decoder from the voice jack, one can communicate to the HI-601VT with the smartphone and perform the tracking on the same smartphone.

2. □ With PDA and mobile or home phone:

- The phone set up communication to HI-601VT. Connect the voice jack cable between the phone speaker phone jack and the decoder. The decoder sends the NMEA sentence back to the PDA via the Bluetooth connection.

3. □ With laptopPC and mobile or home phone:

- The phone set up communication to HI-601VT. Connect the cable between the phone speaker phone jack and the decoder. The decoder sends the NMEA sentence back to the laptopPC via the Bluetooth connection or by the cable sets.



10

HOW to USE Option#1

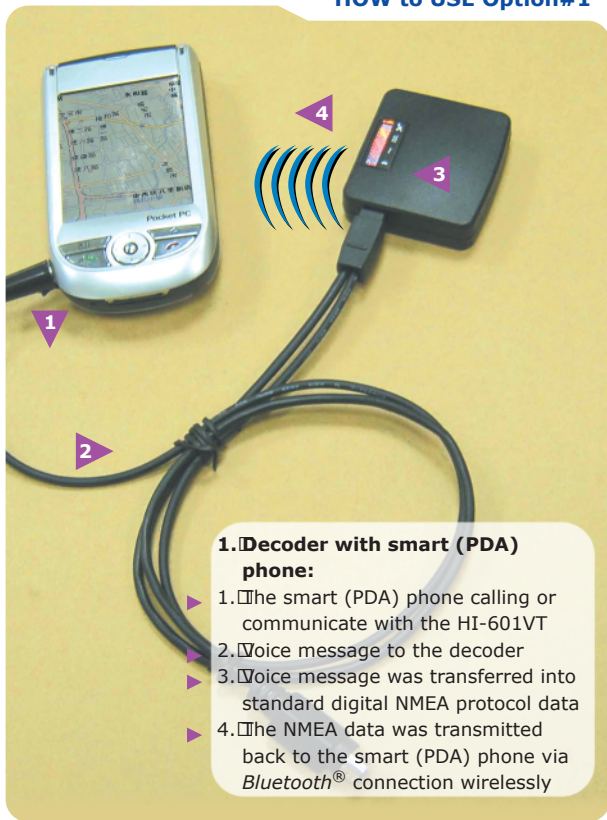

1. Decoder with smart (PDA) phone:

1. The smart (PDA) phone calling or communicate with the HI-601VT
2. Voice message to the decoder
3. Voice message was transferred into standard digital NMEA protocol data
4. The NMEA data was transmitted back to the smart (PDA) phone via *Bluetooth*® connection wirelessly