



TIMEFLYS®

# IPC300

TimeFlays IP Camera Baby Monitor

## User Manual

Network baby monitor, Wi fi Camera

Support IOS and Android system

Intercom function

Night vision function

Sound and motion detecting  
alarm function

Smartphone shooting and video  
recording of babies

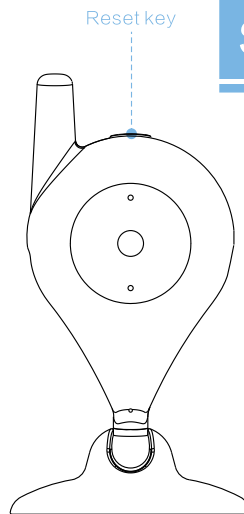

Reset key

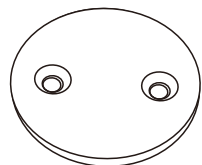

Metal Base for  
Magnetic Adsorption

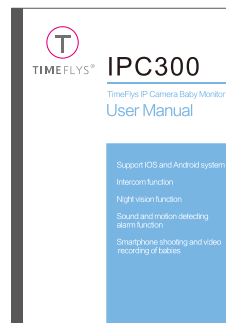

One User Manual

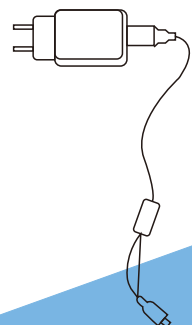

One Power Adapter

## Standard Configuration

## Directions

### Install APP

Download and install APP



IOS



Android

### Booting

Waiting 30 seconds until the green light flashes after the camera is powered on.

Quickly press the reset key and go into WIFI setup (prompt tone), press it for 5 seconds and camera will be reset (prompt tone).

### Indicator light

Green light on: successful WIFI connecting

Green light quick flash: WIFI setup

Green light slow flash: WIFI connecting or false connecting if it lasts a long time

### Add IPC300 Camera

Open the software, click “Add Camera” and then choose “intelligent connecting” according to the process shown in the APP.

After the device is connected to WIFI, when having the same WIFI, you can choose “local area network” to add camera or choose “manual adding”, click the QR Code and add by scanning the QR code of the device bottom. If you want another person in distance to visit the device, you can tell the person the ID password (refer to the following RTEST-001312-RPUKV) to manually add ID, name (user-defined) and password.

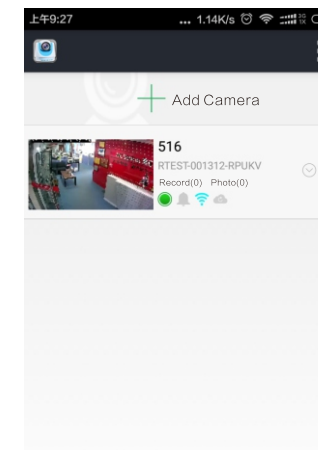

Note: If one smartphone among several phones that use the same IPC300 changes user password, then the others need change it accordingly.

# Directions

## APP Function Explanation

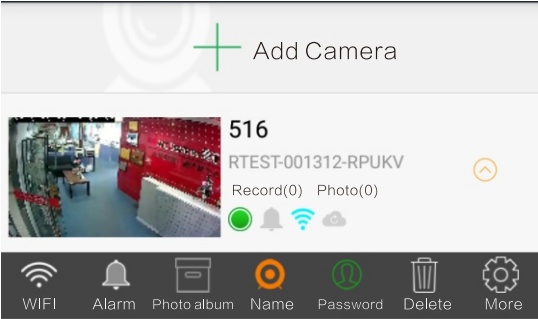

Change WIFI

Voice, mobile alarm setup

Name change

Photos and video-records document

Password change

Delete device

Hide menu

## Hidden Menu

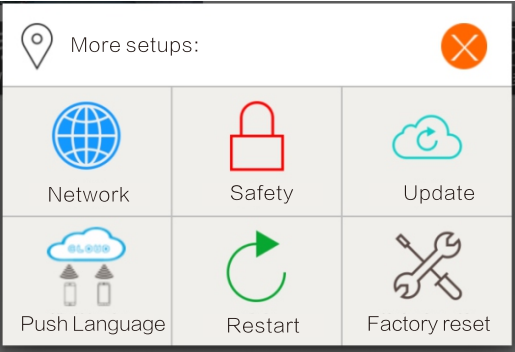

## Alarm Setup

Alarm ON means to open alarm, alarm OFF means to close alarm. Sensibility varies from 0 to 10. The bigger the number, the greater the sensitivity. It takes effect after sound and motion alarm setup is finished and saved.

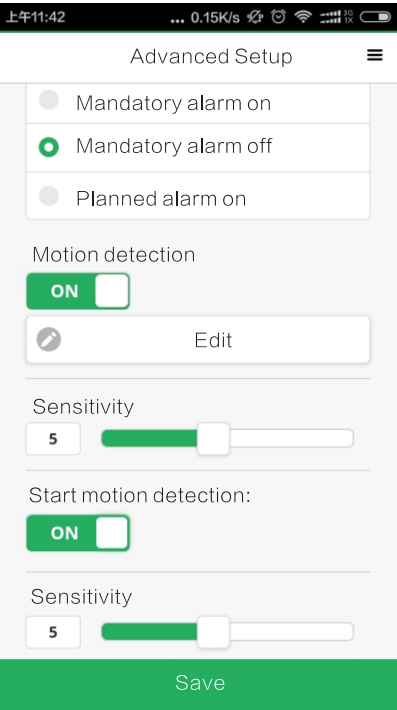

## APP Browse mark Explanation

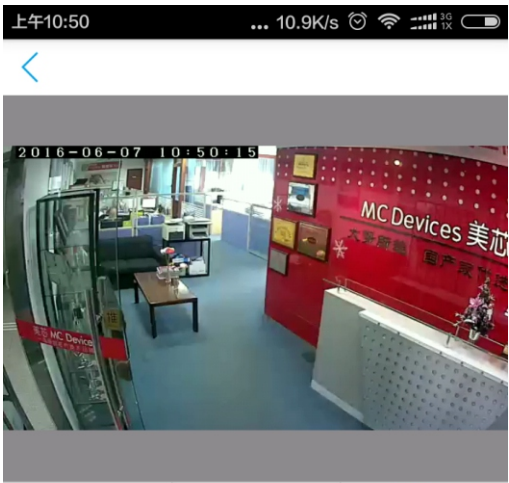

Audio monitor

Pixel conversion

Horizontal and vertical screen conversion

Video record

Press for Intercom

Shoot

This device complies with part 15 of the FCC Rules. Operation is subject to the following two conditions: (1) this device may not cause harmful interference, and (2) this device must accept any interference received, including interference that may cause undesired operation.

Changes or modifications not expressly approved by the party responsible for compliance could void the user's authority to operate the equipment.

NOTE: This equipment has been tested and found to comply with the limits for a Class B digital device, pursuant to Part 15 of the FCC Rules. These limits are designed to provide reasonable protection against harmful interference in a residential installation. This equipment generates, uses and can radiate radio frequency energy and, if not installed and used in accordance with the instructions, may cause harmful interference to radio communications. However, there is no guarantee that interference will not occur in a particular installation.

If this equipment does cause harmful interference to radio or television reception, which can be determined by turning the equipment off and on, the user is encouraged to try to correct the interference by one or more of the following measures:

- Reorient or relocate the receiving antenna.
- Increase the separation between the equipment and receiver.
- Connect the equipment into an outlet on a circuit different from that to which the receiver is connected.
- Consult the dealer or an experienced radio/TV technician for help.

The device has been evaluated to meet general RF exposure requirement. The device can be used in portable exposure condition without restriction. The distance between the parent unit and the human body is less than 20cm

FCC ID: RS5-IPC300

To maintain compliance with FCC's RF Exposure guidelines, This equipment should be installed and operated with minimum distance between 20cm the radiator your body: Use only the supplied antenna. The distance between the baby unit and the baby should be more than 20cm.