

Warnings

- When using this product it is always important to keep your eyes on the road and hands on the wheel. Not doing so could result in personal injury, death, and/or damage to your Xpress[®] Receiver, accessories, and/or to your vehicle or other property.
- Xpress[®] should be placed in your vehicle where it will not interfere with the function of safety features, e.g., deployment of airbags. Failure to correctly place Xpress[®] may result in injury to you or others if the unit becomes detached during an accident and/or obstructs the deployment of an airbag.

What's in the Box?

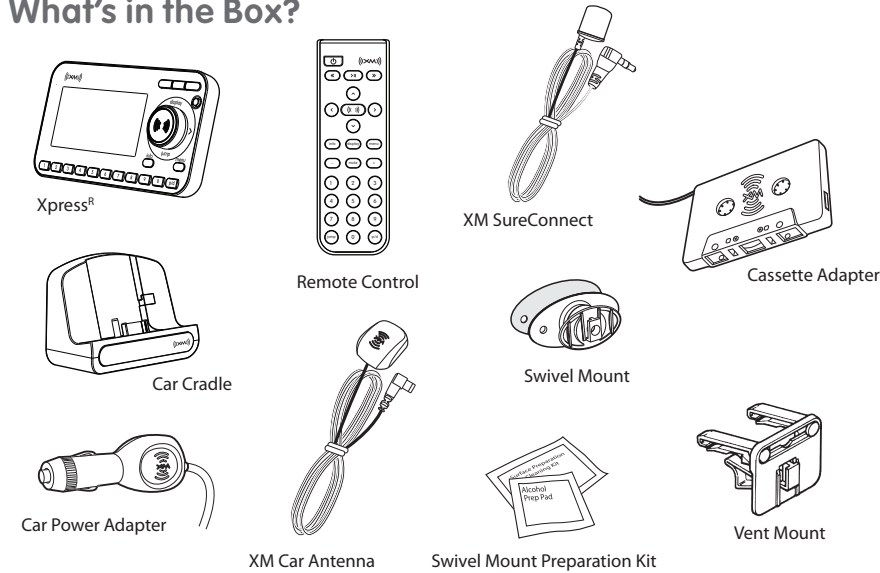

Xpress[®] Functions

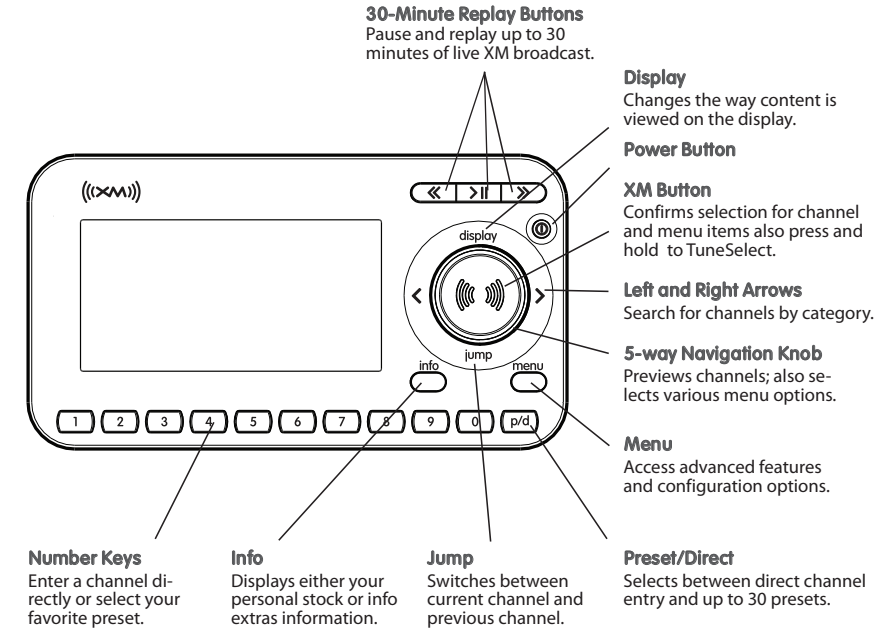

Using the 5-way Navigation Knob

The knob not only rotates, but it toggles. To toggle the knob, press on the edge and in the direction you want to toggle.

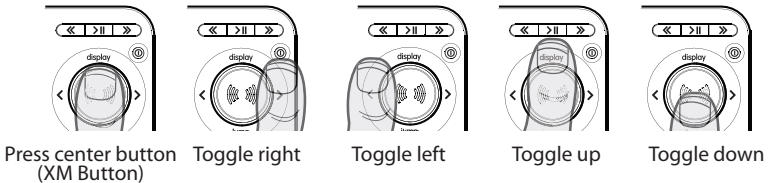

Vehicle Installation

Step 1: Mounting the XM Antenna

Mount the XM antenna to the roof or trunk of the vehicle. During installation, make sure you are outdoors and the antenna is not obstructed by tall buildings. For best results mount the XM antenna to the outside of your vehicle. Below are the recommended options

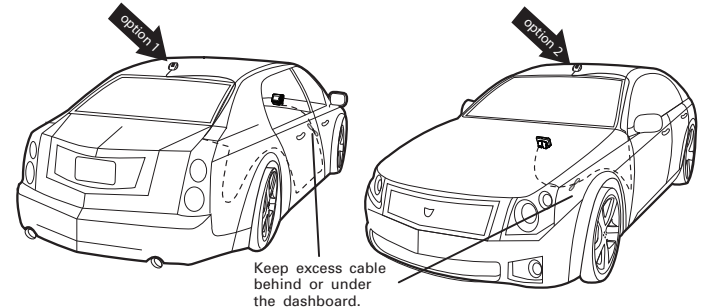

The XM antenna contains a strong magnet, allowing it to stick to any metal parts of your vehicle.

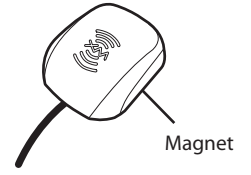

Step 2: Installing the Vent Mount or Swivel Mount

Installing the vent mount

To install the vent mount, find a horizontal vent that is strong enough to hold your Xpress[®] and car cradle. To remove the vent mount, push it into the vent and lift upwards slightly to release the mount's hooks from the vent vane.

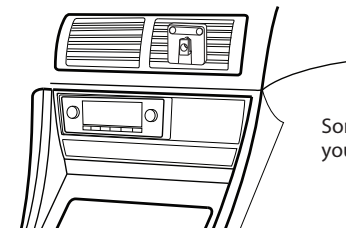
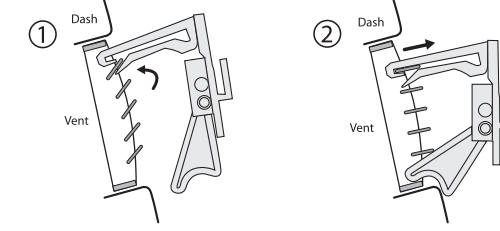

Some parts of the vent mount can be adjusted to better suit your vehicle's vent.

Installing the swivel mount

To install the swivel mount, first find a suitable location. The swivel mount's adhesive is very strong and may be difficult to remove. Do not install this mount on leather surfaces and make sure the air temperature is at least 60°F (15°C).

- Clean the mounting surfaces with the surface preparation kit.

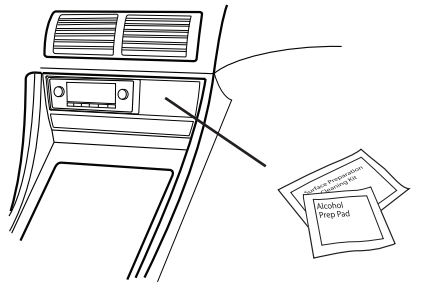

- Peel away the adhesive liner and firmly press the swivel mount to the surface for 30 seconds. Allow 24 hours before using the mount.

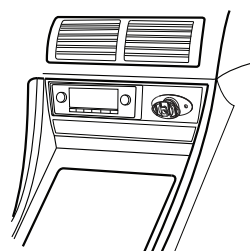

You can orient your swivel different ways to accommodate the space available in your vehicle.

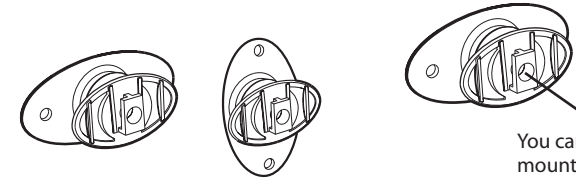

You can adjust the tension of the mount with a screwdriver

If you need to remove the mount, carefully lift the adhesive pad with your fingers or a spoon. Warming with a hair dryer for several minutes will help soften the adhesive. Your swivel mount comes with an extra adhesive pad.

Step 3: How to receive XM through your car stereo

There are several methods of receiving XM through your car stereo

Cassette Adapter: Use the cassette adapter if your vehicle's audio system has a built in cassette player. The cassette adapter will provide the best audio quality.

XM SureConnect: You can listen to your Xpress[®] through your car stereo by using Xpress[®]'s built-in FM modulator and the XM SureConnect. Simply find an unused FM frequency on the stereo and set your Xpress[®] to transmit on that same frequency. **For XM SureConnect install, please see your XM SureConnect installation guide.**

Professional Wired: The third option is the FM Direct Adapter (sold separately). We recommend professional installation if you choose to use this method of install.

Audio input: Some vehicles come with an audio input jack. If your vehicle has this type of input you can simply use a mini audio cable (sold separately).

Plug the antenna, the power adapter, and either the cassette adapter or the XM SureConnect into the car cradle as shown. The FM Direct Adapter is not pictured.

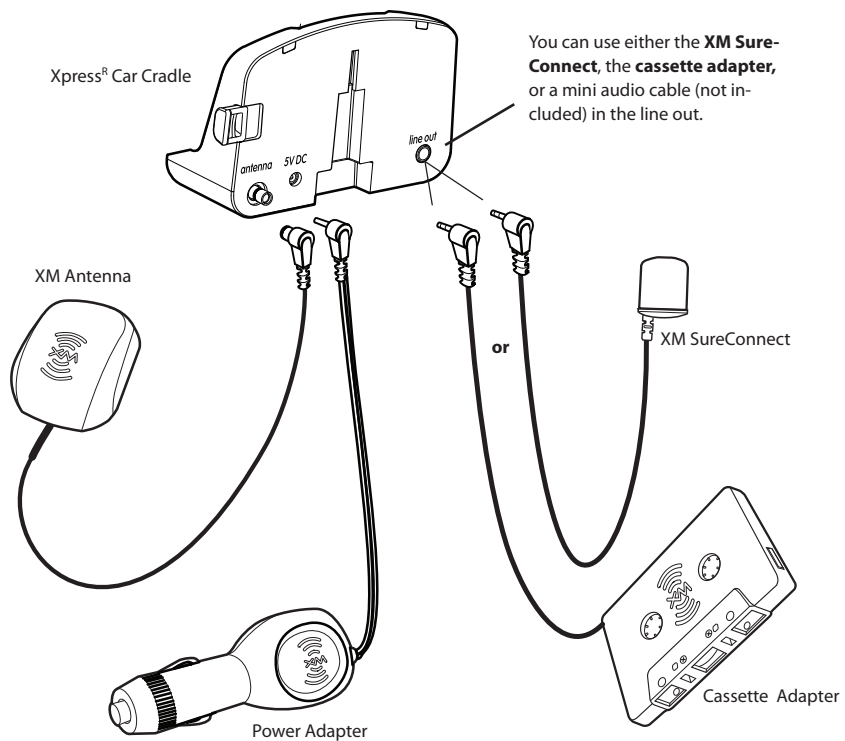

You can use either the XM SureConnect, the cassette adapter, or a mini audio cable (not included) in the line out.

Once you have all of the cables correctly connected you can lock your Xpress[®] into the car cradle.

- Unlock the car cradle locking mechanism
- Slide your Xpress[®] into the car cradle until it is in place.
- Slide the locking mechanism into place. This ensures that your Xpress[®] always stays in place.
- If you haven't already done so, hook the car cradle to the mount.

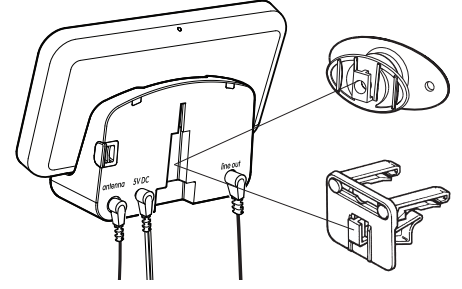
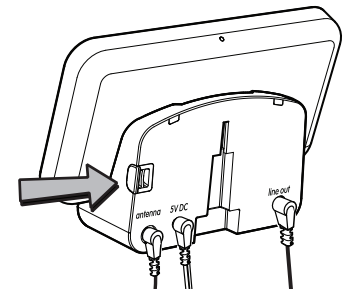
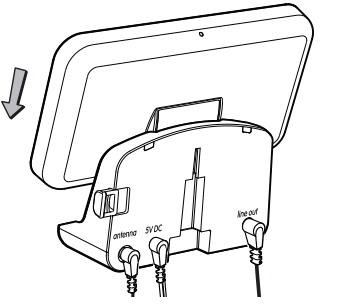
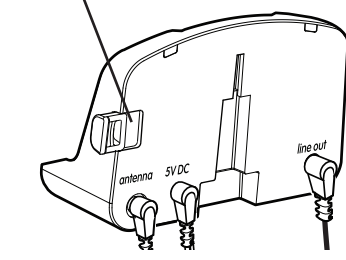

Step 4: Making your Vehicle's FM Radio an XM radio.

Your Xpress[®] contains a built-in FM modulator that transmits the XM audio signal to your vehicle's FM radio.

First, turn on your car stereo. You will need to find a suitable FM frequency in order to get the best sound. A suitable FM frequency is an unused frequency or weak station that is not located near a strong FM station in your area.

Next, power on your Xpress[®]. Be sure all of your cables are properly connected. Go to channel 1, this is the preview channel. You will not hear any sound through your car stereo until you have chosen an FM Frequency.

Press **Menu** → **FM Modulator**  → **FM Frequency**.

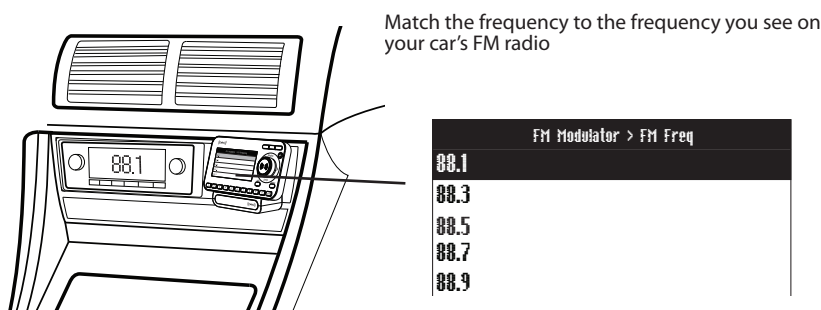

Now you should be able to hear your Xpress[®] through your FM stereo. If you can't hear any sound please check all of your connections and be sure your XM antenna is not obstructed

Basic Controls

Turn on your Xpress[®]. Subscribe to XM if you haven't done so already.

Selecting Channels

Rotate knob to scroll through the list of channels. Press the "XM" button to select that channel. You can also set up Xpress[®] so that you do not have to press the "XM" button to select a channel. See "Direct Tune" in your user guide.

- OR -

Press the number keys on your Xpress[®] or the remote that correspond to the channel number.

- OR -

If you have channels assigned to presets, press a number key and Xpress[®] will tune to the channel assigned to that number.

Direct Entry

1. Press the **p/d** button until the word "Direct" appears in the display.

2. Press the number keys corresponding to the channel number. For example, for channel 31, press **3** followed by **1**. You can select the channel faster by pressing the **XM** button after entering the channel number.

Using Presets

There are 30 presets in all; each bank (A, B, and C) holds 10 presets. Press the "p/d" button to select the proper bank. Use these banks to organize your favorite channels or to create separate preset banks for additional users to enjoy. To set a channel to a preset:

1. Tune to the desired channel.
2. Press the **p/d** button until the appropriate "Preset" bank (Preset A, B, or C) appears in the display.
3. Press and hold the number key that corresponds to the preset you would like to set. Xpress[®] beeps when the channel is stored.

To select a stored preset:

1. Press the **p/d** button until the appropriate "Preset" bank (Preset A, B, or C) appears in the display.
2. Press one of the number keys. Xpress[®] will tune to that channel.

Display

Press the **display** button to change the way you view the content on the display. There are 4 different display modes.

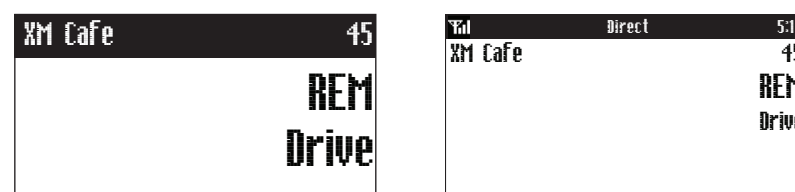

Display mode 1
(single channel large font)

Display mode 2 (single channel)



Xpress[®]



quick guide
XMCK20

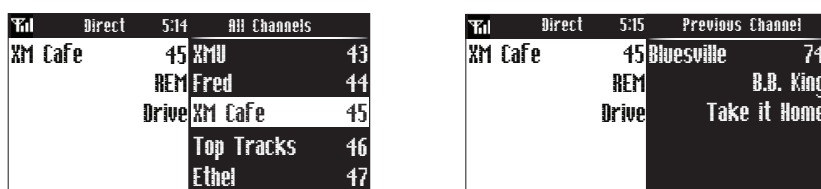

Display mode 3 (split screen with 6 channels)

Display mode 4
(split screen with previous channel)

30-Minute Replay

30-Minute Replay gives you the opportunity to "hear that again." This feature applies to the current listening session only. Turning your Xpress[®] off removes all tracks from the up-to-30 minute buffer.

Both display modes 3 and 4 display a list of replayed tracks. To navigate through the "replay list", you can either rotate the knob and press the **XM** button or press the replay buttons to make a selection.

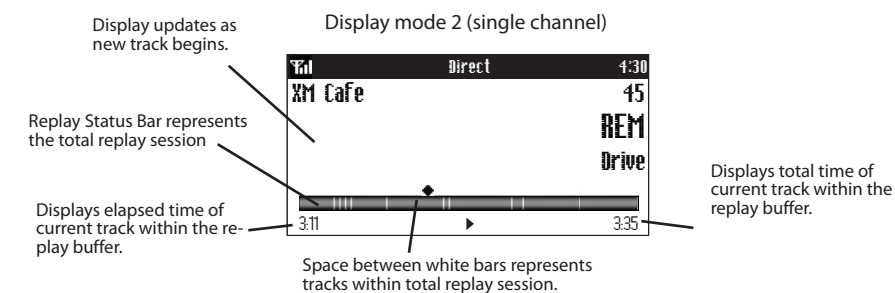

Navigating Replay

1. Press the **◀** button. If a track has been playing for less than 5 seconds, Xpress[®] rewinds to the beginning of the previous track. If the track has been playing for longer than 5 seconds, Xpress[®] rewinds to the beginning of the current track. Upon entering the replay buffer, Xpress[®] will display "Replay" on the display.
2. Pressing the **◀** button again skips backward to previous track in the order they played. Xpress[®] allows you to access up to 30 minutes of previously listened to live broadcast. Press and hold **◀** for 3 seconds to skip to the beginning of your replay list.
3. Pressing the **▶** button skips forward in the track list.
4. To exit 30-Minute Replay and return to the live XM broadcast, press and hold the **▶** button for 3 seconds; Xpress[®] will display "LIVE" on the display.

To Pause a Track

1. Press the **⏸** button. The pause icon appears in the display.
2. To resume playback from where you had paused, press the **⏸** button again.
3. To return to the live XM broadcast, press and hold the **▶** button until Xpress[®] beeps and displays "LIVE" on the screen.

Menu Options

When your Xpress[®] is in the car cradle (and using either SureConnect or FM Direct accessory to transmit audio), and you press **Menu**, your display will look like this:

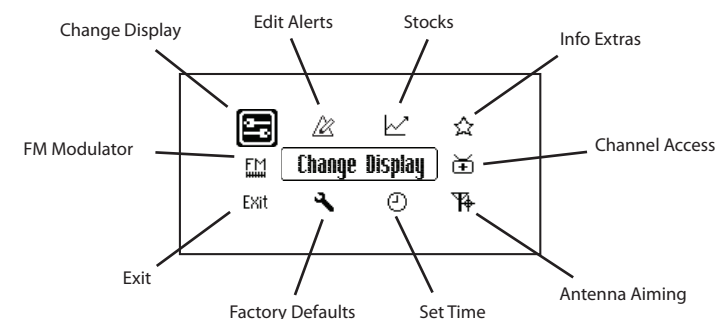

Note: pressing the **Menu** or toggling the knob left, allows you to back out of any menu.

For more information on Menu Options, please refer to your Xpress[®] user guide.

Customer Support

Activate your XM subscription online <http://activate.xmradio.com> or by phone 1 800 XM RADIO (1-800-967-2346)

If your Xpress[®] does not work the way you expect, first consult the troubleshooting section of your Xpress[®] user guide. If the problem persists please contact Listener Care at 1 800 XM RADIO (1-800-967-2346).

FCC Statement

Please note that the power cable that has been supplied with your device is supplied with permanently attached ferrite beads. It is the responsibility of the user to use the power cable with the ferrite beads.

The user is cautioned that changes or modifications not expressly approved by XM Satellite Radio Inc. can void the user's authority to operate this device.

This device complies with Part 15 of the FCC Rules. Operation is subject to the following two conditions:

- (1) This device may not cause harmful interference.
- (2) this device must accept any interference received, including interference that may cause undesired operation.

This equipment has been tested and found to comply with the limits for a Class B digital device, pursuant to Part 15 of the FCC Rules. These limits are designed to provide reasonable protection against harmful interference in a residential installation.

This equipment generates, uses, and can radiate radio frequency energy and, if not installed and used in accordance with the installation instructions, may cause harmful interference to radio communications. However, there is no guarantee that interference will not occur in a particular installation. If this equipment does cause harmful interference to radio or television reception, which can be determined by turning the equipment off and on, the user is encouraged to try to correct the interference by one or more of the following measures:

- Reorient or relocate the receiving antenna of the affected receiver.
- Increase the separation between the XM equipment and the affected receiver.
- Connect the XM equipment into an outlet on a circuit different from that to which the affected receiver is connected.
- Consult the dealer or an experienced radio/TV technician for help.

Warning: The FCC and FAA have not certified this Satellite Radio Receiver for use in any aircraft (neither portable nor permanent installation). Therefore, XM Satellite Radio cannot support this type of application or installation