



ROADY BT

SATELLITE RADIO DESIGNED FOR IN-VEHICLE USE

USER GUIDE



Scan here
for activation
offers

Introduction	3
Features	3
Safety and Care Information	4
What's in the Box?	5
Roady BT Button Functions and Connections	6
Installation	8
Step 1: Choose a Location for Your Radio	8
Step 2: Install the Dash or Vent Mount	9
Step 3: Mount the Magnetic Mount Antenna	11
Step 4: Route the Antenna Cable	13
Step 5: Connect the Magnetic Mount Antenna and Display Cable	18
Step 6: Connect the Audio	19
Activation	29
General Activation and Subscription	29
On-Board Activation Guide	29
Using Your Roady BT	30
Navigation Basics	30
Now Playing Screen	31
Returning to the Now Playing Screen	32
Tuning to a Channel	32
Jump	32
Direct Tune	32
Categories	32
Favorite Channels	34
Pause & Replay	35
Song/Artist Alerts	36
Game Alerts	39
My Sports Zone	42
xL Lock	43
Day/Night Brightness Selection	45
Night Comfort Mode	45
TuneStart	46
Configuring Your Roady BT	47
Radio ID	47
Online Product Support	47
Audio Settings	48
Display Settings	51
Channel Browsing/Tuning Settings	52
Feature Settings	53
xL Lock Setting	54
Signal Indicator	54
Auto Shut Off	54
Factory Settings	55
Software Update	55
Demo Mode	56
Regulatory Information	57
Troubleshooting	58
Product Specifications	60
Patent and Environmental Information	61
FCC Statements	62
Copyrights and Trademarks	63

Features

Thank you for purchasing Roady BT!

SiriusXM Roady BT has these exciting features to enhance your overall listening experience:

- Hear SiriusXM through your existing vehicle stereo with easy, do-it-yourself installation¹
- Very neat installation - only a single wire solution from the Display Control Unit (DCU) to the Intelligent Power Adapter (IPA)
- Newly designed magnetic mounting solution for the display (DCU) using the in-box vent and dash mounts, or other aftermarket mounting solutions (purchased separately)
- Antenna, and optional AUX or FM cable connections, are made to the IPA
- Bluetooth® audio streaming to in-vehicle audio systems
- AUX and FM audio connection options (FM requires the use of the SiriusXM FM Direct Adapter sold separately)
- View artist or show name, song or program title and content or channel information on an easy-to-read large high-resolution full color display
- Single button access to day or night screen brightness setting
- Store up to 20 of your favorite channels for one touch access
- Song, Artist, and Game Alerts (up to 50)
- Pause, Rewind, and Replay of the current channel (live broadcast and smart favorite channels)
- Easily lock and unlock channels with mature content
- Browse what's playing on other channels while listening to the current one
- One-Touch Jump™ to the previous channel to which you were listening
- Listen in multiple vehicles, at home, in the office or outdoors - all with just one subscription
- Compatible with the SiriusXM Remote Control 2.0
- Works on the XM network and receives all SiriusXM audio packages

Please review this User Guide to familiarize yourself with Roady BT!

¹. Requires Aux In or Bluetooth capability. Use the included Aux Audio Cable if your vehicle has Aux In capability for best performance..

Safety and Care Information



IMPORTANT! Self installation instructions and tips are provided for your convenience. It is your responsibility to determine if you have the knowledge, skills, and physical ability required to properly perform an installation. SiriusXM shall have no liability for damage or injury resulting from the installation or use of any SiriusXM or third party products. It is your responsibility to ensure that all products are installed in adherence with local laws and regulations and in such a manner as to allow a vehicle to be operated safely and without distraction. SiriusXM product warranties do not cover the installation, removal or reinstallation of any product.

- Do not expose to extreme temperatures (above 140°F or below -4°F, or above 60°C or below -20°C).
- Do not expose to moisture. Do not use device near or in water. Do not touch the device with wet hands.
- Do not let any foreign matter spill into device.
- Do not store in dusty areas.
- Do not expose to chemicals such as benzene and thinners. Do not use liquid or aerosol cleaners. Clean with a soft damp cloth only.
- Do not expose to direct sunlight for a prolonged period of time, and do not expose to fire, flame, or other heat sources.
- Do not try to disassemble and/or repair device yourself.
- Do not drop your device or subject it to severe impact.
- Do not place heavy objects on device.
- Do not subject device to excessive pressure.
- If the LCD screen is damaged, do not touch the liquid crystal fluid.

Warning!

- Opening the case may result in electric shock.
- If the liquid crystal fluid comes in contact with your skin, wipe the skin area with a cloth and then wash the skin thoroughly with soap and running water. If the liquid crystal fluid comes into contact with your eyes, flush the eyes with clean water for at least 15 minutes and seek medical care. If the liquid crystal fluid is ingested, flush your mouth thoroughly with water. Drink large quantities of water, and induce vomiting. Seek medical care.
- Make sure that you insert the Intelligent Power Adapter all the way into the vehicle's cigarette lighter or power adapter socket.
- When using this product, it is always important to keep your eyes on the road and hands on the steering wheel. Not doing so could result in personal injury, death, and/or damage to your device, accessories, and/or to your vehicle or other property.
- Vehicle installation, service activation, and Radio configuration functions should not be performed while driving. Park your vehicle in a safe location before beginning installation.
- This product contains chemicals known to the State of California to cause cancer and birth defects or other reproductive harm.
- Your device should be placed in your vehicle where it will not interfere with the function of safety features, e.g., deployment of airbags. Failure to correctly place device may result in injury to you or others, if the unit becomes detached during an accident and/or obstructs the deployment of an airbag.

What's in the Box?

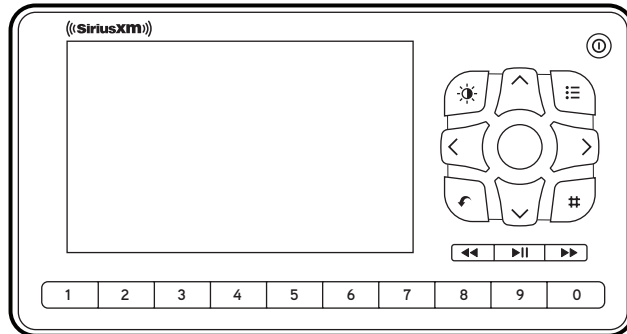

Roady BT Radio

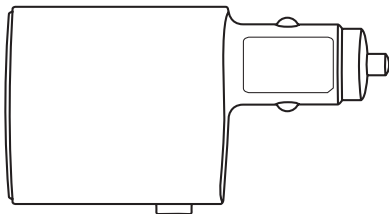

Intelligent Power Adapter

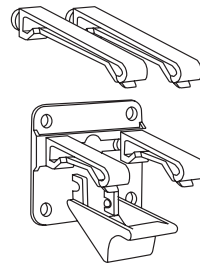

Vent Mount and
Extended Vent Clamps

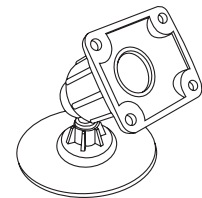

Dash Mount



Aux Audio Cable

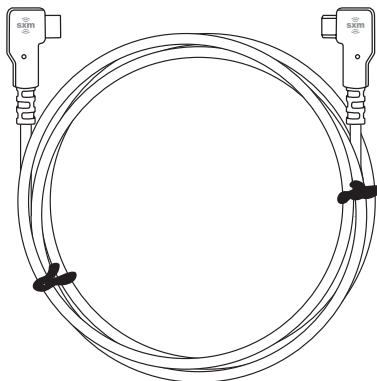

Display Cable

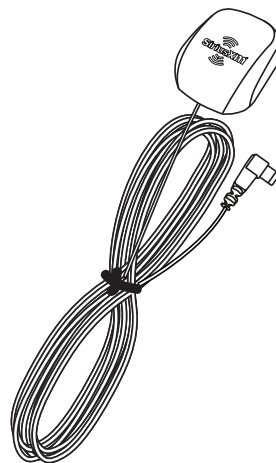

Magnetic Mount Antenna



Magnetic
Adapter

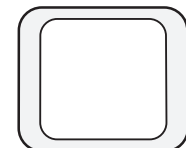

Extra
Adhesive



Antenna Alcohol
Preparation Pads

Roady BT Button Functions and Connections

Roady BT Button Functions

Day/Night Brightness Button

Press to toggle between day and night brightness setting; **press and hold** to enter display settings in the menu.

Up and Down Buttons

Press to preview and tune to channels through the channel lineup; **press and hold** to continuously scroll through channels; also **press** to scroll through lists and highlight items in lists.

Power Button

Press to turn Radio on and off.

Menu Button

Press to access advanced features and configuration options; when in configuration options, **press and hold** to return to Now Playing screen.

Left and Right Buttons

Press to search for channels by category; **press and hold** to continuously scroll through categories.

Select Button

Press to confirm selection of highlighted item in a menu or list; **press and hold** to set a Song, Artist, or Game Alert at the Now Playing screen.

Favorite Bank/Direct Tune Button

Press to toggle between favorite banks A & B; **press and hold** to enter Direct Tune and enter a channel number to tune.

Play/Pause, Rewind, Fast-Forward Buttons

Play/Pause: Press to pause or resume playing the channel; **press and hold** to jump to live.

Rewind: Press to skip back to the beginning of the song/segment; **press and hold** to continuously skip back.

Fast-Forward: Press to skip forward when listening behind live broadcast; **press and hold** to continuously skip forward when listening behind live broadcast.

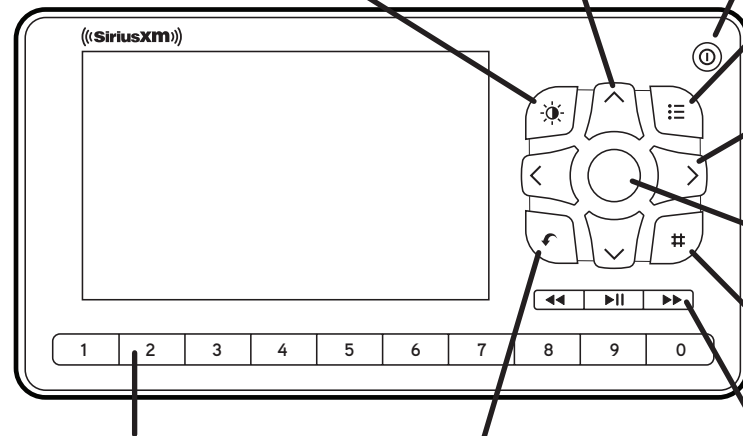

Number Buttons

Press to tune to a stored favorite channel; **press and hold** to store a favorite channel. Also used to enter channel numbers when the Direct Tune button is pressed.

Jump Button

Press to go back to the previous channel to which you were listening.

Roady BT Connections

Roady BT Side View

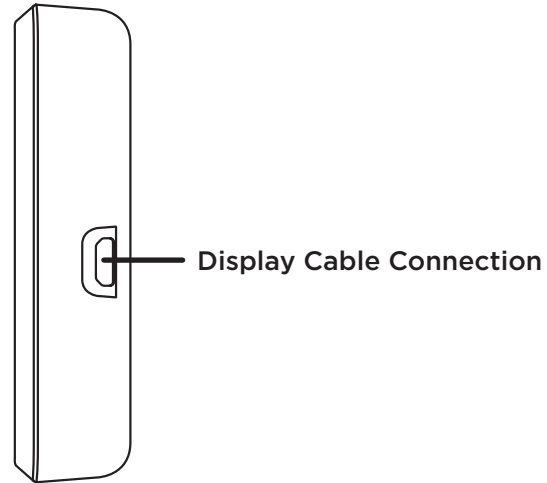

**Intelligent Power Adapter
Rear View**

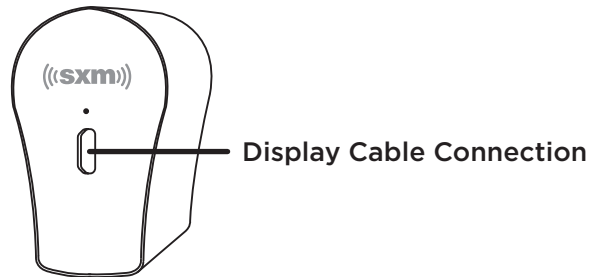

**Intelligent Power Adapter
Side View**

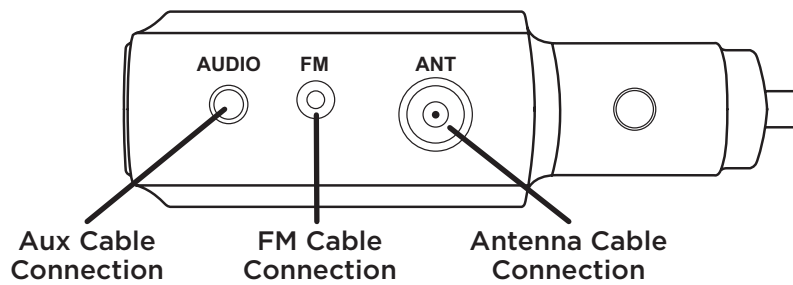

WARNING! DO NOT attempt to install Roady BT while driving. Park your vehicle in a safe location before beginning installation.

Step 1: Choose a Location for Your Radio

When installing Roady BT in your vehicle, choose a location where it will not block your vision, interfere with the controls, or obstruct the air bag. The location should be easily accessible and provide good visibility of the display, and should not be located where it will be in direct sunlight, which will affect the visibility of the display screen.

Several examples of Roady BT mounted in a vehicle are shown: **A** is the on dash method using the Dash Mount, and **B** is the vent clip method using the Vent Mount.

Option 1

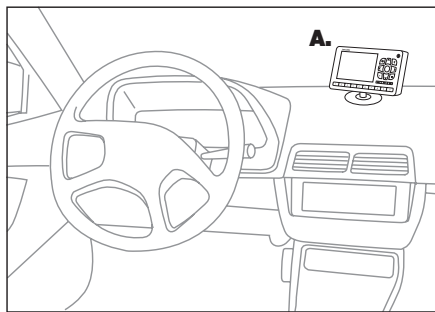

Option 2

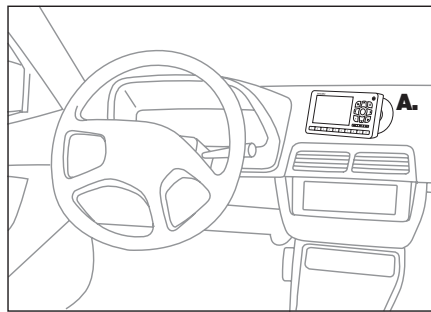

Option 3

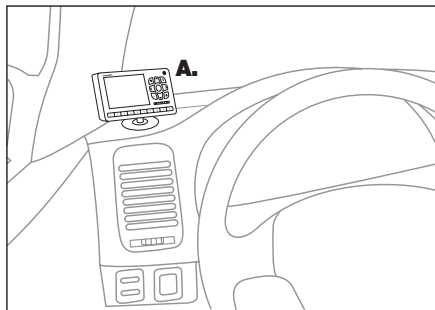

Option 4

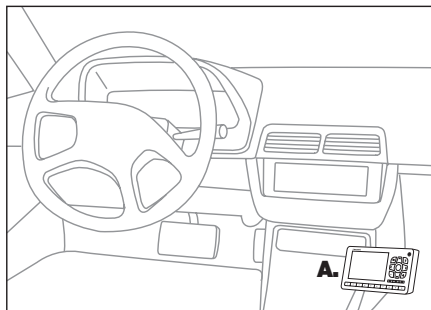

Option 5

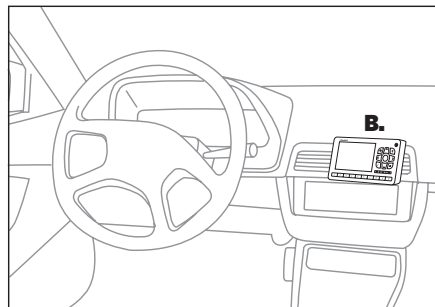

Option 6

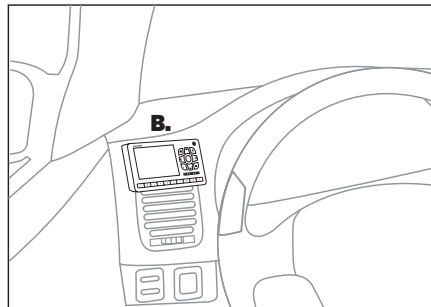

Step 2: Install the Dash or Vent Mount

Follow the instructions on the next several pages for the mounting method you have selected.

Installing the Adhesive Mount



CAUTION! The adhesive used on the Adhesive Mount may be difficult to remove. Do not install this mount on leather surfaces (contact your automobile dealership if you are unsure about your dash surface), and make sure the air temperature is at least 60°F (15°C) during installation. If it's not at least 60°F, turn on the heater in your vehicle to bring the temperature up to 60°F.

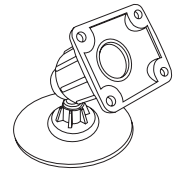

1. Locate a flat surface for the Adhesive Mount. Make sure there is ample room for the Intelligent Vehicle Dock and Roady BT Radio when installed.
2. Set the orientation of the Adhesive Mount before adhering it. Loosen the knob and adjust the adhesive foot for the location you selected in "Step 1: Choose a Location for Your Radio" on page 8.

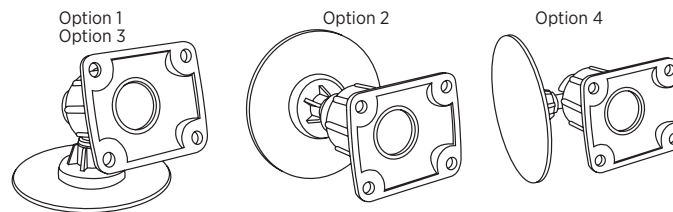

3. The dock mounting plate can be tilted in different directions. Adjust as necessary for your particular vehicle. When the orientation is correct, tighten the knob.

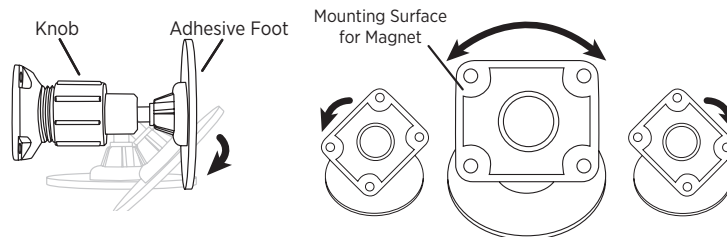

4. Remove the adhesive liner from the back of the Magnet and adhere the adhesive side of the Magnet to the Dash Mount.
5. Clean the mounting surface in the vehicle with the alcohol preparation pad and let it dry thoroughly.
6. Once the surface is dry, remove the adhesive liner from the Dash Mount. Press and hold the Dash Mount in place for 30 seconds. Allow the adhesive to cure for 2-4 hours.
7. Attach the Roady BT Display to the magnet on the Dash Mount.

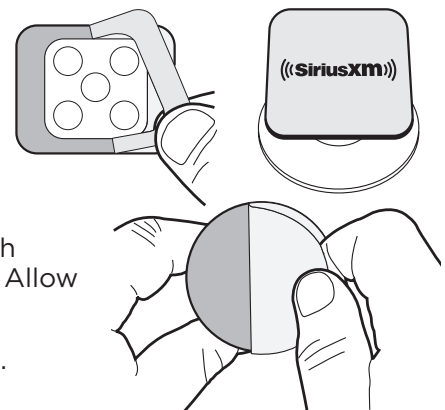

IMPORTANT! Allow the Adhesive Mount adhesive to cure (dry) for a minimum of 2-4 hours before using the mount. The best adhesion occurs after 24 hours.



TIP! To remove the Adhesive Mount, carefully lift the adhesive pad with your fingers or a spoon. Warming the pad with a hair dryer for several minutes will help soften the adhesive.

Installing the Vent Mount

1. Locate a vent with horizontal louvers sturdy enough to hold the Roady BT Radio.
2. If the vent louvers in your vehicle are recessed, you may need to use the longer vent clamps with the Vent Mount. If so, remove the shorter vent clamps and install the longer ones into the Vent Mount. Be sure to observe the orientation of the vent clamps as shown, and replace both vent clamps.

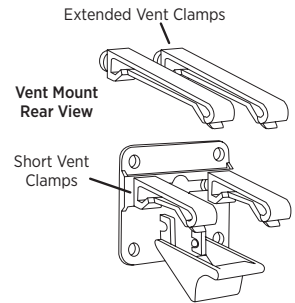

Vent Mount Rear View

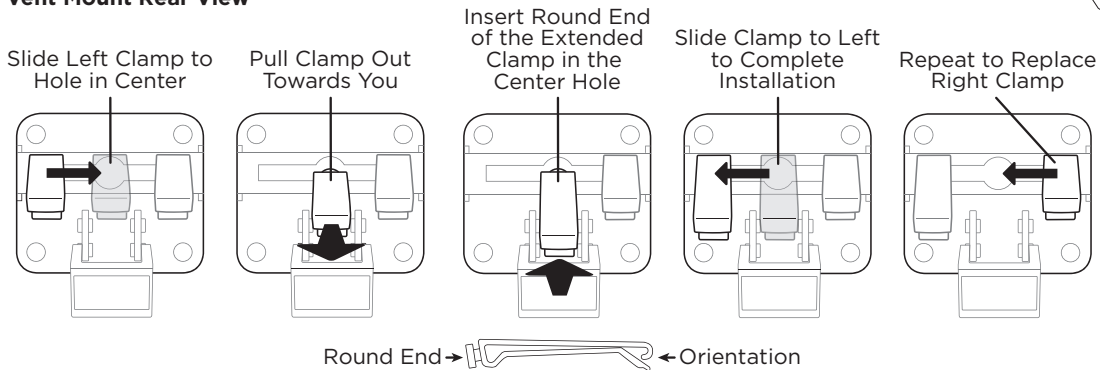

3. Remove the adhesive liner from the back of the Magnet and adhere the adhesive side of the Magnet to the Vent Mount.

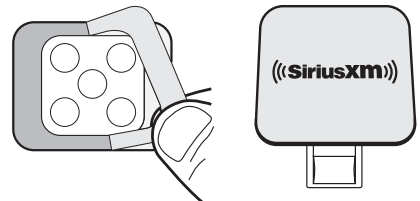

4. Install the Vent Mount onto the vehicle vent.
 - i. Insert the vent mount into the vent opening.
 - ii. Push until hooked on the rear of the vent louver. Rest the foot against the bottom of the vent.
 - iii. If necessary, adjust the tilt of the Vent Mount by repositioning the foot to a different tilt adjustment hole.

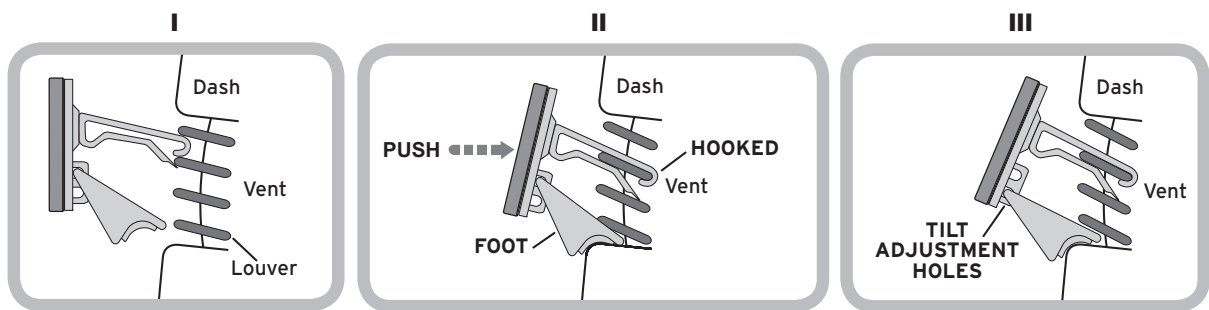

5. Attach the Roady BT Display to the magnet on the Vent Mount.



TIP! To remove the Vent Mount, push the mount into the vent. Then lift up until disengaged from the rear of the vent louver, and remove the Vent Mount.

Step 3: Mount the Magnetic Mount Antenna

Mount the Magnetic Mount Antenna on the outside of your vehicle, on a horizontal surface that will always face the sky. The antenna contains a strong magnet which will stick to any metal part of your vehicle, but will not damage the vehicle.

1. Choose the best location for your antenna considering your vehicle type. Pay particular attention to any accessories that you may have like luggage racks and how frequently you may use them.
2. **Sedan/Coupe:** We recommend mounting the antenna just above either the front windshield or the back window as shown.

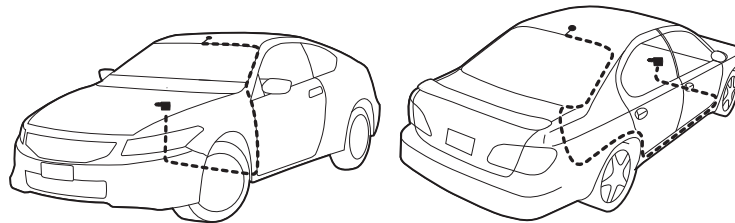

3. **SUV:** We recommend mounting the antenna at the rear of the roof as shown.

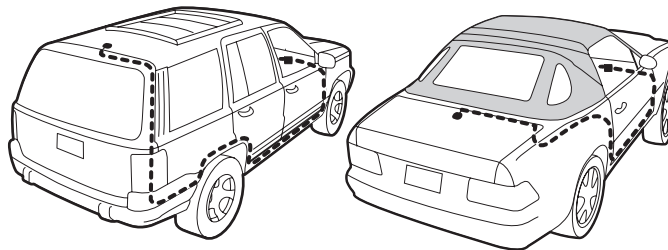

4. **Convertible:** We recommend mounting the antenna at the leading edge of the trunk as shown.
5. **Pickup Truck:** We recommend mounting the antenna just above the front windshield as shown.

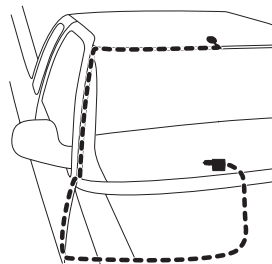

IMPORTANT! Consult a professional installer if your vehicle roof or hood is non-metallic (i.e., fiberglass), or you have difficulty finding a location for your antenna.

6. Clean the surface of the selected mounting location using the alcohol preparation pad and let it dry thoroughly.

7. Place the antenna in the location you selected. Follow the Tips and Cautions shown below.



TIP! Mount the antenna on the roof (for most vehicles) or trunk (for convertibles) where it has a clear view of the sky in all directions

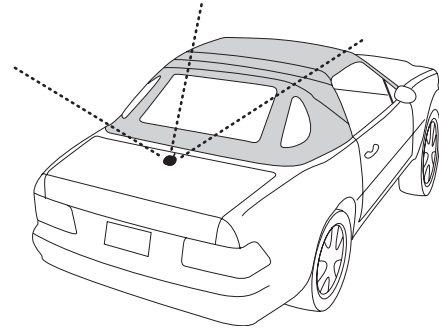
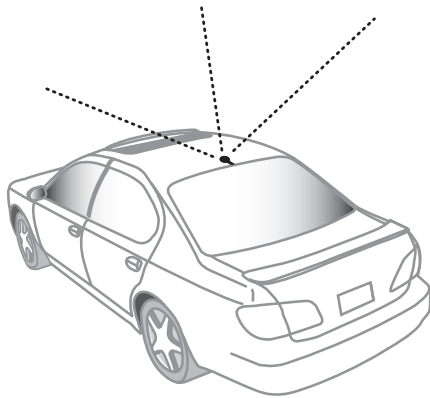

CAUTION! Don't mount the antenna inside the vehicle, for example, on the dashboard.

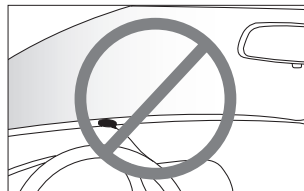

CAUTION! Don't mount the antenna on any of the vehicle's front, back or side pillars.

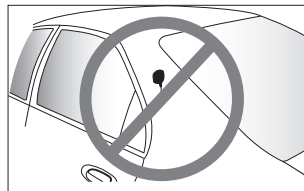

CAUTION! Don't mount the antenna close to a roof rack. Adjust the rack so it's further away from the antenna or move the antenna closer to the center of the roof.



CAUTION! Don't mount the antenna close to another antenna. Mount it at least 3 inches away.

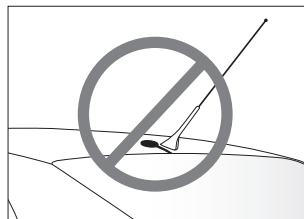

Step 4: Route the Antenna Cable

Before you begin routing the antenna cable, read these general instructions for how to route and hide the antenna cable. Then route your antenna cable according to the step-by-step instructions which follow for your specific type of vehicle.

Use care when routing the antenna cable into and through the vehicle interior, avoiding sharp objects that can damage the cable. Keep the antenna cable away from moving parts such as gas, clutch, and brake pedals, trunk and door hinges, and sliding seat brackets. Hide the antenna wire inside the vehicle cabin by routing the cable under the carpet and behind plastic trim, toward the Tuner Module location. Coil and secure any excess cable in a hidden location, such as under the carpet, using wire ties (not included). **CAUTION!** Do not kink or sharply fold the antenna cable.

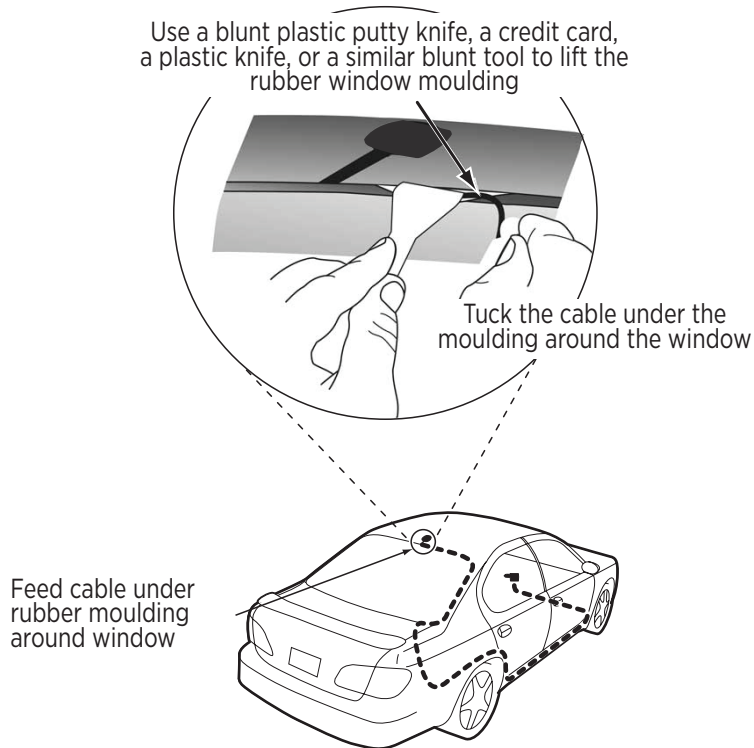

Route cable out from under rear windshield moulding and tuck into weatherstripping around trunk opening
Avoid sharp bends by running cable through weatherstripping for several inches

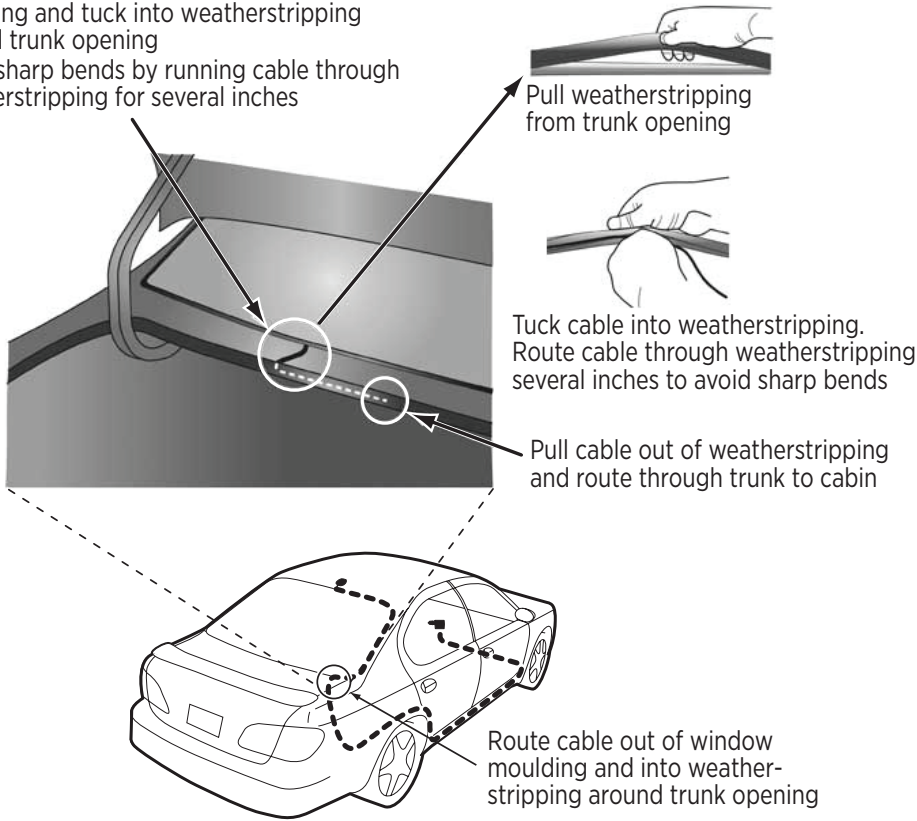

Bring cable out of weatherstripping and into trunk

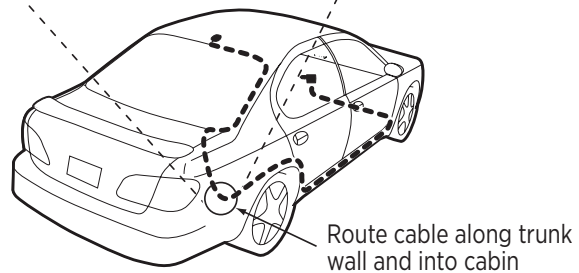
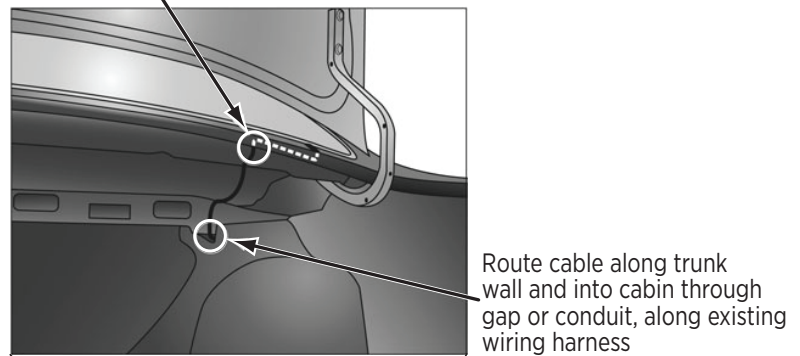

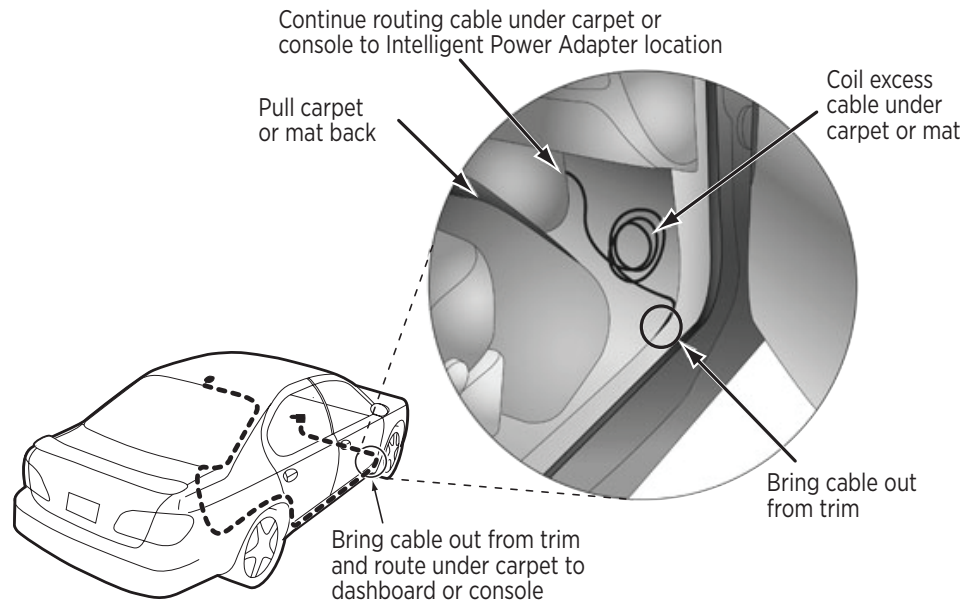
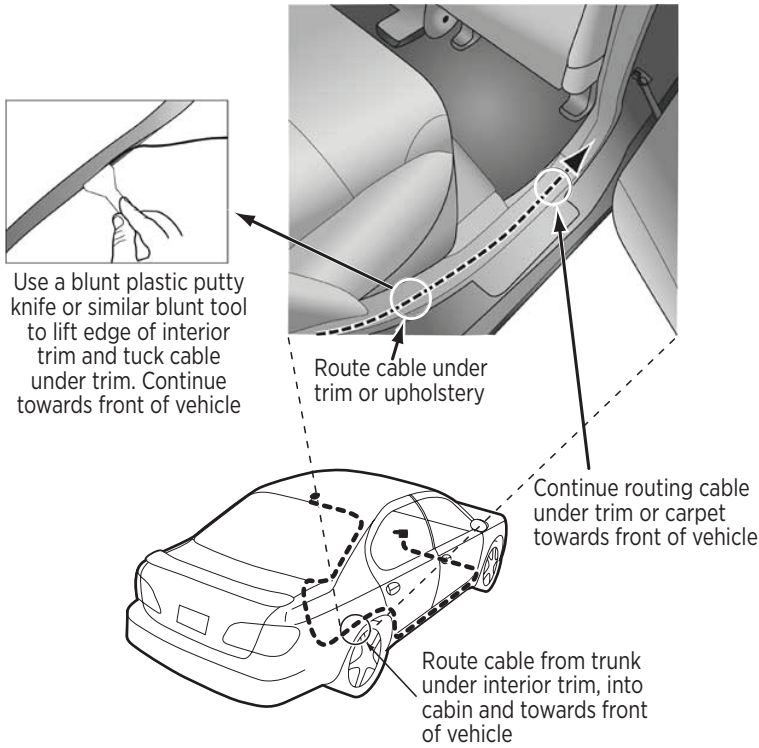

TIP! Always be careful to include enough slack in your cable to accommodate open doors or trunk lids. Use things typically found around the home, like electrical tape, to secure cables in areas so that hinges do not pinch the cable with the door. Hide any excess cable in the trim.

Sedan/Coupe With Antenna Placed at the Rear of the Roof:

1. Feed the antenna cable from the antenna underneath the rubber molding around the rear window. Use a blunt plastic putty knife or similar blunt tool to lift the rubber molding around the rear window and tuck the antenna cable underneath the molding. Route the antenna cable around and down the window to the lowest point. If your rear window does not have rubber molding, we recommend consulting a professional installer.
2. Route the antenna cable out of the window molding and into the rubber weather stripping around the trunk opening. Lift the weather stripping from the opening and tuck the cable inside it, then replace the weather stripping. To avoid sharp bends in the cable, run the cable inside the weather stripping for a few inches, then remove the cable from the weather stripping inside the trunk. Keep the cable away from hinges, gears, etc., that could damage it.
3. Route the cable out from the rubber weather stripping and along the trunk wall. Continue routing the cable into the vehicle cabin through a conduit or along an existing wiring harness.
4. Route the cable through the main cabin area under the interior trim, towards the front of the vehicle. Use a blunt plastic putty knife or similar blunt tool to lift the plastic trim just enough to tuck the cable under underneath. Avoid side airbag locations on back pillars and above the doors. Airbag locations are marked with “SRS” logos. Be careful not to crimp or cut the cable.
5. Bring the cable out from the trim near the front of the cabin and route it under the carpet toward the dashboard or console. Coil any excess cable in a hidden location, such as under the carpet, keeping it away from any vehicle pedals or controls. Secure the excess cable with wire ties (purchased separately).
6. Bring the end of the cable out at the Intelligent Vehicle Dock location. Leave yourself enough cable so you can easily connect it to the antenna connector of the dock.
7. Continue with “Step 5: Connect the Magnetic Mount Antenna and Display Cable” on page 18.

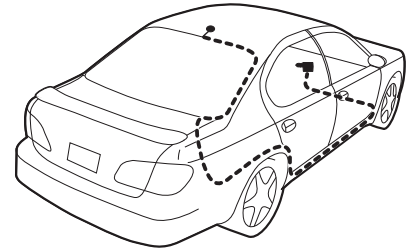

Sedan/Coupe With Antenna Placed at the Front of the Roof:

1. Feed the antenna cable from the antenna underneath the rubber molding around the windshield. Use a blunt plastic putty knife or similar blunt tool to lift the rubber molding around the windshield and tuck the antenna cable underneath the molding. Route the antenna cable around and down the windshield to the lowest point.
2. At the lowest corner of the windshield, route the cable out of the windshield molding and into the rubber weather stripping around the door opening. Lift the weather stripping from the opening and tuck the cable inside it, then replace the weather stripping. Run the cable inside of the weather stripping to the bottom of the door opening.
3. Pull the cable out of the weather stripping at the bottom of the door opening and route it under the carpet toward the dashboard. Coil any excess cable in a hidden location, such as under the carpet, keeping it away from any vehicle pedals or controls. Secure the excess cable with wire ties.
4. Bring the end of the cable out at the Intelligent Vehicle Dock location. Leave yourself enough cable so you can easily connect it to the antenna connector of the dock.
5. Continue with “Step 5: Connect the Magnetic Mount Antenna and Display Cable” on page 18.

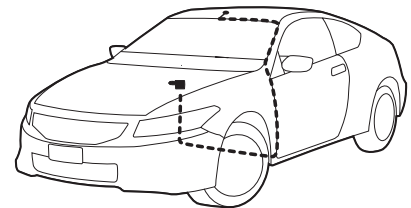

Sport Utility Vehicle (SUV)

1. Feed the antenna cable underneath the rubber weather stripping of the rear tailgate window/door and route the cable along the rear hatch. Lift the weather stripping from the opening and tuck the cable inside it, then replace the weather stripping. Pull the cable out from weather stripping and route it into the cabin under the interior trim. Avoid hinges or gears that could crimp or cut the cable.
2. Route the cable through the SUV's main cabin area under the interior trim, towards the front of the vehicle. Use a blunt plastic putty knife or similar blunt tool to lift the plastic trim just enough to tuck the cable under underneath. Avoid side airbag locations on back pillars and above the doors. Airbag locations are marked with "SRS" logos. Be careful not to crimp or cut the cable.
3. Bring the cable out from the trim near the front of the cabin and route it under the carpet toward the dashboard or console. Coil any excess cable in a hidden location, such as under the carpet, keeping it away from any vehicle pedals or controls. Secure the excess cable with wire ties (purchased separately).
4. Bring the end of the cable out at the Intelligent Vehicle Dock location. Leave yourself enough cable so you can easily connect it to the antenna connector of the dock.
5. Continue with "Step 5: Connect the Magnetic Mount Antenna and Display Cable" on page 18.

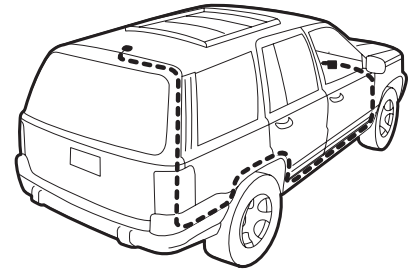
**Convertible**

1. Bring the antenna cable from the antenna into the trunk at the front edge of the trunk lid. Keep any bends in the cable loose. Tape or tie the cable along the inside of the trunk lid to the trunk lid hinge strut.
2. Allow enough slack in the cable so the trunk lid can easily open and close and keep the cable away from hinges, gears, etc., that could crimp or cut it. Route the cable along the trunk wall and into the cabin through a conduit or along an existing wiring harness.
3. Route the cable through the main cabin area under the interior trim, towards the front of the vehicle. Use a blunt plastic putty knife or similar blunt tool to lift the plastic trim just enough to tuck the cable under underneath. Avoid side airbag locations on back pillars and above the doors. Airbag locations are marked with "SRS" logos. Be careful not to crimp or cut the cable.
4. Bring the cable out from the trim near the front of the cabin and route it under the carpet toward the dashboard or console. Coil any excess cable in a hidden location, such as under the carpet, keeping it away from any vehicle pedals or controls. Secure the excess cable with wire ties (purchased separately).
5. Bring the end of the cable out at the Intelligent Vehicle Dock location. Leave yourself enough cable so you can easily connect it to the antenna connector of the dock.
6. Continue with "Step 5: Connect the Magnetic Mount Antenna and Display Cable" on page 18.

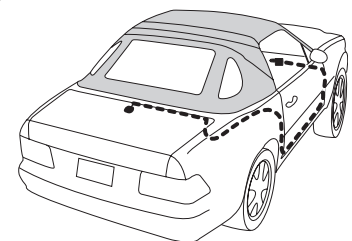
**Pickup Truck**

1. Use a blunt plastic putty knife or similar blunt tool to lift the rubber molding around the windshield and tuck the antenna cable underneath it.
2. Continue tucking the cable underneath the windshield molding around the windshield to the

lowest corner.

3. At the lowest corner of the windshield, route the cable out of the windshield molding and into the rubber weather stripping around the door opening. Lift the weather stripping from the opening and tuck the cable inside it, then replace the weather stripping. Run the cable inside of the weather stripping to the bottom of the door opening.
4. Pull the cable out of the weather stripping at the bottom of the door opening and route it under the carpet toward the dashboard. Coil any excess cable in a hidden location, such as under the carpet, keeping it away from any vehicle pedals or controls. Secure the excess cable with wire ties.
5. Bring the end of the cable out at the Intelligent Vehicle Dock location. Leave yourself enough cable so you can easily connect it to the antenna connector of the dock.
6. Continue with “Step 5: Connect the Magnetic Mount Antenna and Display Cable” on page 18.

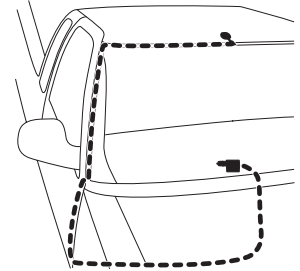

Step 5: Connect the Magnetic Mount Antenna and Display Cable

1. Plug the Magnetic Mount Antenna connector into the **ANT** connector on the Intelligent Power Adapter.
2. Connect one end of the Display Cable to the Intelligent Power Adapter and the other end to the Roady BT display.
3. Insert the Intelligent Power Adapter into your vehicle's cigarette lighter or power adapter socket.
4. Roady BT should power on automatically. If not, press the **Power button** on Roady BT to turn it on.

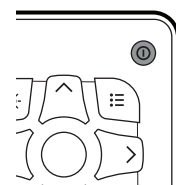
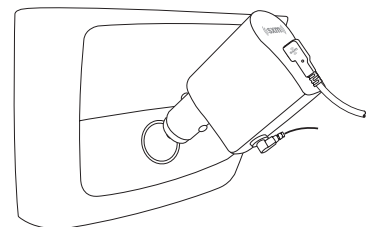
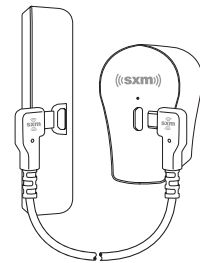
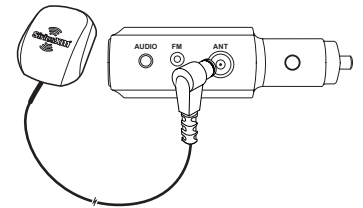

Step 6: Connect the Audio

To play the SiriusXM audio through your vehicle's radio/headunit, decide on one of the following audio connection options:

- **Option 1: Best:** Use the provided **Aux Audio Cable** if your vehicle's radio/headunit has an auxiliary input connection or jack. Refer to your vehicle's owners manual to find the location of the auxiliary input jack, or consult the vehicle dealer.



TIP! The auxiliary input jack may be located on the face plate of the vehicle radio/headunit, on the back of the radio/headunit, anywhere on the front dash panel, inside the glove compartment, or inside the center console between the front seats.

- **Option 2: Best:** Connect the audio using **Bluetooth** if your vehicle's radio/headunit supports Bluetooth, and supports the Bluetooth audio streaming protocol. If the vehicle radio/headunit supports only the Bluetooth phone protocol, Bluetooth cannot be used for the Roady BT audio connection.
- **Option 3: Good:** Connect the audio using the **FM** feature of Roady BT. If none of the previous two audio connection options will work in your vehicle, then you will need to use the FM Direct Adapter (FMDA) (sold separately). The FMDA needs to be installed by a professional installer and directly connects Roady BT to your vehicle's FM radio. To learn more, check with the retailer where you bought your Roady BT, or go to www.siriusxm.com/accessories.

Follow the installation instructions in the next several sections for the audio connection option that you have selected.

Option 1: Aux Audio Cable Installation Instructions

1. Plug one end of the Aux Audio Cable into the **AUDIO** connector of the Intelligent Power Adapter and the other end into the auxiliary input (Aux or Audio) jack in the vehicle.

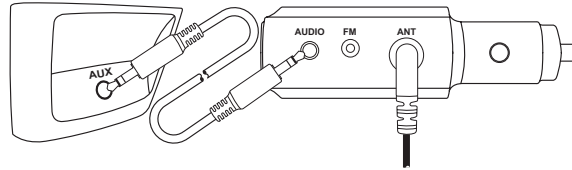

2. Turn on your vehicle's radio/headunit and set it to play from the auxiliary input source.
3. Press **Menu** on Roady BT, and then press ▼ to highlight Audio Settings and press **Select**.
4. **Audio Output** will be highlighted. Press the **Select button** until **AUX** is shown as the selected audio output.

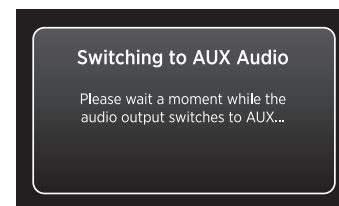
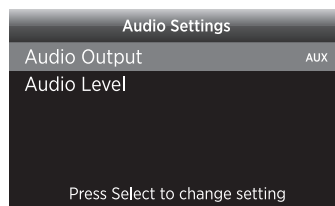
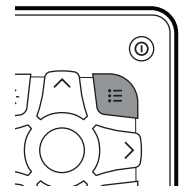

5. Wait a moment while the Aux audio is enabled and then you should hear the SiriusXM audio playing through the radio/headunit.
6. Be sure the vehicle is outside and the antenna has a clear view of the sky. Verify that you are receiving the SiriusXM signal. There should be at least two bars in the upper left corner of the Now Playing screen that denotes antenna signal strength. You can also press **Menu** and then press **down ▼** to scroll to and highlight **Signal Indicator**. Press the **Select button**. The Satellite and Terrestrial bars show the strength of the signal being received. If the signal reception is good, press and hold **Menu** to return to the main display screen.
7. Ensure Roady BT is tuned to channel 1, the SiriusXM Preview channel. Upon power up, Roady BT should tune to channel 1 by default, when it's not yet activated. If it's not on channel 1, refer to "Tuning to a Channel" on page 32 to learn about how to tune a channel.
8. The audio installation is complete. Continue to "Activation" on page 29.

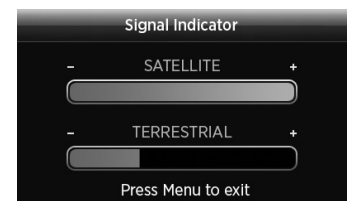
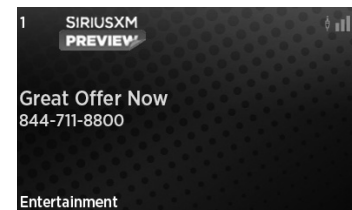

The audio level output of Roady BT can be increased or decreased as necessary to match the audio levels of other sources in your vehicle. Refer to "Audio Level" on page 50.

If the signal reception is good, showing at least two bars in the lower left corner of the display, but there is no SiriusXM audio, be sure the vehicle's radio/headunit is set to the auxiliary input source (step 8). Also be sure that the audio level is set high enough to be heard (step 8). Refer to "Troubleshooting" on page 58 for additional help.

Option 2: Bluetooth Installation Instructions

Important! Roady BT is only compatible with radios and headunits which support the Bluetooth audio streaming protocol. If the vehicle radio/headunit only supports the Bluetooth phone protocol, Bluetooth cannot be used for the Roady BT audio connection.

There are two methods of pairing Roady BT with your radio/headunit:

- A. Pairing from Roady BT to the radio/headunit.** In this method you will place the radio/headunit into pairing mode to passively wait for a pairing request from Roady BT. You will select your radio/headunit from a list of Bluetooth devices that Roady BT has discovered, and complete the pairing and connection to the radio/headunit.
- B. Pairing from the vehicle radio/headunit to Roady BT.** Using this method you will place Roady BT into pairing mode to passively wait for a pairing request from the vehicle radio/headunit. You will select Roady BT from a list of Bluetooth devices that the radio/headunit has discovered, and complete the pairing and connection to Roady BT.

While many vehicle radio/headunits support method **A**, not all do, and you may need to use method **B**.

Begin with “Method A: Bluetooth pairing from Roady BT to the radio/headunit” on page 22. If you discover that Bluetooth pairing must be initiated from your radio/headunit skip ahead to “Method B: Bluetooth pairing from the vehicle radio/headunit to Roady BT” on page 24.

Bluetooth Support

Please be aware that there are many nuances in vehicle radio/headunits as to how each manufacturer has implemented Bluetooth pairing and connection. To help make your Bluetooth installation as easy as possible, SiriusXM has done extensive testing with many different radio/headunits and has provided FAQs with tips and information to assist you if you encounter any difficulties with Bluetooth (and other features).

Using a mobile device such as your phone, scan the following QR code:

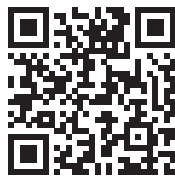

or go to www.siriusxm.com/roadybt-support for additional assistance.

SiriusXM also has a dedicated email where you can receive personalized support from SiriusXM experts: roadybt@siriusxm.com.

Method A: Bluetooth pairing from Roady BT to the radio/headunit

1. Temporarily turn off Bluetooth capability in any devices that you may have with you during the installation, such as a **cellphone**, to avoid other devices connecting to the vehicle's radio/headunit instead of Roady BT.
2. Turn on the vehicle's radio/headunit and place it in Bluetooth pairing mode. Refer to the vehicle owner's manual for instructions on how to do this.
3. Press **Menu** on Roady BT and then, press ▼ to highlight **Audio Settings** and press the **Select button**.
4. **Audio Output** will be highlighted. Press the **Select button** until **Bluetooth** is shown as the selected audio output, and then wait a moment while Bluetooth audio is enabled.
5. Press ▼ to highlight **Bluetooth Settings** and press the **Select button**.

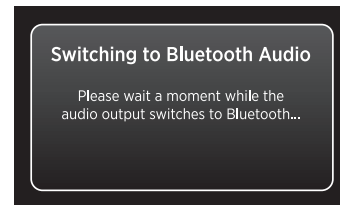
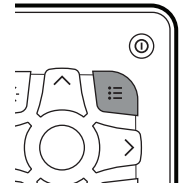

6. Highlight **Add New Bluetooth Device** and press the **Select button**.



7. The **Pair Bluetooth Device** message is displayed. Verify that the vehicle's radio/headunit is on, is discoverable and in pairing mode and press the **Select button** to continue.

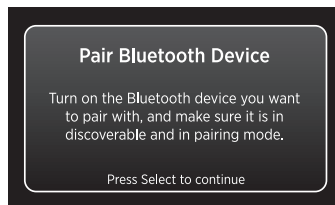

8. Wait as Roady BT searches for discoverable Bluetooth devices. When the vehicle's radio/headunit is shown in the list, press ▼ to highlight the name and press the **Select button**. (If you don't know the Bluetooth name of the radio/headunit, refer to the vehicle owner's manual for the name.)

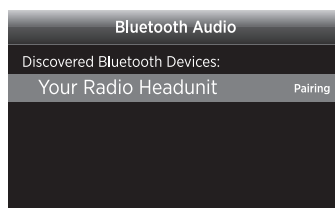

9. Roady BT will begin pairing. During the process you may or may not be prompted to confirm a PIN/Passcode, or enter a PIN/Passcode. If prompted, follow the displayed instructions and confirm or enter the PIN/Passcode.
10. When connected will display a **Successfully Connected** message. If the Bluetooth pairing and connection failed, skip to step 14.

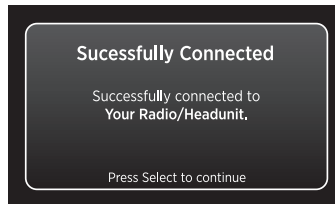

11. Press the **Select button**. Press and hold **Menu** to exit to the Now Playing screen. Wait a moment and then you should hear the SiriusXM audio playing through the radio/headunit.
12. Be sure the vehicle is outside and the antenna has a clear view of the sky. Verify that you are receiving the SiriusXM signal. There should be at least two bars on the upper left corner of the Now Playing screen that denotes antenna signal strength.

You can also press **Menu** and then press **down ▼** to scroll to and highlight **Signal Indicator**. Press the **Select button**. The Satellite and Terrestrial bars show the strength of the signal being received. If the signal reception is good, press and hold **Menu** to return to the main display screen.

13. Ensure Roady BT is tuned to channel 1, the SiriusXM Preview channel. Upon power up, Roady BT should tune to channel 1 by default, when it's not yet activated. If it's not on channel 1, refer to "Tuning to a Channel" on page 32 to learn how to tune a channel.

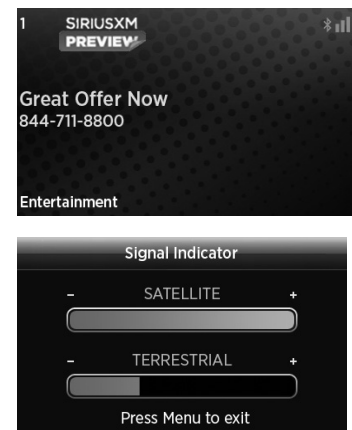

14. The audio installation is complete. Continue to "Activation" on page 29.

Note that the audio level output of Roady BT can be increased or decreased as necessary to match the audio levels of other sources in your vehicle. Refer to "Audio Level" on page 50.

15. If the Bluetooth pairing and connection failed, try again using the alternate Bluetooth Device Class. Follow the steps in "Changing the Bluetooth Device Class" on page 26, and then return here to step 6.

If method **A** was unable to pair and connect Roady BT to your radio/headunit try "Method B: Bluetooth pairing from the vehicle radio/headunit to Roady BT" on page 24. Also refer to "Bluetooth Support" on page 21 for the Roady BT **FAQs** which have the very latest Bluetooth tips and information.

Method B: Bluetooth pairing from the vehicle radio/headunit to Roady BT

1. Temporarily turn off Bluetooth capability in any devices that you may have with you during the installation, such as a cellphone, to avoid other devices connecting to the vehicle's radio/headunit instead of Roady BT.
2. Press **Menu** on Roady BT and then, press ▼ to highlight **Audio Settings** and press the **Select button**.
3. **Audio Output** will be highlighted. Press the **Select button** until **Bluetooth** is shown as the selected audio output, and then wait a moment while Bluetooth audio is enabled.
4. Press ▼ to highlight **Bluetooth Settings** and press the **Select button**.

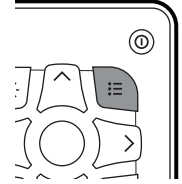

5. Highlight **Add New Bluetooth Device** and press the **Select button**



6. The **Pair Bluetooth Device** message is displayed. Press the **Select button** to continue.

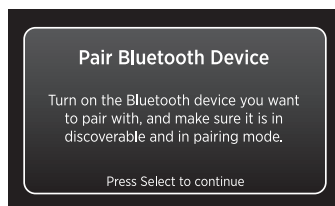

7. Press ▼ to highlight **Pair from headunit/radio** and press the **Select button**. (Note that “Pair from headunit/radio” will not be shown if Roady BT found any Bluetooth devices. That’s OK, just skip this step and continue with the next step.)

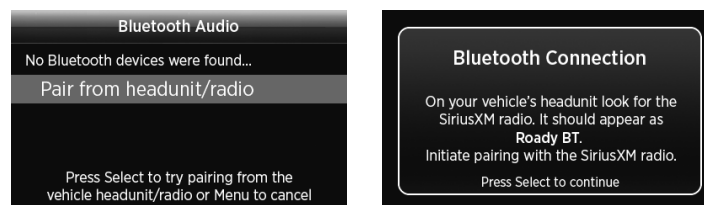

8. Next go to the vehicle's radio/headunit in Bluetooth and initiate pairing. Refer to the vehicle owner's manual for instructions on how to do this. Look for Roady BT in the list of Bluetooth devices and pair and connect to it.

9. Pairing will begin. During the process you may or may not be prompted to confirm a PIN/Passcode, or enter a PIN/Passcode. If prompted, follow the displayed instructions and confirm or enter the PIN/Passcode.
10. If pairing and connection was successful, Roady BT will display a **Successfully Connected** message. If the Bluetooth pairing and connection failed, skip to step 15.

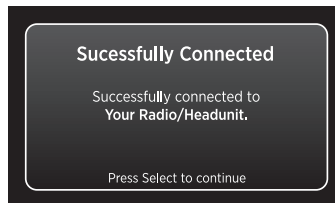

11. Press the **Select button**. Press and hold **Menu** to exit to the Now Playing screen. Wait a moment and then you should hear the SiriusXM audio playing through the radio/headunit.
12. Be sure the vehicle is outside and the antenna has a clear view of the sky. Verify that you are receiving the SiriusXM signal. There should be at least two bars on the upper left corner of the Now Playing screen that denotes antenna signal strength.

You can also press **Menu** and then press **down ▼** to scroll to and highlight **Signal Indicator**. Press the **Select button**. The Satellite and Terrestrial bars show the strength of the signal being received. If the signal reception is good, press and hold **Menu** to return to the main display screen.

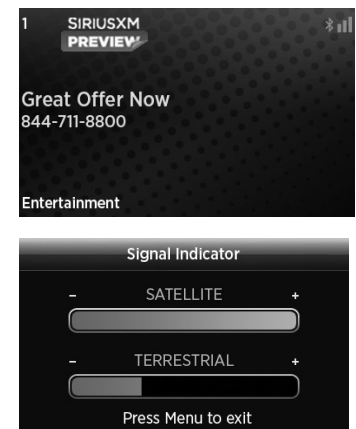

13. Ensure Roady BT is tuned to channel 1, the SiriusXM Preview channel. Upon power up, Roady BT should tune to channel 1 by default, when it's not yet activated. If it's not on channel 1, refer to "Tuning to a Channel" on page 32 to learn how to tune a channel.
14. The audio installation is complete. Continue to "Activation" on page 29.

Note that the audio level output of Roady BT can be increased or decreased as necessary to match the audio levels of other sources in your vehicle. Refer to "Audio Level" on page 50.

15. If the Bluetooth pairing and connection failed try again using the alternate Bluetooth Device Class. Follow the steps in "Changing the Bluetooth Device Class" on page 26, and then return here to step 5.

If you were unable to pair and connect, refer to "Bluetooth Support" on page 21 for the Roady BT **FAQs** which have the very latest Bluetooth tips and information.

Changing the Bluetooth Device Class

If Bluetooth pairing and connection failed you can try again using the alternate Bluetooth Device Class. Switch to the class and then return to Method **A** or **B**.

1. Press **Menu** once or twice to return to the **Bluetooth Audio** screen.



2. Press ▼ to highlight **Bluetooth Device Class** and press the **Select** button.



3. Press the **Select** button again to confirm changing the Bluetooth Device Class to **alternate**.

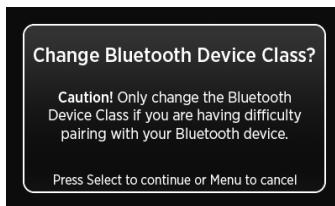

4. For method **A**, continue with step 6 in “Method A: Bluetooth pairing from Roady BT to the radio/headunit” on page 22.

For method **B** continue with step 5 in “Method B: Bluetooth pairing from the vehicle radio/headunit to Roady BT” on page 24.

Option 3: FM Installation Instructions

The FM Direct Adapter (required, and sold separately) should be installed by a professional installer. Professional installation can help improve your Roady BT's reception and significantly reduce the visibility of wires. To learn more, check with the retailer where you bought Roady BT, or go to www.siriusxm.com/accessories.

1. Purchase an FM Direct Adapter (FMDA25) and have it installed by a professional, or install it by following the installation instructions included with the FMDA25.
2. Connect the FM cable from the FMDA25 to the FM connector on the Intelligent Power Adapter.
3. Press **Menu** on Roady BT and then, press ▼ to highlight **Audio Settings** and press the **Select button**.
4. **Audio Output** will be highlighted. Press the **Select button** until **FM** is shown as the selected audio output. Wait a moment while FM audio is enabled.

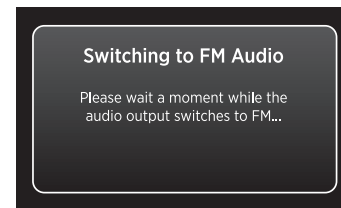
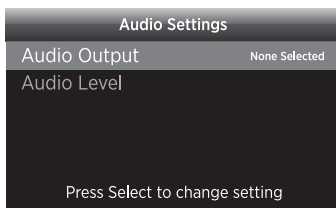
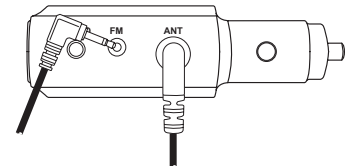

5. Be sure the vehicle is outside and the SiriusXM antenna has a clear view of the sky. Verify that you are receiving the SiriusXM signal. There should be at least two bars in the upper right corner of the Now Playing screen that denotes antenna signal strength.

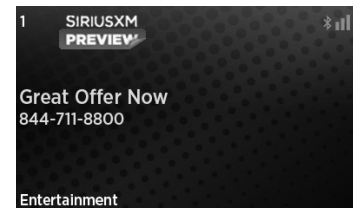

You can also press **Menu** and then press ▼ to scroll to and highlight **Signal Indicator**. Press the **Select button**. The Satellite and Terrestrial bars show the strength of the signal being received. If the signal reception is good, press and hold **Menu** to return to the Now Playing screen.

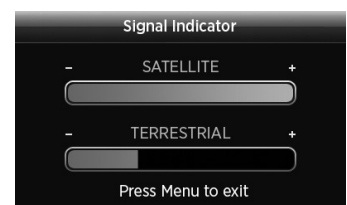

6. You'll first need to find an available FM channel. An available FM channel is one that's not being used by an FM radio station in your area. When you tune your vehicle's FM radio to an available channel, you should only hear static or silence – not talk or music. We recommend one of the following methods to find an available FM channel:

- a. Use the SiriusXM FM Channel Finder at www.siriusxm.com/fmchannel. Go to the website and enter your zip code. The Channel Finder will suggest a list of available FM channels in your area. For convenience, write down or print out the list.

OR

- b. Manually tune through your local FM channels on your vehicle's FM radio. Locate and create a list of channels that aren't being used by any FM radio station. Write down the list. Once you have created your list of available FM channels, you will need to find the one that provides the best match for Roady BT.



TIP! You'll need to use the 'Manual' tune function on your vehicle's FM radio to tune through every FM channel one-by-one. Turn on your vehicle's FM radio. Start at 88.1 and use the 'Manual' tune function on your vehicle's FM radio to tune through each FM channel one-by-one (88.1 followed by 88.3 etc.) to locate channels that aren't being used by a local

FM radio station. Write down each FM channel that has only static or silence on it, until you reach 107.9.

7. Ensure Roady BT is tuned to channel 1, the SiriusXM Preview channel. Upon power up, Roady BT should tune to channel 1 by default, when it's not yet activated. If it's not on channel 1, refer to "Tuning to a Channel" on page 32 to learn about how to tune a channel.
8. Pick the first FM channel on your list from step 6. Turn on your vehicle's FM radio (if you have not already done so) and tune it to this FM channel.

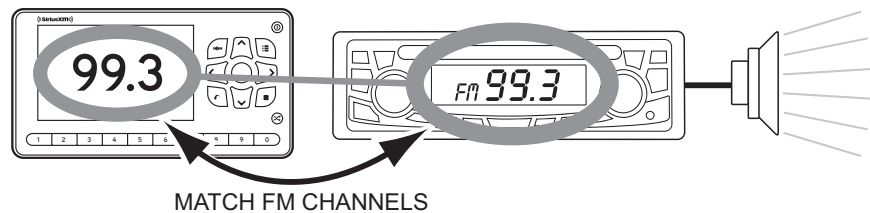

9. Set your Roady BT to transmit on the same FM channel that you have selected in step 8:

- i. Press **Menu**.
- ii. Press ▼ to scroll to and highlight **Audio Settings** and press the **Select button**.
- iii. Press ▼ to scroll to and highlight **FM Channels** and press the **Select button**.
- iv. Press ▼ to scroll to and highlight the storage location **FM 2** and press the **Select button**.
- v. Tune to the available FM channel you choose in step 8. Press ◀ and ▶ to tune in steps of .2, i.e., 99.3 to 99.5. Press ▼ and ▲ to tune in steps of 1, i.e., 99.3 to 100.3. Press the **Select button** to select the FM channel.
- vi. The FM channel you selected will be confirmed on the display screen. Press **Menu**.

FM Channels		
FM 1	97.9	current
FM 2	---	
FM 3	---	
FM 4	---	
FM 5	---	

Press Select to change setting

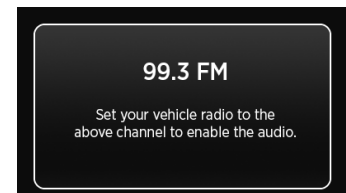

10. You should hear SiriusXM audio through your vehicle's FM radio. If you are satisfied with the sound quality, the audio installation is complete. Continue to "Activation" on page 29.

Note that the audio level output of Roady BT can be increased or decreased as necessary to match the audio levels of other sources in your vehicle. Refer to "Audio Level" on page 50.

11. If the selected FM channel doesn't work well for you, work down the list of FM channels until you find one with which you are satisfied. Each time, you will need to tune your vehicle's FM radio to the FM channel and then set your Roady BT to transmit on the same FM channel (steps 8 & 9).

If the signal reception is good, showing at least two bars in the lower left corner of the display, but there is no SiriusXM audio, verify that both Roady BT and your vehicle's FM radio are tuned to the same FM channel (steps 8 & 9). Also ensure the chosen FM channel is a suitable one to use in your area (step 6). Refer to "Troubleshooting" on page 58 for additional help.

You can follow either the General Activation and Subscription Process or use the On-Board Activation Guide to activate your Roady BT and subscribe to the SiriusXM service.

General Activation and Subscription

Subscribe to the SiriusXM service by following these steps:

1. Make sure your Roady BT is turned on, tuned to SiriusXM Preview channel 1, and receiving the SiriusXM signal so that you can hear the SiriusXM audio.
2. Make a note of the SiriusXM Radio ID. You can find it:
 - by selecting **Radio ID** in menu items
 - on channel 0 (zero)
 - on a label on the bottom of the gift box
 - on the label on the back of your Roady BT



NOTE! The SiriusXM Radio ID does not use the letters I, O, S, or F.

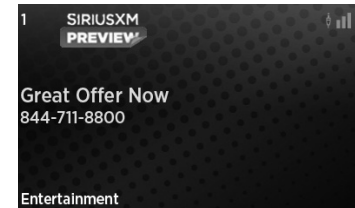

*The phone number show above may differ from the one shown on your Roady BT. All numbers are valid.

3. To subscribe:
 - Online: Go to **www.siriusxm.com/activatenow** to access or set up an online account, subscribe to the service, and activate your Radio.
 - OR
 - By phone: Call **1-866-635-2349**.

Activation usually takes 10 to 15 minutes after you have completed the subscription process, but may take up to an hour. We recommend that your Radio remain on until subscribed. Once subscribed, the Radio will receive and you can tune to channels in your subscription plan.

Press **up ▲** or **down ▼** to tune to other channels, and **left ◀** or **right ▶** to browse the different categories of channels. Learn what all the buttons do by turning to “Navigation Basics” on page 30.

On-Board Activation Guide

For your convenience, Roady BT has an on-board activation guide. You can activate your radio and subscribe to the SiriusXM service by using this guide, where you will be guided step-by-step through the subscription process. To access and use the activation guide, follow these steps:

1. Turn Roady BT on and press **Menu**.
2. **Activate Radio** will be highlighted. Press the **Select button**.
3. Follow the directions on each successive screen until you complete the subscription process.

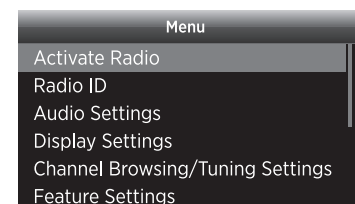

Navigation Basics

Power Button



Pressing the **Power button** turns Rody BT On or Off.

Navigation Buttons

Pressing **Left**, **Right**, **Up**, and **Down** navigates through various features and functions of Rody BT.

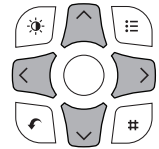

Left ◀ or Right ▶ button: Displays the channel categories such as Rock, Pop, Sports, Talk/News, etc. Repeated presses cycle through the categories one at a time. Also, decreases or increases the settings of various menu options such as Brightness, Audio Level, etc.

Up ▲ or Down ▼ button (press and release): Immediately tunes to the next or previous channel in the channel lineup. Also, scrolls through lists and highlights an item in the list.

Up ▲ or Down ▼ button (press and hold): Continuously scrolls through any list. While on the main display screen, continuously scrolls through the channel lineup and briefly displays the information of each channel. When the button is released, Radio tunes to the last channel it had scrolled to in the channel lineup.

Select Button

Pressing the **Select button** displays and dismisses the favorite channel preview pane at the main display screen.

Pressing the **Select button** selects a highlighted item in a list and confirms settings.

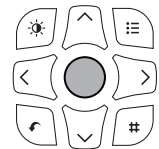

Menu Button

Pressing the **Menu button** displays various options to make setup and feature changes. Pressing **Menu** when in menu options returns to the previous menu option screen until menu options is exited. Pressing and holding **Menu** returns to the main display screen in most instances.



Day/Night Brightness Button

Pressing the **Day/Night Brightness button** toggles between the day and night screen brightness setting. Pressing and holding the **Day/Night Brightness button** enters the display settings in the menu where day and night brightness settings can be adjusted.



Jump Button

Depending on how it is configured, pressing **Jump** either tunes to the previous channel that was being played, or tunes to the channel broadcasting traffic and weather conditions of a city of your choice which has been selected from a list of cities.

Pressing and holding **Jump** toggles the display screen between black background with white text and white background with black text.



Favorite Bank/Direct Tune Button

Press the **Favorite Bank/Direct Tune button** to toggle between favorite banks A & B.

Press and hold the **Favorite Bank/Direct Tune button** to enter a channel number using the number buttons. Once the channel number is entered the Radio directly tunes to the new channel.



Favorite Bank/Direct Tune Button

Press to toggle between favorite banks A & B; **press and hold** to enter Direct Tune and enter a channel number to tune.

Play/Pause, Rewind, Fast-Forward Buttons



Press the **Play/Pause button** to pause or resume playing the channel. Press and hold the **Play/Pause button** to jump to live.

Press the **Rewind button** to skip back to the beginning of the song/segment. Press and hold the **Rewind button** to continuously skip back.

Press the **Fast-Forward button** to skip forward when listening behind live broadcast. Press and hold the **Fast-Forward button** to continuously skip forward when listening behind live broadcast.

Number Buttons



Each number button stores a favorite channel in its button location and provides one touch access to tune the channel. Number buttons also directly tune to a channel when the channel number is entered after pressing and holding the **Favorite Bank/Direct Tune button**.

Now Playing Screen

When listening to a channel, information about the channel and what is currently playing is displayed on the Now Playing screen.

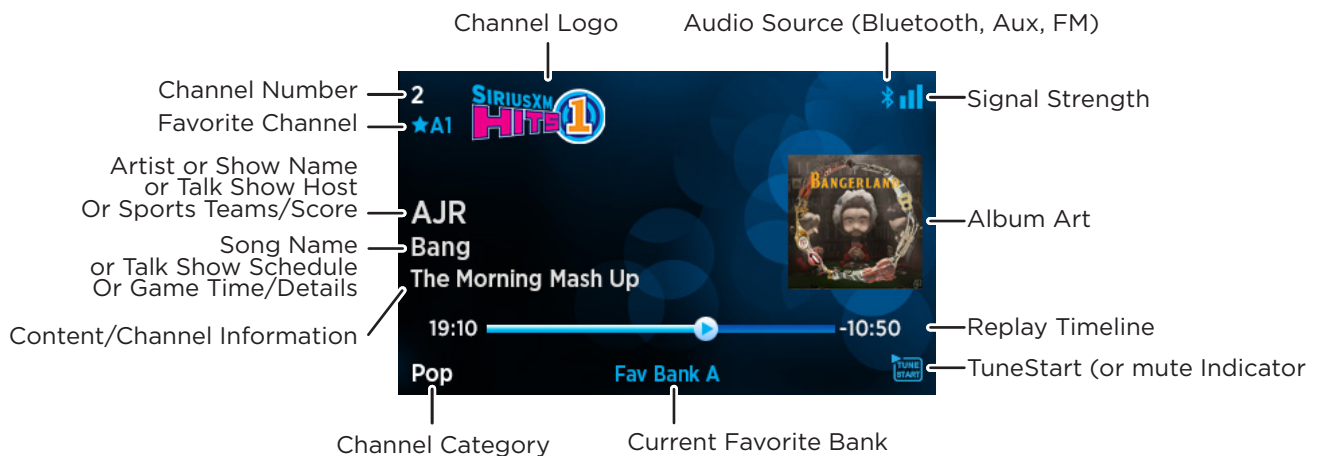

Returning to the Now Playing Screen

Pressing and holding **Menu** in most instances will return you to the Now Playing screen when not at the Now Playing screen. In some instances, you may need to follow the instructions displayed on the screen to return to the Now Playing screen.

Tuning to a Channel

Press and release ▲ and ▼ to immediately tune to the next or previous channel.

Press and hold ▲ and ▼ to quickly scroll through the channels. Release to tune to the channel that is displayed.

Jump

Pressing **Jump** will jump back to the immediate previous channel to which you were listening. Use **Jump** to toggle back and forth between two channels.

Direct Tune

A channel can be tuned directly by entering the channel number.

1. To directly tune to a channel press and hold **Favorite Bank/Direct Tune button** until the Direct Tune screen is displayed.
2. Use the number buttons **0-9** to enter the channel number and wait until the channel is tuned, or press the **Select button** to immediately tune to the channel. If you make a mistake while entering the channel number, press ◀ to delete the number that was entered.

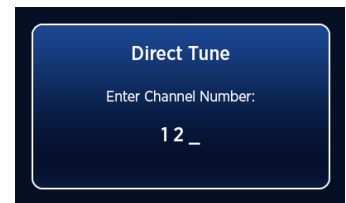

Note that invalid channel numbers cannot be tuned. For example, you can enter channel 9 and channel 99, but if you attempt to enter channel 999, Rody BT will not allow you to enter the third 9 digit.

Categories

Channels are organized into categories to make it easier for you to find channels, such as Pop, Rock, Country, Family, etc.

In addition to the regular categories, there are special category for Favorite channels, Sports Games, and Replay List. When you press ◀ from the Now Playing screen the these categories are shown. Also, if you are tuned to a favorite channel, when you press ▶ the Favorites category is the first category shown.



Browsing Categories

1. To view channels in a category in a list press ◀ or ▶.

2. Scroll through the channels in a category by using ▲ and ▼ to find the channel you want to tune. Press the **Select button** to tune to a highlighted channel, or press ◀ or ▶ to view channels in the previous or next category.

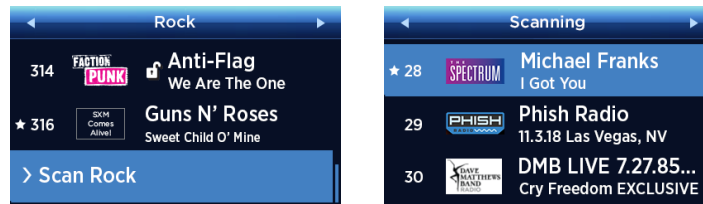

Scanning Channels in a Category

You can scan a category and listen to each channel for 10 seconds as Roady BT automatically tunes to each channel in the category. If you want to stay tuned to the channel being played and stop the scan, just press the **Select button**.

To scan a category:

1. Press ◀ or ▶ until the desired category is displayed.
2. Scroll down and highlight the last item in the category which will be **Scan** and the category name.
3. Press the **Select button**. The scan will begin.
4. Press the **Select button** to stop the scan and to continue to listen to the channel currently being played, or press ▼ or ▲ or **Menu** to return to the channel you were listening to before you began the scan.

Favorite Channels

You can select up to 20 of your favorite channels so you can easily tune to them. Each favorite channel can be assigned to a number button.

To assign or replace a favorite channel to a number button:

1. Tune to the channel to be saved as a favorite.
2. Press the **Favorite Bank/Direct Tune button** to select favorite bank A or B.
3. Press and hold a number button between **0-9** that you want to assign for the favorite channel. An advisory with the channel number and name will be displayed on the screen confirming that the channel has been assigned.
4. If a favorite channel is already assigned to the number button, an advisory will be displayed prompting you to replace the favorite channel or to cancel saving. Press the **Select button** to replace the favorite channel or **Menu** to cancel the replacement.

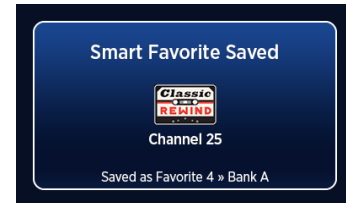

To listen to a favorite channel:

1. Select the favorite bank by pressing the **Favorite Bank/Direct Tune button** to select favorite bank A or B.
2. Press the number button between **0-9** that was assigned to the desired favorite channel. Rody BT will tune to the favorite channel.



TIP! When you are at the Now Playing screen, press ◀ to see your list of favorite channels. Scroll to highlight a favorite channel and press the **Select button** to listen to that channel.

To erase favorite channels:

All favorite channels, or just the favorite channels in bank A or B, can be erased all-at-once.

1. Press **Menu**.
2. Press ▼ to scroll to and highlight **Feature Settings**. Press the **Select button**.
3. Press ▼ to scroll to and highlight **Erase Favorite Channels**. Press the **Select button**.
4. Highlight your choice, **Erase All Favorites**, **Erase All Favorites In Bank A**, or **Erase All Favorites In Bank B** and press the **Select button**.
5. You will be prompted that favorite channels are about to be erased. Press the **Select button** to erase all favorite channels or **Menu** to cancel.
6. A confirmation message will be displayed. Press the **Select button** to confirm or press **Menu** to cancel.
7. Press and hold **Menu** to return to the Now Playing screen.

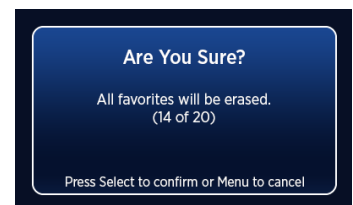
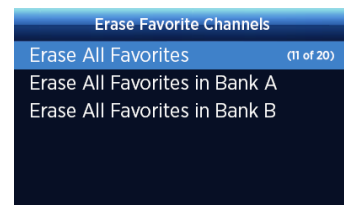

Pause & Replay

Pause & Replay gives you the opportunity to “hear that again” by temporarily storing and then letting you access the stored content. For the currently tuned channel, you can pause and replay for as long as you have been tuned to the channel, up to a maximum of approximately 60 minutes. A replay timeline is displayed when you are not listening to the channel live.

You can also Pause and Replay up to approximately 30 minutes from channels which you have saved as smart favorite channels, and also from the channel that was tuned immediately prior to the currently tuned channel. Pressing **▶||** or **◀◀** places the Radio into Pause & Replay mode.

Turning Roady BT off removes the temporarily stored content from the Radio.

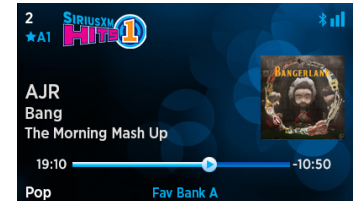

To Play/Pause:

1. Press and release **▶||** to pause the audio. At this point the Radio will mute and continue to store live audio.
2. Pressing and releasing **▶||** again will begin playing stored audio from the point at which the Radio was paused.



TIP! Pressing **◀** (or pressing **◀** twice if favorite channels are stored) will show the **Replay List**. A listing of artist names and song or show titles are shown for the stored audio from most recent to oldest, beginning with entry called “Go to Live”. Press **up ▲** or **down ▼** to scroll to and highlight a song or program and press the **Select button** to play it. Choosing **Go to Live** exits Pause & Replay mode and resumes playing the live broadcast.

To listen to the previous track:

1. Press and release **◀◀** to rewind to the beginning of the current song or program.
2. Repeated press and releases skips backwards to the start of the previous songs or programs until the beginning of the stored audio is reached. When the beginning is reached, playback automatically begins.



TIP! Pressing and holding **◀◀** rewinds through stored audio in 5 second intervals, which increases to 15 and then 30 second intervals the longer the button is pressed. Playback begins when the button is released. If the beginning of the stored audio is reached, playback automatically begins.

To listen to the next track:

1. Press and release **▶▶** to skip forward to the start of the next song or program.
2. Repeated press and releases skips forward to the beginning of the next songs or programs until the end of stored audio is reached. When the end is reached, the Radio will exit Pause & Replay mode and resume playing the live broadcast.



TIP! Pressing and holding **▶▶** advances through the stored audio in 5 second intervals, which increases to 15 and then 30 second intervals the longer the button is pressed. Playback begins when button is released. If end of stored audio is reached, the Radio exits Pause & Replay mode and resumes playing the live broadcast.

To listen to live broadcast:

1. Pressing and holding **▶||** while the Radio is in Pause & Replay mode exits Pause & Replay mode and resumes playing the live broadcast.

Song/Artist Alerts

You can set your Rody BT to alert you when the following events occur:

- **Song Alert:** Alerts can be set for your favorite songs, so that whenever the song begins to play on any music channel, you will be alerted and given the opportunity to tune to the channel.
- **Artist Alert:** Alerts can be set for your favorite artists, so that whenever a song by that artist begins to play on any music channel, you will be alerted and given the opportunity to tune to the channel.

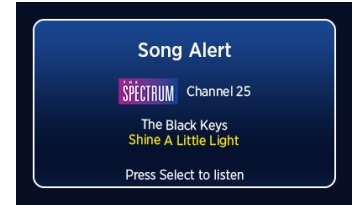

Song and artist alerts can be saved while you are tuned to a channel where the song or artist is currently playing. Alerts can be set while listening to the live broadcast and in Pause and Replay mode. You can save up to 100 Song and Artist Alerts. If the alert list is full you will be prompted to replace an existing alert.

Alerts are displayed visually and are accompanied by an optional audible alert beep, except when you are not at the Now Playing screen. If you are not at the Now Playing screen, you will hear the audible alert beep (provided it's turned on), but the visual alert will be delayed until you have returned to the Now Playing screen.

If a single alert is displayed, you can press the **Select button** to tune to the channel, or press **Menu** to dismiss the alert, or wait for the alert to time out.

There may be occasions when several Song/Artist Alerts happen simultaneously, and then a list of alerts will be displayed. These multiple alerts can be a mixture of Song, Artist, and Game alerts, depending upon what alerts you have saved. You can browse through the multiple alerts by pressing **up ▲** or **down ▼** to scroll to and highlight an alert, and press the **Select button** to tune to the channel. Once you have selected an alert from the list, all other alerts in the list are dismissed.

To save a Song or Artist Alert:

1. While the song is playing press and hold the **Select button**.



TIP! You can save an alert for a song or artist that you had listened to previously on the channel. Press ◀◀ to rewind to the song.

2. You will be prompted to select whether to save a Song Alert or an Artist Alert. Highlight your choice by pressing ▲ or ▼ and press the **Select button**, or press **Menu** to cancel.
3. A message will confirm that you have successfully saved the alert, and how many alerts you have saved, and how many are still available to save.
4. Press and hold **Menu** to return to the Now Playing screen.



TIP! If you saved an Artist Alert for a song, you will not be able to save a song alert, and the message **Artist Alert Already Saved** will be displayed. This happens because you will be alerted whenever any song by that artist begins to play, so it is not necessary to save individual songs by the artist.

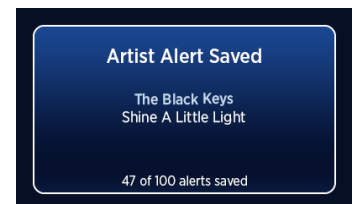
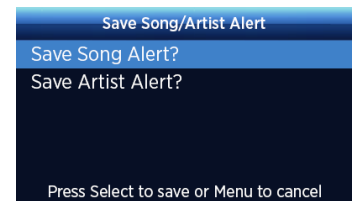

To edit Song and Artist Alerts:

Individual Song and Artist alerts can be edited in the following ways:

- **Turn specific alerts on or off (on/off):** An individual Song or Artist alert can be turned off so you no longer receive the alert, but it is still kept in the alert list so you can turn it back on.
- **Switch alert (switch):** Roady BT remembers both the Song and the Artist for each saved alert, although you will only receive an alert for what you had selected. Switching the alert provides the ability to turn a Song Alert into an Artist Alert, and an Artist Alert into a Song Alert.
- **Delete alert (delete):** Song and Artist alerts can be permanently deleted.

1. Press **Menu**.
2. Press ▼ to highlight **Feature Settings** and press the **Select button**.
3. Press ▼ to highlight **Song/Artist Alerts** and press the **Select button**.
4. Press ▼ to highlight **Edit Song/Artist Alerts** and press the **Select button**.
5. From the list of alerts, highlight the alert you want to edit by pressing ▲ or ▼. Songs are shown in yellow and artists in blue.
6. Press and release the **Select button** to move through the editing options and select an option:

Switch	To switch the alert from an Artist Alert to a Song Alert and vice versa. Wait a moment for the confirmation screen to appear and press the Select button to confirm the switch or press Menu to cancel.
Delete	Delete the alert. Wait a moment for the confirmation screen to appear and press the Select button to confirm the deletion or press Menu to cancel.
Off	Turn the alert off, but keep it in the list.
On	Turn the alert on.

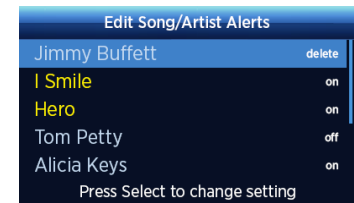

7. Press and hold **Menu** to return to the Now Playing screen.

To turn all Song and Artist Alerts on or off:

You can turn all Song or Artist Alerts on or off without deleting the saved alerts. If you turn them off, you will no longer receive any Song or Artist alerts.

1. Press **Menu**.
2. Press ▼ to highlight **Feature Settings** and press the **Select button**.
3. Press ▼ to highlight **Song/Artist Alerts** and press the **Select button**.
4. **Song/Artist Alerts** should be highlighted. Press the **Select button** to toggle between **On** and **off**.
5. Press and hold **Menu** to return to the Now Playing screen.

To delete Song and Artist Alerts:

There are several options for deleting Song and Artist alerts:

- **Delete All:** Deletes all Song and Artist alerts.
- **Delete All Song Alerts:** Deletes all song alerts, keeps all artist alerts.
- **Delete All Artist Alerts:** Deletes all artist alerts, keeps all song alerts.

1. Press **Menu**.
2. Press ▼ to highlight **Feature Settings** and press the **Select button**.
3. Press ▼ to highlight **Song/Artist Alerts** and press the **Select button**.
4. Press ▼ to highlight **Delete Alerts** and press the **Select button**.
5. Press ▲ or ▼ to select **Delete All**, **Delete All Song Alerts**, or **Delete All Artist Alerts**.
6. A confirmation message will be displayed. Press the **Select button** to confirm deletion or press **Menu** to cancel.
7. Press and hold **Menu** to return to the Now Playing screen.

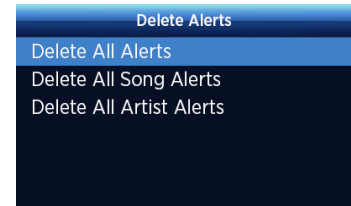

Game Alerts

If your subscription package includes the play-by-play sports channels for your desired sports leagues, and SiriusXM broadcasts the games, you can set your Roady BT to alert you when your favorite sports teams so that whenever SiriusXM begins broadcasting a game in which your favorite sports team is playing, you will be alerted and given the opportunity to tune to the game.

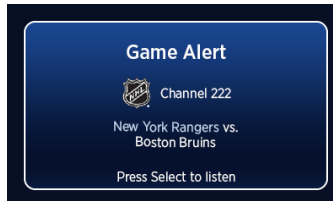

IMPORTANT! A subscription package which includes the play-by-play sports channels of the desired leagues is required. For example, if you selected an alert for an NFL team, and your subscription package did not include NFL play-by-play sports channels, you cannot receive Game Alerts.

We recommend you do not select alerts for teams in a league which are not included in your subscription package. Check your subscription package to confirm that it includes the play-by-play sports channels for the desired leagues before selecting any teams for alerts in the leagues.

Game Alerts can be saved while you are tuned to a channel where a game is being broadcast, or you can preselect teams through the menu options. There is no limit on the number of sports teams which can be saved for Game Alerts.

Alerts are displayed visually and are accompanied by an optional audible alert beep, except when you are not at the Now Playing screen. If you are not at the Now Playing screen, you will hear the audible alert beep (provided it's turned on), but the visual alert will be delayed until you have returned to the Now Playing screen.

When a single alert is displayed, you can press the **Select button** to tune to the game, or press **Menu** to dismiss the alert, or wait for the alert to time out.

There may be occasions when several Game Alerts happen simultaneously and then a list of alerts will be displayed. These multiple alerts can be a mixture of Game, Song, and Artist alerts. You can browse through the multiple alerts by pressing ▲ or ▼ to highlight an alert, and press the **Select button** to tune to the channel. Once you have selected an alert from the list, all other alerts in the list are dismissed.

Tips for Obtaining the Best Experience With Game Alerts

Before selecting teams for Game Alerts, familiarize yourself with the following tips to help you obtain the best experience with Game Alerts:

- Game Alerts normally do not occur if you are tuned to the channel which is broadcasting the game in which the selected team is playing. However, it's possible that the same game may be broadcast on multiple SiriusXM channels simultaneously. If so, you will receive Game Alerts for the other channels where the game is being broadcast. You can temporarily turn off Game Alerts if desired (page 41).
- Avoid selecting all teams in a league for alerts. Select only those teams you are most interested in following.

To save a team for Game Alert while listening to a game:

1. While tuned to the channel where the game is being broadcast press and hold the **Select button**.
2. You will be prompted to select the team for the Game Alert. Highlight your choice by pressing ▲ or ▼ and press the **Select button**, or press **Menu** to cancel.
3. A message will confirm that you have successfully saved the alert, and how many alerts you have saved.
4. Press and hold **Menu** to return to the Now Playing screen.

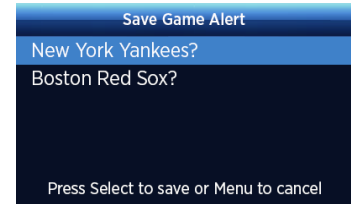

To preselect (or deselect) teams for Game/Score Alerts:

1. Press **Menu**.
2. Press ▼ to highlight **Feature Settings** and press the **Select button**.
3. Press ▼ to highlight **Game Alerts** and press the **Select button**.
4. Press ▼ to highlight **Manage Teams** and press the **Select button**.
5. Press ▲ or ▼ to highlight a league and press the **Select button**.
6. Press ▲ or ▼ to highlight a team and press the **Select button** to toggle the team selection. Selected teams have an **X** in the box to the left of the team name.
7. Continue selecting (or deselecting) teams and press **Menu** when complete.
8. Highlight and select another league and teams in the league, as desired.
9. When done press and hold **Menu** to return to the Now Playing screen.



To remove all teams from Game Alerts:

All teams you had previously selected can be removed for Game Alerts.

1. Press **Menu**.
2. Press ▼ to highlight **Feature Settings** and press the **Select button**.
3. Press ▼ to highlight **Game Alerts** and press the **Select button**.
4. Press ▼ to highlight **Remove Teams** and press the **Select button**.
5. A confirmation message will be displayed. Press the **Select button** to confirm removing all teams or press **Menu** to cancel.
6. Press and hold **Menu** to return to the Now Playing screen.

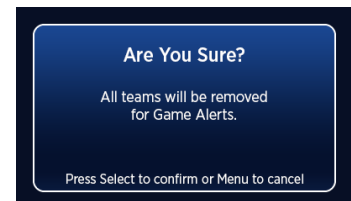

To turn Game Alerts on or off:

You can turn all Game Alerts on or off without deleting the saved alerts. If you turn them off, you will no longer receive Game alerts.

1. Press **Menu**.
2. Press ▼ to highlight **Feature Settings** and press the **Select button**.
3. Press ▼ to highlight **Game Alerts** and press the **Select button**.
4. **Game Alerts** should be highlighted. Press the **Select button** to toggle between **on** and **off**.
5. Press and hold **Menu** to return to the Now Playing screen.

My Sports Zone

If your subscription package includes the play-by-play sports channels for your desired sports leagues, the My Sports Zone category is a virtual category which will display sports games which are currently being broadcast on SiriusXM along with the current score and game details.

You can select the sports leagues which you wish to be shown in My Sports Zone, and when a team in the league is playing a game, you can tune to a game from **My Sports Zone**.

My Sports Zone is accessed using the category buttons. Press ◀ or ▶ until the **My Sports Zone** category is shown.

To select or deselect leagues for My Sports Zone:

1. Press **Menu**.
2. Press ▼ to highlight **Feature Settings** and press the **Select button**.
3. Press ▼ to highlight **My Sport Zone** and press the **Select button**.
4. **Manage Leagues** will be highlighted. Press the **Select button**.
5. Press ▲ or ▼ to highlight a league (or **All Leagues**) and press the **Select button**. Selected leagues have an **X** in the box to the left of the league name.
6. Continue selecting (or deselecting) leagues and press **Menu** when complete.
7. Press and hold **Menu** to return to the Now Playing screen.

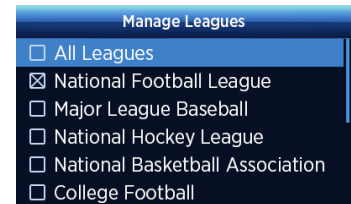

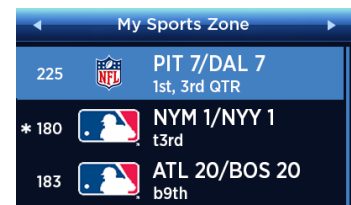

Tuning a game from My Sports Zone:

1. Press ◀ or ▶ until the **My Sports Zone** category is displayed.
2. Press ▲ or ▼ to highlight a sports game, and press the **Select button**.
3. **Listen to Game?** will be highlighted. Press the **Select button** to tune to the game.



xL Lock





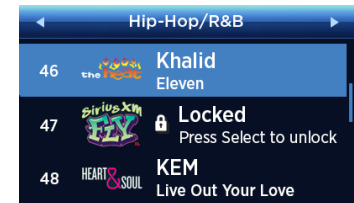



Explicit (xL) channels can be locked so that these channels are not shown in channel lists, and are shown as locked in categories. When explicit channels are locked, if an attempt is made to tune an explicit channel, you will be prompted for the lock code.

When you browse a category, the channel number and channel logo of the locked channel will be shown but not the artist and song/program information. Instead, a lock icon  and “Press Select to unlock channel“ is shown. If you tune through the channels using  and , the locked channels are skipped and are neither displayed or tuned.



If you attempt to tune to a locked channel, either by using Direct Tune or through the category list, you'll be prompted to enter the 4-digit lock code. When the correct code is entered, you'll be able to tune to and listen to the channel, and all locked channels will become unlocked and remain unlocked until you turn Roady BT Off and back On. In the category list, the previously locked channels will show an unlocked icon .

To turn xL Lock on or off:

1. Press **Menu**.
2. Press  to scroll to and highlight **xL Lock Settings**. Press the **Select** button.
3. If this is the first time you are turning on Parental Controls, xL Lock will be highlighted. Press the **Select** button. You will be prompted to select a 4-digit lock code:
 - i. For each digit, press one of the **0-9** keys (or press  or  to select digits and then press  to advance to the next digit.) Press  if you need to go back and edit a previous digit.
 - ii. When you have selected all 4 digits of your lock code press the **Select** button.
 - iii. The **Lock Code Confirmation** screen will be displayed. For your records, write down the lock code you have selected. Press the **Select** button. Continue with step 5.
4. If you had previously selected a 4-digit lock code you will be prompted to enter your existing lock code:
 - i. For each digit, press one of the **0-9** keys (or press  or  to select digits and then press  to advance to the next digit.) Press  if you need to go back and edit a previous digit.
 - ii. When you have selected all 4 digits of the lock code press the **Select** button.
5. At the **xL Lock Settings** screen, **xL Lock** will be highlighted. Press the **Select** button to toggle the xL lock setting **on** or **off**.
6. Press and hold **Menu** to return to the Now Playing screen.

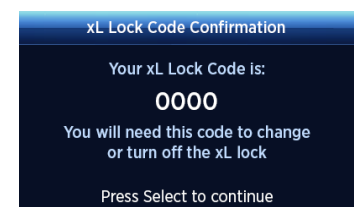
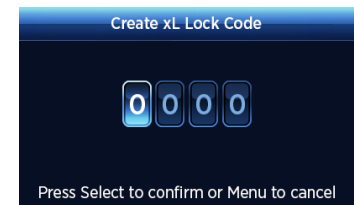

To change the xL Lock code:

1. Press **Menu**.
2. Press  to scroll to and highlight **xL Lock Settings**. Press the **Select** button.

3. Press ▼ to scroll to and highlight **Change Lock Code** and press the **Select button**.
4. You will be prompted to enter your existing 4-digit lock code. For each digit, press one of the **0-9** keys (or press ▼ or ▲ to select digits and then press ► to advance to the next digit.) Press ◀ if you need to go back and edit a previous digit.
5. When you have entered all 4 digits of the existing lock code press the **Select button**.
6. You will be prompted to enter a new 4-digit lock code. For each digit, press one of the **0-9** (or press ▼ or ▲ to select digits keys and then press ► to advance to the next digit.) Press ◀ if you need to go back and edit a previous digit.
7. The **Lock Code Confirmation** screen will be displayed. For your records, write down the lock code you have selected. Press the **Select button**.
8. Press and hold **Menu** to return to the Now Playing screen.

To listen to a locked channel:

There are two ways to tune to a channel which has been locked. The first is to directly tune to the locked channel using **Direct Tune**, and the second is to select the locked channel from a category list.

1. Directly tune a channel, or select the locked channel from a category list:

To directly tune to a locked channel:

- i. Press and hold the **Favorite Bank/Direct Tune Button** and enter the channel number using the **0-9** keys.

To select a locked channel from the category list:

- i. Press ◀ or ► to view the category list of the locked channel to which you wish to tune.
 - ii. Press ▼ to scroll to and highlight the locked channel. Press the **Select button**.
2. You will be prompted to enter your existing 4-digit lock code. For each digit, press one of the **0-9** keys (or press ▼ or ▲ to select digits and then press ► to advance to the next digit.) Press ◀ if you need to go back and edit a previous digit.
 3. When you have entered all 4 digits of the lock code, press the **Select button**. If your lock code is correct the channel will be tuned. All locked channels will become unlocked and will remain unlocked until you turn Rody BT Off and back On. In the category list, the previously locked channels will show an unlocked icon 🔒.



Day/Night Brightness Selection

The display screen on the Roady BT can be toggled for day and night brightness settings.

To switch between day and night brightness settings:

1. Press the **Day/Night Brightness button** to toggle between the day and night mode.

To adjust the brilliance of the day or the night setting:

1. Press **Menu** (or press and hold the **Day/Night Brightness button** and skip to step 3).
2. Press ▼ to highlight **Display Settings** and press the **Select button**.
3. Press ▼ to highlight **Brightness - Day** or **Brightness - Night** and press the **Select button**.
4. Press ▲ or ▼ to adjust the screen brilliance and press the **Select button** to save the setting.
5. Press and hold **Menu** to return to the Now Playing screen.

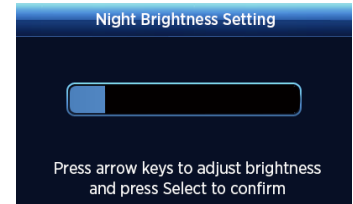

Night Comfort Mode

Night Comfort Mode will automatically turn off the display screen on Roady BT after a period of 5, 15, 30, or 60 minutes when Roady BT is in the night brightness mode.

Press any button when in night comfort mode to turn the display screen back on.

To adjust Night Comfort Mode:

1. Press **Menu** (or press and hold the **Day/Night Brightness button** and skip to step 3).
2. Press ▼ to highlight **Display Settings** and press the **Select button**.
3. Press ▼ to highlight **Night Comfort Mode**.
4. Press the **Select button** to toggle between **off**, **5**, **15**, **30**, or **60** minutes.
5. Press and hold **Menu** to return to the Now Playing screen.

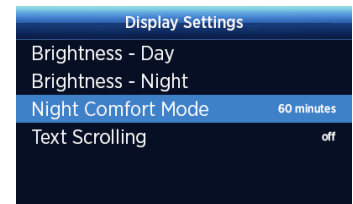

TuneStart

The TuneStart feature plays the current song from the beginning when you tune to a music channel which you have saved as a smart favorite channel. TuneStart is on by default.

TuneStart also occurs if you tune back to the channel that was tuned immediately prior to the currently tuned channel, either by pressing **Jump**, or by directly tuning the channel.

When a TuneStart occurs, the TuneStart icon will be displayed for 10 seconds on the Now Playing screen to show that a TuneStart has occurred. Should you wish to return to the live broadcast, press and hold **Play/Pause**.

In order for a TuneStart to occur, the beginning of the song must be present in the TuneStart memory. If Roady BT is powered on after a song has already begun to be broadcast, a TuneStart will not be possible for that song.

TuneStart will only occur once per song. For example, if you tune to smart favorite music channel A1 and a TuneStart occurs, then tune channel B1, and then tune back to channel A1 while the same song is still playing on channel A1, a TuneStart will not occur. However, if you want to hear the song from the beginning, you can always press and release **◀◀** to return to the beginning of the song.



NOTE: Certain music channels are not eligible for TuneStart due to the way in which they are broadcast. While these music channels can be saved as smart favorites, TuneStart will not occur for these channels.

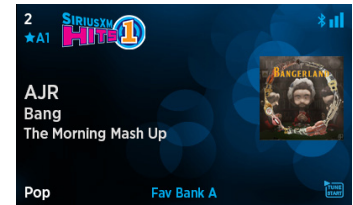

To turn TuneStart on or off:

1. Press **Menu**.
2. Press **▼** to scroll to and highlight **Feature Settings** and press the **Select button**.
3. Press **▼** to scroll to and highlight **TuneStart** and press the **Select button**.
4. Press the **Select button** to toggle between **on** and **off**.
5. Press and hold **Menu** to return to the Now Playing screen.

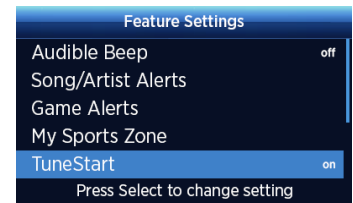

Before attempting to change any of Roady BT's settings you should park your vehicle in a safe location.

Radio ID

Radio ID is where the **Radio ID** and **Radio Information** is displayed.

The Radio ID is an 8 character alphanumeric ID which uniquely identifies the Radio, and is used for the subscription process. Radio Information shows subscription state and software revisions.

To display the Radio ID:

1. Press **Menu**.
2. **Radio ID** will be highlighted. Press the **Select button** to display the Radio ID.
3. Press and hold **Menu** to return to the Now Playing screen.

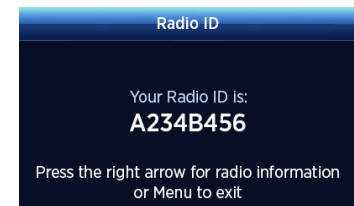

To display Radio Information:

1. Press **Menu**.
2. **Radio ID** will be highlighted. Press the **Select button**.
3. Press **▶** to display the **Radio Information** screen.
4. Press and hold **Menu** to return to the Now Playing screen.

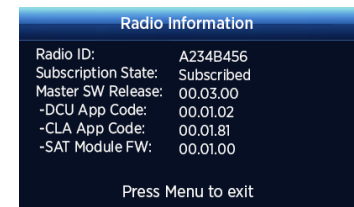

Online Product Support

Online Product Support displays a QR code and website URL where you can go to find additional support information for Roady BT.

Using a mobile device such as your phone, scan the QR code which is displayed or use a browser to go to the website for additional assistance.

SiriusXM also has a dedicated email address where you can receive personalized support from SiriusXM experts:

roadybt@siriusxm.com.



Audio Settings

Audio Settings is where the **Audio Output** for Roady BT is selected (Aux, Bluetooth, or FM), and where the **Audio Level** can be adjusted.

To select the Audio Output:

Detailed instructions for each type of audio output may be found in the following sections:

Aux: Refer to “Option 1: Aux Audio Cable Installation Instructions” on page 20 for detailed information.

Bluetooth: Refer to “Option 2: Bluetooth Installation Instructions” on page 21 for detailed information.

FM: Refer to “Option 3: FM Installation Instructions” on page 27 and the sections below for detailed information. (The FM audio option requires an FM Direct Adapter which is sold separately.)

The following sections contain further detail for the FM audio option, **and assumes that you have selected FM as your audio output option.**

To find available FM channels in your area:

You need to find an available FM channels that are not being used by an FM radio station in your area. When you tune your vehicle’s FM radio to an available channel, you should only hear static or silence – not talk or music.

Once you have found an available FM channel, you’ll need to tune Roady BT and your vehicle’s radio to the same FM channel to receive the SiriusXM audio through your vehicle’s radio.

We recommend one of the following methods to find an available FM channel:

1. Use the SiriusXM FM Channel Finder

Use the SiriusXM FM Channel Finder at www.siriusxm.com/fmchannel. Go to the website and enter your zip code. The Channel Finder will suggest a list of available FM channels in your area. For convenience, write down or print out the list.

Tune Roady BT to a SiriusXM channel (or to channel 1, if it’s not activated). Turn on your vehicle’s FM radio. Pick the first FM channel on your Channel Finder list and tune the FM radio to that channel. If you do not hear a local FM station broadcast, then tune Roady BT to the same FM channel. (Refer to “To set and select an FM Channel:” on page 49.) You should hear the SiriusXM audio through your vehicle’s radio. If you are satisfied with the sound quality, you’re done! If this FM channel doesn’t work well for you, work down the list until you find an FM channel that allows you to hear the SiriusXM audio clearly.

OR

2. Manually tune through your local FM channels

Manually tune through your local FM channels on your vehicle’s FM radio. Turn on your vehicle’s FM radio. Start at 88.1 and use the ‘Manual’ tune function on your vehicle’s FM radio to tune through each FM channel one-by-one (88.1 followed by 88.3 etc.) to locate channels that aren’t being used by a local FM radio station. Write down each FM channel that has only static or silence on it, until you reach 107.9. Once you have created your list of available FM channels, you will need to find the one that provides the best match for Roady BT.

Tune Roady BT to a SiriusXM channel (or to channel 1, if it’s not activated). Pick the first FM channel on your list and tune the FM radio to that channel. Then tune Roady BT to the same FM channel. (Refer to “To set and select an FM Channel:” on page 49 for instructions on how to do this.) You should hear the SiriusXM audio through your vehicle’s radio. If you are satisfied with the sound quality, you’re done! If this FM channel doesn’t work well for you, work down the list until you find an FM channel that allows you to hear the SiriusXM audio clearly.



NOTE! You may find an FM channel with static or silence that does not work with Roady BT. It is possible that some type of inaudible interference is present that prevents reception of the SiriusXM audio. Your only options are to use another FM channel or a different audio connection method.



TIP! If you regularly drive from one location to another, such as your daily commute, you may need to use different FM channels along your route for best performance. If this is the case, we recommend saving the best FM channels as presets on your FM radio and Roady BT. Then you simply select and match the best channel for the area you are in.



TIP! It will be much more difficult to find available FM channels in large cities than in most suburban or rural locations. A direct audio connection using Aux or Bluetooth, or professional installation is your best solution if you drive in or near large metropolitan areas.



NOTE! The SiriusXM FM Channel Finder relies on data from the Federal Communications Commission. The data may not reflect the latest stations in your area. In addition, local geography and weather conditions can impact reception, so your results may be different from the list.



NOTE! The performance of FM radios are different, based on manufacturer and vehicle style. Some may not work well with the type of FM transmitter used by Roady BT. This is why we recommend a using the Aux or Bluetooth if they can be used in your vehicle. Professional installation can also resolve almost any performance issue.

To set and select an FM Channel:

Roady BT allows you to easily store (i.e., preset) up to 5 different FM channels. At any time, you can select any one of these 5 FM presets to hear SiriusXM through your existing vehicle radio. Having a choice of 5 FM presets also makes it easy to switch to the appropriate FM channel as you travel from one area to another. Each FM preset is stored in its own storage location. You can easily add or edit the FM preset in any one of the 5 storage locations.



IMPORTANT! Roady BT and the vehicle’s FM radio need to be tuned to the same FM channel in order to hear the audio.



TIP! The FM 1 storage location is preset with FM channel 97.9.

1. Press **Menu**.
2. Press ▼ to highlight **Audio Settings** and press the **Select button**.
3. Press ▼ to highlight **FM Channels** and press the **Select button**.
4. Press ▲ or ▼ to highlight to scroll to and highlight the storage location (FM 1 to FM 5) you want as a preset and press the **Select button**. You can choose among the following options:

- i. If the chosen storage location is empty (denoted by “---”), or if the storage location contains the FM preset currently being used (denoted by “current”), then the FM channel tuning screen is displayed.
- ii. If the chosen storage location has an FM preset that is not

FM Channels		
FM 1	97.9	current
FM 2	101.5	
FM 3	106.3	
FM 4	---	
FM 5	---	

Press Select to change setting

currently being used, and you want to edit it, **Edit Channel** is highlighted. Press the **Select button**. The FM channel tuning screen is displayed.

iii. If the chosen storage location has an FM preset that is not currently being used, and you want to start using it, press ▲ to highlight **Start Using** and press the **Select button**. Skip to step 7.

5. Press ◀ and ▶ to tune to the desired FM channel in steps of .2, i.e., 99.3 to 99.5. Press ▼ and ▲ to tune to the desired channel in steps of 1, i.e., 99.3 to 100.3. Press the **Select button** to select the FM channel.
6. If you are editing the storage location that has the “current” FM preset, skip to step 7. Otherwise, **Start Using** will be highlighted. Press the **Select button**.



NOTE! You can also set an FM preset without having to start using it right away. Just press **Menu** and exit the screen.

7. The chosen FM channel will be confirmed on the display screen and Rody BT will tune to that FM channel.
8. Set your vehicle’s FM radio to same FM channel.



IMPORTANT! You’ll first need to find a suitable FM channel that is unused or available in your area.



To select a different FM preset:

FM presets make it easy to choose a new FM channel from the saved presets. FM presets are used when you use FM as your audio connection.

1. Press **Menu**.
2. Press ▼ to highlight **Audio Settings** and press the **Select button**.
3. Press ▼ to highlight **FM Channels** and press the **Select button**.
4. Press ▲ or ▼ to highlight the desired FM channel and press the **Select button**.
5. Press ▲ to highlight **Start Using** and press the **Select button**.
6. Press and hold **Menu** to return to the Now Playing screen.
7. Set your vehicle’s FM radio to the same FM channel.



IMPORTANT! You need to ensure that your vehicle’s FM radio is tuned to the same FM channel as Rody BT.

Audio Level

The audio level of Rody BT can be adjusted when an audio connection is made between Rody BT and the vehicle’s radio/headunit. Audio level is used to adjust Rody BT’s volume level to match the volume of other audio sources you may use, such as a other apps, CD player, FM radio, etc.

Do not use the audio level as a volume control. Use the volume control on your vehicle’s radio/headunit instead.

To adjust the Audio Level:

1. Press **Menu**.
2. Press ▼ to highlight **Audio Settings** and press the **Select button**.
3. Press ▼ to highlight **Audio Level** and press the **Select button**.
4. Press ▲ or ▼ to adjust the audio level and press the **Select button** to confirm the new setting.
5. Press and hold **Menu** to return to the Now Playing screen.

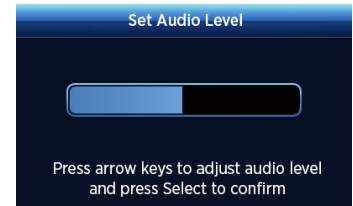

Display Settings

Display Settings is where the **Day and Night Brightness**, **Night Comfort Mode**, and **Text Scrolling** options are adjusted.

Day and Night Brightness

Refer to “Day/Night Brightness Selection” on page 45 for detailed information.

Night Comfort Mode

Refer to “Night Comfort Mode” on page 45 for detailed information.

Text Scrolling

When an artist’s name or a song title is too long to be completely displayed on the Now Playing screen, the artist name and/or song title will scroll after a few seconds. This feature can be adjusted as follows:

Off	Metadata never scrolls (default).
Once	Metadata scrolls once and then does not scroll again until the metadata changes.
Continuous	Metadata will continuously scroll.

1. Press **Menu**.
2. Press ▼ to highlight **Display Settings** and press the **Select button**.
3. Press ▼ to highlight **Text Scrolling**.
4. Press the **Select button** to toggle between **off**, **once**, and **continuous**.
5. Press and hold **Menu** to return to the Now Playing screen.

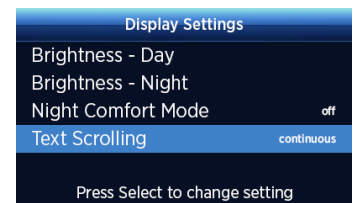

Channel Browsing/Tuning Settings

Display Settings is where the **Channel Browsing Auto Select**, **Channel Tuning**, and **Show/Hide Categories** options are adjusted.

Channel Browsing Auto Select

Rody BT is configured to automatically tune channels when browsing a category list so that when you highlight a channel in the list and pause for a few seconds, the channel is tuned. This feature can be turned off so that channels are not tuned automatically, if desired.

1. Press **Menu**.
2. Press ▼ to scroll to and highlight **Channel Browsing/Tuning Settings**. Press the **Select button**.
3. Press ▼ to scroll to and highlight **Channel Browsing Auto Select**.
4. Press the **Select button** to toggle between **on** and **off**.
5. Press and hold **Menu** to return to the main display screen.

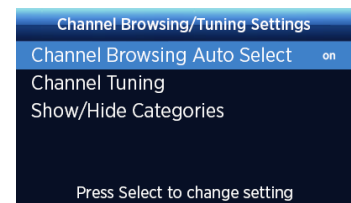

Channel Tuning

Channel Tuning controls the way channels are displayed when browsing through channels using ▲ or ▼, and when browsing channels in category browsing. There are two different channel tuning modes, **Tune by Channel** (default) and **Tune by Category**.

- **Tune by Channel:** Channels are displayed in ascending or descending numerical order, regardless of their category. The numerical channel numbers are shown when channels in a category are viewed in list mode. This is the default method.
- **Tune by Category:** Channels are grouped and displayed according to their category (Rock, Pop, Family, etc.), regardless of their numerical channel number. Once you have scrolled through all the channels in a category, the channels in the next category are shown.

1. Press **Menu**.
2. Press ▼ to highlight **Channel Browsing/Tuning Settings** and press the **Select button**.
3. Press ▼ to highlight **Channel Tuning**.
4. Press ▼ to scroll to and highlight **Tune by Channel** or **Tune by Category**. Press the **Select button**.
5. Press and hold **Menu** to return to the Now Playing screen.

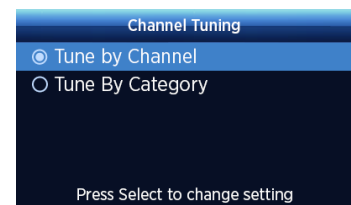

Show/Hide Categories

Categories can be hidden if you do not wish to have a category shown in the category carousel. Channels in hidden categories may still be tuned by using Direct Tune to enter the channel number.

To show or hide a category:

1. Press **Menu**.

2. Press ▼ to highlight **Channel Browsing/Tuning Setting** and press the **Select** button.
3. Press ▼ to highlight **Show/Hide Categories** and press the **Select** button.
4. Press ▲ or ▼ to highlight a category and press the **Select** button to toggle the show/hide selection. Categories to be hidden have an **X** in the box to the left of the category name.
5. Continue selecting (or deselecting) categories and press **Menu** when complete.
6. Press and hold **Menu** to return to the Now Playing screen.

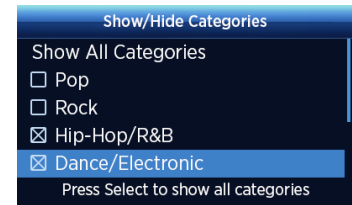

To show all categories:

1. Press **Menu**.
2. Press ▼ to highlight **Channel Browsing/Tuning Setting** and press the **Select** button.
3. Press ▼ to highlight **Show/Hide Categories** and press the **Select** button.
4. If any categories have been hidden, **Show All Categories** will be highlighted. Press the **Select** button to show all categories.
5. Press and hold **Menu** to return to the Now Playing screen.

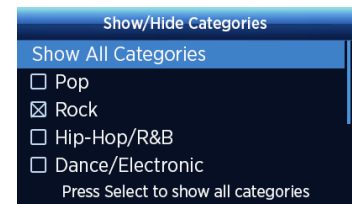

Feature Settings

Feature Settings is where the **Audible Beep**, **Song/Artist Alerts**, **Game Alerts**, **My Sports Zone**, and **TuneStart** options are adjusted.

Audible Beep

Audible Beep controls the beep that is heard when an advisory message or alert screen is displayed. The audible beep can be turned on or off. If the audible beep is turned off you will still continue to receive any associated visual alert.

1. Press **Menu**.
2. Press ▼ to highlight **Feature Settings** and press the **Select** button.
3. Press ▼ to highlight **Audible Beep**.
4. Press the **Select** button to toggle between **on** and **off**.
5. Press and hold **Menu** to return to the Now Playing screen.

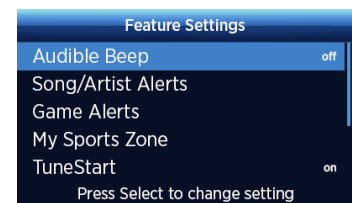

Song/Artist Alerts

Refer to “Song/Artist Alerts” on page 36 for detailed information.

Game Alerts

Refer to “Game Alerts” on page 39 for detailed information.

My Sports Zone

Refer to “My Sports Zone” on page 42 for detailed information.

TuneStart

Refer to “TuneStart” on page 46 for detailed information.

xL Lock Setting

Explicit (xL) channels can be locked so that these channels are not shown in channel lists, and are shown as locked in categories. Refer to “xL Lock” on page 43 for detailed information.

Signal Indicator

For best reception the Magnetic Mount Antenna should have an unobstructed view of the SiriusXM satellites. In large cities, there are terrestrial transmitters (ground repeaters) to help supplement the signal coverage.

Your Rody BT can display the received strength of the satellite and terrestrial signals being received.

1. Press **Menu**.
2. Press ▼ to highlight **Signal Indicator** and press the **Select button**.
3. The Satellite and Terrestrial bars show the strength of the signal being received.
4. If necessary, reposition the antenna if you are having trouble receiving the signal. Be sure your vehicle is outside with an unobstructed view of the sky.
5. Press and hold **Menu** to return to the Now Playing screen.

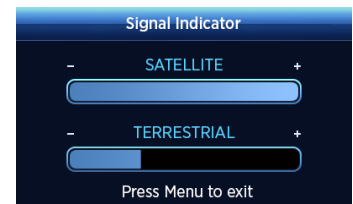

Auto Shut Off

Auto Shut Off will automatically turn Rody BT off after 8 hours of inactivity, i.e., when no buttons have been pressed for 8 hours. This feature prevents the vehicle battery from being accidentally discharged if you forgot to turn Rody BT off. Auto Shut Off is on by default, but can be disabled if the feature is not desired.

When Rody BT is about to shut off, an advisory will be displayed. If you wish to continue listening, press any button to cancel the auto shut off.

1. Press **Menu**.
2. Press ▼ to highlight **Auto Shut Off** and press the **Select button**.

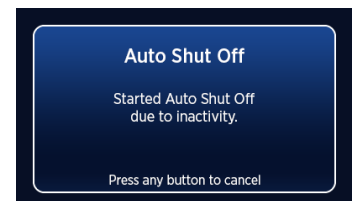

- 3. Auto Shut Off** will be highlighted. Press the **Select button** to toggle between **enabled** or **disabled**.
- 4.** Press and hold **Menu** to return to the Now Playing screen.

Factory Settings

Configuration changes and personal settings can be removed with a factory reset, and Roady BT returned to its original out-of-the-box condition. Please note that a factory reset will not change or affect Roady BT's subscription status.



NOTE! Factory Settings permanently removes all configuration and personal settings **and cannot be undone**. In particular, the audio connection configuration will have to be done again after a factory reset.

- 1.** Press **Menu**.
- 2.** Press ▼ to scroll to and highlight **Factory Settings** and press the **Select button**.
- 3.** A confirmation screen will be displayed. If you are certain that you want to reset your Roady BT to the factory settings, press the **Select button** to proceed, or press **Menu** to cancel.
- 4.** Press and hold **Menu** to return to the Now Playing screen.
- 5.** Note that the **No Audio Connection** message will be displayed on the Now Playing screen because the audio output selection has been reset to **none selected**. Refer to “Step 6: Connect the Audio” on page 19 for audio connection options.

Restore Factory Settings

All radio settings will be erased and the radio restored to the factory settings.
Are you sure you want to proceed?

Press Select to confirm or Menu to cancel

Software Update

Software Update is where a new software release for Roady BT is installed. Until a software update has been copied to the Roady BT display, **Software Update** is not selectable.

There are several requirements for a software update:

- 1.** A special cable (which will be made available on the Roady BT product support page).
- 2.** A Microsoft® Windows® based computer, or an Apple® computer, with Internet access, is required for downloading the software update from SiriusXM. Also, a USB A-type connection on the computer is required to copy the software update to the Roady BT display.

Detailed information will be made available on the Roady BT product support page if a software update is available.

Demo Mode

Roady BT has a demo mode that can play that shows some of its features.

The ability for Roady BT to enter demo mode is enabled by default. If you don't want Roady BT to enter the demo mode you can disable the demo feature. You can enable it again at another time, if desired.

To enable or disable Demo Mode:

1. Press **Menu**.
2. Press ▼ to highlight **Demo Mode** and press the **Select button**.
3. **Status** will be highlighted. Press the **Select button** to toggle between **enabled** or **disabled**.
4. Press and hold **Menu** to return to the Now Playing screen.

To enter Demo Mode

1. Press **Menu**.
2. Press ▼ to highlight **Demo Mode** and press the **Select button**.
3. Press ▼ to highlight **Enter Demo Mode** and press the **Select button**.
4. Roady BT will begin a 10 second countdown before entering Demo Mode. Press the **Select button** if you want to cancel entering Demo Mode.
5. To exit Demo Mode press and hold the **Select button** for 10 seconds until the Demo Mode menu is displayed.
6. Press and hold **Menu** to return to the Now Playing screen.

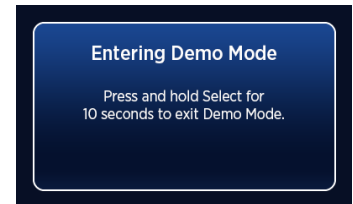

Regulatory Information

Regulatory Information displays specific information about the radio.

1. Press **Menu**.
2. Press ▼ to highlight **Regulatory Information** and press the **Select button**.
3. Press and hold **Menu** to return to the Now Playing screen.



Roady BT has been designed and built to be trouble-free but if you experience a problem, try this:

- Check that all connections are firm and secure.
- Make sure the vehicle power socket is clean and free of corrosion.
- Make sure you have connected Roady BT as described in this User Guide. Verify that the Intelligent Power Adapter is plugged into the vehicle’s cigarette lighter or power adapter socket, and that the LED on the Intelligent Power Adapter is lit (on). If not, your vehicle may need to be running to provide power to the socket.

If you see this on the screen:	Try this:
Acquiring Signal	<ul style="list-style-type: none"> • Make sure that the vehicle is outdoors with a clear view of the sky. • Make sure the Magnetic Mount Antenna is mounted outside of the vehicle. • Move the antenna away from any obstructed area. For example, if you are parked in an underground garage, you should receive a signal after leaving the garage.
Check Antenna Connection	<ul style="list-style-type: none"> • Make sure that the antenna cable is firmly and securely plugged into the Intelligent Power Adapter. Make sure the cable is not bent or broken. • Turn Roady BT Off, then On, to reset this message. • If the message persists, most likely the Magnetic Mount Antenna cable has been damaged. Replace the antenna.
Channel Off Air	<ul style="list-style-type: none"> • The channel you’ve selected is not currently broadcasting. Tune to another channel.
Loading	<ul style="list-style-type: none"> • Your Roady BT is acquiring audio or program information This message usually goes away in a few seconds.
Updating	<ul style="list-style-type: none"> • Your Roady BT is updating with the latest encryption code. Wait until the update is done. • You may be trying to tune to a channel that is blocked or unavailable. Tune to another channel.
—	<ul style="list-style-type: none"> • No program information, such as artist name, song title, or channel exists.
No Audio Connection	<ul style="list-style-type: none"> • An audio option must be selected, and the audio connection made before audio can be heard. Refer to “Step 6: Connect the Audio” on page 19 for instructions on selecting and installing an audio connection.
If this happens:	Try this:
You do not receive all the channels to which you subscribed	<ul style="list-style-type: none"> • Ensure that you have subscribed to the service by following the steps in “Activation” on page 29. • Go to www.siriusxm.com/refresh and follow the directions to refresh your Radio. • Call 1-866-635-2349 for further assistance.
Audio sounds too soft	<ul style="list-style-type: none"> • Raise the volume of your vehicle’s radio/headunit or increase the audio level of your Roady BT until the sound quality improves. Refer to “Audio Level” on page 50.

If this happens:	Try this:
Audio fades or has static when listening	<ul style="list-style-type: none"> • Check all cables for a firm and secure connection. • If you are using the FM audio connection option to listen via your vehicle's FM radio, and the problem persists, it most likely is interference from another commercial or broadcast FM station. You will need to find an unused or available FM channel in your area. Refer to "To find available FM channels in your area:" on page 48.
No audio when using the FM audio connection option	<ul style="list-style-type: none"> • Check that your Roady BT and your vehicle's FM radio are tuned to the same FM channel.
No song title or artist name is displayed	<ul style="list-style-type: none"> • The information may not be available or updates may be in progress.
Bluetooth will not pair and connect	<ul style="list-style-type: none"> • Please read the information in "Option 2: Bluetooth Installation Instructions" on page 21, and also refer to the Roady BT FAQs for Bluetooth referenced there.
The demo is playing	<ul style="list-style-type: none"> • Press and hold the Select button for 10 seconds to exit Demo Mode. • You can disable Demo Mode. Refer to "Demo Mode" on page 56.

Patent Information

It is prohibited to, and you agree that you will not, copy, decompile, disassemble, reverse engineer, hack, manipulate, or otherwise access and/or make available any technology incorporated in this product. Furthermore, the AMBE® voice compression software included in this product is protected by intellectual property rights including patent rights, copyrights, and trade secrets of Digital Voice Systems, Inc. The software is licensed solely for use within this product. The music, talk, news, entertainment, data, and other content on the Services are protected by copyright and other intellectual property laws and all ownership rights remain with the respective content and data service providers. You are prohibited from any export of the content and/or data (or derivative thereof) except in compliance with applicable export laws, rules and regulations. The user of this or any other software contained in a Sirius XM Radio Inc is explicitly prohibited from attempting to copy, decompile, reverse engineer, hack, manipulate or disassemble the object code, or in any other way convert the object code into human-readable form.

Environmental Information

Follow local guidelines for waste disposal when discarding packaging and electronic appliances.

Perchlorate Material - special handling may apply. See www.dtsc.ca.gov/hazardouswaste/perchlorate (Applicable to California, U.S.A.)

FCC Statement

The user is cautioned that changes or modifications not expressly approved by Sirius XM Radio Inc. can void the user's authority to operate this device.

This device complies with Part 15 of the FCC Rules. Operation is subject to the following two conditions:

1. This device may not cause harmful interference.
2. This device must accept any interference received, including interference that may cause undesired operation.

This equipment has been tested and found to comply with the limits for a Class B digital device, pursuant to Part 15 of the FCC Rules. These limits are designed to provide reasonable protection against harmful interference in a residential installation.

This equipment generates, uses, and can radiate radio frequency energy and, if not installed and used in accordance with the installation instructions, may cause harmful interference to radio communications. However, there is no guarantee that interference will not occur in a particular installation. If this equipment does cause harmful interference to radio or television reception, which can be determined by turning the equipment off and on, the user is encouraged to try to correct the interference by one or more of the following measures:

- Reorient or relocate the receiving antenna of the affected receiver.
- Increase the separation between the SiriusXM equipment and the affected receiver.
- Connect the SiriusXM equipment into an outlet on a circuit different from that to which the affected receiver is connected.
- Consult the dealer or an experienced radio/TV technician for help.

Part 15 Device Warning: Modifications by anyone other than the party responsible for compliance with the FCC rules may void the authority granted under FCC regulations to operate this device.

FCC RF Exposure Statement

This Intelligent Power Adapter complies with FCC RF exposure limits set forth for an uncontrolled environment. This Intelligent Power Adapter should be installed and operated with a minimum distance of 20 cm (8 in) from your body.

WARNING! The FCC and FAA have not certified this Satellite Radio Receiver use in any aircraft (neither portable nor permanent installation). Therefore, Sirius XM Radio Inc. cannot support this type of application or installation.

IMPORTANT NOTICE: REQUIRED SUBSCRIPTION

Hardware and subscription sold separately. Activation fee, other fees, and taxes required. All fees, content and features are subject to change. Our satellite service is available only to those at least 18 and older. **Installation instructions are provided. You must determine if you have the knowledge, skills and ability required to properly perform installation. Professional installation recommended. You must ensure that all products are installed in adherence with local laws and regulations and in such a manner as to allow a vehicle to be operated safely and without distraction.** SiriusXM product warranties do not cover the installation, removal or reinstallation of any product.

© 2022 SiriusXM Radio Inc. SiriusXM, Pandora and all related logos are trademarks of Sirius XM Radio Inc. and its respective subsidiaries. Other marks, channel names and logos are the property of their respective owners. All rights reserved. All rights reserved. The Bluetooth® word mark and logos are registered trademarks owned by Bluetooth SIG, Inc. and any use of such marks by SiriusXM is under license.

WARNING: This product contains chemicals known to the State of California to cause cancer and birth defects or other reproductive harm.

**Sirius XM Radio Inc.
1221 Avenue of the Americas, 36th Floor
New York, NY 10020**

1.866.635.2349

siriusxm.com