

■ Introduce

BT-211 is a solution based on Bluetooth wireless technology which propels you into a new dimension in connectivity. The technology offers fast and reliable transmission of voice and data information between compatible devices.

■ Package

- Bluetooth Headset
- Charger
- User manual

■ Headset Overview

1. Charging connector
2. Call handling button
3. Indicator light
4. Volume up
5. Volume down
6. Ear hook
7. Speaker
8. Microphone

■ Putting on the headset

1. Make sure the ear hook leans against speaker.



2. Place the ear hook behind your ear.



3. Adjust the headset and make sure the microphone is pointing towards your mouth.

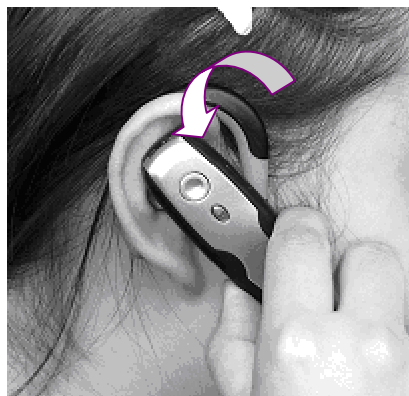

■ **Adjusting Ear Hook To Wear**

1. For your personal favorite, the BT-211 can be worn on the right or left ear.
2. Taking off the ear hook gently.
 - a. Make sure the ear hook is positioned as shown in the picture.



- b. Put your thumb on the circle which connects ear hook and headset.

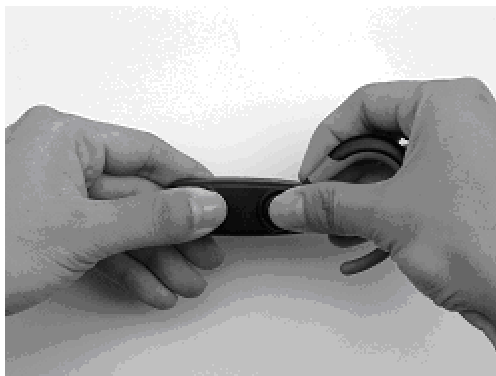

- c. Hold the headset firmly then pull the hear hook towards your face.

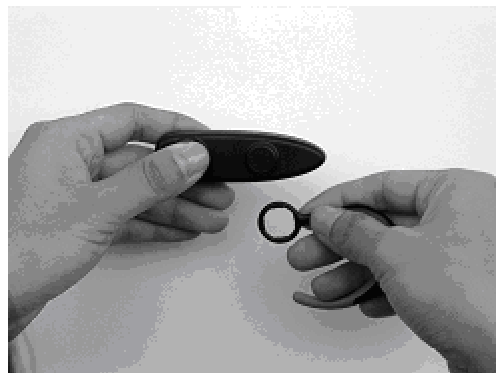

3. According which ear you want to wear then remount the ear hook to a direction desired.

- a. Put the ear hook on the connector as shown in the picture.



- b. Press the ear hook back into the connector.

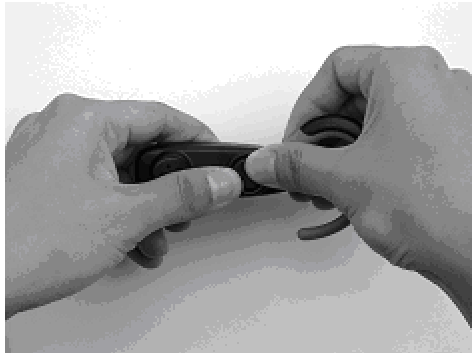

- c. Adjust the ear hook to an appropriate position for wearing.

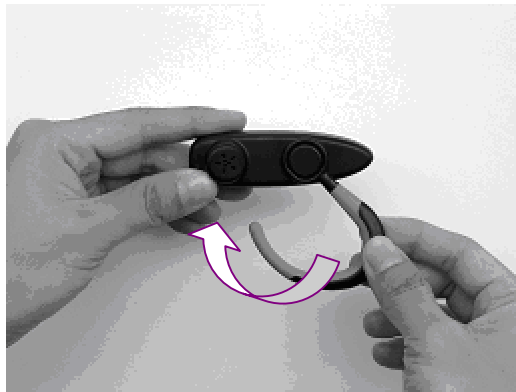

■ **Charging**

1. We recommended that you charge the battery until the headset indicator light turns off before using the headset at the first time
2. The headset comes with a built-in rechargeable Li-ion battery. If indicator light flashes red slowly, you need to recharge the battery. During charging, the indicator light shows a steady red light and turn off when the battery is fully charged.
3. When you use AC Adapter to charge the battery, the headset function is off.

■ **Getting Started**

Before you use your BT-211, you must pair it with a device, for example, a Bluetooth mobile phone. Mobile and headset can communicate as they are turned on and within range of the phone up to 10 m (30 ft) outdoors or up to 5 m (15 ft) indoors with no solid objects in between.

✓ **Pairing**

1. Preparing your phone according to the phone's user manual on adding a Bluetooth device.
2. When the headset is off, press and hold the call handling button for up to 10 seconds until the indicator light on the headset flashes green and red. Then headset is in the pairing mode.
3. Following the phone's user manual, entering the headset PIN code: **1234**.
4. When pairing has been completed, the headset indicator light flashes green.

Note: *You only need to add the headset to the phone once. If you want to use the headset with a new phone, you need to add it to that phone.*

✓ **Turning on / off Headset**

To turn on headset, please press and hold the call handling button until you hear a short low tone. The headset indicator light flashes green.

To turn off headset, please press and hold the call handling button until you hear a short high tone followed by a short low tone. The headset indicator light switches off.

✓ **Answering, Rejecting and Hang-up**

You can make and answer the calls using the buttons on the headset. When you hear the ring from headset, you just need to press the call handling button once to answer the calls and if you want to hang up this call, you also press the call handling button once to hang up. Due to the reason that phone functionality is still available when the headset is connected, if you use the keys on the phone to answer the calls, you will have to take this call from the phone rather than the headset. Besides, you can reject the incoming call by press and hold the call handling button about 2 to 3 seconds.



✓ **Adjusting The Volume**

During taking, you can adjust the volume from the buttons of headset.

To increase the volume, press "+".

To decrease the volume, press "-".

Note: *For safety and comfortable reasons, we recommend that do not tune the volume to the maximum level.*

✓ **Using Voice Dialing**

Please make sure the phone and the headset are on and within range of each other. Press the call handling button about 1~2 seconds. During this time, you might hear a repeated tone in the headset. After the beep, voice dial as you normally would. In order to use voice dialing, you must make sure your mobile phone supports this function.

Note: *1. If you fail using the voice commands you have recorded through your phone, record them through the headset instead.*

2. Voice commands, such as dial, redial, answer and reject, can be very useful when you are using the headset. For more information on voice commands, refer to the phone's user guide.

✓ **Audio Transfer**

During a call, you can press and hold the call handling button until hearing a short low tone to transfer the sound to mobile phone. If the headset is turned on after a call has been initiated or the sound is on the mobile phone, you can transfer the sound to the headset by pressing the call handling button once.



Please Note

The warranty will be invalid, if fail to follow the operation manual.

Federal Communications Commission (FCC) Statement:

15.21

You are caution that changers or modifications not expressly approved by the part responsible for compliance could void the user's authority to operate the equipment.

15.1.5 (b)

This equipment has been tested and found to comply with the limits for a Class B digital device, pursuant to part 15 of the FCC rules. These limits are designed to provide reasonable protection against harmful interference in a residential installation. This equipment generates uses and can radiate radio frequency energy and if not installed and used in accordance with the instruction may cause harmful interference to radio communications. However, there is no guarantee that interference will not occur in a particular installation. If this equipment does not cause harmful interference to radio or television reception which can be determined by turning the equipment off and on, the user is encouraged to try to correct the interference by one or more of the following measures:

- Reorient or relocate the receiving antenna.
- Increase the separation between the equipment and receiver.
Connect the equipment into an outlet on a circuit different from that to which the receiver is connected.
- Consult the dealer or an experience radio/TV technician for help.

You are cautioned that changes or modifications not expressly approved by the party responsible for compliance could void your authority to operate the equipment.

FCC RF Radiation Exposure Statement:

This Transmitter must not be co-located or operating in conjunction with any other antenna or transmitter.