

Mobile Phone

L575

User Guide

Attentions



SWITCH OFF IN HOSPITALS

Please abide by relevant provisions or regulations. Please turn off your mobile phone near medical equipment.



SWITCH OFF WHEN REFUELING

Don't use the phone at a refueling point. Don't use near fuel or chemicals.



Micro SIM CARDS ARE PORTABLE

Keep your phone, phone parts and accessories out of children's reach.



BATTERY

Please do not destroy or damage the battery, it can be dangerous and cause fire.

Please do not throw battery in fire to avoid hazard.

When battery cannot be used, please dispose in safe environment.

Do not try to dismantle the battery.

If the battery or the charger is broken or old, please stop using them, and replace with certified genuine battery



USE QUALITY EQUIPMENT

Use authorized equipment to avoid danger



ROAD SAFETY COMES FIRST

Give full attention while driving, Park before using your phone. Please follow traffic rules of local city town.



INTERFERENCE

All wireless devices may be susceptible to cause interference, which could affect performance.



SWITCH OFF IN AIRCRAFT

Wireless devices can cause interference in aircraft. It's not only dangerous but also illegal to use mobile phone in an aircraft.



Get Started

Get to grip with the basics and have your phone up and running in no time.

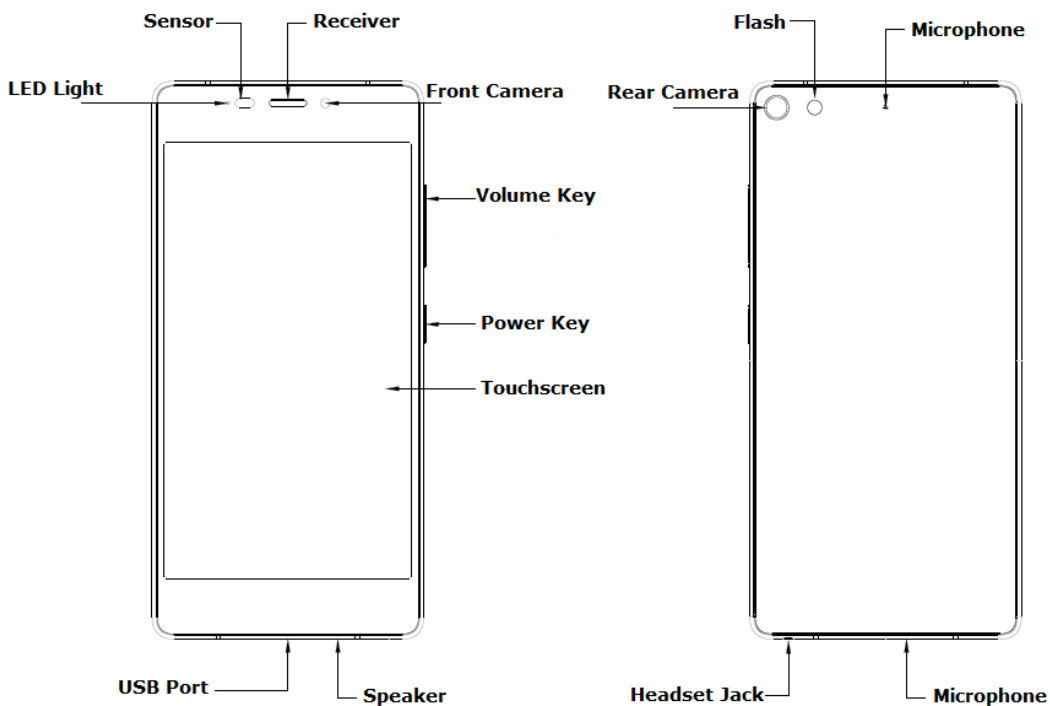
Over view



Keys definition

Keys	Definition
Power key (Right side)	a) Press to Turns on/off the screen. b) Press and Hold to power off or reboot the phone.
Volume key (Right side)	a) Press when call is in progress, increase or decrease the volume, when the phone is ringing, silences the ringer. On the home screen when no call in progress, increase or decrease the ringtone volume or sets the phone to the silent instead of ringing. In other applications, controls the volume of music, spoken directions and other audio. b) Press and hold to quickly increasing ringtone volume to maximum or minimum.
 Recent task key	Tap to open the list of recent used apps.
 Home key	Tap to return to Home screen.
 Back key	Tap to return to the previous screen.

★ **Tip:** The battery of mobile phone is fixed. It cannot remove.

Insert SIM card

1. Stick the SIM eject tool into the pin hole, then SIM card tray will be out of phone.

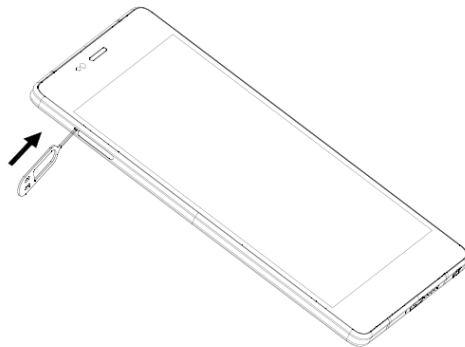

2. Put the Micro-SIM cards insert to card tray.

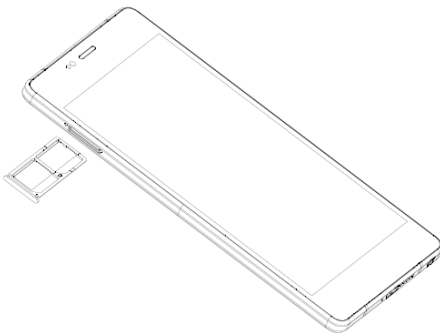

3. Push the holder back into the phone until it locks into place.

★ **Tip:** The SIM card is a small part. Please keep away from Children to avoid swallowing the card by accident. Please do not touch the metal surface of SIM card and away from electromagnetic field to avoid damage data.

Charge the Battery

Charge the battery before using it. Connect the USB cable to the USB power adaptor, and then plug the end of the USB cable into the USB Port.

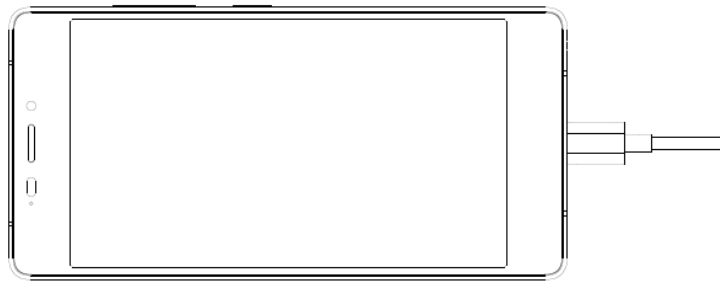

- ★ **Tip:** You can use USB charging when a wall outlet is not available. Data can be transferred while charging the device. The efficiency of USB charging power varies significantly, and it may take a long time for charging to start and the device to start functioning.

First connect the USB cable to computer USB port, then to your phone. When charging is done, first disconnect the USB cable from your phone, then from the computer USB port.

First start-up

Learn how to get your new phone up and running.

Basic operations

- [Turn on the phone](#)
Press and hold a while of power key to turn on the phone.
- [Turn off the phone](#)
Long press the power key until a menu will show. Choose "Power off" to turn off the phone.
- [Reboot the phone](#)
Option 1: Long press the power key until a menu will show. Choose "Reboot" to restart the phone.
Option 2: Long press the power key till 12 seconds to auto restart the phone.
- [Lock the screen](#)
Option 1: Press the power key to turn off the screen and lock it
Option 2: The screen will auto lock if you don't use the phone for a while.
- [Unlock the screen](#)
Press the power key, and then slide to top for unlocking.

Toolbox operation

- [Disable the toolbox](#)
Swipe from touch panel bottom to top, then can disable the toolbox.

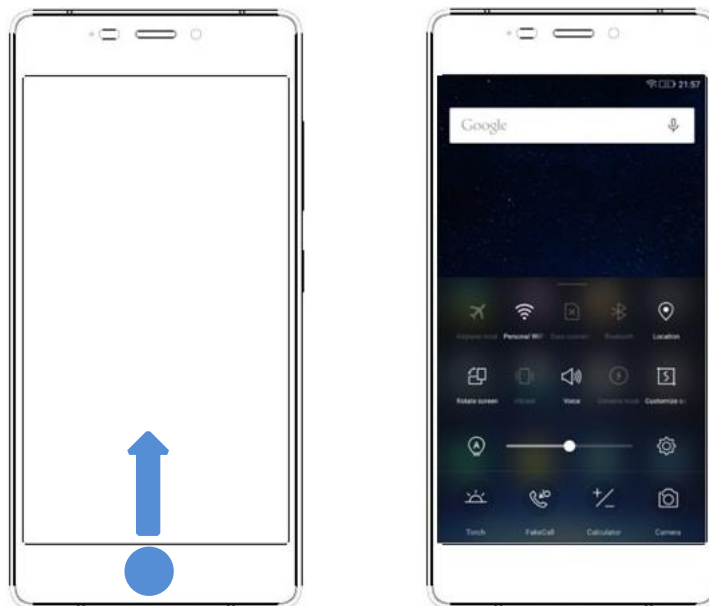

Touch operations

- Touch:

To act on items on the screen, such as application and settings icons, to type letters and symbols using the onscreen keyboard, or to press onscreen buttons, you simply touch them with your finger.

- Touch & hold:

Touch & hold an item on the screen by touching it and not lifting your finger until an action occurs.

- Drag:

Touch & hold an item for a moment and then, without lifting your finger, move your finger on the screen until you reach the target position. You drag items on the Home screen to reposition them and you drag to open the Notification panel.

- Swipe or slide:

To swipe or slide, you quickly move your finger across the surface of the screen, without pausing when you first touch (so you don't drag an item instead). For example, you slide the screen up or down to scroll a list, and in some Calendar views you swipe quickly across the screen to change the range of time visible.

- Pinch:

In some applications (Such as Maps and Gallery) you can zoom in and out by placing two fingers on the screen at once and pinching them together (to zoom out) or spreading them apart (to zoom in).

- Rotate the screen:

On most screens, the orientation of the screen rotates with the phone as you turn it from upright to its side and back again. You can turn this feature on and off.

Funny camera

Camera designed many funny functionalities to make you fall in love with camera at any time.

	Normal	Take a phone as usually.
	Professional	Change the clarity and focus mode. For Rear camera only.
	Face Beauty	DIY your face with Smoother, Whitening, Slimming, Enlarger.
	Take anytime	Best shot, Tracks, Best face, Motion blur, Eraser
	Magic Focus	For Rear camera only.
	Filter	Multiple filters can choose. Normal, Cate, Beauty, LOMO, B&W, Time, Sweet, Vintage, Hazy, Bokeh.
	HDR	High-Dynamic Range. For Rear camera only.
	Panorama	Press camera button and move the phone on one direction slowly. For Rear camera only.
	Night	For Rear camera only.
	Pic Note	Focus to PPT, Whiteboard, Book, Clip and optimize smartly after capturing. For Rear camera only.

Smart Gestures

Settings-->Advanced Settings--> Smart gestures, check Smart gestures to turn it on.

The smart gestures system supports a variety of experience and control, through gesture can be more convenient operation.

● [Smart dial](#)

Settings-->Advanced Settings--> Smart gestures --> Select Smart dial

In message content page, contacts details page or call history details page, dial the number automatically after pick up the phone to your ear. In contacts details page, directly dial the first number if you have many numbers. Dual card mobile phone, please set default dial card from Settings-Dual card settings – Calls at first.

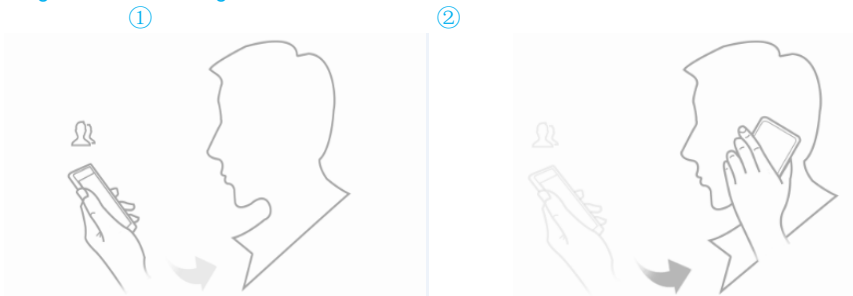

● [Smart answer](#)

Settings--> Advanced Settings--> Smart gestures -->Select Smart answer

Pick up the phone to your ear so it will answer the incoming call automatically.

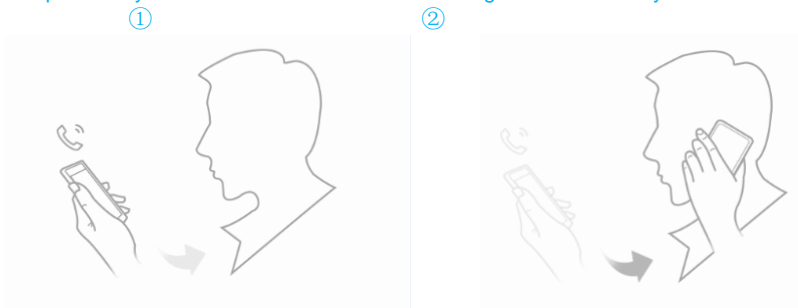

● [Pause alarm](#)

Settings--> Advanced Settings-->Smart gestures -->Select Pause alarm

Flip back the phone to pause the on-going alarm.

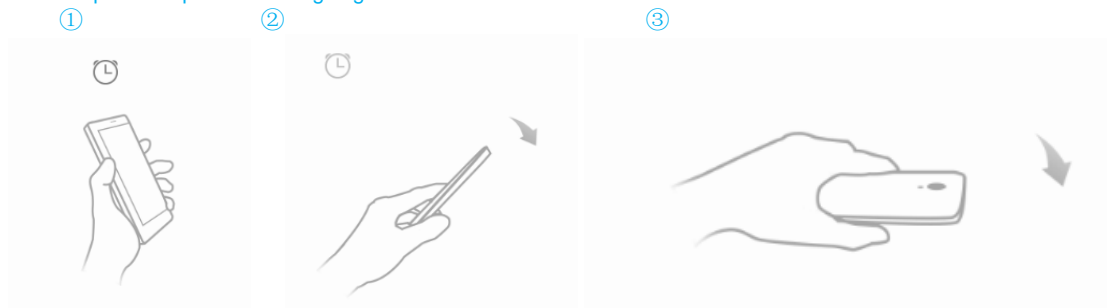

● [Black screen gestures](#)

Settings--> Advanced Settings--> Smart gestures -->Select Black screen gestures

Draw pattern to access menu quickly while phone is in sleep mode.

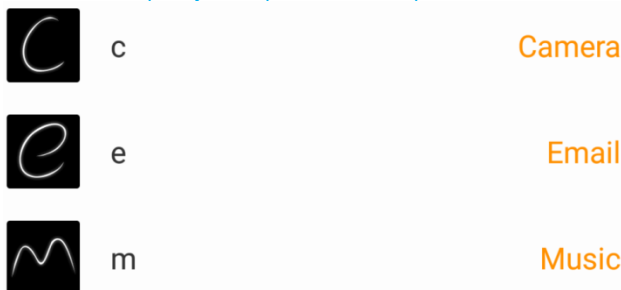

● [Smart vibration remind](#)

Settings--> Advanced Settings--> Smart gestures -->Select Smart vibration remind

Phone vibrate to remind the unread message or missed call notification in sleep mode.





● [Smart bright screen](#)

Settings--> Advanced Settings--> Smart gestures -->Select Smart bright screen

When front camera detects you are viewing screen, the screen can be maintained normally. Enable this function, the status bar will display this icon .

The following scenario, the function maybe failure:

- User doesn't face on the screen
- The light is too strong or too dark
- Front camera in use by other applications

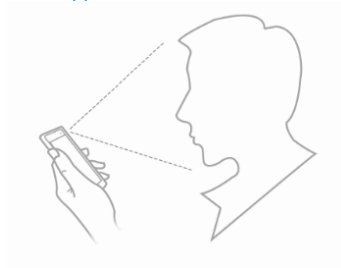

● [Double click wake](#)

Settings--> Advanced Settings--> Smart gestures -->Select Double click wake

In sleep screen, quick double tapping can wake up the mobile phone.

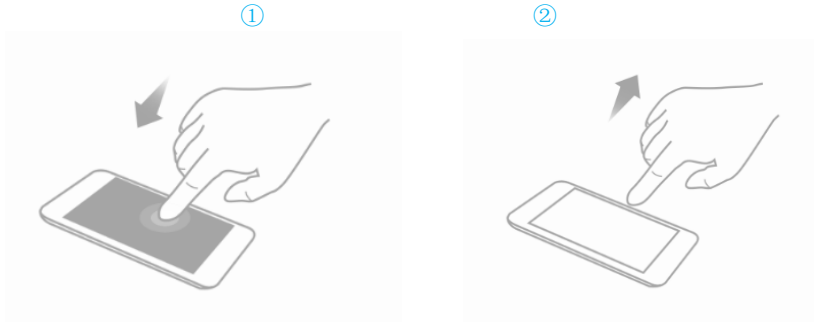

Touchless wake-up

Settings-->Advanced Settings-->Smart gestures -->Touchless wake-up, check Touchless wake-up to turn it on.

You can slide to unlock, view image, control volume without touch screen.

● [Air light screen](#)

Settings--> Advanced Settings--> Smart gestures -->Touchless wake-up -->Select Air light screen

In sleep screen, palm wave slowly over the phone can wake up the screen.

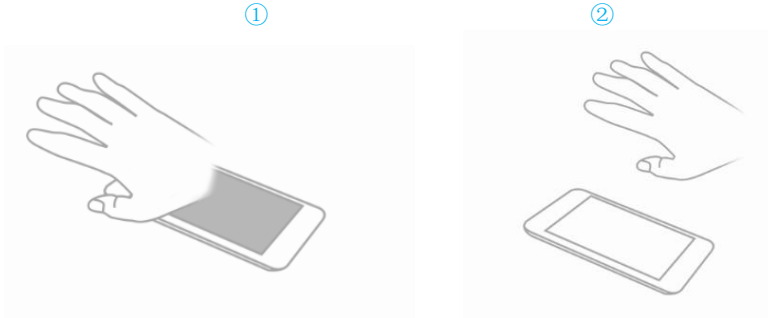

- [Touchless unlock](#)

Settings--> Advanced Settings--> Smart gestures -->Touchless wake-up -->Select Touchless unlock
In wake-up screen, palm wave slowly over the phone can unlock the phone.

①

②

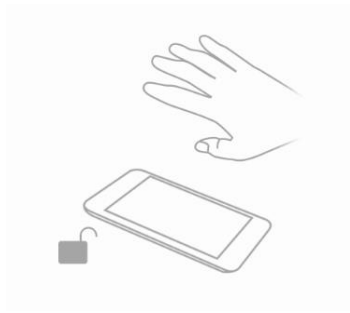

- [Touchless desktop control](#)

Settings--> Advanced Settings--> Smart gestures -->Touchless wake-up -->Select Touchless desktop control
While mobile phone is in system desktop, palm slowly wave left/right over the phone can slid desktop to according direction.

①

②



- [Touchless image browsing](#)

Settings--> Advanced Settings--> Smart gestures -->Touchless wake-up -->Select Touchless image browsing
Wave your palm left/right slowly over the top of the phone to view the previous/next image.

①

②

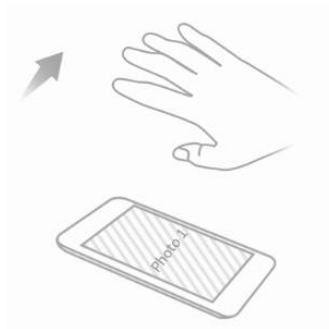

- [Touchless video control](#)

Settings--> Advanced Settings--> Smart gestures -->Touchless wake-up -->Select Touchless video control
Wave your palm left/right slowly over the top of the phone to play/pause playing. Wave up/down to control volume up/down.

①

②

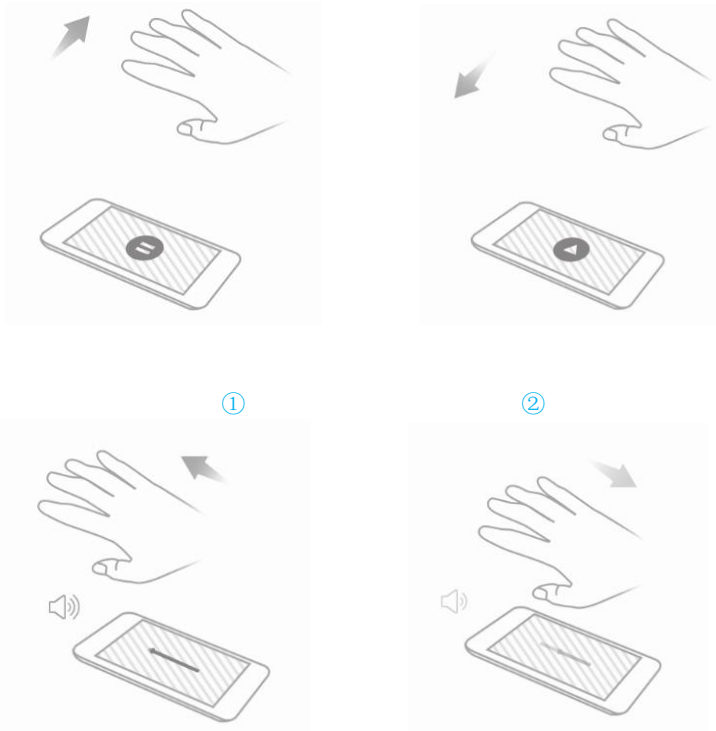

Warnings and notes

IMPORTANT INFORMATION ON SAFE AND EFFICIENT OPERATION. Read this information before using your phone. For the safe and efficient operation of your phone, observe these guidelines:

Potentially explosive at atmospheres: Turn off your phone when you are in any areas with a potentially explosive atmosphere, such as fueling areas (gas or petrol stations, below deck on boats), storage facilities for fuel or chemicals, blasting areas and areas near electrical blasting caps, and areas where there are chemicals or particles (Such as metal powders, grains, and dust) in the air.

Interference to medical and personal Electronic Devices: Most but not all electronic equipment is shielded from RF signals and certain electronic equipment may not be shielded against the RF signals from your phone.

Audio Safety: This phone is capable of producing loud noises which may damage your hearing. When using the speaker phone feature, it is recommended that you place your phone at a safe distance from your ear.

Other Media Devices, hospitals: If you use any other personal medical device, consult the manufacture of your device to determine if it is adequately shielded from external RF energy. Your physician may be able to assist you in obtaining this information. Turn your phone OFF in health care facilities when any regulations posted in these areas instruct you to do so. Hospitals or health care facilities may be using equipment that could be sensitive to external RF energy.

Product statement on handling and use: You alone are responsible for how you use your phone and any consequences of its use.

You must always switch off your phone wherever the use of a phone is prohibited. Use of your phone is subject to safety measures designed to protect users and their environment.

Always treat your phone and its accessories with care and keep it in a clean and dust-free place

- Do not expose your phone or its accessories to open flames or lit tobacco products.
- Do not expose your phone or its accessories to liquid, moisture, or high humidity.
- Do not drop, throw, or try to bend your phone or its accessories
- Do not use harsh chemicals, cleaning solvents, or aerosols to clean the device or its accessories.
- Do not attempt to disassemble your phone or its accessories; only authorized personnel must do so.
- Do not expose your phone or its accessories to extreme temperatures, minimum 32°F and maximum 113°F(0°C to 45°C).

Battery: Your phone includes an internal lithium-ion or lithium-ion polymer battery. Please note that use of certain data applications can result in heavy battery use and may require frequent battery charging. Any disposal of the phone or battery must comply with laws and regulations pertaining to lithium-ion or lithium-ion polymer batteries.

Faulty and damaged products: Do not attempt to disassemble the phone or its accessory. Only qualified personnel must service or repair the phone or its accessory. If your phone or its accessory has been submerged in water, Punctured, or subjected to a severe fall, do not use it until you have taken it to be checked at an authorized service center.

The SAR limit of USA (FCC) is 1.6 W/kg averaged over one gram of tissue. Device types **L575** (FCC ID: **RQQHLT-GL5H0**) has also been tested against this SAR limit. The highest SAR value reported to the FCC for this device type when tested for use at the ear is 0.733 W/kg, and when properly worn on the body is 0.549 W/kg, and when using Wi-Fi hotspot function is 1.19 W/Kg. This device was tested for typical body-worn operations with the back of the handset kept 1.5cm from the body. To maintain compliance with FCC RF exposure requirements, use accessories that maintain a 1.5cm separation distance between the user's body and the back of the handset. The use of belt clips, holsters and similar accessories should not contain metallic components in its assembly. The use of

accessories that do not satisfy these requirements may not comply with FCC RF exposure requirements, and should be avoided.

This device complies with part 15 of the FCC rules. Operation is subject to the following two conditions: (1) this device may not cause harmful interference, and (2) this device must accept any interference received, including interference that may cause undesired operation.

NOTE: The manufacturer is not responsible for any radio or TV interference caused by unauthorized modifications to this equipment. Such modifications could void the user's authority to operate the equipment.

NOTE: This equipment has been tested and found to comply with the limits for a Class B digital device, pursuant to part 15 of the FCC Rules. These limits are designed to provide reasonable protection against harmful interference in a residential installation. This equipment generates uses and can radiate radio frequency energy and, if not installed and used in accordance with the instructions, may cause harmful interference to radio communications. However, there is no guarantee that interference will not occur in a particular installation. If this equipment does cause harmful interference to radio or television reception, which can be determined by turning the equipment off and on, the user is encouraged to try to correct the interference by one or more of the following measures:

- Reorient or relocate the receiving antenna.
- Increase the separation between the equipment and receiver.
- Connect the equipment into an outlet on a circuit different from that to which the receiver is connected.
- Consult the dealer or an experienced radio/TV technician for help

Changes or modifications made to this equipment not expressly approved by (Gionee Communication Equipment Co.,Ltd.) may void the FCC authorization to operate this equipment.

15.247 (DSS,DTS)

This equipment complies with FCC RF radiation exposure limits set forth for an uncontrolled environment.

Radio frequency radiation exposure Information:

To ensure compliance with RF exposure guidelines, the device must be used with a minimum of 1.5 cm distance from the body (as specified in FCC rules) and 10mm from the body for hotspot use.