

Appendix D. Photographs of EUT and Setup

FCC SAR Test Report

<Photographs of EUT>

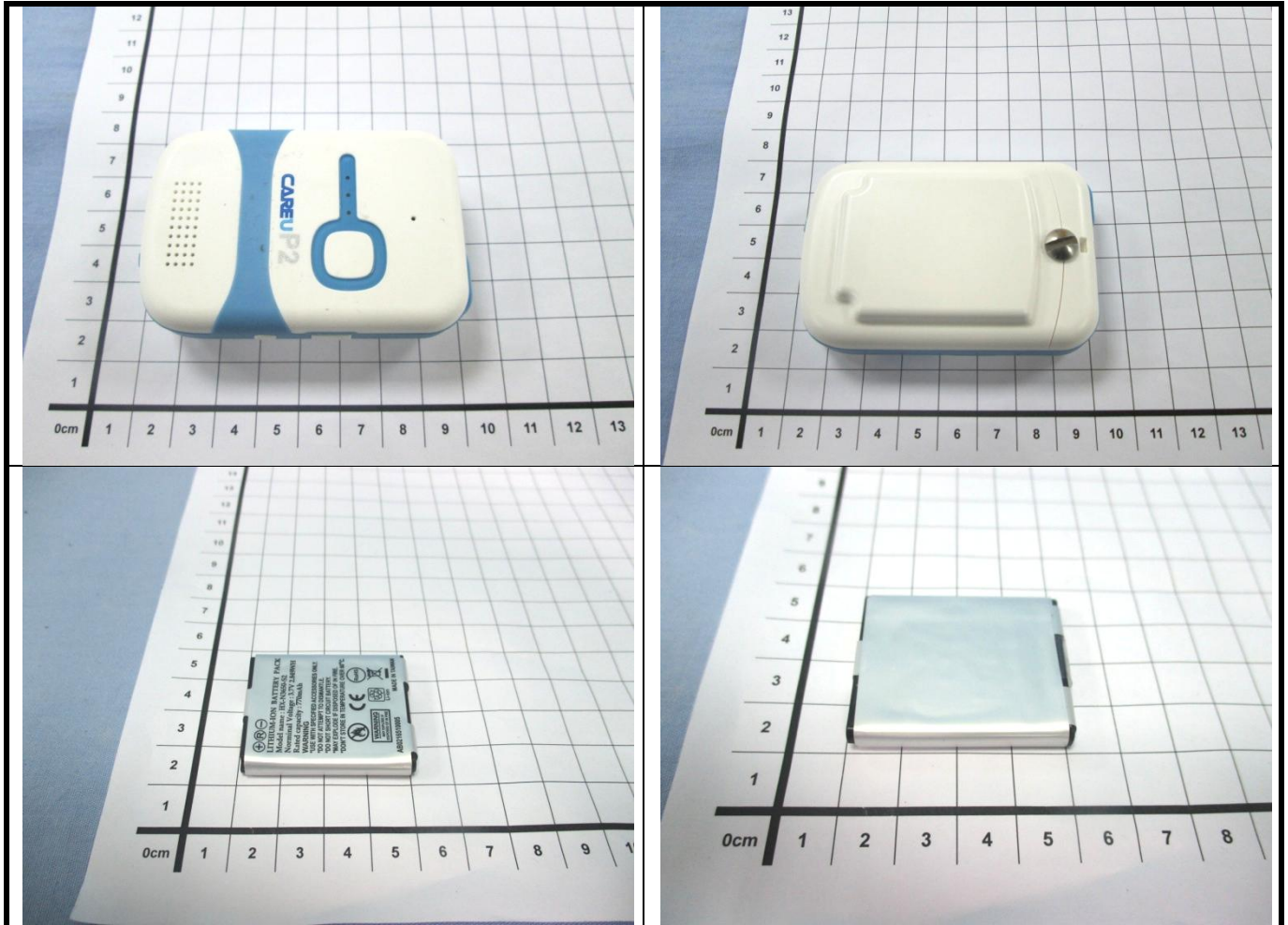

<Antenna Location>

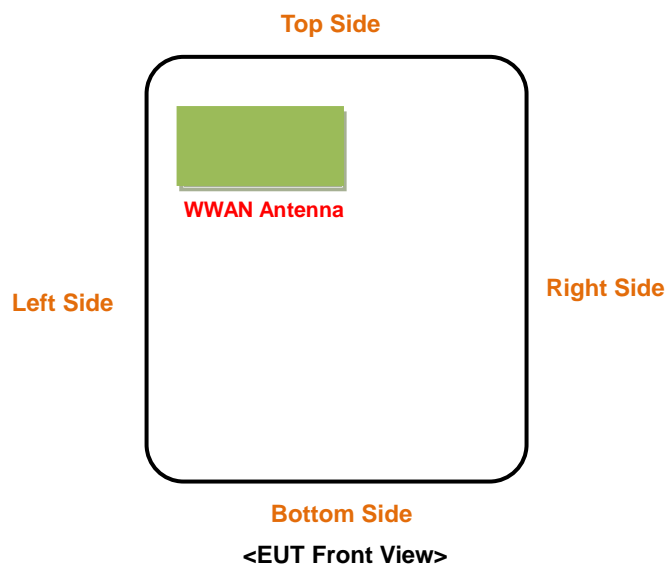

The separation distance for antenna to edge:

Antenna	To Top Side (mm)	To Bottom Side (mm)	To Left Side (mm)	To Right Side (mm)
WWAN	17	55	7	37

FCC SAR Test Report

<Photographs of SAR Setup>



**Front Face of EUT with 0 cm Gap
(Body Mode)**



**Rear Face of EUT with 0 cm Gap
(Body Mode)**





**Left Side of EUT with 0 cm Gap
(Body Mode)**



**Right Side of EUT with 0 cm Gap
(Body Mode)**

FCC SAR Test Report

	
Top Side of EUT with 0 cm Gap (Body Mode)	Bottom Side of EUT with 0 cm Gap (Body Mode)
	
Front Face of EUT with 1 cm Gap (Face Mode)	