

PRODUCT SPECIFICATIONS

Modulation	FM Stereo Modulation
Frequencies	88.1, 88.3, 88.5, 88.7 MHz
Audio Input Connector	3.5mm Stereo Plug
Power Requirement	1 "CR2" Lithium Battery
Battery Life	40+ hrs. typical

FCC INFORMATION

This device complies with part 15 of the FCC Rules. Operation is subject to the following two conditions:

- (1) This device may not cause harmful interference, and
- (2) This device must accept any interference received, including interference that may cause undesired operation.

CAUTION: Changes or modifications not expressly approved by Aerielle may void the users authority to operate this equipment.

Email: customerservice@aerielle.com

Website: www.aerielle.com

Phone: 408-564-5096

Made in CHINA

Copyright © 2003-2004, Aerielle. All Rights Reserved.

Aerielle and AudioBUG are trademarks of Aerielle Group International Inc.

Covered under U. S. Patent No. 5,771,441, 6,671,494, D478,057, and other Patent Pending applications.

AUDIO SPECIFICATIONS

Signal Format	Standard FM Stereo Format, 38 KHz subcarrier
Audio Range	15Hz – 15 KHz
Signal-to-Noise Ratio*	>60dB
Total Harmonic Distortion	0.3%, Max.
Channel Separation	40 dB Typical
Channel Balance	+/- 2 dB



* A weighted



WARNING

CHOKING HAZARD - Small parts.
Not for children under 3 years.



INTRODUCTION

Thank you for purchasing the AudioBUG™ from Aerielle™. AudioBUG is a user-friendly portable wireless audio system that lets you enjoy your music collection while on the go.

AudioBUG features Aerielle patented wireless technology to send high-fidelity stereo audio signals from any audio device to any FM radio or stereo within 15 ft. Simply plug the AudioBUG into any audio output source, choose one of the four frequencies (88.1, 88.3, 88.5 or 88.7 MHz) that you wish to broadcast and tune your radio to that frequency. AudioBUG gives you the freedom to enjoy your music where you want, with out the wires.

BEFORE YOU BEGIN

Read these instructions thoroughly before setting up your AudioBUG. If you need any assistance, please contact customer service at: 408-564-5096, or submit an email request to: customerservice@aerielle.com.

COMPATIBILITY

One of the many unique features of AudioBUG is that it was designed to work with any portable personal stereo. This means that no matter what brand or size of personal stereo you may have, your AudioBUG is compatible. Typical uses for AudioBUG include:

- ▶ Portable MP3 digital audio players
- ▶ Portable CD players
- ▶ Portable Mini-disc players
- ▶ Portable DVD players
- ▶ Laptop or Desktop Computers

AudioBUG is compatible with every audio player, and will broadcast to any FM radio or stereo. Whether it is your surround sound stereo system in your family or living room or on your car stereo, AudioBUG just plugs and plays.

- 1 Power on Indicators
- 2 Frequency Selector
- 3 3.5 mm stereo cable
- 4 Battery Compartment "CR2"

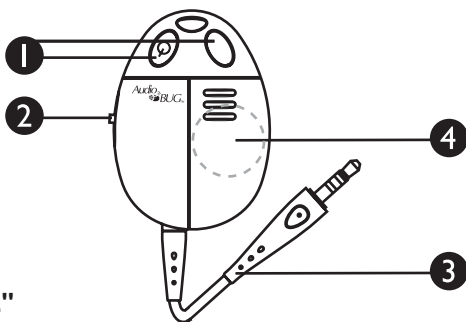

AUTO-ON/AUTO-OFF FUNCTIONALITY

Your AB-250 AudioBUG features special Auto-On and Auto-Off capabilities for extended battery life. Once audio is detected, the lights on your AudioBUG will illuminate to indicate your AudioBUG is transmitting an audio signal. If after 30 seconds there is no detection of audio, the AudioBUG will turn off. When turning off your audio source, your AudioBUG turns off automatically.

SETUP PROCEDURE

Setting up your AudioBUG is an easy procedure. Simply:

- 1) Remove the battery cover from the top of unit by gently sliding the battery door marked toward you.
- 2) Install 1 CR2 battery with the negative end facing the eyes of the AudioBUG.
- 3) Select the frequency that you wish to transmit to with the selector on the side of the AudioBUG (88.1, 88.3, 88.5, 88.7 MHz)
- 4) Plug the 3.5mm stereo cable into the audio out connector or the headphone jack of the audio source you wish to transmit* AudioBUG lights will turn when audio an signal is detected.
- 5) Tune your FM stereo to the corresponding FM frequency as selected in step # 3
- 6) Adjust the volume on your audio player and stereo or headphone radio for maximum enjoyment.

* Best results achieved when audio level of source is at 3/4. Some audio sources output level is either to high or to low at the line-out jack. If it is to high, the sound might be distorted. If it is to low, the sound might be to noisy. If this happens, connect the AudioBUG to the headphone jack and adjust the volume level on your audio device.

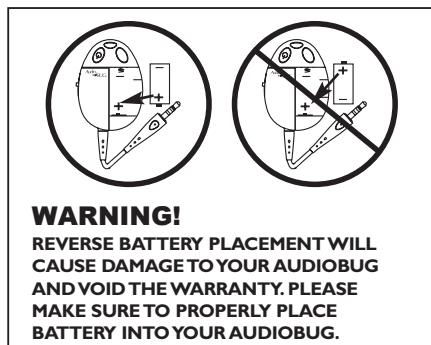

FREQUENTLY ASKED QUESTIONS

Q: What is an AudioBUG?

A: Developed by Aerielle, the AudioBUG is a portable music transmitter that connects to any personal stereo headphone jack and transmits your music to any FM radio within 15 ft.

Q: How can I achieve maximum performance and sound quality from AudioBUG?

- A:
- 1) Maintain fresh batteries
 - 2) Keep your AudioBUG within 15 ft. of the FM radio that it is transmitting to.
 - 3) Keep the cord that connects the AudioBUG to the audio player straight, positioning the player as far from the AudioBUG as possible.
 - 4) Before using the AudioBUG, listen to 88.1, 88.3, 88.5, 88.7 FM on your radio and use the frequency with the least amount of interference.

WARRANTY INFORMATION

Aerielle provides a 90 day warranty for this product and will promptly repair or replace any product shown to be defective during this warranty period. In order to return a defective product, you must contact Aerielle at: 408-564-5096, or submit an email request to customerservice@aerielle.com to receive a Return Merchandise Authorization (RMA) number. This number MUST be displayed on your mailing label. You will also be given instructions on how to package and return the defective unit.

THIS WARRANTY DOES NOT APPLY TO AudioBUG™ THAT HAS BEEN DAMAGED AS A RESULT OF IMPROPER MAINTENANCE, ACCIDENTS, IMPROPER VOLTAGE SUPPLY, OR OTHER MISUSE. THE WARRANTY IS ALSO VOID IF THE OWNER REPAIRS OR MODIFIES THE PRODUCT IN ANY WAY. AERIELLE IS NOT LIABLE FOR ANY INCIDENTAL OR CONSEQUENTIAL DAMAGES WITH REGARD TO THIS PRODUCT. THE WARRANTY EXCLUDES ANY LIABILITY OTHER THAN WHAT IS STATED ABOVE. NO OTHER WARRANTIES ARE GIVEN.

Legal rights vary from state to state. Some states do not allow the exclusion of limitation of incidental or consequential damages, so the above limitations may not apply to you.

Important note: Use only CR2 batteries as power for AudioBUG. Use of any other power supply will void this warranty.