

SECIFICATION

**OA-2450-12 Dipole
Antennas for Base
Stations with 12dBi Gain**

SUMMARY:

This Omni antenna is an omni directional type that will increase signal range and strength greatly in a sphere shape. It comes with a very good fitting kit that includes high quality brackets nuts, bolts and washers. It can be used to cover 360 degree pops.

- Designed for wireless LAN communications
- Mounts easily for indoor or outside applications
- Suited for IEEE 802.11b/g wireless LANs
- Made with high quality fiberglass material

Technical information

Frequency	2400 - 2500MHz
-----------	----------------

Gain	12 dBi
------	--------

Polarization	Vertical
--------------	----------

Beamwidth deg vertical & horizontal	Horz.360°Vert.7°
-------------------------------------	------------------

SWR	≤1.5 : 1
-----	----------

Impedance	50 Ohm
-----------	--------

Dimensions

Length	H1500 mm
--------	----------

Weight	850 g
--------	-------

15 Jul 2002 10:39:06

CH1 RFL LOG 10 dB/REF 0 dB 3*-17.480 dB 2.493.500 000 MHz

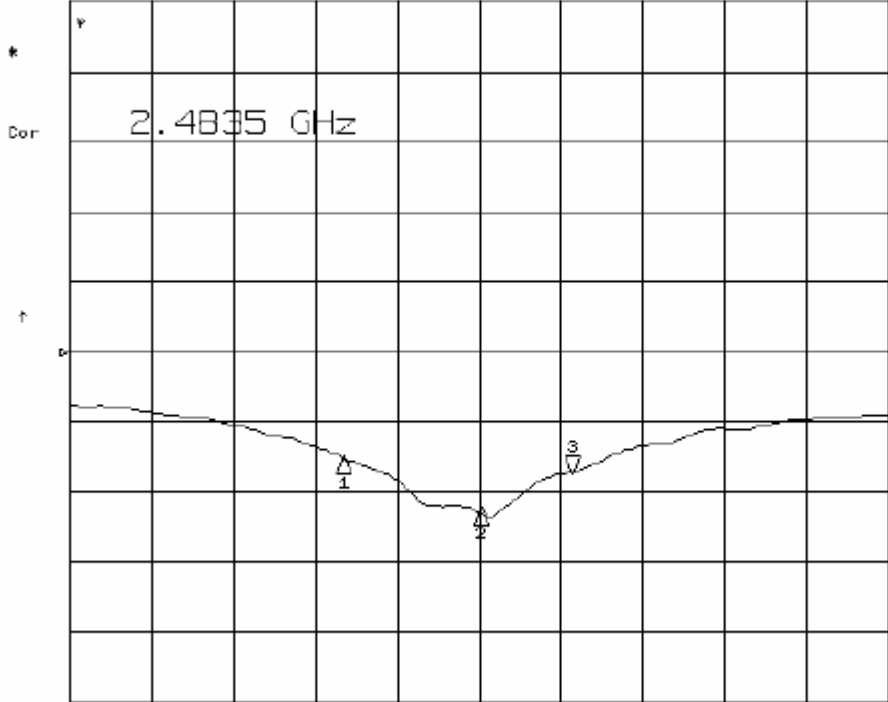

CH1 Markers
1:-15.050 dB
2.48000 GHz
2:-22.379 dB
2.48600 GHz

CENTER 2.450.000 000 MHz

SPAN 300.000 000 MHz

H-PLANE FIELD PATTERNS

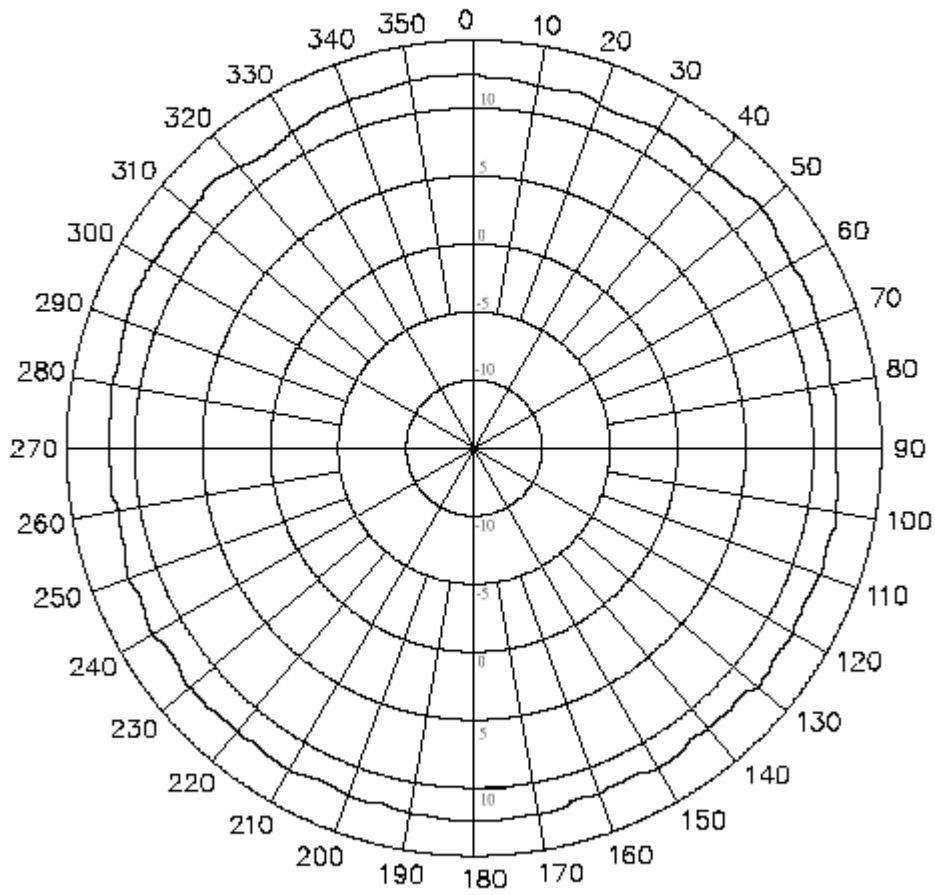

E-PLANE FIELD PATTERNS

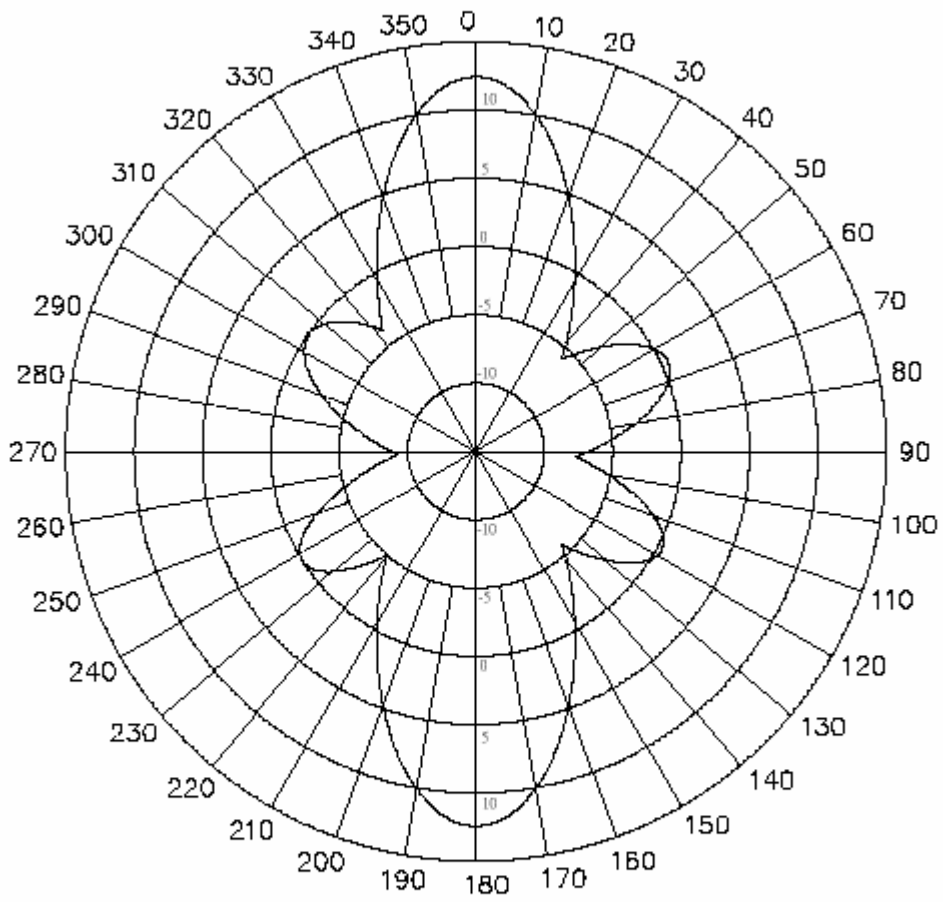

REV	DESCRIPTION	DRAWN	DATE

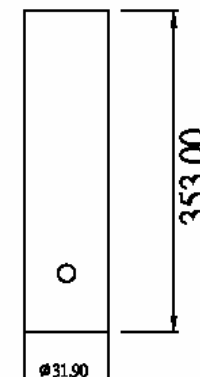
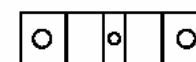
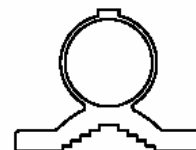
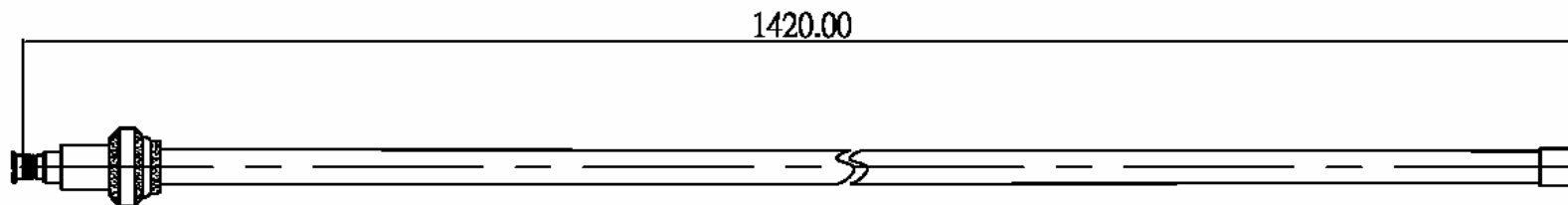

Key Specifications/Special Features:

- Omni-directional antenna designed for wireless LAN communication
- Supports IEEE's 802.11a standard for wireless Ethernet networking
- Mounts easily for indoor or outside applications

8	Gain (dBi)	12	Weight	350g
7	Type	Omni	Mount	N/A
6	Polarization	Vertical		
5	Beamwidth deg.	Horz. N/A/Vert. 90°		
4	SWR	≤1.5:1		
3	Frequency	2400~2485MHz		
2	Connector	N-Female		
1	Size	E1420mm		

UNLESS OTHERWISE SPECIFIED
 1. REMOVE ALL BURRS.
 2. BREAK ALL CONNERS & EDGES 0.15 MAX.
 3. CHAMFER 1ST & LAST THREADS 45°
 4. DIAMETERS ON COMMON CENTERS TO BE CONCENTRIC WITHIN 0.1 TIR.
 5. ALL DIMENSIONS ARE AFTER PLATING.

UNLESS OTHERWISE NOTED TOLERANCES
 0.5-6=±0.2
 6-30=±0.4
 30-120=±0.6
 120-315=±1.0
 ANGLES=±1°

SCALE 5/1 UNIT MM

APPROVED
 CHECKED
 DRAWN PEN
 DRAWN DATE 09/30/04

華耀科技有限公司
 Hwa Yao Technologies Co., Ltd
 TITLE Omni 12dbi Antenna
 DRAWING NO. OA-2450-12
 REV A
 FILE NO. D:\JWG\Dev\Bdbi Antenna\OA-2450-12