

GPS1200 Professional Series



User Manual

Version 1.0

English

Leica
Geosystems

Introduction

Purchase

Congratulations on the purchase of a GPS1200 Professional Series instrument.



This manual contains important safety directions as well as instructions for setting up the product and operating it. Refer to "7 Safety Directions" for further information. Read carefully through the User Manual before you switch on the product.

Product identification

The model and the serial number of your product are indicated on the type plate. Enter the model and serial number in your manual and always refer to this information when you need to contact your agency or Leica Geosystems authorized service workshop.





Type: _____

Serial No.: _____

Software-Version: _____

Symbols

The symbols used in this manual have the following meanings:

Type	Description
 Danger	Indicates an imminently hazardous situation which, if not avoided, will result in death or serious injury.
 Warning	Indicates a potentially hazardous situation or an unintended use which, if not avoided, could result in death or serious injury.
 Caution	Indicates a potentially hazardous situation or an unintended use which, if not avoided, may result in minor or moderate injury and/or appreciable material, financial and environmental damage.
	Important paragraphs which must be adhered to in practice as they enable the product to be used in a technically correct and efficient manner.

Trademarks

- Windows (registered trademark of Microsoft Corporation)
- Bluetooth (registered trademark of Bluetooth SIG, Inc.)

All other trademarks are the property of their respective owners.

Table of Contents

In this manual

Chapter	Page
1 How to Use this Manual	1-1
2 Description of the System	2-1
3 User Interface	3-1
4 Operation	4-1
5 Reference Station	5-1
6 Care and Transport	6-1
7 Safety Directions	7-1
8 Technical Data	8-1

1 How to Use this Manual



It is recommended to set-up the product while reading through this manual.

Path

Main Menu: Manage...Data stands for this working sequence:
From the **Main Menu** select **Manage...** and then select **Data**.

Screen

CONFIGURE General Menu describes the name of the screen.

Page

Screens can have more than one page. **Units** page describes a specific page of a screen. For example: '...in **CONFIGURE Units & Formats, Units** page...'

Fields and options

Fields displayed on the screen are described as **<Coord System:>** or **<Coord System: Swiss>**, if 'Swiss' is the selected coordinate system.

Index

The index is at the back of the manual.



Keys, fields and options on the screens which are considered as self-explanatory are not explained.

Validity of this manual

- This manual applies to all GPS1200 instruments. Differences between the various models are marked and described.

- The RX1200 is available as RX1210 or RX1220 and with touch screen functionality as [RX1210T](#) or [RX1220T](#). The names RX1210 and RX1220 are used throughout the manual and may also represent the T models. Only use the supplied stylus on the touch screens of the T models.

Illustrations

For the purpose of the illustrations, a GX1230 model has been selected which is representative for all models.

Available documentation

Name of documentation	Description
GPS1200 User Manual	All instructions required in order to operate the instrument to a basic level are contained in this User Manual. Provides an overview of the system together with technical data and safety directions.

Name of documentation	Description
GPS1200 System Field Manual	Describes the general working of the system in standard use. Intended as a quick reference field guide.

Name of documentation	Description
GPS1200 Application Programs Field Manual	Describes specific onboard application programs in standard use. Intended as a quick reference field guide.
GPS1200 Technical Reference Manual	Overall comprehensive guide to the system and program functions. Included are detailed descriptions of special software/hardware settings and software/hardware functions intended for technical specialists.

Format of the documentation

The GPS1200 CD contains the entire documentation in electronic format. All manuals are also available in printed form except for the GPS1200 Technical Reference Manual.

2 Description of the System

In this chapter

	Topic	Page
2.1	System Components	2-2
2.2	Container Contents	2-5
2.3	Receiver Components	2-8
2.4	System Concept	2-9

2.1 System Components

Main components

Receiver:	To calculate a range to all visible satellites.
RX1200:	To operate the user interface either by the keyboard or by the touch screen with supplied stylus.
Antenna:	To receive the satellite signals from the NAVSTAR satellites.
Leica Geo Office:	The office software including a series of help programs which support working with GPS1200.
Leica GPS Spider :	The reference station software required to operate the reference station receivers of GPS1200.

Receivers

GX1230:	Twelve L1, twelve L2 channels, code and phase, real-time capable
GX1220:	Twelve L1, twelve L2 channels, code and phase
GX1210:	Twelve L1 channels, code and phase
GX1200 PPS with PPS/Event option	Twelve L1, twelve L2 channels, code and phase, real-time capable, with event and PPS ports
GRX1200	Twelve L1, twelve L2 channels, code and phase, real-time capable, for reference station applications

GRX1200 Pro

Twelve L1, twelve L2 channels, code and phase, real-time capable, with event, PPS, oscillator and NET port, for reference station applications

[Refer to "8 Technical Data"](#) for information on technical specifications.



The GX1230, GX1220, [GX1200 PPS](#) with PPS/Event option, GRX1200 and GRX1200 Pro receivers use the GPS P-code signal, which by U.S. policy is liable to be switched off without notice. Phase measurements on L2 are ensured as these receivers automatically switch to patented tracking techniques.

Antennas used with receivers

Receiver	Antenna
GX1230/GX1220	Typically: AX1202, otherwise: AT504
GX1210	AX1201
GRX1200/GRX1200 Pro	Typically: AT504, otherwise: AX1202

[Refer to "8 Technical Data"](#) for information on technical specifications.

Leica Geo Office

The office software is called Leica Geo Office LGO.

Use

- to post-process data.
- to create and edit codelists.

- to edit coordinates.
- to exchange data between the receiver and a PC.
- to create and edit format files.
- to load and delete system software and application program software.

Operating systems

- Windows® XP
- Windows® ME
- Windows® 2000

Refer to the online help of LGO for additional information.

Leica GPS Spider

The reference station software is known as [Leica GPS Spider](#). It is required to operate the GRX1200 and GRX1200 Pro.

Use

- to connect from a PC to a GPS1200 receiver locally or remotely.
- to configure receiver operation.
- to monitor receiver operation.
- to automatically download raw data.
- to automatically convert data to RINEX format.
- to automatically archive data files.
- to automatically distribute to FTP locations.

Operating systems

- Windows® XP
- Windows® 2000

Refer to the online help of [Leica GPS Spider](#) for additional information.

2.2 Container Contents

Description

The GPS1200 with all accessories is packed in one transport container. Additional equipment which does not fit into the transport container might be required, for example a tripod. These accessories are not mentioned.

Lower portion

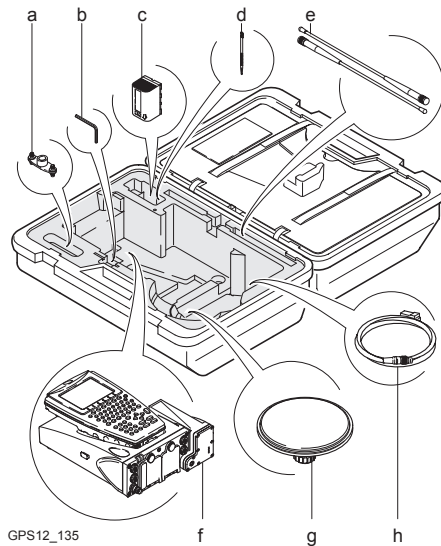

- a) Double arm for antennas of devices
- b) Adjusting pin
- c) Spare battery
- d) Supplied stylus
- e) Antennas of device
- f) GX1200 with RX1210 and device such as radio
- g) Antenna
- h) Cables

Upper portion

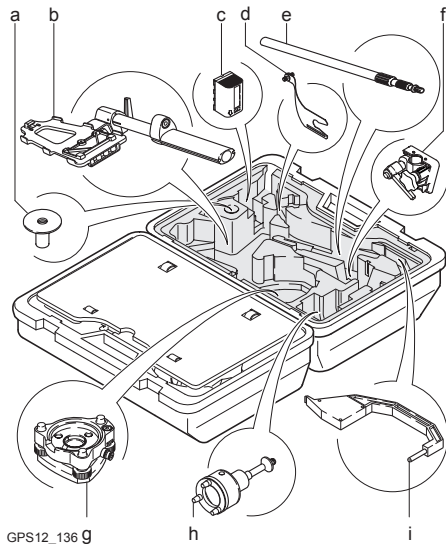

- a) Base for telescopic rod
- b) Holder for GX1200/RX1210 on pole with grip for pole
- c) Spare battery
- d) Arm 15 cm long for antenna of device
- e) Telescopic rod
- f) Screw for holder for RX1210 on pole
- g) Tribrach
- h) Carrier
- i) Height hook

2.3 Receiver Components

Receiver components

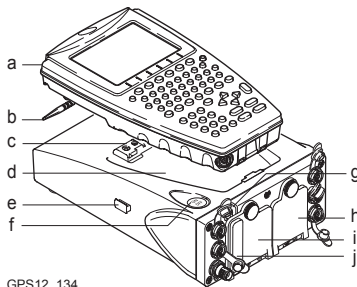

- a) RX1200
- b) Supplied stylus
- c) Clip-on-contacts for connecting RX1200 without cable
- d) Recess for RX1200
- e) Guide rail for clip-on-housing of a device
- f) ON/OFF button
- g) LED indicators
- h) Battery compartment 2 or port NET
- i) Battery compartment 1
- j) CompactFlash card compartment

ON/OFF button

The receiver can be preprogrammed in the office and used in the field without the RX1200 attached. In this case, the receiver is turned on by holding down the ON/OFF button for 2 s or off by holding down the ON/OFF button for 4 s. A green steady light at the power LED indicates that the receiver is turned on.

2.4 System Concept

In this chapter

	Topic	Page
2.4.1	Software Concept	2-10
2.4.2	Data Storage and Data Conversion	2-12
2.4.3	Power	2-14

2.4.1 Software Concept

Description	All receivers use the same software concept. The software is divided into standard and customised application programs.	
Standard software components	System software:	To manage and configure data and functions. Includes the application program Survey to measure.
	Application program software:	To generate data in specific application programs. Some application programs are already uploaded when purchasing the receiver. Some application programs can be uploaded through LGO. Some application programs have to be purchased and then activated through a specific licence key.
Customised application programs	Customised application programs can be developed locally using the GeoC++ development environment. Information on the GeoC++ development environment is available on request from the Leica Geosystems representative.	
Languages	Number of languages:	Three languages can be stored on the receiver at one time - English and two others. English cannot be deleted. One language is selected as active language.

Validity of a language:

- For standard software: If a language is not available for the system software, the English language is used instead. Application programs run in the language they were loaded.
 - Customised application programs do always run in the language they were developed in.
-

Uploading software

Software can be uploaded

- from LGO on a PC through a serial interface to the CompactFlash card in the receiver and from there to the System RAM.
 - from a CompactFlash card to the System RAM.
 - from [Leica GPS Spider](#) using the firmware upload tool through the available communication link, for example a serial, dial-up modem or network connection.
-

2.4.2 Data Storage and Data Conversion

Description

Data is stored within a job in a database on a memory device. This is either a CompactFlash card or an internal memory.

Memory device

CompactFlash card: A CompactFlash card slot is standard. A CompactFlash card can be inserted and removed. Various capacities are available.



Whilst other CompactFlash cards may be used, Leica recommends to only use Leica CompactFlash cards and is not responsible for data loss or any other error that may occur whilst using a non-Leica card.

Internal memory: An internal memory is optional. It resides inside the receiver.

Available capacity: 32 MB



Unplugging connecting cables or removing the CompactFlash card during the measurement may cause loss of data. Always return to **GPS1200 Main Menu** before removing the CompactFlash card and switch off the instrument before removing cables.



For GRX1200/GRX1200 Pro receivers:

While in remote operation mode, stop point occupation and ring buffer logging before removing the CompactFlash card.

Data conversion

Export

Data can be exported from a job in a wide range of ASCII formats. The format is defined in Leica Geo Office. Refer to the online help of LGO for information on creating format files.

Import

Data can be imported from ASCII, GSI8 or GSI16 format.

Transfer raw data to LGO

Raw data can be transferred between the database on the CompactFlash card or the internal memory of the receiver and LGO in two ways:

- From the CompactFlash card or the internal memory directly through a serial interface to a project in LGO on a PC.
 - From the CompactFlash card using for example an OMNI drive as supplied by Leica Geosystems to a project in LGO on a PC.
-



CompactFlash cards can directly be used in an OMNI drive as supplied by Leica Geosystems. Other PC card drives may require an adaptor.

2.4.3 Power

General

Use the Leica Geosystems batteries, chargers and accessories or accessories recommended by Leica Geosystems to ensure the correct functionality of the instrument.

Description

Power for the receiver can be supplied either internally or externally. Up to two external power supplies can be connected using a Y-cable. For the GRX1200/GRX1200 Pro one of the two external power supplies can be configured to be the primary which is always used when available.

Internal power supply:

Two GEB221 batteries fit into the receiver.

External power supply:

GEB171 battery connected via a cable.

OR

Car battery connected via a converter cable supplied by Leica Geosystems.

OR

10.5-28 V DC power supply via a converter cable supplied by Leica Geosystems.

OR

110/240 V AC to 12 V DC power supply unit, supplied by Leica Geosystems.



For permanent operations use **Uninterruptible Power Supply** units as a back-up in case of a main power failure.

3 User Interface

In this chapter

	Topic	Page
3.1	General Operating Principles	3-2
3.2	Icons	3-5

3.1 General Operating Principles

Keyboard and touch screen

The user interface is operated either by the keyboard or by the touch screen with supplied stylus.

The workflow is the same for keyboard and touch screen. The difference is the way information is selected and entered.

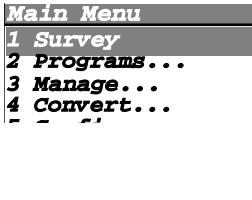

Selecting from a menu

Appearance	Description
	To select an item from a menu, do one of the following: Move the focus to the item. ENTER or CONT (F1) OR Type the complete selection number in front of the item. ENTER or CONT (F1) are not required. OR Tap on the item.

Appearance and selection from a choicelist

Chocelists have various appearances. [Replace screenshots](#)

Closed choicelist



Appearance	Description	Selection
<pre> Logfile : Yes** File Name : COGO.txt** Format File : COGO.frt** </pre>	Triangles on the right indicate further available choices.	Use the arrow keys   to toggle through the list or tap the triangles on the screen.

ENTER or tap on the field to access the choicelist. Opening a choicelist reveals either a simple listbox or a comprehensive listbox dialog.

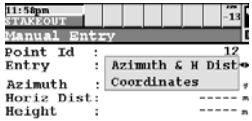
Simple listbox

Appearance	Description	Selection
	<ul style="list-style-type: none"> • Choicelist shows items to select. • A search field is shown if necessary. • A scroll bar is shown if necessary. 	<ul style="list-style-type: none"> • Highlight an item and ENTER. • To exit without changes ESC or tap outside the simple listbox.

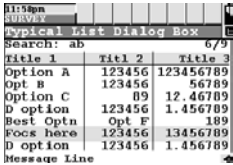
Listbox dialog

Appearance	Description	Selection
	<ul style="list-style-type: none">• Choicelist fills the whole screen.• A search field is shown.• A scroll bar is shown if necessary.• The functionalities comprise adding, editing and deleting of items.• Listbox dialogs are explained in detail at appropriate places in the manuals.	<ul style="list-style-type: none">• Highlight an item and CONT (F1) or ENTER.• To exit without changes press ESC or tap .

3.2 Icons

Description

Icons show the current status information of the receiver.



The icons provide information related to basic receiver functions. The icons that appear depend upon which GPS1200 receiver is used and the current receiver configuration.

Position of the icons on the screen

[Get correct screenshot](#)

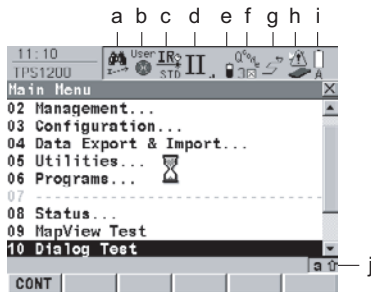

- a) Position status
- b) Number of visible satellites
- c) Contributing satellites
- d) Real-time device and real-time status
- e) Position mode
- f) Quick coding
- g) Line/area
- h) CompactFlash card/internal memory
- i) Battery
- j) **SHIFT**

Icons

Icon	Description
Position status	Displays the status of the current position.
Number of visible satellites	Displays the number of theoretically visible satellites above the configured cut off angle according to the current almanac.
Contributing satellites	<p>Displays the number of satellites on L1 and L2 that are contributing to the currently computed position solution.</p> <p> The number of contributing satellites can differ from the number of visible satellites. This may be either because satellites cannot be viewed or the observations to these satellites are considered to be too noisy to be used in the position solution.</p>
Real-time device and real-time status	Displays the real-time device configured to be used and its status.
Position mode	<p>Displays the current position mode depending on the configuration defined.</p> <p>Symbols are added to the basic position mode icon when raw data logging or logging of auto points is configured. As soon as this icon becomes visible the receiver is in a stage where practical operation can commence.</p>

Icon	Description
Quick coding	The Quick coding is displayed. Visible during Survey and other application programs where it is possible to measure a point with quick codes.
Line/area	The number of lines and areas currently open in the active job is displayed.
CompactFlash card/internal memory	The status of the CompactFlash card and internal memory are displayed. <ul data-bbox="627 462 1362 598" style="list-style-type: none">• For the CompactFlash card, the capacity of used space is shown in seven levels.• For the internal memory, the capacity of used memory is shown in nine levels.

Icon	Description
Battery	<p>The status and source of the battery is displayed. The remaining power in the battery is indicated by six levels.</p> <ul style="list-style-type: none">• If two internal batteries are inserted, the battery with the lower voltage is used.• If an external power supply is connected and one or two internal batteries are inserted, then the external power is used.• If two external power supplies are attached, then the system uses the one which is configured as the preferred power supply.
SHIFT	The status of the SHIFT key is displayed.

4 Operation

In this chapter



	Topic	Page
4.1	Equipment Setup	4-2
4.2	Battery	4-4
4.3	CompactFlash Card	4-7
4.4	Clip-On-Housings for Devices	4-11
4.5	Accessing Survey Application Program	4-19
4.6	Guidelines for Correct Results	4-22
4.7	Operation with a Typical Configuration Set	4-23



4.1 Equipment Setup



Equipment setup step-by-step

The example given is for static operations.

Step	Description
1.	Set up the tripod.
2.	Mount and level the tribrach on the tripod.
3.	Ensure that the tribrach is over the marker.
4.	Place and lock the carrier in the tribrach.
5.	Screw the GPS antenna onto the carrier.
6.	Check that the tribrach is still level.
7.	Insert the batteries into the receiver.
	Alternatively or in addition, to power the receiver externally, connect a GEB171 battery to the port PWR on the receiver.
8.	If no internal memory is fitted, insert a CompactFlash card into the receiver.
	A memory device must be available otherwise a survey cannot be carried out.

Step	Description
	Close the lid carefully after insertion of the CompactFlash card in order to prevent water and dust from getting inside the receiver.
9.	Attach the RX1200 to the receiver, if required, either directly or via a connection cable by plugging it into the port RX on the receiver.
10.	Connect the receiver to the GPS antenna using the antenna cable and port ANT on the receiver.
11.	To hang the receiver on the tripod leg, use the hook on the rear of the unit.
	Alternatively place the receiver in the transport container.
12.	Insert the height hook into the carrier.
13.	Measure the antenna height using the height hook.
14.	Press the ON/OFF button on the receiver for at least 2 s or PROG on the RX1210 to switch the receiver on.
15.	The receiver is now ready for operation.

4.2 Battery

Change battery step-by-step

The batteries are inserted in the front of the receiver.

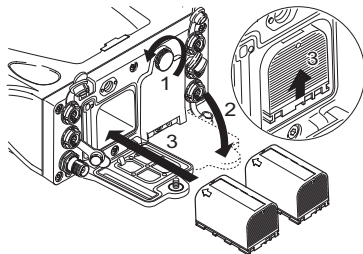

GPS12_085

Step	Description
1.	Loosen the screw of one of the battery compartments.
2.	Open the cover of the battery compartment.
3.	With the Leica logo facing upwards, slide the battery into the battery compartment and push upwards so that it locks into position.

Step	Description
4.	Close the cover of the battery compartment and tighten the screw.
5.	Repeat steps 2. to 4. for the second battery compartment.
6.	To remove a battery, loosen the screw to open the cover of the battery compartment.
7.	Push the battery slightly in and at the same time downwards. This releases the battery from its fixed position.
8.	Pull out the battery.
9.	Close the cover of the battery compartment and tighten the screw.
10.	Repeat steps 6. to 9. for the second battery compartment.



Primary use/charging

- The battery must be charged prior to using it for the first time because it is delivered with an energy content as low as possible.
- For new batteries or batteries that have been stored for a long time (> three months), it is effectual to make only one charge/discharge cycle.

- For Li-Ion batteries, a single discharging and charging cycle is sufficient. We recommend carrying out the process when the battery capacity indicated on the charger or on a Leica Geosystems product deviates significantly from the actual battery capacity available.
- The permissible temperature range for charging is between 0°C to +40°C/ +32°F to +104°F. For optimal charging we recommend charging the batteries at a low ambient temperature of +10°C to +20°C/+50°F to +68°F if possible.
- It is normal for the battery to become warm during charging. Using the chargers recommended by Leica Geosystems, it is not possible to charge the battery if the temperature is too high.

Operation/Discharging

- The batteries can be operated from -20°C to +55°C/-4°F to +131°F.
 - Low operating temperatures reduce the capacity that can be drawn; very high operating temperatures reduce the service life of the battery.
-

4.3 CompactFlash Card



- Keep the card dry.
 - Use it only within the specified temperature range.
 - Do not bend the card.
 - Protect the card from direct impacts.
-



Failure to follow these instructions could result in data loss and/or permanent damage to the card.

Insert and remove a CompactFlash card step-by-step

The CompactFlash card is inserted into a slot inside of battery compartment A on the front of the receiver.

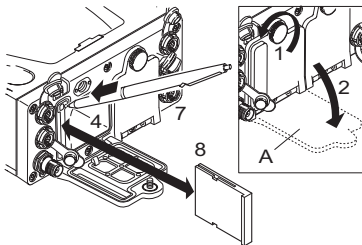

GPS12_086

A Battery compartment A



Step	Description
1.	Loosen the screw of the battery compartment A.
2.	Open the cover of battery compartment A.
3.	The card should be held with the label for the care instructions towards the right-hand side of the receiver.
4.	Slide the card firmly into the slot until it clicks into position.
5.	Close the compartment cover.
6.	To remove the card, open the cover of battery compartment A.
7.	Press the eject button above the card slot.

Step	Description
8.	Pull out the CompactFlash card.
9.	Close the compartment cover.

Format a Compact-Flash card step-by-step

Formatting the CompactFlash card before logging data is started is required if a completely new CompactFlash card is used or if all existing data needs to be deleted.

Step	Description
1.	Select Main Menu: Tools...\Format Memory Device.
2.	TOOLS Format Memory Device <Memory Device: CF Card> <Format Method: Quick> Select the memory device to be formatted.
	By activating the format command all data will be lost. Make sure that all important data on the CompactFlash card has been backed up before formatting the card. Before formatting the internal memory make sure that all important data is first transferred to the PC.

Step	Description
	To exit the screen without formatting the memory device, press ESC . This returns to the previous screen.
3.	CONT (F1)
4.	YES (F4) to continue with the formatting of the selected device.
	NO (F6) to not continue with the formatting of the selected device and to return to TOOLS Format Memory Device .
5.	Once the formatting of the card is completed the system returns to GPS1200 Main Menu .

4.4 Clip-On-Housings for Devices

Devices fitting into a clip-on-housing

Digital cellular phones fitting into a clip-on-housing

Digital cellular phone	Clip-on-housing
Ericsson DM25	GFU18
Siemens MC45	GFU17

Radios fitting into a clip-on-housing

Radio	Clip-on-housing
Pacific Crest PDL, receive	GFU15
Satellite 3AS, transceive	GFU14

Attach a clip-on-housing step-by-step

The clip-on-housing for devices fits on either of the small sides of the receiver.

Step	Description
1.	Place the clip-on-housing into position such that the guide rails for the clip-on-housing on the receiver and the guide rails on the clip-on-housing are aligned.

Step	Description
2.	Ensure that the connector on the clip-on-housing fits to port P1 or port P3 on the receiver front panel.
3.	Slide the clip-on-housing towards the receiver front panel until the connector is completely plugged into port P1 or port P3.
4.	On the top side of the clip-on-housing, turn the screw clockwise, as shown by the symbols on the screw, to lock the clip-on-housing to the receiver.

Detach a clip-on-housing step-by-step

Step	Description
1.	On the top side of the clip-on-housing, turn the screw anticlockwise, as shown by the symbols on the screw, to unlock the clip-on-housing from the receiver.
2.	Slide the clip-on-housing away from the receiver front panel until the connector is completely unplugged from port P1 or port P3.

Insert a SIM card step-by-step

For those digital cellular phones that require SIM cards.

Step	Description
1.	Take the SIM card, a coin and a pen.

Step	Description
2.	Locate the SIM card screw, that covers the SIM card slot, on the bottom of the clip-on-housing.
3.	Insert the coin into the groove of the SIM card screw.
4.	Turn the coin anticlockwise to loosen the SIM card screw.
5.	Remove the SIM card screw from the housing.
6.	Using the pen, press the small button of the SIM card slot to eject the SIM card holder.
7.	Take the SIM card holder out off the housing.
8.	Put the SIM card into the SIM card holder, the chip facing up.
9.	Insert the SIM card holder into the SIM card slot, the chip facing the connectors inside the slot.
10.	Place the SIM card screw back on the housing.
11.	Insert the coin into the groove of the SIM card screw.
12.	Turn the coin clockwise to tighten the SIM card screw.

**Remove a SIM card
step-by-step**

For those digital cellular phones that require SIM cards.

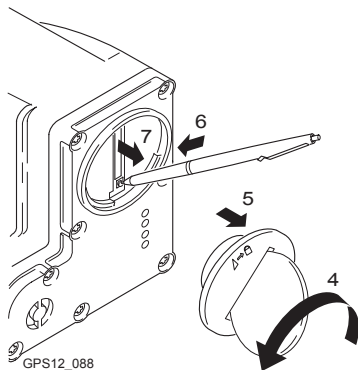

GPS12_088

Step	Description
1.	Take a coin and a pen.
2.	Locate the SIM card screw, that covers the SIM card slot, on the bottom of the clip-on-housing.
3.	Insert the coin into the groove of the SIM card screw.
4.	Turn the coin anticlockwise to loosen the SIM card screw.

Step	Description
5.	Remove the SIM card screw from the housing.
6.	Using the pen, press the small button of the SIM card slot to eject the SIM card holder.
7.	Take the SIM card holder out off the SIM card slot.
8.	Take the SIM card out of the SIM card holder.
9.	Put the SIM card holder back into the SIM card slot, the even side not facing the contacts inside the slot.
10.	Place the SIM card screw back on the housing.
11.	Turn the coin clockwise to tighten the SIM card screw.

LED indicators**Description**

Each clip-on-housing for a radio or a digital cellular phones has four **L**ight **E**mitting **D**iode indicators on the bottom side. They indicate the basic device status.

Diagram

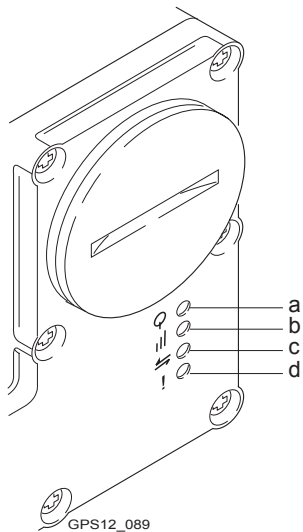

- a) Power LED
- b) Signal strength LED
- c) Data transfer LED
- d) Warning LED, for Satellite 3AS

Description of the LED's

IF the	on	is	THEN
Power LED	any device	off	power is off.
		green	power is okay.
Signal strength LED	GFU18 with Ericsson DM25	red	call is in progress.
		off	no call is in progress or device is off.
	GFU17 with Siemens MC45	red	call is in progress.
		red: long flash, short break	no SIM card inserted, no PIN entered or network search, user authentication or network login in progress.
		red: short flash, long break	logged onto network, no call in progress.
off	device is off.		

IF the	on	is	THEN
	GFU15 with Pacific Crest PDL	red or flashing red	the communication link, Data Carrier Detection , is okay on the roving receiver.
		off	the DCD is not okay.
	GFU14 with Satellite 3AS	red or flashing red	the communication link, Data Carrier Detection , is okay on the roving receiver.
		off	the DCD is not okay.
Data transfer LED	any device	off	data not being transferred.
		green or flashing green	data is being transferred.
Warning LED	GFU14 with Satelite 3AS	red	the device is in the configuration mode controlled from the PC via cable.

Description of fields

Field	Option	Description
<Job:>	Choicelist	The active job. All jobs from Main Menu: Manage...\Jobs can be selected.
<Coord System:>	Output	The coordinate system currently attached to the selected <Job:>.
<Codelist:>	Choicelist	No codes are stored in the selected <Job:>. All codelists from Main Menu: Manage...\Codelists can be selected.
	Output	Codes have already been stored in the selected <Job:>. If codes had been copied from a System RAM codelist, then the name of the codelist is displayed. If codes have not been copied from a System RAM codelist but typed in manually, then the name of the active job is displayed.

Field	Option	Description
<Config Set:>	Choicelist	The active configuration set. All configuration sets from Main Menu: Manage...\Configuration Sets can be selected. The receiver has numerous user configurable parameters and functions. This allows a variety of preferences to be addressed. The configuration of the parameters and functions for an individual measuring technique are combined in a configuration set.
<Antenna:>	Choicelist	The antenna currently defined to be used in the selected configuration set. All antennas from Main Menu: Manage...\Antennas can be selected.

Next step

CONT (F1) accepts the changes and accesses, depending on the selected **<Config Set:>**, **SURVEY Survey: Job Name** or **SURVEY Survey Set Up Reference Station**. Measurements can be performed with **OCUPY (F1)**, **STOP (F1)** and **STORE (F1)**.

4.6 Guidelines for Correct Results

Undisturbed satellite signal reception

Successful GPS surveys require undisturbed satellite signal reception, especially at the receiver which serves as a reference. Set up the receivers in locations which are free of obstructions such as trees, buildings or mountains.

Steady antenna for static surveys

For static surveys, the antenna must be kept perfectly steady throughout the whole occupation of a point. Put the antenna on a tripod or pillar.

Centred and levelled antenna

Centre and level the antenna precisely over the marker.



4.7 Operation with a Typical Configuration Set



Static operations step-by-step

The example given is for static operations.

Step	Description
1.	Set up the equipment.
	Always fill out a field record sheet for each point.
	It is vital that the antenna height is measured correctly. Measure the height at the beginning and at the end of the occupation.
2.	Start the Survey application program.
3.	SURVEY Survey Begin <Job: Default> <Coord System: WGS 1984> <Codelist: <None>> <Config Set:> Select a configuration set for static operations. <Antenna: AX1202>
4.	CONT (F1)

Step	Description
5.	<p>SURVEY Survey: Job Name</p> <p>Type in the point ID and the antenna height.</p>
	<p>The position mode icon is the moving icon. This indicates that the antenna can be moved around and that no static observations are being recorded.</p>
6.	<p>OCUPY (F1) starts logging of static observations.</p>
	<p>The position mode icon changes to the static icon indicating that the receiver should remain stationary. For a static survey, the GPS antenna has to be kept totally still.</p>
7.	<p>If required, check information, for example on the satellites, the memory or the battery.</p>
	<p>SHIFT QUIT (F6) always terminates the survey operation, even during a site occupation. In this case all data collected since pressing OCUPY (F1) is lost.</p>
8.	<p>STOP (F1) when enough data is collected.</p>
9.	<p>STORE (F1) to store the point information.</p>
10.	<p>Check that the tribrach is still level and note it down in the field record sheet.</p>

Step	Description
11.	Measure the antenna height and note it down in the field record sheet.
	If the tribrach is not level or the antenna height has changed, the collected data is not reliable.
12.	SHIFT QUIT (F6) to return to from where SURVEY Survey: Job Name was accessed.
13.	ESC until in GPS1200 Main Menu .
14.	GPS1200 Main Menu PROG plus USER to turn off the receiver.
15.	Take down the equipment and put it back into the transport container.
16.	Are more points to be surveyed? <ul style="list-style-type: none">• If yes, continue with step 17.• If no, continue with step 19.
17.	Move to the next point.
18.	Repeat steps 1. to 16.
19.	Post-process the data in the office.



The antenna must not be moved while data is logged, otherwise the quality of post-processed coordinates is impaired.



The CompactFlash card must be removed in **GPS1200 Main Menu**. If the card is removed when in any other screen all stored data might get corrupted, preventing LGO from successfully reading the data on the card.

5 Reference Station

In this chapter

	Topic	Page
5.1	Overview	5-2
5.2	Equipment Setup	5-5
5.3	Getting Started with the GRX1200/GRX1200 Pro	5-10

5.1 Overview

Description

The GRX1200/GRX1200 Pro

- are designed to operate for specific reference station applications using remote control software, for example Leica [GPS Spider](#) reference station software.
 - support internal logging of raw observations which can be downloaded using an external remote control software package such as Leica [GPS Spider](#).
 - support streaming output of GPS raw observations and status information.
 - can log or stream out data from specific external devices approved by Leica Geosystems, such as meteo and tilt, which can be directly output to an external remote control software package.
 - can be used - with a suitable radio, digital cellular phone or modem attached - to transmit data for real-time operations using proprietary as well as standard RTCM, CMR and CMR+ formats. The GRX1200 and GRX1200 Pro cannot receive reference station broadcasts and therefore cannot be used as a real-time rover receiver.
 - operate in the same manner as the other GPS1200 receivers.
 - have the same receiver and measurement performance as the other GPS1200 receivers. [Refer to "8 Technical Data"](#) for information on technical data.
-

Special features

To operate for specific reference station applications, the GRX1200/GRX1200 Pro are, compared with the other GPS1200 receivers, equipped with some special features.

Specific to GRX1200 and GRX1200 Pro:

- Controllable dual external power supply
- Ring buffer logging
- Support of external devices such as meteo and tilt

Additional features for GRX1200 Pro:

- One Ethernet port including three logical NET ports
- One port to output PPS
- One port to input event messages
- One port for input from an external oscillator

Data storage

All CompactFlash cards recommended by Leica Geosystems are supported. Storing data on a CompactFlash card enables subsequent data download and post-processing. [Refer to "2.4.2 Data Storage and Data Conversion"](#) for information on available memory. [Refer to "4.3 CompactFlash Card"](#) for information on inserting and removing a CompactFlash card.

Data streaming

The receiver can be set to stream the raw observations out of one or more communication ports instead of or in addition to storing data on the CompactFlash card.

Power supply

[Refer to "2.4.3 Power"](#).

Commands for remote control

Special commands from **Outside World Interface** or Leica **Binary 2** format can be used to control the receiver through the configured port. Documentation for OWI and LB2 is available on request from the Leica Geosystems representative.

5.2 Equipment Setup

Equipment setup

An example for an equipment setup for a reference station is shown in the following diagram. It is a basic serial setup with Leica [GPS Spider](#), including a meteo/tilt device and a local radio to broadcast real-time data.

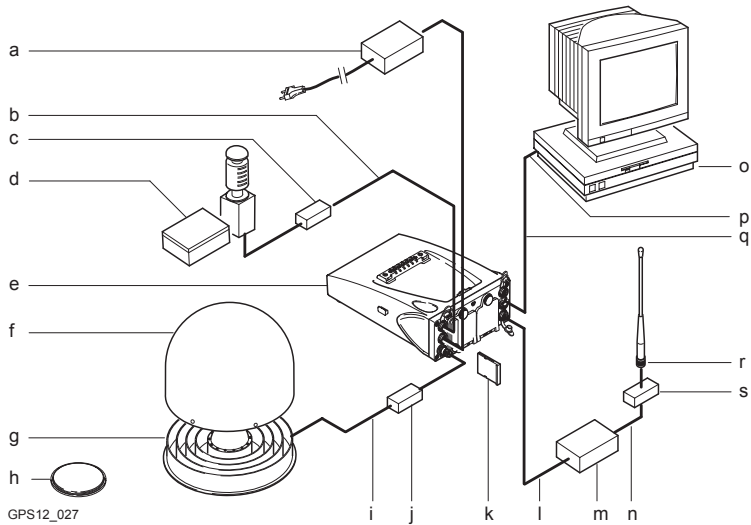

-
- | | |
|---|---|
| a) Power supply unit 100/240 V AC to 12 V DC | k) CompactFlash card |
| b) Interface cable | l) Radio interface cable |
| c) DB9 surge arrester with 12 V DC pass through | m) Radio |
| d) Meteo/tilt device with interface cable | n) Cable to connect radio antenna |
| e) Receiver GRX1200/GRX1200 Pro | o) PC with, for example, Leica GPS Spider |
| f) Weather protection radome for AT504 | p) Serial port |
| g) AT504 | q) Data transfer cable for receiver communication |
| h) AX1202 | r) Radio antenna |
| i) TNC to TNC antenna cable | s) Radio surge arrester |
| j) Surge arrester | |



Normally, the data transfer cable GX RX to RS232 is used to connect the GRX1200/GRX1200 Pro to a PC. Connect the cable to port RX on the receiver and to the COM port on the PC.



Connect the device to transmit real-time data to port P1, P2 or P3 of the receiver. Some devices fit into a clip-on-housing that plugs directly into these ports. Other devices require an interface cable.



Unauthorised radio units should not be connected to the GRX1200/GRX1200 Pro.

Cable connection

Cable connections are identical to other GPS1200 receivers. Additional cables are available from Leica Geosystems for the specific oscillator and Ethernet ports on the GRX1200 Pro.

Switch on

Hold down the ON/OFF button on the receiver for at least 2 s.

OR

Press **PROG** on the RX1200, if used.

OR

Send a pulse/data to one of the serial ports. Port P1, P2 and P3 can be configured not to allow receiver switch on upon pulse reception.

Switch off

Press the ON/OFF button on the receiver for at least 4 s.

OR

Press **PROG** and **USER** simultaneously on the RX1200, if used.

OR

Send a pulse/data to one of the serial ports.

Behaviour when turning off and on

Turning the GRX1200/GRX1200 Pro off and on again resets the receiver. The consequences are:

- If the configuration of the output is stored in the configuration set, standard NMEA messages are still output.
 - All data/message outputs scheduled via OWI or LB 2 commands are no longer output.
 - Data logging parameters and interface configuration options, that have been set by OWI or LB 2 commands and have not been saved to a configuration set using the corresponding OWI or LB 2 command, are reset.
-

Behaviour after power failure

After temporary power failure, the GRX1200/GRX1200 Pro will automatically power itself up and resume the previously set operations. Two power fail recovery options are available - **Sudden Loss Only** and **Always**. To access the configuration select **Main Menu: Config...\General Settings...\Start Up & Power Down**.

5.3 Getting Started with the GRX1200/GRX1200 Pro

Ways of operating

The GRX1200/GRX1200 Pro can either be operated with the RX1200 like the other GPS1200 receivers or by remote control.

Operation	Description
With RX1200	<p>The receiver can be fully configured. In order to start and stop a point occupation, an external application software such as Leica GPS Spider must send appropriate OWI or LB2 commands through a remote interface port to the receiver.</p> <p>Available with full functionality</p> <ul style="list-style-type: none">• Job management• Data management• Configuration of ports• Configuration of operation parameters• Status information• Transfer capabilities including the upload of new firmware

Operation	Description
	<p>Unavailable</p> <p>Any application program available on GPS1200 such as Survey or Stakeout</p> <p> Refer to the relevant chapters in this manual or to the GPS Technical Reference Manual for information on configuring and using the receiver.</p>
By remote control	<ul style="list-style-type: none">• Special commands from OWI or LB2 can be used to control the GRX1200/GRX1200 Pro through a remote interface.• Remote control also supports the download of internally logged data and upload of files to the receiver.• For the majority of applications, the GRX1200/GRX1200 Pro has to be operated using a suitable application software that supports the OWI or LB 2 commands, such as Leica GPS Spider.

Configure a remote interface connection

Remote interface to be configured	Configure using
Standard default RS232	<ul style="list-style-type: none">• Each port is by default a remote port. No specific receiver configurations must be done.• The default settings allow immediate communication using the following port communication parameters: Baud rate: 115200 Data bits: 8 Parity: None Stop bit: 1 Flow control: None
Specific devices such as modems for a particular port	Must be configured using the RX1200. Refer to "Configure a modem interface step-by-step" for an example.
GRX1200 Pro built-in ethernet device for communicating with the receiver	Must be configured using the RX1200. Refer to "Configure a NET port step-by-step" for an example.
Any other interface and operation configuration required	Can be done using Leica GPS Spider .

**Configure a
modem interface
step-by-step**

In order to use a modem for the remote interface connection, the corresponding device has to be created on the receiver and attached to the receiver serial port. As an example, the following step-by-step description shows how to configure a U.S. Robotics 56k modem for port P1 on the receiver. Refer to the GPS Technical Reference Manual for more information. Refer to the manual of the modem for information on the modem configuration.

Step	Description
1.	Main Menu: Config...\Interfaces...
2.	CONFIGURE Interfaces Highlight Remote .
3.	EDIT (F3) to access CONFIGURE Remote Interfaces .
4.	Highlight 1 .
5.	USE (F6) to use port P1 by remote.
6.	DEVCE (F5) to access CONFIGURE Devices .
7.	PAGE (F6) changes to the Modem page.

Step	Description
8.	CONFIGURE Devices, Modem page Highlight Modem .
9.	NEW (F2) to create a new modem.
10.	CONFIGURE New Device Type in a name and the port parameters for the modem.
11.	OPT (F4) to access the ???.
12.	??? <Type: U.S. Robotics 56k>.
13.	CONT (F1) to accept the changes and return to
14.	STORE (F1) to ...
	The receiver is ready to accept an incoming call from a remote application.
15.	Connect the modem to port P1 of the receiver using a modem cable.
16.	Connect the modem cable to the phone line and to a suitable power supply.

Configure a NET port step-by-step

In order to use a NET port for the remote interface connection, the RJ45 connector of the GRX1200 Pro must be connected to a network hub, router or PC Ethernet port which requires a special crossed cable. A static IP address must be available. Talk to the network administrator in order to obtain a static network IP address. The following step-by-step description shows how to create a NET port and assign the remote interface to it. Refer to the GPS Technical Reference Manual for more information.

Step	Description
1.	Main Menu: Config...\Instrument Settings...\NET Port Parameters
2.	CONFIGURE Set NET Parameters Enter the Internet Protocol address and network mask.
3.	CONT (F1) returns to GPS1200 Main Menu .
4.	Main Menu: Config...\Interfaces...
5.	CONFIGURE Interfaces Highlight Remote .
6.	EDIT (F3) to access CONFIGURE Remote Interfaces .

Step	Description
7.	DEVICE (F5) to access CONFIGURE Devices .
8.	PAGE (F6) changes to the Ethernet page.
9.	CTRL (F4) to configure the NET port numbers and access control.
10.	CONFIGURE Set NET Port CONT (F1) to accept settings and return to CONFIGURE Devices .
11.	CONT (F1) to return to CONFIGURE Remote Interfaces .
12.	Highlight NETX .
13.	USE (F6) to use the port NET by remote.
14.	Press CONT (F1) three times to return to ...
15.	STORE (F1) to ...
	The receiver is ready to accept an incoming call from a remote application.
16.	Connect the receiver port NET to a LAN using a suitable network cable.

6 Care and Transport

In this chapter

	Topic	Page
6.1	Transport	6-2
6.2	Storage	6-3
6.3	Cleaning and Drying	6-4

6.1 Transport

Transport in the field

When transporting the equipment in the field, always make sure that you

- either carry the product in its original transport container,
 - or carry the tripod with its legs splayed across your shoulder, keeping the attached product upright.
-

Transport in a road vehicle

Never carry the product loose in a road vehicle, as it can be affected by shock and vibration. Always carry the product in its transport container and secure it.

Shipping

When transporting the product by rail, air or sea, always use the complete original Leica Geosystems packaging, transport container and cardboard box, or its equivalent, to protect against shock and vibration.

Shipping, transport of batteries

When transporting or shipping batteries, the person in charge of the product must ensure that the applicable national and international rules and regulations are observed. Before transportation or shipping, contact your local passenger or freight transport company.

6.2 Storage

Product

Respect the temperature limits when storing the equipment, particularly in summer if the equipment is inside a vehicle. [Refer to "8 Technical Data"](#) for information about temperature limits.

Li-Ion batteries

- [Refer to "8.3 General Technical Data of the Receiver"](#) for information about storage temperature range.
 - A storage temperature range of -20 to +30°C/-4 to 68°F in a dry environment is recommended to minimise self-discharging of the battery.
 - At the recommended storage temperature range, batteries containing a 10% to 50% charge can be stored for up to one year. After this storage period the batteries must be recharged.
 - Remove batteries from the product and the charger before storing.
 - After storage recharge batteries before using.
 - Protect batteries from damp and wetness. Wet or damp batteries must be dried before storing or use.
-

6.3 Cleaning and Drying

Product

Use only a clean, soft, lint-free cloth for cleaning. If necessary, moisten the cloth with water or pure alcohol.

Do not use other liquids; these may attack the polymer components.

Damp products

Dry the product, the transport container, the foam inserts and the accessories at a temperature not greater than 40°C/108°F and clean them. Do not repack until everything is completely dry.

Cables and plugs

Keep plugs clean and dry. Blow away any dirt lodged in the plugs of the connecting cables.

Connectors with dust caps

Wet connectors must be completely dry before attaching the dust cap.

7 Safety Directions

In this chapter

	Topic	Page
7.1	General	7-2
7.2	Intended Use	7-3
7.3	Limits of Use	7-5
7.4	Responsibilities	7-6
7.5	Software Licence Agreement	7-7
7.6	Hazards of Use	7-9
7.7	Electromagnetic Compatibility EMC	7-18
7.8	FCC Statement, Applicable in U.S.	7-21

7.1 General

Description

The following directions should enable the person responsible for the product, and the person who actually uses the equipment, to anticipate and avoid operational hazards.

The person responsible for the product must ensure that all users understand these directions and adhere to them.

7.2 Intended Use

Permitted use

- Measuring and computing coordinates using P-code and/or C/A-code signals from NAVSTAR GPS satellites.
- Carrying out measurement tasks using various GPS measuring techniques.
- Recording GPS and point related data.
- Computation and evaluation by means of software.
- Data transfer via radio or digital cellular phone for real-time kinematic surveys.

Adverse use

- Use of the product without instruction.
- Use outside of the intended limits.
- Disabling safety systems.
- Removal of hazard notices.
- Opening the product using tools, for example screwdriver, unless this is specifically permitted for certain functions.
- Modification or conversion of the product.
- Use after misappropriation.
- Use of products with obviously recognizable damages or defects.
- Use with accessories from other manufacturers without the prior express approval of Leica Geosystems.

- Inadequate safeguards at the surveying site, for example when measuring on roads.
- Controlling of machines, moving objects or similar monitoring application without additional control- and safety installations.

 **Warning**

Adverse use can lead to injury, malfunction and damage.

It is the task of the person responsible for the equipment to inform the user about hazards and how to counteract them. The product is not to be operated until the user has been instructed on how to work with it.

7.3 Limits of Use

Environment

Suitable for use in an atmosphere appropriate for permanent human habitation: not suitable for use in aggressive or explosive environments.



Danger

Local safety authorities and safety experts must be contacted before working in hazardous explosive areas, or in close proximity to electrical installations or similar by the person in charge of the product.

7.4 Responsibilities

Manufacturer of the product

Leica Geosystems AG, CH-9435 Heerbrugg, hereinafter referred to as Leica Geosystems, is responsible for supplying the product, including the user manual and original accessories, in a completely safe condition.

Manufacturers of non Leica Geosystems accessories

The manufacturers of non Leica Geosystems accessories for the product are responsible for developing, implementing and communicating safety concepts for their products, and are also responsible for the effectiveness of those safety concepts in combination with the Leica Geosystems product.

Person in charge of the product

The person in charge of the product has the following duties:

- To understand the safety instructions on the product and the instructions in the user manual.
- To be familiar with local regulations relating to safety and accident prevention.
- To inform Leica Geosystems immediately if the product and the application becomes unsafe.



The person responsible for the product must ensure that it is used in accordance with the instructions. This person is also accountable for the training and the deployment of personnel who use the product and for the safety of the equipment in use.

7.5 Software Licence Agreement

Description

This product contains software that is preinstalled on the product, or that is supplied to you on a data carrier medium, or that can be downloaded by you online pursuant to prior authorization from Leica Geosystems. Such software is protected by copyright and other laws and its use is defined and regulated by the Leica Geosystems Software Licence Agreement, which covers aspects such as, but not limited to, Scope of the Licence, Warranty, Intellectual Property Rights, Limitation of Liability, Exclusion of other Assurances, Governing Law and Place of Jurisdiction. Please make sure, that at any time you fully comply with the terms and conditions of the Leica Geosystems Software Licence Agreement.

Such agreement is provided together with all products and can also be found at the [Leica Geosystems AG](http://www.leica-geosystems.com/swlicense) home page at <http://www.leica-geosystems.com/swlicense> or your Leica Geosystems dealer.

You must not install or use the software unless you have read and accepted the terms and conditions of the Leica Geosystems Software Licence Agreement. Installation or use of the software or any part thereof, is deemed to be an acceptance of all the terms and conditions of such licence agreement. If you do not agree to all or some of the terms of such licence agreement, you may not download, install or use the software and you must return the unused software together with its accompa-

nying documentation and the purchase receipt to the dealer from whom you purchased the product within ten (10) days of purchase to obtain a full refund of the purchase price.

7.6 Hazards of Use

Warning

The absence of instruction, or the inadequate imparting of instruction, can lead to incorrect or adverse use, and can give rise to accidents with far-reaching human, material, financial and environmental consequences.

Precautions:

All users must follow the safety directions given by the manufacturer and the directions of the person responsible for the product.

Caution

Watch out for erroneous measurement results if the product has been dropped or has been misused, modified, stored for long periods or transported.

Precautions:

Periodically carry out test measurements and perform the field adjustments indicated in the user manual, particularly after the product has been subjected to abnormal use and before and after important measurements.



Danger

Because of the risk of electrocution, it is very dangerous to use poles and extensions in the vicinity of electrical installations such as power cables or electrical railways.

Precautions:

Keep at a safe distance from electrical installations. If it is essential to work in this environment, first contact the safety authorities responsible for the electrical installations and follow their instructions.



Warning

By surveying during a thunderstorm you are at risk from lightning.

Precautions:

Do not carry out field surveys during thunderstorms.



Warning

During dynamic applications, for example stakeout procedures there is a danger of accidents occurring if the user does not pay attention to the environmental conditions around, for example obstacles, excavations or traffic.

Precautions:

The person responsible for the product must make all users fully aware of the existing dangers.

 **Warning**

Inadequate securing of the surveying site can lead to dangerous situations, for example in traffic, on building sites, and at industrial installations.

Precautions:

Always ensure that the survey site is adequately secured. Adhere to the regulations governing safety and accident prevention and road traffic.

 **Warning**

If computers intended for use indoors are used in the field there is a danger of electric shock.

Precautions:

Adhere to the instructions given by the computer manufacturer with regard to field use in conjunction with Leica Geosystems products.

 **Caution**

If the accessories used with the product are not properly secured and the product is subjected to mechanical shock, for example blows or falling, the product may be damaged or people may sustain injury.

Precautions:

When setting-up the product, make sure that the accessories, for example tripod, tribrach, connecting cables, are correctly adapted, fitted, secured, and locked in position.

Avoid subjecting the product to mechanical stress.

 **Caution**

The product uses the GPS P-Code signal which by U.S. policy may be switched off without notice.

 **Caution**

During the transport, shipping or disposal of batteries it is possible for inappropriate mechanical influences to constitute a fire hazard.

Precautions:

Before shipping the product or disposing of it, discharge the batteries by running the product until they are flat.





When transporting or shipping batteries, the person in charge of the product must ensure that the applicable national and international rules and regulations are observed. Before transportation or shipping contact your local passenger or freight transport company.

 **Warning**

Using a battery charger not recommended by Leica Geosystems can destroy the batteries. This can cause fire or explosions.

Precautions:

Only use chargers recommended by Leica Geosystems to charge the batteries.

-
-  **Warning** High mechanical stress, high ambient temperatures or immersion into fluids can cause leakage, fire or explosions of the batteries.
- Precautions:**
Protect the batteries from mechanical influences and high ambient temperatures. Do not drop or immerse batteries into fluids.
-
-  **Warning** Short circuited battery terminals can overheat and cause injury or fire, for example by storing or transporting in pockets if battery terminals come in contact with jewellery, keys, metallized paper or other metals.
- Precautions:**
Make sure that the battery terminals do not come into contact with metallic objects.
-
-  **Warning** If an external antenna is not properly fitted to vehicles or any other means of transportation it can be torn off by mechanical shock, vibration or wind, possibly causing accident and injury.
- Precautions:**
Attach the external antenna professionally. The external antenna must be secured additionally, for example by use of a safety cord. Ensure that the mounting device is correctly mounted and able to safely carry the weight of the external antenna (>1kg).
-
-  **Warning** If the product is improperly disposed of, the following can happen:
- If polymer parts are burnt, poisonous gas are produced which may impair health.

- If batteries are damaged or are heated strongly, they can explode and cause poisoning, burning, corrosion or environmental contamination.
- By disposing of the product irresponsibly you may enable unauthorized persons to use it in contravention of the regulations, exposing themselves and third parties to the risk of severe injury and rendering the environment liable to contamination.

Precautions:

Dispose of the product appropriately in accordance with the regulations in force in your country.

Always prevent access to the product by unauthorized personnel.



If the product is used in exposed locations, for example on masts, mountains or buildings, it is at risk from lightning. Danger from high voltages also exists near power lines. Lightning, voltage peaks, or the touching of power lines can cause damage, injury and death.

Precautions:

- Do not use the product in a thunderstorm as you may increase the risk of being struck by lightning.
- Be sure to remain at a safe distance from electrical installations. Do not use the product directly under or in close proximity to power lines. If it is essential to work in such an environment contact the safety authorities responsible for electrical installations and follow their instructions.

- If the product has to be permanently mounted in an exposed location, it is advisable to provide a lightning conductor system. A suggestion on how to design a lightning conductor for the product is given below. Always follow the regulations in force in your country with regard to grounding antennas and masts. These installations must be carried out by an authorised specialist.
- To prevent damages due to indirect lightning strikes (voltage spikes) cables, for example for antenna, power source or modem should be protected with appropriate protection elements, like a lightning arrester. These installations must be carried out by an authorized specialist.
- If there is a risk of a thunderstorm, or if the equipment is to remain unused and unattended for a long period, protect your product additionally by unplugging all systems components and disconnecting all connecting cables and supply cables, for example, receiver - antenna.

Lightning conductors

Suggestion for design of a lightning conductor for a GPS system:

1. On non-metallic structures

Protection by air terminals is recommended. An air terminal is a pointed solid or tubular rod of conducting material with proper mounting and connection to a conductor. The position of four air terminals should be uniformly distributed around the antenna at a distance equal to the height of the air terminal.

The air terminal diameter should be 12 mm for copper or 15 mm for aluminium.

The height of the air terminals should be 25 cm to 50 cm. All air terminals should

be connected to the down conductors. The diameter of the air terminal should be kept to a minimum to reduce GPS signal shading.

2. On metallic structures

Protection is as described for non-metallic structures, but the air terminals can be connected directly to the conducting structure without the need for down conductors.

**Air terminal
arrangement, plan
view**

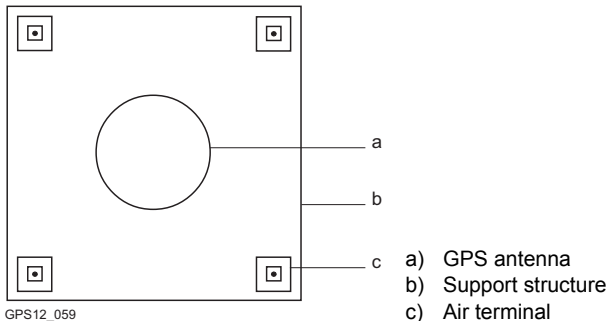

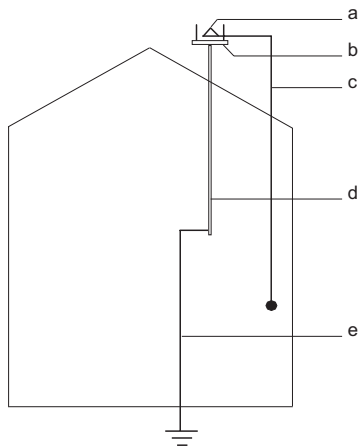
Grounding the receiver/antenna

GPS12_060

- a) Lightning conductor array
- b) GPS antenna
- c) Antenna/receiver connection
- d) Metallic mast
- e) Connection to earth

7.7 Electromagnetic Compatibility EMC

Description

The term Electromagnetic Compatibility is taken to mean the capability of the product to function smoothly in an environment where electromagnetic radiation and electrostatic discharges are present, and without causing electromagnetic disturbances to other equipment.

Warning

Electromagnetic radiation can cause disturbances in other equipment.

Although the product meets the strict regulations and standards which are in force in this respect, Leica Geosystems cannot completely exclude the possibility that other equipment may be disturbed.

Caution

There is a risk that disturbances may be caused in other equipment if the product is used in conjunction with accessories from other manufacturers, for example field computers, personal computers, two-way radio, non-standard cables or external batteries.

Precautions:

Use only the equipment and accessories recommended by Leica Geosystems. When combined with the product, they meet the strict requirements stipulated by the guidelines and standards. When using computers and two-way radio, pay attention to the information about electromagnetic compatibility provided by the manufacturer.

 **Caution**

Disturbances caused by electromagnetic radiation can result in erroneous measurements.

Although the product meets the strict regulations and standards which are in force in this connection, Leica Geosystems cannot completely exclude the possibility that the product may be disturbed by very intense electromagnetic radiation, for example, near radio transmitters, two-way radio or diesel generators.

Precautions:

Check the plausibility of results obtained under these conditions.

 **Warning**

If the product is operated with connecting cables attached at only one of their two ends, for example external supply cables, interface cables, the permitted level of electromagnetic radiation may be exceeded and the correct functioning of other products may be impaired.

Precautions:

While the product is in use, connecting cables, for example product to external battery, product to computer, must be connected at both ends.

Radios or digital cellular phones



Use of product with radio or digital cellular phone devices:

Electromagnetic radiation can cause disturbances in other equipment, in installations, in medical devices, for example pacemakers or hearing aids and in aircraft. It can also affect humans and animals.

Precautions:

Although the product meets in combination with radio or digital cellular phone devices recommended by Leica Geosystems the strict regulations and standards which are in force in this respect, Leica Geosystems cannot completely exclude the possibility that other equipment may be disturbed or that humans or animals may be affected.

- Do not operate the product with radio or digital cellular phone devices in the vicinity of filling stations or chemical installations, or in other areas where an explosion hazard exists.
 - Do not operate the product with radio or digital cellular phone devices near to medical equipment.
 - Do not operate the product with radio or digital cellular phone devices in aircraft.
 - Do not operate the product with radio or digital cellular phone devices for long periods immediately next to your body.
-

7.8 FCC Statement, Applicable in U.S.

Applicability

The grayed paragraph below is only applicable for products of the GPS1200 system without radio or digital cellular phone devices.

Warning

This equipment has been tested and found to comply with the limits for a Class B digital device, pursuant to part 15 of the FCC rules.

These limits are designed to provide reasonable protection against harmful interference in a residential installation.

This equipment generates, uses and can radiate frequency energy and, if not installed and used in accordance with the instructions, may cause harmful interference to radio communications. However, there is no guarantee that interference will not occur in a particular installation.

If this equipment does cause harmful interference to radio or television reception, which can be determined by turning the equipment off and on, the user is encouraged to try to correct the interference by one or more of the following measures:

- Reorient or relocate the receiving antenna.
- Increase the separation between the equipment and the receiver.
- Connect the equipment into an outlet on a circuit different from that to which the receiver is connected.
- Consult the dealer or an experienced radio/TV technician for help.

Warning

Changes or modifications not expressly approved by Leica Geosystems for compliance could void the user's authority to operate the equipment.

Labelling GPS1200

Type: GX... ..
.....
.....
.....
.....

CE

*This device complies with part 15 of the FCC Rules. Operation is subject to the following two conditions:
(1) This device may not cause harmful interference, and (2) this device must accept any interference received, including interference that may cause undesired operation.*

.....
.....
.....

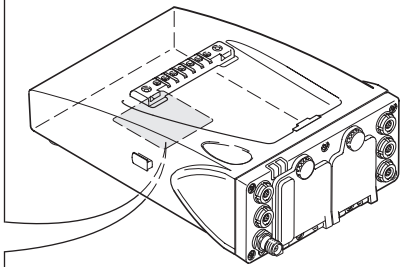

GPS12_101

Labelling RX1200

Type: RX... ..
.....
.....
.....
.....
.....
.....
.....
.....
.....

CE

This device complies with part 15 of the FCC Rules. Operation is subject to the following two conditions: (1) This device may not cause harmful interference, and (2) this device must accept any interference received, including interference that may cause undesired operation.

GPS12_102

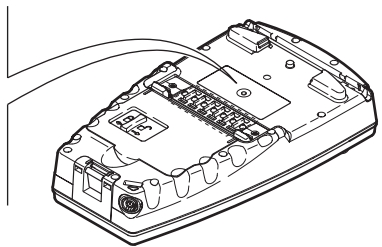

Labelling GFU16

.....
.....
.....
.....
.....
.....
.....

CE

This device complies with part 15 of the FCC Rules. Operation is subject to the following two conditions: (1) This device may not cause harmful interference, and (2) this device must accept any interference received, including interference that may cause undesired

GPS12_105

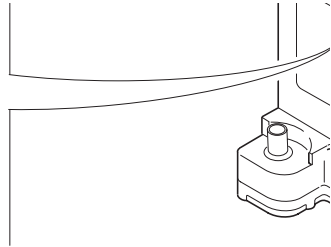

Labelling GFU17

.....
.....
.....
.....



This device complies with part 15 of the FCC Rules. Operation is subject to the following two conditions: (1) This device may not cause harmful interference, and (2) this device must accept any interference received, including interference that may cause undesired

GPS12_103

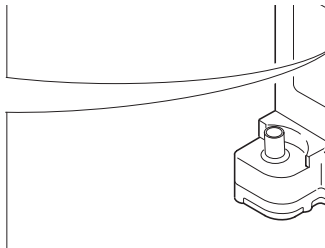

Labelling GFU18

.....
.....
.....
.....



This device complies with part 15 of the FCC Rules. Operation is subject to the following two conditions: (1) This device may not cause harmful interference, and (2) this device must accept any interference received, including interference that may cause undesired

GPS12_104

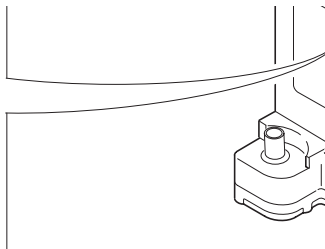

**Labelling internal
battery GEB211,
GEB221**

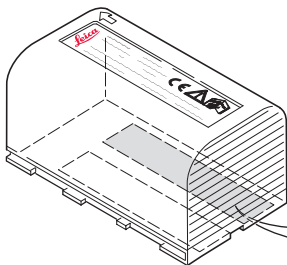

This device complies with part 15 of the FCC Rules. Operation is subject to the following two conditions: (1) This device may not cause harmful interference, and (2) this device must accept any interference received, including interference that may cause undesired operation.

TPS12_082

8 Technical Data

In this chapter

	Topic	Page
8.1	Tracking Characteristics of the Receiver	8-2
8.2	Accuracy	8-5
8.3	General Technical Data of the Receiver	8-7
8.4	Antennas	8-13
8.5	RX1210	8-18
8.6	Bluetooth Device and Digital Cellular Phones	8-20

8.1 Tracking Characteristics of the Receiver

GPS technology

SmartTrack

Satellite reception

GX1230/GX1220/GRX1200/GRX1200 Pro: Dual frequency
GX1210: Single frequency

Receiver channels

GX1230/GX1220/GRX1200/GRX1200 Pro: Twelve channels continuous tracking on L1 and L2
GX1210: Twelve channels continuous tracking on L1

Supported codes

Type	L1	L2
GX1230/GX1220/ GRX1200/ GRX1200 Pro	Carrier phase, C/A code	Carrier phase, P2 code
GX1210	Carrier phase, C/A code	-

Carrier tracking

Condition	GX1230/GX1220/GRX1200/ GRX1200 Pro	GX1210
L1, AS off or on	Reconstructed carrier phase via C/A code	Reconstructed carrier phase via C/A code
L2, AS off	Reconstructed carrier phase via P2 code	-
L2, AS on	Switches automatically to patented P code-aided technique providing full L2 reconstructed carrier phase	-

Code measurements

Condition	GX1230/GX1220/GRX1200/ GRX1200 Pro	GX1210
L1, AS off L1, AS on	Carrier phase smoothed code measurements: C/A code	Carrier phase smoothed C/A code measurements
L2, AS off	Carrier phase smoothed code measurements: P2 code	-

Condition	GX1230/GX1220/GRX1200/ GRX1200 Pro	GX1210
L2, AS on	Carrier phase smoothed code measurements: Patented P code-aided code	-



Carrier phase and code measurements on L1 and L2 are fully independent with AS on or off.

Satellites tracked

GX1230/GX1220/GRX1200/GRX1200 Pro:	Up to twelve simultaneously on L1 and L2
GX1210:	Up to twelve simultaneously on L1

8.2 Accuracy



Accuracy is dependent upon various factors including the number of satellites tracked, constellation geometry, observation time, ephemeris accuracy, ionospheric disturbance, multipath and resolved ambiguities.

The following accuracies, given as **root mean square**, are based on measurements processed using LGO and on real-time measurements.

Differential code

For all receivers, the baseline precision of a differential code solution for static and kinematic surveys is 25 cm.

Differential phase in post-processing

Normal baselines with GX1230/GX1220/GRX1200/GRX1200 Pro with AX1202

Static		Kinematic	
Horizontal	Vertical	Horizontal	Vertical
5 mm + 0.5 ppm	10 mm + 0.5 ppm	10 mm + 1 ppm	20 mm + 1 ppm

Long baselines with GX1230/GX1220/GRX1200/GRX1200 Pro plus AT504

Static	
Horizontal	Vertical
3 mm + 0.5 ppm	6 mm + 1 ppm

Short baselines with GX1210 plus AX1201

Static		Kinematic
Horizontal	Vertical	
10 mm + 1 ppm	20 mm + 2 ppm	20 mm + 2 ppm

Differential phase
in real-time

GX1230/GX1220/GRX1200/GRX1200 Pro plus AX1202

Static		Kinematic	
Horizontal	Vertical	Horizontal	Vertical
5 mm + 0.5 ppm	10 mm + 0.5 ppm	10 mm + 1 ppm	20 mm + 1 ppm

8.3 General Technical Data of the Receiver

Dimensions

The dimensions are given for the housing without the sockets.

Type	Length [m]	Width [m]	Thickness [m]
All receivers	0.212	0.166	0.079

Weight

Receiver weights without battery and radio:

Type	Weight [kg]
GX1230/GX1220/GX1210/GRX1200	1.2
GRX1200 Pro	1.3

Recording

Data can be recorded on the CompactFlash card or in the internal memory, if fitted.

Type	Capacity [MB]	Data capacity
CompactFlash card	<ul style="list-style-type: none">• 32• 256	32 MB is sufficient for about <ul style="list-style-type: none">• 550 h L1 + L2 data logging at 15 s rate• 2200 h L1 + L2 data logging at 60 s rate• 45000 real-time point with codes
Internal memory	32	

Power	Power consumption:	GX1230/GX1220/GX1210, radio and RX1200 excluded: 3.8 W typically, 320 mA
	External supply voltage:	Nominal 12 V DC (???,???, GEV71 car battery cable to a 12 V car battery), voltage range 10.5-28 V DC
Battery internal	Type:	Li-Ion
	Voltage:	7.4 V
	Capacity:	GEB221: 3.8 Ah
Battery external	Type:	NiMH
	Voltage:	12 V
	Capacity:	GEB171: 8.0 Ah
Operating times	<p>The given operating times are valid for</p> <ul style="list-style-type: none"> • all receiver types except GRX1200 Pro. • receiver plus antenna plus RX1200 without keyboard illumination and without screen heating. • two fully charged GEB221 batteries. • room temperature. Operating times will be shorter when working in cold weather. 	

Equipment			Operating time
Type	Radio	Digital cellular phone	
Static	-	-	15 h continuously
Rover	Pacific Crest PDL, receive	-	10 h continuously
Rover	-	Siemens MC45	10 h continuously

Environmental specifications

Temperature

Type	Operating temperature [°C]	Storage temperature [°C]
GX1230/GX1220/ GX1210/GRX1200	-40 to +65	-40 to +80
GRX1200 Pro	0 to +45	0 to +45
Leica CompactFlash cards, all sizes	-40 to +80	-40 to +80
Optional internal memory	-40 to +85	-40 to +80

Type	Operating temperature [°C]	Storage temperature [°C]
Battery internal	-20 to +55	-40 to +70

Protection against water, dust and sand

Type	Protection
All receivers	IP67 (IEC 60529) Dusttight Waterproof to 1 m temporary immersion

Humidity

Type	Protection
All receivers	Up to 100 % The effects of condensation are to be effectively counteracted by periodically drying out the receiver.

PPS output

For [GX1200 PPS](#) with PPS/Event option and GRX1200 Pro

PPS output characteristics:

Peak:	3.3 V = High
Impedance:	50 Ω
Pulse length:	1 ms
Leading edge:	Coinciding with the beginning of each epoch.
Positive/negative edge:	Selectable via RX1200.

Cable connectivity:

Matched with an appropriate impedance of:	50 Ω
Connector type:	Huber & Suhner FFA.0S.CTAC32Z

Event input

For [GX1200 PPS](#) with PPS/Event option and GRX1200 Pro

Pulse type:	TTL, positive or negative going pulse
Pulse length:	125 ns at minimum
Voltage:	TTL level, ~ 5 V, min. 3.3 V
Pin definition:	Center = signal, Case = ground
Connector type:	Huber & Suhner LEMO Typ II FFA.00.250.CTAC327

External oscillator input

For GRX1200 Pro

External clock input:

Frequency:	5 MHz or 10 MHz
Input impedance:	50 Ω nominal
Input VSWR:	2:1 maximum
Signal level:	0 dBm minimum to +13.0 dBm maximum
Frequency stability:	± 0.5 ppm maximum
Wave shape:	Sinusoidal

Connector:	MMCX female
------------	-------------

8.4 Antennas

Description and use

The GPS antenna is selected for use based upon the application. The table gives a description and the intended use of the individual antennas.

Type	Description	Use
AX1201	L1 SmartTrack antenna with built in groundplane.	With GX1210 receiver.
AX1202	L1/L2 SmartTrack antenna with built in groundplane.	With GX1220 or GX1230 receiver.
AT504	Dorne & Margolin L1/L2 antenna element with gold anodized choke ring groundplane. Complies with IGS type 'T' antenna, JPL design. Optional protective radome.	With GX1220, GX1230, GRX1200 or GRX1200 Pro where higher precision is required. For example static surveys of long baselines, tectonic plate monitoring and reference stations.

Dimensions

Type	AX1201	AX1202	AT504
Height	6.2 cm	6.2 cm	14.0 cm
Diameter	17.0 cm	17.0 cm	38.0 cm

Connector

AX1201/AX1202: TNC female
AT504: N female

Mounting

AX1201/AX1202/AT504: 5/8" Whitworth

Weight

AX1201/AX1202: 0.44 kg
AT504 4.3 kg, radome 1.1 kg

Electrical data

Type	AX1201	AX1202	AT504
Voltage	4.75 to 15 V DC	4.75 to 15 V DC	4.75 to 15 V DC
Current	50 mA max	50 mA max	50 mA max
Frequency	GPS L1 1575.46 MHz	GPS L1 1575.46 MHz GPS L2 1227.60 MHz	GPS L1 1575.46 MHz GPS L2 1227.60 MHz
Gain	Typically 27 dBi	Typically 27 dBi	Typically 27 dBi
Noise Figure	Typically < 2 dBi	Typically < 2 dBi	3 dBi max
BW, -3 dBiW	-	-	40 MHz min

Type	AX1201	AX1202	AT504
BW, -30 dBi	-	-	120 MHz max

Environmental specifications

Temperature

Type	Operating temperature [°C]	Storage temperature [°C]
All antennas	-40 to +70	-55 to +85

Protection against water, dust and sand

Type	Protection
AX1201/AX1202	IP66, IP67 (IEC 60529) Dusttight Protected against water jets Waterproof to 1 m temporary immersion
AT504	IP57 (IEC 60529) Dustprotected Waterproof to 1 m temporary immersion

Humidity

Type	Protection
AX1201/AX1202	Up to 100 % The effects of condensation are to be effectively counteracted by periodically drying out the antenna.
AT504	Up to 92 % The effects of condensation are to be effectively counteracted by periodically drying out the antenna.

Cable length

Separation distance from receiver ...	to antenna	Supplied cable lengths [m]	Optional cable lengths [m]
GX1230/GX1220/ GX1210	AX1202/AX1201	1.2 2.8	30 50 70
GRX1200	AX1202	1.2 2.8 10	30 50 70

Separation distance from receiver ...	to antenna	Supplied cable lengths [m]	Optional cable lengths [m]
GRX1200 Pro	AT504/AX1202	-	1.2 2.8 10 30

Longer cables are available on request.

8.5 RX1210

Control unit

Display:	1/4 VGA, monochrome, graphics capable
Keyboard:	62 keys; 12 function keys, illumination
Characters:	Maximum 256, extended ASCII character set as standard
Touch screen	Toughened film on glass

Dimensions

Type	Length [m] / [ft]	Width [m] / [ft]	Thickness [m] / [ft]
RX1210	0.218 /	0.123 /	0.036 /

Weight

Type	Weight [kg] / [lbs]
RX1210	0.480 / 1.058

Environmental specifications

Temperature

Type	Operating temperature [°C]	Storage temperature [°C]
RX1210	-30 to +65	-40 to +80

Protection against water, dust and sand

Type	Protection
RX1210	IP67 (IEC 60529) Dusttight Waterproof to 1 m temporary immersion

Humidity

Type	Protection
RX1210	Up to 100 % The effects of condensation are to be effectively counter-acted by periodically drying out the RX1210.

Ports

- 8 pole LEMO type 1 socket for power and/or communication.
- Special clip-on interface for power and communication to the GPS1200.

8.6 Bluetooth Device and Digital Cellular Phones

In this chapter

	Topic	Page
8.6.1	GFU16 Bluetooth Device	8-21
8.6.2	GFU17 with Siemens MC45	8-22
8.6.3	GFU18 with Ericsson DM25	8-24

8.6.1 GFU16 Bluetooth Device

Conformity to national regulations

- FCC Part 15 (applicable in US)
- European Directive 1999/5/EC on radio equipment and telecommunication terminal equipment (see CE Conformity Declaration)
- The conformity for countries with other national regulations not covered by the FCC part 15 or European directive 1999/5/EC has to be approved prior to use and operation.

Frequency band

2402 - 2480 MHz



Output power

Bluetooth Class 2 type: 2.5 mW

Antenna

Type	Internal patch antenna
Gain	2.7 dBi

8.6.2 GFU17 with Siemens MC45

Conformity to national regulations

- FCC Part 15 and 24 (applicable in US)
- European Directive 1999/5/EC on radio equipment and telecommunication terminal equipment (see CE Conformity Declaration)
- The conformity for countries with other national regulations not covered by the FCC part 15 and 24 or European directive 1999/5/EC has to be approved prior to use and operation.

Frequency band

Tri-Band EGSM900 / GSM1800 / GSM1900 MHz

Output power

EGSM900: 2 W
GSM1800: 1 W
GSM1900: 1 W

Antennas

Type	GAT 3	GAT 5
Frequency band	900 or 1800 MHz	800 or 1900 MHz
Type	Detachable $\lambda/2$ antenna	Detachable $\lambda/2$ antenna
Gain	0 dBi	0 dBi
Connector	TNC	TNC

Specific Absorption Rate (SAR)

The product meets the limits for the maximum permissible exposure of the guidelines and standards which are force in this respect. The product must be used with the recommended antenna. A separation distance of at least 20 centimeters should be kept between the antenna and the body of the user or nearby person within the intended application.

8.6.3 GFU18 with Ericsson DM25

Conformity to national regulations

- FCC Part 15, 22 and 24 (applicable in US)
 - European Directive 1999/5/EC on radio equipment and telecommunication terminal equipment (see CE Conformity Declaration)
 - The conformity for countries with other national regulations not covered by the FCC part 15, 22 and 24 or European directive 1999/5/EC has to be approved prior to use and operation.
-

Frequency band

Dual-Band TDMA800 / TDMA1900 MHz

Output power

TDMA800: 2 W
TDMA1900: 0.4 W

Antenna

Type	GAT 5
Frequency band	800 or 1900 MHz
Type	Detachable $\lambda/2$ antenna
Gain	0 dBi
Connector	TNC

Specific Absorption Rate (SAR)

The product meets the limits for the maximum permissible exposure of the guidelines and standards which are force in this respect. The product must be used with the recommended antenna. A separation distance of at least 20 centimeters should be kept between the antenna and the body of the user or nearby person within the intended application.

Index

- A**
- AC, power supply unit 2-14
 - In Diagram 5-7
 - Accuracy 8-5
 - Antennas 8-13
 - GFU16 Bluetooth device 8-21
 - GFU17 with Siemens MC45 8-22
 - GFU18 with Ericsson DM25 8-24
 - Type 8-13
 - Used with receivers 2-3
 - Application program software 2-4
 - Application programs, customised 2-10
 - Area, icon 3-7
 - Attach, clip-on-housing 4-11
- B**
- Battery
 - Change 4-4
 - External 8-8
 - For internal power supply 2-14
 - Icon 3-8
 - Internal 8-8
 - Baud rate 5-12
- C**
- Capacity, memory 8-7
 - Choicelist 3-2
 - Clip-on-housing
 - Attach 4-11
 - Detach 4-12
 - Commands, remote control 5-4
 - Communication parameters
 - Remote interface 5-12
 - CompactFlash card 4-7
 - Format 4-9
 - Icon 3-7
 - Insert 4-7
 - Memory device 2-12
 - Remove 4-7
 - Safety instructions 4-7

Connector, antennas	8-14	Antennas	8-13
Container		Receivers	8-7
Contents	2-5	RX1210	8-18
Lower portion	2-6	Documentation	1-2
Upper portion	2-7	Drive	
Contents, container	2-5	OMNI	2-13
Conversion of data	2-13	PC card, on office computer	2-13
Customised application programs	2-10	E	
D		Electrical data, antennas	8-14
Data		Environmental specifications	
Exchange between receiver and PC	2-4	Antenna	8-15
Data bits	5-12	Receiver	8-9
Data conversion	2-13	RX1210	8-18
Data storage	2-12	Equipment setup	4-2, 5-5
Reference station	5-3	Ericsson DM25	
Data streaming, reference station	5-4	In GFU18, technical data	8-24
Detach, clip-on-housing	4-12	Event input	8-11
Device		Exchange	
Clip-on-housing	4-11	Data between receiver and PC	2-4
Status	4-15	External power supply	2-14
Dimensions			

F		Indicators, LED	4-15
Fields	1-1	Insert	
Flashing LED on clip-on-housing	4-17	CompactFlash card	4-7
Flow control	5-12	SIM card	4-12
Format CompactFlash card	4-9	Interface	
Frequency band		Remote	5-12
GFU16 Bluetooth device	8-21	User	3-1
GFU17 with Siemens MC45	8-22	Internal memory	2-12
GFU18 with Ericsson DM25	8-24	Icon	3-7
G		Internal power supply	2-14
GAT 3, antenna	8-22	K	
GeoC++	2-10	Keyboard	3-2
GFU16	8-21	L	
GFU17	8-22	LED	
GFU18	8-24	Description	4-17
GPS Spider	2-2, 2-4	Housing	4-15
H		Leica	
Housing for devices	4-11	Geo Office	2-2, 2-3
I		GPS Spider	2-2, 2-4
Icons	3-6	LGO	2-3
		Light Emitting Diode	4-15

Li-Ion battery	8-8	Operation	
Storage	6-3	GRX1200/GRX1200 Pro	5-10
Line, icon	3-7	GX1200, typical configuration set	4-23
M		Options	1-1
Manual		Output power	
GPS1200		GFU16 Bluetooth device	8-21
Application Programs Field	1-3	GFU17 with Siemens MC45	8-22
System Field	1-2	GFU18 with Ericsson DM25	8-24
Technical Reference	1-3	P	
How to use this	1-1	Page	1-1
Memory device, available	2-12	Parameters, remote interface	5-12
Menu, select from	3-2	Parity	5-12
Mount, antennas	8-14	Path	1-1
N		PC card drive on office computer	2-13
NiCd battery	8-8	Position mode, icon	3-6
O		Position status, icon	3-6
OFF button	2-8, 4-3	Power	2-14, 8-8
OMNI drive	2-13	Power supply unit	
ON button	2-8, 4-3	AC, reference station setup	5-7
Operating times	8-8	PPS output	8-10

Q		S	
Quick coding, icon	3-7	Satellites	
		Icon, contributing	3-6
		Icon, visible	3-6
R		Screen	1-1
Raw data transfer to LGO	2-13	Select	
Real-time device, icon	3-6	Menu	3-2
Real-time status, icon	3-6	Setup	4-2
Receiver components	2-8	Reference station	5-5
Receivers	2-2	SHIFT	3-8
Recording	8-7	Icon	3-8
Remote control		Siemens MC45	
Commands	5-4	In GFU17, technical data	8-22
Reference station	5-11	SIM card	
Remote interface	5-12	Insert	4-12
Remove		Remove	4-13
CompactFlash card	4-7	Software	
SIM card	4-13	Application program	2-10
RX1200	2-2	Standard	2-10
Functionality for GRX1200/GRX1200 Pro ..	5-10	System	2-10
With/without touch screen	1-2	Upload	2-11
RX1210	8-18	Specifications, environmental	8-1

Antennas	8-15	Internal memory	
Receiver	8-9	Operating	8-9
RX1210	8-18	Storage	8-9
Spider	2-2, 2-4	Receiver	
Status, device	4-15	Operating	8-9
Stop bit	5-12	Storage	8-9
Survey application program	4-19	RX1210	
System software	2-4	Operating	8-18
		Storage	8-18
T		Temperature range	
Technical data	8-1	Receiver	
Receiver	8-7	Drying	6-4
Temperature		Time, operating	8-8
Antenna		Touch screen	3-2
Operating	8-15	Tracking characteristics	8-2
Storage	8-15	Transfer raw data to LGO	2-13
Battery internal			
Charging	4-6	U	
Operating	8-10	Uninterruptible Power Supply	2-15
Storage	8-10	Upload software	2-11
CompactFlash card		UPS	2-15
Operating	8-9	User interface	3-1
Storage	8-9		

W

Weight

Antennas	8-14
Receiver	8-7
RX1210	8-18

**Leica Geosystems AG,
Heerbrugg, Switzerland, has
been certified as being
equipped with a quality system
which meets the International
Standards of Quality
Management and Quality
Systems (ISO standard 9001)
and Environmental
Management Systems (ISO
standard 14001).**



**Total Quality Management -
Our commitment to total
customer satisfaction.**

Ask your local Leica Geosystems
agent for more information about our
TQM program.

733483-1.0.0en

Printed in Switzerland - Copyright Leica Geosystems AG, Heerbrugg,
Switzerland 2004
Original text

Leica
Geosystems

Leica Geosystems AG
CH-9435 Heerbrugg
(Switzerland)
Phone +41 71 727 31 31
Fax +41 71 727 46 73
www.leica-geosystems.com