

# 450mm

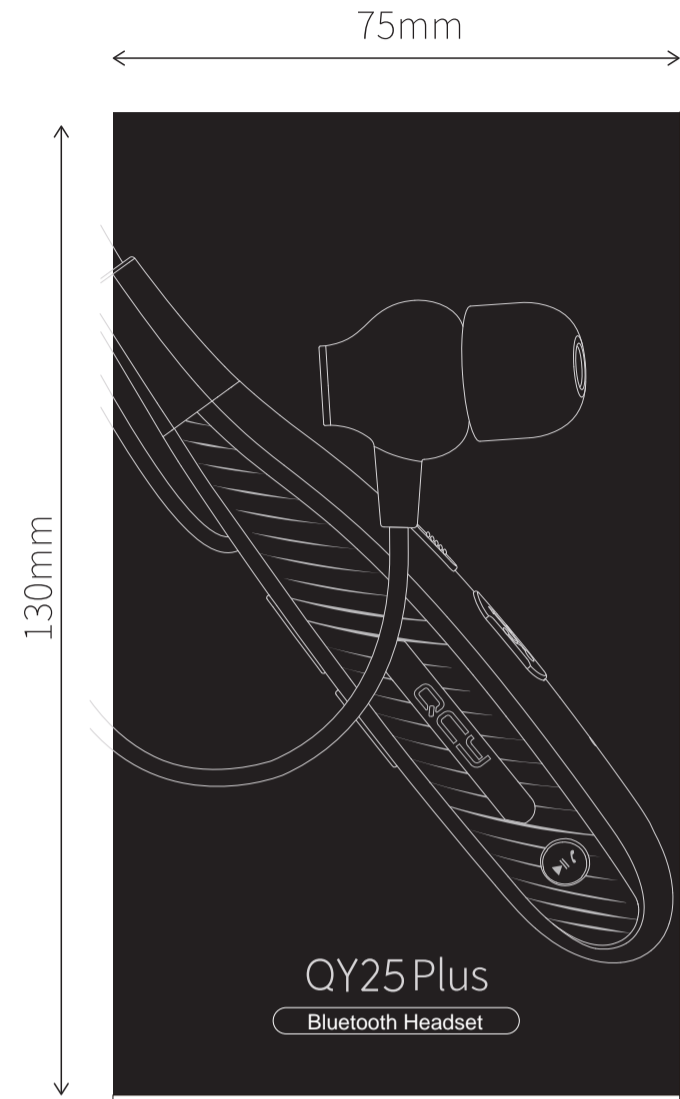

### Overview

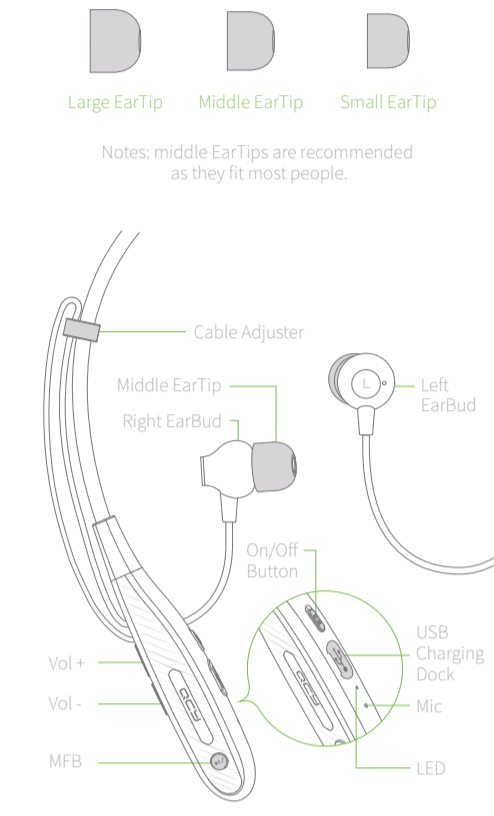

### How to Wear

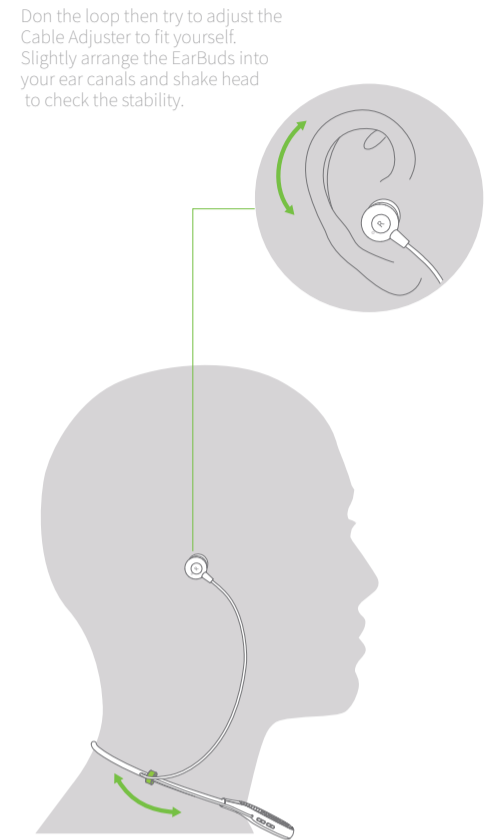

### How to Connect

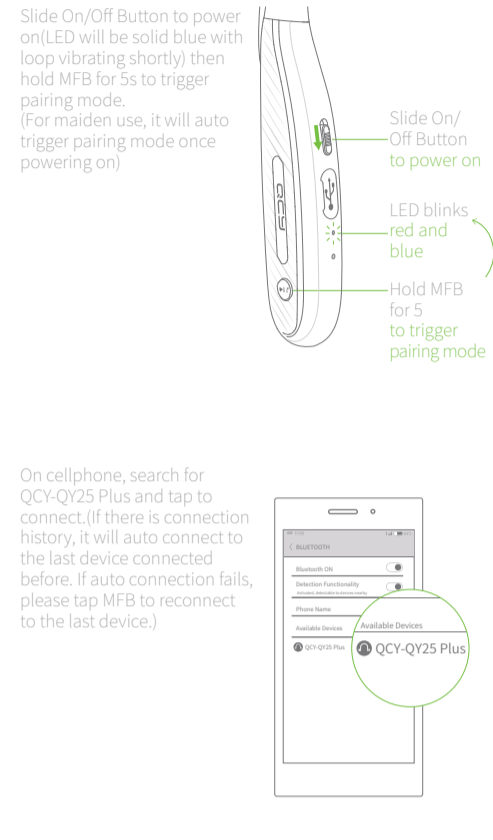

### How to Charge

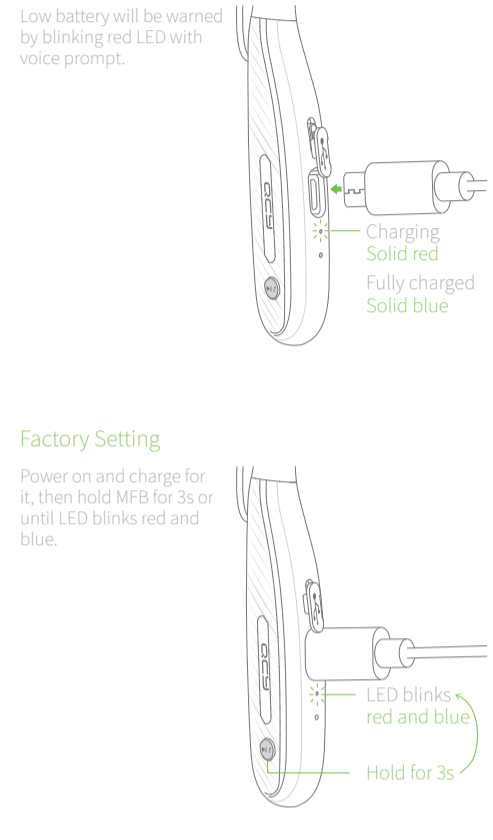

### Functions

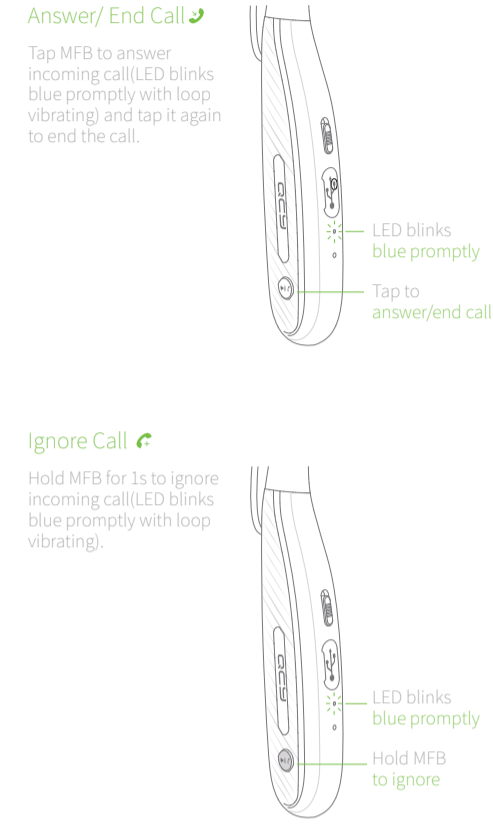

### Operation

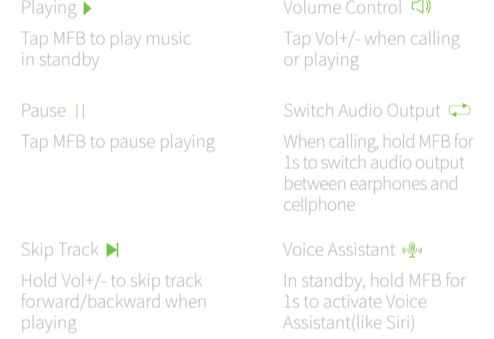

### Multi-Point Connection

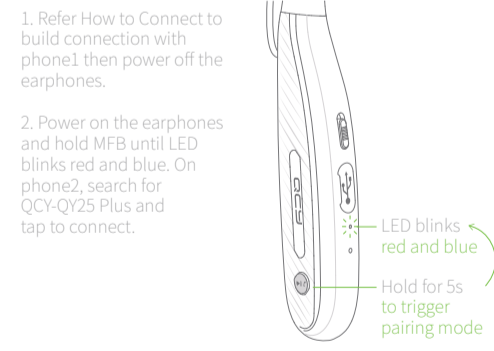

### Three-Way Calling

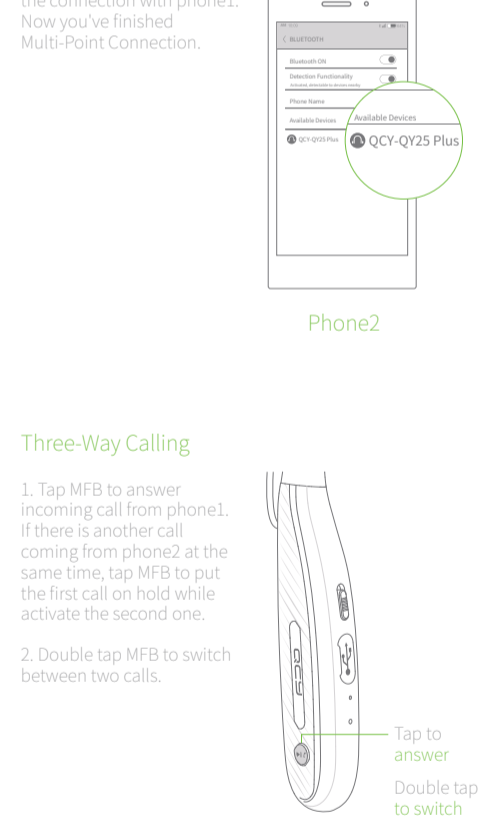

### Features



### Basic Parameter



### Tips

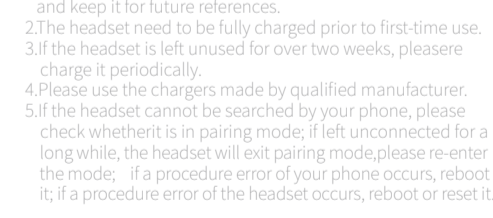

### Q&A:

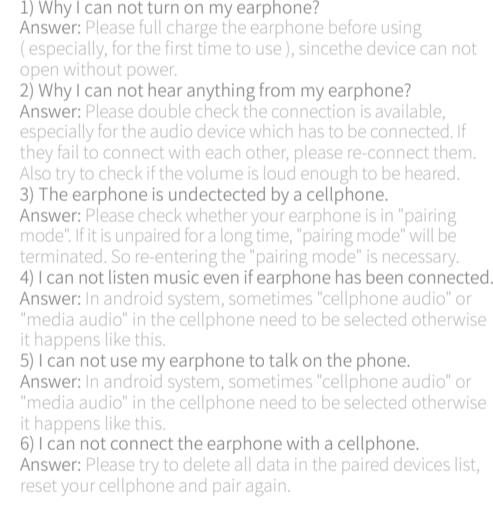

### Caveats

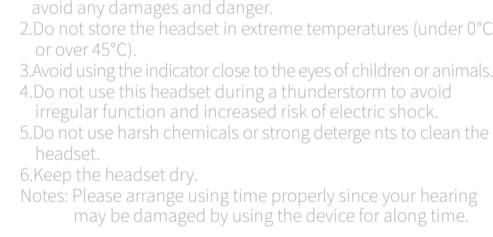

### Hazardous substances and their contents in the item

Part Name	Hazardous Substances					
	(Pb)	(Hg)	(Cd)	(Cr (VI))	(PBB)	(PBDE)
Main body	X	O	O	O	O	O
Battery	O	O	O	O	O	O
Ear tips	O	O	O	O	O	O
Accessories	O	O	O	O	O	O
Charging cable	X	O	O	O	O	O

This form is made by SJ/T 11364 regulation.  
 O: means that hazardous substance content in the homogeneous materials of this part is within the limits of GB/T 26572 regulation.  
 X: means that hazardous substance content in, at least, one certain homogeneous material of this part is beyond the limits of GB/T 26572 regulation.

**Lifespan:**  
 As the booklet states, the eco-lifespan of the item is 5 years while using it in normal ways. During the period, no dangerous material will be leaked. The item must be recycled by the local law.

**For any after service, please contact local distributor**  
 Perform standard: Q/HL 2-2017  
 Manufacturer: Dongguan Hele Electronics Co., Ltd.  
 Address: Dalingya Industrial Zone, Daojiao Town, Dongguan City, Guangdong Province (QCY Environmental Zone, Dalingya No.5, Yuehui Road)



### FCC Statement

This equipment has been tested and found to comply with the limits for a Class B digital device, pursuant to Part 15 of the FCC Rules. These limits are designed to provide reasonable protection against harmful interference in a residential installation. This equipment generates uses and can radiate radio frequency energy and, if not installed and used in accordance with the instructions, may cause harmful interference to radio communications. However, there is no guarantee that interference will not occur in a particular installation. If this equipment does cause harmful interference to radio or television reception, which can be determined by turning the equipment off and on, the user is encouraged to try to correct the interference by one or more of the following measures:  
 - Reorient or relocate the receiving antenna.  
 - Increase the separation between the equipment and receiver.  
 - Connect the equipment into an outlet on a circuit different from that to which the receiver is connected.  
 - Consult the dealer or an experienced radio/TV technician for help.

This device complies with part 15 of the FCC Rules. Operation is subject to the following two conditions:  
 (1) This device may not cause harmful interference, and (2) this device must accept any interference received, including interference that may cause undesired operation.

Changes or modifications not expressly approved by the party responsible for compliance could void the user's authority to operate the equipment.

