

Table with 2 columns: Parameter and Value. Includes model number, Bluetooth version, pairing name, charging time, standby time, music time, talk time, operation range, battery type, capacity, and input parameters.

Table with 5 columns: Use Case, Status, Operation, LED, and Prompt. Lists functions like power on, power off, answer/end call, reject incoming call, voice assistant, music pause/play, and skip track forward.

Table with 5 columns: Use Case, Status, Operation, LED, and Prompt. Lists functions like power on, power off, answer/end call, reject incoming call, voice assistant, music pause/play, and skip track forward.

QCY蓝牙耳机售后服务. 包含三包凭证、产品保修、退换货政策及售后服务联系方式。

FAQ. 常见问题解答，包括配对失败、无法充电、无法开机、无法接听电话、无法播放音乐、无法接听来电、无法使用语音助手、无法暂停/播放音乐、无法切换下一曲。

Table with 2 columns: Part Name and Hazardous Substances. Lists substances like Pb, Hg, Cd, Cr(VI), PBB, PBDE, DBP, DEHP, BPA, and BPS.

提示. 使用前的注意事项，包括仔细阅读说明书、首次使用前的充电、长期存放后的使用、配对模式下的使用、避免高温/低温、避免液体接触、避免长时间使用。

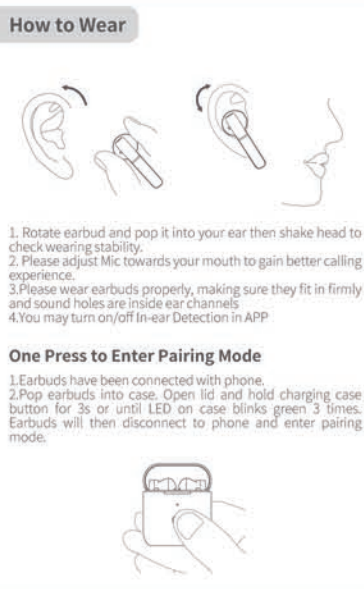
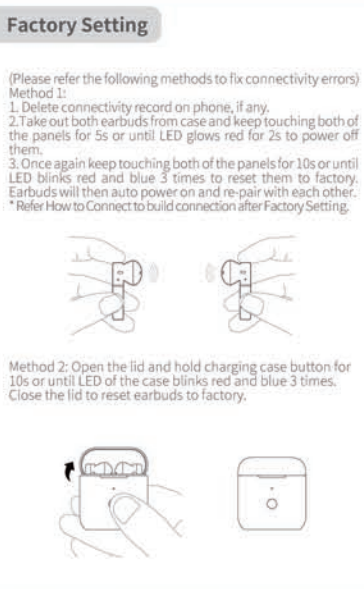
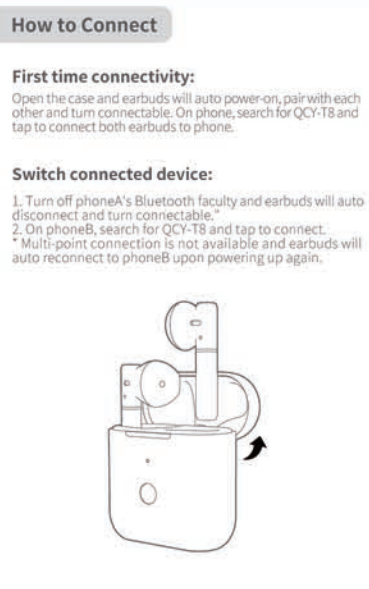
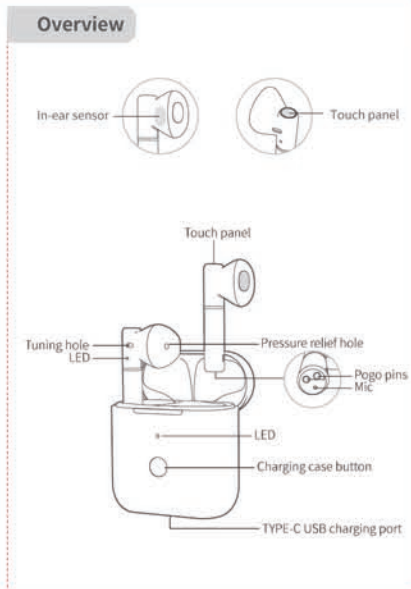
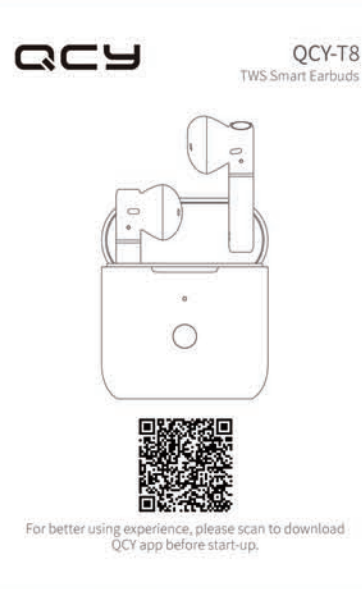

Table with 2 columns: Parameter and Value. Includes model number, Bluetooth version, pairing name, charging time, standby time, music time, talk time, operation range, battery type, capacity, and input parameters.

Table with 5 columns: Functions, Current status, Operation, LED, and Prompt. Lists functions like power on, power off, answer/end call, ignore call, voice assistant, music pause/resume playing, and skip track forward.

Table with 5 columns: Functions, Current status, Operation, LED, and Prompt. Lists functions like power on, power off, answer/end call, ignore call, voice assistant, music pause/resume playing, and skip track forward.

Warranty Card. 包含三包凭证、产品保修、退换货政策及售后服务联系方式。

FCC Statement. 关于设备符合FCC法规的声明，包括辐射测试、电磁兼容性测试、使用限制及免责声明。

Table with 2 columns: Part Name and Hazardous Substances. Lists substances like Pb, Hg, Cd, Cr(VI), PBB, PBDE, DBP, DEHP, BPA, and BPS.

提示. 使用前的注意事项，包括仔细阅读说明书、首次使用前的充电、长期存放后的使用、配对模式下的使用、避免高温/低温、避免液体接触、避免长时间使用。

160.0 mm

