

QCY

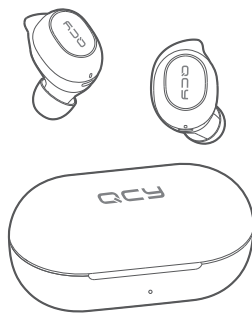

QCY-T9 TWS蓝牙小耳机



Oh My God, 教学视频太好用了吧!

认识耳机

选择并组装耳套

中耳套适合大多数人群佩戴,建议从中耳套开始试戴。

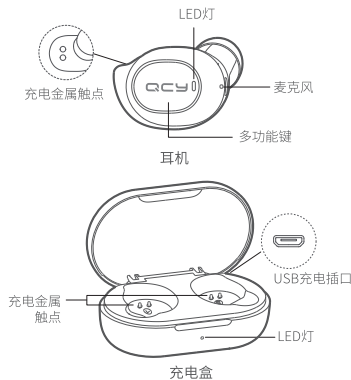

双耳机配对

首次配对方法:

- 1. 取出两只耳机,再将两只耳机放回充电盒中(此步骤为新机激活)
2. 再次取出两只耳机
3. 刷新手机蓝牙设备列表,点击配对QCY-T9,完成配对*耳机取出会自动开机,若未自动开机,请充电后重新尝试

切换设备配对方法:

- 1. 关闭A手机蓝牙,耳机自动断开进入配对模式
2. 刷新B手机蓝牙设备列表,点击配对QCY-T9,完成配对*不支持同时连接两台手机,下次开机默认回连上次配对的手机

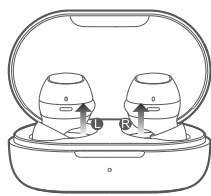

恢复出厂设置

清除配对记录(此方法用于无法正常连接的情况)

- 1. 已有连接过手机,在手机蓝牙设备列表中,找到QCY-T9,点击进入设置,选择忽略或取消配对。
2. 在关机状态下(适用于双耳无法组对使用时)长按多功能键10秒,红绿灯同时闪3次后关机,则表示耳机重置成功。*恢复出厂后用首次配对的方法连接即可正常使用

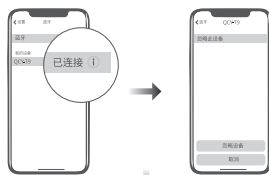

佩戴耳机

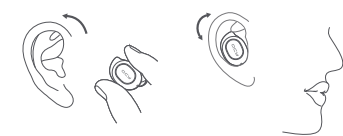

- 1. 将耳帽向下轻轻塞入耳道,以轻柔头部耳机不晃动为宜。
2. 通话时,将耳机麦克风朝向嘴部可使通话更清晰。

三方通话接听与切换通话

当手机来电时,单击多功能键接听电话进行通话;当手机有新来电时,单击多功能键保持上一个通话,进行第二个来电的通话。双击多功能键可以随意切换两个通话。

拒接第二个来电

当手机来电时,单击多功能键接听电话进行通话;当手机有新来电时,长按多功能键拒接新来电,继续保持当前通话。

单耳机使用模式

- 1. 耳机在关机状态下(需有过双耳组队记录),任一耳机长按多功能键约5秒,进入配对状态(红绿灯交替闪烁)
2. 打开手机蓝牙搜索配对名,选择QCY-T9点击连接。
3. 连接完成

给耳机充电

耳机放入充电盒后关盖,即进入充电状态,充电时红灯长亮,充满电后绿灯长亮1分钟后熄灭

给充电盒充电

连接USB充电线充电,充电时指示灯提示如下:
当电量≤60%时:红灯闪烁
当电量在60%-95%时:绿灯闪烁
当电量≥95%时:白灯闪烁
充满电:白灯长亮

产品参数

蓝牙版本: V5.0 待机时间: 约70小时
充电时间: 约2小时 音乐时间: 约4.5小时
通话时间: 约4小时 通信距离: 10米(无障碍环境下)
电池类型: 聚合物锂离子电池
耳机电池容量: 3.7V 43mAh
充电盒电池容量: 3.7V 380mAh
充电盒输入参数: 5V=400mA
支持协议: HSP/HFP/A2DP/AVRCP

功能介绍

更多操作方法请关注二维码

Table with 5 columns: 使用场景, 状态, 操作/现象, LED, 语音提示. Rows include 开机, 关机, 清除配对, 接听电话/结束电话, 拒接来电, 唤醒语音助手, 静音开/静音关, 音乐暂停/播放, 切换上下曲, 转移通话到耳机, 转移通话到手机.

QCY蓝牙耳机售后服务

QCY蓝牙耳机售后服务承诺:严格按照《中华人民共和国消费者权益保护法》、《中华人民共和国产品质量法》实行售后三包服务...

三包凭证: 产品信息: 产品型号, 订单编号, 用户信息: 用户姓名, 联系电话, 联系地址, 销售单位

FAQ

- 1.Q: 怎么只能听一个? A: 将两只耳机放回充电盒,重新取出查看是否恢复双耳模式...
2.Q: 手机提示无法连接怎么解决? A: 将手机上的配对记录删除,删除后重新进行搜索信号连接即可。
3.Q: 怎么听歌/通话没声音? A: 安卓在手机连接记录的右边有个设置图标,点击进入,将两个音频选项取消勾选重新选择,苹果在设置通用辅助功能进入音频通话方式,选择自动...
4.Q: 怎么视频/游戏有延迟? A: 受使用环境、网络、手机编解码速度的影响,会造成手机传送给音频数据到耳机时造成不同程度的延迟。
5.Q: 怎么卡顿/断续? A: 亲,如果使用时有大量的Wi-Fi连接、4G信号、大功率电器等等产生干扰,可能会出现卡顿、断续的情况,换个环境或者重新配对连接下就可以解决了。

若有售后服务需求,请联系客服
电话: 4008-306-708
网址: www.qcy.com
制造商: 东莞市和乐电子有限公司
地址: 广东省东莞市道滘镇大岭丫工业区(粤晖路大岭丫段5号)

产品中有毒物质的名称及含量

Table with columns for components (耳机主体, 电池, 耳套, 配件, 充电线) and hazardous substances (Pb, Hg, Cd, Cr(VI), PBB, PBDE, BDE, DEHP, DBP, BBP).

本表格依据SJ/T 11364的规定编制
O: 表示该有害物质在部件所有均匀材质中的含量均在(EU)2015/863规定的限量要求以下。
X: 表示该有害物质至少在该部件的某一均质材料中的含量超出(EU)2015/863规定的限量要求,但目前行业无成熟的替代方案,在豁免范围仍可合欧盟ROHS指令的环保要求。

使用年限: 如本手册所述,在正常使用条件下,本产品的环保使用期限为10年。在此期间,产品不会泄露任何危险物质,本产品可以回收,必须按照当地法规处理。

提示

- 1. 使用产品前请仔细阅读本使用说明书并请妥善保管;
2. 首次使用时,请先将本产品充满电;
3. 如果产品长期(超过2个星期)不用,请对其充电;
4. 必须选择正规厂家生产且经过国家CCC认证的充电器;
5. 若手机无法搜索蓝牙耳机,请确认蓝牙耳机是否处于“配对模式”,若长时间未进行配对或连接,蓝牙耳机配对功能将关闭,请重新开启蓝牙耳机至“配对模式”;若手机程序出错,请重启手机;若蓝牙耳机程序出错,请重启蓝牙耳机或者恢复出厂设置。

警告

- 请勿以任何理由拆除或维修改装耳机,否则可能会导致起火,电子击穿甚至彻底损坏本产品;
- 请勿将产品置于温度过低或过高(0°C以下或45°C以上)的环境下;
- 请勿在雷暴天气下使用该产品,雷暴可导致本产品工作不正常,并增加触电的危险;
- 请勿用油及其他挥发性液体擦拭本产品;

注意: 长时间使用耳机可能会造成听力损害,请合理安排使用时间。本耳机不支持输出超过2A的充电座给耳机充电,否则会造成耳机本体。

QCY

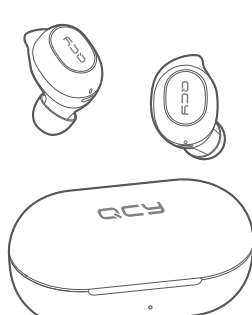

QCY-T9 TWS Bluetooth Earbuds



Instruction Video

Overview

Choose Your Eartips

Please try medium eartips first as they fit most people.

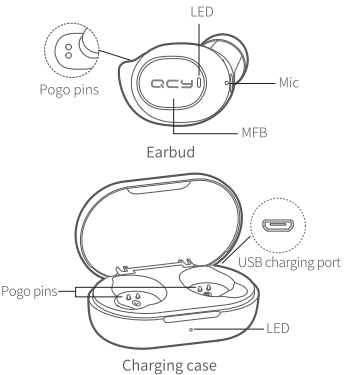

How to Pair

- First Time Pairing:
1. Pick up both earbuds, pop both earbuds into the case to activate them.
2. Pick up both earbuds again.
3. On cellphone, search for QCY-T9 and tap to connect. *Once paired earbuds will auto power on upon picking up from the case. If earbuds fail to auto power on, please charge them and try again.

- Switch Paired Device:
1. Turn off phoneA's Bluetooth faculty and earbuds will auto disconnect and enter into pairing mode.
2. On phoneB, search for QCY-T9 and tap to connect. *Multi-point connection is not available. Earbuds will auto reconnect to phoneB upon powering up again.

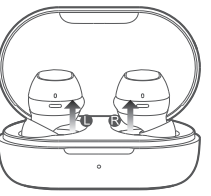

Factory Setting

- Deleting pairing records (please try the following steps if earbuds fail to connect)
1. On cellphone, delete the connectivity records of QCY-T9.
2. Power off earbuds, hold MFBs for 10s or until LEDs blink red and green 3 times to set earbuds to factory.
* After factory setting, please refer How to Pair to build connection with cellphone.

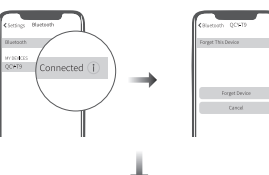

How to Wear

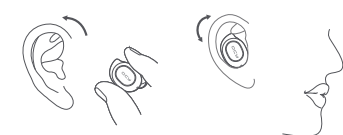

- 1. Rotate earbud and pop it into your ear then shake head to check wearing stability.
2. Please adjust mic towards your mouth to gain better calling experience.

Three-way Calling & Switch

Press MFB to answer incoming call. If another call is coming in sync, press MFB to put the first call on hold while activating the second call or hold MFB to ignore the second call. Double press MFB to switch between held call and active call.

Mono Mode

- 1. Power off earbuds, keep touching either panel for 5s to enter pairing mode (LED blinks red and green).
2. On cellphone, search for QCY-T9 and tap to connect.
3. Connected.

Charging Earbud

Push earbuds into case then close the lid and earbuds will auto be charged. LEDs will glow solid red when charging and turn green for 1 minute once topped up.

Charging the Case

Please charge the case via USB cable.
Battery level ≤ 60%: LED blinks red
Battery level between 60% and 95%: LED blinks green
Battery level ≥ 95%: LED blinks white
Top up: LED turns on solid white

Parameter

Bluetooth version: V5.0 Standby time: approx. 70hr
Charging time: approx. 2hr Music time: approx. 4.5hr
Operation range: 10m(with no obstacle)
Talk time: approx. 4hr
Battery type: li-ion
Battery capacity(earbud): 3.7V 43mAh
Battery capacity(case): 3.7V 380mAh
Input parameter(case): 5V=400mA
Bluetooth profiles: HSP/HFP/A2DP/AVRCP

Function Introduction

Table with 5 columns: Functions, Current status, Operation/result, LED, Prompt. Rows include Power-on, Power-off, Factory setting, Answer/end call, Ignore call, Voice assistant, Mute on/off, Music pause/resume playing, Skip track, Switch call to earbud, Switch call to phone.

Warranty Card

Warranty Period: 12 months after you purchase this item. (or you may inquire your local shopper for more details.)
Free Service: Supposing any defects caused by quality issues occur within the warranty period, please take this warranty card and purchase receipts to your distributor for free exchange service.

Form for warranty card with fields for Model Number, Date of Purchasing, User's Name, User's Phone, User's Address, Shop's Name, Shop's Address, and Comments.

Free exchange service will not be accessed under following circumstances:
1. Damages caused unauthorized disassembly.
2. Defects or physical damages caused by leaking or dropping off.
3. Damages by act of God. Supposing your item is within any damages or defects except the above circumstances, please return to us or your distributor for free repairing.

FCC Statement

This equipment has been tested and found to comply with the limits for a Class B digital device, pursuant to Part 15 of the FCC Rules. These limits are designed to provide reasonable protection against harmful interference in a residential installation.
This equipment generates uses and can radiate radio frequency energy and, if not installed and used in accordance with the instructions, may cause harmful interference to radio communications. However, there is no guarantee that interference will not occur in a particular installation. If this equipment does cause harmful interference to radio or television reception, which can be determined by turning the equipment off and on, the user is encouraged to try to correct the interference by one or more of the following measures:
-- Reorient or relocate the receiving antenna.
-- Increase the separation between the equipment and receiver.
-- Connect the equipment into an outlet on a circuit different from that to which the receiver is connected.
-- Consult the dealer or an experienced radio/TV technician for help.

This device complies with part 15 of the FCC Rules. Operation is subject to the following two conditions:
(1) This device may not cause harmful interference, and (2) this device must accept any interference received, including interference that may cause undesired operation.

Changes or modifications not expressly approved by the party responsible for compliance could void the user's authority to operate the equipment.
FCC ID: RDR-IN1950

Hazardous substances and their contents in the item

Table with columns for Part Name and hazardous substances (Pb, Hg, Cd, Cr(VI), PBB, PBDE, BDE, DEHP, DBP, BBP).

This form is made by SJ/T 11364 regulation.
O: means that hazardous substance content in the homogeneous materials of this part is within the limits of (EU) 2015/863 regulation.
X: means that hazardous substance content in, at least, one certain homogeneous material of this part is beyond the limits of (EU) 2015/863 regulation, but there is no mature alternative in the industry at present, it still conforms to the EU ROHS Directive in the scope of exemption.

Notes: Please arrange using time properly as your hearing may be damaged by using the device for a long time.
Manufacturer: Dongguan Hele Electronics Co., Ltd.
Address: Daojiao Town, Dongguan City, Guangdong, China

Tips

- 1. Before using the headset, please read the manual carefully and keep it for future references.
2. The headset need to be fully charged prior to first-time use.
3. If the headset is left unused for over two weeks, please recharge it periodically.
4. Please use the chargers made by qualified manufacturer.
5. If the headset cannot be found by your phone, please check whether it is in pairing mode; if left unconnected for a long while, the headset will exit pairing mode, please re-enter the mode; if a procedure error of your phone occurs, reboot it; if a procedure error of the headset occurs, reboot or reset it.

Caveats

- 1. Never disassemble or modify your headset for any reasons to avoid any damages and danger.
2. Do not store the headset in extreme temperatures (under 0°C or over 45°C).
3. Avoid using the indicator close to the eyes of children or animals.
4. Do not use this headset during a thunderstorm to avoid irregular function and increased risk of electric shock.
5. Do not use harsh chemicals or strong detergents to clean the headset.
6. Keep the headset dry.

