

RN6 Portable Navigation Device



Prepared by RoyalTek Company LTD.

4F., No.188, Wen Hwa 2nd Rd., Kuei Shan,

Tao Yuan 333, Taiwan

TEL: 886-3-3960001

FAX: 886-3-3960065

Email: <http://www.royaltek.com/contact>

Web: [Http://www.royaltek.com](http://www.royaltek.com)

Legal Notices

COPYRIGHT

RoyalTek RN6 Portable Navigation Device User's Guide Original issue: July 2009.

RoyalTek and the RoyalTek logo are registered trademarks of RoyalTek Inc. Other products or system names appearing in this document are trademarks or registered trademarks of their respective owners. Further, the © or TM symbols are not used in the text.

Changes may be made periodically to the information in this publication without obligation to notify any person of such revision or changes. Such changes will be incorporated in new editions of this User's Guide or supplementary documents and publications.

No part of this publication may be reproduced, stored in a retrieval system, or transmitted, in any form or by any means, electronic, mechanical, photocopy, recording, or otherwise, without the prior written permission of RoyalTek Inc.

DISCLAIMER AND LIMITATION OF LIABILITY

RoyalTek and its subsidiaries make no representations or warranties, either expressed or implied, with respect to the contents hereof and specifically disclaims the implied warranties of merchantability or fitness for a particular purpose. RoyalTek and its subsidiaries assume no responsibility for any damage or loss resulting from the use of this RoyalTek RN6 Portable Navigation Device.

NOTE : Record the device ID, serial number, purchase date, and place of purchase information in the space provided below. The serial number is indicated on the label affixed to your RoyalTek device. All correspondence concerning your unit should include the serial number, device ID, and purchase information.

Revision: 1.00

June, 2009

NOTE: Information in this manual is subject to change without notice.

WARNINGS and NOTICES

For your safety, do not operate the controls of the product while driving.

GPS satellite signals cannot typically pass through solid materials (except glass). GPS location information is not typically available inside buildings, tunnels, or underground parking lots.

A minimum of 4 GPS satellite signals is needed to calculate your GPS position. Signal reception can be affected by weather events or overhead obstacles (e.g. dense foliage and tall buildings).

Other wireless devices in the vehicle may interfere with the reception of satellite signals and cause the reception to be unstable.

ADAPTOR

Do not attempt to service the unit. There are no serviceable parts inside. Replace the unit if it is damaged or exposed to excess moisture.

Do not use the adapter if the cord becomes damaged.

Connect the adapter to the proper power source. The voltage requirements are found on the product case and/or packaging.

BATTERY

This unit contains a non-replaceable internal Li-polymer battery. The battery could be bursting or exploding and releasing hazardous chemicals in case of over battery specification and using in an abnormal conditions; disassemble, crush, puncture, or dispose of the battery in fire or water. Abnormal operation could be dangerous to your human body. Please be aware.

Use only the specified charger approved by the manufacturer.

Risk of explosion if battery is replaced by an incorrect type dispose of used batteries according to the instructions.

WARNING: The Lithium-Ion battery in the device must be recycled or disposed of properly.

FCC WARNING

Federal Communications Commission (FCC) Statement

15.21

You are cautioned that changes or modifications not expressly approved by the part responsible for compliance could void the user's authority to operate the equipment.

15.105(b)

This equipment has been tested and found to comply with the limits for a Class B digital device, pursuant to part 15 of the FCC rules. These limits are designed to provide reasonable protection against harmful interference in a residential installation. This equipment generates, uses and can radiate radio frequency energy and, if not installed and used in accordance with the instructions, may cause harmful interference to radio communications. However, there is no guarantee that interference will not occur in a particular installation. If this equipment does cause harmful interference to radio or television reception, which can be determined by turning the equipment off and on, the user is encouraged to try to correct the interference by one or more of the following measures:

- Reorient or relocate the receiving antenna.
- Increase the separation between the equipment and receiver.
 - Connect the equipment into an outlet on a circuit different from that to which the receiver is connected.
- Consult the dealer or an experienced radio/TV technician for help.

This device complies with Part 15 of the FCC Rules. Operation is subject to the following two conditions:

- 1) this device may not cause **harmful** interference and
- 2) this device must accept any interference **received**, including interference that may cause undesired operation of the device.

FCC RF Radiation Exposure Statement:

This equipment complies with FCC radiation exposure limits set forth for an uncontrolled environment. End users must follow the specific operating instructions

for satisfying RF exposure compliance. This transmitter must not be co-located or operating in conjunction with any other antenna or transmitter.

THIS DEVICE COMPLIES WITH PART 15 OF THE FCC RULES. OPERATION IS SUBJECT TO THE FOLLOWING TWO CONDITIONS: (1) THIS DEVICE MAY NOT CAUSE HARMFUL INTERFERENCE, AND (2) THIS DEVICE MUST ACCEPT ANY INTERFERENCE RECEIVED, INCLUDING INTERFERENCE THAT MAY CAUSE UNDESIRE OPERATION.

CE MARK

This equipment complies with the requirements for CE marking when used in a residential, commercial, vehicular or light industrial environment. R&TTE Directive. Products with the CE marking comply with Radio & Telecommunication Terminal Equipment Directive (R&TTE) (1999/5/EEC), the Electromagnetic Compatibility Directive (89/336/EEC) and the Low Voltage Directive (73/23/EEC) – as amended by Directive 93/68/ECC - issued by the Commission of the European Community.

Index

Chapter 1	Features and Specifications	8
1.1.	RoyalTek RN6 PND Features	8
1.2.	RN6 Specifications	8
Chapter 2	Getting Started	10
2.1.	Packing Items	10
2.2.	Features	12
2.2.1	Front and Rear Views	12
2.2.2	Left and Right Views	12
2.2.3	Top and Bottom Views	13
2.3.	How to Use Car Holder	14
2.4.	How to Use Mounting Bracket	14
2.5.	How to Charge RN6	16
2.6.	How to Start RN6	16
2.7.	How to Turn off RN6	16
2.8.	How to Reset RN6	17
Chapter 3	Start to Use RN6	18
3.1.	Operating Basics	18
3.2.	Turn on the device	18
3.3.	Configure system settings	18
3.4.	How to Use System Settings	20
3.5.	Reset	21
3.6.	System Information	23
3.7.	Volume	24
3.8.	Backlight	24
3.9.	Set Favorite Application Category	25
3.9.1	Add Icons to Favorite Page	25
3.9.2	Delete Icon to Favorite Page	26
3.10.	Power Supply	26
3.10.1	Charging	26
3.10.2	Discharge	27
3.10.3	Power Outage	27
Chapter 4	Entertainment	28
4.1.	RN6 Multimedia Applications	28
4.2.	Music player	28
4.3.	Photo Viewer	31

4.3.1	Use Photo Album	32
4.3.2	View Photos in Slide Show Mode	33
4.4.	Video Player (Optional)	34
4.4.1	Use Video Player	34
4.5.	FM Transmitter (Optional)	37
4.5.1	Turn on FM Transmitter Frequency	37
4.5.2	Set FM Transmitter Frequency	38
Chapter 5	Communications	39
5.1.	Connection	39
5.2.	Mobile Phone Connection	39
5.3.	Calling Out	42
5.4.	Receiving a Call	43
5.5.	Phone Book (Import Phonebooks)	45
Chapter 6	Troubleshooting and Maintenance	46
6.1.	General Troubleshooting.....	46
6.1.1	If your device does not respond, do a “hard reset”	46
6.1.2	Users can also perform a “system reset”	46
6.1.3	Screen responds slowly	46
6.1.4	Inaccurate responses to tap on touch screen	46
6.1.5	Connection Problems with PC	46
6.1.6	No GPS connection.....	46
6.1.7	No sound coming from the device	47
6.1.8	Cannot see photos	47
6.1.9	Take longer than normal time to get a GPS fix.	47
6.1.10	Factory reset does mean a GPS reset.	47
6.2.	Maintenance	47
6.2.1	Storage precautions	48
6.2.2	Accessories and repair precautions.....	48

Chapter 1 Features and Specifications

1.1. RoyalTek RN6 PND Features

RoyalTek RN6 Portable Navigation Device is a powerful multifunction GPS/multimedia navigation and entertainment device.

- Compact size and lightweight
- Integrated GPS receiver for GPS navigation
- High-resolution color LCD
- 5.0" wide touch screen with 480 x 272 bits
- Multimedia functionality with high performance processor

1.2. RN6 Specifications

Table 1: RN6 dimensions and specifications

Category	Item
Chassis	
Dimension	128.9*85.2*12.6 mm
Weight	185g
Specifications	Operating Temperature: 0 to +55 Storage Temperature : -20 to + 70 Battery charge Temperature: 0 to +35
System	
OS	Windows CE 5.0 Core Version
Storage	1GB/2GB iNAND Flash
Memory	64MB/128MB Mobile DDR SDRAM
Display	
Screen Type	TFT, Touch Panel
Screen Size	5.0"
Resolution	WQVGA 480* 272
Backlight	Yes, brightness with TSP
Touch Panel	Yes (Finger Tapped)

Category	Item
Battery	
General	1,250mAh, Li-Polymer Battery
Recharge Time	<p>Wake-up Mode (Default setting after factory reset)</p> <ul style="list-style-type: none"> ▪ From empty to full by AC adapter: 6 hrs <p>Power Suspend Mode</p> <ul style="list-style-type: none"> ▪ From empty to full by AC adapter: 4 hrs
Audio	
Earphone	Yes (option)
Speaker	1.5W mono speaker
Microphone	Option for Bluetooth SKU
Hardware Button\Slot	
Micro SD	Supports Micro SD
Power Button	Yes
Reset Button	Yes
Mini USB Device Slot	USB 2.0 device with supporting mass storage (High Speed)

Chapter 2 Getting Started

This chapter describes the hardware interface of the RoyalTek RN6 and its peripherals. Instructions for setting up the device and some basic system operations are also discussed.

NOTE: Although RN6 battery comes approximately 25% capacity, it is advised to fully charge the battery before using.

2.1. Packing Items

RoyalTek RN6 box contains all of the items listed below :

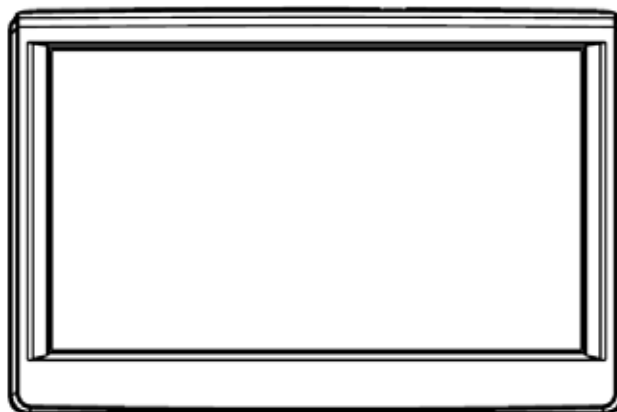

Portable Navigation Device

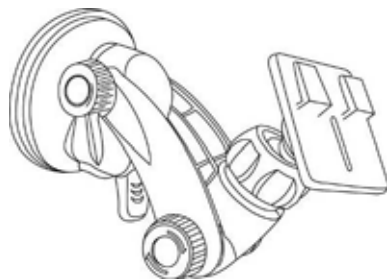

Car mount



Car holder



Car charger

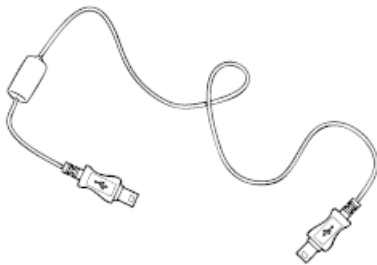

USB cable (Optional Accessory)



Earphone (Optional Accessory)

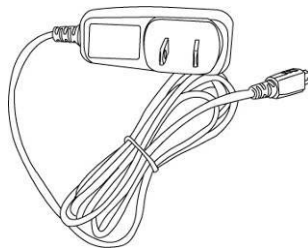

AC adaptor (Optional Accessory)

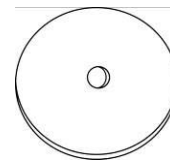

Dashboard (Optional Accessory)

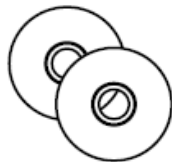

Application Software CD



Quick Start Guide & Warranty statement

2.2. Features

2.2.1 Front and Rear Views

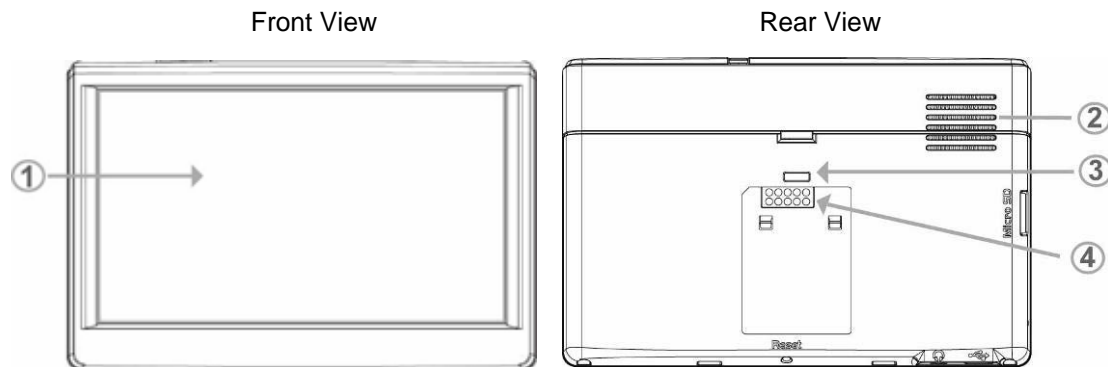

NO	Function	Description
1	Touch Screen	Displays the applications, data, and map images.
2	Speaker	Emits system sounds.
3	Hook Point	Fixed point for car holder
4	Car Kit Connector (Option)	Connector for power car holder

2.2.2 Left and Right Views



NO	Function	Description
1	Micro SD Slot	To upload files from Micro SD storage cards.
2	Microphone (Optional)	Receives your voice while using hands-free of Bluetooth function.

2.2.3 Top and Bottom Views

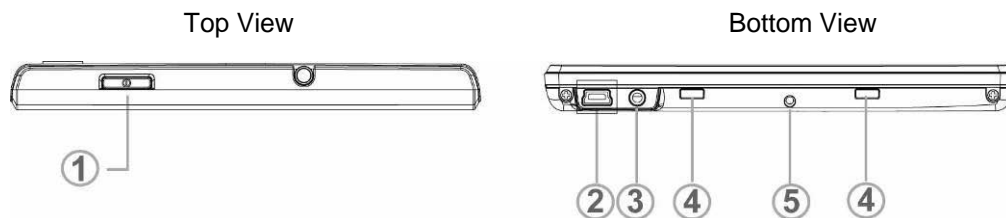

NO	Function	Description
1	Power Button	<ul style="list-style-type: none"> ▪ Click button to witch suspend/wake-up mode ▪ Short press (2 seconds) for turn on ▪ Long press (5 seconds) for turn off when PND is with battery only
2	USB Port /Docking connector	Mini-USB connector serves as the power connector for charging the device or as the dock for uploading files from computers. It can not be charged by USB device cable.
3	Earphone	Standard stereo headphone jack
4	Hook Point	Fixed point for car holder
5	Reset Button	<ul style="list-style-type: none"> ▪ To reset system when PND is with external power supply ▪ To turn system off when PND is with battery only

2.3. How to Use Car Holder

Car holder side views

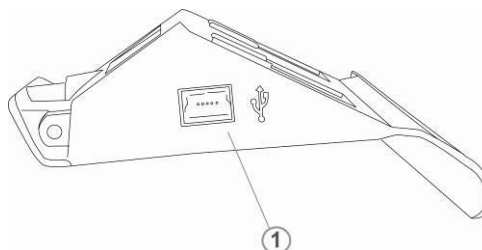

NO	Function	Description
1	USB Port/Docking connector (Optional)	The mini-USB connector of car cradle can be used to charge power only. It can not be charged by USB device cable.

2.4. How to Use Mounting Bracket

RN6 comes with a car mount kit and a car charger to help install your device in your vehicle. The car mount kit uses a suction cup on the windshield to offer flexible mounting options for RN6.

WARNING: Some countries prohibit the mounting of any electronic device on the vehicle dashboard. Be sure to check your local laws for acceptable mounting areas before installing the car mount bracket.

This section shows how to install the car mount kit in your vehicle's windshield using the suction cup. RN6 uses a snap on mounting cradle to use when the device attaches to the car mount. Below is the backside view of RN6 in the cradle.

1. Clean the mounting surface with a glass cleaner and a clean cotton cloth.
2. If the ambient temperature is below +15°C (60°F), you can warm the mounting area and the suction cup (e.g. with a hair dryer) to ensure a strong suction bond.
3. Install the car mount on the selected area.

- a. Press the suction cup of the car mount firmly against to the windshield. (See Figure 2-4-1)
- b. Press down the lever to fix the suction cup in place.
- c. Adjust the angles of the arm to your proper viewing position.

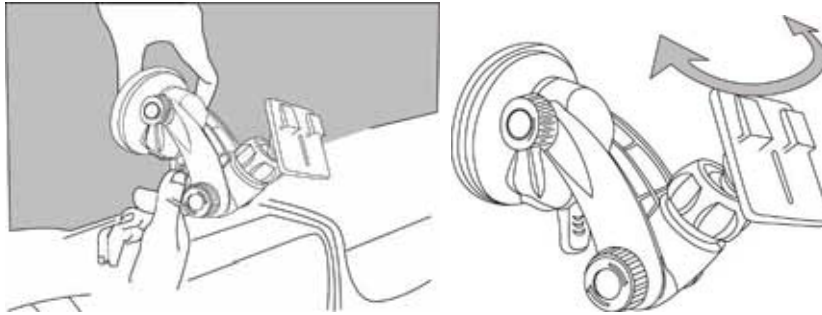

Figure 2-4-1

4. Mounting the device holder with your RN6.
 - a. Fit RN6 down in the device holder first, and then lock it using the plugs on the bottom of the device holder. (See Figure2-4-2)
 - b. Firmly lock RN6 with device holder on the car mount which has been mounted to your windscreen. (See Figure2-4-3)

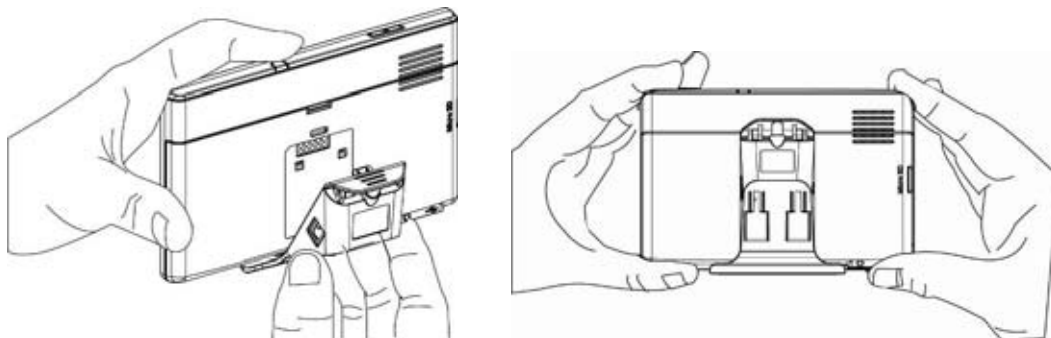

Figure 2-4-2

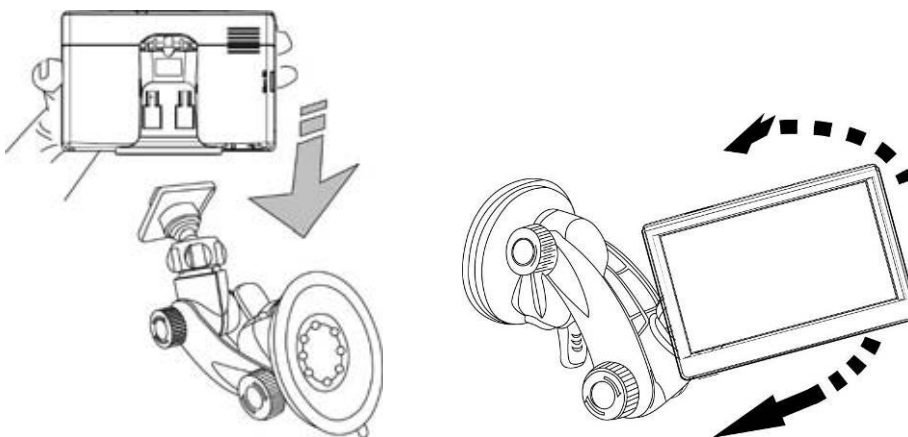

Figure 2-4-3

2.5. How to Charge RN6

- a. Plug the car charger to the 12 V outlet of your car and then connect the charger cable to the Mini USB port of RN6 car holder or directly on the device. (See Figure 2-5-1)
- b. Then RN6 can have the continuous power from the car charger.

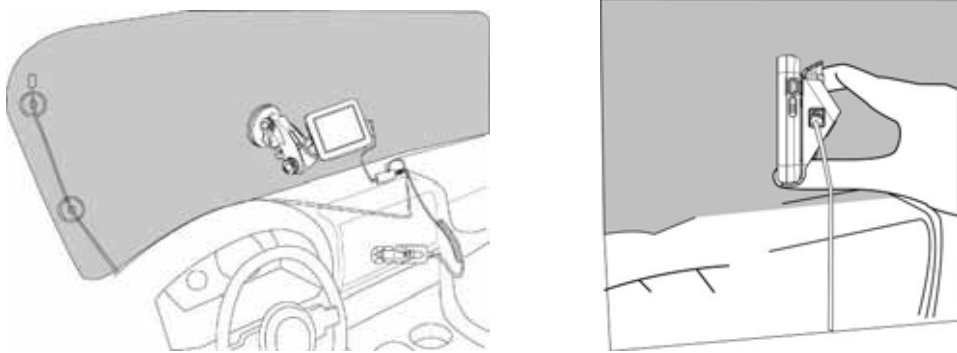

Figure 2-5-1

NOTE:

Your car may be required to switch the vehicle ignition into the accessories position to power the cigarette lighter. Your RN6 will not charge with the ignition off.

2.6. How to Start RN6

- a. When PND is off mode, short pressing (2 seconds) power button or plugging by car charger or AC adaptor can boot system. Then the main menu screen appears.
- b. When PND is suspend mode, clicking power button or plugging by car charger or AC adaptor can wake up system. Then the main menu screen appears.
- c. Tap Navigation, you will see the map screen displayed.
- d. Please read the User's Guide of Navigation software for the detail setting information.

Please be noted, the first time turning on RN6 may take some time to obtain a valid GPS fix.

2.7. How to Turn off RN6

- a. To disconnect all power supply or connecting cables first, including USB device cable, car charger or AC adapter, from your device.
- b. Long pressing (5 seconds) power button will turn off the device.

2.8. How to Hard Reset RN6

In the normal situation, it is unnecessary to reset your RN6. If a problem cannot be corrected, you can reset RN6 by either of the following ways:

- a. When RN6 is **with external power supply**, please press reset button to reboot RN6 directly.
- b. When RN6 is **with battery only**, please press reset button to turn off RN6. Then short press (2 seconds) power button to turn on RN6.

Chapter 3 Start to Use RN6

3.1. Operating Basics

After fully charging RN6 it is ready to be used. You can now turn it on and proceed to system settings configuration.

3.2. Turn on the device

Long pressing (5 seconds) power button or plugging by car charger or AC adaptor can boot system. Then the main menu screen appears. This is also referred to the Favorite page.

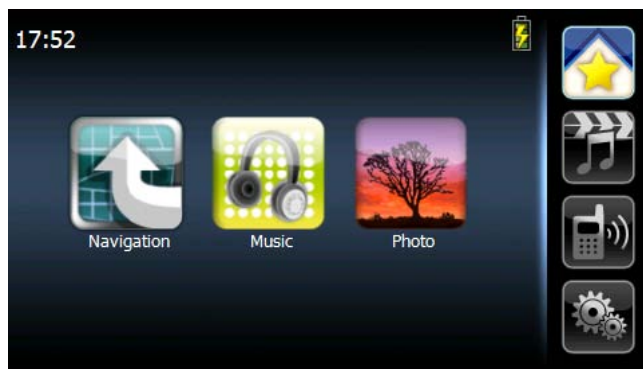

3.3. Configure system settings

If you intend to start using your RN6 at once, we recommend that you configure the language and time zone settings first.

- a. Tap "System" in the right category bar

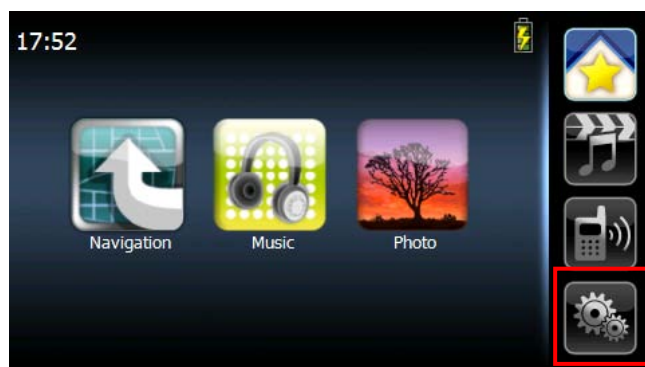

- b. Tap “Language” on the System page.

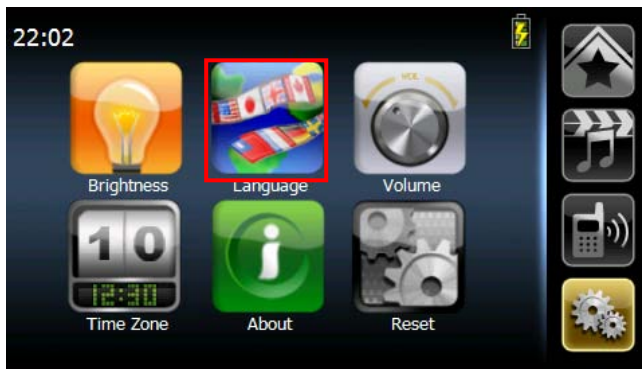



- c. It will display the current language in central column.
d. To scroll wheel for language tags.



- e. To set the system time zone, tap “Time Zone” in System Menu.



- f. Tap the  icon to set up the function of daylight saving time.
-  To enable the function of daylight savings time.
 -  To disable the function of daylight savings time.
- g. Drag the Map to adjust the time zone.

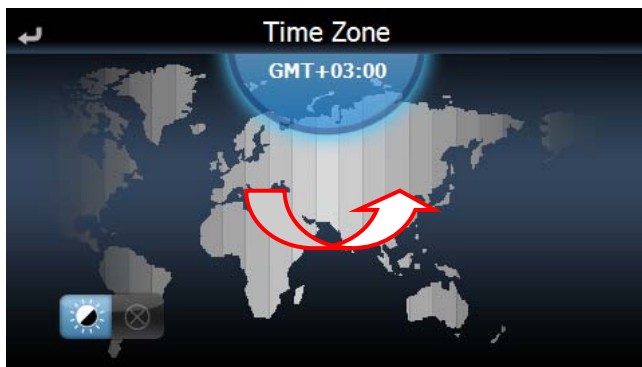

3.4. How to Use System Settings

Other system settings can be used to view and adjust your device current preferences.

Navigate from the System Menu.



3.5. Resetting

GPS Reset: Users can check if GPS receiver performs properly or not. (ex. Change regions)

Factory Reset: The factory reset function not only resets the operating system settings to default factory values, but also reset the GPS settings.

Calibration: When touch screen does not respond well, calibrate the screen of your device.

- a. Tap the “Reset” icon in the System Menu.



- b. Tap the “GPS Reset” icon in the Reset Menu.



- c. Tap the “YES” to reset the GPS.



- d. Tap the “Factory Reset” icon in the Reset Menu.



- e. Tap the “YES” to do the Factory Reset.

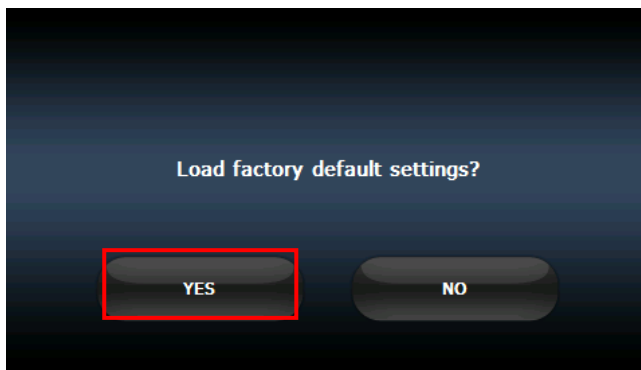

- f. Tap the “Calibration” icon in the Reset Menu.



- g. Tap on the center of the target. Repeat as the target moves around the screen.

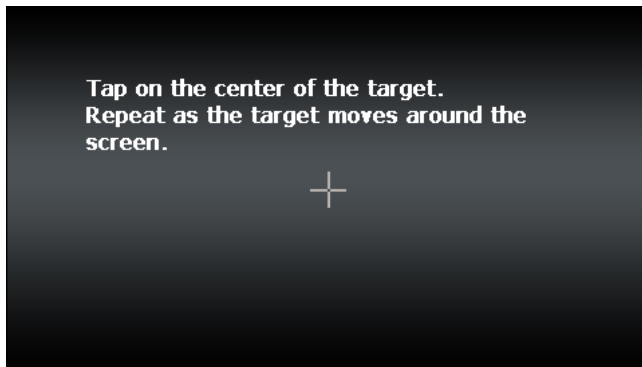

3.6. System Information

- a. Tap “About” icon in the System Menu.



- b. You can view the OS, AP, GPS firmware version and other system information.

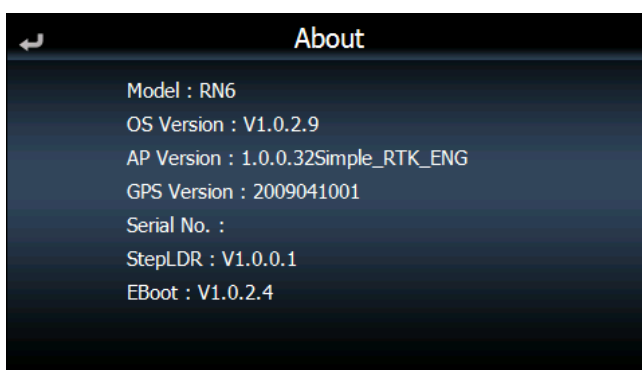

3.7. Volume

- a. Tap the Volume icon in the System Menu.



- b. Adjust the volume by dragging the wheel.
- c. Dragging to left will become mute, and opposite will become larger.

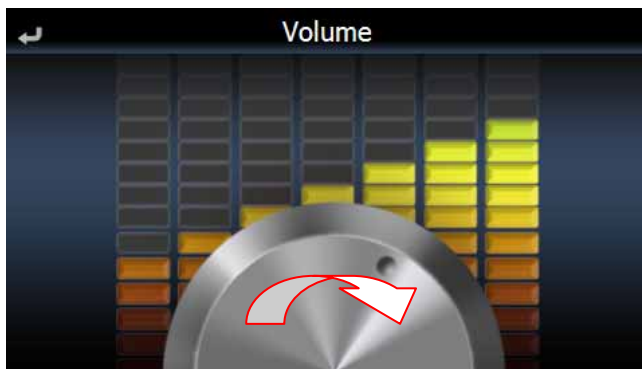

3.8. Backlight

- a. Tap the Backlight icon in the System Menu.

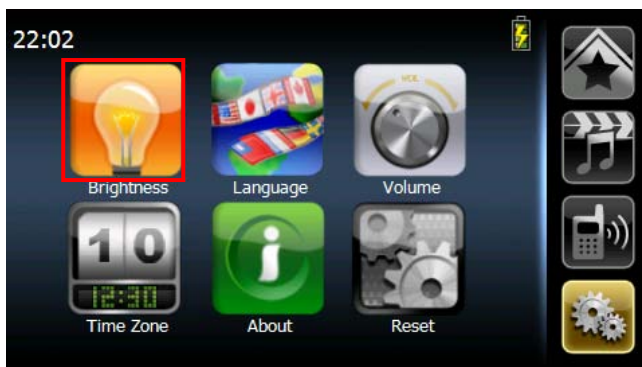

- b. Adjust the Backlight brightness by dragging triangle icon.
- c. Dragging to left will become darker; dragging to right will become lighter.

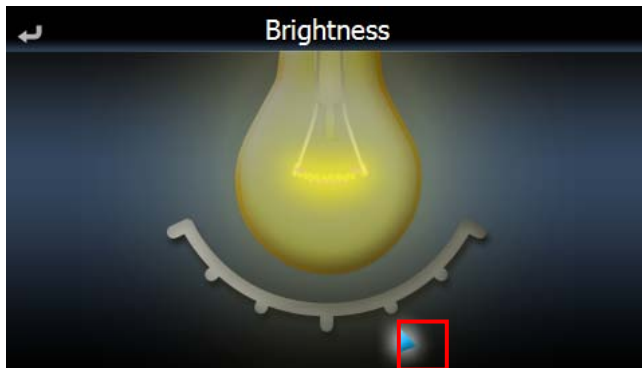

3.9. Set Favorite Application Category

You can drag-and-drop to organize your own favorite application category, but the maximum number of favorite application shortcut is six.

3.9.1 Add Icons to Favorite Page

- a. Drag the icon to the favorite icon of the right category bar.



- b. Tap the favorite icon. Then the icon will show in the favorite page.

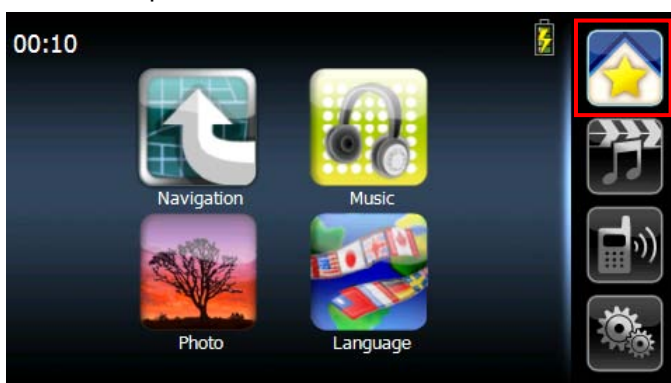

3.9.2 Delete Icon to Favorite Page

- a. Drag the icon from Favorite page to right category bar and drop it.
- b. Confirm dialog will pop up, just tap “YES” to delete.



3.10. Power Supply

RN6 has a complete power management system. It can make you more convenient to carry it for entertainment purpose, not only using in cars but also at home or outdoor activities.

3.10.1 Charging

Please use our standard car charger or AC adapter to charge RN6, the main screen would remind you the charging status.

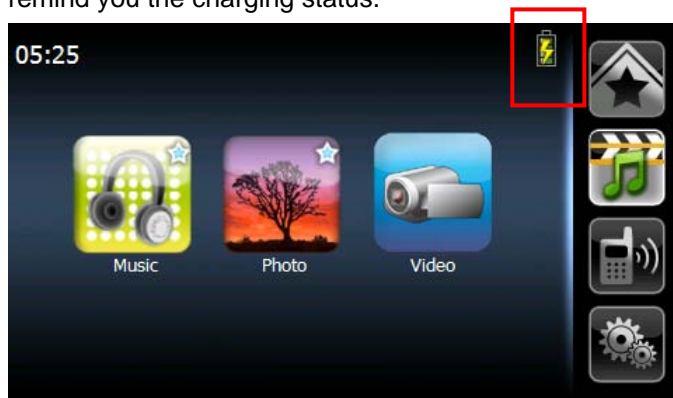

3.10.2 Discharge

When a car charger or AC adapter is taken off from the device, the main screen would remind if you would like to have RN6 suspend or not. Suspend mode still slightly consumes power. If you want to cut off power output, please turn off the device.

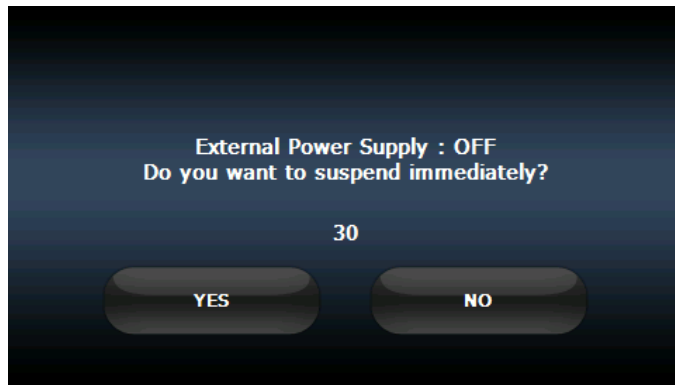

3.10.3 Power Outage

When battery capacity is lower than 15%, the main screen would remind you the following message. Please recharge the device immediately.

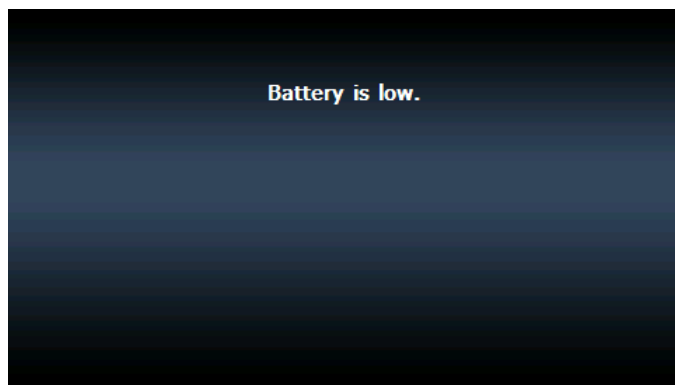

Chapter 4 Entertainment

4.1. RN6 Multimedia Applications

RN6 is capable of optional multimedia applications that can enhance your portable entertainment. In addition to its navigating function, RN6 is also a mobile entertainment tool to enjoy digital music, view photos or videos. These functions make RN6 as a true multimedia device.

To enjoy more multimedia files, please do by either of the following ways to transfer files from a computers to RN6.

- To use USB device cable to connect the device with a computers and then via File Explorer to copy digital files into the device.
- To use a compatible card reader and directly copy digital music and image files to the Micro SD card.

It is recommended to organize files into subfolders. These folders will make files easier to find and play.

4.2. Music player





Enjoy your favorite music on the road. The program features:

- Support for WMA and MP3 files Constant bit rate only;
- Auto-scanning of supported files in the device's Micro SD card and Flash memory;

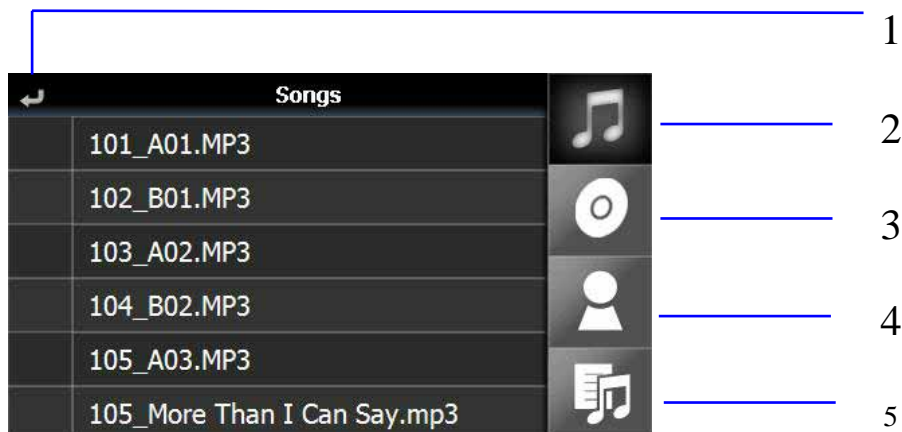
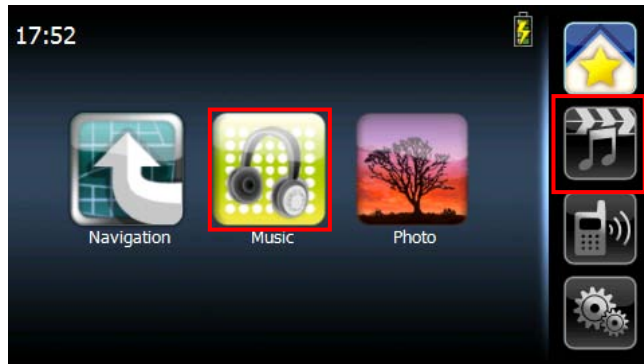
Each sub-directory containing compatible music files is treated as an individual different album. For easy search, it is advisable to named sub-directories based on genre or listening preferences.

- a. Tap "Music" icon of the Main Menu or multimedia icon of the right category bar.



NO	Icons	Functions	Description
1		Return	Return to list page
2		Songs	List all song by alphabet
3		Album	List all albums by alphabet.
4		Artist	List all artists by alphabet
5		Search	Current play list

b. Tap a song or scroll upward or downwards to view songs on the music list.

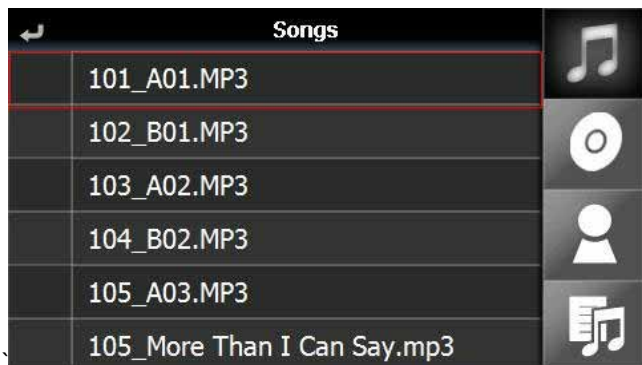



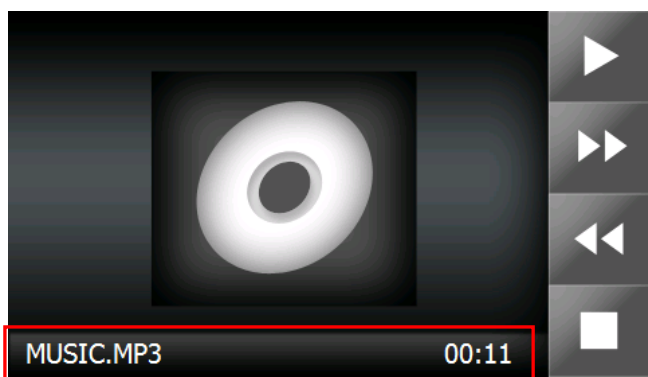

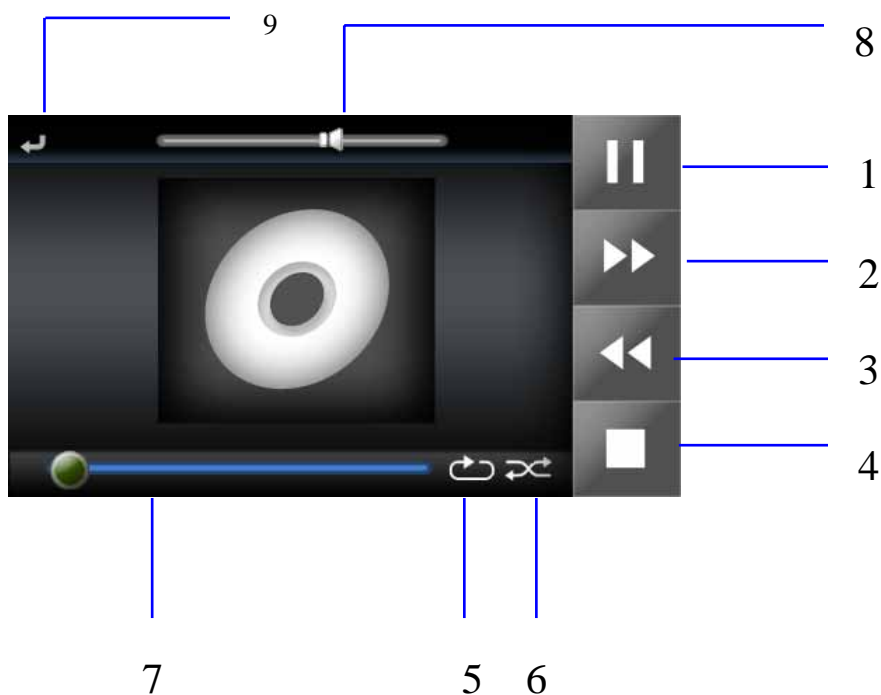

c. Bottom information bar will show song's name and play time



d. Taping the screen will switch to song's progress status.



NO	Icon	Function	Description
1		Play/Pause	Play/Pause a song
2		Forward	Forward to the next song.
3		Backward	Back to the previous song
4		Stop	Stop music play.
5		Repeat	Repeat play songs.
6		Random	Random play songs.
7		Bottom info. bar	To adjust the song's progress.
8		Sound bar	To adjust the sound.
9		Return	Return to list page.

4.3. Photo Viewer

RN6 has a great photo viewer option that makes it easy to share and view digital photos anywhere you like. The program features:

- Support for JPEG files (Support Max. 500 photos)
- Auto-scanning of supported files in the device's Micro SD card
- Three viewing modes: Thumbnail, Full Screen, and Slide Show

Each sub-directory containing compatible music files is treated as an individual different album. For easy search, it is advisable to named sub-directories based on meaningful name or date. An example could be "summer vacation pictures" or "New baby" or "2005 Best."

4.3.1 Use Photo Album

- a. Tap "Photo" icon in the Main Menu or multimedia icon of the right category bar.

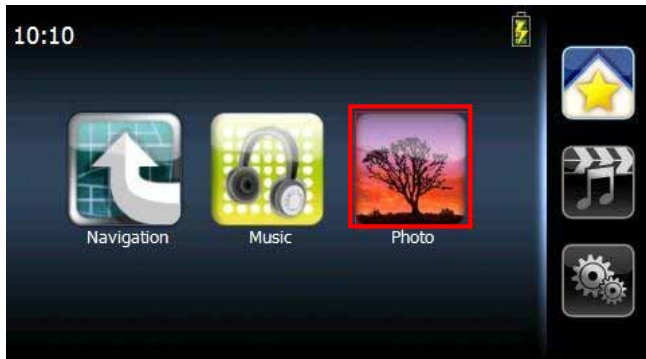

- b. List photos of thumbnail viewing mode.
- c. Dragging upward or downwards will make photos move to next or previous page.

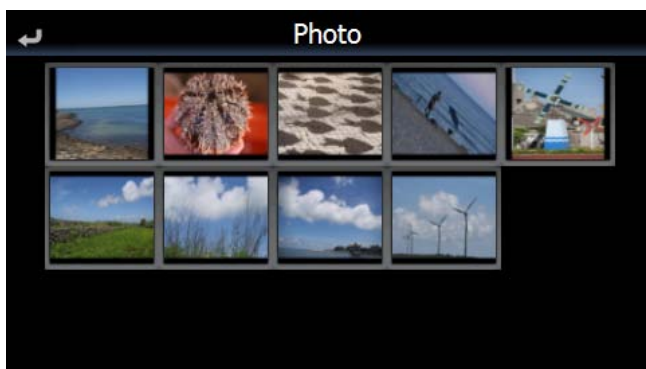





- d. Taping a specific thumbnail photo will switch the photo to full screen view.

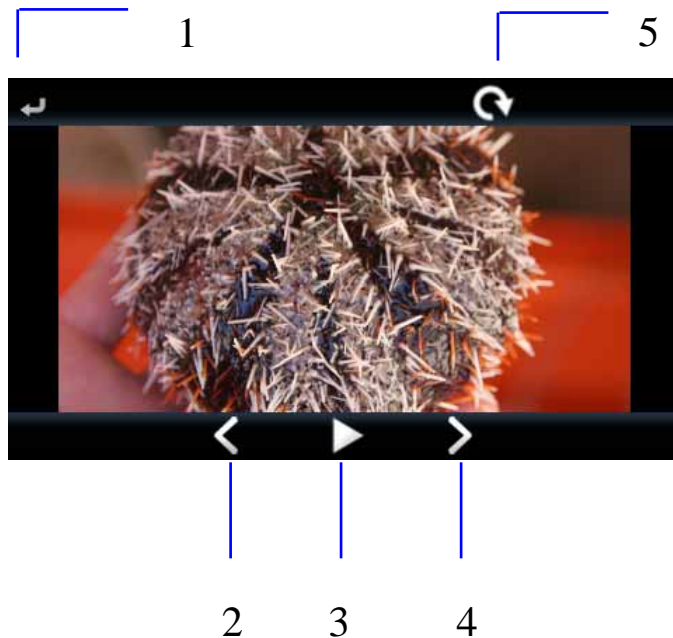

e. Tapping the screen will display the control bar.



NO	Function		Description
1		Return	Return to thumbnail page
2		Previous page	Display previous photo.
3		Slide show mode	Automatically play all photos.
4		Next page	Display next photo.
5		Rotate	Rotate photo

4.3.2 View Photos in Slide Show Mode

You have the option to view images in a slide show much like viewing a Power- Point presentation in your computer. Images are adjusted to fit the entire display area and are shown in a 5-second interval.

4.4. Video Player (Optional)

Video Player is a unique function in RN6, which can make you enjoy your favorite videos and have fun. The program features:

- Support WMV files (Maximum 500 files)
- Auto-scanning of supported files in the device's Micro SD card and Flash memory
- Three viewing modes: Browser Mode, Normal Mode, Play Mode

4.4.1 Use Video Player

- Tap "Video" icon in the Main Menu or multimedia icon of the right category bar.



- The screen will show safety warning message. Tap "Accept" icon to enter Video Player function screen, or tap "Cancel" to give up.

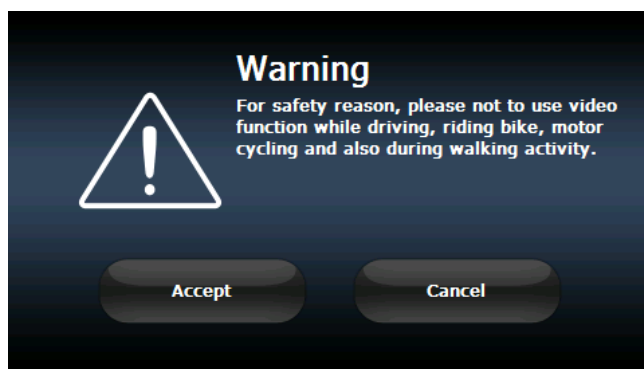

- c. Tap “File Manager” to view files by browser mode.

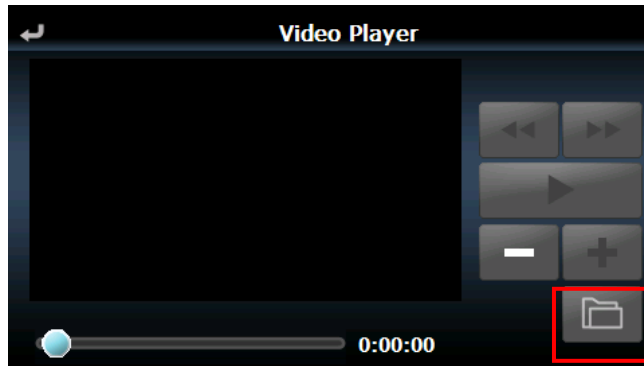

- d. The screen shows “Browser Mode”.

- e. Tap a file which you would like to play.

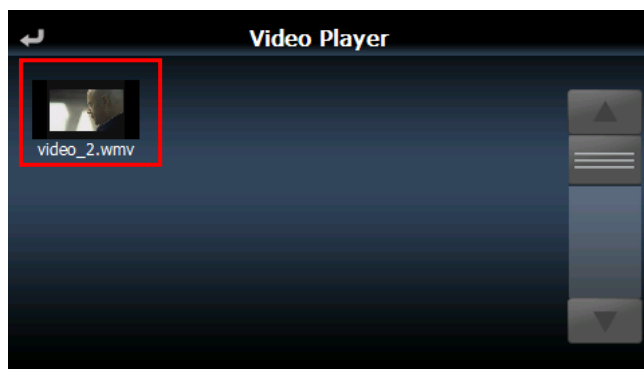

- f. The screen switches to “Normal Mode” and shows function icons.

- g. Tap “Play”.

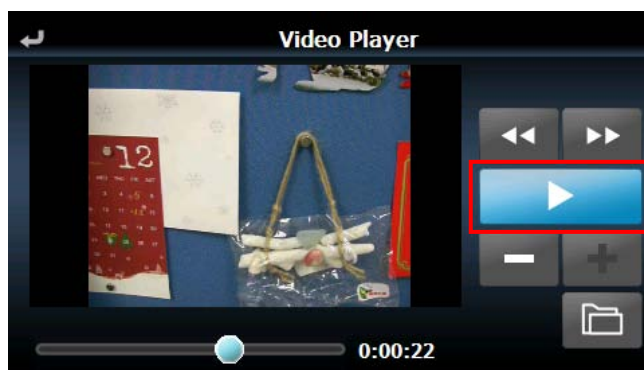







h. Tapping screen will switch to "Play Mode".





i. Tap screen at Play Mode. Function icons will pop up.

j. Then tap "Mode Switch. The screen will switch back to "Normal Mode".



NO	Icon	Function	Description
1		Play	Play a video file
2		Pause	Pause to play a video file
3		Forward	
4		Downward	
5		Volume down	Turn down volume
6		Volume up	Turn up volume
7		File Manager	List video files

NO	Icon	Function	Description
8		Progress bar	Show playing progress (Tap or drag to control playing progress)
9		Return	Return to the previous page
10		Mode Switch	Switch screen from Play mode to Normal mode.





4.5. FM Transmitter (Optional)

RN6 has a great music-player-supported function to output sounds via your car audio/stereo. FM frequency can be varied from 88.2 to 107.8 Mhz.

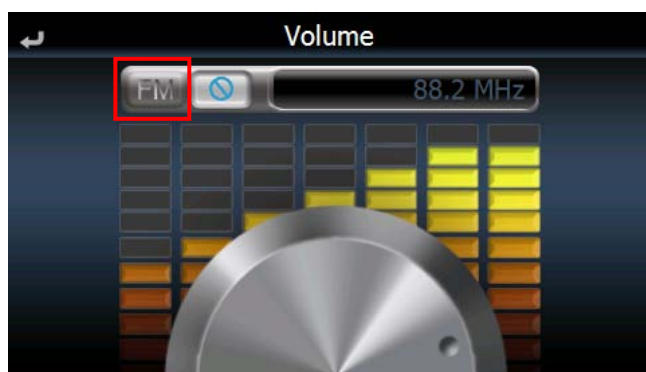
4.5.1 Turn on FM Transmitter Frequency

- a. Tap "Volume" icon in the System Menu.
- b. Tap "FM" icon to open FM Transmitter function



NO	Icon	Function	Description
1		FM Transmitter	Open FM Transmitter function
2		Stop	Stop FM Transmitter function
3		Frequency	Set frequency (Default setting: 88.2 MHz)
4		Return	Return to list page.

NOTE : There will be  icon on the main menu to remind you if FM Transmitter is operating.

4.5.2 Set FM Transmitter Frequency

- a. Set a frequency, 88.2 MHz for example, in your car radio.
- b. Tap frequency entry



- c. Set the number as same as the frequency of your car radio, and tap "Enter"



- d. Set the same frequency number to make your car radio receive audio from RN6.
- e. Go back to Main menu. Play "Music Player", "Video player" or "Navigation".
- f. Then sounds will come out from your car radio.

NO	Icon	Function	Description
1		Delete	Delete frequency number
2		Enter	Implement this frequency number
3		Return	Return to list page.

NOTE : FM Frequency can only be set from 88.2 to 107.8 Mhz.

Chapter 5 Communications

Bluetooth (Option Function)

Once your Bluetooth-enabled mobile phone is paired with your RN6, you can make hands-free phone calls through your RN6 integrated microphone and speaker. RN6 makes it easy to make and receive phone calls with ease while you drive a car. Hands-free calling keeps things safe, letting you keep your eyes on the road, while RN6 integrates seamlessly with your mobile phone. Easy to connect and use, just follow a few quick steps to enjoy the benefits of Hands-free calling.

5.1. Connection

- a. Tap “Bluetooth” icon of the right category bar to enter the communication main menu.



NOTE : Make sure the Bluetooth setting of your mobile is “ON” or “enable” mode, and the visibility is set to “Discoverable” or “Show my phone”, (For more detailed information, see your phone’s manual.)

5.2. Mobile Phone Connection

- a. Tap “Settings” icon on the communication main menu.

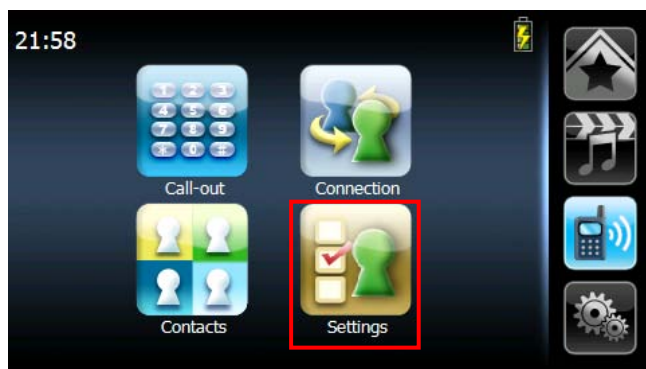

- b. Turn on Bluetooth function



- a. Turn on "Automatic Answer" too if you also prefer to automatically receive calls when the mobile phone is ringing.
- b. Choose automatic answering time: 3 seconds, 10seconds, or 30 seconds.

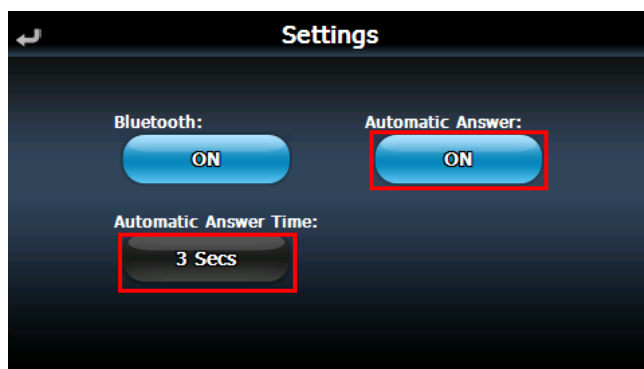

NOTE : There will be  icon on the main menu to remind you if Bluetooth is operating.

- c. Go back to the communication main menu screen and tap "Connection".



- d. Tap “Search” to look for Bluetooth mobile phones.

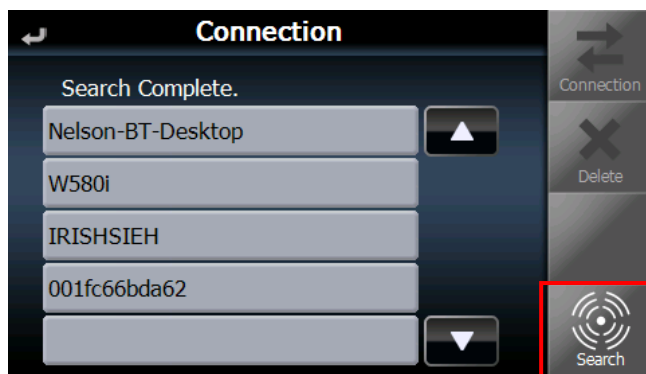

- e. Choose the mobile phone you want to connect with and tap “Connection”.



- f. Your mobile phone may require you to enter a password to connect the device. Enter “0000” on the mobile phone in this case.
- g. When connection is accomplished, the name of the connected phone is displayed on the title bar of the “communications” screen.



NOTE :

- If the connected mobile phone has the Bluetooth auto-accept function, please turn on this function. (For more detailed information, see your phone’s manual.)
- Bluetooth function has distance limitation. When the mobile phone is away, and makes Bluetooth function disconnected, RN6 would try to re-connect within 10 seconds.

5.3. Calling Out

- a. Tap “Call-out” icon.





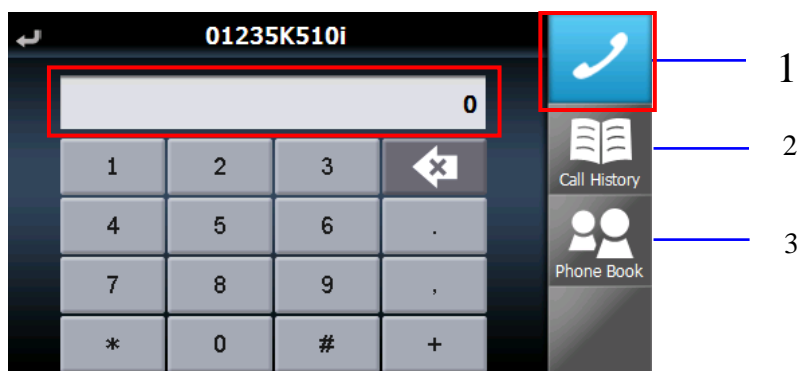

- b. Set the phone number you would like to call out and tap “Dial” icon.

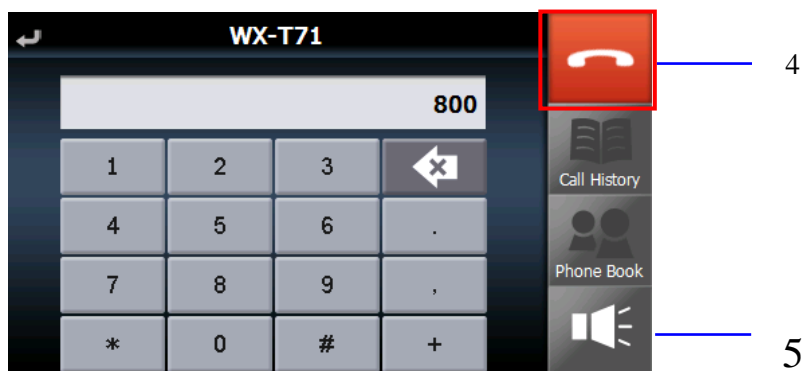

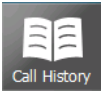

- c. If you would like to end a call, please tap “Hang up” icon.



- d. To enable or disable mute function, tap speaker icon.

No.	Icon	Function	Description
1		Dial	Make a call.
2		Call History	Incoming/ receiving call logs. You can tap a phone number directly to call out.
3		Phone Book	Entering to phone book page. (pl. refer to 5.5) You can tap a phone number directly to call out.
4		Hang up	End a call.
5		Non-Mute	Two sides of the phone call can hear each other.
6		Mute	Mute function is turned on. Your conversation won't be heard by the other side of the phone call.

5.4. Receiving a Call

- c. When the connected mobile phone receives a call, the caller's phone number and two buttons are displayed on the screen.
- d. To receive a call, tap ; to quit a call, tap .

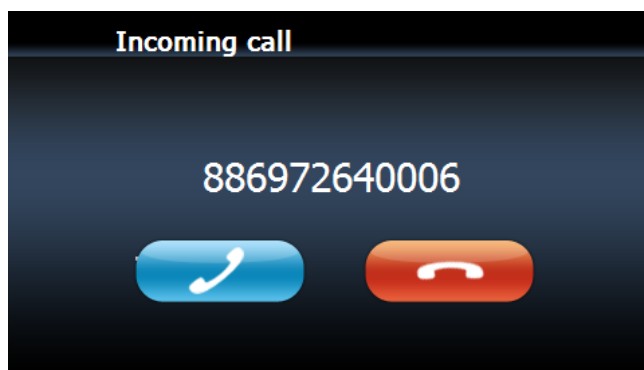



- e. If you have set “Automatic Answer” function, the incoming call will be picked up automatically. And the screen will switch to the communication main menu.
- f. If you would like to end a call, please tap “Hang up” icon.



- g. To enable or disable mute function, tap Microphone icon.



No.	Icon	Function	Description
1		Hang up	End a call.
2		Microphone “ON”	Microphone function is turned on. The other side of the phone call can hear your voice.
3		Microphone “OFF”	Microphone function is turned off and mute. Your conversation won't be heard by the other side of the phone call.

5.5. Phone Book (Import Phonebooks)

- a. Tap "Contacts" icon.



- b. Tap "Import" icon.
- c. The contact information will be imported from the connected mobile phone.

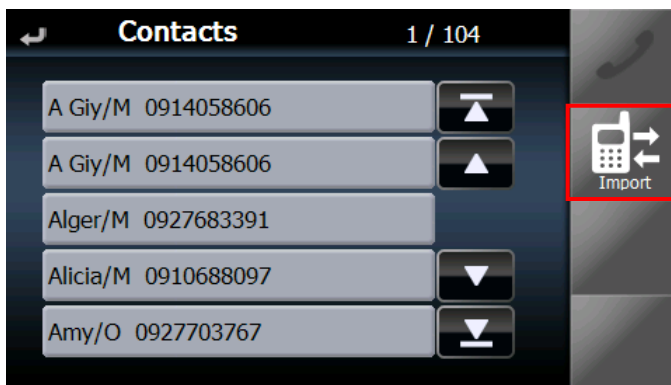

Chapter 6 Troubleshooting and Maintenance

6.1. General Troubleshooting

6.1.1 If your device does not respond, do a “hard reset”

You can reset RN6 by either of the following ways:

- a. When RN6 is **with external power supply**, please press reset button to reboot RN6 directly.
- b. When RN6 is **with battery only**, please press reset button to turn off RN6. Then short press (2 seconds) power button to turn on RN6.

6.1.2 Users can also perform a “system reset”

- a. Do a “system reset,” in the Main menu, tap System, then tap System Info.
- b. This will allow you to do a factory reset (restore to default settings), reset the GPS status and recalibrate the touch screen interface.

6.1.3 Screen responds slowly

- a. Make sure you have enough battery power.

6.1.4 Inaccurate responses to tap on touch screen

- a. Recalibrate the touch screen.

6.1.5 Connection Problems with PC

- a. Make sure that the cable is securely plugged into the USB port on your computer and on the device. Connect the USB cable directly to your computer—do not use the cable through a USB hub.
- b. Reset your device before connecting the cable. Always disconnect your device before you restart your computer.

6.1.6 No GPS connection

- a. Make sure RN6 is put near car windshield or no obstacle on its top.
- b. Note that the GPS reception can be affected by:
 - Bad weather

- Dense overhead obstacles (e.g. trees and tall buildings)
- Other wireless devices in the car

6.1.7 No sound coming from the device

- a. Make sure mute is not selected for Volume in system settings. The built-in speaker turns off when the headphone jack is being used.

6.1.8 Cannot see photos

- a. Make sure you are using supported image formats JPG.

6.1.9 Take longer than normal time to get a GPS fix.

- a. If the previous GPS fix position was more than 500 km or 12 hours apart from your current position and time, it will also take significantly longer than the standard TTFF time to get a GPS fix. This is due to the nature of the GPS algorithm and rotational velocity between the satellites and planet Earth, and deemed normal.
- b. Perform a GPS reset in the main/system/system info menu to get a faster GPS fix.

6.1.10 Factory reset does mean a GPS reset.

- a. Yes. The Factory Reset function resets the OS settings to their default factory values and it will reset the GPS settings.

6.2. Maintenance

- Avoid exposing your device to direct sunlight or strong ultraviolet light for extended periods of time.
- Do not drop your device or subject it to severe shock.
- Do not subject your device to sudden and severe temperature changes. This could cause moisture condensation inside the unit, which could damage your device. In the event of moisture condensation, allow the device to dry out completely before use.
- The screen surface can be easily scratched. Sharp objects may scratch the screen. You may use non-adhesive generic screen protectors designed specifically for use on portable devices with LCD panels to help protect the screen from minor scratches.
- Never clean your device when it powered on.
- Never use organic solvents such as benzene or paint thinner to clean your device. Use of these solvents can cause deformation or discoloration.

- Use a soft, clean, lint-free cloth to clean the display screen. Moistened LCD screen wipes could also be used as required.
- Never attempt to disassemble, repair or make any modifications to your device. Disassembly, modification or any attempt at repair could cause damage to your device and even bodily injury or property damage and will void any warranty.

6.2.1 Storage precautions

- Do not store your device anywhere it may be exposed to water or in conditions of high humidity.
- When the device is not in use for an extended period of time, bring it indoors and store it in cool dry area.

6.2.2 Accessories and repair precautions

- Only authorized accessories should be use with the device. The use of incompatible accessories could result in bodily injury and/or damage to the device.
- The use of unauthorized accessories will also void your warranty.
- Never attempt to disassemble, repair or make any modification to your device.