

10-45G

10-45D

Quick Start Guide

For more information about how to use the phone, please go to www.alcatelontouch.com to download complete user manual (English version only). Also on our website you can find helpful FAQs (English version only).



www.sar-tick.com

This product meets applicable national SAR limits of 1.6W/kg. The specific maximum SAR values can be found in the RADIOWAVES section of this user guide.

When carrying the product or using it while worn on your body, either use an approved accessory such as a holster or otherwise maintain a distance of 10 mm from the body to ensure compliance with RF exposure requirements. Note that the product may be transmitting even if you are not making a phone call.

PROTECT YOUR HEARING
To prevent possible hearing damage, do not listen at high volume levels for long periods. Exercise caution when holding your device near your ear while the loudspeaker is in use.



ALCATEL
ontouch

Your mobile.....

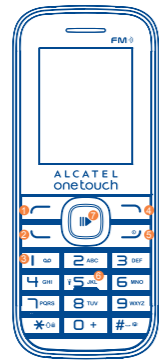

- 1 Left softkey
- 2 Answer/Send call
- 3 Call log
- 4 Voicemail (press and hold)
- 5 Right softkey
- 6 Switch on/Switch off End call
- 7 LED Flashlight
- 8 Navigation key: Menu/Confirm an option
- 9 Profiles
- 10 Calendar
- 11 Messages
- 12 Alarm

1.1 Keys

Navigation key
Confirm an option (press the middle of the key)

Answer
Send a call
In idle screen:
- Press: **5** (space)

Switch on/Switch off the telephone (press and hold)
End call
Return to idle screen

Left softkey

Right softkey

Access your voicemail (press and hold)

In Edit mode:
- Press: access the symbols table
- Press and hold: enter zero

In Edit mode:
- Press: change input methods

#
In idle screen:
- Press: #
- Press and hold: activate/deactivate vibrate mode
In Edit mode:
- Press: (space)

5
From Idle screen
- Press: dial '5'
- Press and hold: switch the LED Flashlight on/off

1.2 Main screen icons ⁽¹⁾

1045G:

Battery charge level

Call forwarding activated: your calls are forwarded

Alarm or appointments programmed

Level of network reception

Voicemail message received

Missed calls

Radio is on

Roaming

Silence mode: your phone does not ring, beep or vibrate with the exception of the alarm

SMS unread

Flight mode

1045D:

Level of network reception.

Call forwarding activated: your calls are forwarded.

Roaming

⁽¹⁾ The icons and illustrations in this guide are provided for information purposes only.

2 Getting started.....

2.1 Set-up

Removing and installing the back cover



Removing and installing the battery



Inserting and removing the SIM card

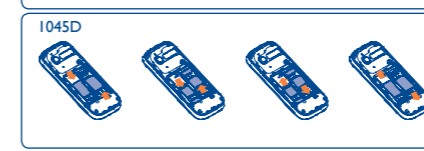
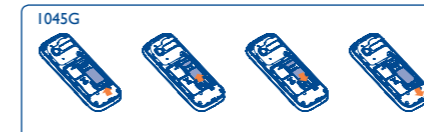

Place the SIM card with the chip facing downwards and slide it into its housing. Make sure that it is correctly inserted. To remove the card, press it and slide it out.

⁽¹⁾ The quality of the radio depends on the coverage of the radio station in that particular area.

Charging the battery

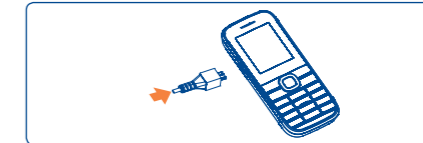

Connect the battery charger to your phone and outlet respectively.

- Charging may take about 20 minutes to start if the battery is fully discharged.
- Be careful not to force the plug into the socket.
- Make sure the battery is correctly inserted before connecting the charger.
- The outlet must be near to the phone and easily accessible (avoid electric extension cables).
- When using your telephone for the first time, charge the battery fully (approximately 3 hours). You are advised to fully charge the battery ().
- To reduce power consumption and energy waste, when battery is fully charged, disconnect your charger from the plug; reduce the backlight time, etc.

The charge is complete when the animation stops.

2.2 Power on your phone

Hold down the **5** key until the phone powers on.

2.3 Power off your phone

Hold down the **5** key from the main screen.

3 Calls

3.1 Making a call

Dial the desired number then press the **5** key to place the call. If you make a mistake, you can delete the incorrect digits by pressing the right softkey.

To hang up the call, press the **5** key.

Making an emergency call

If your phone is covered by the network, dial emergency number and press the **5** key to make an emergency call. This works even without a SIM card and without typing the PIN code.

3.2 Calling your voicemail ⁽¹⁾

To access your voicemail, hold down the **5** key.

3.3 Receiving a call

When you receive an incoming call, press the **5** key to talk and then hang up using the **5** key.

3.4 Available functions during the call

During a call, you can use your directory, your calendar, text messages, etc. without hanging up or dropping the call.

⁽¹⁾ Contact your network operator to check service availability.

4 Contacts.....

4.1 Consulting your contacts

To access the **Contacts** from the main screen, press the **5** key and select the **5** icon from the menu.

4.2 Adding a contact

You can add a new contact to phone or SIM card by selecting **Add contact**.

5 Messages

5.1 Create message

From the main menu select **Messages** to create text. You can type a message and you can also modify a predefined message in **Templates**. While writing a message, select **Options** to access all of the messaging options. You can save your messages that you send often to **Drafts**.

Specific letters (accent) will increase the size of the SMS, this may cause multiple SMS to be sent to your recipient.

6 Call log

6.1 Access

You can access the function using the following options:

- Select **5** from main menu
- Press the send key from Home screen
- For dual SIM model, the complete contacts of both SIM1 and SIM2 are available in this menu ⁽¹⁾.

6.2 Available options

When you press **Options**, you can have access to **View, Send SMS, Save to Contacts, Edit before call, Add to blacklist, Add to whitelist, Delete** etc.

7 Camera

Your mobile phone is fitted with a camera for taking photos that you can use in different ways:

- Store them in your **My files\Images**.
- Customize your main screen.

Make sure that microSD card is well inserted before taking photos.

8 Settings

From the main menu, select the menu icon **5** and select the function of your choice in order to customize your telephone: **Profiles, Phone settings, Call settings, Network, Connectivity, Security, Regulatory & Safety, Restore default**.

9 Tools.....

9.1 Alarm

Your mobile phone has a built-in alarm clock with a snooze feature.

9.2 Calculator

Enter a number, select the type of operation to be performed, and enter the second number, then press **=** to display the result.

9.3 Calendar

Once you enter this menu from the main menu, there is a monthly-view calendar for you to query date.

9.4 Notes

You can create a note in text format by accessing **Tools\Notes** from the main menu.

9.5 Bluetooth

Access this feature by pressing **5** to enter the main menu, then selecting **Tools\Bluetooth**.

9.6 Converter

Weight converter and Length converter.

9.7 Voice Alarm

With this menu, you may create the voice file and set it as the alarm.

9.8 Fake call

This program enables you to call yourself by simulating a caller number/name, ringtone at a scheduled time. It helps you to politely escape from social situations at any time you wish. This call can be rejected by **5** key.

9.9 Call filter

Enable blacklist, all callers in the list will be automatically blocked. Enable whitelist, only callers in the list can be connected. You are allowed to add 20 contacts to each list from the Contacts, call log, Messages or create directly by pressing **5**.

9.10 Torch

To use the flashlight feature, you can activate **Torch** by using the below operations:

In idle screen, press and hold **5** to activate the flashlight; press **5** or press and hold **5** to deactivate it.

9.11 WAP

Access Wap options: **Homepage, Bookmarks, Go to URL, Recent pages, Settings**. Make sure that MicroSD card is well inserted before accessing this feature.

9.12 Services

Contact your network operator to check service availability.

10 Media.....

10.1 FM radio

Your phone is equipped with a radio ⁽¹⁾ with RDS functionality. You can use the application as a traditional radio with saved channels or with parallel visual information related to the radio program on the display if you tune to stations that offer Visual Radio service. You can listen to it while running other applications.

10.2 Images

A library links to the images (stored in **My images**) in phone or SD card to multi-mark, set as wallpaper, power on/off display or sent by Bluetooth, etc.

10.3 Recorder

Accessing **Recorder** allows you to make voice or sound recordings.

11 Music

Access this feature from the main menu by selecting **Music**. You will have full flexibility of managing music on your memory card.

⁽¹⁾ The quality of the radio depends on the coverage of the radio station in that particular area.

12 My files

You will have access to all audio and visual files stored in memory card in **My files**. You can access a number of items with this option: **My audios, Images, Received**, etc.

Inserting the memory card:

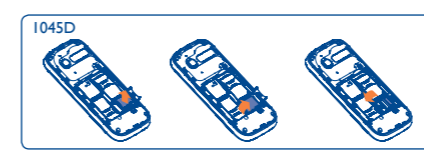
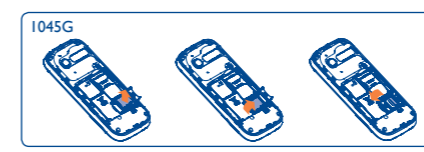

To release the microSD card holder, slide it in the direction of the arrow and lift it. Then insert the microSD card with the golden contact downward. Finally, turn down the microSD holder and slide it in the opposite direction to lock it.

⁽¹⁾ 1045G only.

13 Latin input mode

To write messages, there are two writing methods:

- Normal: this mode allows you to type a text by choosing a letter or a sequence of characters associated with a key.
- Predictive with the eZi mode ⁽¹⁾: this mode speeds up the writing of your text.
- **5** + key in edit mode
Press: access the symbols table
Press and hold: enter zero

PROTECT YOUR HEARING

To prevent possible hearing damage, do not listen at high volume levels for long periods. Exercise caution when holding your device near your ear while the loudspeaker is in use.

