

Quick Start Guide

For more information about how to use the phone, please go to www.alcatelone-touch.com to download complete user manual. Also on our website you can find helpful FAQs, realize software upgrade, etc.

Prolonged exposure to music at full volume on the music player may damage the listener's hearing. Set your phone volume safely. Use only headphones recommended by TCT Mobile Limited and its affiliates.

ALCATELone touch.

English - CJB2610ALAAAN

Your mobile

1.1 Keys and connectors



- Press to go left/right/up/down
- Press to confirm an option
- Press and hold to enter Music player
- Left softkey
- Access main menu
- Send key
- Answer/Send a call
- Press: Enter Call log
- Press and hold: Enter Fake call
- Right softkey
- Access contacts
- Press: End a call
- Return to the Home screen
- Press and hold: Power on/off
- Vibrate alert
- Press and hold: Access your voicemail
- Press to input capitalized characters
- Press once: Input a top-half character
- Press twice: Lock the keyboard in top-half key input mode
- Press and hold: Input top-half characters only until key is released
- Fn + B: Access Bluetooth
- Fn + M: Access Music
- Fn + P: Access Profiles
- Fn + J: Access Java applications
- Press: Enter a space (on edit mode)
- Confirm an option (on edit mode)
- Unlock the keypad (on Home screen)
- Press and hold: Access language list (on edit mode)
- Lock the keypad (on Home screen)

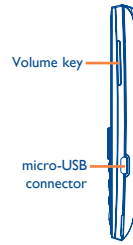

5.3 Write message

You can select "Messages|Write new SMS/MMS" from the main menu or access from widget to write text/multimedia message. For dual SIM model, you can type a message and select to send it to a recipient in either the SIM1 or SIM2 directory ⁽¹⁾. One or more recipients can be added from contact list and you can remove a recipient by pressing Delete key. Press "Contacts" through key to multi-select recipients from Contacts.

An SMS will be converted to MMS automatically when images, videos, audio, slides or attachments are inserted; Subject, CC/BCC/email address is added; or the message contains more than 8 pages of text.

An SMS message of more than a certain number of characters (the number of characters depends on your language) will be charged as several SMS. An MMS message containing photos and/or sounds may also be billed as more than one message. Specific letters (accent) will increase the size of the SMS, this may cause multiple SMS to be sent to your recipient.

6 Email.....

Your phone has an email client with the settings pre-defined for a few popular email services like - Google Mail, Yahoo, AOL, etc. Besides this, you can set up other POP3 or IMAP4 email accounts that you may be using.

7 Push mail.....

The **One Touch Mail** is a unique messaging service that will enable you to send and receive email messages directly from your mobile device. The One Touch Mail messaging service notifies you with a specific sound and a message on your screen every time a new message arrives. Even when the application is in idle or in standby mode, the email messaging service on your mobile device is still available.

⁽¹⁾ one touch 815D only. 10

8 Contacts.....

8.1 Consulting your contacts
You can access to this function by selecting "Contacts" from the main menu.
For dual SIM model, the complete contacts of both SIM1 and SIM2 are available in this menu ⁽¹⁾.

8.2 Adding a contact
You can add a new contact to phone or SIM card by selecting "Add contact".

9 Call log.....

9.1 Access
You can access the function using the following options:

- Select from main menu
- Press the send key from Home screen
- Select from widget bar, and then enter the sub-menu you require.

9.2 Available options
When you press "Options", you can have access to **Dial, Send message, Save to Contacts, Edit before call, Add to blacklist, Add to whitelist, Delete** etc.

⁽¹⁾ one touch 815D only. 11

10 Media applications.....

10.1 Music.....
You can access this feature from the main menu by selecting "Music". You will have full flexibility of managing music both on your mobile and SD card.

10.2 Images.....
A library links to the images both in phone and SD card to be shown in list, slide, multi-mark, set as wallpaper, power on/off display and incoming call image or sent by MMS, Email, Bluetooth, to Facebook.

10.3 Videos.....
Contains all video clips both in phone and SD card and enables you to play, send, set as power on/off display, delete, rename, sort, etc.

10.4 Radio.....
Your phone is equipped with a radio ⁽¹⁾ with RDS ⁽²⁾ functionality. You can use the application as a traditional radio with saved channels or with parallel visual information related to the radio program on the display, if you tune to stations that offer Visual Radio service. You can listen to it while running other applications.

9.2 Available options
When you press "Options", you can have access to **Dial, Send message, Save to Contacts, Edit before call, Add to blacklist, Add to whitelist, Delete** etc.

⁽¹⁾ The quality of the radio depends on the coverage of the radio station in that particular area.
⁽²⁾ Depending on your network operator and market. 12

11 Internet ⁽¹⁾.....

11.1 Web.....
Web not only gives you the full Web experience where you stay in touch with your friends, obtain information, do your online banking etc., but also saves time by using compressed web pages.

11.2 Wap.....
Access Wap options: **Homepage, Bookmarks, Go to URL, Open file, Last wap address, Recent pages, Offline pages, Service inbox, Settings.**

11.3 News.....
It is a huge time saver providing news updates from a website in a simple form.

Once subscribed to a channel, it gives you the ability to track and manage all your favorite RSS content on your mobile phone at anytime, anywhere!

11.4 Weather.....
Your phone is equipped with a weather function for consulting up to 3-day forecast of favorite cities.

11.5 mTweet.....
Twitter is a social networking and microblogging service that has gained notability and popularity worldwide. This feature enables phone users to exchange news updates and ideas with a community in the form of messages or posts. Posts are displayed on the author's profile page and delivered to the author's subscribers or followers. To open an account online, please go to: <http://m.twitter.com>.

⁽¹⁾ Depending on your network operator. May cause additional network charges for data flow to provide this service. Extra fees might also be charged in roaming states. 13

12 Apps.....

Apps store is an online software store, where you can download and install applications and games to your phone.

13 Facebook.....

Facebook is a social utility that connects people with friends and others who work, study and live around them. You can select "Facebook" in main menu or press key on the keypad to enter the Facebook page, then you can access to **NewsFeed, Me, Messages, Friends, Photos, Events, Search, Notification and Settings.**

14 Entertainment.....

14.1 Stopwatch.....
The stopwatch is a simple application for measuring time with the possibility to register several results and suspend/resume measurement.

14.2 Ebook.....
A bookshelf contains the electronic books (.txt and .pdb file only). While reading the book, you may add bookmark, or reach the text by searching words, phrases (**Options|Find, Options|Jump to**).

⁽¹⁾ Depending on your network operator. 5

15 Camera.....

Your mobile phone is fitted with a camera for taking photos and shooting videos that you can use in different ways:

- store them as your creations in SD card or phone.
- send them in a multimedia message (MMS) to a mobile phone or an email address.
- send them directly by MMS, Email, Bluetooth, to Facebook.
- customize your Home screen.
- select them as incoming call image to a contact in your Contacts.
- transfer them by data cable or microSD card to your computer.

16 Profiles.....

With this menu, you may personalize ringtones for different events and environments.

17 My files.....

You will have an access to all audio and visual files stored in phone or SD card in My files. You can access a number of items with this option: **My audios, Ebook, My images, My videos, Received, etc.**

18 Bluetooth.....

Access this feature by pressing "Menu" through Left softkey from the Home screen to enter the main menu, then selecting "Bluetooth".

⁽¹⁾ Depending on your country or your operator. 16

19 Wi-Fi.....

To access this function, press "Menu" to enter the main menu, and select or press directly.

20 Tethering.....

Tethering is a method for connecting a computer or other devices to the internet via an internet-capable mobile phone. Access this feature by pressing "Menu" through Left softkey from the Home Screen to enter the main menu, then selecting "Tethering".

21 Others.....

21.1 Calendar.....
Once you enter this menu from main menu, there is a monthly-view calendar for you to keep track of important meetings, appointments, etc. Days with events entered will be marked in color.

21.2 Calculator.....
Access this feature by selecting "Calculator" from the main menu. Enter a number, select the type of operation to be performed using the navigation keys, and enter the second number, then select "=" to display the result.

21.3 Notes.....
You can create a note in text format by accessing "Notes" from the main menu.

21.4 Recorder.....
Accessing "Recorder" from the main menu allows you to make voice or sound recordings.

21.5 Tasks.....
Enables you to easily manage and track the progress of a task with priorities. All the tasks will be sorted by due date.

17

2 Getting started.....

2.1 Set-up

Removing or installing the back cover

Inserting or removing the SIM card
You must insert your SIM card to make phone calls. Please power off your phone and remove battery before inserting or removing the SIM card.

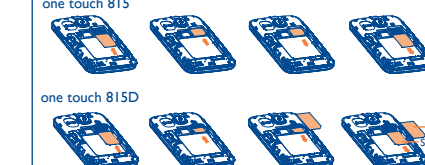

Place the SIM card with the chip facing downwards and slide it into its housing. Make sure that it is correctly inserted. To remove the card, press and slide it out.



Insert and click the battery into place, then close the telephone cover. Unclip the cover, then remove the battery.

8

3 Making a call.....

3.1 Power on your phone

Hold down the key until the telephone powers on.

3.2 Power off your phone

Hold down the key from the Home screen.

4 Menu arrange.....

It is designed to vary according to your preference.
Change the order
Access the main menu, focus on the main menu item you want to move, select "Options|Move", and tick "y" will be shown on the item you selected, then release it to your favorite destination.
Show/Hide
Access the main menu, select "Options|Add and remove menu", and select the left check box of the selected menu once to show/hide, and then select "Done" to save the operation.

5 Messages.....

You may access this menu using the following options:

- Access from the main menu by selecting "Messages".
- Select from widget bar, and then enter the sub-menu you require.

5.1 Access

5.2 Conversational On (Off) mode
In conversational on mode, you can view chat history in chronological order. In conversational off mode, you may have access to the following folders: **Inbox, Outbox, Sent, Drafts, Voicemail, Broadcast SMS, Empty folder, Archive, Templates, Settings.** Conversational view mode is set as default. You may switch to conventional mode by selecting "Options|Settings|Switch view mode".

5.2 Conversational On (Off) mode

Prolonged exposure to music at full volume on the music player may damage the listener's hearing. Set your phone volume safely. Use only headphones recommended by TCT Mobile Limited and its affiliates.

5.2 Conversational On (Off) mode

ALCATEL is a trademark of Alcatel-Lucent and is used under license by TCT Mobile Limited.
All rights reserved © Copyright 2012 TCT Mobile Limited.
TCT Mobile Limited reserves the right to alter material or technical specification without prior notice.

18



22 Settings



From the main menu, select the menu icon and select the function of your choice in order to customize your telephone: **Phone settings, Call settings, Security, Network, Connectivity, Restore default, Dual SIM switch, Dual SIM settings**⁽¹⁾.

23 Making the most of your mobile

PC suite

You can download PC Suite for free from the website (www.alcatelone-touch.com). The PC suite includes:

• Backup/restore

You can backup the important data in your mobile and restore them when needed.

• GPRS modem

Use your mobile phone to connect PC to the internet.

• Multimedia Personalization

Customize your mobile with images, animations and melodies.

• Messages

You can compose SMS/MMS easily on your PC and transfer them to your phone.

Supported Operating Systems

Windows XP/Vista/Windows 7.

ONE TOUCH Upgrade

Using ONE TOUCH Upgrade tool you can update your phone's software from your PC.

Download ONE TOUCH Upgrade from [ALCATEL ONE TOUCH website \(www.alcatelone-touch.com\)](http://ALCATELONE-TOUCH.COM) and install it on your PC. Launch the tool and update your phone by following the step by step instructions (refer to the User Guide provided together with the tool).

Your phone's software will now have the latest software.



All personal information will be permanently lost following the update process. We recommend you backup your personal data using PC Suite before upgrading.

Supported Operating Systems

Windows XP/Vista/Windows 7.

Webcam⁽¹⁾

You can use your phone as a webcam for instant messaging on your PC.

• Connect your phone to PC via USB cable.

• Go to **"My computer"** folder on your PC and find USB video device (Under Scanners & Cameras).

24 Latin input mode

There are two text entry methods that can be used to write messages:

- Normal: this mode allows you to type a text by choosing a letter or a sequence of characters.
- CooTek mode: this mode can perform predictive input in hardware keypad and supports multi-language input.

Keypad inputting:

Press to input capitalized characters

Press once: Input a top-half character

Press twice: Lock the keyboard in top-half key input mode

Press and hold: Input top-half characters only until key is released

Press: Delete one by one

Press and hold: Delete all

Press: Enter a space

Press and hold: Access language list

Press: Confirm an option

Enter the next line

Hold down Fn key, then press SYM key to enter symbol table

Safety and use.....

We recommend that you read this chapter carefully before using your mobile phone. The manufacturer disclaims any liability for damage, which may result as a consequence of improper use or use contrary to the instructions contained herein.

- TRAFFIC SAFETY:

Given that studies show that using a mobile phone while driving a vehicle constitutes a real risk, even when the hands-free kit is used (car kit, headset...), drivers are requested to refrain from using their mobile phone when the vehicle is not parked. Check the laws and regulations on the use of wireless mobile phones and their accessories in the areas where you drive. Always obey them. The use of these devices may be prohibited or restricted in certain areas.

When driving, do not use your mobile phone and headphone to listen to music or to the radio. Using a headphone can be dangerous and forbidden in some areas.

When switched on, your mobile phone emits electromagnetic waves that can interfere with the vehicle's electronic systems such as ABS anti-lock brakes or airbags. To ensure that there is no problem:

- do not place your mobile phone on top of the dashboard or within an airbag deployment area.
- check with your car dealer or the car manufacturer to make sure that the car's electronic devices are shielded from mobile phone RF energy.

• CONDITIONS OF USE:

You are advised to switch off the mobile phone from time to time to optimize its performance.

Remember to abide by local authority rules of mobile phone use on aircrafts.

Operational Warnings: Obey all posted signs when using mobile devices in public areas.

Follow Instructions to Avoid Interference Problems: Turn off your mobile device in any location where posted notices instruct you to do so. In an aircraft, turn off your mobile device whenever instructed to do so by airline staff. If your mobile device offers an airplane mode or similar feature, consult airline staff about using it in flight.

Switch the mobile phone off when you are in health care facilities, except in designated areas. As with many other types of equipment now in regular use, mobile phones can interfere with other electrical or electronic devices, or equipment using radio frequency.

Switch the mobile phone off when you are near gas or flammable liquids. Strictly obey all signs and instructions posted in a fuel depot, gas station, or chemical plant, or in any potentially explosive atmosphere.

When the mobile phone is switched on, it should be kept at least 15 cm from any medical device such as a pacemaker, a hearing aid or insulin pump. In particular when using the mobile phone you should hold it against the ear on the opposite side to the device, if any.

Read and follow the directions from the manufacturer of your implantable medical device. If you have any questions about using your mobile device with your implantable medical device, consult your healthcare provider.

To avoid hearing impairment, answer the call before holding your mobile phone to your ear. Also move the handset away from your ear while using the "hands-free" option because the amplified volume might cause hearing damage.

It is recommended to have proper supervision while small children use your mobile phone.

When replacing the cover please note that your mobile phone may contain substances that could create an allergic reaction.

Always handle your mobile phone with care and keep it in a clean and dust-free place.

Do not allow your mobile phone to be exposed to adverse weather or environmental conditions (moisture, humidity, rain, infiltration of liquids, dust, sea air, etc.). The manufacturer's recommended operating temperature range is -10°C (14°F) to +55°C (131°F) (the max value depends on device, materials and housing paint/texture).

Over 55°C (131°F) the legibility of the mobile phone's display may be impaired, though this is temporary and not serious.

Do not open or attempt to repair your mobile phone yourself.

Do not drop, throw or try to bend your mobile phone.

Do not point it.

Use only batteries, battery chargers, and accessories which are recommended by TCT Mobile Limited and its affiliates and are compatible with your mobile phone model. TCT Mobile Limited and its affiliates disclaim any liability for damage caused by the use of other chargers or batteries.

Your mobile phone should not be disposed of in a municipal waste. Please check local regulations for disposal of electronic products.

Remember to make back-up copies or keep a written record of all important information stored in your mobile phone.

Some people may suffer epileptic seizures or blackouts when exposed to flashing lights, or when playing video games. These seizures or blackouts may occur even if a person never had a previous seizure or blackout. If you have experienced seizures or blackouts, or if you have a family history of such occurrences, please consult your doctor before playing video games on your mobile phone or enabling a flashing-lights feature on your mobile phone.

Parents should monitor their children's use of video games or other features that incorporate flashing lights on the mobile phones. All persons should discontinue use and consult a doctor if any of the following symptoms occur: convulsion, eye or muscle twitching, loss of awareness, involuntary movements, or disorientation. To limit the likelihood of such symptoms, please take the following safety precautions:

- Play at the farthest distance possible from the screen.

When you play games on your mobile phone, you may experience occasional discomfort in your hands, arms, shoulders, neck, or other parts of your body. Follow these instructions to avoid problems such as tendonitis, carpal tunnel syndrome, or other musculoskeletal disorders:

- Take a minimum of a 15-minute break every hour of game playing.
- If your hands, wrists or arms become tired or sore while playing, stop and rest for several hours before playing again.
- If you continue to have sore hands, wrists, or arms during or after playing, stop the game and see a doctor.

Prolonged exposure to music at full volume using the music player may damage your hearing. Set your mobile phone's volume to it's lowest setting prior to inserting headphones in your ears and adjust the volume to your preference. Only use headphones that are recommended by TCT Mobile Limited and its affiliates.

• PRIVACY:

Please note that you must respect the laws and regulations in force in your jurisdiction or other jurisdiction(s) where you will use your mobile phone regarding taking photographs and recording sounds with your mobile phone. Pursuant to such laws and regulations, it may be strictly forbidden to take photographs and/or to record the voices of other people or any of their personal attributes, and reproduce or distribute them, as this may be considered to be an invasion of privacy.

It is the user's sole responsibility to ensure that prior authorization be obtained, if necessary, in order to record private or confidential conversations or take a photograph of another person; the manufacturer, the seller or vendor of your mobile phone (including the operator) disclaim any liability which may result from the improper use of the mobile phone.

• BATTERY AND ACCESSORIES:

Before removing the battery from your mobile phone, please make sure that the mobile phone is switched off.

Observe the following precautions for battery use:

- Do not attempt to open the battery (due to the risk of toxic fumes and burns).
- Do not puncture, disassemble or cause a short-circuit in a battery.
- Do not burn or dispose of a used battery in the garbage or store it at temperatures above 60°C (140°F).

Batteries must be disposed of in accordance with locally applicable environmental regulations. Only use the battery for the purpose for which it was designed. Never use damaged batteries or those not recommended by TCT Mobile Limited and/or its affiliates.

This symbol on your mobile phone, the battery and the accessories means that these products must be taken to collection points at the end of their life:

- Municipal waste disposal centers with specific bins for these items of equipment
- Collection bins at points of sale.

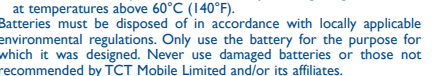

They will then be recycled, preventing substances being disposed of in the environment, so that their components can be reused.

In European Union countries:

These collection points are accessible free of charge. All products with this sign must be brought to these collection points.

In non European Union jurisdictions:

Items of equipment with this symbol are not to be thrown into ordinary bins if your jurisdiction or your region has suitable recycling and collection facilities; instead they are to be taken to collection points for them to be recycled.

In the United States you may learn more about CTIA's Recycling Program at www.recyclewirelessphones.com

CAUTION: RISK OF EXPLOSION IF BATTERY IS REPLACED BY AN INCORRECT TYPE. DISPOSE OF USED BATTERIES ACCORDING TO THE INSTRUCTIONS

• CHARGERS

Home A.C./Travel chargers will operate within the temperature range of: 0°C (32°F) to 40°C (104°F).

The chargers designed for your mobile phone meet with the standard for safety of information technology equipment and office equipment use. Due to different applicable electrical specifications, a charger you purchased in one jurisdiction may not work in another jurisdiction.

Your mobile phone is a radio transmitter and receiver. It is designed and manufactured not to exceed the emission limits for exposure to radio-frequency (RF) energy. These limits are part of comprehensive guidelines and establish permitted levels of RF energy for the general population. The guidelines are based on standards that were developed by independent scientific organizations through periodic and thorough evaluation of scientific studies. These guidelines include a substantial safety margin designed to ensure the safety of all persons, regardless of age and health.

The exposure standard for mobile phones employs a unit of measurement known as the Specific Absorption Rate, or SAR. The SAR limit set by public authorities such as the Federal Communications Commission of the US Government (FCC), or by Industry Canada, is 1.6 W/kg averaged over 1 gram of body tissue. Tests for SAR are conducted using standard operating positions with the mobile phone transmitting at its highest certified power level in all tested frequency bands.

Although the SAR is determined at the highest certified power level, the actual SAR level of the mobile phone while operating can be well below the maximum value. This is because the mobile phone is designed to operate at multiple power levels so as to use only the power required to reach the network. In general, the closer you are to a wireless base station antenna, the lower the power output of the mobile phone.

Before a mobile phone model is available for sale to the public, compliance with national regulations and standards must be shown.

The highest SAR value for this model mobile phone when tested is 0.758 W/kg for use at the ear and 1.111 W/kg for use close to the body.

While there may be differences between the SAR levels of various mobile phones and at various positions, they all meet the government requirement for RF exposure. For body-worn operation, the mobile phone meets FCC RF exposure guidelines provided that it is used with a non-metallic accessory with the handset at least 1.0 cm from the body. Use of other accessories may not ensure compliance with FCC RF exposure guidelines.

Additional information on SAR can be found on the Cellular Telecommunications & Internet Association (CTIA) Web site: <http://www.phonefacts.net>

The World Health Organization (WHO) considers that present scientific information does not indicate the need for any special precautions for use of mobile phones. If individuals are concerned, they might choose to limit their own or their children's RF exposure by limiting the length of calls, or using "hands-free" devices to keep mobile phones away from the head and body. (fact sheet n°193). Additional WHO information about electromagnetic fields and public health are available on the following website: <http://www.who.int/peh-emf>

Note: This equipment has been tested and found to comply with the limits for a Class B digital device pursuant to part 15 of the FCC Rules. These limits are designed to provide reasonable protection against harmful interference in a residential installation. This equipment generates, uses and can radiate radio frequency energy and, if not installed and used in accordance with the instructions, may cause harmful interference to radio communications. However, there is no guarantee that interference to radio or television reception, which can be determined by turning the equipment off and on, the user is encouraged to try to correct the interference by one or more of the following measures:

- Reorient or relocate the receiving antenna.
- Increase the separation between the equipment and receiver.
- Connect the equipment into an outlet on a circuit different from that to which the receiver is connected.
- Consult the dealer or an experienced radio/TV technician for help.

Changes or modifications not expressly approved by the party responsible for compliance could void the user's authority to operate the equipment.



For the receiver devices associated with the operation of a licensed radio service (e.g. FM broadcast), they bear the following statement: This device complies with Part 15 of the FCC Rules. Operation is subject to the condition that this device does not cause harmful interference.

For other devices, they bear the following statement: This device complies with Part 15 of the FCC Rules. Operation is subject to the following two conditions:

- (1) this device may not cause harmful interference
- (2) this device must accept any interference received, including interference that may cause undesired operation.

Your mobile phone is equipped with a built-in antenna. For optimal operation, you should avoid touching it or degrading it.

As mobile devices offer a range of functions, they can be used in positions other than against your ear. In such circumstances the device will be compliant with the guidelines when used with headset or usb data cable. If you are using another accessory ensure that whatever product is used is free of any metal and that it positions the mobile phone at least 1.5 cm away from the body.

• LICENCES

Obigo® is a registered trademark of Obigo AB. microSD Logo is a trademark.

The Bluetooth word mark and logos are owned by the Bluetooth SIG, Inc. and any use of such marks by TCT Mobile Limited and its affiliates is under license. Other trademarks and trade names are those of their respective owners.

ONE TOUCH 815/815D Bluetooth QD ID B020195

Java™ and all Java™ based trademarks and logos are trademarks or registered trademarks of Sun Microsystems, Inc. in the U.S. and other countries.

Facebook and the f Logo are trademarks of Facebook, Inc., and are used under license.

Twitter and the T Logo are trademarks of Twitter, Inc., and are used under license.

The Wi-Fi Logo is a certification mark of the Wi-Fi Alliance.

Your device uses non-harmonised frequency and is intended for use in all European countries. The WLAN can be operated in the EU without restriction indoors, but cannot be operated outdoors in France.

⁽¹⁾ one touch 815D only. 19

⁽¹⁾ The using of webcam may vary according to the operating system of your PC. 20

21

22

23

24

25

26

27

Hearing Aid Compatibility

Your mobile phone is rated: "For Hearing Aid", to assist hearing device users in finding mobile phones that may be compatible with their hearing devices.

This device is HAC M3 compatible.

For more information please refer to "Hearing Aid Compatibility with Mobile Phones" leaflet or visit our website <http://www.alcatelone-touch.com>

General information

- **Website:** www.alcatelone-touch.com
- **Facebook:** <http://www.facebook.com/alcatelone-touch>
- **Twitter:** <http://www.twitter.com/alcatelone-touch>
- **Hot Line Number:** In the United States, call 877-702-3444 for technical support.

On our Internet site, you will find our FAQ (Frequently Asked Questions) section. You can also contact us by e-mail to ask any questions you may have.

An electronic version of this user guide is available in English and other languages according to availability on our server: www.alcatelone-touch.com

Your mobile phone is a transceiver that operates on GSM in quad-band (850/900/1800/1900 MHz).

Protection against theft⁽¹⁾

Your mobile phone is identified by an IMEI (mobile phone serial number) shown on the packaging label and in the product's memory. We recommend that you note the number the first time you use your mobile phone by entering *#06# and keep it in a safe place. It may be requested by the police or your operator if your mobile phone is stolen.

Disclaimer

There may be certain differences between the user manual description and the mobile phone's operation, depending on the software release of your mobile phone or specific operator services.

TCT Mobile shall not be held legally responsible for such differences, if any, nor for their potential consequences, which responsibility shall be borne by the operator exclusively.

⁽¹⁾ Contact your network operator for service availability. 28

29

30

31

32

33

34

35

36