

# Quick Start Guide

Welcome! This manual brief is the profile of your HSPA USB-Modem, about the details of the management program (Dashboard) and safety using, please refers to appropriate User Manual. When you click “?” on the Dashboard, the User Manual will be displayed.

## 1. Getting to Know Your Modem

1. USB Interface
2. SIM/USIM Card Slot
3. Micro-SD Card Slot
4. Strap Hole
5. Indicator LED

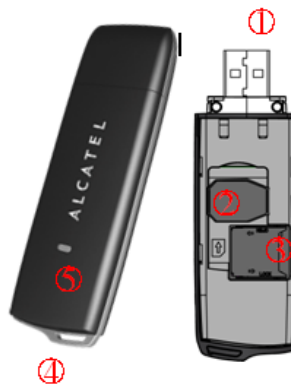

## 2. How to start your modem

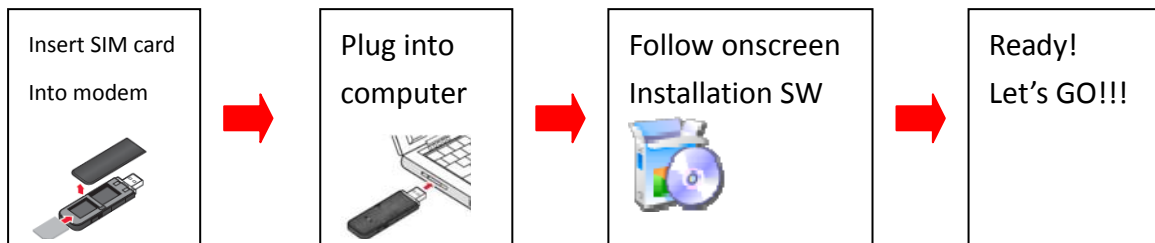

Note:

1. You can get detail installation guide information in User Manual (PDF version). Once software has been installed, the HSPA USB modem will start automatically. If installation “auto-run” does not begin, you will

need to Double-Click the “ HSPA USB MODEM” icon in device path of “My Computer” to run the installation manually.

## 3. LED Indicates

(Following table are listed the LED Indicates for each status.)

LED Indicator	Description
Flashing Green & Red multicolor circularly	Network Searching

Quickly Flashing Green & Red multicolor circularly	Out of order
Green Light Slow Flashing	Registering into HSPA or UMTS network
Constant Green Light	Registered to HSPA or UMTS network
Red Light Slow Flashing	Registering into GPRS or EDGE network
Constant Red Light	Registered to GPRS or EDGE network

## 4. Safety and Use

We recommend that you read this chapter carefully before using the HSPA USB-Modem. The manufacturer disclaims any liability for damage, which may result as a consequence of improper use of the HSPA USB-Modem or of use contrary to the instructions contained herein.

### Traffic Safety

When driving, do not use the HSPA USB-Modem

- ✧ When switched on, the HSPA USB-Modem emits electromagnetic waves that can interfere with the vehicle's electronic systems such as ABS anti-lock brakes or airbags. To ensure that there is no problem, do not place the HSPA USB-Modem on top of the dashboard or within an airbag deployment area.
- ✧ Check with your car dealer or the car manufacturer to make sure that the dashboard is adequately shielded from modem RF energy.

### Conditions of Use

- Switch the HSPA USB-Modem off before boarding an aircraft.
- Switch the HSPA USB-Modem off when you are in health care facilities, except in designated areas. As with many other types of equipment now in regular use, the HSPA USB- can interfere with other electrical or electronic devices, or equipment-using radio frequencies.
- Switch the HSPA USB-Modem off when you are near gas or flammable liquids. Strictly obey all signs and instructions posted in a fuel depot, petrol station, chemical plant, or in any potentially explosive atmosphere.
- When the HSPA USB-Modem is switched on, it should be kept at least 15 cm from any medical device such as a pacemaker, a hearing aid or insulin pump, etc.
- Do not let children use the HSPA USB-Modem without supervision.
- When replacing the cover, please note that the HSPA USB-Modem may contain substances that could create an allergic reaction.
- Always handle the HSPA USB-Modem with care and keep it in a clean and dust-free place.
- Do not allow the HSPA USB-Modem to be exposed to adverse weather or environmental conditions (moisture, humidity, rain, infiltration of liquids, dust, sea air, etc). The manufacturer's recommended operating temperature range is -10°C to +50°C.
- Do not open, dismantle or attempt to repair the HSPA USB-Modem yourself.
- Do not drop, throw or bend the HSPA USB-Modem.

- Do not paint it.

## WEEE Approval

The HSPA USB-Modem is in compliance with the essential requirements and other relevant provisions of the Waste Electrical and Electronic Equipment Directive 2002/96/EC (WEEE Directive).

## RoHs Approval

The HSPA USB-Modem is in compliance with the restriction of the use of certain hazardous substances in electrical and electronic equipment Directive 2002/95/EC (RoHs Directive).

## Radio Waves

Proof of compliance with international standards (ICNIRP)<sup>(1)</sup> or with European Directive 1999/5/EC (R&TTE) is required of all modem models before they can be put on the market. The protection of the health and safety for the user and any other person is an essential requirement of these standards or this directive.

This HSPA USB-MODEM complies with international and European requirements regarding exposure to radio waves

The HSPA USB-Modem is a radio transmitter/receiver. It was designed and manufactured to comply with the radiofrequency (RF) exposure thresholds recommended by international requirements (ICNIRP) and by the Council of the European Union (Recommendation 1999/519/EC)<sup>(2)</sup>.

These limits are part of a set of requirements and establish authorized radiofrequency levels for the public. These limits were established by independent groups of experts on the basis of regular and detailed scientific assessments. They include a significant safety margin intended to ensure the safety of all, regardless of age or state of health.

The exposure standard for modems is determined by a measurement unit known as the Specific Absorption Rate or "SAR". The SAR limit is set by international requirements or by the Council of the European Union at 2 watts/kilogram (W/kg) averaged over 10 grams of body tissue.

The tests used to determine SAR levels were carried out on the basis of standard usage modes with the modems phones transmitting at their maximum power level over the entire range of frequency bands.

Although the SAR was established at the highest certified level, the actual SAR level for the modems during use is generally much lower than the maximum values. In fact, since modems are designed to operate at many different power levels, they only use the minimum level of power required to provide a connection to the network. In theory, the closer you are to a base station antenna, the lower the power level required by the modem.

<sup>(1)</sup> **The ICNIRP** requirements are applicable in the following regions: Central America (except Mexico), South America, North and South Africa, Pacific Asia (except Korea), Australia.

<sup>(2)</sup> **The European recommendation** (1999/519/EC) is applicable in the following regions: Europe, Israel.

The highest SAR value reported under this standard during product certification for use when properly worn on the body is 0.783W/kg.

This device complies with part 15 of the FCC rules. Operation is subject to the following two conditions: (1) this device may not cause harmful interference, and (2) this device must accept any interference received, including interference that may cause undesired operation.

NOTE: The manufacturer is not responsible for any radio or TV interference caused by unauthorized modifications to this equipment. Such modifications could void the user's authority to operate the equipment.

NOTE: This equipment has been tested and found to comply with the limits for a Class B digital device, pursuant to part 15 of the FCC Rules. These limits are designed to provide reasonable protection against harmful interference in a residential installation. This equipment generates uses and can radiate radio frequency energy and, if not installed and used in accordance with the instructions, may cause harmful interference to radio communications. However, there is no guarantee that interference will not occur in a particular installation. If this equipment does cause harmful interference to radio or television reception, which can be determined by turning the equipment off and on, the user is encouraged to try to correct the interference by one or more of the following measures:

- Reorient or relocate the receiving antenna.
- Increase the separation between the equipment and receiver.
- Connect the equipment into an outlet on a circuit different from that to which the receiver is connected.
- Consult the dealer or an experienced radio/TV technician for help

The World Health Organization (WHO) considers that present scientific information does not indicate the need for any special precautions for use of modems. If individuals are concerned, they might choose to limit their own or their children's RF exposure by limiting the length of calls, or using "hands-free" devices to keep modems away from the head and body (fact sheet n° 193). Additional information about electromagnetic fields and public health are available on the following site: <http://www.who.int/peh-emf>.

Although no danger relating to the use of modems was ever proved, the World Health Organization advises as a precautionary measure to use modems with a good level of network reception as indicated on the HSPA USB-Modem software display (4 to 5 bars). It is also advised to keep the modem, during communications, away from the belly of pregnant women and from the lower abdomen for teenagers.

The HSPA USB-Modem is equipped with a built-in antenna. For optimal operation, you should avoid touching it or degrading it.

**CE 0700**

This equipment is in compliance with the essential requirements and other relevant provisions of Directive 1999/5/EC. The entire copy of the Declaration of Conformity for your telephone can be obtained through our

Website: [www.alcatelonetouch.com](http://www.alcatelonetouch.com).