

# Antenna Gain test report

FCC ID: R9C-CPH2565

Equipment: Smart Phone

Brand Name: OPPO

Model Name: CPH2565

Manufacturer: Guangdong OPPO Mobile

Telecommunications Corp., Ltd.

NO.18 Haibin Road, Wusha Village,

Chang'an Town, Dongguan City,

Guangdong, China

Issue Date: Apr 6, 2023

## Antenna Location:

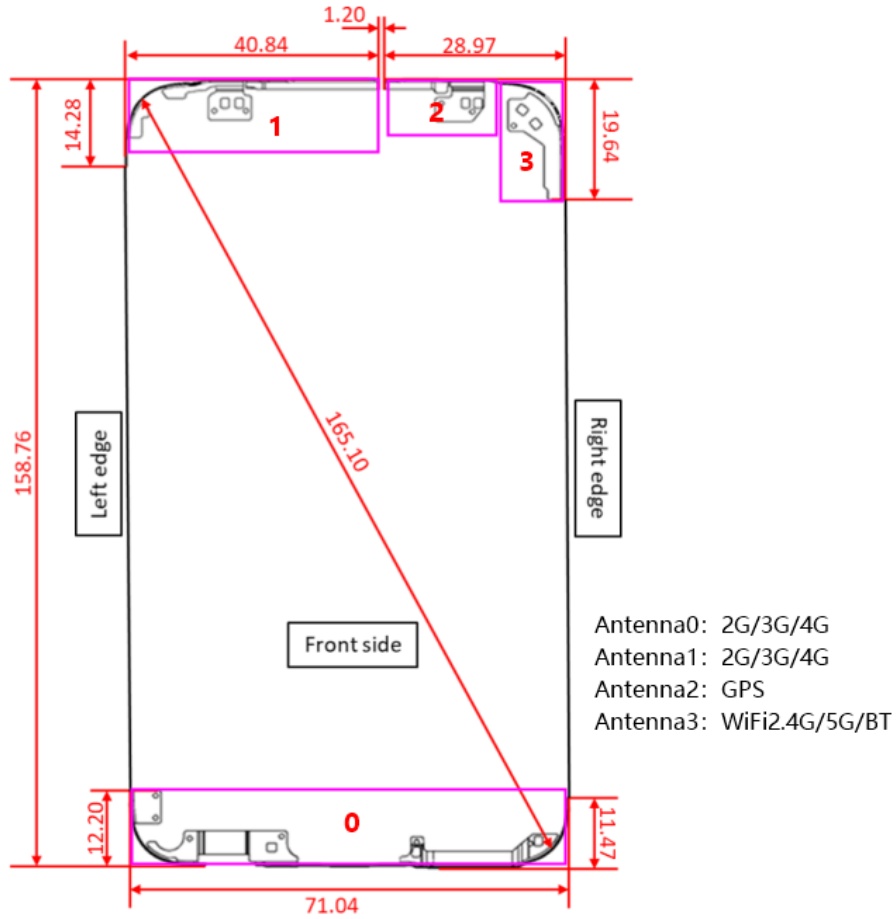

| Antenna | Support bands   |
|---------|---|
| Ant 0   | GSM:850/900/1800/1900<br>3G:WCDMA B1/2/4/5/8/6/19<br>4G:B1/2/3/4/5/26/18/19/7/8/12/17/13/28/66/38/40/41 |
| Ant 1   | GSM:850/900/1800/1900<br>3G:WCDMA B1/2/4/5/8/6/19<br>4G:B1/2/3/4/5/26/18/19/7/8/12/17/13/28/66/38/40/41 |
| Ant 2   | GPS   |
| Ant 3   | wifi 2.4/5G/BT  |

**Antenna Gain and Antenna Type specification:**

Note: Antenna gain was measured in the anechoic chamber, 3D scan was exercised, and the highest numbers are reported in this document

| Antenna Gain (dBi) |                 | Ant 0 | Ant 1 | Ant 2 | Ant 3 | Ant 4 | Ant 5 | Antenna Type   |
|--------------------|-----------------|-------|-------|-------|-------|-------|-------|----------------|
| GSM 850            | 824 - 849 MHz   | -4.31 | -5.53 |       |       |       |       | Fixed Internal |
| GSM 900            | 880 - 915 MHz   | -5.04 | -5.03 |       |       |       |       | Fixed Internal |
| DCS 1800           | 1710 - 1785 MHz | -2.42 | -0.91 |       |       |       |       | Fixed Internal |
| PCS 1900           | 1850 - 1910 MHz | -1.76 | 0.09  |       |       |       |       | Fixed Internal |
| WCDMA band 1       | 1920 - 1980 MHz | -2.28 | 0.91  |       |       |       |       | Fixed Internal |
| WCDMA band 2       | 1850 -1910 MHz  | -1.76 | 0.09  |       |       |       |       | Fixed Internal |
| WCDMA band 4       | 1710 -1755MHz   | -2.42 | -0.91 |       |       |       |       | Fixed Internal |
| WCDMA band 5       | 824 - 849MHz    | -4.31 | -5.53 |       |       |       |       | Fixed Internal |
| WCDMA band 6       | 830 - 840 MHz   | -4.31 | -5.53 |       |       |       |       | Fixed Internal |
| WCDMA band 8       | 880 - 915 MHz   | -5.04 | -5.03 |       |       |       |       | Fixed Internal |
| WCDMA band 19      | 830 - 845 MHz   | -4.31 | -5.53 |       |       |       |       | Fixed Internal |
| LTE band 1         | 1920 - 1980 MHz | -2.28 | 0.907 |       |       |       |       | Fixed Internal |
| LTE band 2         | 1850 - 1910 MHz | -1.76 | 0.09  |       |       |       |       | Fixed Internal |
| LTE band 3         | 1710 - 1785 MHz | -2.42 | -0.91 |       |       |       |       | Fixed Internal |
| LTE band 4         | 1710 - 1755 MHz | -2.42 | -0.91 |       |       |       |       | Fixed Internal |

|             |                 |       |       |  |  |  |  |                |
|-------------|-----------------|-------|-------|--|--|--|--|----------------|
| LTE band 5  | 824 - 849 MHz   | -4.31 | -5.53 |  |  |  |  | Fixed Internal |
| LTE band 7  | 2500 - 2570 MHz | -0.66 | 0.405 |  |  |  |  | Fixed Internal |
| LTE band 8  | 880 - 915 MHz   | -5.04 | -5.03 |  |  |  |  | Fixed Internal |
| LTE band 12 | 699 - 716 MHz   | -4.3  | -6.9  |  |  |  |  |                |
| LTE band 13 | 777 - 787 MHz   | -4.3  | -6.9  |  |  |  |  | Fixed Internal |
| LTE band 17 | 704 - 716 MHz   | -4.3  | -6.86 |  |  |  |  | Fixed Internal |
| LTE band 18 | 815 - 830 MHz   | -4.31 | -5.53 |  |  |  |  | Fixed Internal |
| LTE band 19 | 830 - 845 MHz   | -4.31 | -5.53 |  |  |  |  | Fixed Internal |
| LTE band 20 | 832 - 862 MHz   |       |       |  |  |  |  | Fixed Internal |
| LTE band 26 | 814 - 849 MHz   | -4.31 | -5.53 |  |  |  |  | Fixed Internal |
| LTE band 28 | 703 - 748 MHz   | -4.3  | -6.86 |  |  |  |  | Fixed Internal |
| LTE band 38 | 2570 - 2620 MHz | -1.18 | 0.26  |  |  |  |  | Fixed Internal |
| LTE band 39 | 1880 - 1920 MHz |       |       |  |  |  |  | Fixed Internal |
| LTE band 40 | 2300 - 2400 MHz | -1.56 | 2.06  |  |  |  |  | Fixed Internal |
| LTE band 41 | 2496 - 2690 MHz | -1.18 | 0.26  |  |  |  |  | Fixed Internal |
| LTE band 66 | 1710 - 1780 MHz | -2.42 | -0.91 |  |  |  |  | Fixed Internal |



# 3D Pattern

2400M(Frequency=2412M)

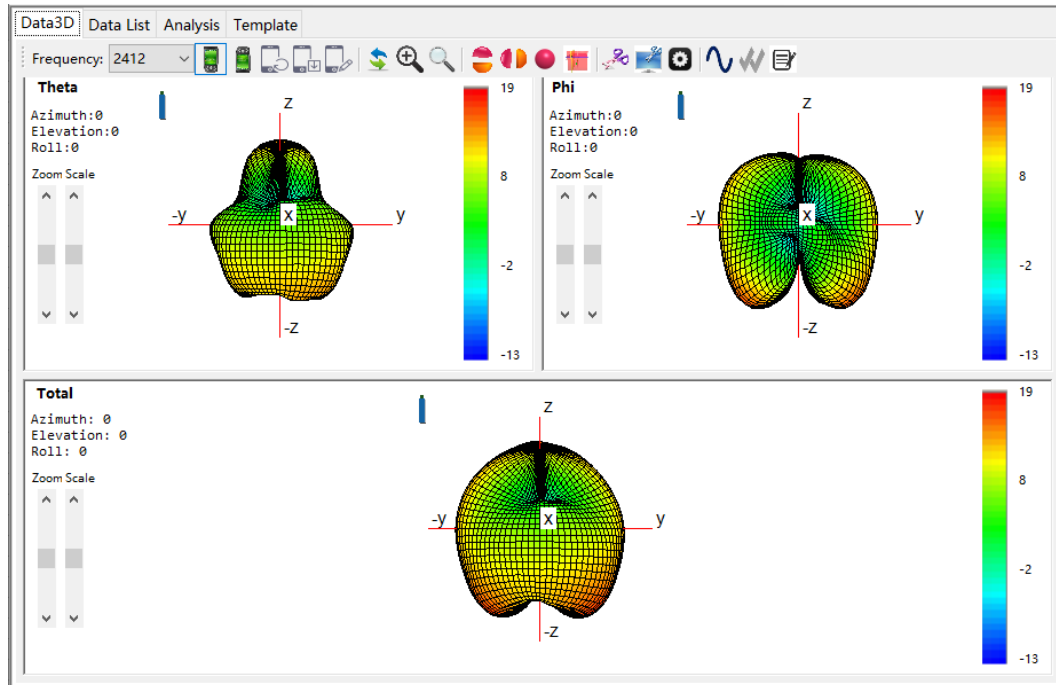

2400M(Frequency=2442M)

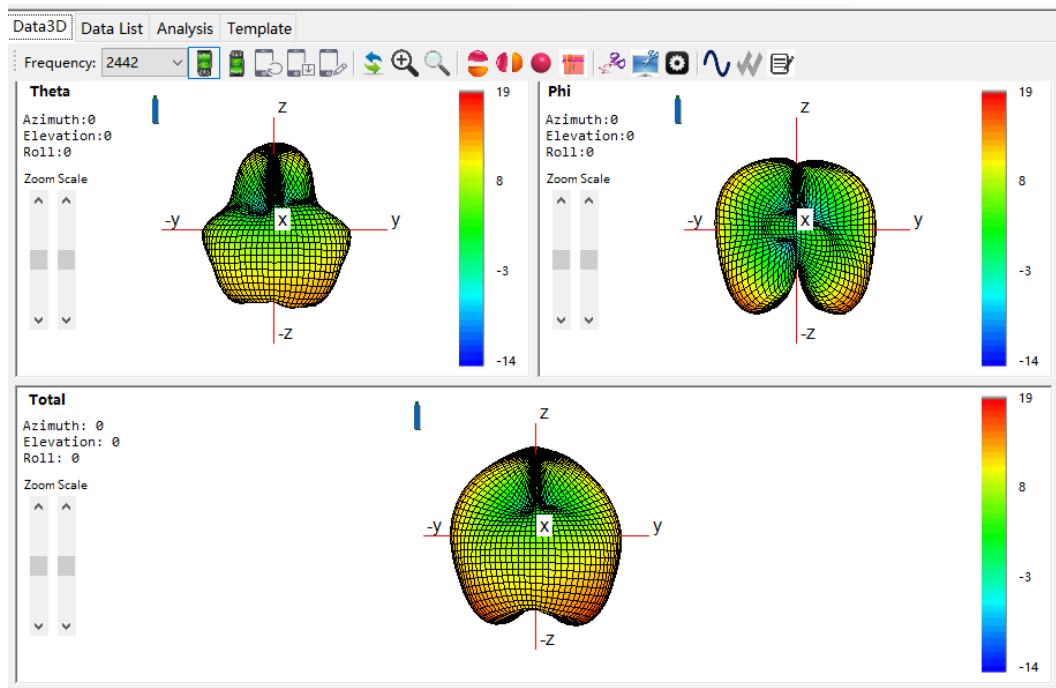

2400M(Frequency=2472M)

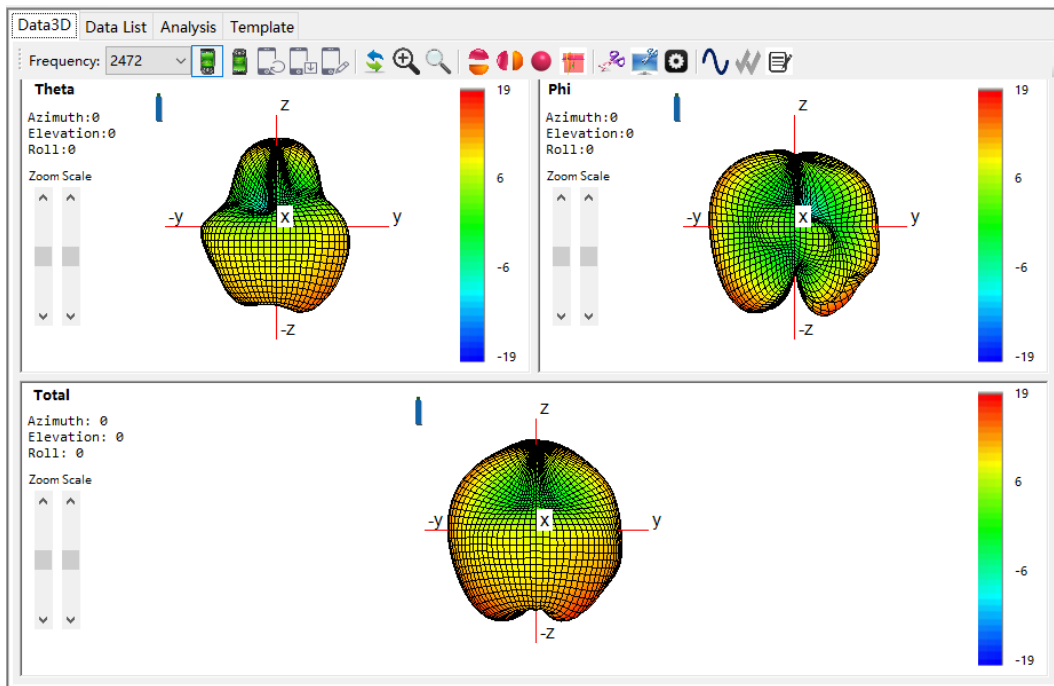

5000M(Frequency=5200M)

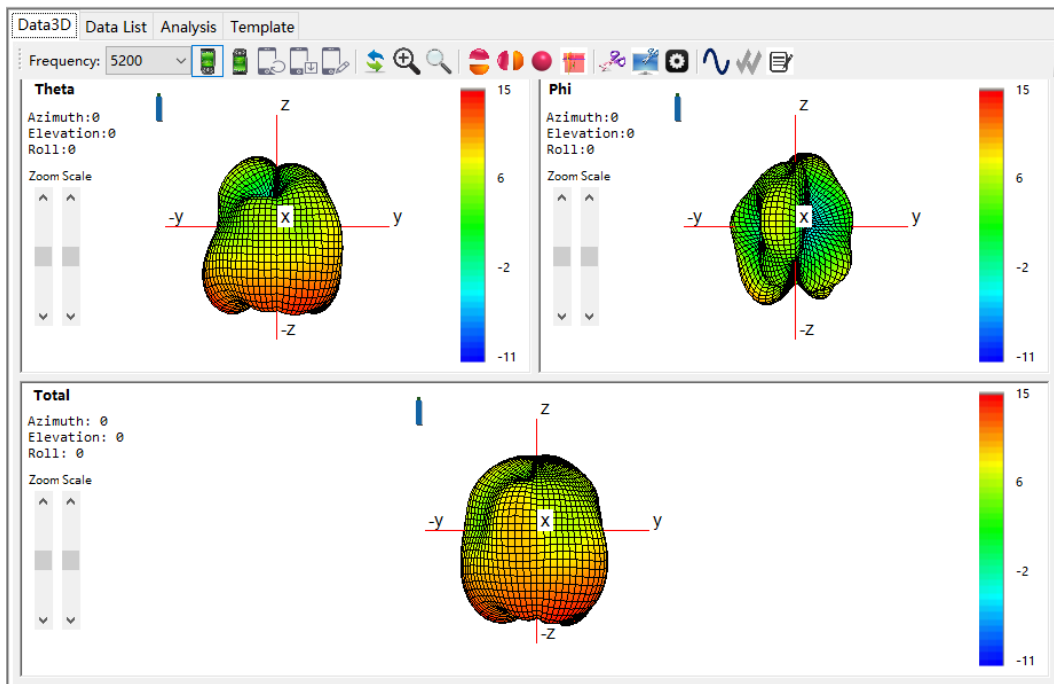



5000M(Frequency=5745M)

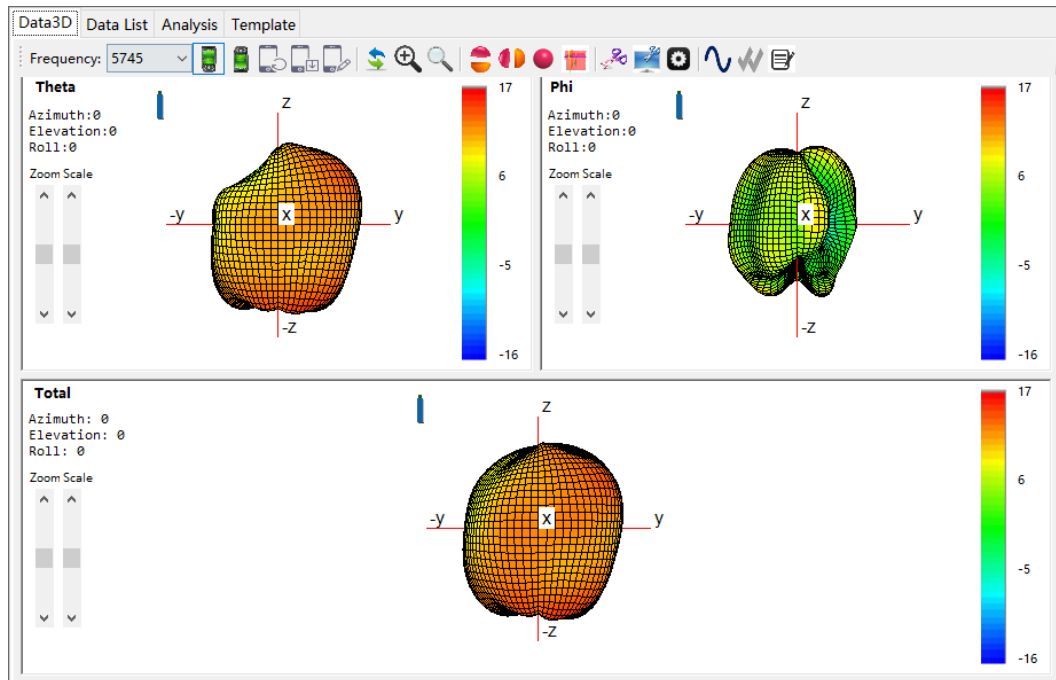

5000M(Frequency=5785M)

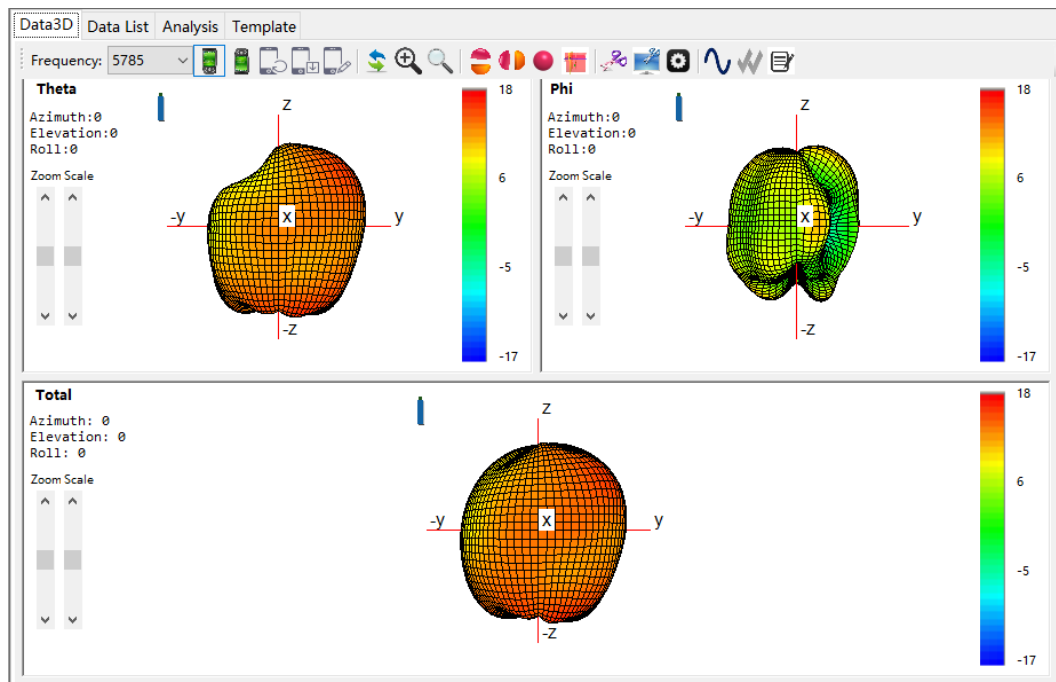

5000M(Frequency=5825M)

