

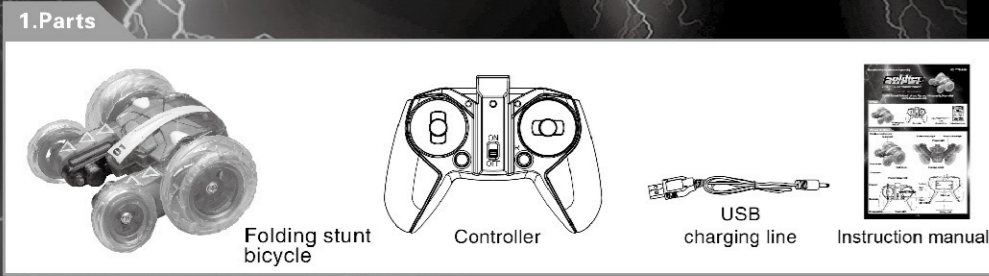

COOL STYLING STRONG POWER

DOUBLE-SIDED RUNNING

Function: Forward, Backward, Left turn, Right turn, 360 degrees flip, Double-sided running, Demonstration, light.

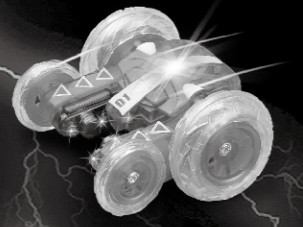

2. Name of fittings

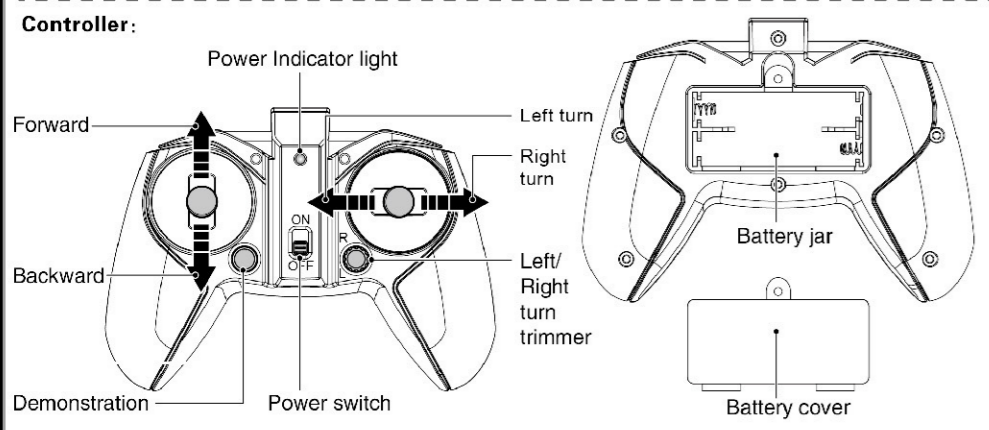
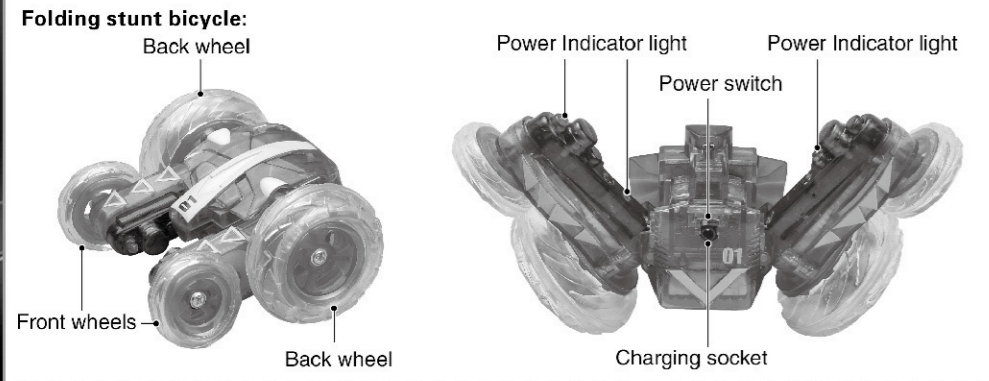

3. Installation and recharging of the remote control batteries

- Unscrew the screw on the back of the controller, install 2x1.5 "AAA" batteries with the correct polarity, and tighten the screw.
- Charge with the USB cable.
 - Insert the USB Cable to the computer socket.
 - Connect the USB cable to the charging port of the stunt four-wheeler. USB lights ON during charging & USB lights OFF when finish charging.
 - Charging time via this USB cable is about 15 minutes. Stunt Four-wheeler running time is about 8 minutes.

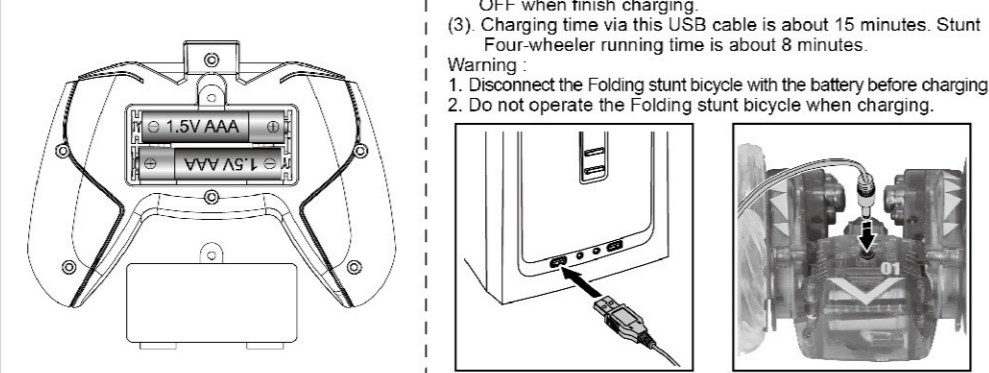

4. Control methods

Turn on the power: Turn "ON" the Folding stunt bicycle, and then turn "ON" the controller, the Folding stunt bicycle and the remote control will start matching code, and the product indicator will change to constant light. By this time, code matching is successfully done. (When many cars play together, you can finish frequency one by one.)

Control distance: The longest distance is above 20 meters but beyond this it may affect the sensibility of the operation.

Running time: more than 8 minutes when fully charged

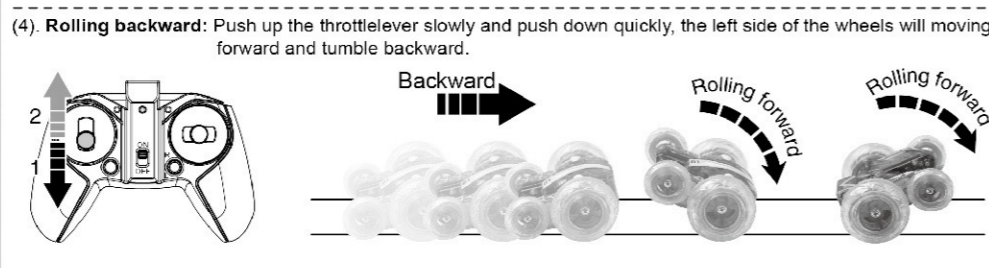
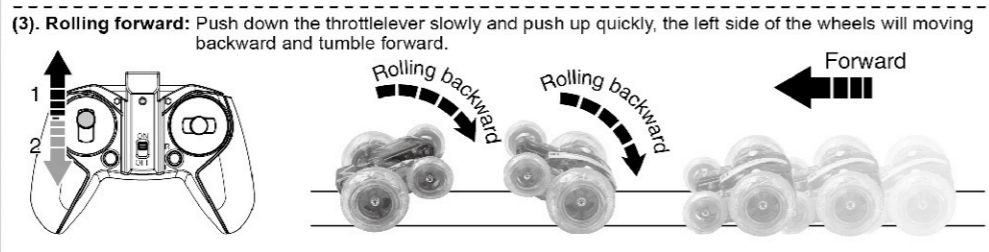
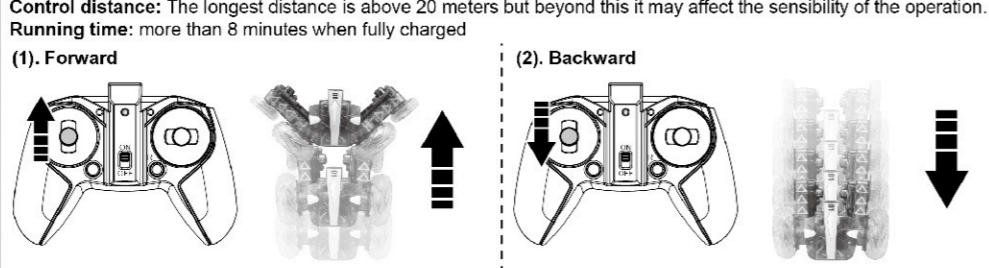

5. Demo button

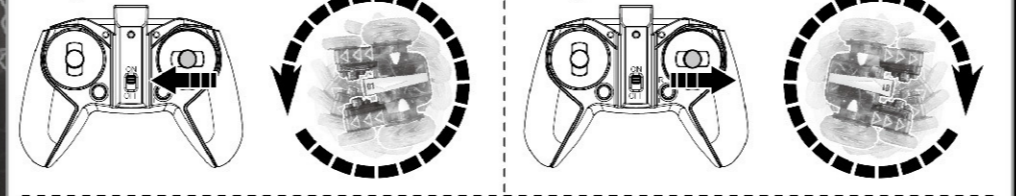

6. Left/Right turn trimmer



(7). Vertical rotation in the clockwise direction

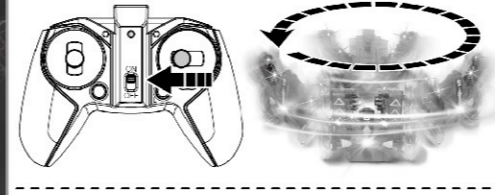

(8). Vertical rotation in the counter-clockwise direction

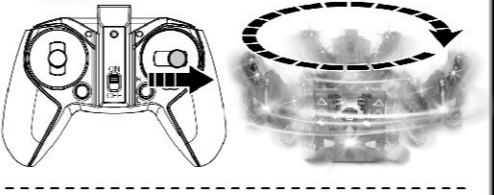

(9). Forward and turn left

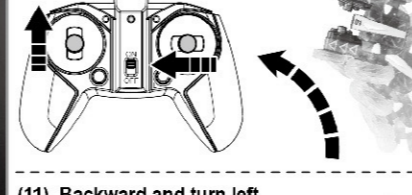

(10). Forward and turn right

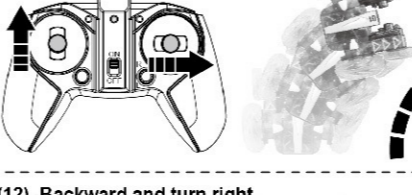

(11). Backward and turn left

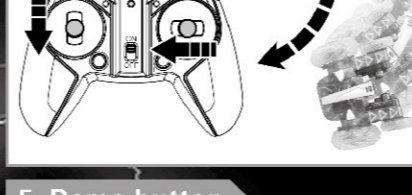

(12). Backward and turn right



5. Demo button

Folding stunt bicycle possesses the function of automatic demonstration. Press the "demo" button on the remote control and Folding stunt bicycle will automatically present its functions such as moving forward/backward, turning left/right, rotating and rolling. Press the "demo" button on the remote control again or push the control lever and the car drops out of demonstration mode.



6. Left/Right turn trimmer

- If the remote control car turns left while moving forward without touching the right control lever, rotate the fine-tuning knob of the remote control clockwise until the car go straight.
- If the remote control car turns right while moving forward without touching the right control lever, twist the fine-tuning knob of the remote control anticlockwise until the car go straight.

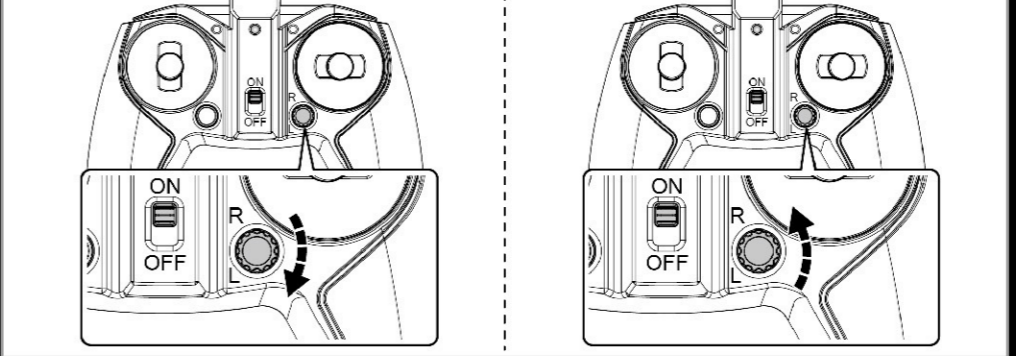

7. Notice

- Non-rechargeable batteries are not to be recharged.
- Rechargeable batteries are only to be charged under adult supervision.
- Different types of batteries or new and used batteries are not to be mixed.
- Please take out batteries when running low on power.
- The supply terminals are not to be short-circuited.
- Please do not throw the battery pack into fire or decomposition in the water to avoid accidents.
- Check the toy regularly; make sure the toy is in good shape.
- Please take note on the polarity when install or replace the battery.
- Folding stunt bicycle uses a set of 3.7V 90mAh rechargeable batteries. Remote control uses 2x1.5V "AAA" batteries.

8. Maintenance

- Wipe the toy gently with clean damp cloth.
- Do not insolation on sun and calefaction for a long time.
- Turn off the power of the controller and the remote control car when not in use.
- Remove battery from the controller when not used for a long time.
- New 1.5V "AAA" alkaline batteries for the remote control car to obtain best and maximum performance.
- Check the toy regularly; make sure the toy is in good shape.

9. Problem - Solving

Symptom	Cause	Correction
Wheels can't move.	<ul style="list-style-type: none"> ON/OFF switch is "OFF". Weak battery. 	<ul style="list-style-type: none"> Set switch to "ON". Install new battery or charge the battery.
Suddenly stop.	<ul style="list-style-type: none"> Weak power. 	<ul style="list-style-type: none"> Install new battery or charge the battery.
Controller Indicator light coruscate	<ul style="list-style-type: none"> Weak power. 	<ul style="list-style-type: none"> Install new battery

changes or modifications not expressly approved by the party responsible for compliance could void the user's authority to operate the equipment.

This equipment has been tested and found to comply with the limits for a Class B digital device, pursuant to Part 15 of the FCC Rules. These limits are designed to provide reasonable protection against harmful interference in a residential installation. This equipment generates, uses and can radiate radio frequency energy and, if not installed and used in accordance with the instructions, may cause harmful interference to radio communications. However, there is no guarantee that interference will not occur in a particular installation.

If this equipment does cause harmful interference to radio or television reception, which can be determined by turning the equipment off and on, the user is encouraged to try to correct the interference by one or more of the following measures:

- Reorient or relocate the receiving antenna.
- Increase the separation between the equipment and receiver.
- Connect the equipment into an outlet on a circuit different from that to which the receiver is connected.
- Consult the dealer or an experienced radio/TV technician for help.