

2.4G-4CH Radio Control Quad-copter

SKY PHANTOM

EASY MANIPULATED (Instruction manual)

For Indoor & Outdoor
Collapsible / Hobby Style

Built-in gyroscope
2.4GHz remote Control

1. Parts

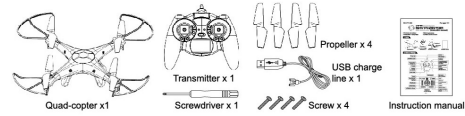

2. Name of fittings

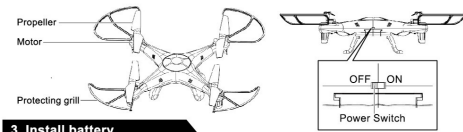
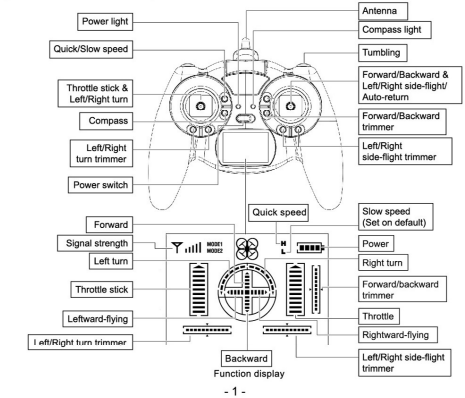

3. Install battery

Open the battery cover and insert 5*1.5 AA batteries (Batteries are not included) (Pic.1)

- NOTICE:**
- Do not mix new and old batteries.
 - Do not mix different types of batteries.

4. USB charge (Pic.2)

- Insert the USB Cable to the computer socket.
- Connect the USB cable to the charging port of the Quad-copter. USB lights ON during charging & USB lights OFF when finish charging.
- Charging time via this USB cable is about 100 minutes. Quad-copter flying time is about 6 minutes.

Warning :

- Turn "OFF" the Quad-copter during charging.
- Do not operate the Quad-copter when charging.

5. Environment for flight

Please be sure that without obstacles, animal and people around during fly.
Note: • Please make sure the ambiances before fly. • Child playing must be guided by adult.
• Do not control the Quad-copter out of sight. • For indoor and outdoor use.

6. Ready to fly (Pic.3)

- Put the Quad-copter on a flat surface. Turn "ON" the Quad-copter, and then turn "ON" the controller, the Quad-copter and the remote control will start matching code, then you will hear two continuous beeps, and the product indicator will change from quick flash to slow flash. Push up the accelerator and then push it down to the bottom, you will find the flashing red light on the right side of the controller will be off, by this time, code matching is successfully done.
- Make sure the Quad-copter is far away from crowd, animals and other obstructions.

NOTICE: 1. While the indicator of the controller is flashing which means the controller is lack of power and need to change new batteries.
2. Flip is disabled when the quad-copter is under low-voltage while the indicator of the quad-copter will flashing fast.

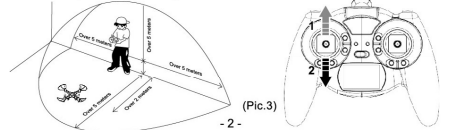

7. Control methods

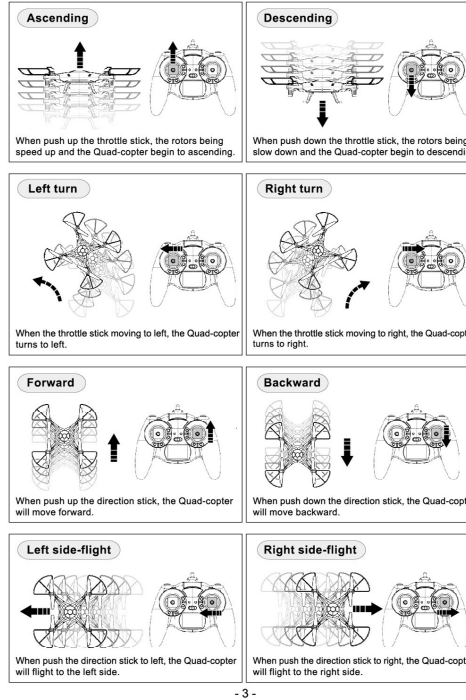

8. 360° flip

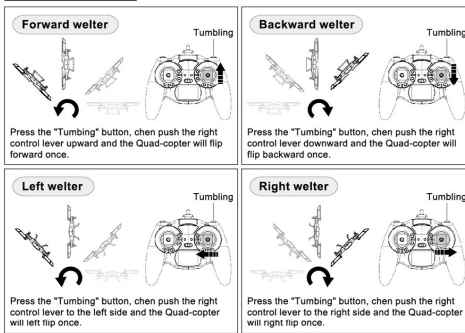

9. Headless Mode

Put the Quad-copter on a flat surface. Turn "ON" the Quad-copter, then turn "ON" the controller. Push up the accelerator and then push it down to the bottom and then press "Headless Mode" button, you will hear continuously "di-di-di", and the indicator change to slowly flashing while the Compass light is on, that means headless mode has been successfully set. Press again the "headless" button to cancel the headless mode.

- NOTICE:**
- In the Normal Mode, the red light of the Quad-copter is Forward direction, green light is backward direction.
 - In headless mode, the direction of the red light pointed is the FORWARD direction.
 - In the Headless Mode, the Quad-copter indicator will flash slowly.
 - If headless mode setting is failed or the Quad-copter has been crashed, it may appears deviation, please re-start the Quad-copter.

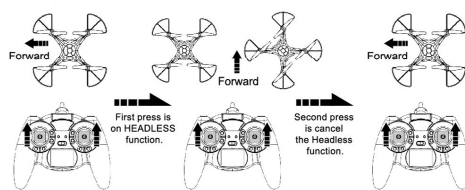

10. Auto-return

Press down the "Auto-return" button and the Quad-copter will fly back automatically. In order to avoid potential accidents, make sure there are no obstacles around when using this function.

11. Quick/slow gear key

There are quick/slow gears on this product. Slow gear is suitable for the new learner. Quick gear is suitable for the professionals. When the controller is switched on, the defaulted state is in slow gear.

12. Special note

Slowly raise up the throttle stick and let the Quad-copter lift-off the ground, you can use the trimmer to adjust the direction if the Quad-copter leans in a different direction.

- Left/Right Turn Trimmer**
When the Quad-copter leans right, adjust the trimmer to the left side. When the Quad-copter leans left, adjust the trimmer to the right side.
- Forward/Backward Trimmer**
When the Quad-copter leans forward, adjust the trimmer to down. When the Quad-copter leans backward, adjust the trimmer to up.

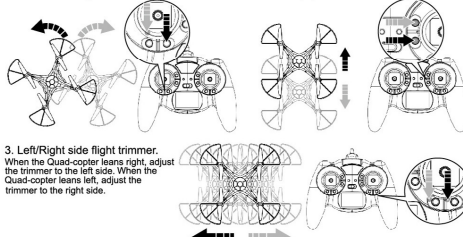

- Left/Right side flight trimmer**
When the Quad-copter leans right, adjust the trimmer to the left side. When the Quad-copter leans left, adjust the trimmer to the right side.
- Calibration**
Turn on the Quad-copter and the remote control to start code matching. To check the connection, slowly push up the accelerator, if the blades are spinning normally, means code matching is successful. Then push down the accelerator to the bottom. Pull the accelerator on the left side of the controller to the lower left corner and pull the accelerator on the right side of the controller to the lower right corner, the indicator of the Quad-copter and the indicator on the controller will flashing quickly, and you will hear a sound of "DI", at this time, the indicator of the Quad-copter will change to constant light on. Pull the accelerator back to the position and correction is done.

13. Problems and Solutions

PROBLEM	CAUSE	SOLUTION
Controller doesn't work.	• Power switch is "OFF". • Insert batteries into controller improperly. • Batteries lack of power.	• Turn the power switch to "ON". • Confirm batteries are inserted correctly. • Change new batteries instead.
Can not control the Quad-copter.	• Power switch is "OFF". • You play the Quad-copter in strong winds weather.	• Turn the power switch to "ON". • Do not play in big windy place, it would make it out of control.
Quad-copter can not rise.	• Main rotor blades rotate too slowly. • Doesn't fully charge the battery.	• Pull up the throttle stick. • Fully charge the battery.
Quad-copter landed too fast.	• Pull down the throttle stick too fast.	• Slowly pull down the throttle stick till Quad-copter landing smoothly.

14. Caution

- The control distance will be shorter when battery is weak.
- The Quad-copter would not fly enough high, when lack of battery.
- If the rotor become damaged or broken, do not fly, otherwise, it will lead to injury.
- If you don't use for a long time, remove all batteries out from the controller, in order to avoid the battery leakage to damage the product.
- Don't drop the Quad-copter from high position or crash, to avoid damage it.
- The biggest control radius of the Quad-copter is 50 meters, please uses in 50 meters area, otherwise it will be out of control when it overstep this area.
- Rechargeable batteries are only to be charged under adult supervision.
- Different types of batteries or new and used batteries are not to be mixed.
- Batteries are to be inserted with the correct polarity.
- Exhausted batteries are to be remove from the toy.
- The supply terminals are not to be short-circuited.
- If the Quad-copter become damaged, deformation, please repaired in time.

FCC
Caution: The user is cautioned that changes or modifications not expressly approved by the party responsible for compliance could void the user's authority to operate the equipment.
This device complies with Part 15 of the FCC Rules. Operation is subject to the following two conditions: (1) this device may not cause harmful interference, and (2) this device must accept any interference received, including interference that may cause undesired operation.
NOTE: This equipment has been tested and found to comply with the limits for a Class B digital device, pursuant to part 15 of the FCC Rules. These limits are designed to provide reasonable protection against harmful interference to radio communications. However, there is no guarantee that interference will not occur in a particular installation.
If this equipment does cause harmful interference to radio or television reception, which can be determined by turning the equipment off and on, the user is encouraged to try to correct the interference by one or more of the following measures:
-- Reorient or relocate the receiving antenna.
-- Increase the separation between the equipment and receiver.
-- Connect the equipment into an outlet on a circuit different from that to which the receiver is connected.
-- Consult the dealer or an experienced radio/television technician for help.
FCC Radiation Exposure Statement:
This equipment complies with FCC radiation exposure limits set forth for an uncontrolled environment. This transmitter must not be co-located or operating in conjunction with any other antenna or transmitter.