

Remote Control User Guide

Button function explained

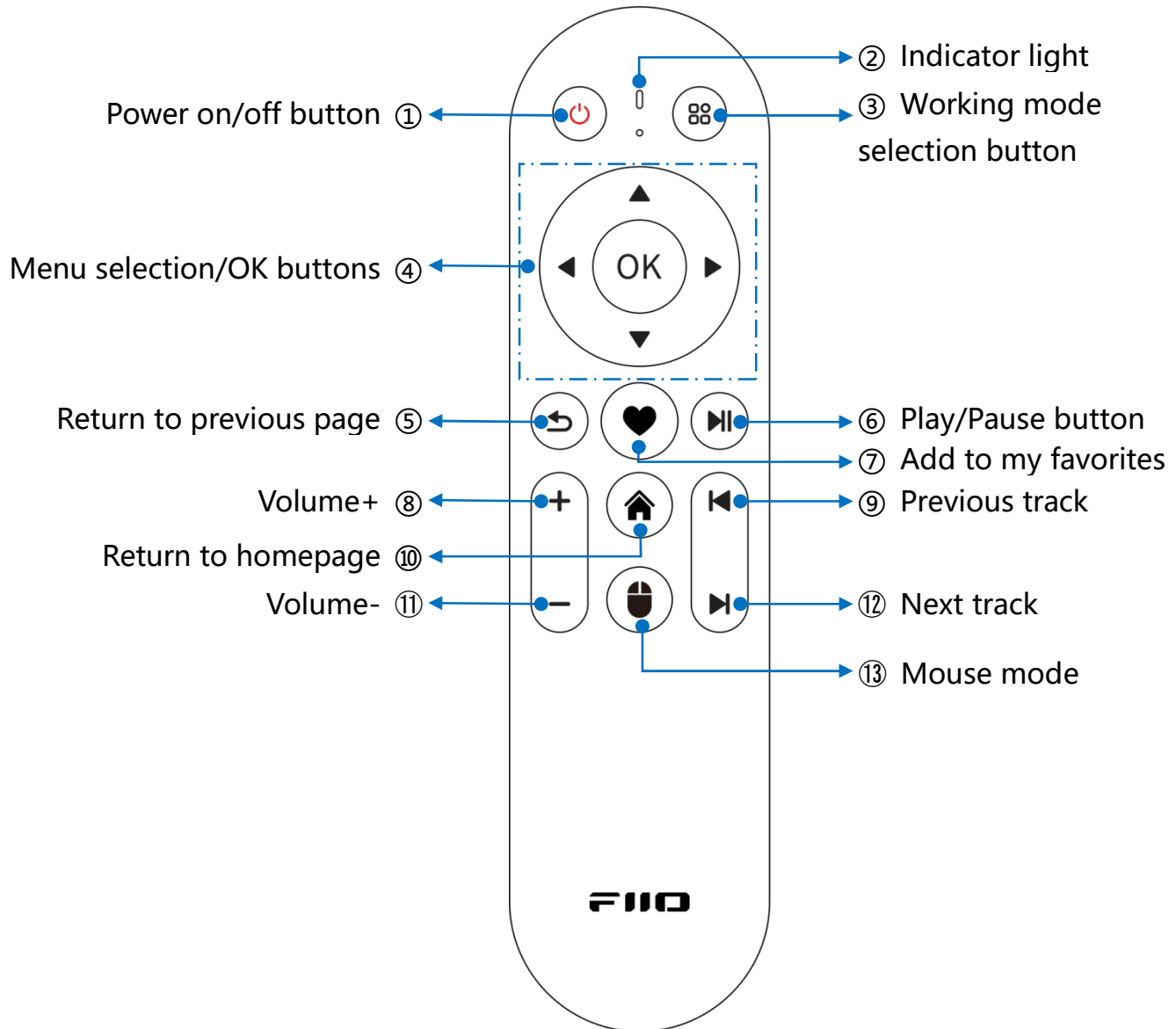

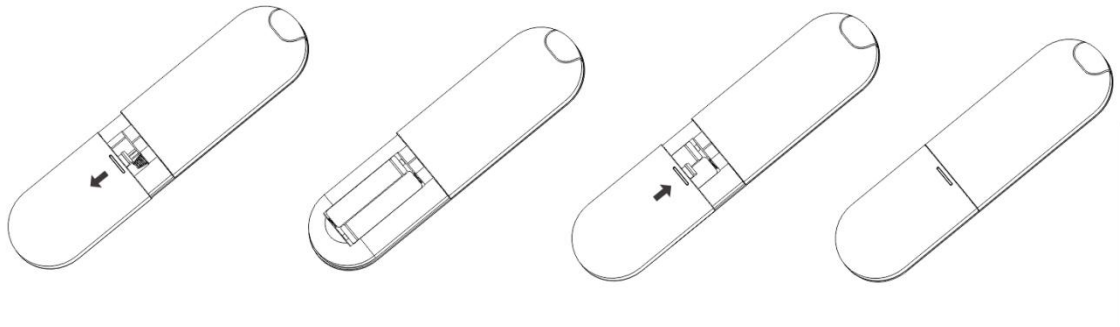

Battery installation instruction

The remote control needs a battery before use. Slide and open the battery cover on the back of the remote control as the arrow direction shown in the pictures. Please pay attention to the polarity of the battery when installing it.

Operating instruction

Pairing: Hold the Power on/off button for about 3s until the indicator light flashes, and the FiiO RM3 can be searched on the host device for connection. If the connection fails after entering the pairing state for over 30s, the FiiO RM3 will enter the standby mode with the indicator light turning off.

Notes:

※The effective distance of the remote control is within 10 meters.

※The remote control is a customized version for FiiO's R series, so some

buttons are only valid for them.

※The unmarked parts of the remote control can be regarded as a non-functional or non-native function.

FCC Warning

This device complies with part 15 of the FCC Rules. Operation is subject to the following two conditions:(1) This device may not cause harmful interference, and (2) this device must accept any interference received, including interference that may cause undesired operation.

Any Changes or modifications not expressly approved by the party responsible for compliance could void the user's authority to operate the equipment.

This equipment has been tested and found to comply with the limits for a Class B digital device, pursuant to part 15 of the FCC Rules. These limits are designed to provide reasonable protection against harmful interference in a residential installation. This equipment generates uses and can radiate radio frequency energy and, if not installed and used in accordance with the instructions, may cause harmful interference to radio communications. However, there is no guarantee that interference will not occur in a particular installation. If this equipment does cause harmful interference to radio or television reception, which can be determined by turning the equipment off and on, the user is encouraged

to try to correct the interference by one or more of the following measures:

- Reorient or relocate the receiving antenna.
- Increase the separation between the equipment and receiver.
- Connect the equipment into an outlet on a circuit different from that to which the receiver is connected.
- Consult the dealer or an experienced radio/TV technician for help.

The device has been evaluated to meet general RF exposure requirement. The device can be used in portable exposure condition without restriction.