

## Ornament Motion Detector Transmitter

Warning: for indoor use only. The motion sensor detects motion to remote on lights for an adjustable amount of time. A built-in photocell can be set to keep lights off when the lights aren't needed.. The unit has excellent sensitivity and wide 150 degree detection range.

### Features include:

150 degree motion detection angle.

Adjustable on-time from 30min. to 4 hours.

Adjustable photocell.

Selectable ON, OFF, AUTO modes.

Battery Operated. 3 x AAA size Alkaline Battery(not included)

### Installation

#### 1. Select a location

Mount this ornament motion sensor on a X'mas tress. Choose a location where the motion sensor has a clear view of the entire area where occupant motion may occur. To install this motion transmitter near by an existing wall switch. Use only where the existing location provides a clear view of the occupied area.

**General Application Information:** The detector is more sensitive to motion across the front of the sensor than to motion towards the sensor. The detector senses heat in motion and possible heat sources that change temperature quickly. Therefore, to avoid false triggering, avoid placing the sensor where it will be aimed at air conditioners, heaters, and sources of heat or cold.

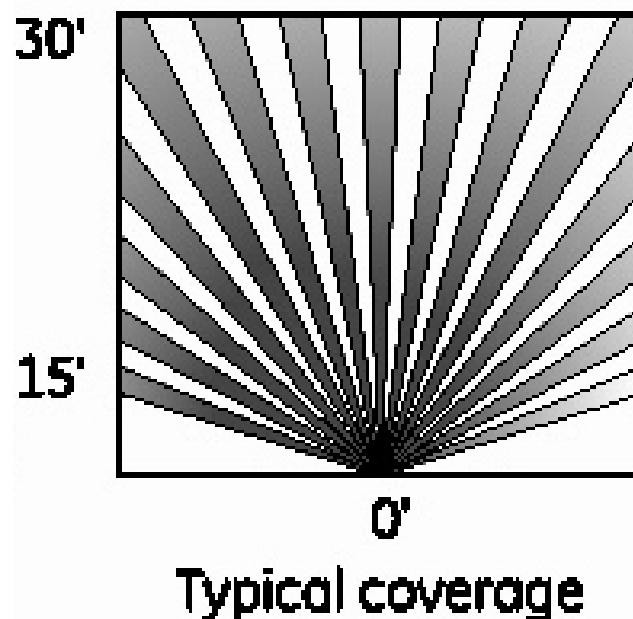

## 2. Installed

To install, can bend X'mas tree branch on the 3 holes of its Stand. Or use the wire supplied, twist the X'mas branch to the Stand.

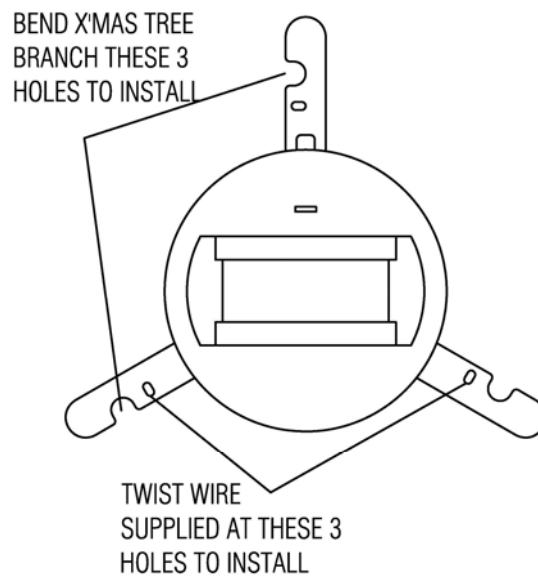

### Open the Ornament for adjusting or battery replacement.

Press the button on top of the Ornament, then turn front cover out to open. To close, push front cover back.

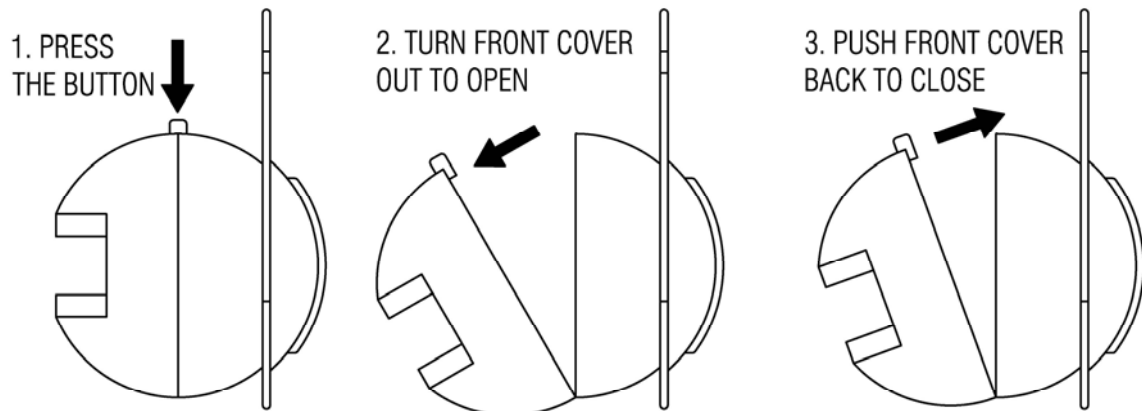

### Adjust Time & Light Sensitivity

The TIME and LIGHT knobs is at the right side of the battery compartment. TIME knob is on the top and LIGHT knob at bottom

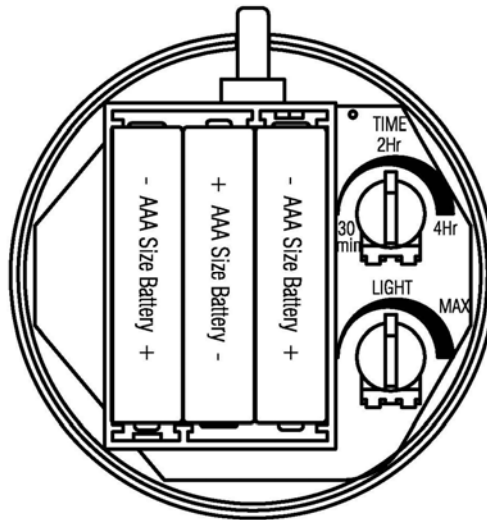

**Time,** The length of time that the lights stay on is adjustable from 30 minutes to 4 hours. Turning the knob marked with **TIME** to set the time by using the diagram as a guide. In the fully counter-clockwise position, the sensor turns off the lights 30 minutes after no movement detected. In the fully clockwise position, the sensor turns off the lights 4 hours after no movement detected.

**Light Level,** The sensor can be prevented from turning on lights when there is already enough light in the room. Turning the knob marked with **LIGHT** to set the light level using this diagram as a guide. In the fully counter-clockwise position, the sensor turns on the lights even in fully daylight. In the fully clockwise position, the sensor only turns on lights when the surrounding light level is very low.

#### To adjust the photocell,

- When the light in the room is at the level you want the lights to turn on.
- Put the TIME control to 30seconds(fully counter-clockwise)
- Put the LIGHT control to the minimum dark(fully clockwise) position. Wait for the LED indicator does not flash any more.
- Turn the LIGHT adjustment counter-clockwise in very small steps and wait 2 seconds before moving your hand in front of the sensor. Repeat until the LED indicator flashing by the sensor come on. The light will now come on when the light level is at below the present level and motion is detected.

#### Manual ON/OFF Operation

**Manual ON,** Pressing the button under the motion eye, the output will be ON instantly and continuously. The LED indicator will be lighted always.

**Manual OFF,** Pressing again the button under the motion eye, the output will be OFF instantly and continuously. The LED indicator will be off always.

**Back AUTO,** Pressing again the button under the motion eye, the output will be controlled by the motion detector. The LED indicator will be flashed only when it detect any movement.

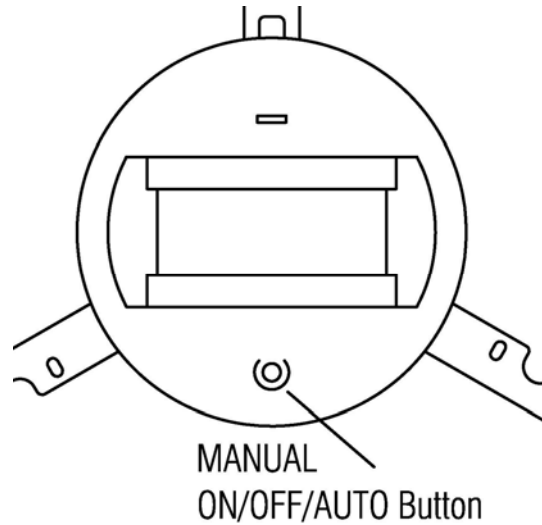

#### **FCC STATEMENT**

1. This device complies with Part 15 of the FCC Rules. Operation is subject to the following two conditions:

- (1) This device may not cause harmful interference.
- (2) This device must accept any interference received, including interference that may cause undesired operation.

2. Changes or modifications not expressly approved by the party responsible for compliance could void the user's authority to operate the equipment.

NOTE: This equipment has been tested and found to comply with the limits for a Class B digital device, pursuant to Part 15 of the FCC Rules. These limits are designed to provide reasonable protection against harmful interference in a residential installation.

This equipment generates uses and can radiate radio frequency energy and, if not installed and used in accordance with the instructions, may cause harmful interference to radio communications. However, there is no guarantee that interference will not occur in a particular installation. If this equipment does cause harmful interference to radio or television reception, which can be determined by turning the equipment off and on, the user is encouraged to try to correct the interference by one or more of the following measures:

Reorient or relocate the receiving antenna.

Increase the separation between the equipment and receiver.

Connect the equipment into an outlet on a circuit different from that to which the receiver is connected.

Consult the dealer or an experienced radio/TV technician for help.