



Excellence in Compliance Testing

Certification Exhibit

**FCC ID: QZC-UFTR1
IC: 4557A-UFTR1**

**FCC Rule Parts: 15.247, Part 90
ISED Canada's Radio Standards Specifications: RSS-247, RSS-119**

ACS Project Number: 17-3005

**Manufacturer: Elster Solutions
Model: UFTR1**

Label

SYM	PART	PART-DESCRIPTION-MATERIAL	TORQUE	QTY.	PART NUMBER	G01	NOTES
	1	UPPER HOUSING ASSEMBLY	N/A	1	1B12629	G01	
	2	LOWER HOUSING ASSEMBLY	N/A	1	1B12628	G01	
	3	GASKET, LOWER HOUSING	N/A	1	1B12627	H01	
	4	PCB ASSEMBLY	30-35 IN-LBS	1	5D26226	G01	TORQUE SUPPLIED 9/16 NUT
	5	BATTERY ASSEMBLY	N/A	1	1B12630	G01	
	6	FOAM PAD	N/A	2	3A35625	H01	
	7	BELTCLIP POST	N/A	1	3A35624	H01	
	8	SCREW, 2-56X.250, PAN HD, SS	5-6 IN-LBS	2	MSC DIRECT P/N P/N 67570648 OR EQUIV.	X	
	9	SCREW, M3 X 8mm, METRIC SEALING PAN HD, SS	3-4 IN-LBS	4	MSC DIRECT P/N 58945262 OR EQUIV.	X	
	10	SCREW, M3 X 10mm, FLAT HD, SS	8-10 IN-LBS	1	MSC DIRECT P/N 68018126 OR EQUIV.	X	
	11	FCC LABEL	N/A	1	3A35626	H01	
B	12	ANTENNA, C3 450-470 MHZ 3.3" SMA CONN	N/A	1	LAIRD TECHNOLOGIES P/N EXD450SMV	X	
	13	OVERLAY, CLEAR, UFT BELTCLIP	N/A	1	3A35639	H01	
AB	14	BELTCLIP, RATCHET	N/A	1	SEE NOTE A	X	
	15	FLAT WASHER, 7/16, PASSIVATED SS	N/A	1	MSC DIRECT P/N 05389002 OR EQUIV.	X	
D	16	LABEL, BARCODE	N/A	1	4075B04	H16	

NOTES:

- A - WWW.THECLIP.COM P/N 582R RACHETING BELTCLIP.
- B - BELTCLIP (ITEM 14) ARE TO BE PACKAGED IN THE BOX, UNASSEMBLED TO THE RADIO FOR THE CUSTOMER TO ASSEMBLE TO THE RADIO AT THEIR DISCRETION.
- C - APPLY THREAD-LOCKING ADHESIVE (LOC-TITE 271 OR EQUIV.) TO THIS BELT CLIP TAB SCREW (ITEM 10) AND THREADS OF ANTENNA (ITEM 12) PRIOR TO INSTALLATION. INSURE FLATS ON ITEM 7 RUN PARELLEL TO THE LONG LENGTH OF THE RADIO, THIS INSURES THE RADIO WILL BE POSITIONED CORRECTLY WHEN CLIPPED TO THE USER'S BELT.
- D - MARK LABEL WITH BARCODE AND ALPHA-NUMERIC CHARACTERS USING THIS ELECTRONIC ASSEMBLY NUMBER PER DRAWING 1B12181. INSTALL LABEL (ITEM 16) AND OVERLAY (ITEM 13) ON TOP OF FCC LABEL (ITEM 11) WHERE IT STATES "BARCODE LABEL HERE".

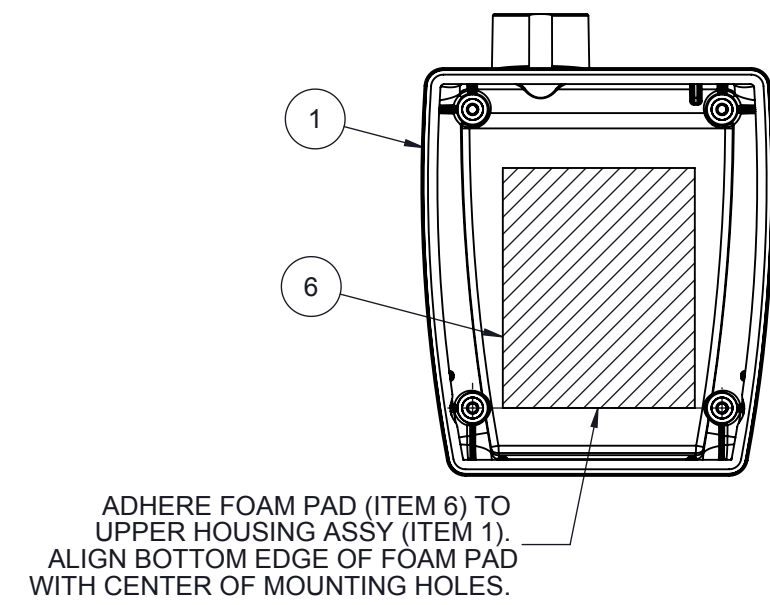

UPPER HOUSING ASSEMBLY

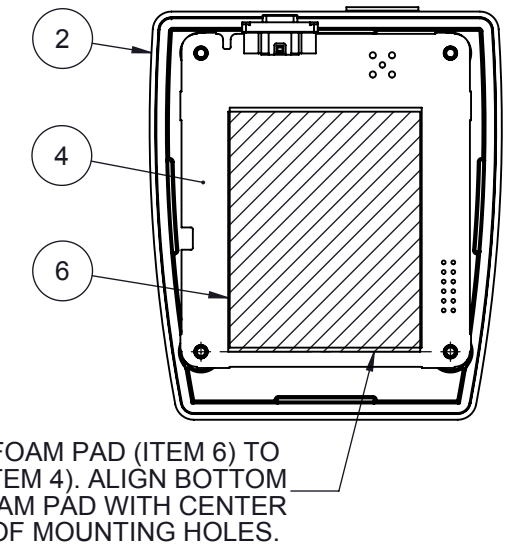

LOWER HOUSING/PCB ASSEMBLY

DETAIL A
FOAM PAD LOCATIONS

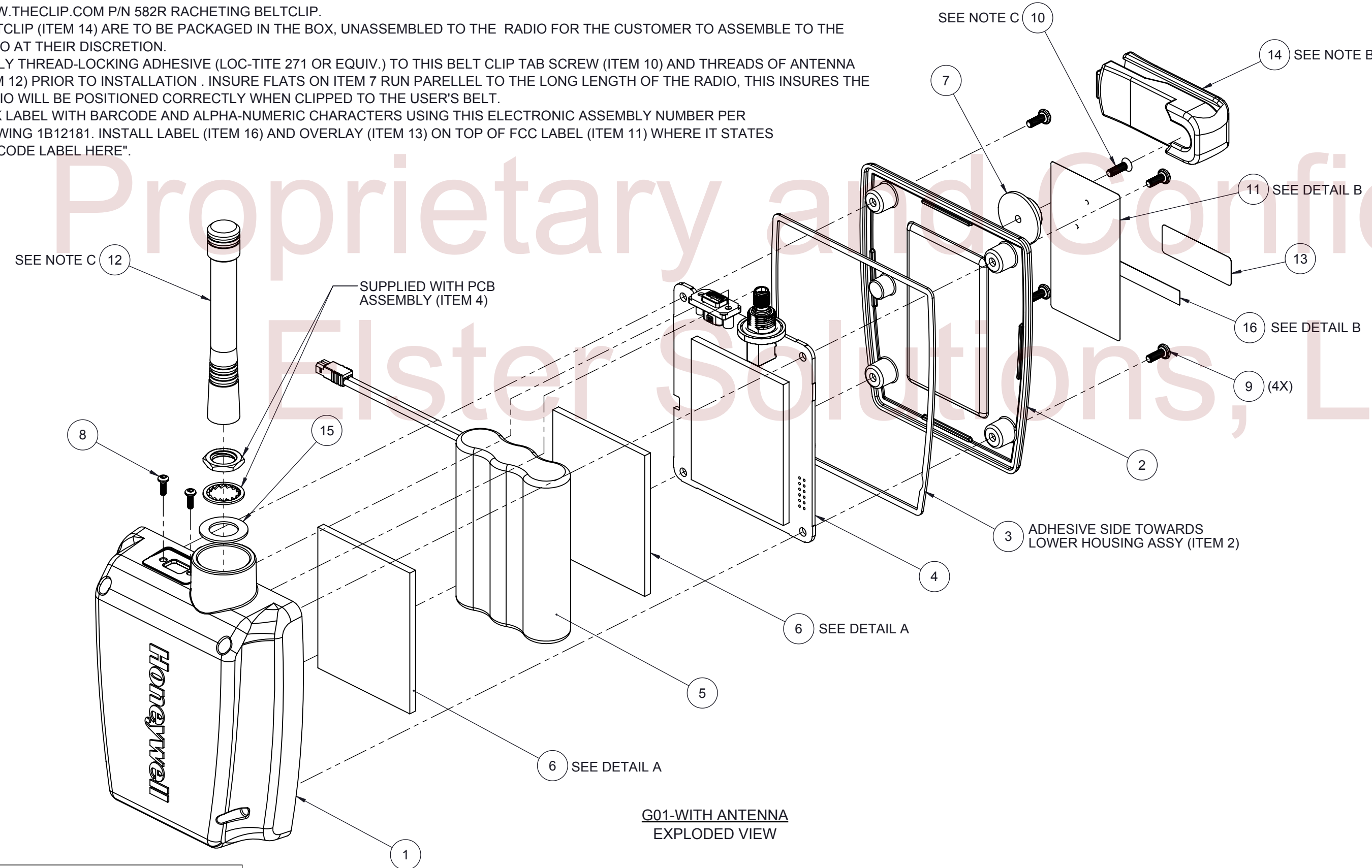

G01-WITH ANTENNA
EXPLODED VIEW

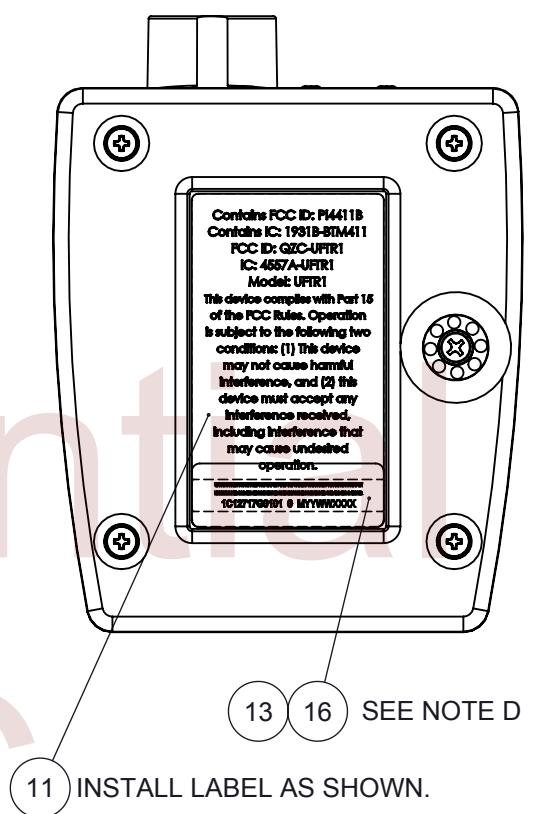

DETAIL B
LABEL VIEW

FIRST MADE FOR ASSY. DWG

CAD NO. DWG SLD17026	DRAFTSMAN DATE RSB 04/13/16	APPROVED DATE S. CRISCIONE 04/13/16	02 R#ES20160429-01 G02 WAS ON ITEM 1 UPDATED TO NEW DESIGN. ITEMS 15 & 16 WERE NOT ON	03 R#ES20160728-02 FLIPPED BATTERY '180'. MSC DIRECT PINS WERE MCM-SATER-CARR. TORQUE & NOTES COLUMN WERE NOT ON. SEE R#N FOR COMPLETE LIST OF CHANGES. RSB 08/16/16	04 R#ES20161101-01 TORQUE SPEC ON ITEM 8 WAS 6-8 IN-LBS TORQUE ON ITEM 9 WAS 8-10 IN-LBS. RSB 11/22/16	05 R#ES20170317-01 ITEM 13 WAS COAX CAP LABEL OVERLAY WAS NOT ON. ANTENNA & LOC-TITE WERE NOT INSTALLED ON ASSEMBLY. RSB 03/22/17
-------------------------	--------------------------------	--	--	--	--	--

Elster Solutions, LLC.
Raleigh, N.C.

TITLE:
UNIFIED FIELD TOOL (UFT) BELTCLIP
RADIO GENERAL ASSEMBLY

SIZE C	UNSPEC'D TOL. X.XX ±.010 X.XXX ±.005 ANGLES ±1°	DWG. NO. 1C12717	REV 05
-----------	---	---------------------	-----------

SCALE: 2:3 NOTE: DRAWING DIMENSIONED IN INCHES SHEET 1 OF 1

SYM	PART	PART-DESCRIPTION-MATERIAL	FINISH NO. ELSTER REF.	MATERIAL NO. ELSTER REF.
	1	FCC LABEL		

NOTES:

- BOUGHT OUTSIDE: MAVERICK LABEL OR ELSTER APPROVED SUBSTITUTE.
- MATERIAL: 10 MIL LEXAN, VELVET SURFACE, SUBSURFACE PRINTED ON BACK SIDE, 2 MIL ADHESIVE USED FOR LSE PLASTIC SURFACE. LABEL COLOR IS WHITE WITH BLACK PRINT.

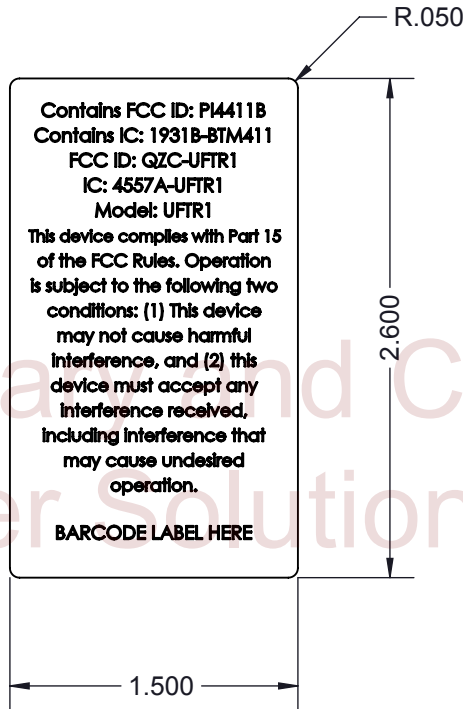

Proprietary and Confidential
 Elster Solutions, LLC

FIRST MADE FOR ASSY. DWG.

CAD DWG. NO. SLD17027 REFERENCE DWG. DRAFTSMAN DATE RSB 04/13/16 APPROVED DATE S. CRISCIONE 04/13/16 RN#ES20170202-01 MATERIAL WAS 'VINYL 4 MIL CLEAR WITH LEXSAVER 5 MIL VELVET OVERLAMINATE. WITH 1 MIL ACRYLIC ADHESIVE. RSB 02/09/17 S. CRISCIONE 02/09/17 RN#ES20170317-01 MODEL NUMBER WAS UFTR-1. RSB 03/22/17 S. CRISCIONE 03/22/17	Elster Solutions, LLC Raleigh, N.C.			
	TITLE FCC LABEL, UNIFIED FIELD TOOL (UFT) BELTCLIP RADIO			
	SIZE A	UNSPEC'D TOL. X.XX±.010 X.XXX±.005 ANGLES ±1°	DWG NO. 3A35626	REV 03
	SCALE: 1:1		NOTE: DRAWING DIMENSIONED IN INCHES	SHEET 1 OF 1