

# Getac

Input/輸入/額定輸入:19V == 4.74A Model/型號/型号: B300

AC Adapter/電源適配器/交流適配器

**CAUTION:** For use with power supply model  
ADP-90SB BB or ADM-9019M  
Pour utiliser avec alimentation modèle  
ADP-90SB BB ou ADM-9019M



This device complies with part 15 of the FCC rules. Operation is subject to the following two conditions: (1) this device may not cause harmful interference; and (2) this device must accept any interference, received, including interference that may cause undesired operation.



**CAUTION:**  
This surface is hot, avoid continuous body contact and do not place this notebook on your lap while it is operating.

S/N:

REF:

MADE IN CHINA  
神基科技股份有限公司/中国制造

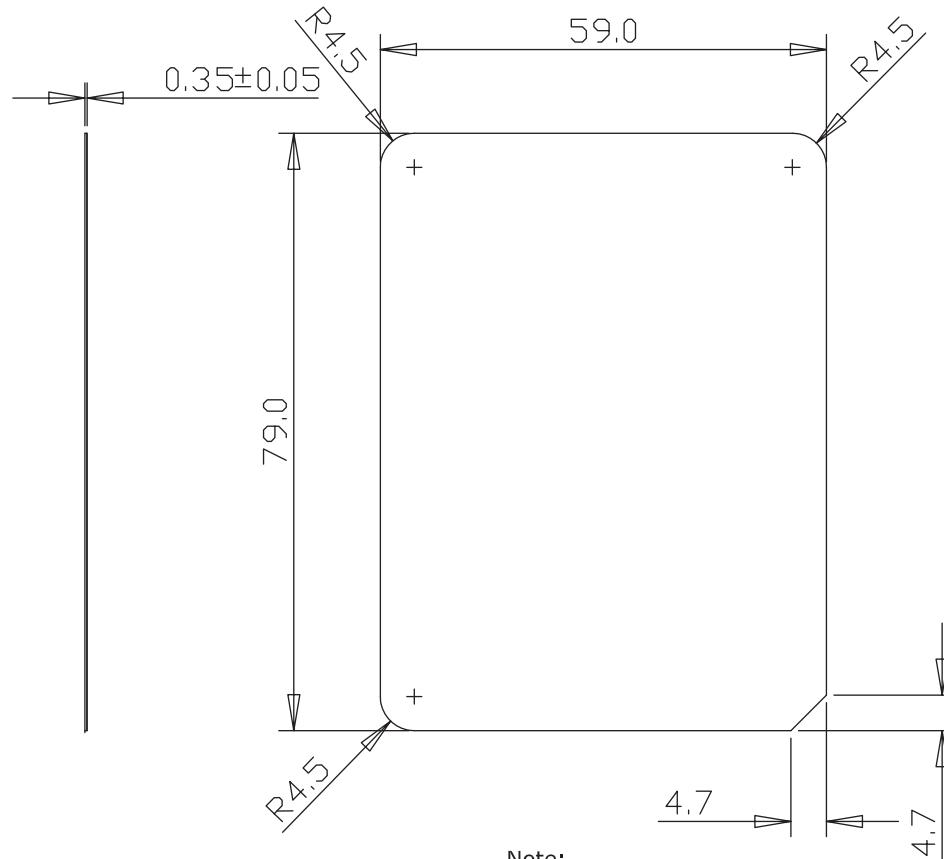

**Note:**

1. MATERIAL: 霧面PC(FR65),t 0.254,防火係數94-0, IT MUST BE APPROVED BY UL & CSA STANDARD
2. LABEL SHOULD HAVE PRESSURE SENSITIVE ADHESIVE WITH PROTECTIVE RELEASE LINER ON THE BACK SIDE.
3. COLORS:TEXT FOREGROUND : Pantone Cool Gray 3C  
BACKGROUND: Pantone black
4. LABEL MANUFACTURER MUST USE A PROCESS & MATERIALS THOSE WHICH HAVE BEEN APPROVED BY UL & CSA
5. ADHESIVE: SONY T4000
6. 依RD承認 SAMPLE 為準
7. 成品需符合GP要求

ITEM	CONTENTS OF CHANGE	RVS	CHK	APV	M/D/Y	TOL±	MATERIAL								DATE	Jul-22-2009	MATERIAL	SEE NOTES	TREATMENT	REMARK	
							Plt	Met	Ins	Por	Cab	Pac	Gas	PCB	UNIT	MM	SCALE	--	DRAWING NAME	TF1-LABEL; RATING,MP, B300	
						0~6	0.1	0.1	0.1	0.2	0.5	1	0.5	0.1	DRAWN	DESIGNED	CHECKED	APPROVED	MATERIAL NO.	MF 242 8144 000XX R 00	
						6~30	0.1	0.1	.15	.25	1	1	0.5	0.1							
						30~80	0.1	.15	0.2	0.3	2	1.5	1	0.1							
						80~180	.15	.15	.25	0.3	2	2	1	.15							
						180~315	.15	0.2	0.3	0.4	2.5	2	1	.15							
						315~800	0.2	0.3	0.4	0.5	3	3	2	.15							

**Getac** Technology Corp.