

1

2

3

4

5

1	訂正		
---	----	--	--

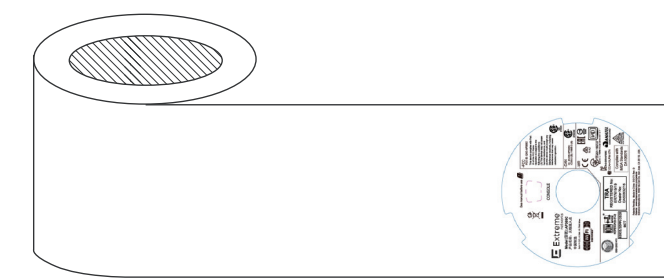
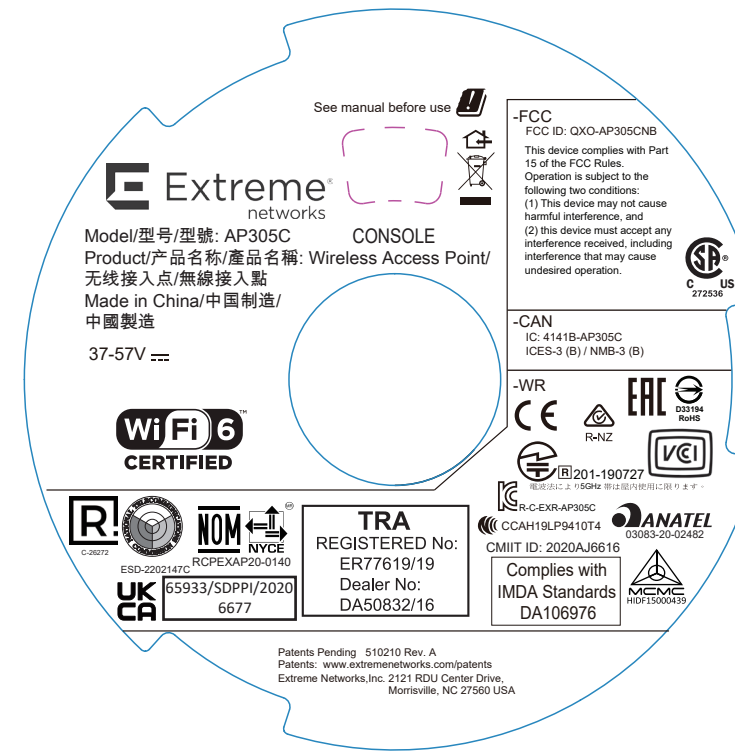
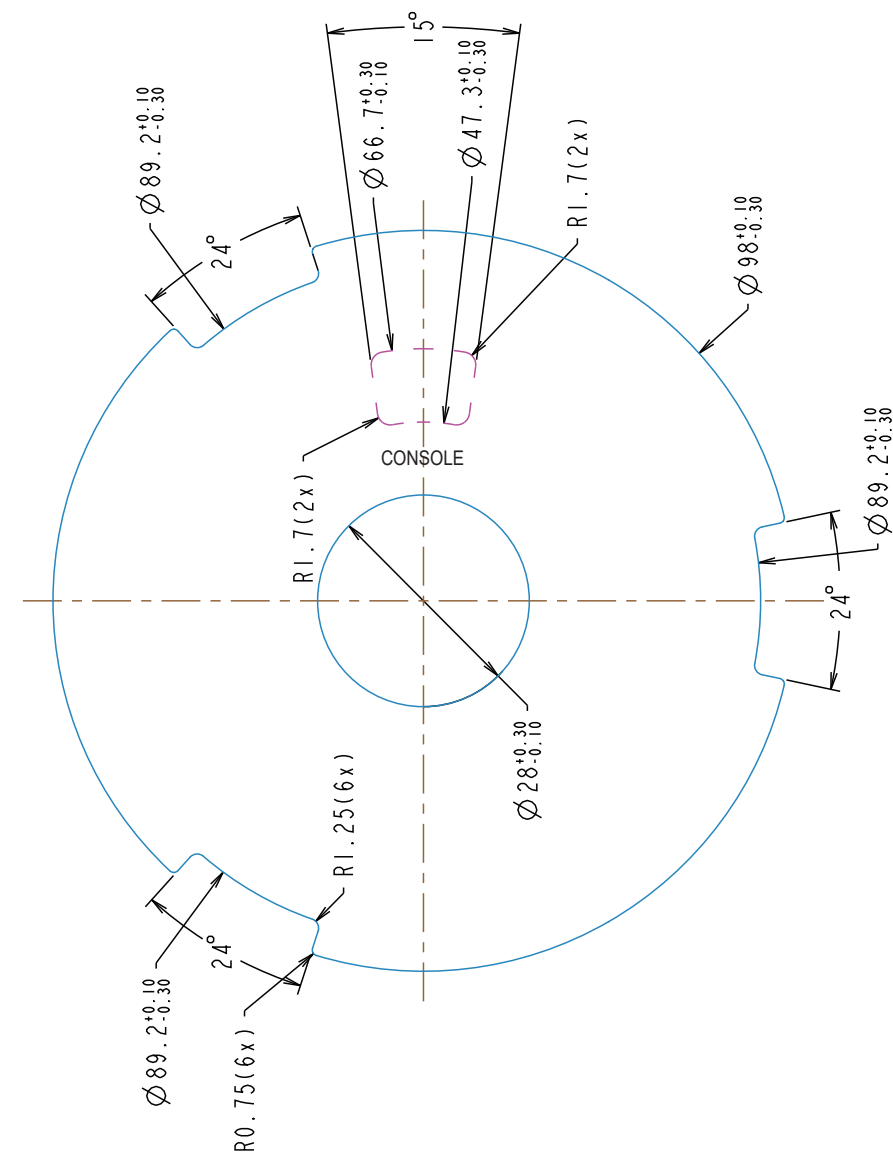

NOTE:

- MATERIAL: WHITE MATTE PET, T=0.1
ADHESIVE: ACRYLIC 網紋背膠
- FINISH: FINISH: ,T=0.025
- COLOR: ORIGINAL MATERIAL COLOR
印刷: BLACK, 刀模: 斷刀線: - - - - -
- UL APPROVED, PGJ12,PRINTED,.
- 被貼物: 鋁件
- TEMPERATURE RESISTANT= 120° C
- 印刷公差: 尺寸30mm以下為±0.2mm,30~120mm為±0.3mm,120~315mm為±0.5mm,315以上±0.8mm
- 捲狀出貨,離型紙左右間距各3±0.5mm, 上下間距各3±0.3mm
- 中間圓孔排廢
- TEST REQUIREMENTS

	TEST ITEM	TEST SPEC	TEST CONDITION	CRITERIA
1	附著力測試	ISO Class.: 1 ASTM Class.: 4 B	ASTM D3359-02/ ISO 2409:2007	Detachment of small flakes of the coating at the intersections of the cuts. A cross-cut area not significantly greater than 5% is affected.

DONOTSCALEDRAWING

MODEL	AP305C	NAME	Label/Extreme	SCALE	1 / 1
DSN		PART. NO	510210 Rev. A	SHEET	OF
CHK		MATERIAL	white PET	Q' TY	PC
APV					
FILE					

USED