



ITEM NO. 6597  
MADE IN CHINA



General Motors Trademarks used under license to  
Plastic Manufacturing, Ltd.  
model body and grille designs are General Motors  
Hummer H2, the H2 Emblem and distinctive vehicle  
contents, colors and decorations may vary from photos.  
© 2003 TSM SHA TSUI EAST, KOWLOON, HONG KONG  
Official Licensed Product  
Ford, F-150 Pick Up trademarks are used under  
license from Ford Motor Company.  
Official Licensed Product  
TSM SHA TSUI EAST, KOWLOON, HONG KONG



# RACING TEAM

- GOES FORWARD
- TURNS IN REVERSE



FOR AGES ABOVE 3



# RACING TEAM

- GOES FORWARD
- TURNS IN REVERSE

FOR AGES ABOVE 3



- GOES FORWARD
- TURNS IN REVERSE

SCALE  
1:24



HUMMER H2

FOR AGES ABOVE 3



**WARNING:**  
CHOKING HAZARD – Small parts.  
Not for children under 3 yrs.

# RACING TEAM

- GOES FORWARD
- TURNS IN REVERSE



- GOES FORWARD
- TURNS IN REVERSE

SCALE  
1:24



Ford F-150 PICK UP

PLEASE READ ALL INSTRUCTIONS CAREFULLY BEFORE PLAYING, AND RETAIN THIS INSTRUCTION FOR FUTURE REFERENCE.

**RADIO CONTROL FREQUENCY**  
FOR INTERFERENCE-FREE RESULTS, DO NOT OPERATE THIS VEHICLE WITH OTHER RADIO-CONTROLLED TOYS NOT INCLUDED IN THIS SET WITHIN TRANSMISSION RANGE.

**TRANSMITTER AND RECEIVER**  
SINCE RADIO WAVES CONTROL THIS VEHICLE AND IN ORDER TO AVOID INTERRUPTION, DO NOT OPERATE THIS VEHICLE NEAR ELECTRICAL OR TELEPHONE LINES, CB INTERFERENCE, CD PLAYERS, MOBILE PHONES, ELEVATORS, STEEL GRIDDERS, OTHER ELECTRONIC DEVICES AND NEAR HIGHWAYS.

**INSTALLING THE BATTERIES**  
• REMEMBER TO SET THE "ON-OFF" SWITCH AT BOTTOM OF THE VEHICLE TO "OFF" POSITION BEFORE INSERTING THE BATTERIES.  
• UNSCREW AND OPEN BATTERY COMPARTMENT COVER TO INSERT BATTERIES IN THE VEHICLE AS SHOWN IN FIGURE. MAKE SURE ALL BATTERIES ARE AT THE CORRECT POLARITY.  
• CLOSE THE COVER AND TIGHTEN THE SCREW.  
• TO INSERT BATTERY IN THE CONTROLLER, OPEN BATTERY COMPARTMENT COVER TO INSERT BATTERY AS SHOWN IN FIGURE.  
• CLOSE THE COVER.  
• DO NOT LEAVE BATTERIES IN THE VEHICLE AND TRANSMITTER WHEN THE TOY IS NOT IN USE.  
• DO NOT MIX OLD AND NEW BATTERIES TOGETHER.  
• DO NOT MIX ALKALINE, STANDARD (CARBON-ZINC) OR RECHARGEABLE (NICKEL-CADMIUM) BATTERIES.  
• DO NOT DISPOSE OF BATTERIES IN FIRE. BATTERIES MAY EXPLODE OR LEAK.  
• FOR BEST PERFORMANCE, ALKALINE BATTERIES ARE RECOMMENDED.

**OPERATING THE VEHICLE**  
• FOR YOUR SAFETY, NEVER PLAY WITH THIS TOY ON THE STREET.  
• TURN THE "ON-OFF" SWITCH AT THE BOTTOM OF THE VEHICLE TO "ON" POSITION, THEN THE VEHICLE WILL GO BACKWARD IN CIRCULAR PATH.  
• PULL THE TRIGGER DOWNWARD ON THE TRANSMITTER, THE VEHICLE WILL RESPOND IN GOING FORWARD.

**OPERATION TIPS**  
1. OPERATE ONLY ON SMOOTH (BUT NOT SLIPPERY), DRY AND CLEAN SURFACE.  
2. DO NOT PLAY WITH THIS TOY ON THE STREET, IN GRASS, SAND OR CARPET.  
3. DO NOT DRIVE THE TOY THROUGH WATER.  
4. ALWAYS POINT THE CONTROLLER ANTENNA UPWARD FOR BETTER TRANSMISSION.  
5. DO NOT MAKE ANY PHYSICAL CONTACT WITH THE CONTROLLER ANTENNA WHILE OPERATING.  
6. KEEP THE TOY IN A DRY AND COOL PLACE AFTER PLAYING. DO NOT LEAVE IT DIRECTLY UNDER SUNLIGHT.

CONFORMS TO TOY SAFETY STANDARDS ASTM F963-96a.

"MODIFICATIONS NOT AUTHORIZED BY THE MANUFACTURER MAY VOID USERS AUTHORITY TO OPERATE THIS DEVICE"

**NOTE:**  
THIS EQUIPMENT HAS BEEN TESTED AND FOUND TO COMPLY WITH THE LIMITS FOR A CLASS B DIGITAL DEVICE, PURSUANT TO PART 15 OF THE FCC RULES. THESE LIMITS ARE DESIGNED TO PROVIDE REASONABLE PROTECTION AGAINST HARMFUL INTERFERENCE IN A RESIDENTIAL INSTALLATION. THIS EQUIPMENT GENERATES, USES AND CAN RADIATE RADIO FREQUENCY ENERGY AND, IF NOT INSTALLED AND USED IN ACCORDANCE WITH THE INSTRUCTIONS, MAY CAUSE HARMFUL INTERFERENCE TO RADIO COMMUNICATIONS. HOWEVER, THERE IS NO GUARANTEE THAT INTERFERENCE WILL NOT OCCUR IN A PARTICULAR INSTALLATION. IF THIS EQUIPMENT DOES CAUSE HARMFUL INTERFERENCE TO RADIO OR TELEVISION RECEPTION, WHICH CAN BE DETERMINED BY TURNING THE EQUIPMENT OFF AND ON, THE USER IS ENCOURAGED TO TRY TO CORRECT THE INTERFERENCE BY ONE OR MORE OF THE FOLLOWING MEASURES:  
• REORIENT OR RELOCATE THE RECEIVING ANTENNA.  
• INCREASE THE SEPARATION BETWEEN THE EQUIPMENT AND RECEIVER.  
• CONNECT THE EQUIPMENT INTO AN OUTLET ON A CIRCUIT DIFFERENT FROM THAT TO WHICH THE RECEIVER IS CONNECTED.  
• CONSULT THE DEALER OR AN EXPERIENCED RADIO/TV TECHNICIAN FOR HELP.

## BATTERY INSTRUCTION DIAGRAMS

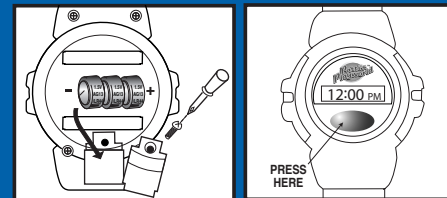

UNDERNEATH WATCH CONTROLLER  
USES 3 BUTTON CELL BATTERIES (AG13 / LR44) FOR CONTROLLER (INCLUDED).

PRESS HERE  
PRESS BUTTON TO GO FORWARD.  
RELEASE BUTTON TO GO BACKWARD.

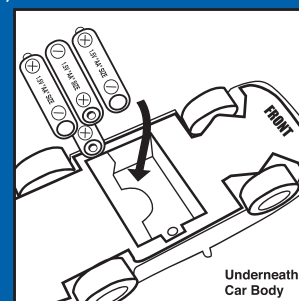

USES 4 X 1.5V "AA" SIZE BATTERIES (NOT INCLUDED)