

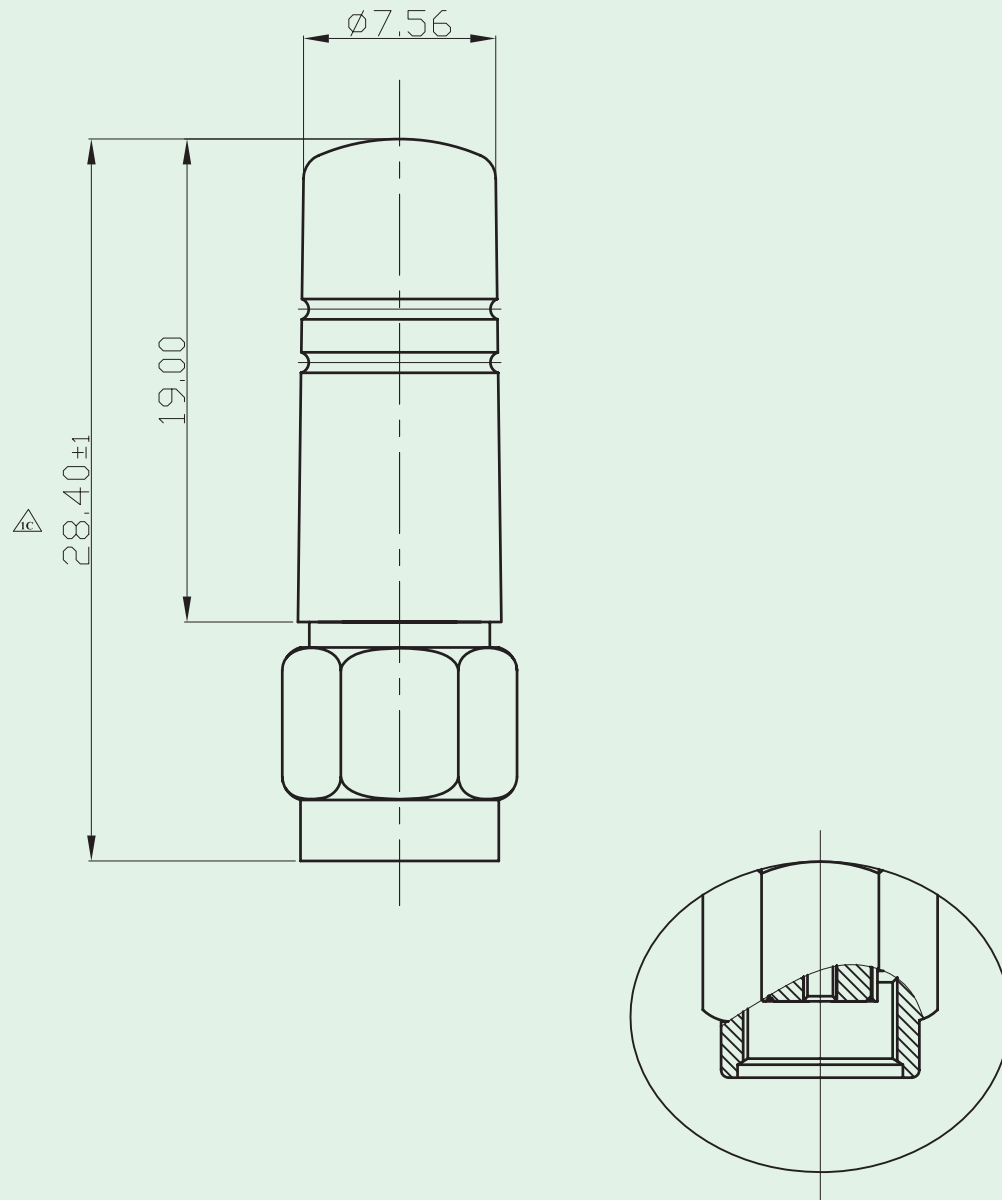

2.4GHz Shorter Antenna

KINSUN



ELECTRICAL :

- Frequency Range : 2.4GHz
- Impedance : 50Ω
- V.S.W.R. : ≤ 2.0
- Max. Gain : 1.0dBi
- Radiation : Omni
- Electrical Wave : $1/4\lambda$, Dipole
- Polarization : Vertical

MECHANICAL :

- Antenna Cover : TPE
- Color : Black
- Operating Temperature : $-20^{\circ}\text{C} \sim +65^{\circ}\text{C}$
- Storage Temperature : $-30^{\circ}\text{C} \sim +75^{\circ}\text{C}$
- Connector : SMA-Male-RP

Series No.

6625102000