

# X35T

## Remote control quadcopter

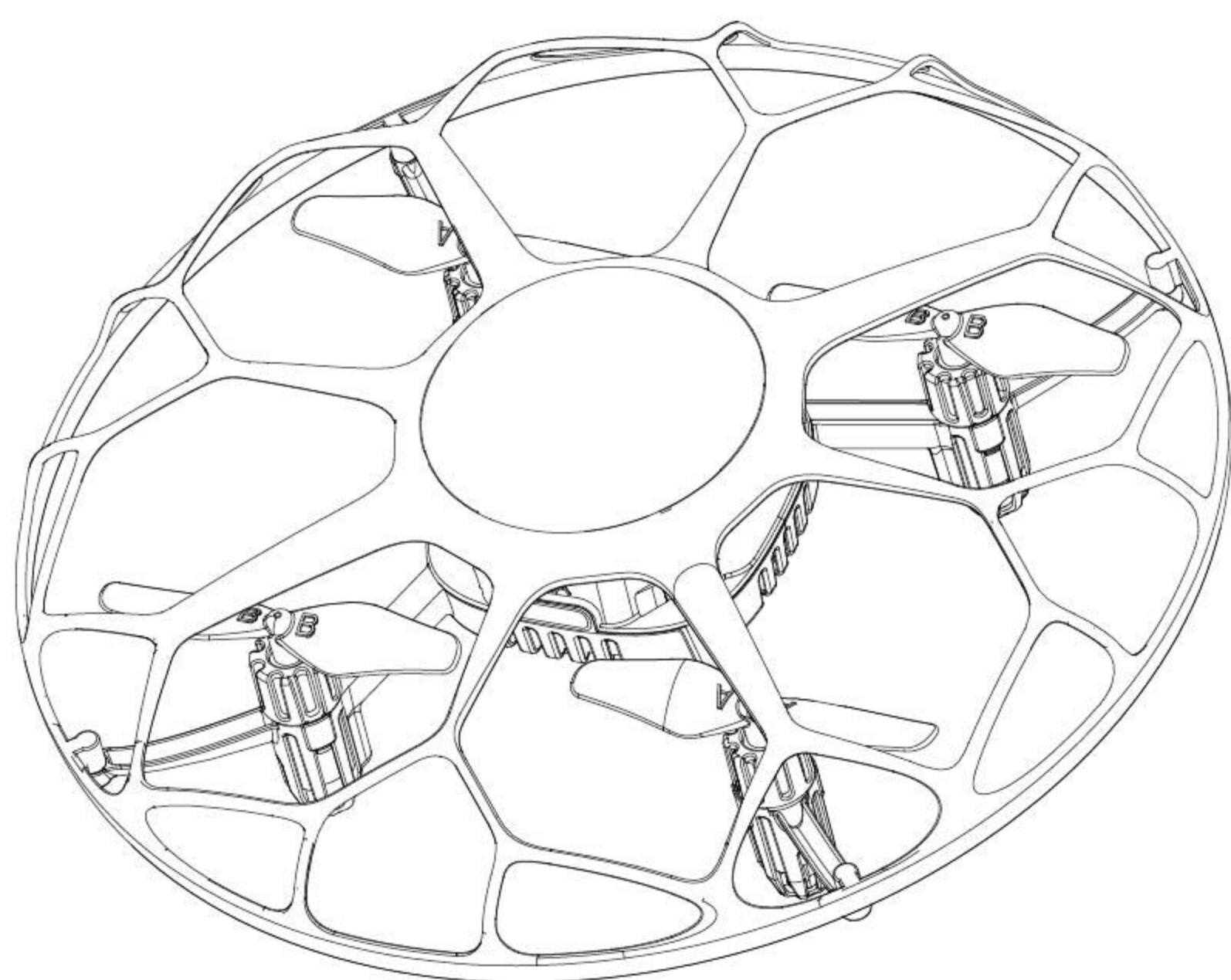

# User Manual

Accreditation standard: GB/T26701-2011

The materials, specifications, parts and packaging mentioned in this manual are for reference purposes only. We are not responsible for any changes made to this printed material, nor are we able to inform customers of any updates or changes. Please refer to the SYMA Toys website for the latest information.

### Important safety information

Thank you for purchasing this SYMA product. To ensure that you operate the aircraft correctly, please read these instructions carefully before first use and store them in a safe place for future reference.

#### Safety information

- Keep the smaller-sized accessories out of the reach of children.
- This aircraft can move very quickly. When flying for the first time, push left joystick up slowly to prevent the aircraft from ascending too rapidly and causing damage or collisions.
- When the flight has ended, switch off the remote control before switching off the power on the aircraft.
- Do not store the battery in a hot environment (e.g. near open flames or a heating device).
- When the quadcopter is airborne, it should be kept at least 2-3m away from the pilot and other people to avoid the risk of a collision during landing.
- Children must be supervised by an adult when operating the aircraft. The aircraft should always remain within the line of sight of the pilot (or instructor).
- Do not recharge non-rechargeable batteries. When installing or changing the batteries, ensure that they are connected in the correct polarity. Do not mix old and new batteries or different types of batteries.
- Do not short circuit the battery terminals.
- If you do not plan to use the quadcopter for at least 10 days, discharge the battery to 40%-50% (e. g. if the battery is fully charged, drive the quadcopter for half of the total driving time). This helps to prolong the lifespan of the battery.
- Maintain a safe distance from the spinning propellers to avoid the risk of injury.
- In order to prevent interference with air traffic control systems, it is forbidden to use remote controls within a 5000m radius of an airport runway (calculated from the centre of the runway). Always comply with remote control restriction orders issued by national authorities.
- You must only use the recommended transformer for this model. The transformer is not part of the model. Disconnect the model from the transformer or charger before cleaning with cleaning fluid. Regularly inspect the transformer's wires, plug socket, outer casing and other accessories to ensure that they are not damaged. If there are any signs of damage, discontinue use immediately until the fault has been repaired.
- After use, ensure that the quadcopter and remote control are switched off and remove the batteries in the remote control.
- The packaging and this manual contain important information and should be kept in a safe place for future reference.
- Do not look directly at the laser beam.
- a reminder that the toy must be used with caution since skill is required in order to control the flight and avoid collisions with the user, objects or third parties.
- precautions to be observed such as "Do not touch the rotating rotor, avoid loose clothing or hair that could be caught in the rotor do not fly near the face"
- advice to adult supervisors to teach children how to safely fly and control the toy.
- conditions to be observed when using the toy

#### Repair and maintenance

- Clean the product regularly with a clean, soft cloth.
- Avoid exposing the product to direct sunlight or heat.
- Do not submerge the product in water, as this may damage the electrical components.
- Regularly inspect the propellers, motor and battery. If there are any signs of damage, discontinue use immediately until the fault has been repaired.

### About this product

#### Specifications

- Aircraft
  - Weight Aircraft: Approx. 24 g
  - Specifications: 119x119x42 mm
  - Flight range: Approx. 20 m
  - Flight time: Approx. 7 mins
  - Motor: ø6
  - Battery: 3.7 V, 200 mAh
  - Battery Charging time: Approx. 40 min
- Remote control
  - Operating frequency: 2.4 GHz
  - Operating temperature: 0°C to 40°C
- Package contents
  - Aircraft: 1
  - Remote: 1
  - USB charging cable: 1
  - Propeller: 2 (A/B)
  - User manual: 1

#### Aircraft components

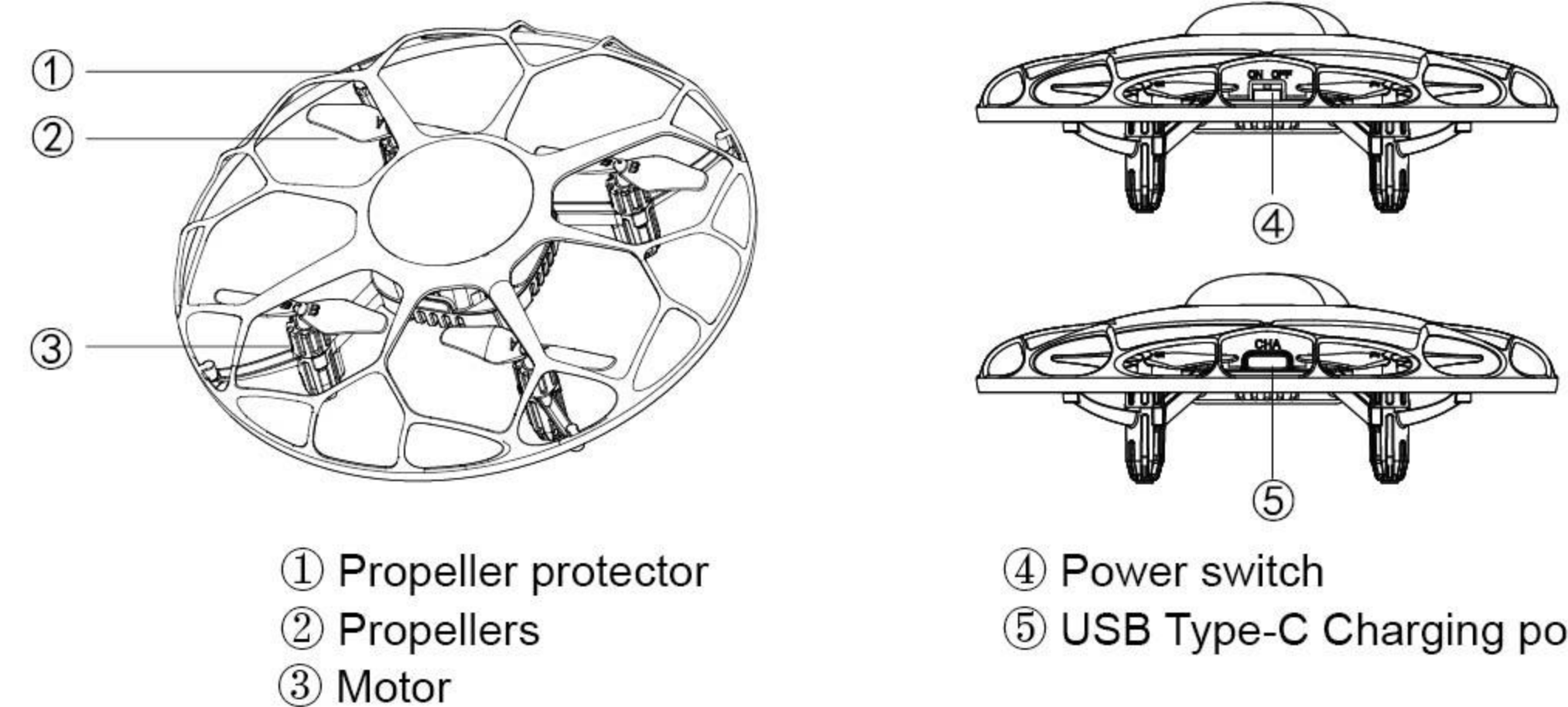

### Remote control components

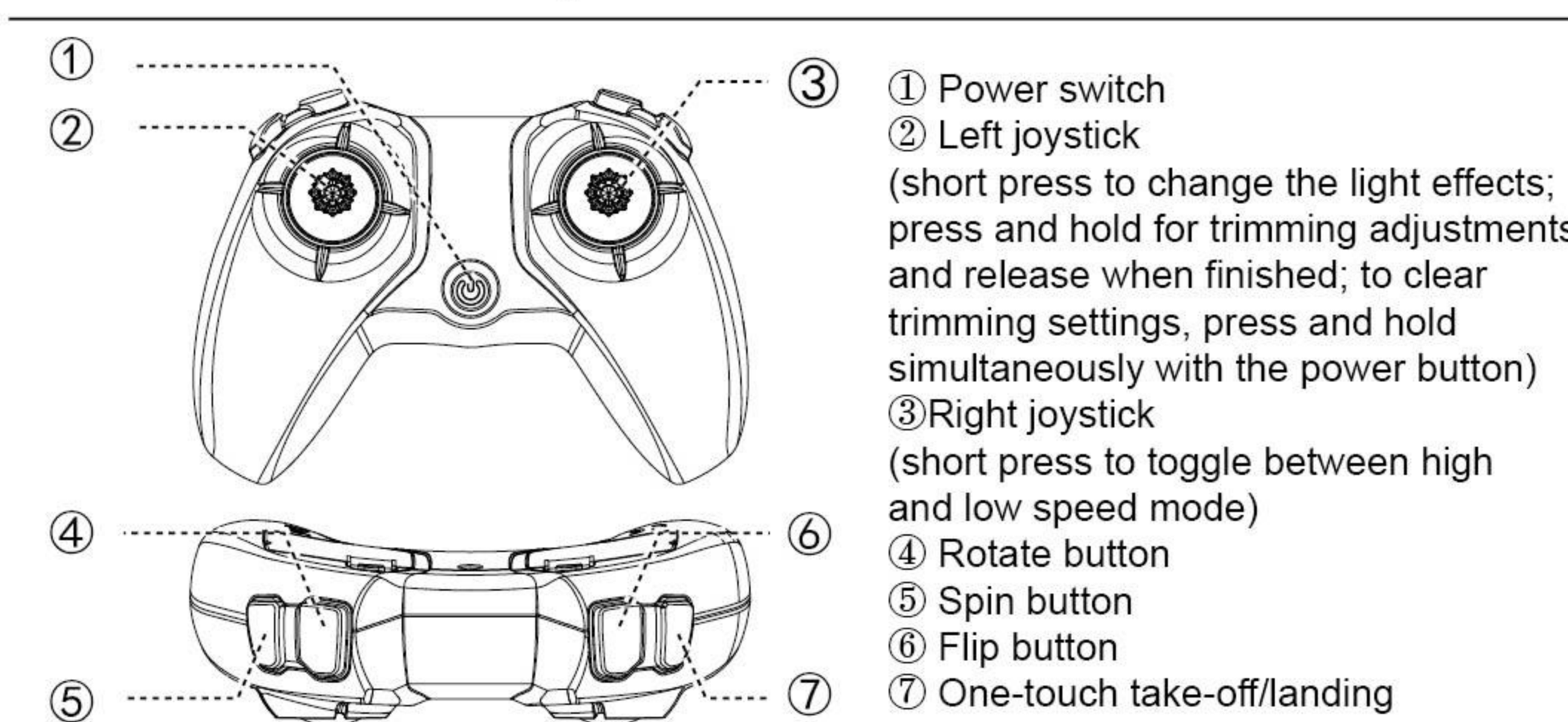

#### Charging the aircraft battery

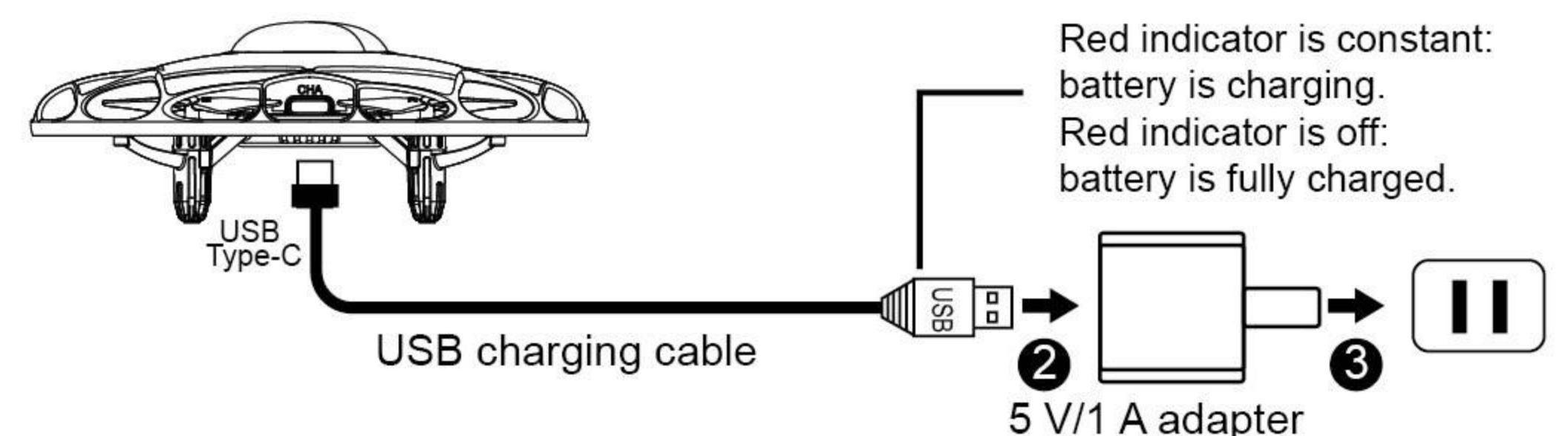

- Charge the quadcopter with the USB charging cable that came with the product.
- Using adapters with a lower rated current will result in a longer charging time.

\* The toy is only to be connected to Class II equipment bearing the



- Do not short circuit or compress the battery, as this may cause an explosion.
- Do not disassembling the battery or store it in a hot environment.
- If you do not plan to use the aircraft for at least 10 days, discharge the battery to 40%-50%. This helps to prolong the lifespan of the battery.
- Rechargeable batteries should be removed from the aircraft before charging charged.
- Rechargeable batteries should only be charged under the supervision of adults and keep away from flammable materials.
- Exhausted batteries should be removed from the aircraft.
- Caution: Risk of explosion if battery is replaced with incorrect ones.

### Inserting the remote control batteries:

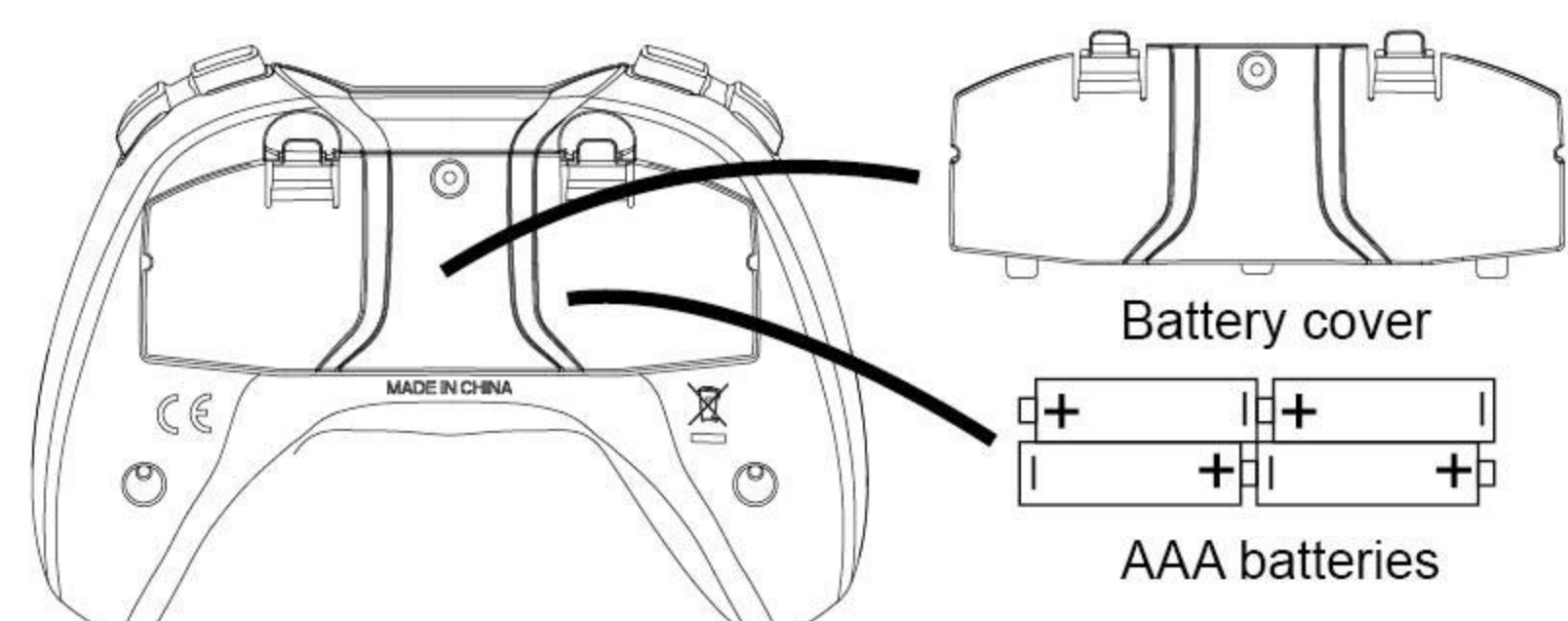

To insert the controller batteries, open the battery cover on the back of the remote control and insert 4 x AAA alkaline batteries, ensuring that you observe the polarity markings (batteries are not included and must be purchased separately).

1. When installing the batteries, ensure that you match the + and - ends of the battery with the + and - signs on the controller.
2. Do not mix old and new batteries.
3. Do not mix different types of batteries.

### Flight preparation and turning the aircraft on/off

#### Pairing the remote control with the aircraft

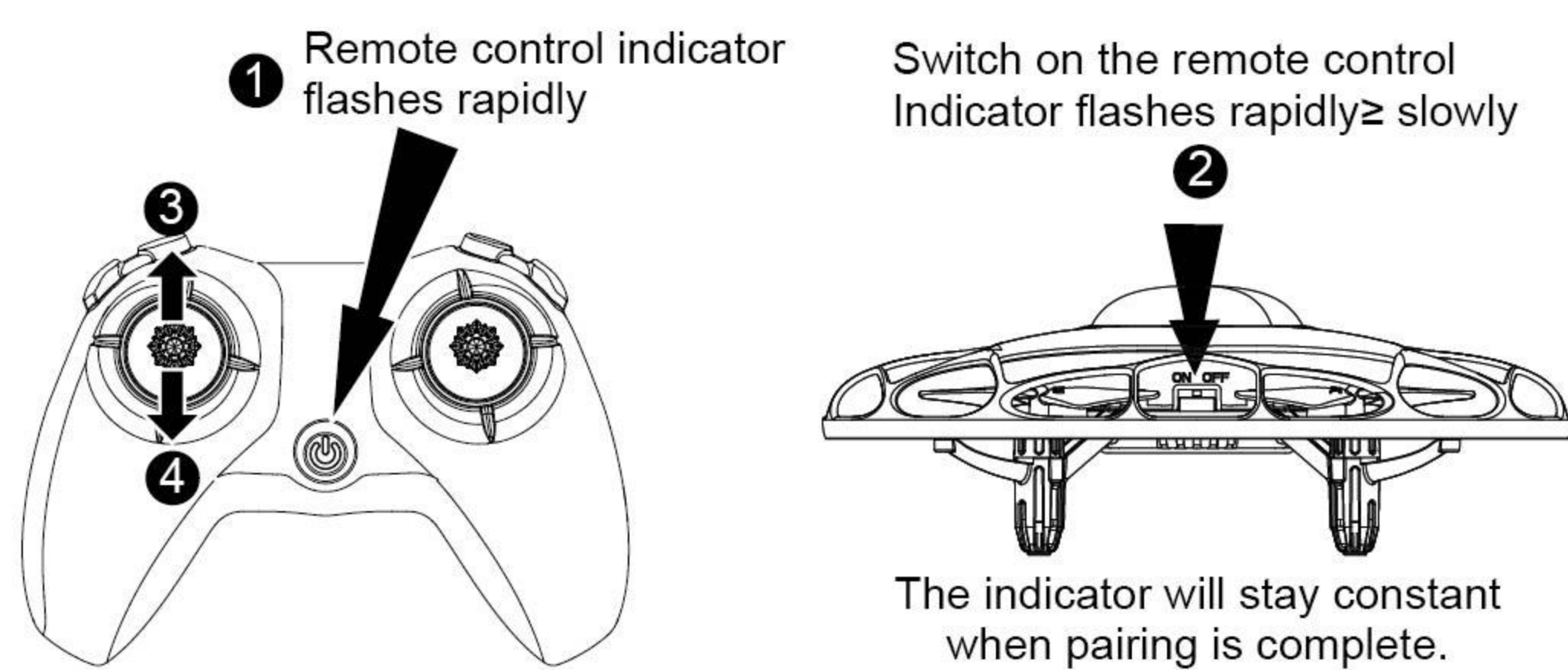

After you switch on the remote control, the indicator will flash quickly to indicate that the remote control is waiting to pair with the quadcopter.

#### Turning the quadcopter on

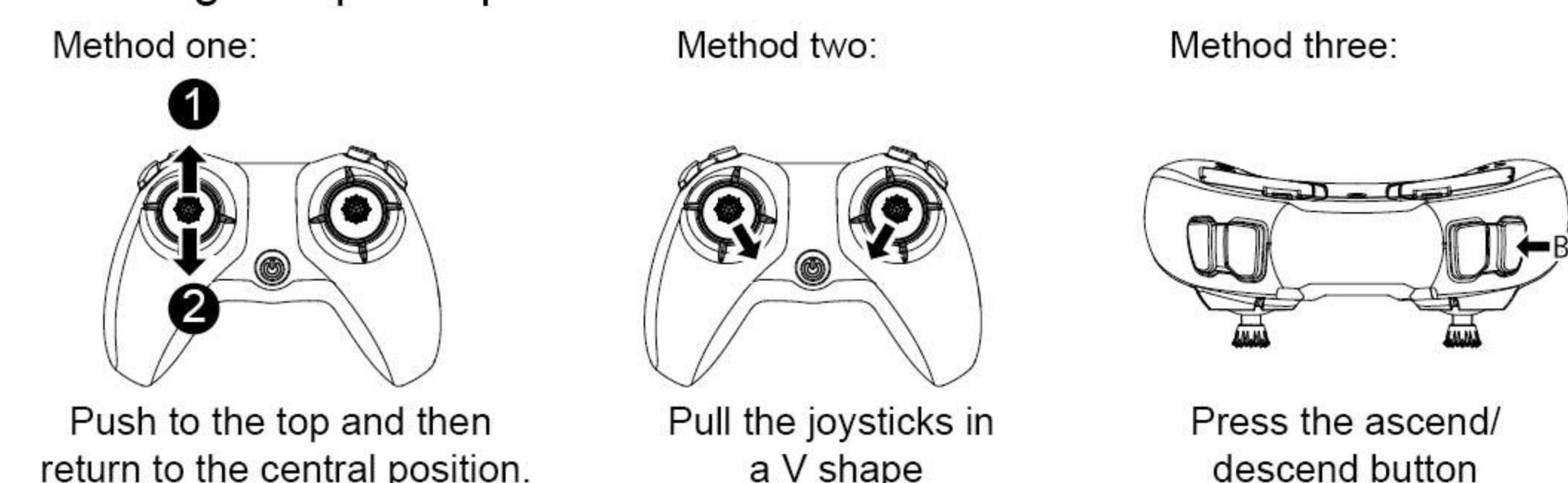

Note: 1. If the aircraft is flown out of range from the remote control, the aircraft indicator light will start to flash and the aircraft will land slowly.  
2. If the remote control suddenly turns off or runs out of power during flight, the aircraft will automatically land and come to a stop. If the remote control

#### Turning the quadcopter off

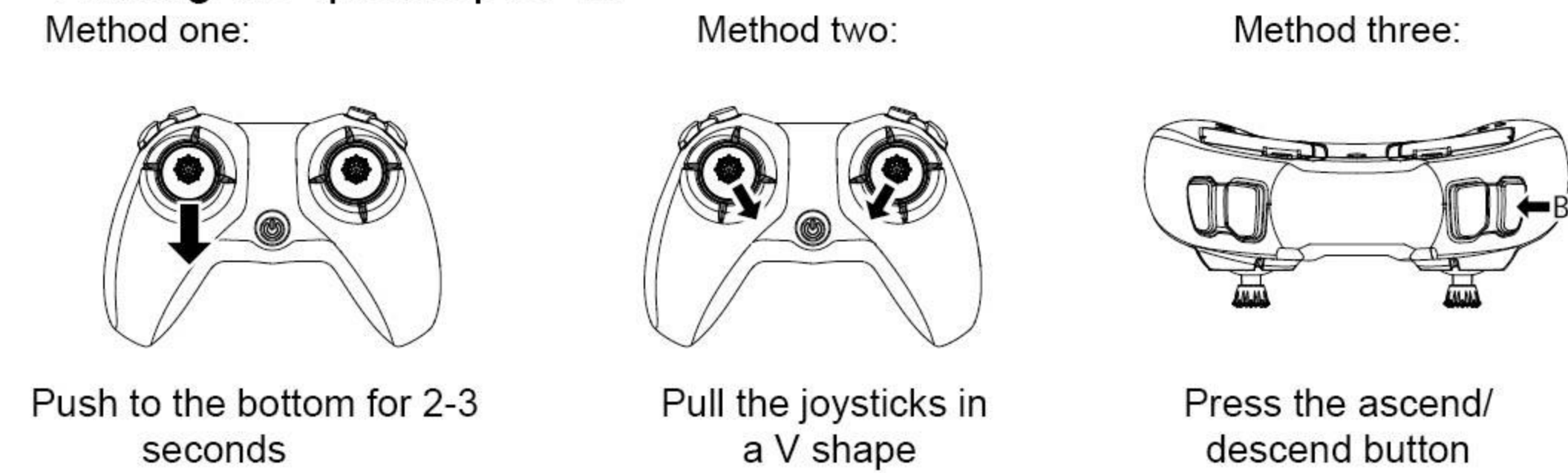

#### Using the remote control

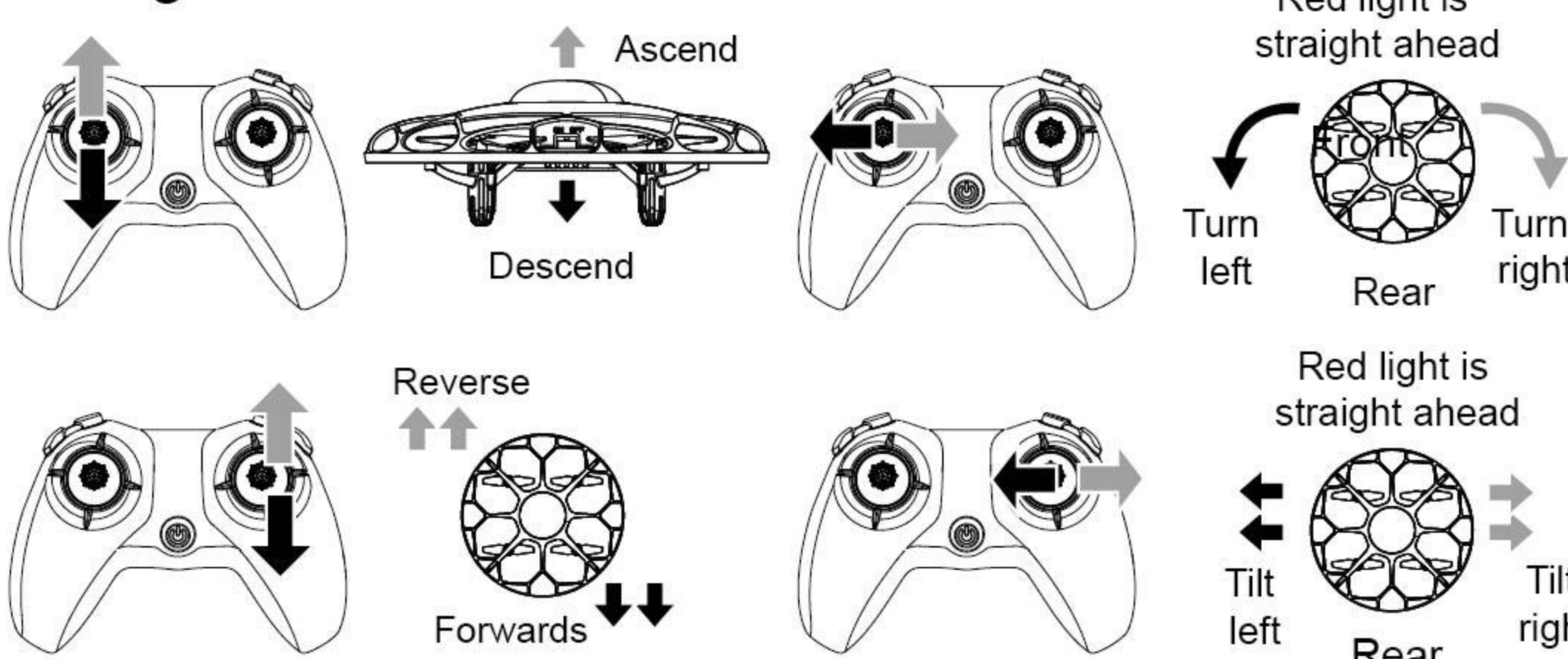

### Trimming

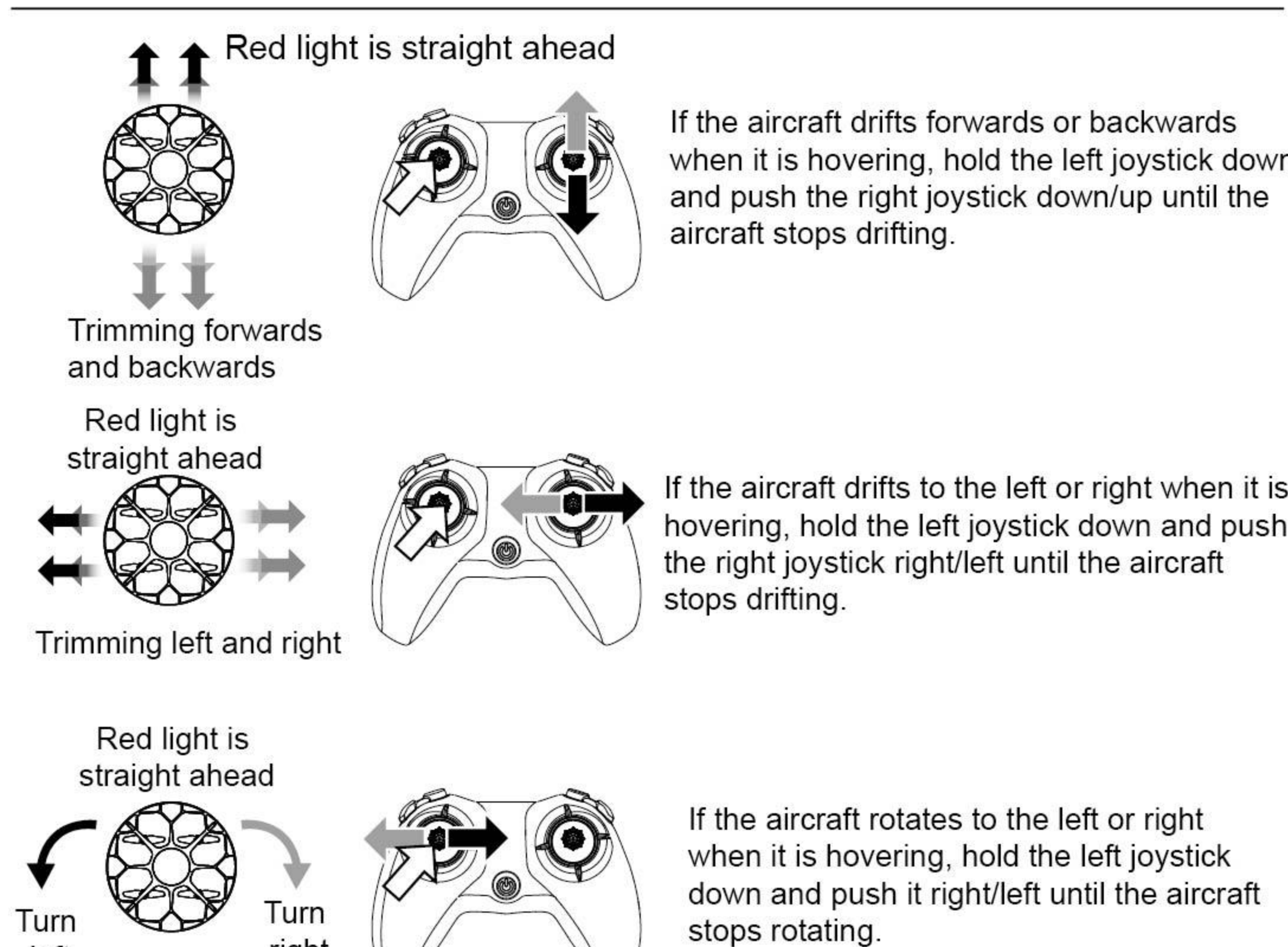

### Stunt manoeuvres (Red light is straight ahead)

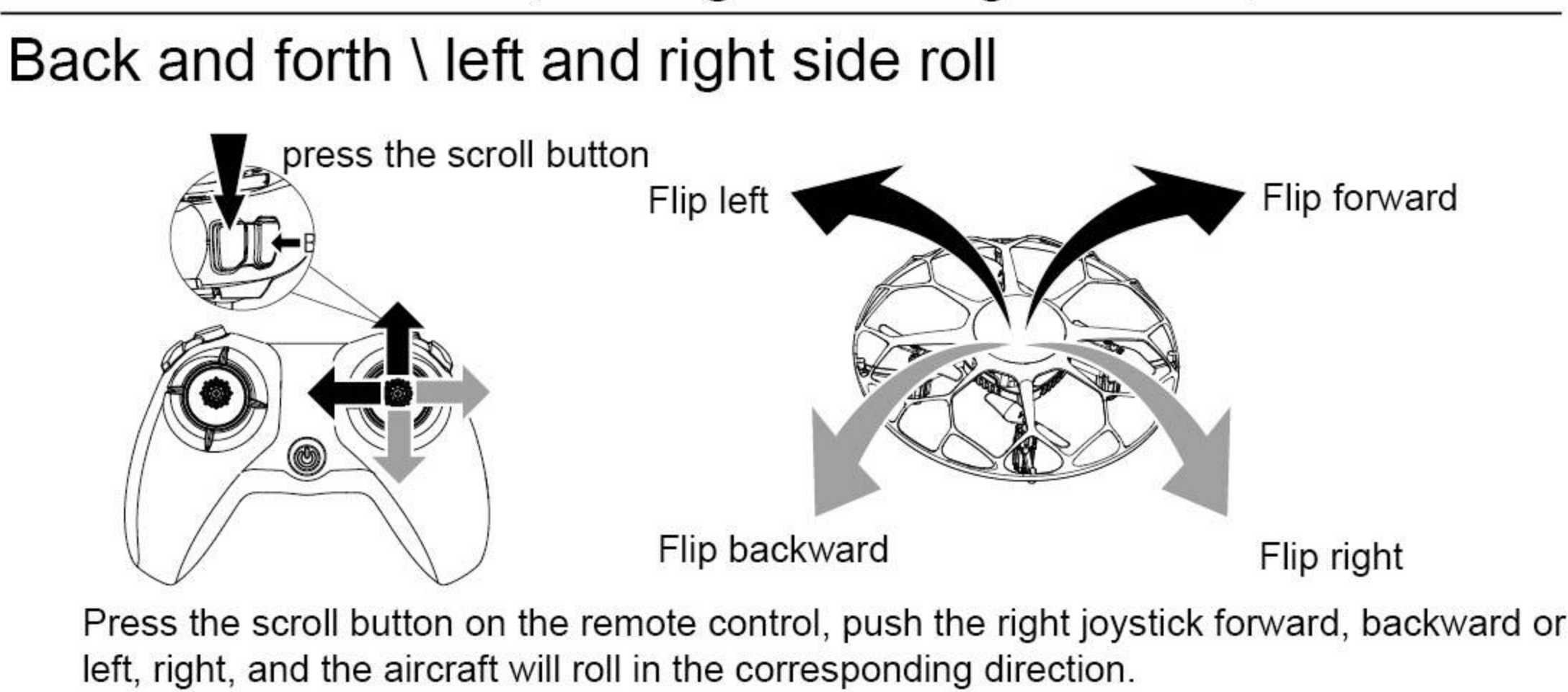

### Diagonal roll

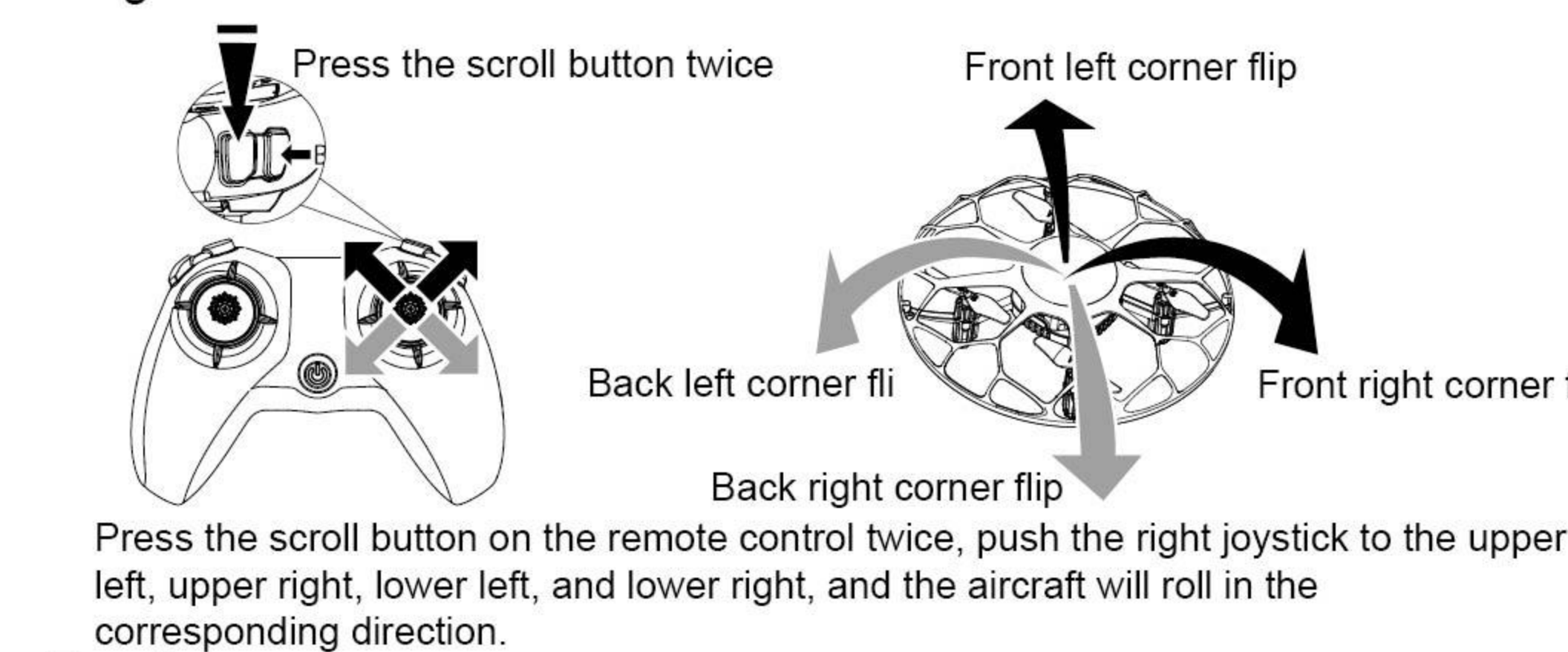

#### To rotate

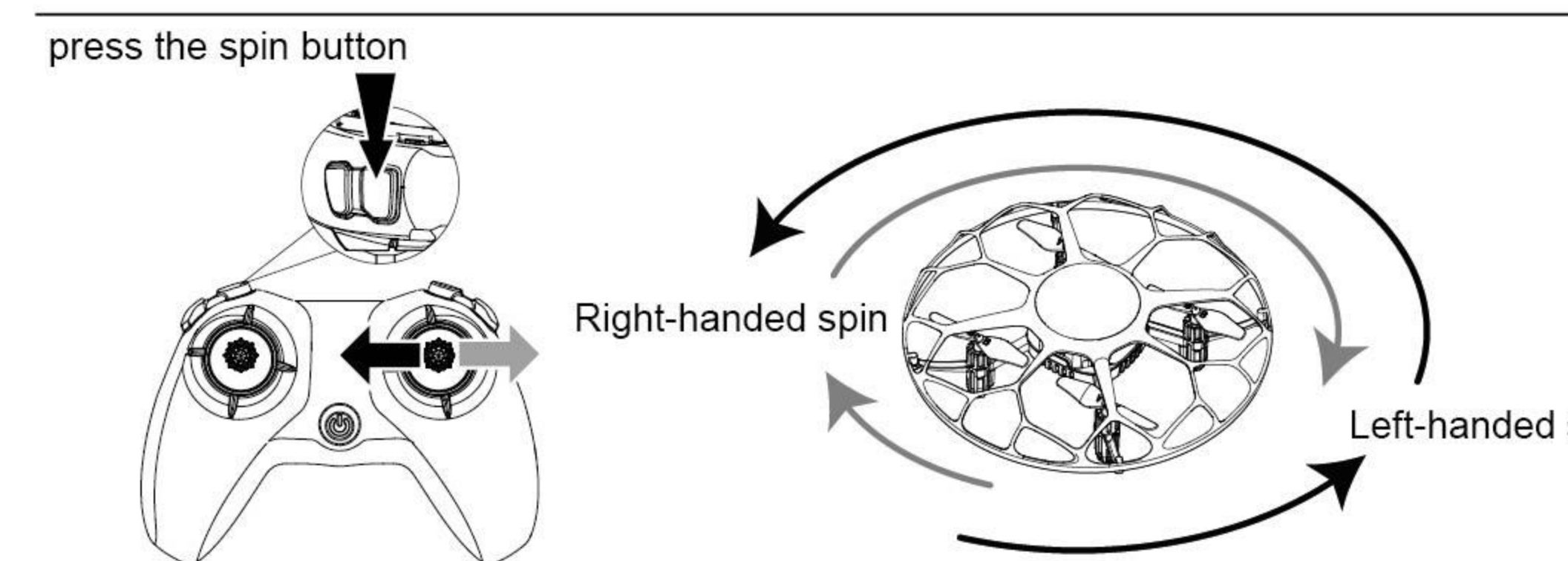

Press the rotation button on the remote control, push the right joystick to the left or right, and the aircraft will rotate a circle in the corresponding direction

#### Press the spin button twice

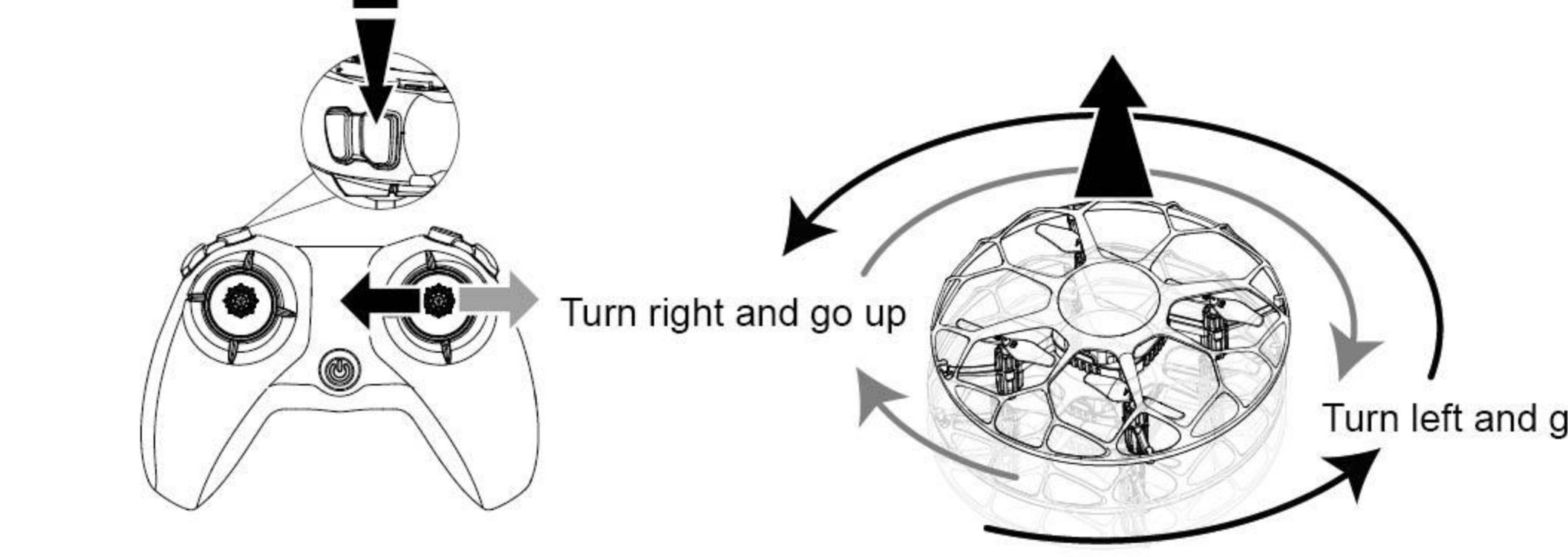

Press the spin button on the remote control twice, push the right joystick to the left or right, and the aircraft will rotate and rise in the corresponding direction

### Fly circle

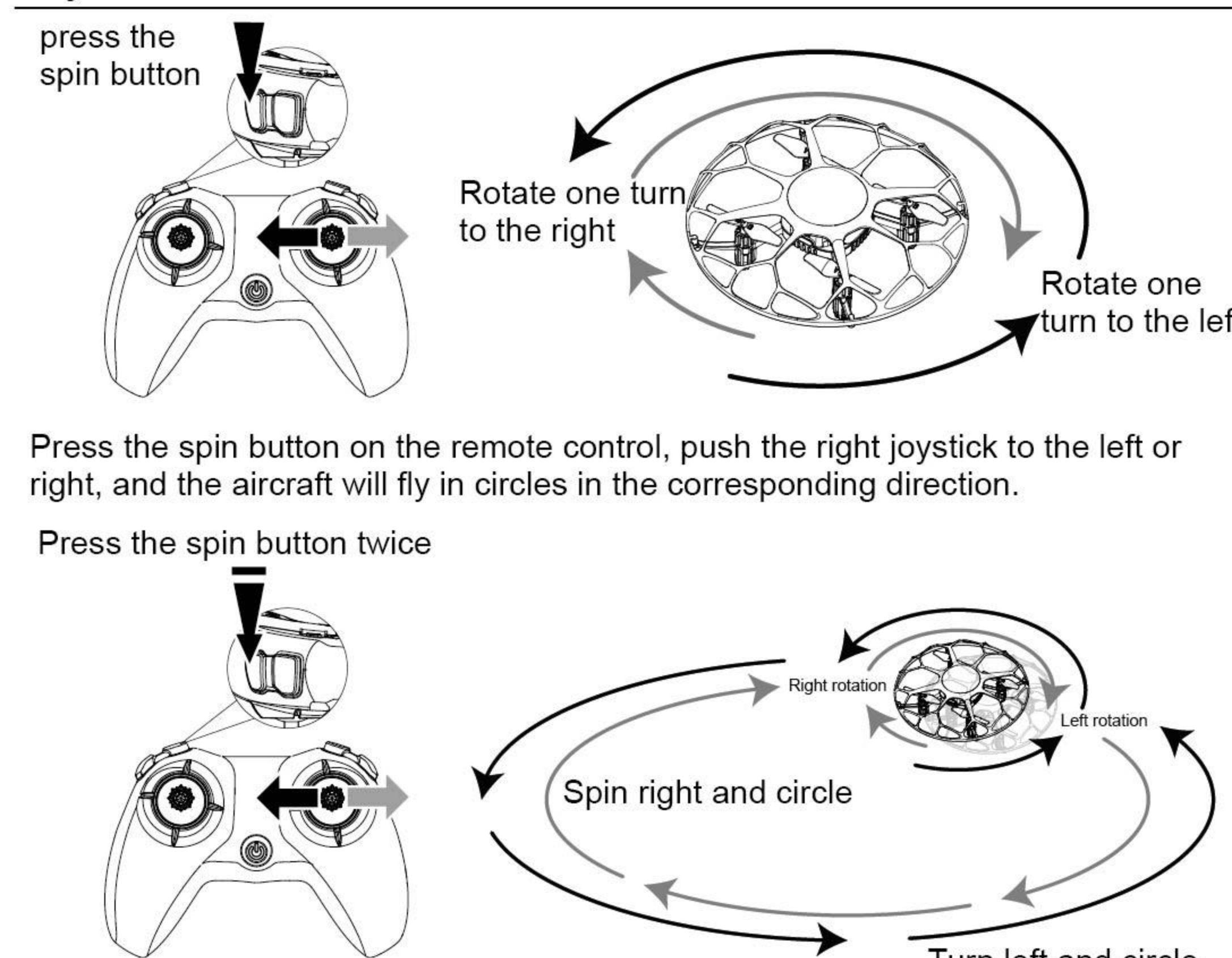

Press the spin button on the remote control twice, push the right joystick to the left or right, and the aircraft will rotate and circle in the corresponding direction flight.

### Stunt functions

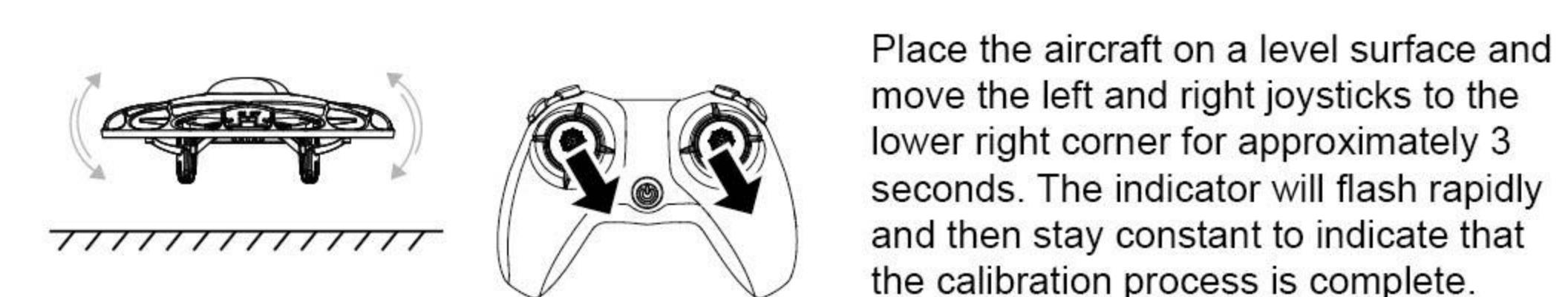
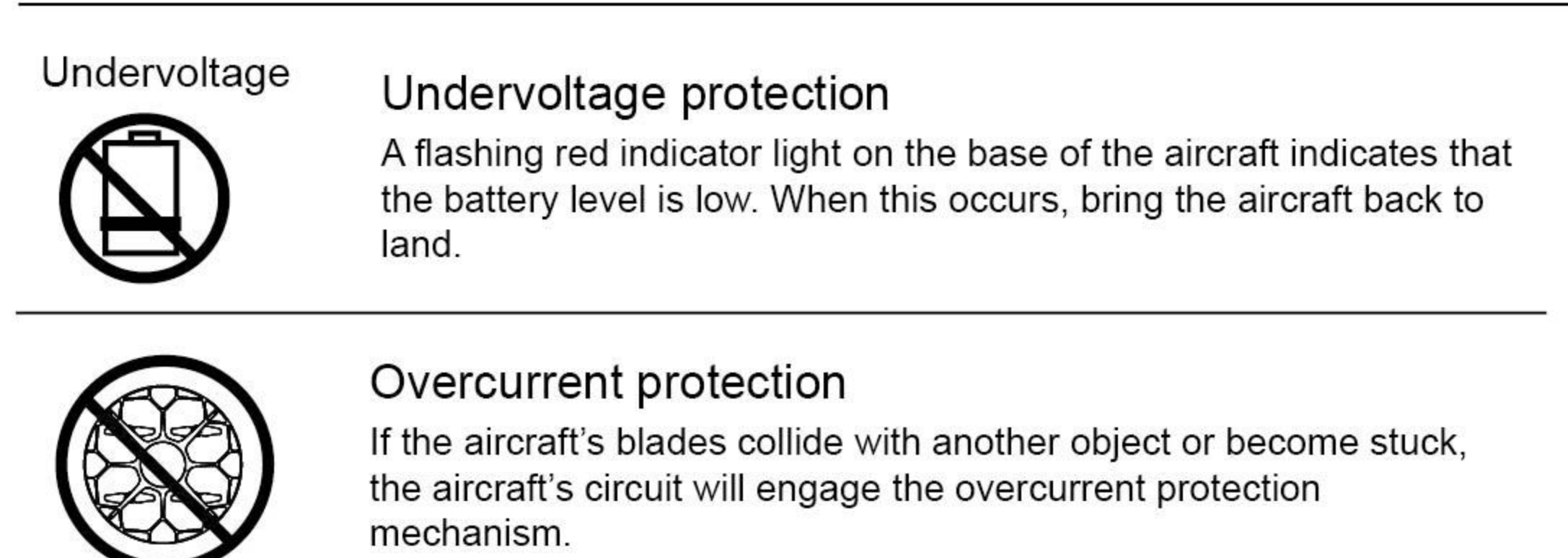

Place the aircraft on a level surface and move the left and right joysticks to the lower right corner for approximately 3 seconds. The indicator will flash rapidly and then stay constant to indicate that the calibration process is complete.

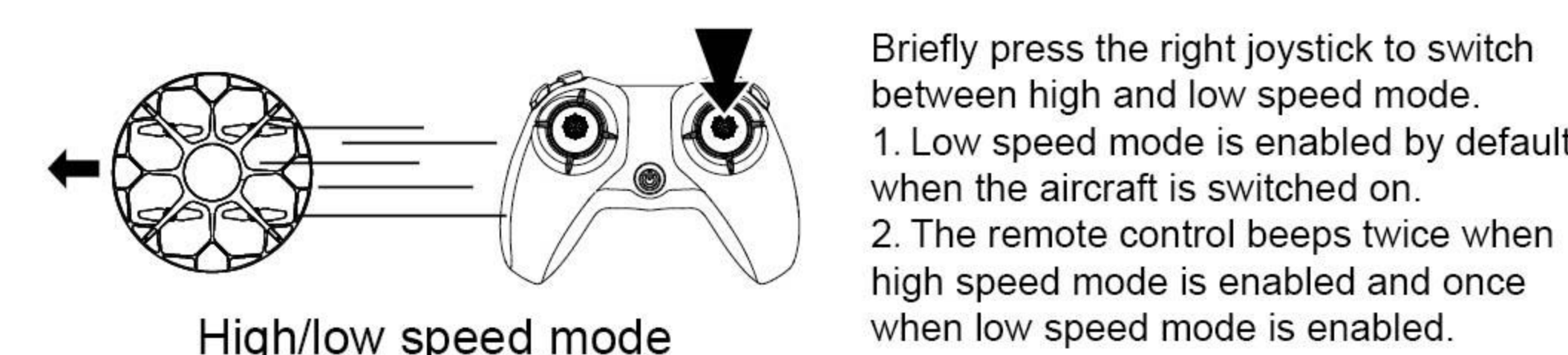

Briefly press the right joystick to switch between high and low speed mode.  
1. Low speed mode is enabled by default when the aircraft is switched on.  
2. The remote control beeps twice when high speed mode is enabled and once when low speed mode is enabled.

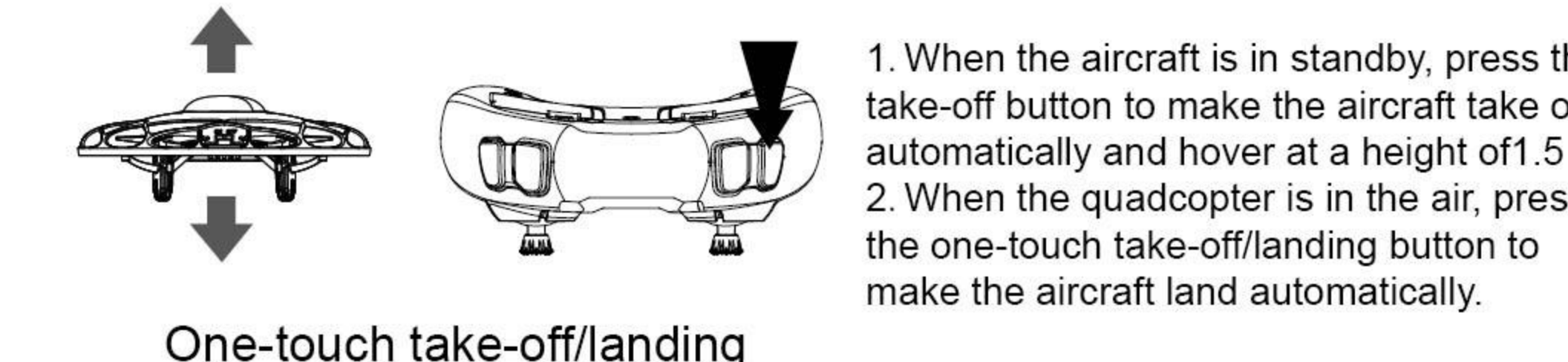

1. When the aircraft is in standby, press the take-off button to make the aircraft take off automatically and hover at a height of 1.5 m.  
2. When the quadcopter is in the air, press the one-touch take-off/landing button to make the aircraft land automatically.

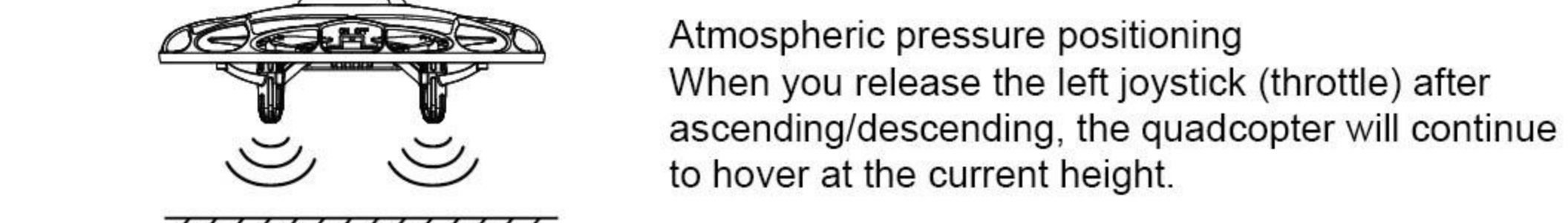

Atmospheric pressure positioning  
When you release the left joystick (throttle) after ascending/descending, the quadcopter will continue to hover at the current height.



Light controls  
The start-up colourful lights default to a gradual change. Press the left joystick or right joystick to left and right during standby mode to change the colourful lights into seven cycles. Press the left joystick during flight to change the colourful lights. Seven times for a cycle.

### Accessories (available separately)

The following section contains a list of optional accessories that are available to purchase. Accessories can be purchased from your local retailer. Please indicate your preferred colour when making your purchase.

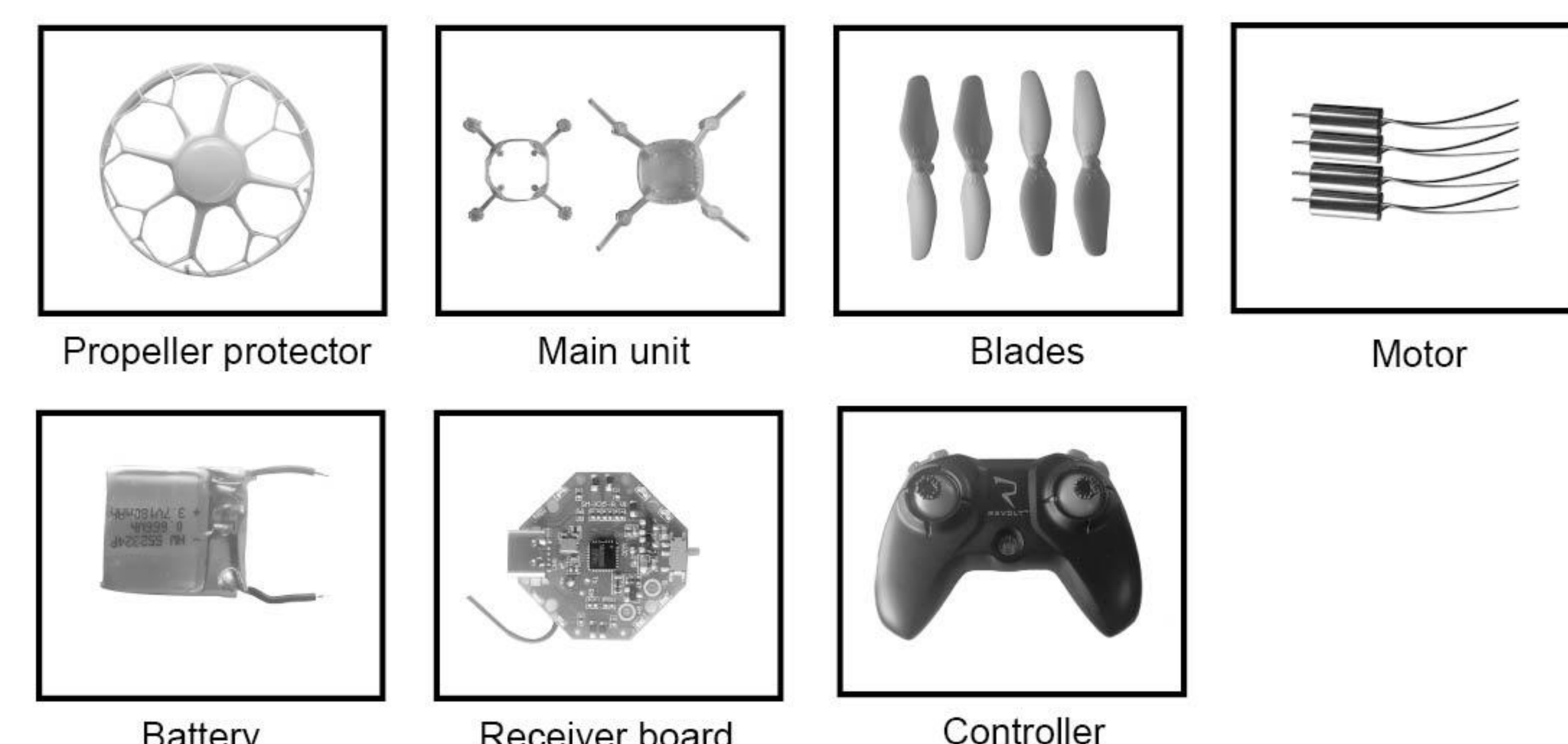

### Rectification Procedures

Problem	Reason	Solution
The drone has no response	1. The drone has entered into low-voltage protection. 2. When the power of the remote control is weak the power light indicator will blink.	1. Charge up the drone. 2. Change the batteries of the remote control.
The flight response of the drone is not sensitive	1. The power of the remote control is weak. 2. There is an interference with the same frequency as that of the remote control.	1. Change the batteries. 2. Change to a place where there is no interference with the same frequency.
The drone is flying towards its side in one direction during hovering	The drone is not calibrated level to the ground.	Re-adjust the calibration until the drone is level to the ground. For further details,
In the headless state, it is biased towards the front direction	Many collisions may cause head drift.	Re-define the front direction. For further details,
Fixed high instability / up and down movement	1. The drone is not calibrated level to the ground. 2. Unstable air pressure under the severe weather condition. 3. Violent collision resulting in data disorder of gyroscope.	1. Re-adjust the calibration until the drone is level to the ground. For further details, 2. Avoid to fly under the severe weather condition. 3. Make level adjustment again,

Warning: Changes or modifications to this unit not expressly approved by the party responsible for compliance could void the user's authority to operate the equipment.

NOTE: This equipment has been tested and found to comply with the limits for a Class B digital device, pursuant to Part 15 of the FCC Rules. These limits are designed to provide reasonable protection against harmful interference in a residential installation. This equipment generates, uses and can radiate radio frequency energy and, if not installed and used in accordance with the instructions, may cause harmful interference to radio communications. However, there is no guarantee that interference will not occur in a particular installation. If this equipment does cause harmful interference to radio or television reception, which can be determined by turning the equipment off and on, the user is encouraged to try to correct the interference by one or more of the following measures:

- Reorient or relocate the receiving antenna.
- Increase the separation between the equipment and receiver.
- Connect the equipment into an outlet on a circuit different from that to which the receiver is connected.
- Consult the dealer or an experienced radio/TV technician for help.

\*This device complies with FCC radiation exposure limits set forth for general population (uncontrolled exposure). This device must not be collocated or operating in conjunction with any other antenna or transmitter.

RF frequency band : 2408-2472MHz  
Transmitter power : <math>-3.7\text{d}Bm</math> (Max.)  
Sold to EU country  
product name: [Drone]  
model number: [X35T]  
Brand name: SYMA  
Contact person: Ivan  
Tel: +86-0754-86381701

Hereby, [GUANGDONG SYMA MODEL AIRCRAFT INDUSTRIAL CO., LTD], declares that this [aircraft ] is in compliance with Directive 2014/53/EU. The full test of the EU declaration of conformity is available at the following internet address: <http://www.symatoys.com/down/declaration-of-conformity.html>  
SIMPLIFIED EU DECLARATION OF CONFORMITY

Manufacturer:  
Guangdong SYMA Model Aircraft Industrial Co., Ltd.  
Address: 2 West Xingye Rd, Laimei Industrial Area, Chenghai, Shantou, China  
Postal Code: 515800  
Sales department: +86 0754 86390668  
After-sales service: +86 0754 86395095  
Fax: +86 0754 86395098  
Website: www.symatoys.com  
Email: syma@symatoys.com

The company has the right of final interpretation of this user manual.