

X *GYRO REMOTE CONTROL SERIES* **8SC 2.4G**

4-CHANNEL PRESSURE FIXED POSITION HOVERING
REMOTE CONTROL DRONE

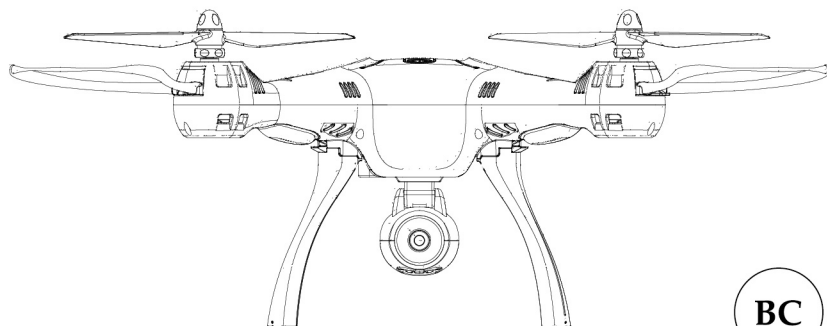

BC

USER MANUAL

MAIN FEATURES

- Utilizes the 4-axis structure, enabling the drone to be even more flexible, speedy, and possessing a relatively stronger wind-withstanding capability. It can fly both in large indoor spaces and outdoors.
- Built-in 6-axis gyro stabilizer to ensure accurate positioning in-flight.
- The structure uses a modular design which makes it easy to install and repair.
- Headless function making it easy for directional control.
- Pressure-fixed-position hovering function for Auto Hover Mode.
- 360° stunt flip.
- High quality aerial function for getting the fun of different photography.

Safety Guide

1. Please store the smaller-sized drone accessories in places that are out of reach of children.
2. This drone is very powerful. For all first-time flights, the left joystick must be slowly pushed up in order to prevent the drone from ascending too fast to avoid unnecessary collision and possible damage or injury.
3. When the flight is ended, first turn off the power of the remote control. Then turn off the power of the drone.
4. Avoid placing the batteries in places with high temperatures and exposure to heat.
5. Take extra precaution to ensure that the drone is at a minimum distance of 15 feet from the pilot, other people, and animals in order to prevent bodily injury during flight operation. A minimum separation distance of 20 cm must be maintained between the user's body and the device under normal use condition.
6. This drone is for people ages 14+. It must be flown always within the line of sight of the pilot (or instructor) and flown safely.
7. Non-rechargeable batteries are not to be recharged; Batteries are to be inserted with the correct polarity; Different types of batteries or new and used batteries are not to be mixed.
8. When the drone is not in use, please remove the batteries in the remote control.
9. The supply terminals are not to be short-circuited.
10. Attention: Drone assembly under adult supervision.
11. The pilot is responsible for the safe operation and safe distance from uninvolved persons and property on the ground and from other airspace users and shall never fly the drone above crowds (> 12 persons).
12. Discharge the battery to 40%-50% (On a full charge, fly for half of the total flight time) if it will not be used for 10 days or more, this can greatly extend the battery life.

Repair and maintenance

1. Use dry and soft cloth to clean this product.
2. Avoid exposing this product to heat.
3. Do not immerse this product in water, otherwise, the electronic parts will be damaged.

4.Transformers used with the toy are to be regularly examined for damage to the cord,plug,enclosure and other parts,and that,in the event of such damage,the toys must be used with this transformer until the damage has been repaired.

Package Description

The following items can be found in this product package:

- Drone
- Remote Control
- Instruction Manual
- Screwdriver
- Card Reader
- Main Blades
- Charger
- Protective Gear
- Camera
(Contain Memory Card)
- Wrench



Installation/Removal Procedures For Protective Gear

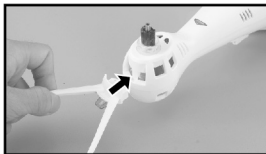

Protective Gear Installation:

1. Push the protective gear into the connector on the main body as shown.

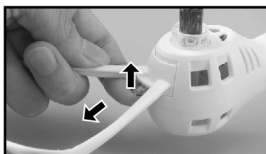

Protective Gear Removal:

1. Pull up the protective gear according to the figure and at the same time pull the protective gear outwards as shown.

Blade Installation/Removal

Blade installation:

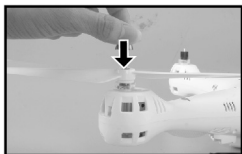
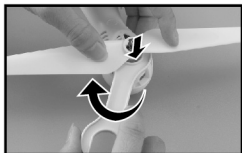
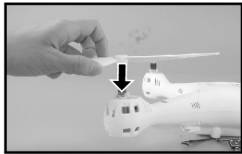

1. Blade is inserted as shown.
2. Use a wrench to fasten the hexagonal nut under the base of the main axis, then press blade A onto the axis. Turn the blade counterclockwise to lock it in. Blade B is locked in by turning it clockwise.

3. Attach blade cover as shown.

Blade removal:

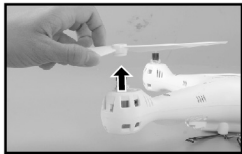
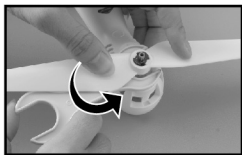
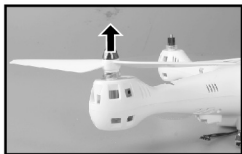

1. Remove the blade cover as shown.

2. Use a wrench to fasten the hexagonal nut under the base of the main axis, then press blade A onto the axis. Turn the blade clockwise to loosen it. Blade B is loosened by turning it counter-clockwise.

3. Remove the blade.

NOTE: Make sure to match the marking on the blade "A" or "B" with the body base marking "A" or "B".

Installation/Disassembly Steps For High-Definition Camera

Installation steps for camera

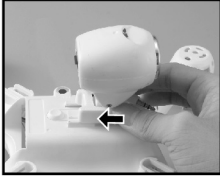

1. Aim the camera at the interface and push it as left image.

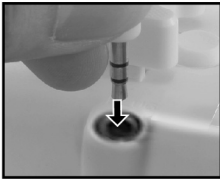

2. Connect the camera cable into the socket as left image.

Dismantling steps for camera

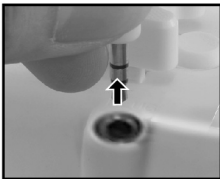

1. Pull out the camera cable from the socket as left image.

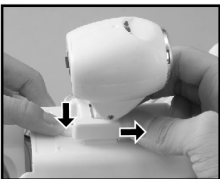

2. Press the camera locked button and pull camera out at the same time.

Note: After switching on the power of the drone, do not insert or pull out the plug that connects to the drone on the high-definition camera.

Battery Changing And Charging Methods For Drone

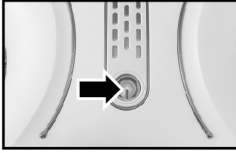

1. Press the power button on the top of the drone to make sure the drone is turned "OFF".

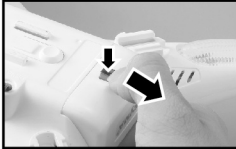

2. Press and hold the fastening component underneath the battery and pull the battery out at the same time.

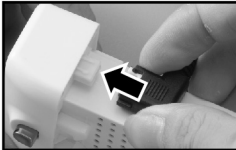

3. Connect the plug from the charger into the port in the battery, then connect the charger into the charging cradle. The indicator light will turn on while charging and turn off when charging is complete. It takes 150 minutes to completely charge the battery.

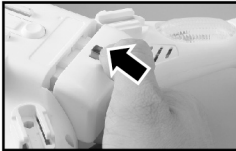

4. After the battery is fully charged, put the the battery back into the drone.

The charging time is about 150 minutes; Hover flight time is approximately 9 minutes.

Precautions as follows during charging of battery:

- Avoid placing the active batteries in places with direct exposure, sunlight and high temperatures. For example, naked light or electrical equipment installations; otherwise it may cause damages or explosions.
- Avoid immersing the batteries in the water. The batteries shall be stored in a cool and dry place.
- Avoid dismantling the batteries.
- During the charging of battery, avoid leaving the charging place.
- Rechargeable batteries are to be removed from the toy before being charged;
- Rechargeable batteries are only to be charged under adult supervision;
- Exhausted batteries are to be removed from the toy;
- Caution: Risk of explosion if battery replaced by an incorrect type, dispose of used batteries according to the instructions.