



BW UNV WRLS PWRBNK

Model: BWB18WI109

## PRODUCT GUIDE

Ver.00 Rev.07/04/18

### Welcome Guide

Portable Charger / BW UNV  
WRLS PWRBNK

Contents:

Before getting started, ensure the package contains the following components:

Power Bank

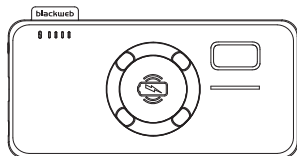

1ft USB charging cable  
Micro B to A



Adapter



### Safety and Compliance

Read all the instructions before using the product.

- To reduce the risk of injury, close supervision is necessary when the product is used near children.
- Don't put finger or hand into product.
- Do not expose power bank to rain or snow.
- Use of a power supply or charger not recommended or sold by power pack manufacturer may result in a risk of fire or injury to persons.
- Do not use the power bank in excess of its output rating. Overload outputs above rating may result in a risk of fire or injury to persons.
- Do not use the power bank that is damaged or modified. Damaged or modified batteries may exhibit unpredictable behavior resulting in fire, explosion or risk of injury.
- Do not disassemble the power bank. Take it to a qualified service person when service or repair is required. Incorrect reassembly may result in a risk of fire or injury to persons.
- Do not expose a power pack to fire or excessive temperature. Exposure to fire or temperature above 100°C may cause explosion.
- Switch off the power bank when not in use.
- If your power bank will not be used for an extended period of time, please take the following steps once every three months to ensure proper function:
  - Charge the power bank

- Discharge the power bank by using it to supply power to a mobile device.
- Recharge the power bank for 6 hours
- Store the power bank in a cool, dry place to avoid short-circuiting and damaging the product.
- Do not store or transport the product with metal objects.
- Clean only with dry cloth, avoid cleaning the power bank with rough or chemical objects.
- The device is not a toy. Keep it out of the reach of children and pets.
- Protect the product from extreme temperatures, direct sunlight, strong jolts, flammable gases, vapors and solvents.
- Protect the product against high humidity and wet conditions.
- Prevent the product from undergoing any mechanical stress.
- If it is no longer possible to operate the product safely, stop using it and prevent further or accidental use. Safe operation can no longer be guaranteed if the product:
  - is visibly damaged,
  - is no longer working properly,
  - has been stored for extended periods in poor conditions,
  - has been subjected to any serious transport-related stress.
- Please handle the product carefully. Jolts and impacts

- can damage the product.
- Also observe the safety and operating instructions of any other devices connected to the product.
- Never use the product immediately after it has been brought from a cold room into a warm one. Condensation could destroy the product.
- Allow the device to warm up to room temperature before connecting and using it. This may take a few hours.
- Never leave the product unattended during use.
- Make sure not to squeeze, bend or in any way damage the cable.
- If this device is intended by Purchaser to be used by a minor, purchasing adult agrees to provide detailed instructions and warnings to any minor prior to use.
- Failure to do so is sole responsibility of purchaser, who agrees to indemnify Manufacturer for any unintended use/misuse by a minor.
- If you find that our device is excessively hot, is emitting odor, is deformed, abraded, cut or is experiencing or demonstrating an abnormal phenomenon, immediately stop all product use and contact Manufacturer.
- To comply with FCC RF exposure compliance requirements, the wireless charging base must be used with a separation distance of at least 10cm from all persons.

- Do not disassemble the device into its parts and do not try to change or repair it by yourself. It does not contain serviceable parts and in this case the guarantee expires.
- Do not insert objects intended for use into the product opening. There is short circuit danger.
- Do not operate the device with wet hands.
- Please do not use water or chemical substances to clean the device. Please only use a dry cloth.
- It is normal that during the use the device produces heat.
- Do not cover the product during use.
- Do not use the device if it has visible damages or has become wet.
- If you have a pacemaker or another technical implant, consult your physician or the constructor of the implant, before you use the inductive charge station.
- The socket must be next to the device and easily accessible.
- When you position the device, pay attention that nobody steps on the cable or trips over it. Do not put objects on the cable.
- Do not open the adapter box. With the open box there may be a danger of life threatening electric shock. It does not contain serviceable parts.
- Operate the adapter only on earthed sockets with AC 100-240V~, 50/60 Hz. If the power supply is not safe at the installation site, ask the competent power supplier.
- To interrupt the power supply of your device, disconnect the power supply from the power socket. When disconnecting, always hold the adapter. Never pull the cable.

- Do not expose or store the device and include adapter in high-temperature environment, including heat caused by intense sunlight or other forms of heat. Do not place device in fire or other excessively hot environments.

### Rechargeable battery

- The rechargeable battery is built into the product and cannot be replaced.
- Never damage the rechargeable battery. Damages to the casing of the rechargeable battery might lead to an explosion or a fire.
- Do not throw the rechargeable battery or the product into fire. Danger of fire and explosion.
- Never charge the rechargeable battery when the product is unattended.
- When charging, place the product on a heat-proof surface. It is normal for the product to be warm to the touch during charging.
- Do not modify or alter the product.

### SAVE THESE INSTRUCTIONS

#### FCC Information

This device complies with Part 15 of the FCC Rules. Operation of this product is subject to the following two conditions: (1) this device may not cause harmful interference, and (2) this device must accept any interference received, including interference that may cause undesired operation.

Warning: Changes or modifications not expressly approved by the party responsible for compliance with the FCC Rules could void the user's authority to operate the equipment.

NOTE: This equipment has been tested and found to comply with the limits for a class B digital device, pursuant to Part 15 of the FCC Rules. These limits are designed to provide reasonable protection against harmful interference in a residential installation. This equipment generates, uses and can radiate radio frequency energy and, if not installed and used in accordance with the instructions, may cause harmful interference to radio communications. However, there is no guarantee that interference will not occur in a particular installation. If this equipment does cause harmful interference to radio or television reception, which can be determined by turning the equipment off and on, the user is encouraged to try to correct the interference by one or more of the following measures:

- Reorient or relocate the receiving antenna.
- Increase the separation between the equipment and receiver.
- Connect the equipment into an outlet on a circuit different from that to which the receiver is connected.
- Consult the dealer or an experienced technician for help. Shielded cables must be used with this unit to ensure compliance with the Class B FCC limits.

### Compatibility

- Your power bank has 2 output ports.
  - USB-A Output: 5V/2.4A Max
  - Wireless Output: 5W, Apple 7.5W, Samsung 10W

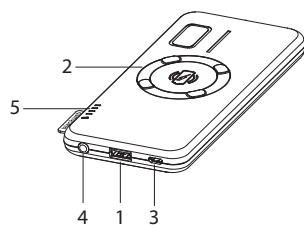

1. USB-A Output Port
2. Wireless Output
3. Micro USB Input Port
4. Power button
5. LEDs

### Specifications

Battery capacity	10000mAh/ 37Wh
Cell type	Li-Polymer battery
LEDs	1 LED of Wireless+4 LEDs of Powerbank
Protection function	Short circuit, over current, overcharge, over discharge, over voltage
Input	Micro USB: 5V/2A, 9V / 2A
Rated output	USB-A: 5 V / 2.4 A Max Wireless: 5W, Apple 7.5W, Samsung 10W (Under any condition Priority Wireless Output, and USB-A output will cut off)
Working temperature	32 ~95 °F (0~35 °C)
Dimensions (L x W x D)	6.10 x 3.19 x 0.74 in. (155x81x18.9mm)
Weight	9.77 oz (277 g)
Qi-version:	Version 1.2.4
Status display:	LED lamp, see <i>Powerbank LEDs and Wireless LED</i>
Protection:	Temperature protection, short circuit protection, Over Current protection, Over Output Power Protection, FOD, Stray Metal Parts Detection
Cover-friendly: Yes	Yes (depending from cover material and thickness. Maximum 5mm and no metal.)

### Adaptor

Model	BLJ-QC06HU
Input	100~240V~50/60Hz 0.5A
Output	5V/3A, 9V/2A, 12V/1.5A Standard mode: 9V/2A
Dimensions (L x W x D)	2.74 x 1.67 x 0.91 in. (69.56x42.5x23mm)
Weight	5.04 oz (143g)

### PowerBank Part: Power Button

This product is inserted into the device, will automatic startup When your powerbank is under On status, Long-press power button to turn off powerbank. When your Powerbank is under OFF status, short - press the power button to turn on power bank and indicate battery level. Then LEDs will automatically turn off after 3~4s, and power bank will automatically turn off after 30~40s when include cable disconnect from your device or remove your device from the inductive charge station. Battery running out, product automatic shutdown.

### Power Overload Protection

Your power bank has overload protection. To protect your power bank and your connected device in an overload situation, charging stops.

## Charging The Portable Battery

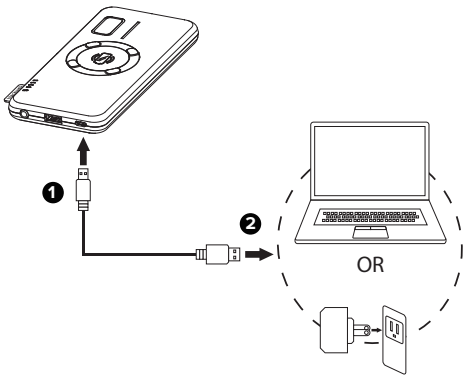

1. Plug the Micro USB-B connector of the charging cable into the Micro USB-B ports on your power bank.
2. Plug the USB-A connector into a power source, like an AC power adapter (included) or a USB-A ports of a computer. The Powerbank LED lights will turn on to show the current battery level. When fully charged, 2~5 LED lights will stay lit.

### Note:

When the LED2 blinks, it indicates that the power bank is running out of power and must be recharged.

## Wireless Part:

### Operation

#### 1. Status display LED

The actual operating condition of device will be displayed by the status LED. The Wireless LED will turn yellow when the charge procedure starts. If the LED is switched off, the charge procedure is concluded or there is no Qi-compatible terminal to be charged on the inductive charge station. If the LED flashes red, there is an error, for example because the device has become warm, a foreign body is between the devices or a noncompatible adapter is used.

#### 2. Starting-Up / Charging Connected Devices

##### Step 1: Preparation

Connect the supplied micro USB cable with the micro USB connection (IN) of the inductive charge station and connect the other USB cable end with a USB adapter. Then connect the adapter with a socket (by complying with the safety instructions mentioned above).

##### Step 2: Start charge procedure

Position your Qi-compatible device in the middle on the inductive charge station. The charge procedure starts automatically and the status LED turns yellow.

If this is not the case, please check (if):

- a) There is a foreign body between the devices.
- b) Whether your adapter is a compatible adapter.
- c) Your device is Qi-compatible.
- d) The cable ends and the devices are connected correctly.

## Caution

Charging status: Don't move your phone

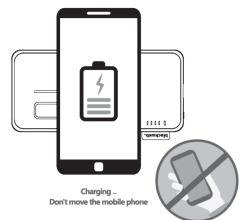

No metal object between devices and wireless charger

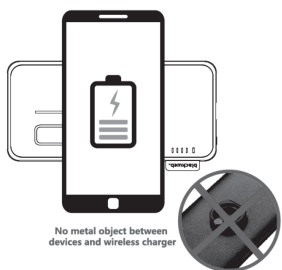

## Checking The Power Level

When the power bank is neither charging nor being charged, you can check the battery level by pressing the power button. See the table below:

LEDs	Status/Power level
○○○○○ 1 LED	Wireless LED, detail see <b>Wireless LED</b> part
○●○○○ 2 LED blink	< 3%
○●●○○ 2 lit	Between 3%~25%
○●●●○ 2~3 lit	Between 25% ~ 50%
○●●●● 2~4 lit	Between 50% ~ 75%
●●●●● 2~5 lit	Between 75% ~ 100%

## Charging Devices

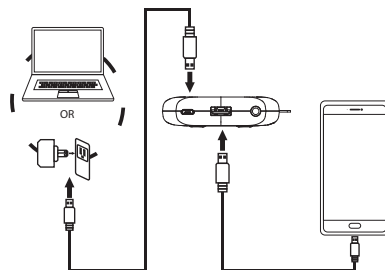

e) Where there is the correct position on your device for the wireless charge. In case, you must change position.

### Step 3: Complete charge procedure

To complete the charge procedure, simply remove your device from the inductive charge station.

### Exclusion of liability

Changes to the firmware and / or hardware can be made at any time without prior notification. For this reason it is possible that parts of the manual, technical data and images in this documentation may deviate slightly from the product in your hand. All products described in this manual are only for the purpose of clarification and must not necessarily match any certain situation. No claims can be made based on this manual.

### Note:

If this equipment does cause harmful interference to radio or television reception, which can be determined by turning the equipment off and on, the user is encouraged to try to correct the interference by one or more of the following measures:

- Reorient or relocate the receiving antenna
- Increase the separation between the equipment and receiver.
- Connect the equipment into an outlet on a circuit different from that to which the receiver is connected.
- Consult the dealer or an experienced technician for help.

## Troubleshooting

### My power bank doesn't charge.

- Make sure that the USB charging cable is connected correctly.
- If you're using an AC power outlet, make sure that the outlet is properly powered.
- If you're using a computer USB port, make sure that the computer is turned on and the USB port is properly powered.
- If none of the above solves the issue, your power bank may be damaged. Replace your power bank.

### My power bank doesn't charge a device

- Make sure that you have connected the USB cable of your device to the output port of your power bank and the input port on your device. See chapter **Charging your device**.
- Your power bank may be turned off. Press the power button to turn on your power bank.
- Make sure that your power bank is charged. See chapter **Checking the power level**.
- Your power bank has overload protection. If your power bank detects a power overload, it stops charging and all the LEDs turn off. Disconnect the cable, wait a few minutes, then try charging again.

First plug the cable's connector of your device into the input port on your device, then plug the other connector into one of the output ports of your power bank.

### Note:

- To charge your device we recommend that you use the original cable that came with your device or the charging cable of your power bank (included). Using other cables may significantly reduce the charging speed (or prevent the charging altogether).
- The power bank output current is just what your power bank is able to deliver, but the actual charging current depends on your devices.
- Your charger is very matter to your power bank input current as well.
- Under the status of charging and discharging is going at the same time, and Powerbank runs out of power. USB A port or Wireless will close the output until battery level reach to 25%.

## Wireless LED

Status	Your device:
Power on or Micro USB in devices	the red LED is on and retention time 3S, then turns off
Standby	the red LED is on and keep 3S, then turns off
Charging	the yellow LED is on
Your Qi-compatible device is fully charged	the green LED is on and hold 10S, then turns off
FOD or abnormal occurrence	the red LED blinks
remove your device from the inductive charge station	Wireless LED is off

## Powerbank LEDs

	Your power bank:
All Powerbank LEDs are OFF, then the one Powerbank LED turns on	Is charging. As the power level increases, the number of lit Powerbank LEDs changes from up to down. When your power bank is fully charged, all four Powerbank LEDs light. OR Is charging a device. As your power bank's power level decreases, the number of lit Powerbank LEDs changes from down to up
All four Powerbank LEDs are on	Fully charged
Upmost Powerbank LED blinks	Battery is low
All four Powerbank LEDs are off	Needs to be charged

## Portable Wireless Charger working

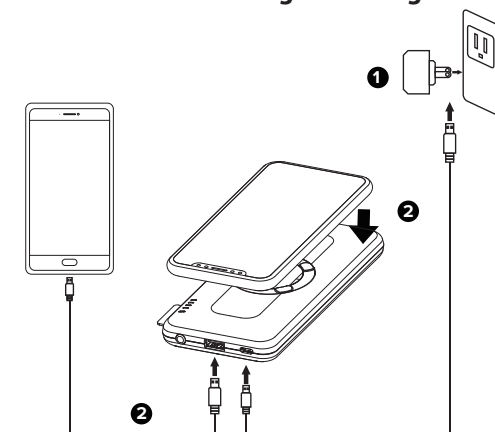

### Note:

1. At any status, Wireless output is priority. USB A port will close when Wireless is output;
2. Under the status of charging and discharging is going at the same time, and Powerbank runs out of power. USB A port or Wireless will close the output until battery level reach to 25%;
3. When wireless device are fully charged, product will power off automatically in 30-40s.

## Disposal



Electronic devices are recyclable waste and must not be disposed of in the household waste.



At the end of its service life, dispose of the product according to the relevant statutory regulations. The built-in rechargeable battery must be disposed of by a specialist.

## Rechargeable battery

You as the end user are required by law (Battery Ordinance) to return all used rechargeable batteries. Disposing of them in the household waste is prohibited.



Contaminated rechargeable batteries are labelled with this symbol to indicate that disposal in the domestic waste is forbidden. The designations for the heavy metals involved are: Cd = Cadmium, Hg = Mercury, Pb = Lead (name on rechargeable batteries, e.g. below the trash icon on the left). Used rechargeable batteries can be returned to collection points in your municipality, our stores or wherever rechargeable batteries are sold.



Wal-Mart Stores, Inc., Bentonville, AR 72716  
Hotline: 1-800-925-6278

MADE IN CHINA