

Smart Mini Vibe Quick User Guide

Model Name: SMV01

Brand Name: Magic Motion

FCC ID: QSESMV01

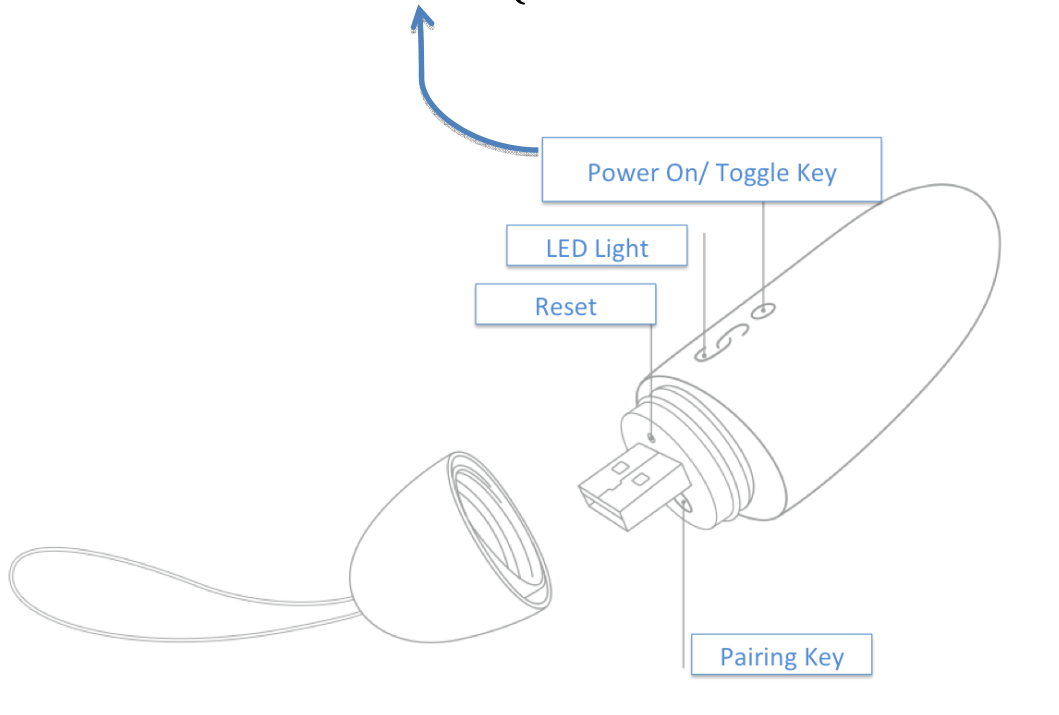

- **Power On**

Press the Power On/ Toggle key for 2 seconds to switch on, then the LED will flash once and the device will vibrate for 0.5 seconds.

- **Power Off**

Press the Power On/ Toggle key 2 seconds, then LED flash once.

- **Charging Battery**

The Smart Mini Vibe includes a li-ion rechargeable battery, Twist off the cap to reveal the USB Charging Port, then charge it with a USB charger, or plug it into a Computer USB Port for battery charging.

Charging: Smart Mini Vibe LED on.

Charging Completed: Smart Mini Vibe LED off.

Low Battery: When the battery is low, the device cannot be powered on or it will turn off immediately after turning on.

(Notice: For the first time using the device, deplete the battery fully then charge for 4 hours continually.)

● Smart Phone Control Mode

First Time Use:

Step 1: Download the Magic Motion App.

Visit iTunes to Download the Magic Motion App, use smart phone to scan the QR Bar on the giftbox, or visit the below website directly:

<https://itunes.Apple.com/us/App/id679035540?mt=8>

Step 2: Switch on Bluetooth on the smart phone, then run the Magic Motion App.

On the smart phone: "Settings" → "Bluetooth," select "On," then run the Magic Motion App.

Step 3: Pairing

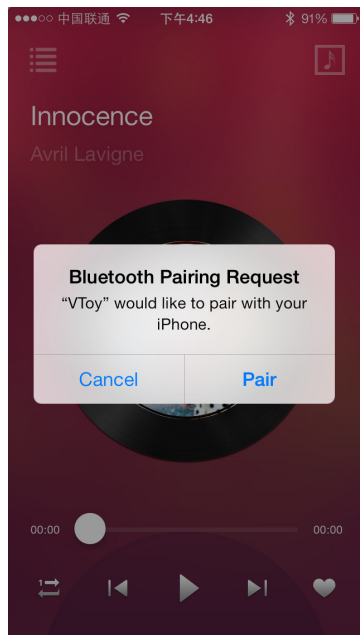

Prepare for Pairing:

Power on the device, take off the cap by rotating counter-clockwise, and hold the Pairing Key for 3 seconds. The Smart Mini Vibe LED will flash quickly (0.5 seconds intervals).

Pairing Process:

Run the Magic Motion App, click "refresh," and a pairing request will pop up. Click "Pair" to pair.

Pairing Success

When the pairing is successful, The Smart Mini Vibe LED quick flashes for 2 seconds, then keeps the light on.

Smart Magic Control

When the pairing is successful, the user can select multiple controlling modes. The LED will blink following the vibration frequency.

When the pairing is successful, if the user doesn't use for a long while, the LED will turn off. Please turn off the Magic Motion App if you don't use it for an extended period of time.

Re-Connect:

Re-connect a paired Smart Mini Vibe with the Magic Motion App: the device will auto-connect when the device is switched on and the Magic Motion App is running. Please make sure the device is within the range of the smart phone Bluetooth coverage. If Magic Motion & the Smart Mini Vibe are not connected, click “refresh” to connect.

Re-Pairing:

When you need to pair the device with another smart phone, quit the current Magic Motion App and download the Magic Motion App on another smart phone, then run it. After running the App, press and hold the Smart Mini Vibe Pairing key for more than 3 seconds to enter into the pairing process.

- **Manual Control Mode**

- a. Changing the Mode manually:

Turn on the Smart Mini Vibe, but do not run the Magic Motion App. Press the “Power On/ Toggle Key” for 1 second or less to toggle different vibration modes. There are a total 7 vibration modes available.

- b. Turn off automatically:

When the Smart Mini Vibe is on, the LED will keep flashing every 2 seconds if it is not connected with Magic Motion App. It will automatically turn off after 5 minutes of no use.

- **Magic Motion App Brief Introduction**

- **Magic Control**

Magic Motion has 7 vibration modes, including: Music Player、Voice、Scenes、Sensor、Custom、Manual、Games.

Music Sync

The user can add their favorite songs to Magic Motion via iTunes、FTP、or WiFi.

Background/Remote Control

Switch Magic Motion to background mode, then run third-party voice or video Apps, such as Line, Skype, or Wechat to have a conversation; the voice can control the vibration frequency.

More Magic Motion functions can be discovered based on other apps.

Notice:

- **Before the Usage:**

Please clean the Smart Mini Vibe with cleanser or warm water and anti-bacterial soap for first time use. We suggest using water-lubricants with the Smart Mini Vibe to enhance the experience.

Charge the battery according to this user manual.

- **In Use:**

We recommend using together with a condom. Select the proper vibration mode; stop using the device if there is discomfort or tingling.

- After Usage

After using, clean the device and dry it.

- Storage

Keep the device in a cool, ventilated place. Avoid leaving your Smart Mini Vibe in direct sunlight, and keep it out of the reach of children.

FAQ

1、 Question: Why do I need to pair? Can I directly use it when I run the Magic Motion App?

Answer: For safety reasons, the pairing can avoid any mis-links with other smart phones.

2、 Question: Why can't it be paired with previous phones when it is paired with the current phone?

Answer: It is for security concerns from Apple Inc. You can ignore previous devices in the Bluetooth settings and re-pair it again.

3、 Question: By powering on the phone, why can't the Smart Mini Vibe connect with the phone automatically since it has already been paired?

Answer: You can run the Magic Motion App and click "Refresh." 20 seconds later, it will connect automatically.

4. Question: What's the use of the small hole close to the USB connector?

Answer: Use a needle to press the small hole to reboot if anything abnormal happens. When the battery runs out, charging the device can return it to the default setting.

For more questions, please check the Magic Motion Setting → Help

This device complies with part 15 of the FCC rules. Operation is subject to the following two conditions:

(1) this device may not cause harmful interference, and

(2) this device must accept any interference received, including interference that may cause undesired operation.

Changes or modifications to this unit not expressly approved by the party responsible for compliance could void the user's authority to operate the equipment.