

**ST-28**

**§ Multi-Player §**

**User's Manual**

# Multi-Player Controls

## Multi-Player

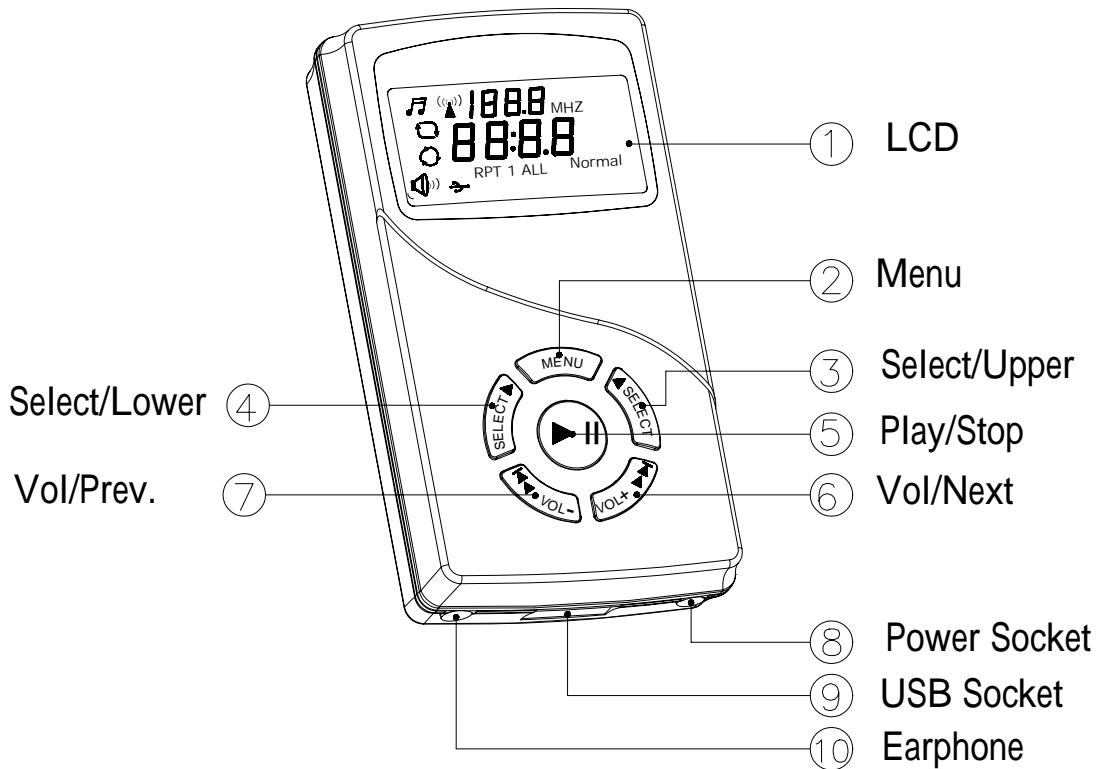

### Key Instructions

Item	Symbol	Title	Description
1		LCD	Display the functions
2	MENU	Menu	1.Play mode 2.Frequency setup
3	SELECT	Select/Lower	Adjust the lower frequency/ Performance mode
4	SELECT	Select/Upper	Adjust the Upper frequency/ Performance mode
5		Play /Stop	Start/stop a song over
6	VOL+	Vol/Next	Skip to next song/ Change the volume lower to press simultaneously for seconds
7	⏮ VOL-	Vol/Prev.	Skip to previous song/ Change the volume louder to press simultaneously for seconds
8		Power socket	For external power-supply
9		USB socket	USB docking
10	🎧	Earphone	For earphone use

## LCD Illustration

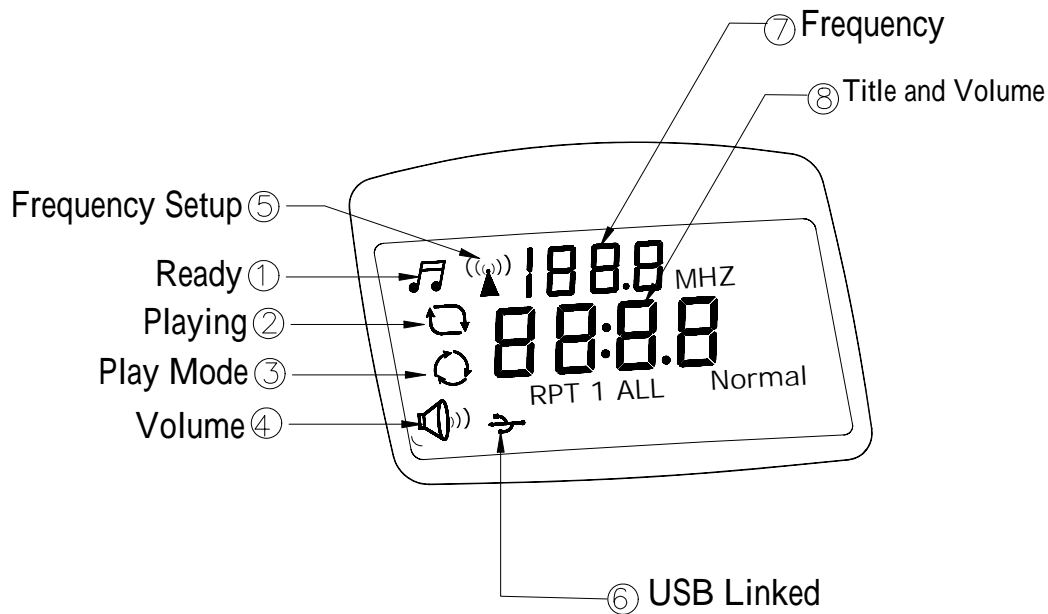

## The description of Symbol on LCD

Item	Symbol	Title	Description
1		Sound Ready	The music is standby
2		Playing	Playing the music
3		Play mode select	Select the play mode Press MENU button when the “ ” appears, then press SELECT or ▼SELECT button to select the items. Play Mode : 1.RPT1 2.RPT ALL
4		Volume setting	The symbol appears when setup volume. After the symbol disappears, then press the VOL+ or VOL- to adjust the volume level.
5	/ 188.8	Frequency setting	When setup the frequency, press MENU button twice and then the symbol  appears. Press ▼SELECT/SELECT button to adjust the frequency., The last frequency will be saved, after several seconds , then the frequency will show the last one used in use next time .
6		USB Storage	The symbol appears ,since The USB storage has been to link with multi-player.
7		Playing time/Vol./Item	This symbol shows the playing time/volume level/item Press the VOL+▶▶▶or ◀◀◀ VOL- to select the item.

## Accessories

### 1. Description

<b>Item</b>	<b>Title</b>	<b>Suitable</b>	<b>Features</b>
01	Desktop	DC 100~240V 5V/1A	Pleasing design and used easily on the desk
02	Cradle Holder	16V/24V	Used in the car and plug-in cigar lighter
03	Power Bank	AC100~240V 5V/1A	Portable and can be Charged when DC idle, suitable for home and in car
04	Desktop Speaker	AC100~120V DC 12V/1A	As speaker. Putting the Multi Player in the desktop speaker for use easily and perform the sound out.

### 2. Wire Accessories

<b>Item</b>	<b>Title</b>	<b>Suitable</b>	<b>Features</b>
A	Travel Charger	AC100V~240V	High voltage charging effectively.
B	Earphone		Portable and easy for personal use
C	Saver Charger	13.5V	High voltage charger. Plug into the cigar lighter to supply the power to Multi player or charge the power bank.
D	USB Cable		Link the PC with Desktop to transmit or store the data to/from the USB storage device.

### 3. Specification:

- 1、 Output FM Range : 88.1MHz~107.9MHz
- 2、 Frequency Adjustment : 0.2 MHz/per step
- 3、 Smart/Auto power saving design
- 4、 High quality fidelity, full stereo sound
- 5、 Big LCD with back light lamp
- 6、 Compatible : USB storage device、 HDD Enclosure、 Card reader

# Accessories Illustrations

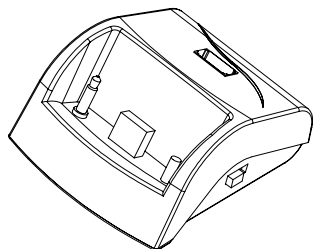

01 Desktop

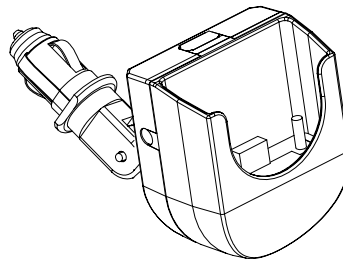

02 Cradle Holder

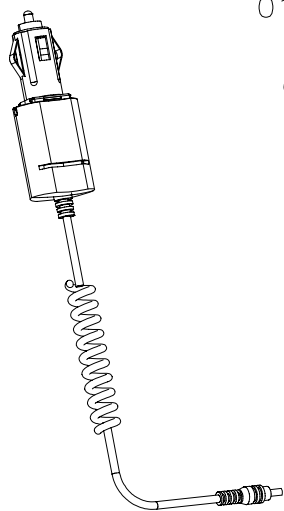

C Saver Charger

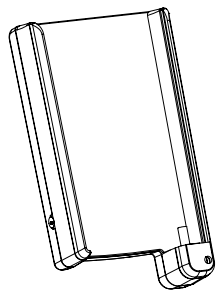

03 Power Bank

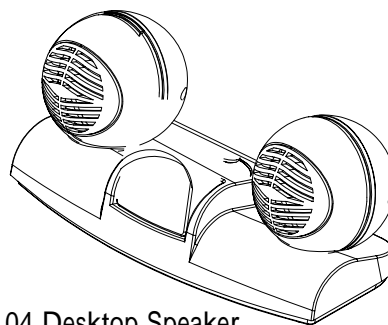

04 Desktop Speaker

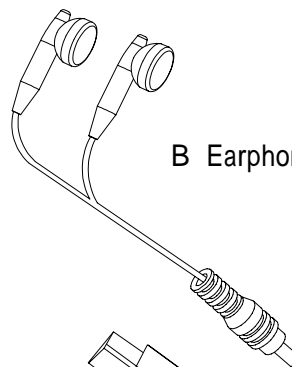

B Earphone

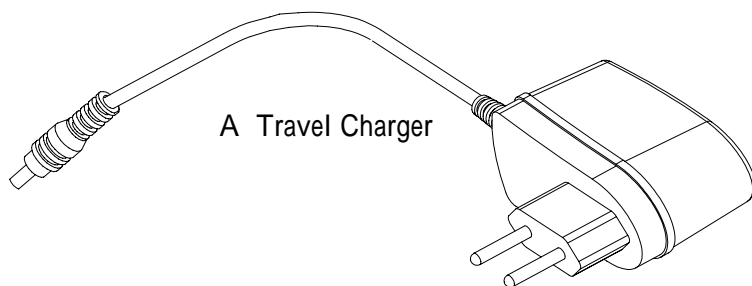

A Travel Charger

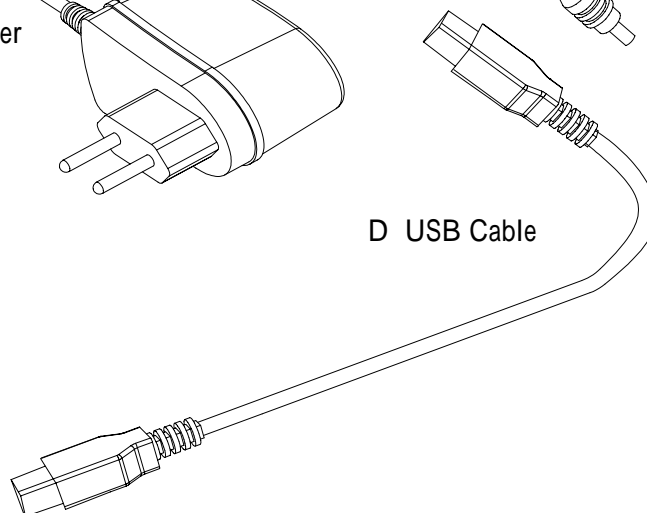

D USB Cable

## 【01 Desktop】

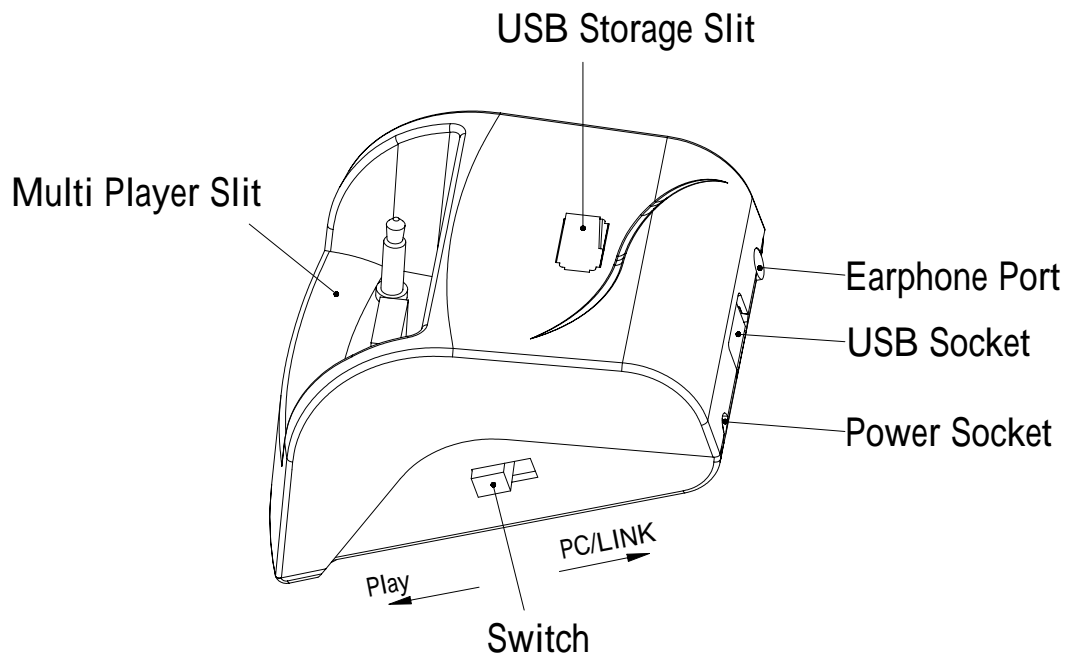

### **Suitable Voltage/Current :**

Travel Charger : AC 100~240 DC 5V/1A

### **Usage of Multi Player + Desktop + Accessories :**

- 1、 With FM Stereo ( Figure 1. )
- 2、 With Earphone ( Figure 2. )
- 3、 With External Speaker ( Figure 3. )
- 4、 Linked with PC to Storage device ( Figure 4. )

Multi Player and FM stereo Installation (Figure 1.)

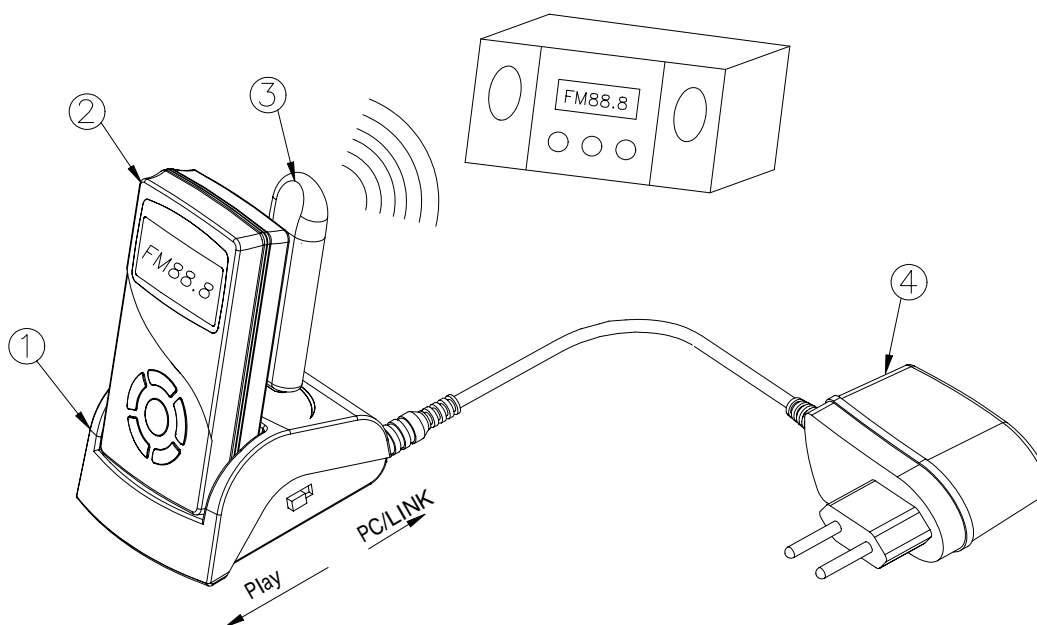

### Assembling Method :

- 1、 Plug in the AC Adaptor④ to a wall plug; plug in the DC Jack to power socket of the Desktop.
- 2、 Install the Multi-Player② to the Multi Player Slit①.
- 3、 Install the USB Flash Memory Stick③ to the USB slit.
- 4、 Change the Switch beside the desktop to “Play” side.

### Operation Method :

1. Set the FM Radio Frequency of home stereo to none-used Radio Frequency ( such as 88.1 )
2. Press the MENU button of the ②Multi-Player twice and find out the (▲) symbol for radio frequency setting,
3. When the symbol flash, press ▼SELECT / SELECT▲ button to set up the same radio channel with Stereo Radio Frequency. ( When the Stereo become totally mute, the connecting completed )
4. Press ► Play/Stop button to transmit the music to the Stereo.
5. Adjust the required volume by adjust the VOL+ ►► / ◄◄ VOL- button. Or, adjust the volume of the car stereo.

### Caution :

- 1、 Ensure the switch in the “Player” side, or Multi player will not work.

## Multi Player and Earphone Installation (Figure 2.)

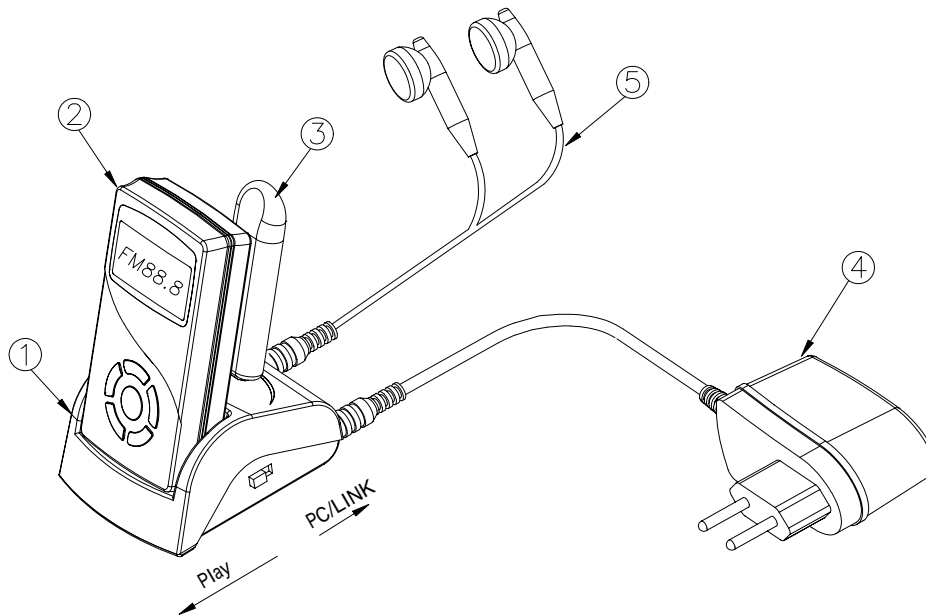

### Assembling Method :

- 1、 Plug in the AC Adaptor④ to a wall plug; plug in the DC Jack to power socket of the Desktop.
- 2、 Install the Multi-Player② to the Multi Player Slit①.
- 3、 Install the USB Flash Memory Stick③ to the USB slit.
- 4、 Install the earphone jack into the earphone socket⑤ in the back of desktop.
- 5、 Change the Switch beside the desktop to “Play” side.

### Operation Method :

1. Set the FM Radio Frequency of home stereo to none-used Radio Frequency ( such as 88.1 )
2. Press the MENU button of the ②Multi-Player twice and find out the (▲) symbol for radio frequency setting,
3. When the symbol flash, press ▼SELECT / SELECT▲ button to set up the same radio channel with Stereo Radio Frequency. ( When the Stereo become totally mute, the connecting completed )
4. Press ► Play/Stop button to transmit the music to the Stereo.
5. Adjust the required volume by adjust the VOL+▶▶ / ◀◀ VOL- button. Or, adjust the volume of the car stereo.

### Caution :

- 1、 Ensure the switch in the “Player” side, or Multi player will not work.



## Multi Player and External Speaker Installations (Figure 3.)

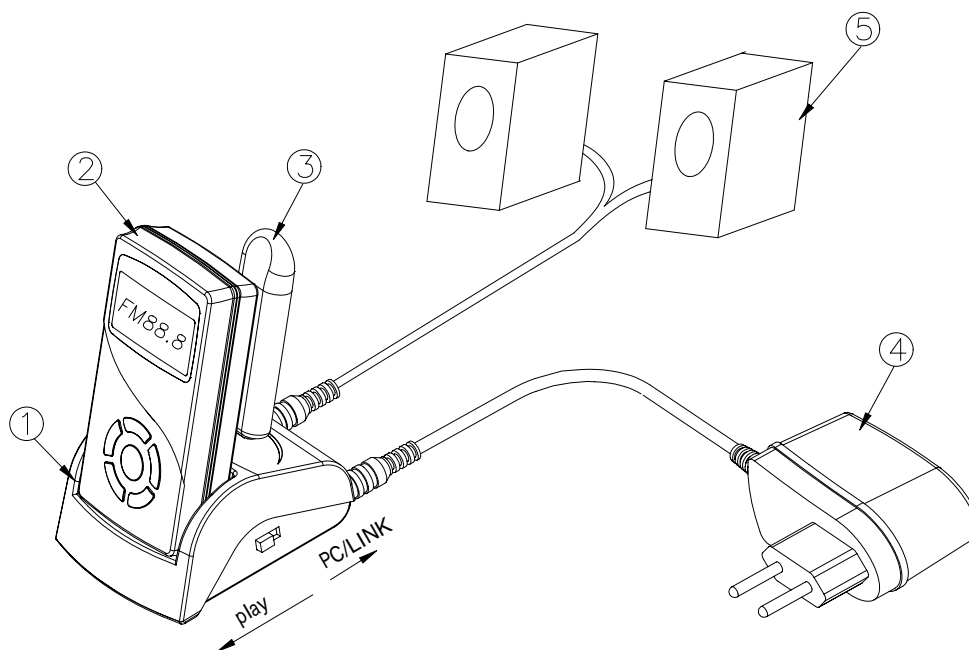

### Assembling Method :

- 1、 Plug in the AC Adaptor④ to a wall plug; plug in the DC Jack to power socket of the Desktop.
- 2、 Install the Multi-Player② to the Multi Player Slit①.
- 3、 Install the USB Flash Memory Stick③ to the USB slit.
- 4、 Install the external speaker jack into the earphone socket⑤ in the back of desktop.
- 5、 Change the Switch beside the desktop to “Play” side.

### Operation Method :

1. Set the FM Radio Frequency of home stereo to none-used Radio Frequency ( such as 88.1 )
2. Press the MENU button of the ②Multi-Player twice and find out the (A) symbol for radio frequency setting,
3. When the symbol flash, press ▼SELECT / SELECT▲ button to set up the same radio channel with Stereo Radio Frequency. ( When the Stereo become totally mute, the connecting completed )
4. Press ► Play/Stop button to transmit the music to the external speaker.
5. Adjust the required volume by adjust the VOL+▶▶ / ◀◀ VOL- button. Or, adjust the volume of the car stereo.

### Caution :

- 1、 Ensure the switch in the “Player” side, or Multi player will not work.

## Multi Player Links with PC installations (Figure 4.)

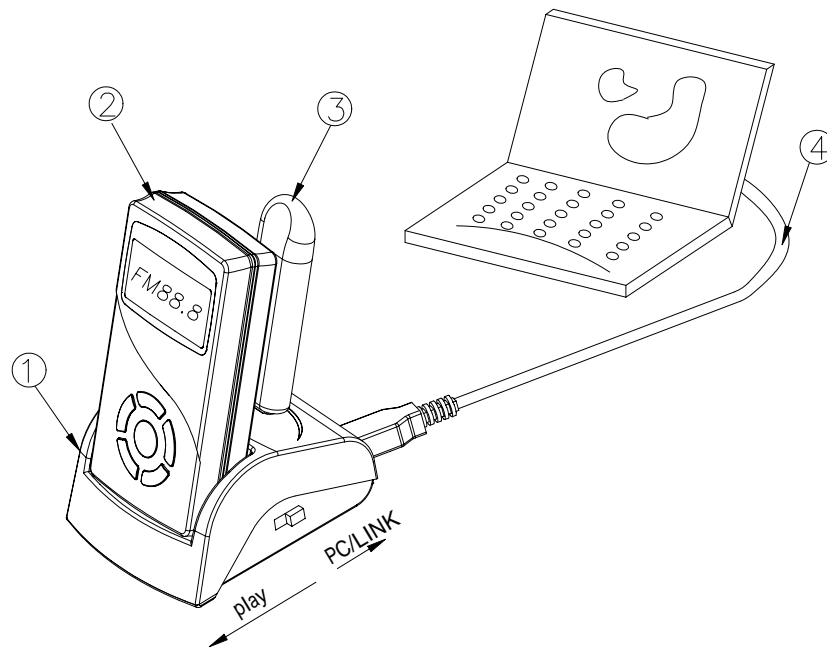

### Assembling Method :

- 1、 Plug in the USB cable in USB port of PC and then plug in the other side into the USB port in back of the Multi Player.
- 2、 Ensure the ②Multi Player is plugged well in Multi Player Slit①。
- 3、 Put the ③USB storage device in the USB slit and no need to have external power supplied.

### Operation Method :

- 1、 Change the switch beside the desktop to “PC/LINK” side, then can transmit the data into the USB storage ③from PC.

### Caution :

1. Ensure the all plugs and accessories installed to correct position.
2. Ensure the switch in the “PC/LINK” side.
3. Only compatible with USB power supplied from PC 。

## 【02Cradle Holder】

Multi Player and Car FM Stereo Installation (Figure 5.)

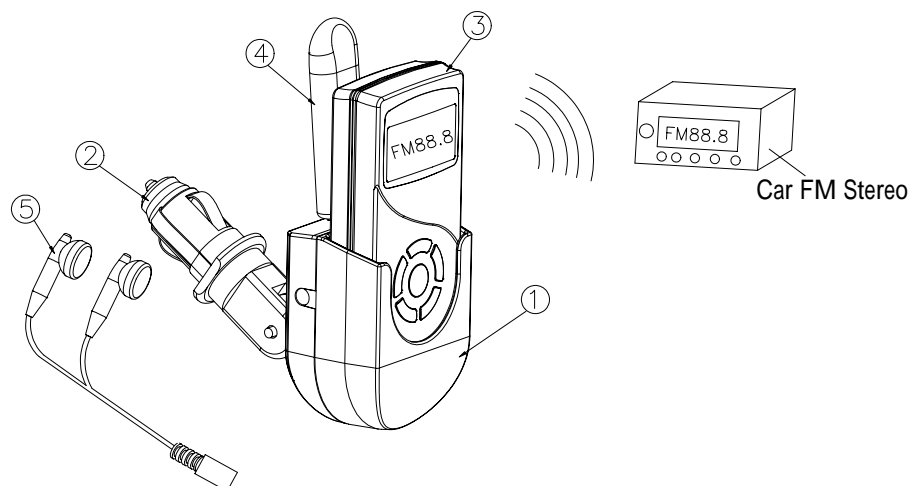

### Current :

Vehicle 16V~24V

### Multi-Player + Cradle Holder Assembling Instruction :

- 1、 Tune with Car FM Stereo and earphone (Figure 5)

### Assembling Method :

- 2、 Insert the power plug② into the cradle holder① (twist gently clockwise.)
- 3、 Insert the installed power plug② and cradle holder① into vehicle cigarette lighter adapter outlet. Adjust to required angle by releasing the bolt on the power plug②, and then re-fasten the bolt again.
- 4、 Install the Multi-Player② to the Cradle Holder socket①.
- 5、 Install the USB Flash Memory Stick③ to the USB socket.
- 6、 Install the earphone jack into the earphone socket⑤. (Depends on user's options)

### Operation Method :

1. Set the FM Radio Frequency of the car stereo to none-used Radio Frequency ( such as 88.1 )
2. Press the MENU button of the ②Multi-Player twice and find out the (▲) symbol for radio frequency setting,
3. When the symbol flash, press ▼SELECT / SELECT▲ button to set up the same radio channel with Stereo Radio Frequency. ( When the Stereo become totally mute, the connecting completed )
4. Press ► Play/Stop button to transmit the music to the Stereo.
5. Adjust the required volume by adjust the VOL+►► / ◀◀ VOL- button. Or, adjust the volume of the car stereo.

### Caution :

- 1、 Ensure the all plugs and accessories installed to correct position.

## 【03 POWER BANK】

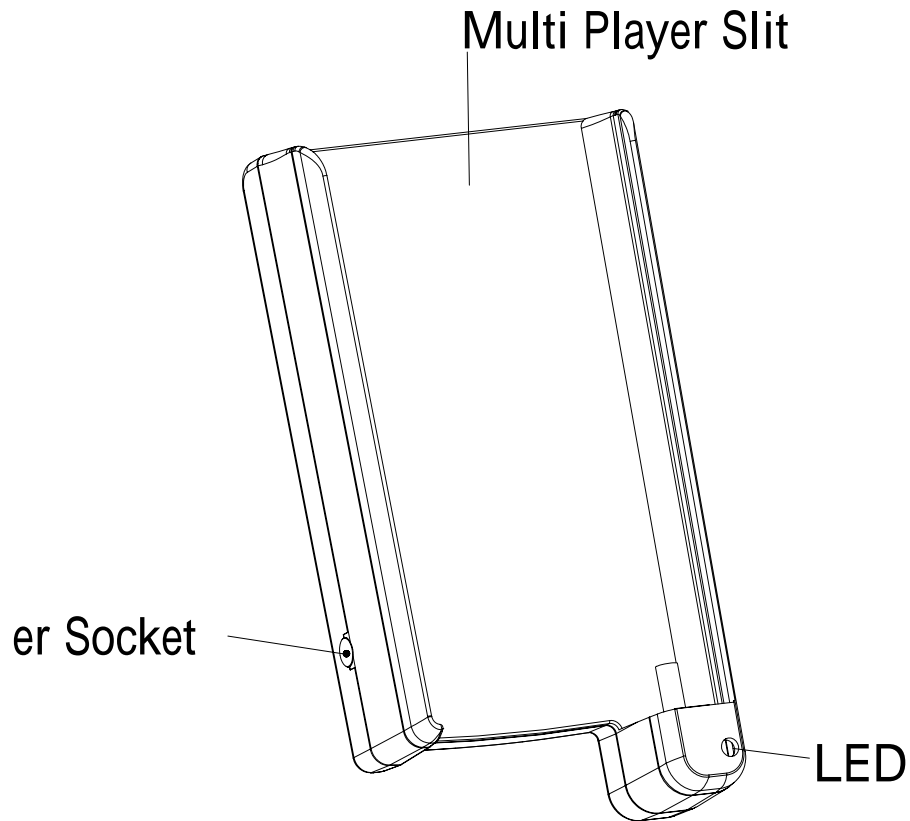

### **CURRENT :**

AC 100~240 DC 5V/1A

### **Multi-Player + Cradle Holder Assembling Instruction :**

- 1、 Tune with Home FM Stereo Radio Frequency (Figure 6)
- 2、 Tune with Mobile FM Stereo (Figure 7)

Multi Player and Home FM stereo Installation (Figure 6.)

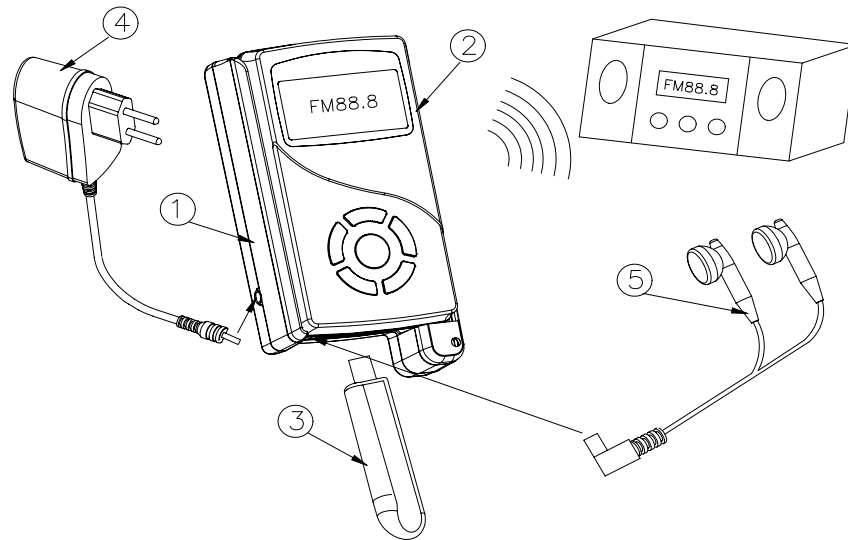

## Assembling Method :







### A. Use the Travel Charger

- 1、 Plug in the AC Adaptor④ to a wall plug, plug in the DC Jack to power socket of the Power bank①.
- 2、 Install the Multi-Player② to the Power Bank socket①.
- 3、 Install the USB Flash Memory Stick③ to the USB socket.
- 4、 Install the earphone jack into the earphone socket⑤.

### B. Use without chargers

- 1、 Install the Multi-Player② to the Power Bank socket①.
- 2、 Install the USB Flash Memory Stick③ to the USB socket.
- 3、 Install the earphone jack into the earphone socket⑤.

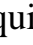
## Operation Method :

- 1、 Set the FM Radio Frequency of the home stereo to none-used Radio Frequency ( such as 88.1 )
- 2、 Press the MENU button of the ②Multi-Player twice and find out the  symbol for radio frequency setting,
- 3、 When the symbol flash, press  SELECT / SELECT  button to set up the same radio channel with Stereo Radio Frequency. ( When the Stereo become totally mute, the connecting completed )
- 4、 Press  Play/Stop button to transmit the music to the Stereo.
- 5、 Adjust the required volume by adjust the VOL+  /  VOL- button. Or, adjust the volume of the stereo.

## Caution :

- 1、 Ensure the all plugs and accessories installed to correct position.
- 2、 User can carry the Power Bank and move freely. It is not necessary to connect the Power Bank with its power supply all the time. Connect the power supply when it's out of power.

Multi Player and Power Bank, Car FM stereo Installations (Figure 7.)

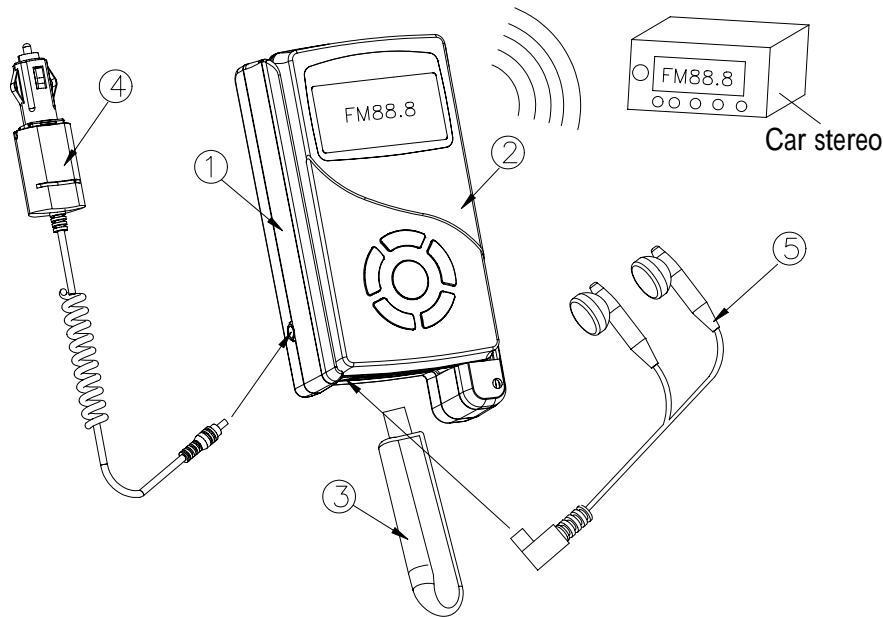

### **Assembling Method :**

#### **A. Use the Saver Charger ( Only used when it's out of power )**

- 1、 Plug in the Saver Charger④ to the car cigarette liter; plug in the DC Jack to power socket of the Power bank①.
- 2、 Install the Multi-Player② to the Power Bank socket①.
- 3、 Install the USB Flash Memory Stick③ to the USB socket.
- 4、 Install the earphone jack into the earphone socket⑤ (depends on user's opinions).

#### **B. Use without chargers**

- 1、 Install the Multi-Player② to the Power Bank socket①.
- 2、 Install the USB Flash Memory Stick③ to the USB socket.
- 3、 Install the earphone jack into the earphone socket⑤.

### **Operation Method :**

1. Set the FM Radio Frequency of the car stereo to none-used Radio Frequency ( such as 88.1 )
2. Press the MENU button of the ②Multi-Player twice and find out the (▲) symbol for radio frequency setting,
3. When the symbol flash, press ▼SELECT / SELECT▲ button to set up the same radio channel with Stereo Radio Frequency. ( When the Stereo become totally mute, the connecting completed )
4. Press ► Play/Stop button to transmit the music to the Stereo.
5. Adjust the required volume by adjust the VOL+▶▶ / ◀◀ VOL- button. Or, adjust the volume of the stereo.

### **Caution :**

- 1、 Use the saver charger when the Power Bank is out of power.
- 2、 Ensure the all plugs and accessories installed to correct position.

## 【04 Desktop Speaker】

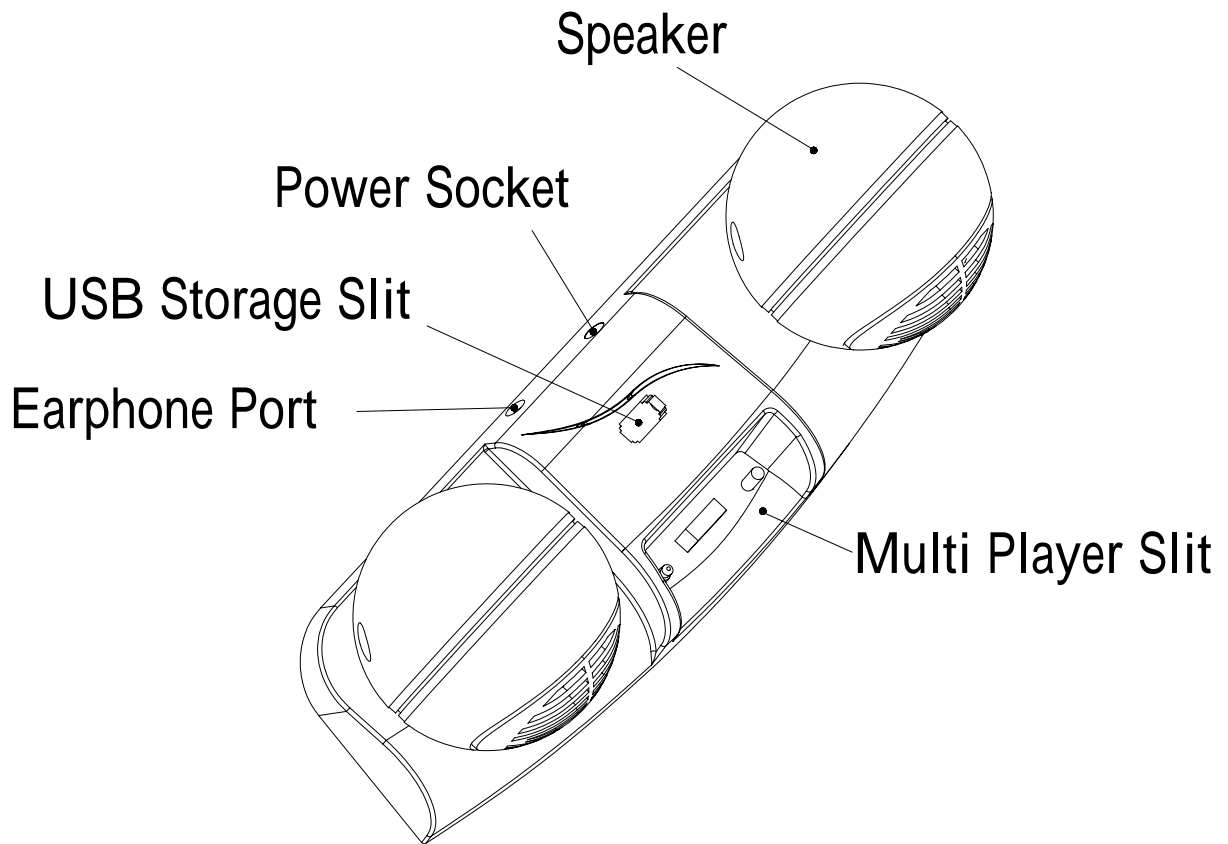

### **Current :**

AC 100~120V DC 12V/1A ( Different county use different AC Adaptor )

### **Multi-Player + Desktop Speaker Assembling Instruction**

- 1、 Tune the Desktop Speaker with a FM Stereo Radio Frequency(Figure 8)
- 2、 Tune the Desktop Speaker with external Speakers(Figure 9)
- 3、 Use Desktop Speaker only ( Figure 10 )

## Multi Player , Desktop Speaker and FM stereo Installations (Figure 8.)

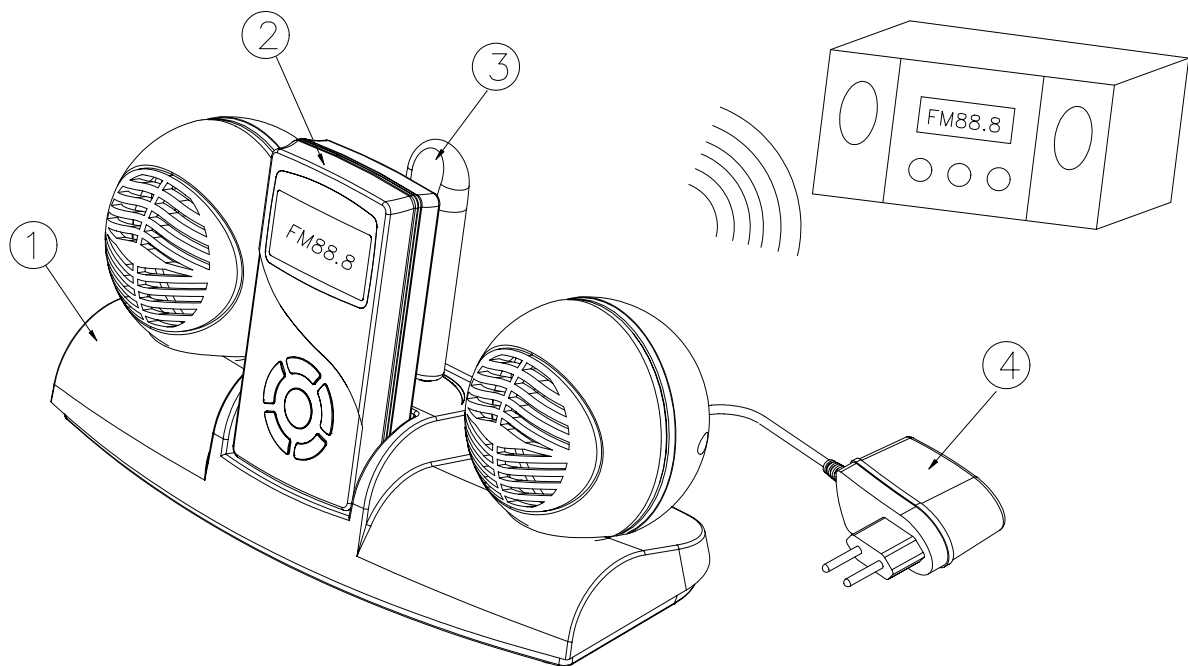

### Assembling Method :

- 1、 Plug in the AC Adaptor④ to a wall plug; plug in the DC Jack to power socket of the Desktop Speaker①.
- 2、 Install the Multi-Player② to the Desktop Speaker socket①.
- 3、 Install the USB Flash Memory Stick③ to the USB socket.

### Operation Method:

1. Set the FM Radio Frequency of the home stereo to none-used Radio Frequency ( such as 88.1 )
2. Press the MENU button of the ②Multi-Player twice and find out the (A) symbol for radio frequency setting,
3. When the symbol flash, press ▼SELECT / SELECT▲ button to set up the same radio channel with Stereo Radio Frequency. ( When the Stereo become totally mute, the connecting completed )
4. Press ► Play/Stop button to transmit the music to the Stereo.
5. Adjust the required volume by adjust the VOL+▶▶ / ◀◀ VOL- button. Or, adjust the volume of the stereo.

### Caution :

Ensure the all plugs and accessories installed to correct position.



## Multi Player, Desktop Speaker and External speaker Installations (Figure 9.)

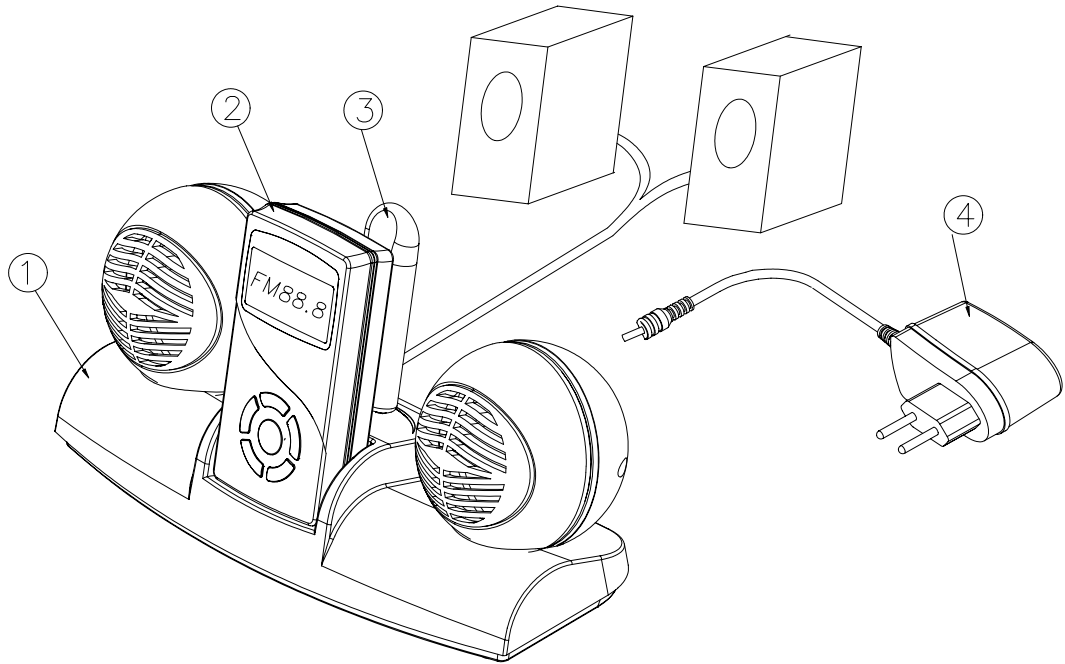

### Assembling Method :

- 1、 Plug in the AC Adaptor④ to a wall plug; plug in the DC Jack to power socket of the Desktop Speaker①.
- 2、 Install the Multi-Player② to the Power Bank socket①.
- 3、 Install the USB Flash Memory Stick③ to the USB socket.
- 4、 Install the audio cable of the external speakers into the earphone socket.

### Operation Method :

1. Set the FM Radio Frequency of the home stereo to none-used Radio Frequency ( such as 88.1 )
2. Press the MENU button of the ②Multi-Player twice and find out the (📻) symbol for radio frequency setting,
3. When the symbol flash, press ▼SELECT / SELECT▲ button to set up the same radio channel with Stereo Radio Frequency. ( When the Stereo become totally mute, the connecting completed )
4. Press ► Play/Stop button to transmit the music to the Stereo.
5. Adjust the required volume by adjust the VOL+▶▶ / ◀◀ VOL- button. Or, adjust the volume of the stereo.

### Caution :

- 1、 Ensure the all plugs and accessories installed to correct position.

## Multi Player and Desktop Speaker Installations (Figure 10.)

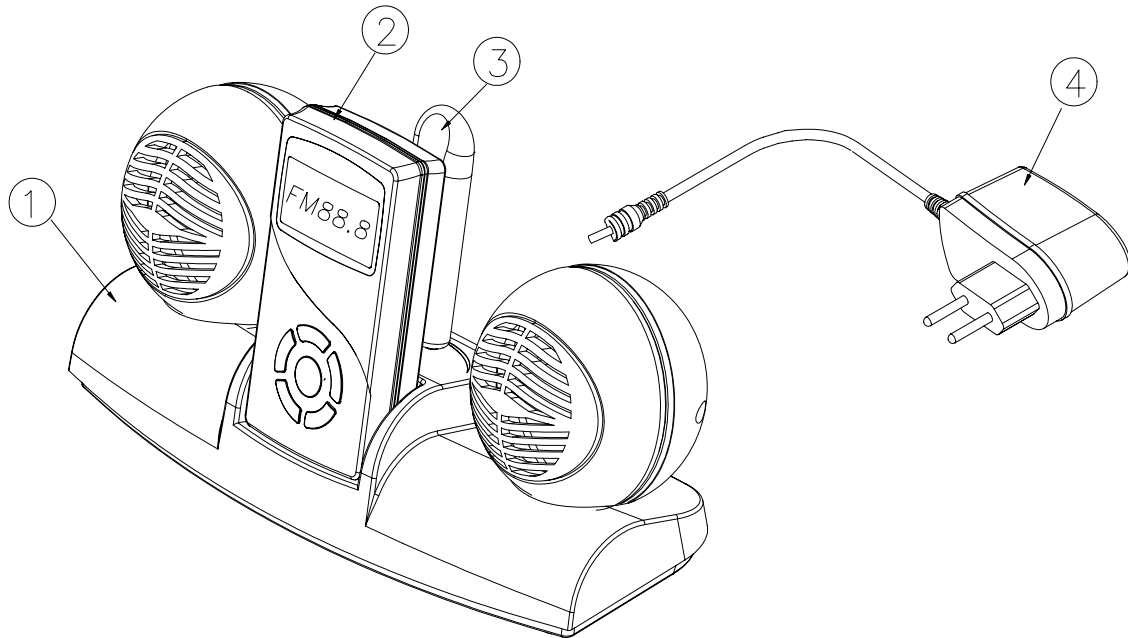

### Assembling Method :

- 1、 Plug in the AC Adaptor④ to a wall plug; plug in the DC Jack to power socket of the Desktop Speaker①.
- 2、 Install the Multi-Player② to the Desktop Speaker socket①.
- 3、 Install the USB Flash Memory Stick③ to the USB socket.

### Operation Method :

1. Press ► Play/Stop button to transmit the music to the Desktop Speaker.
2. Adjust the required volume by adjust the VOL+►► / ◀◀ VOL- button.

### Caution :

- 1、 Ensure the all plugs and accessories installed to correct position.

## **Troubleshooting**

1. Make sure the plug has exactly plug-in
2. IF the cradle have no power please check whether the fuse on power wire is broken, if yes, renew one by 2A/250V required
3. Have check the unit body exactly plug-in
4. Check the screen display and active normal

**If none of the above phenomena .please call your dealer for help**

## **Maintenance and Notice**

1. Keep the product off direct sunlight or heat environment .and keep it away from kids.
2. keep product dry ,and don't use or stock under wet/dirty/high or low temperature environment.
3. Don't disassemble without professional electrical technician.
4. Don't random throw , rap or shake product.

**Don't use irritant chemical; corrosive cleaner to clear the product**

## FEDERAL COMMUNICATIONS COMMISSION INTERFERENCE STATEMENT

This equipment has been tested and found to comply with the limits for a Class B digital device, pursuant to Part 15 of the FCC Rules. These limits are designed to provide reasonable protection against harmful interference in a residential installation. This equipment generates, uses and can radiate radio frequency energy and, if not installed and used in accordance with the instructions, may cause harmful interference to radio communications. However, there is no guarantee that interference will not occur in a particular installation. If this equipment does cause harmful interference to radio or television reception, which can be determined by turning the equipment off and on, the user is encouraged to try to correct the interference by one or more of the following measures:

- Reorient or relocate the receiving antenna.
- Increase the separation between the equipment and receiver.
- Connect the equipment into an outlet on a circuit different from that to which the receiver is connected.
- Consult the dealer or an experienced radio/TV technician for help.

### CAUTION:

To assure continued FCC compliance:

- (1) The user must use shielded USB cable and bonded a ferrite core when connecting to USB port of PC, and use un-shielded line of earphone with a ferrite core and travel charger which contain an un-detachable un-shielded dc output cable with a ferrite core, and the ac adapter must use an un-detachable un-shielded dc output cable with a ferrite core when connecting to power socket of desktop speaker.  
If you use other cables, it may cause interference with radio and television reception.
- (2) Any changes or modifications not expressly approved by the grantee of this device could void the user's authority to operate the equipment.

### FCC Label Compliance Statement:

This device complies with Part 15 of the FCC Rules. Operation is subject to the following two conditions: (1) This device may not cause harmful interference, and (2) This device must accept any interference received, including interference that may cause undesired operation.