

# Mobile Appearance picture

---



## Table of Contents

Foreword .....	3
Getting to know your touch phone .....	6
Starting up the device .....	8
Introduce the basic phone function ...	10
Technical Specifications.....	15
SAR.....	16

# Foreword

---

## Safety

In order to ensure the phone is used safely and correctly, please read the precautions below carefully before use.

### 1. General precaution

- Your phone is only suitable for the battery and charger approved by our company or else it may cause the battery to leak, overheat, explode or even catch fire.
- Do not knock, vibrate or throw the phone heavily to avoid malfunction, fire, overheating, explosion or fire.
- If there is an abnormality such as temperature rise, color change or distortion when using, charging or storing the battery, stop using it and replace it with a new one.
- It may burn the skin if liquid in the battery leaks onto skin or clothes. If this happens please flush with plenty of clean water immediately and go to a hospital at once.
- Please keep the battery away from fire to avoid fire and explosion if the battery leaks or emits a strange smell.
- Do not place expose the battery to moisture or it may cause overheating, fumes and corrosion.
- Do not use or place the battery under direct sunlight, or in hot places, it may cause leakage and overheating, thus reducing performance and shortening the lifespan.
- Do not charge the battery for over 24 hours continuously.

## **2.Precaution for the use of charger**

- Do not cause short circuit to the charger, or it may cause electric shock, fumes and damage to the charger.
- Do not use the charger if the power wire is broken, or it may cause fire and electric shock.
- Please remove accumulated dust on the power plug.
- Do not put water containers next to the power supply to avoid overheating, fire, electric shock and malfunction in case they come into contact.
- Do not disassemble or tamper with the charger or it may cause personal injury, electric shock, fire and the damage of the charger.
- Do not use the charger in places of high humidity, like bathrooms, or it may cause electric shock, fire and damage of charger.
- Do not touch the charger, power cord or power plug with wet hands or it can cause electric shock.
- Do not put heavy objects on the power cord or change the power cord or it may cause electric shock and fire.
- Please unplug the power socket before cleaning and maintenance.
- Please hold the charger to unplug the socket as pulling the power cord may damage the power wire and cause electric shock and fire.

## **3.Cleaning and maintenance**

- As the phone, battery and charger are not waterproof, do not use them in places of high humidity and avoid them being wet by rain.
- Please clean the battery and charger with a soft dry cloth.
- Never use alcohol, thinner or solutions, like benzene, to wipe the phone.

- Dirty sockets can cause poor contact and power down, and even make recharging unavailable. So, please clean them periodically.

# Getting to know your touch phone

---



# Starting up the device

---

## 1. Install SIM card

- Locate the SIM card slot and insert the SIM card. When installing, make sure the chip is facing down, paying attention to the slot orientation.
- Slide the SIM card all the way into the slot.

Note:

- (1) The phone supports two SIM cards. The card will support 2G, 3G and LTE.
- (2) Keep the SIM card away from the child's touch.
- (3) Any wear or folding may easily damage the SIM card, so be careful when inserting, removing and storing.
- (4) Before removing the SIM card, make sure that the power has been turned off and the battery is removed.

## 2. Charge the battery

- The new battery is partially charged. It is recommended that you install and charge the battery before you start using it. Some batteries perform best after several full charge/discharge cycles.

Note:

- (1) The device can only be charged using the AC adapter supplied with the device.
- (2) Plug the AC adapter's cable into the phone's charging port, then plug the AC adapter into a power outlet to begin charging the battery.
- (3) The battery is charging when the device is turned on, and the charging icon is displayed in the status bar of the home screen. When the battery is fully charged, a full battery icon appears in the title bar of the main screen.

## **Warning:**

- When using the AC adapter to charge the battery, do not remove the battery from the device.
- As a safety precaution, the battery stops charging before overheating.

## **3.Power on/off**

- To turn off the phone, press and hold the power button (the blue button on the right side of the phone), the interface pops up the selection box, select the "Shutdown" option.  
To turn the power on again, press and hold the power button.



# Introduce the basic phone function

---

## 1. Switch MainMenu style

(1) In the default home screen, slide your fingertips left and right along the screen to display more home screens.

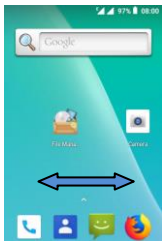

(2) On the home screen, click the icon (main menu icon) at the bottom of the screen to enter the main menu screen, and slide your fingertips up and down along the screen to display more applications.

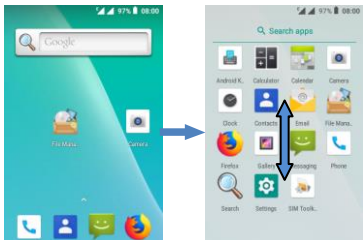

## 2.The main screen

### (1) Read your notice

When you see a notification in the status bar, touch the bar and swipe down on the screen to open the list of notifications that appear in the sliding window.

In-progress notification reports such as receiving information, receiving transmission files, and the like.

The notification will report the arrival of new messages, calendar events, etc. You can clear the list of notifications by selecting the "Clear" icon at the bottom of the notification window.

To open a message, reminder or other notification, you can touch the item. To turn off notifications for a window, swipe your finger left or right to remove notifications from the screen.

### (2) Create home screen shortcuts and widgets

In the main screen, press and hold TP, then click SHORTCUTS. Touch and hold to select a widget to add a saved contact, a signed email user, to a shortcut to the home screen.

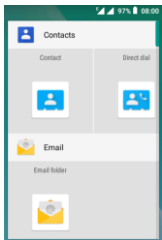
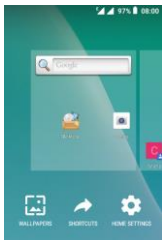

### (3) Move the object on the home screen

To move an icon or other item on the home screen, you must touch and hold it to enter mobile mode.

Do not lift your finger and drag the object to a new location. To move the item to the part of the home screen that is not in the view, move it to the top left corner of the screen. A removal prompt will appear, the screen view will change, the object will be positioned and released.

## 3. Camera

All photos that you can capture or view on your phone are stored on your phone.

Note: This phone does not support SD card.



#### **4. GPRS/WLAN network**

Your device's networking capabilities allow you to access the Internet or your corporate network through WLAN, GPRS, EDGE (if available)

You can also add and set up a VPN or proxy connection.

To use WLAN on your device, you need access to a wireless access point

Note: The availability and range of your device's WLAN signal depends on the number, infrastructure, and other objects through which the signal passes.

To open the Browser you need to be connected to a network.

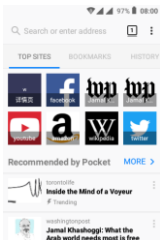
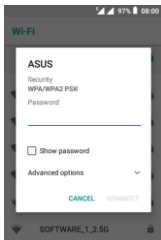

## 5. U-disk storage

This phone supports movable storage, i.e., the U-disk function.

When the phone is switched on, you see the icon in the status bar on the top of the screen when it's connected to a PC by a data line. Touch the bar and slide your finger down the screen to open the list of notifications displayed in the sliding window. Select [USB connected] and touch [Turn on USB storage] to confirm, you can use the phone as a U-disk.

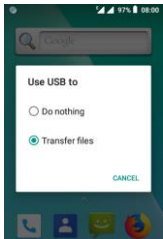

## 6. Bluetooth

The phone supports Bluetooth (BT) function, which can establish a wireless connection between the mobile phone and other compatible devices, and carry out data transmission. A wireless connection can be established between the mobile devices, and the longest distance can be up to 10 meters. Bluetooth connections may be subject to obstacles such as walls or other electronic devices.

(1) Enter the setup menu, touch the Bluetooth open function, the standby screen will display the BT icon in the status bar.

(2) Open the discoverable BT, other devices can search for the phone.

(3) Before using your phone as a Bluetooth device, you need to pair your phone with the target device as follows:

- Make sure your phone is Bluetooth enabled.
- Touch "Scan device". The Bluetooth device within the range of the phone will start scanning.
- Touch the device you want to pair and confirm your password to complete the pairing.

You can share pictures, video files with family and friends using Bluetooth.

# Technical Specifications

---

## Technical Specifications

Weight: 522g(with paper and battery )

Dimensions: 183X72X66.5mm

Band:

2G bands:

GSM900MHz/DCS1800MHz/GSM850MHz/PCS1900 MHz

3Gbands:

WCDMA B1/WCDMA B2/WCDMA B5/WCDMA B8

Battery Type: Li-ion

Battery Voltage: 7.4V

Battery Capacity: 2600mAH

Talk Time: about 15h

Standby Time: about 600h

Note: Actual operating conditions depend on the local network environment, SIM, and user behavior.

Warning: Any consequence caused by misuse, abuse, or not following any and all of the above-written suggestions and instructions shall not hold the producer in any way responsible to any degree.

Announcement: The manufacturer reserves the right to change or upgrade specifications or software versions without prior or separate notice. Trade marks mentioned or used in this material belong to their respective owners.

# SAR

---

This device complies with Part 15 of the FCC Rules. Operation is subject to the following two conditions:

(1) This device may not cause harmful interference.

(2) This device must accept any interference received, including interference that may cause undesired operation.

FCC ID: QPN-MP3PLUS

Any changes or modifications not expressly approved by the party responsible for compliance could void the user's authority to operate the equipment.

NOTE: This equipment has been tested and found to comply with the limits for a Class B digital device, pursuant to Part 15 of the FCC Rules. These limits are designed to provide reasonable protection against harmful interference in a residential installation. This equipment generates uses and can radiate radio frequency energy and, if not installed and used in accordance with the instructions, may cause harmful interference to radio communications. However, there is no guarantee that interference will not occur in a particular installation.

If this equipment does cause harmful interference to radio or television reception, which can be determined by turning the equipment off and on, the user is encouraged to try to correct the interference by one or more of the following measures:

---Reorient or relocate the receiving antenna.

---Increase the separation between the equipment and receiver.

---Connect the equipment into an outlet on a



circuit different from that to which the receiver is connected.

---Consult the dealer or an experienced radio/TV technician for help.

#### Body-worn Operation

This device was tested for typical body-worn operations. To comply With RF exposure requirements, a minimum separation distance of 1.0cm must be maintained between the user' s body and the handset, including the antenna.

Third-party belt-clips, holsters, and similar including the antenna. Third-party belt-clips, holsters, and similar accessories used by this device should not contain any metallic components. Body-worn accessories that do not meet these requirements may not comply with RF exposure requirements and should be avoided.

#### Specific Absorption Rate (SAR) information:

This wireless phone meets the government's requirements for exposure to radio waves. The guidelines are based on standards that were developed by independent scientific organizations through periodic and thorough evaluation of scientific studies. The standards include a substantial safety margin designed to assure the safety of all persons regardless of age or health.

FCC RF Exposure Information and Statement  
The SAR limit of USA (FCC) is 1.6 W/kg averaged over one gram of tissue. Device types MP3 Plus has also been tested against this SAR limit. The highest SAR value reported under this standard during product certification for worn on the body is 1.013W/kg. This device was tested for typical body-worn operations with the back of the

handset kept 1cm from the body. To maintain compliance with FCC RF exposure requirements, use accessories that maintain a 1cm separation distance between the user's body and the back of the handset. The use of belt clips, holsters and similar accessories should not contain metallic components in its assembly. The use of accessories that do not satisfy these requirements may not comply with FCC RF exposure requirements, and should be avoided.

## **CAUTION:**

Use careful with the earphone maybe excessive sound pressure from earphones and headphones can cause hearing loss.

2.This device battery is not removable, please do not disassemble the device.

3. Adapter shall be installed near the equipment and shall be easily accessible.(Adapter model: S048CM0900500)

4. Charger1: A88-3771-5V2A

Charger2: A70-502000

Charger3: A824-5V2A

5.The device complies with RF specifications when the device used at 5mm from your body.

6. USB cable are shielded.