

MULTI-CHANNEL CABLE FREE IN-OUT THERMOMETER

MODEL: GE5805WS4
USER'S MANUAL

ENGLISH

INTRODUCTION

Congratulations on your purchasing of the GE5805WS4 Multi-channel Cable Free In-out Thermometer.

The basic package comes with a main unit and a remote sensor. The main unit can support up to three remote sensors.

The GE5805WS4 is very easy to use. No wire installation is required between the main unit and the remote units.

MAIN FEATURES (Fig. 1)

- OUTDOOR TEMPERATURE**
Shows the temperature of the selected remote channel
- INDOOR TEMPERATURE**
Shows the temperature taken indoor
- [MAX/MIN] BUTTON**
Displays current, maximum or minimum temperature
- [CH] BUTTON**
Selects among different channels
- [CLEAR] BUTTON**
Clears the memory for the indoor temperature and that for the selected channel
- RESET BUTTON**
Returns all settings to default values
- BATTERY COMPARTMENT**
Accommodates two (2) UM-3 or "AA" size 1.5V batteries
- °C/°F SLIDE SWITCH**
Selects between degrees Centigrade (C) and Fahrenheit (F)
- TABLE STAND**
Rotates out to support the unit on a flat surface
- WALL-MOUNT HOLE**
For mounting the unit on a wall

MAIN FEATURES: REMOTE UNIT (Fig. 2)

- LED INDICATOR**
Flashes when the remote unit transmits a reading
- CHANNEL SLIDE SWITCH**
Designates the remote unit Channel 1, Channel 2 or Channel 3
- RESET BUTTON**
Returns all settings to default values
- BATTERY COMPARTMENT**
Accommodates two (2) UM-3 or "AA" size 1.5V batteries
- BATTERY DOOR**

HINTS FOR BEST OPERATION

- Assign different channels to different remote units.
- Insert batteries for remote units before doing so for the main unit.
- Set the main and remote units within range (20 to 30 meters).
- Try different set-ups for best transmission and reception.
- Position the remote units away from direct sunlight, rain or snow.

BATTERY AND CHANNEL INSTALLATION: REMOTE UNIT (Fig. 3)

- Remove the screws on the battery compartment.
- Select the channel number on the CHANNEL slide switch.
- Install 2 batteries (UM-3 or "AA" size 1.5V) strictly according to the polarities shown.
- Replace the battery compartment door and secure its screws.

Note that once a channel is assigned to a remote unit, you can only change it by removing the batteries or resetting the unit.

BATTERY INSTALLATION: MAIN UNIT (Fig. 4)

- Open the battery compartment door.
- Insert two (2) UM-3 or "AA" size 1.5V batteries.
- Press RESET.
- Replace the battery compartment door.

GETTING STARTED

Once batteries are in place for the remote units, they will start transmitting sampling roughly at 30-second intervals.



The main unit will also start receiving once batteries are installed. The temperature of the selected channel will be displayed on the main display and the indoor temperature on the secondary display. The main unit will automatically update its readings at 30-second intervals.

If no signals are received, blanks will be displayed. Press [CH] and [MAX/MIN] simultaneously to enforce an immediate search. This is useful in synchronizing the transmission and reception of the remote and main units.

INDOOR AND OUTDOOR TEMPERATURES

The indoor temperature is shown on the secondary display.

As for the remote sites or channels, press [CH] repeatedly to go from one channel to another. The kinetic wave display on the channel number indicates the reception of that particular channel is in good order.

Kinetic-wave Icon			
Designated Display	Remote Display Channel One	Remote Display Channel Two	Remote Display Channel Three

To start an automatic scan on all channels, press and hold [CH] for two seconds. The main unit will scan from one channel to another and back. The reading for individual channel will be displayed for five seconds. Press any key to end the automatic scan.

MAXIMUM AND MINIMUM TEMPERATURES

The maximum and minimum recorded indoor temperatures and those of each channel will be automatically stored in memory.

To display them,

- Press [CH] to locate the desired channel.
- Press [MAX/MIN] repeatedly to display the current, maximum (MAX) and minimum (MIN) temperatures. The readings of the indoor temperatures will also be displayed.

To clear the memory of a particular channel,

- Press [CH] to locate the desired channel.
- Press [CLEAR]. Note it will also erase the memory for the indoor temperatures. If you press [MAX/MIN] now, the maximum and minimum temperatures will have the same values as the current ones until different readings are recorded.

ICE WARNING FUNCTION

The GE5805WS4 includes an ice warning function. This feature is built into remote sensor CHANNEL 1 functions.

When the temperature recorded at CHANNEL 1 falls to between -2°C (28.4°F) to +3°C (37.4°F) the current outdoor temperature will flash.

TO DEACTIVATE THIS FUNCTION, SET THE REMOTE SENSOR TO CHANNEL 2 or CHANNEL 3.

DISCONNECTED SIGNALS

If without obvious reasons the display for a particular channel goes blank, press [CH] and [MAX/MIN] to enforce an immediate search. If that fails, check if the remote unit of that channel is still in place. Make sure the transmission is within range and path is clear of obstacles and interference. No reading will be shown if no remote unit is assigned to that channel.

LOW BATTERY WARNING

When it is time to replace batteries, the respective low-battery indicator will show up when the respective channel is selected. The battery level of the main unit will be shown on the indoor temperature when it is running low.

HOW TO USE THE TABLE STAND OR WALL MOUNTING (Fig. 5)

Flip the table stand out to place the main unit on a flat surface. Or you can hide the stand and mount the unit on a wall using the recessed hole.

As for the remote unit, mount the unit on a wall using the recessed hole.

THE RESET BUTTON

The [RESET] button is used to enhance synchronization of signals after battery replacement or when the unit is operating in an unfavorable way or malfunctioning. Use a blunt stylus to hold down the button. All settings will return to their default values.

MAINTENANCE

When handled properly, this unit is engineered to give you years of satisfactory service. Here are a few product care instructions:

- Do not immerse the unit in water. If the unit comes in contact with water, dry it immediately with a soft lint-free cloth.
- Do not clean the unit with abrasive or corrosive materials. Abrasive cleaning agents may scratch the plastic parts and corrode the electronic circuit.
- Do not subject the unit to excessive: force, shock, dust, temperature, or humidity. Such treatment may result in malfunction, a shorter electronic life span, damaged batteries, or distorted parts.
- Do not tamper with the unit's internal components. Doing so will terminate the unit's warranty and may cause damage. The unit contains no user-serviceable parts.
- Only use new batteries as specified in this instruction manual. Do not mix new and old batteries as the old batteries may leak.
- Read this instruction manual thoroughly before operating the unit.

SPECIFICATIONS

Temperature Measurement

Main unit

Indoor Temperature measurement

Proposed operating range	: -5.0°C to +50.0°C (23.0°F to 122.0°F)
Temperature resolution	: 0.1°C (0.2°F)
Temperature Display in °C or °F	

Remote unit

Proposed operating range	: -20.0°C to +60.0°C (-4.0°F to 140.0°F)
Temperature resolution	: 0.1°C (0.2°F)
RF Transmission Frequency	: 433 MHz
No. of Remote unit	: Maximum of 3
RF Transmission Range	: 30 meters (open area)
Temperature sensing cycle	: around 30 seconds

Power

Main unit	: use 2 pcs UM-3 or "AA" 1.5V battery
Remote sensing unit	: use 2 pcs UM-3 or "AA" 1.5V battery

Weight

Main unit	: TBC g (without battery)
Remote sensing unit	: TBC g (without battery)

Dimension

Main unit	: 66.5 x 74 x 30 mm (L x W x T)
Remote sensing unit	: 80 x 70 x 33.5 mm (L x W x T)

NOTE ON COMPLIANCE

This device complies with Part 15 of the FCC Rules. Operation is subject to the following two conditions: (1) This device may not cause harmful interference, and (2) This device must accept any interference received, including interference that may cause undesired operations.

Warning: Changes or modifications to this unit not expressly approved by the party responsible for compliance could void the user's authority to operate the equipment.

FCC :

NOTE: This equipment has been tested and found to comply with the limits for a Class B digital device, pursuant to Part 15 of the FCC Rules. These limits are designed to provide reasonable protection against harmful interference in a residential installation. This equipment generates, uses and can radiate radio frequency energy and, if not installed and used in accordance with the instructions, may cause harmful interference to radio communications.

However, there is no guarantee that interference will not occur in a particular installation. If this equipment does cause harmful interference to radio or television reception, which can be determined by turning the equipment off and on, the user is encouraged to try to correct the interference by one or more of the following measures:

- Reorient or relocate the receiving antenna.
- Increase the separation between the equipment and receiver.
- Connect the equipment into an outlet on a circuit different from that to which the receiver is connected.
- Consult the dealer of an experienced radio/TV technician for help.

Company Name: GE Wiring Devices & Specialty Products, Inc.
(d/b/a GE Home Electric Products, Inc.)

Address: 1975 Noble Rd, Cleveland, OH 44112 USA

Contact Person: Beth Eskra

Telephone Number: 216-266-3188

Name and model number of the product:

In/Out Thermo GE5805WS4

CAUTION

- The content of this manual is subject to change without further notice.
- Due to printing limitation, the displays shown in this manual may differ from the actual display.
- The contents of this manual may not be reproduced without the permission of the manufacturer.

Fig.1

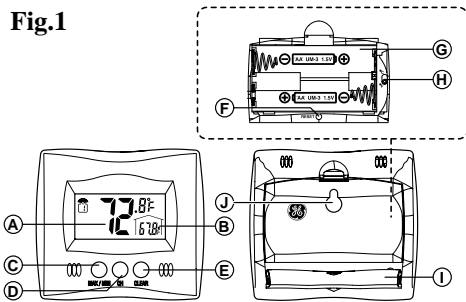

Fig.2

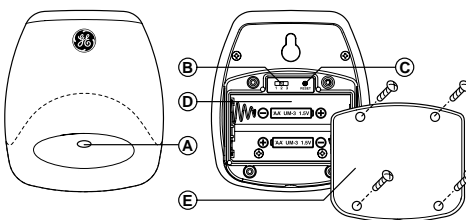

Fig.3

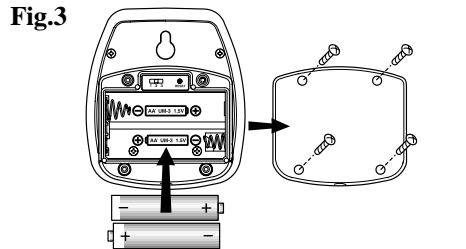

Fig.4

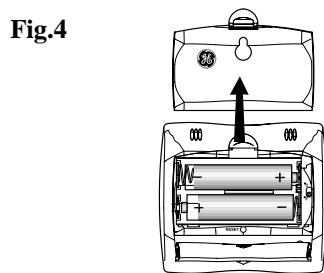

Fig.5

