

## Programming Telestart Transmitters

1. Place batteries into the battery compartment of the transmitter.
2. Remove fuse 1A (black) from the heater's fuse holder (voltage interruption).
3. Wait at least 5 seconds.
4. Replace fuse in heater's fuse holder and within 5 seconds press the OFF button on the transmitter for at least 1 second.
5. "Learning" is completed.

A second or third hand-held transmitter can be programmed in the same manner.

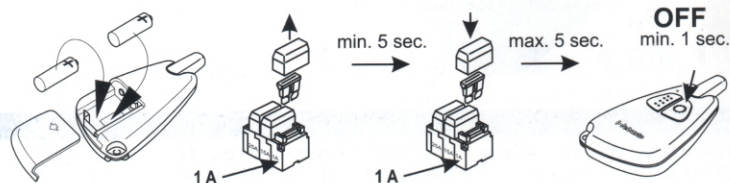

## Checking the Mode

Simultaneously depress and hold down the ON and OFF buttons.

LED illuminates:

in **red**: heating mode

in **green**: ventilating mode

LED extinguishes:

- when the buttons are released, or
- after 10 seconds



## Mode setting

Depress the ON and OFF buttons simultaneously twice within one second.

Upon the second actuation, the LED will change its colour and illuminate until the buttons are released.

The new mode is stored when the button is released.



## Switch on heater or ventilation

Hold the hand-held transmitter with the antenna in upright position and push the ON button for 1 to 2 seconds.

**NOTE:**

In the 'heating' mode, the vehicle's heating system is to be set to "warm" prior to leaving the vehicle. In the 'heating' and 'ventilation' modes, the vehicle's fan switch is to be turned to position 1 in the case of 3-speed blower fans, and to position 2 in the case of 4-speed blowers. In the case of infinitely variable fans adjust to at least 1/3 of the fan's capacity.



## Switch off heater or ventilation

Hold the hand-held transmitter with the antenna in upright position and press the OFF button for 1 to 2 seconds.



## Checking and Setting the Operating Time

The operating time of the heater or the vehicle's fan can be preset on the transmitter in increments of 10 minutes. The operating time is factory-set at 30 minutes.

**NOTE:**

In the case of Thermo Top and Thermo Top T heaters, an operating time of 20 or 30 minutes has to be set in the 'heating' mode. In the case of Thermo Top Z/C and Thermo Top E heating units we recommend that the heating time be set in accordance with the driving time. Example: The vehicle is used for travelling to work and back. With a driving time of approx. 30 minutes (one way), we recommend setting an operating time of 30 minutes.

## Checking the Operating Time

Simultaneously actuate the ON and OFF buttons within one second three times in rapid succession.

**NOTE:**

The first coded flashing signal that is emitted immediately upon the third actuation of both buttons has to be included into the count.

The LED flashes in accordance with the preset operating time.

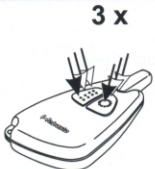

No. of coded flashing signals	1	2	3	4	5	6
Operating time	10 min.	20 min.	30 min.	40 min.	50 min.	60 min.