

Symptom	Check&Remedy
Nothing appears on LCD display	<ul style="list-style-type: none">● Check that the LCD display is connected to base unit properly.● Check that the base unit is connected to cigarette lighter properly.
No operation	<ul style="list-style-type: none">● Check that the base unit is connected to cigarette lighter properly.● Check that the base unit is turned on.● Check the pairing is successful.
No LED indicator	<ul style="list-style-type: none">● Check that the base unit is connected to cigarette lighter properly.● Check that the base unit is turned on.
Cannot work	<ul style="list-style-type: none">● Power down then up the unit.

Advanced Bluetooth Wireless Product

BT-201



Contents

Introduction	1
Feature List	3
Safety and General Information	4
Before Using	6
Package contents	6
Turning the unit on/off.....	7
Installing the unit in a vehicle.....	8
Location of Controls	9
Function Operations	11
Pairing.....	11
Adjusting speaker volume	13
Adjusting ringer volume	15

Care and Maintenance

Your advanced BT-201 is a product of superior design and should be treated with care. The suggestions below will help you to enjoy your product for many years.

- Keep the product dry. Precipitation, humidity and all types of liquids or moisture can contain minerals that will corrode electronic circuits.
- Do not use or store the product in dusty, dirty areas.
- Do not attempt to open the product. Non-expert handling may damage it.
- Do not use harsh chemicals, cleaning solvents or strong detergents to clean the product. Use a clean, soft cloth that is slightly damp to clean the product.
- If the product won't be used for a long time, remove it from cigarette lighter and store it with safely protected.

Status	Indicators
Pairing mode	The Red LED and Blue LED flash alternately.
Standby mode	The Blue LED flashes per 3 seconds.
Turn on /off the unit by pressing MFB	The Blue LED flashes 4 times rapidly.
Power up the unit	The Red LED and Blue LED flash alternately once, then the Blue LED flashes 20 times rapidly.
In talk mode	The Blue LED flashes every second.

Making a call.....	16
Answering a call.....	17
Ending a call.....	18
Last number redial.....	18
Rejecting a call.....	19
Caller ID System Operations	20
Viewing Caller ID numbers.....	20
Calling back the last 5 Caller ID numbers.....	21
Transferring a call.....	21
Status Indicators	23
Care and Maintenance	24
Troubleshooting	25

Your Bluetooth wireless product BT-201

The Bluetooth wireless product BT-201 is developed for installation in motor vehicles to enable handsfree operation of your mobile phone. It is based on Bluetooth wireless technology connects to a compatible phone without wires. It easily converts your mobile phone communication into this in-car solution, talking through its high quality speaker and microphone.

The product is intended for use with any mobile phones which support handsfree and/or headset profile. For the mobile phones which support handsfree and headset profiles, the BT-201 will try to connect to mobile phone with handsfree profile first, if it fails, then with headset profile. **If your mobile phone and the BT-201 connects to each other with headset profile, the following function may be invalid. LCD display, Voice dialling, Last number redial and rejecting a call.**

What is Bluetooth wireless technology

Bluetooth wireless technology propels you into a new dimension in connectivity.

Bluetooth devices communicate without wires, using built-in radio transceivers that operate on a globally available radio frequency to ensure worldwide compatibility. Your

Transferring a call (continued)

3. To transfer back, just press MFB once.

To transfer a call from mobile phone to the unit

- 1. When a call is received, press the reception button in your mobile phone to answer the call.**
- 2. Press MFB once. Then the call is transferred to the unit, and your mobile phone returns to Standby mode.**
- 3. To transfer back, Press MFB for about 3 seconds and then a confirmation tone will be heard.**

Calling back the last 5 incoming numbers

1. In Standby mode, press Volume Up or Volume Down button repeatedly to select the number you want to call back.
2. Press MFB once to call back.



Transferring a call

During a call, the feature allows you to transfer a call from the unit to your mobile phone or vice versa so that you can accept the call in private or in public conveniently.

To transfer a call from the unit to mobile phone

1. When a call is received, press MFB to answer the call.
2. Press MFB for about 3 seconds and then a confirmation tone will be heard. Then the call is transferred to mobile phone, and the unit returns to Standby mode.

What is Bluetooth wireless technology(continued)

Bluetooth wireless product BT-201 can connect to other Bluetooth devices within a range of approximate 10 metres.

The wireless connection between the compatible devices established using Bluetooth technology is free of charge for the user. In some countries, there may be restrictions on using Bluetooth devices. Check with your local authorities.

Feature List

1. **Bluetooth compatible**
2. **Up to 10 metres range**
3. **LCD displays calling numbers**
4. **Talk time display**
5. **Full duplex**
6. **Easy installation**
7. **Speaker and ringer volume adjustment**
8. **Call back function**
9. **Voice dialling function**
10. **Last number redial**
11. **Transfers a call between the unit and mobile phone**

Caller ID System Operations

When a call is received, the LCD display shows caller's number, if your local telephone company provides the Caller ID service. The last 5 incoming numbers will be saved in the Caller ID list, and you can use the list to dial the numbers. If the storage is full, the oldest number will be replaced by the new one.



Viewing incoming numbers

In Standby mode, press Volume Up or Volume Down button repeatedly to view the incoming numbers.

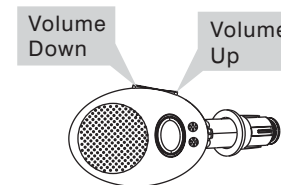

Rejecting a call

When a call is received, the unit rings and the LCD display shows the caller's number.

Press and hold MFB until a prompt tone is heard to reject the call.

OR

Reject the call from your mobile phone's keypad.

When you are making a call with the unit, if you want to end the call before getting through the line, do as follows.

Press MFB once to reject the call.

OR

Reject the call from your mobile phone's keypad.

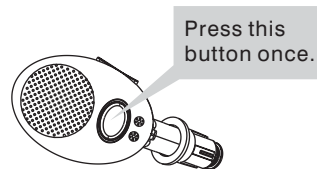
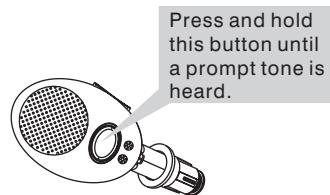

Important information on safe and efficient operation.

Read this information before using your device.

Users are not permitted to make changes or modify the device in any way. Changes or modifications not expressly approved by the party responsible for compliance could void the user's authority to operate the equipment.

Electromagnetic interference/compatibility

Nearly every electronic device is susceptible to electromagnetic interference if inadequately shielded, designed, or otherwise configured for electromagnetic compatibility.

Facilities

To avoid electromagnetic interference and/or compatibility conflicts, turn off your device in any facility where posted notices instruct you to do so. Hospitals or health care facilities may be using equipment that is sensitive to external RF energy.

Aircraft

When instructed to do so, turn off your device when on board an aircraft. Any use of a device must be in accordance with appliance regulations per airline crew instructions.

Medical devices

Hearing aids

Some devices may interfere with some hearing aids. In the event of such interference, you may want to consult with your hearing aid manufacturer to discuss alternatives.

Other medical devices

If you use any other personal medical device, consult the manufacturer of your device to determine if it is adequately shielded from RF energy. Your physician may be able to assist you in obtaining this information.

Ending a call

Press MFB once.

OR

End call from your mobile phone's keypad.

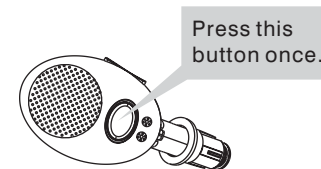

Last number redial

In Standby mode, press and hold Volume Up or Volume Down button until you hear a prompt tone. After the tone, the last dialed number will be dialed out automatically.

OR

Dial the last dialed number from you mobile phone's keypad.

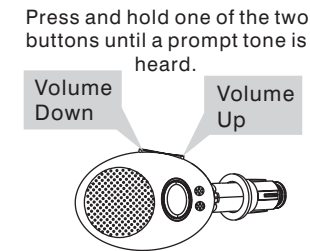

Making a call (continued)

- In voice-dialling mode, you can press **MFB** and **Volume Up** button concurrently no less than 1.6 seconds to disable the voice-dialling function.

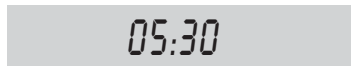

Answering a call

When a call is received, the unit rings and the LCD display shows the caller's number.



Press MFB to answer the call.

OR

Answer the call with your mobile phone's keypad.

Note:

- If the call is answered by pressing MFB, after getting through the line, the unit starts to time and the LCD display shows the talk time.

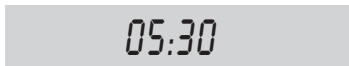

Package contents

Once you have opened the gift box, check to make sure that you have all the parts shown below. If any piece is missing or broken, please call your dealer.

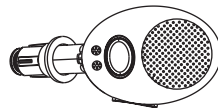

Base unit



Display unit
with coil cord



User's manual

Turning the unit on/off

When you turn on the ignition of your car, the unit is turned on automatically. Then the Red and Blue LEDs flash alternately once and then the Blue LED flashes 20 times rapidly, meanwhile a continuous line flashes on the LCD display. After that, the Blue LED flashes per 3 seconds, and the LCD display shows the icon "VOL". Then unit enters Standby mode and is ready for use.

To turn off the unit in Standby mode
Press and hold MFB until a prompt tone is heard.

To turn on the unit
Press and hold MFB until a prompt tone is heard, and then the Blue LED starts to flash per 3 seconds.



Press and hold this button until a prompt tone is heard.

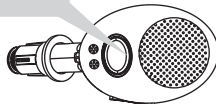

Note:

- When you use **Volume Up** or **Volume Down** button of the unit to adjustment the ringer volume, your mobile phone's ringer volume may be adjusted accordingly (depending on your mobile phone).

Making a call

Using your mobile phone

1. **In Standby mode, dial the number by keypad.**
2. **Press mobile phone's "send" key.**

Using the unit's voice-dialling (if supported by your mobile phone)

1. **In Standby mode, press MFB.**

Note:

- The time of pressing MFB should be

more than 0.2 seconds and less than 1.6 seconds.

2. **You will then hear the voice-activation tone and your mobile will remind you to speak the voice tag. After that, speak a voice tag which matches your desired number that was recorded in your mobile phone. Then the unit will repeat your voice tag and dial out the number.**

Note:

- After activating voice-dialling function, the unit starts timer and the LCD display shows the talk time.

Adjusting ringer volume

When a call is received, the unit rings. At the moment you can press **Volume Up** or **Volume Down** button or use your mobile phone (depends on your mobile phone) to adjust the ringer volume. There are 5 levels for adjusting. During adjusting, the icon  varies according to the volume levels. The more bars, the higher the volume.

1. Press Volume Up button to increase ringer volume.

OR

Use the volume up switch of your mobile phone to increase ringer volume (depending on your mobile phone).

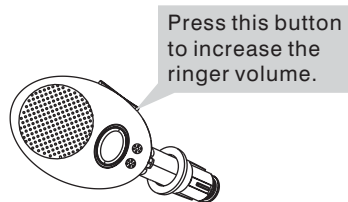

2. Press Volume Down button to decrease ringer volume.

OR

Use the volume up switch of your mobile phone to increase ringer volume (depending on your mobile phone).

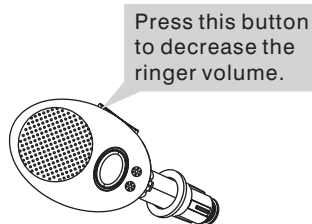

Installing the unit in a vehicle

1. Insert the plug of coil cord into the coil cord jack on the base unit. Make sure the plug clicks into place. See figure A.

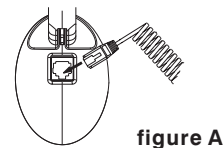

2. Installing the base unit (See figure B)
a. Insert the base unit into the cigarette lighter of your vehicle. See figure B.
b. Push the adjuster in the arrow direction to fasten the base unit.

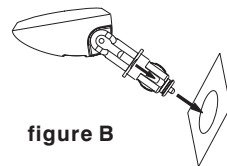

3. Paste the LCD display unit at proper place where you can watch the LCD display easily. The microphone mouth should be pointed toward to your mouth. See figure C.

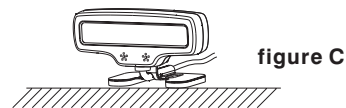

Base unit

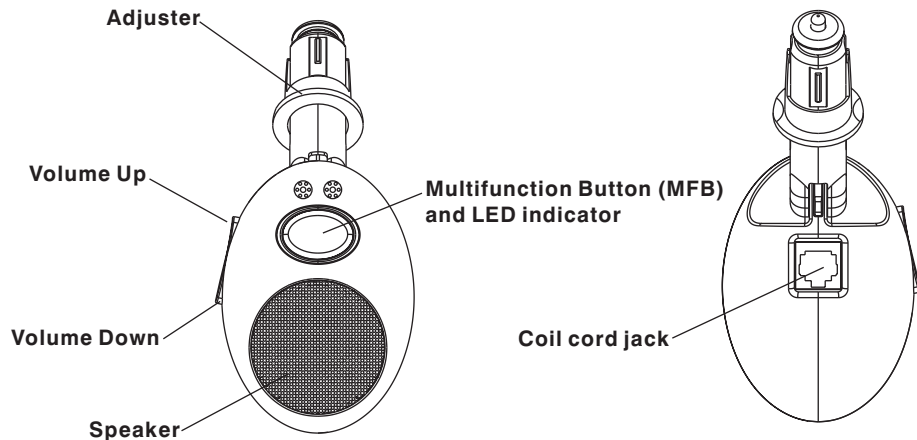

Adjusting speaker volume(continued)

2. Press Volume Down button to decrease speaker volume. See figure 2. OR Use the volume down switch of your mobile phone to decrease speaker volume (depending on your mobile phone).

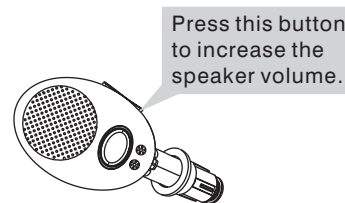

Figure 1

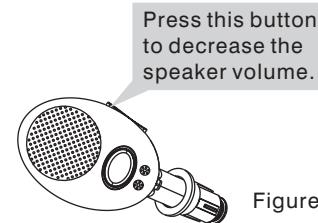

Figure 2

Note:

- When you use **Volume Up** or **Volume Down** button of the unit to adjust the speaker volume, your mobile phone's talk volume may be adjusted accordingly (depending on your mobile phone).

Pairing(continued)

match. Then the phone will remind you to enter passkey. The default passkey is " 0000 ". Please refer to the user's manual of your mobile phone for "pairing process".

VOL

Note:

- After the unit enters pairing mode, if there is no device linked within 2 minutes, the unit will return to Standby mode.
- If the pairing is successful, the LCD display shows "VOL" and the unit enters Standby mode. Then the unit and mobile phone are ready for use.

Adjusting speaker volume

You can press **volume up** or **volume down** button or use your mobile phone (depending on your mobile phone) to adjust the speaker volume during conversation. There are 5 levels for adjusting. During adjusting, the icon  varies according to the volume levels. The more bars, the higher the volume.

1. Press Volume Up button repeatedly to increase speaker volume. See figure 1. **OR** Use the volume up switch of your mobile phone to increase speaker volume (depending on your mobile phone).

Display unit

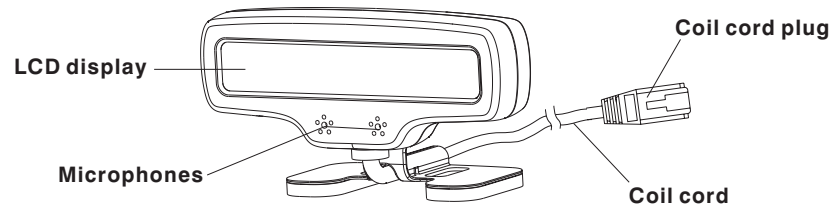

Pairing

Your BT-201 can store pairing information for up to five different devices equipped with Bluetooth wireless technology. When an attempt to pair to more than five devices is made, the oldest paired device is removed from the memory.

When any of the paired devices are in the range of 10 metres and power is on, the unit will automatically initiate a paired connection with the **last** device it was connected to. If not, press **MFB** to quickly start the connection.

If you want to connect to another device of the paired devices, you could initiate the connection from your mobile phone (please refer to your mobile phone's manual). If you want to connect to other devices which haven't paired with the unit, you must initiate the pairing process as follows.

Note:

- If you power down then up the unit or the paired mobile phone, they will initiate the connection automatically.

With the unit and your mobile phone in close proximity, do the following steps to pair them.

Pairing(continued)

1. **Press and hold MFB until a prompt tone is heard to indicate the unit is turned off. (When the unit is in Standby mode.)**
2. **Press and hold MFB until the Red LED and Blue LED flash alternately. Then the unit enters pairing mode, and a continuous line flashes on the LCD.**

Note:

- You will hear a prompt tone which indicates the unit is turned on. You should continually hold the button until the Red LED and Blue LED flash alternately. Then the unit enters pairing mode.

3. **Initiate the pairing process using the mobile phone that you want to**

Press and hold this button.

